

ROUTE NO.	SECTION	COUNTY	TOTAL SHEETS	SHEET NO.
224	04-00137-03-FP	HENRY	31	13
FED. ROAD DIST. NO. 7		ILLINOIS	FED. AID PROJECT SP-204007	

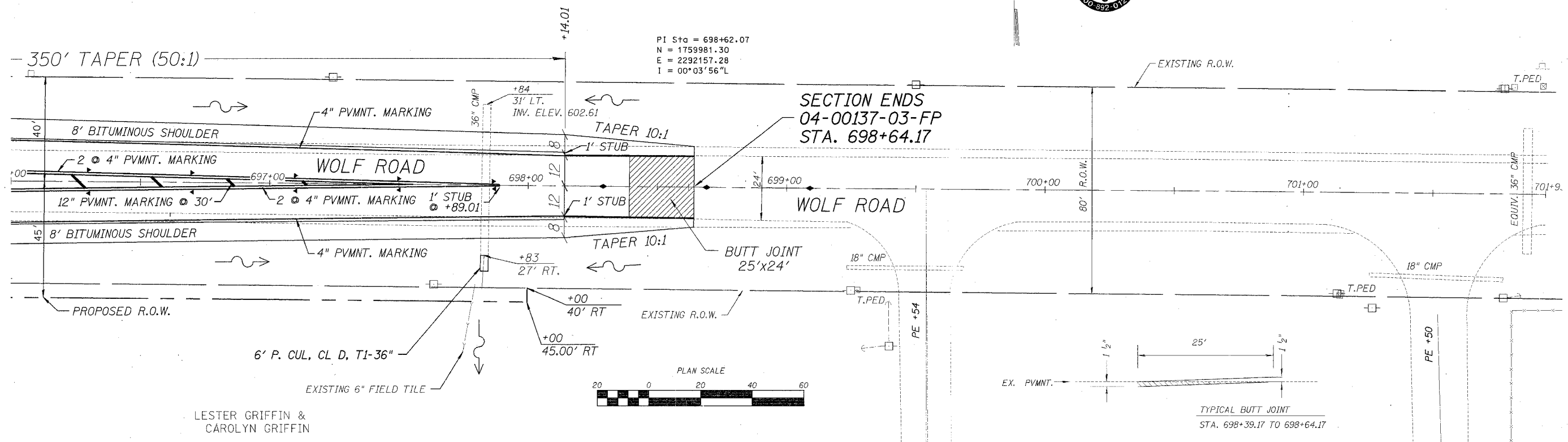

PI Sta = 698+62.07
 N = 1759981.30
 E = 2292157.28
 I = 00°03'56" L



LESTER GRIFFIN &
 CAROLYN GRIFFIN

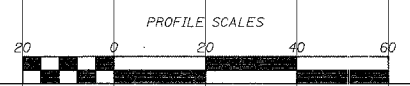
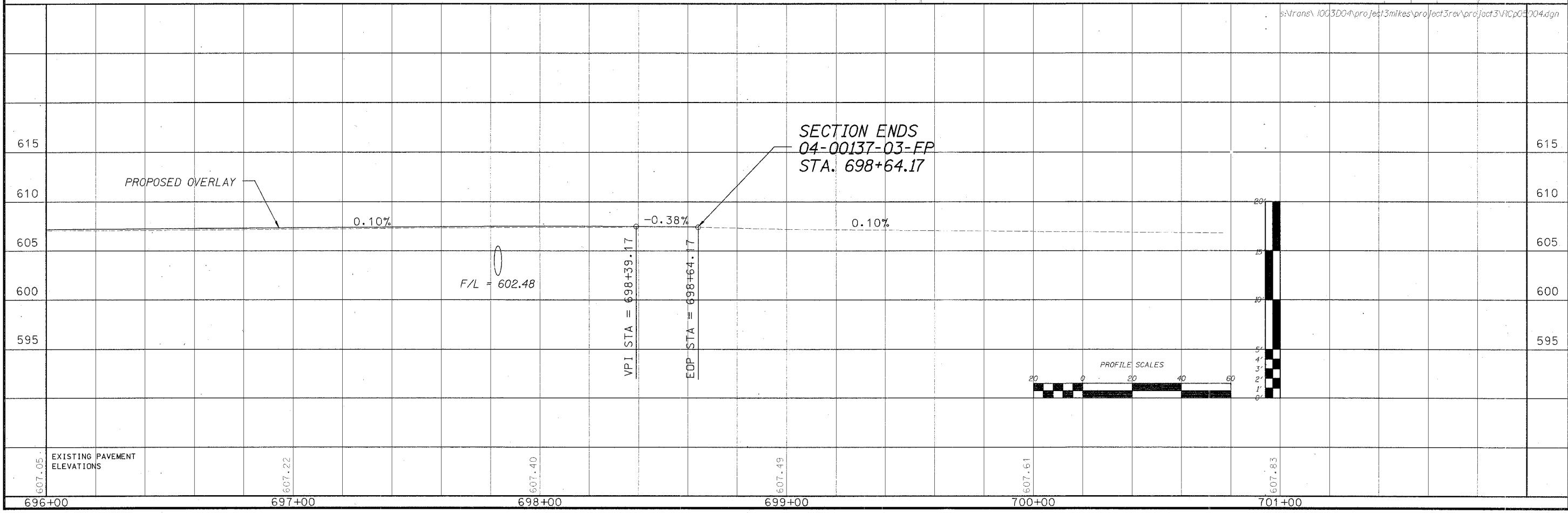
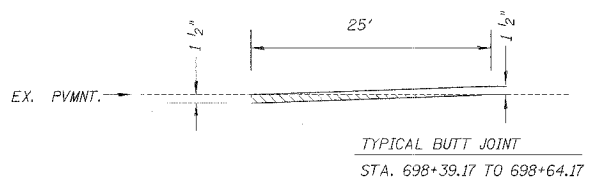

EXISTING PAVEMENT
 ELEVATIONS

607.05
 607.22
 607.40
 607.49
 607.61
 607.83

s:\trans\1003D04\proj\3mikes\project3rev\proj\3\VRCP05004.dgn