

ROUTE NO.	SECTION	COUNTY	TOTAL SHEETS	SHEET NO.
MS 1090	*	BUREAU COUNTY	27	11
SECTION 01-00008-00-BR		ILLINOIS	FED. AID PROJECT	

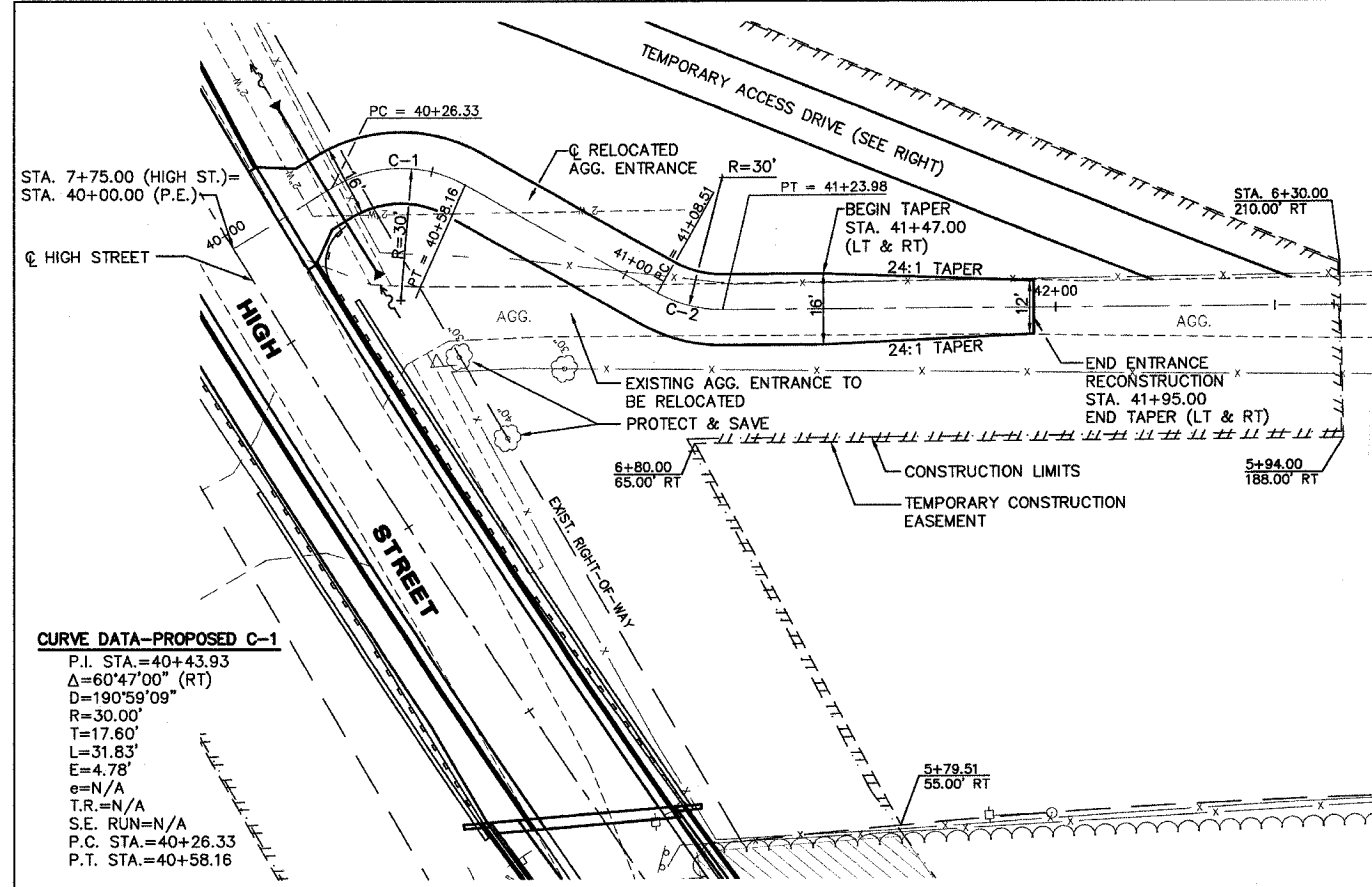

CURVE DATA-PROPOSED C-1
 P.I. STA. = 40+43.93
 Δ = 60°47'00" (RT)
 D = 190°59'09"
 R = 30.00'
 T = 17.60'
 L = 31.83'
 E = 4.78'
 e = N/A
 T.R. = N/A
 S.E. RUN = N/A
 P.C. STA. = 40+26.33
 P.T. STA. = 40+58.16

CURVE DATA-PROPOSED C-2
 P.I. STA. = 41+16.42
 Δ = 29°33'21" (LT)
 D = 190°59'09"
 R = 30.00'
 T = 7.91'
 L = 15.48'
 E = 1.03'
 e = N/A
 T.R. = N/A
 S.E. RUN = N/A
 P.C. STA. = 41+08.51
 P.T. STA. = 41+23.98

DRIVEWAY RELOCATION - STA. 7+75 RT

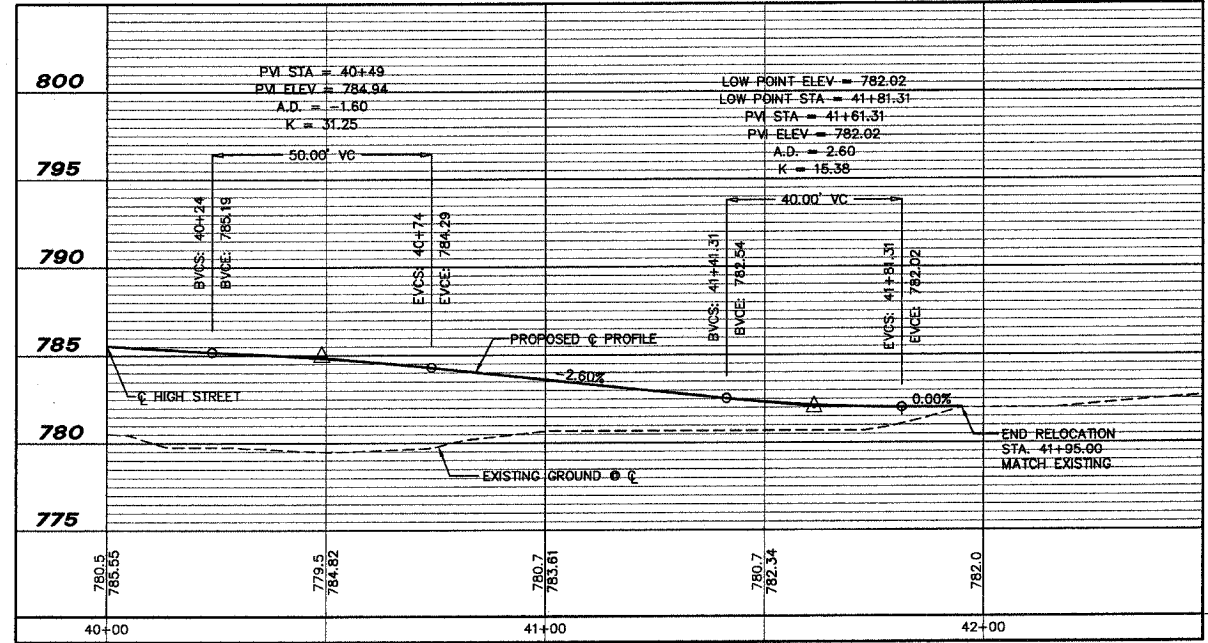
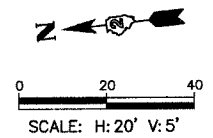

CURVE DATA-PROPOSED C-3
 P.I. STA. = 30+44.29
 Δ = 90°00'00" (RT)
 D = 286°28'44"
 R = 20.00'
 T = 20.00'
 L = 31.42'
 E = 8.28'
 e = N/A
 T.R. = N/A
 S.E. RUN = N/A
 P.C. STA. = 30+24.29
 P.T. STA. = 30+55.71

CURVE DATA-PROPOSED C-4
 P.I. STA. = 30+93.26
 Δ = 38°12'31" (LT)
 D = 286°28'44"
 R = 20.00'
 T = 6.93'
 L = 13.34'
 E = 1.17'
 e = N/A
 T.R. = N/A
 S.E. RUN = N/A
 P.C. STA. = 30+86.33
 P.T. STA. = 30+99.67

CURVE DATA-PROPOSED C-5
 P.I. STA. = 33+47.49
 Δ = 21°51'04" (LT)
 D = 286°28'44"
 R = 20.00'
 T = 3.86'
 L = 7.63'
 E = 0.37'
 e = N/A
 T.R. = N/A
 S.E. RUN = N/A
 P.C. STA. = 33+43.63
 P.T. STA. = 33+51.25

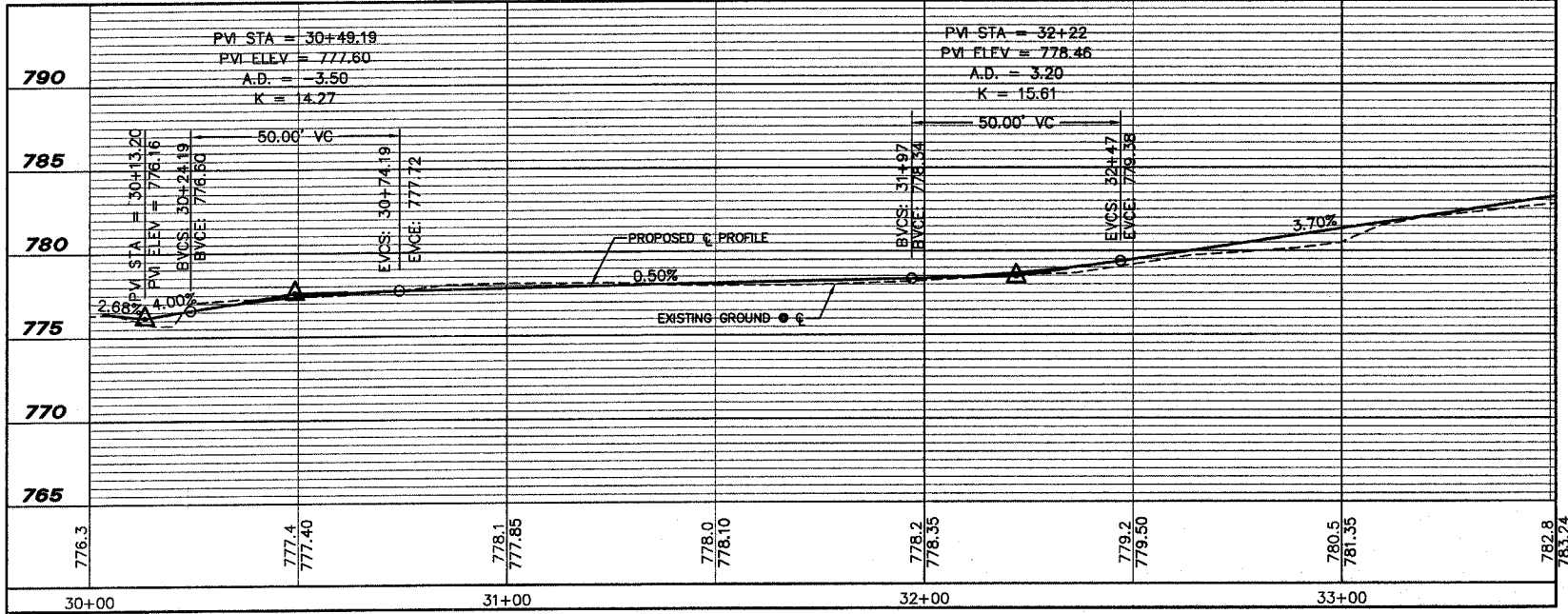
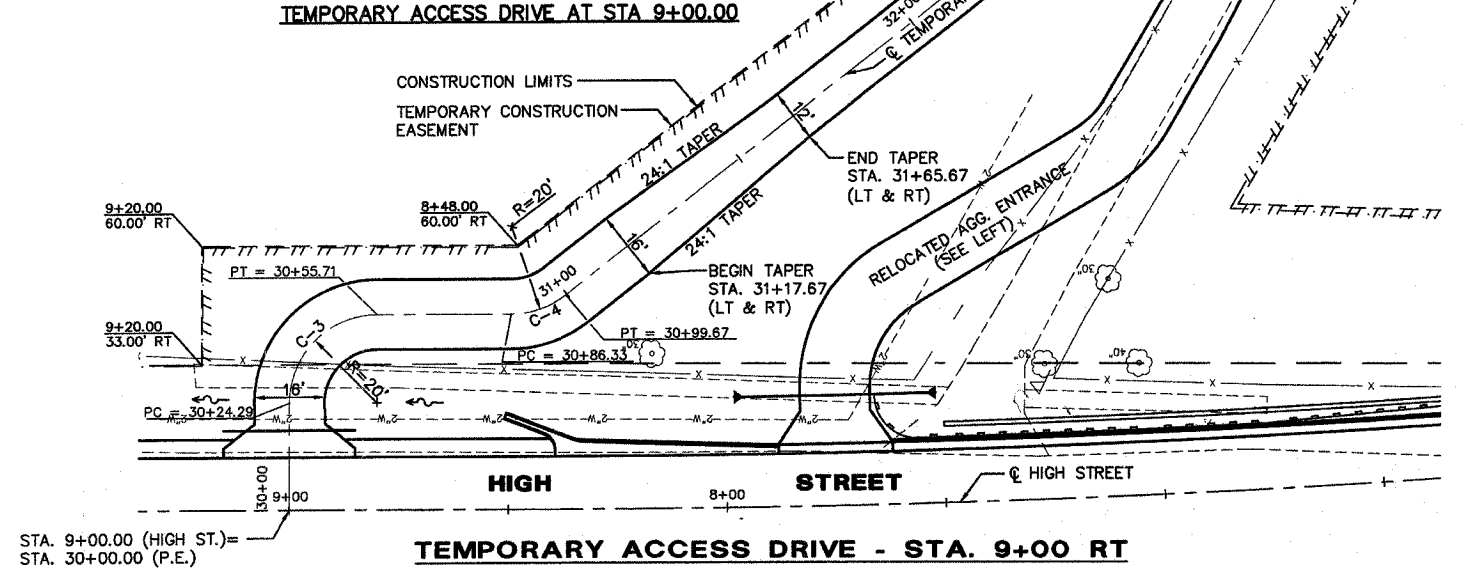
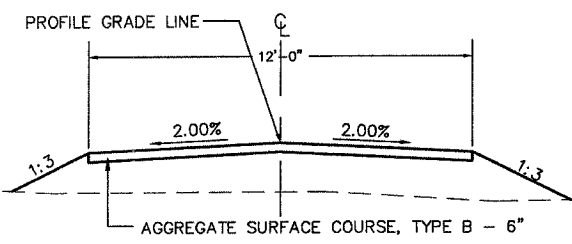

McCLURE ENGINEERING ASSOCIATES, INC.
 1138 COLUMBUS STREET OTTAWA, ILLINOIS 61350
 PHONE (815) 433-2080 FAX (815) 433-5930
 DESIGN FIRM LICENSE: ILLINOIS #184-000816
 COPYRIGHT 2006 BY McCLURE ENGINEERING ASSOCIATES, INC.

REVISIONS	
NAME	DATE

PLAN & PROFILE DRIVEWAY & TEMPORARY ACCESS

SCALE: H: 20' V: 5' DRAWN BY: DAC
 DATE: FEBRUARY 14, 2006 CHECKED BY: JAK/SAS
 FILE: H:\DRVG\BUDA\HIGH ST. BRIDGE BASE-ELEVATED-2005