

**INTERSECTION PAVEMENT MARKING DETAIL**  
SCALE: N.T.S.

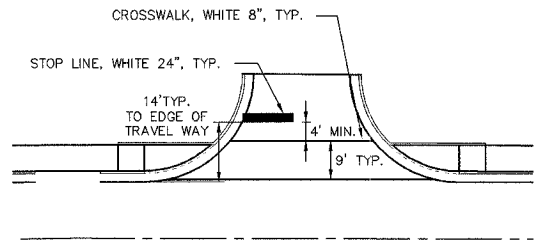

**CROSSWALK AND STOP BAR DETAIL (TYPICAL)**  
SCALE: N.T.S.

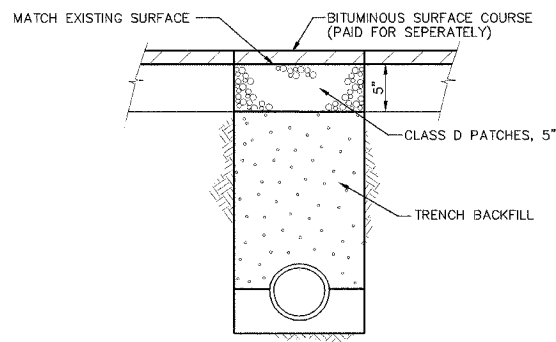

**TRENCH BACKFILL PATCHING DETAILS**  
SCALE: N.T.S.

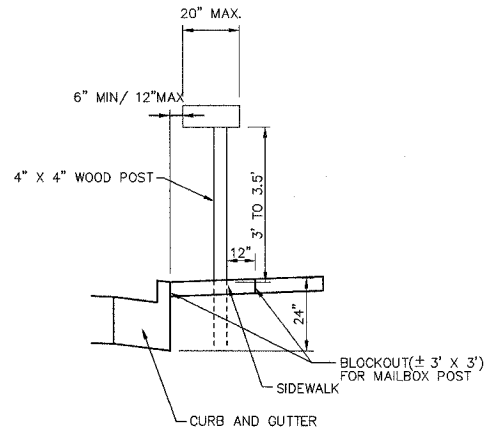

**MAILBOX PLACEMENT DETAIL**  
SCALE: N.T.S.

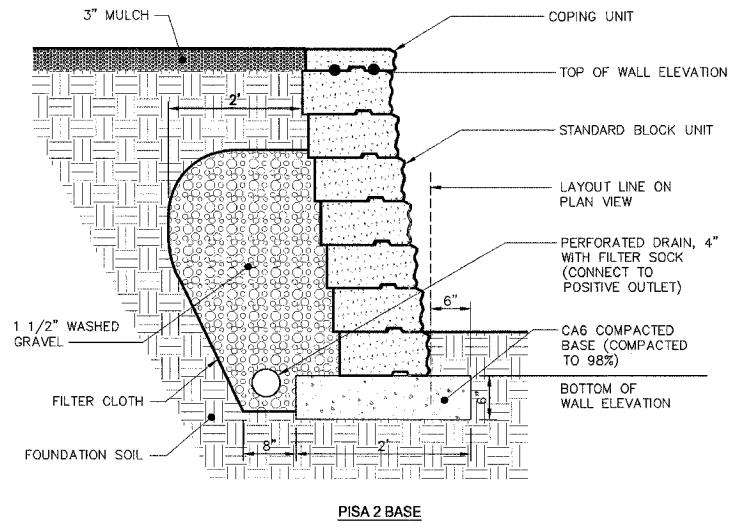

**RETAINING WALL**  
SCALE: N.T.S.

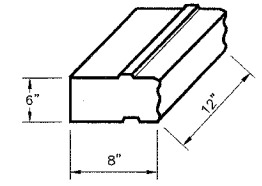

**BLOCK DIMENSIONS**  
SCALE: N.T.S.

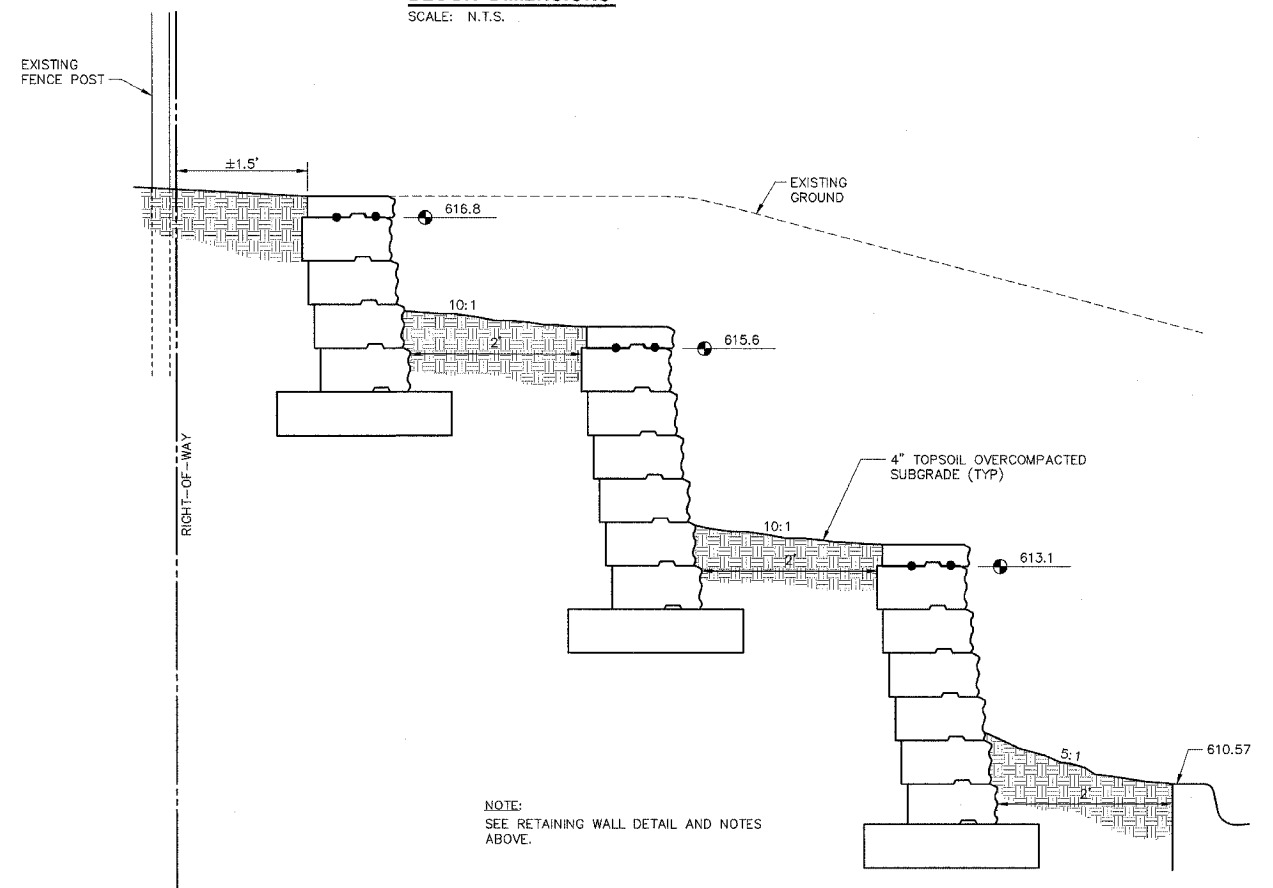

NOTE:  
SEE RETAINING WALL DETAIL AND NOTES ABOVE.

**SECTION THROUGH MODULAR WALLS**  
**STATION 91+00 - LOOKING EAST**  
SCALE: N.T.S.

- RETAINING WALL NOTES:**
1. WALL SHALL BE MODULAR RETAINING WALL SYSTEM AS MANUFACTURED BY UNILOCK, OR PAVELOC INDUSTRIES OR APPROVED EQUIVALENT.
  2. THE COMPLETE WALL SHALL BE BUILT PER DESIGN AND MANUFACTURER'S DETAILS AND SPECIFICATIONS.
  3. COLOR SHALL BE NATURAL.
  4. THE CONTRACTOR SHALL LAYOUT AND STAKE THE ENTIRE WALL PRIOR TO CONSTRUCTION. REVIEW THE ENTIRE LAYOUT WITH THE OWNER PRIOR TO STARTING THE WORK.
  5. SECURE COPING UNITS TO THE WALL PER MANUFACTURER'S DIRECTION.
  6. ALL EXPOSED CORNERS SHALL BE STANDARD CORNER UNITS.
  7. BASE COURSE SHALL BE INSTALLED PER BOTH MANUFACTURERS RECOMMENDATION FOR STRAIGHT WALLS AND FOR CURVED WALLS.
  8. DRAIN TILE BEHIND THE WALL SHALL BE STANDARD ADS 4\"/>