

THE LOCATIONS OF EXISTING WATER MAINS, GAS MAINS, SEWERS, ELECTRIC POWER LINES, TELEPHONE LINES AND OTHER UTILITIES AS SHOWN ON THE PLANS ARE BASED ON CAREFUL FIELD INVESTIGATION AND THE BEST INFORMATION AVAILABLE, BUT THEY ARE NOT GUARANTEED. UNLESS ELEVATIONS ARE SHOWN --- ALL UTILITY LOCATIONS SHOWN ON THE CROSS SECTIONS ARE BASED ON THE APPROXIMATE DEPTH SUPPLIED BY THE UTILITY COMPANY. IT SHALL BE THE CONTRACTOR'S RESPONSIBILITY TO ASCERTAIN THEIR EXACT LOCATION FROM THE UTILITY COMPANIES AND BY FIELD INSPECTION.

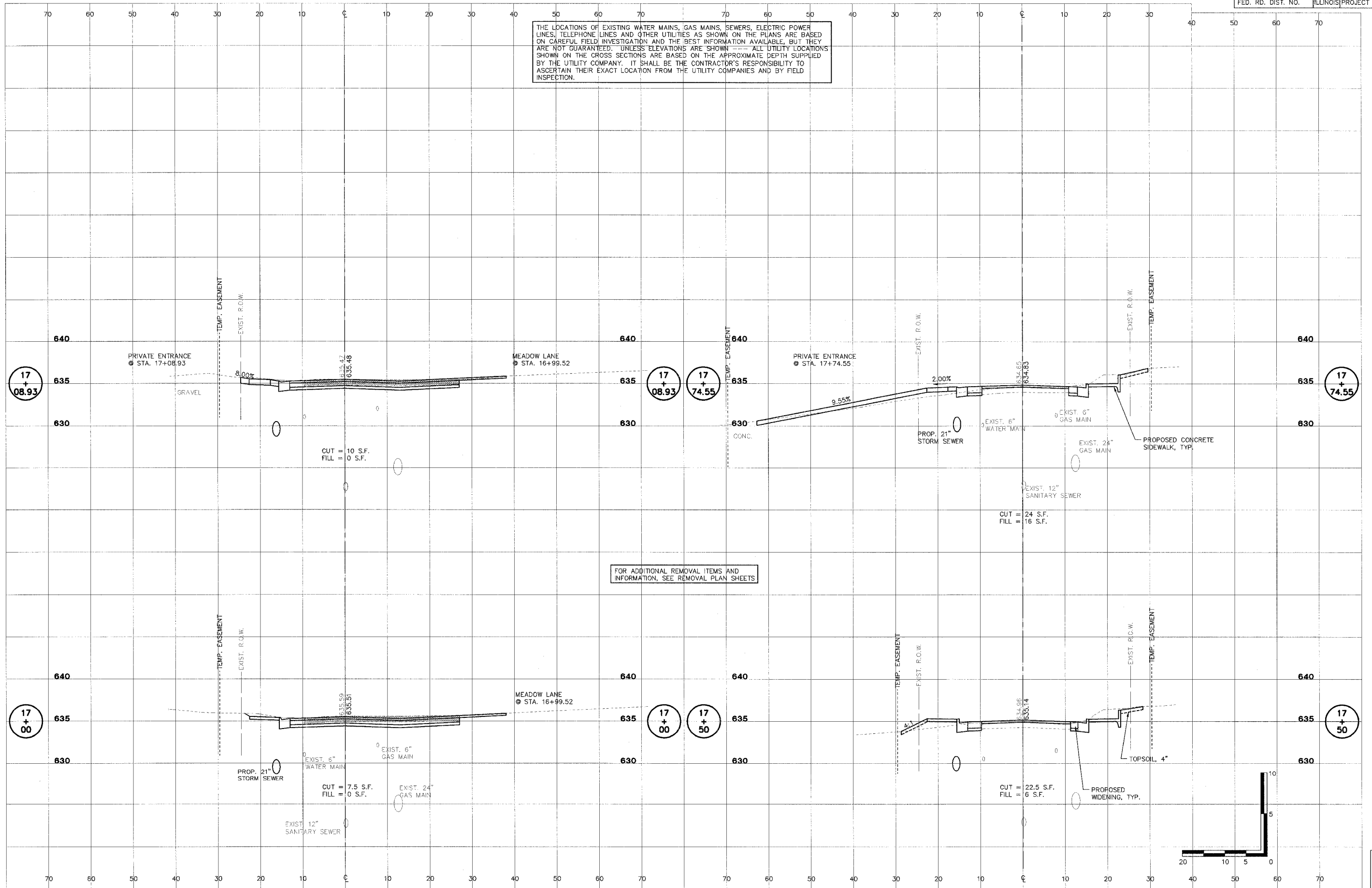

FOR ADDITIONAL REMOVAL ITEMS AND INFORMATION, SEE REMOVAL PLAN SHEETS

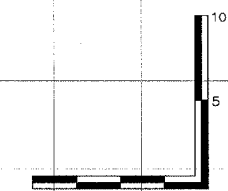

SHEET  
OF  
52  
83

<p><b>STS CONSULTANTS</b> 111 NE Jefferson Ave. Peoria, Illinois 61602 Ph: (309) 679-8484 Fax: (309) 676-5445 IL Design Firm Reg. No. 184-001518</p>	<p><b>LAFAYETTE AVE. BARTONVILLE IL.</b></p>		<p><b>CROSS SECTIONS STA. 17+00 TO STA. 17+74.55</b></p>		<p>SURVEY</p>	<p>CHECKED</p>	<p>ISSUE DATE 01/06/06</p>	
	<p>DESIGN</p>	<p>APPROVED</p>	<p>PRELIM. DATE 11/21/05</p>	<p>PROJECT NO. BART0001</p>	<p>DRAWN DEH</p>	<p>ISSUE DATE 01/06/06</p>	<p>PRELIM. DATE 11/21/05</p>	<p>PROJECT NO. BART0001</p>
	<p>DEPARTMENT OF TRANSPORTATION</p>							