

| F.A.S. RTE. | SECTION | COUNTY | TOTAL SHEETS | SHEET NO. |
|-----------------------|----------------|-----------------------------------|--------------|-----------|
| 405 | 04-00035-01-BR | WARREN | 16 | 5 |
| STA. 32+34.25 | | TO STA. 35+51.75 | | |
| FED. ROAD DIST. NO. 7 | | ILLINOIS PROJECT NO. BRS-405(103) | | |
| CONTRACT NO. 89381 | | | | |

- LEGEND**
- EXISTING CULVERT
 - EXISTING POWER POLE
 - EXISTING SIGN
 - EXISTING TELEPHONE PEDESTAL
 - EXISTING FENCE
 - EXISTING TELEPHONE LINE
 - EXISTING GUARDRAIL
 - EXISTING DITCH FLOWLINE
 - EXISTING R.O.W.

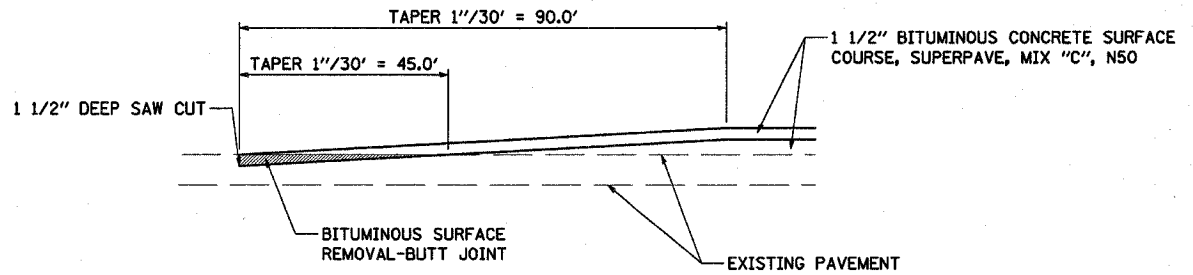
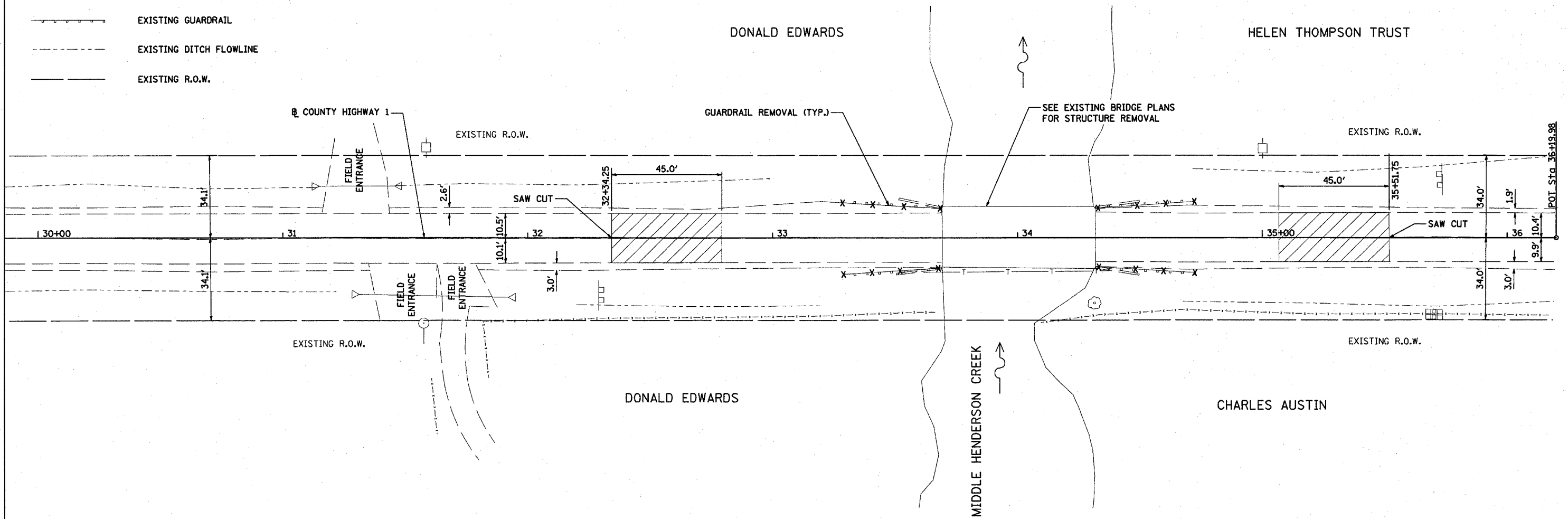
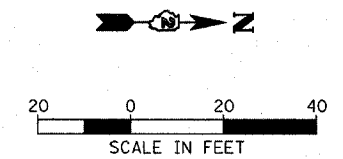

BUTT JOINT DETAIL
NOT TO SCALE

- REMOVAL LEGEND**
- BITUMINOUS SURFACE REMOVAL-BUTT JOINT
 - GUARDRAIL REMOVAL

NOTE:
THE EXISTING GUARDRAIL ON THE SITE SHALL BE SALVAGED AND STOCK PILED FOR PICK-UP BY WARREN COUNTY.

| REVISIONS | |
|-----------|------|
| NAME | DATE |
| | |
| | |
| | |
| | |
| | |
| | |
| | |
| | |
| | |
| | |

ILLINOIS DEPARTMENT OF TRANSPORTATION
F.A.S. 405
SECTION 04-00035-01-BR
WARREN COUNTY
COUNTY HIGHWAY 1 OVER MIDDLE HENDERSON CREEK

REMOVAL PLAN

SCALE: VERT. _____
HORIZ. 1"=20'
DATE 02/06/06

DRAWN BY RLA
CHECKED BY JDS

HANSON Professional Services, Inc. Copyright © Hanson Professional Services, Inc. 2006
 LAYOUT: RLA 09/13/05 r10#
 DRAWN: RLA 02/01/06 02:06:00C06.r10# AM
 REVIEWED: JDS 02/03/06 \$FILE\$