

ROUTE NO.	SECTION	COUNTY	TOTAL SHEETS	SHEET NO.
C.H. 8	05-00085-00-BR	MARSHALL	13	1
		ILLINOIS	PROJ. NO. BROS-123(21)	

CONTRACT NO. 89397

# STATE OF ILLINOIS DEPARTMENT OF TRANSPORTATION DIVISION OF HIGHWAYS PLANS FOR PROPOSED BRIDGE REPLACEMENT AND REHABILITATION PROGRAM

**SECTION 05-00085-00-BR  
MARSHALL COUNTY  
PROJECT NO. BROS-123(21)  
COUNTY HIGHWAY 8  
JOB NO. C-94-078-06**

INDEX OF SHEETS	
SHEET NO.	TITLE
1.	COVER SHEET
2.	SUMMARY OF QUANTITIES, GENERAL NOTES & TYPICAL SECTIONS
3.	PLAN AND PROFILE SHEET
4.-8.	BRIDGE PLANS
9.-13.	STATION CROSS SECTIONS

**STANDARDS:**

- 280001-02
- 515001-02
- 630001-06
- 631026-02
- 635006-02
- 701301-02
- 702001-06
- BLR 21-6

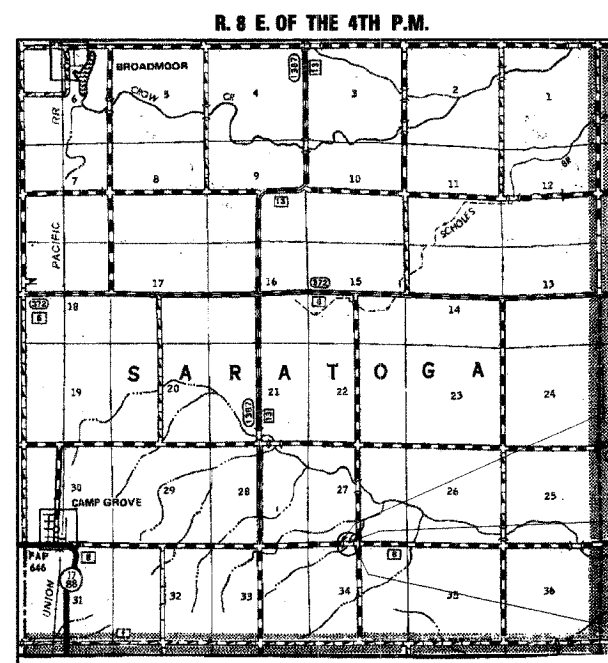
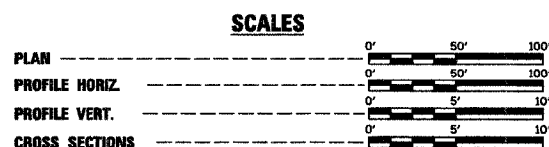

**LOCATION PLAN**

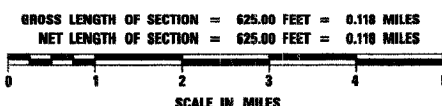

IMPROVEMENT BEGINS  
STA. 12 + 50

STA. 15 + 04 - SPECIAL BRIDGE DESIGN  
PRECAST PRESTRESSED CONCRETE  
DECK BEAM BRIDGE, ONE SPAN @  
55'-0" 28'-0" ROADWAY, 20° SKEW  
EXISTING S.N. 062-3124  
PROPOSED S.N. 062-3133

IMPROVEMENT ENDS  
STA. 18 + 75



*Fred J. Stone, Jr. (1-30-06)*  
ILLINOIS PROFESSIONAL NO. 26065  
EXPIRES 11-30-05

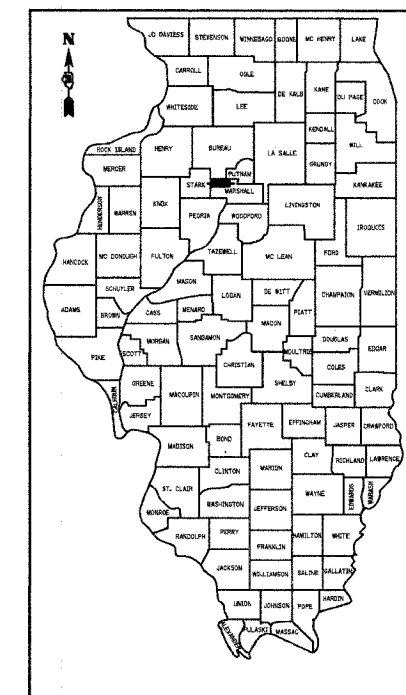

LOCATION OF SECTION INDICATED THUS:

**CLASSIFICATION: RURAL TWO-LANE COLLECTOR**  
**DESIGN VOLUME: ADT UNDER 400**  
**CURRENT ADT: 131 (2005)**  
**DESIGN SPEED: 40 MPH**

TOLL FREE JOINT UTILITY LOCATING  
INFORMATION FOR EXCAVATORS (J.U.L.I.E.)  
TELEPHONE NUMBER 1-800-892-0123

APPROVED	January 27, 2006 <i>George P. Meister</i> COUNTY ENGINEER
PASSED	February 3, 2006 <i>John J. Valle</i> DISTRICT FOUR ENGINEER OF LOCAL ROADS & STREETS
RELEASING FOR BID BASED ON LIMITED REVIEW	February 3, 2006 <i>Joseph J. Pave</i> DEPUTY DIRECTOR OF HIGHWAYS, REGION THREE ENGINEER
STATE OF ILLINOIS DEPARTMENT OF TRANSPORTATION	

4440 ASH GROVE  
SPRINGFIELD, IL 62711  
(217) 793-8600  
oasinc@tamvid.com

**OZYURT AND STONE, INC.**  
CONSULTING ENGINEERS