

| | | | |
|----------------|-----------|--------------|-----------|
| SECTION | COUNTY | TOTAL SHEETS | SHEET NO. |
| 01-00088-00-WR | CHAMPAIGN | 21 | 16 |
| STA. | TO STA. | | |
| F.H.W.A. REG. | ILLINOIS | PROJECT | |

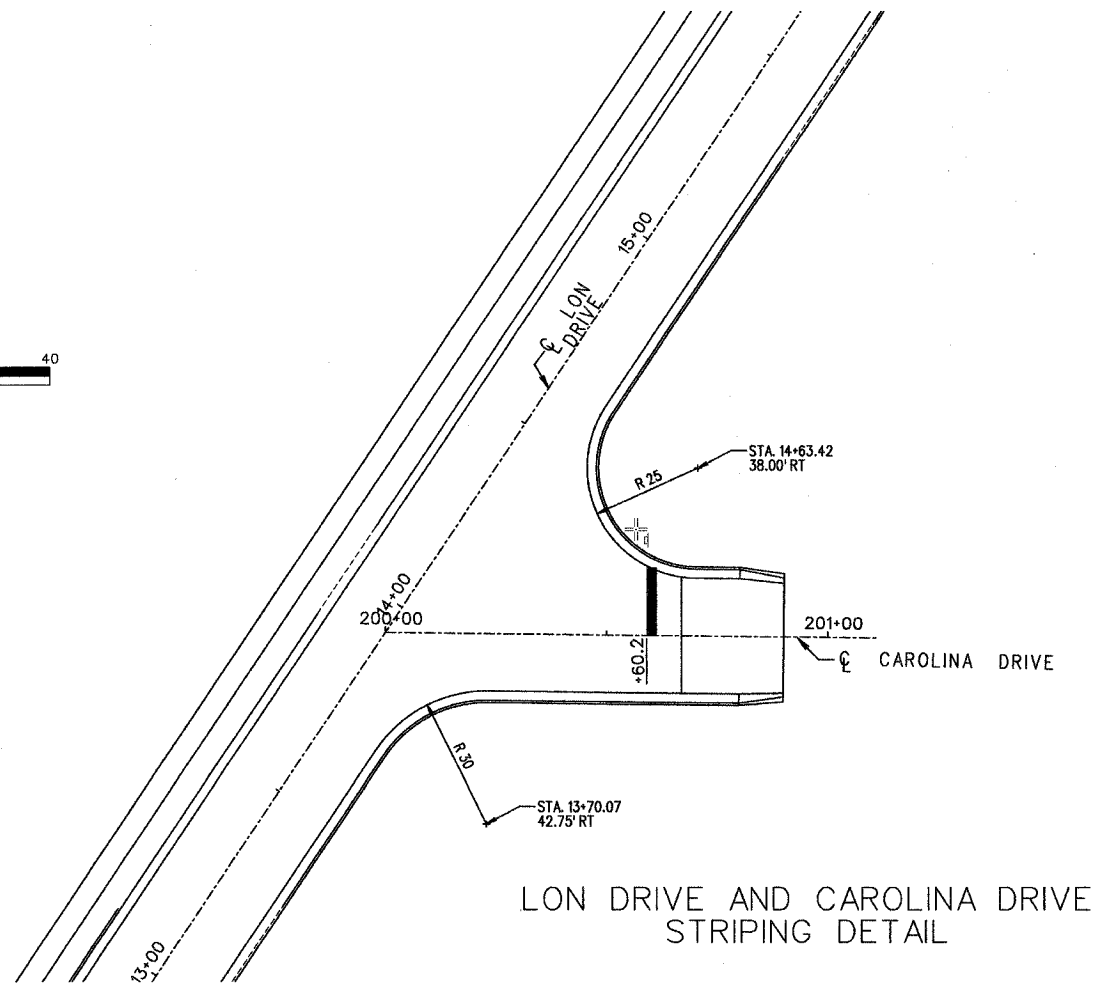

LON DRIVE AND CAROLINA DRIVE STRIPING DETAIL

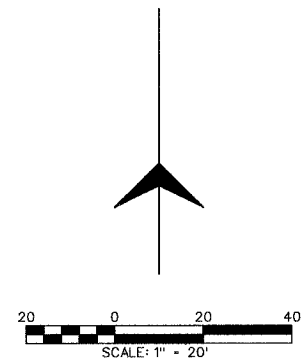
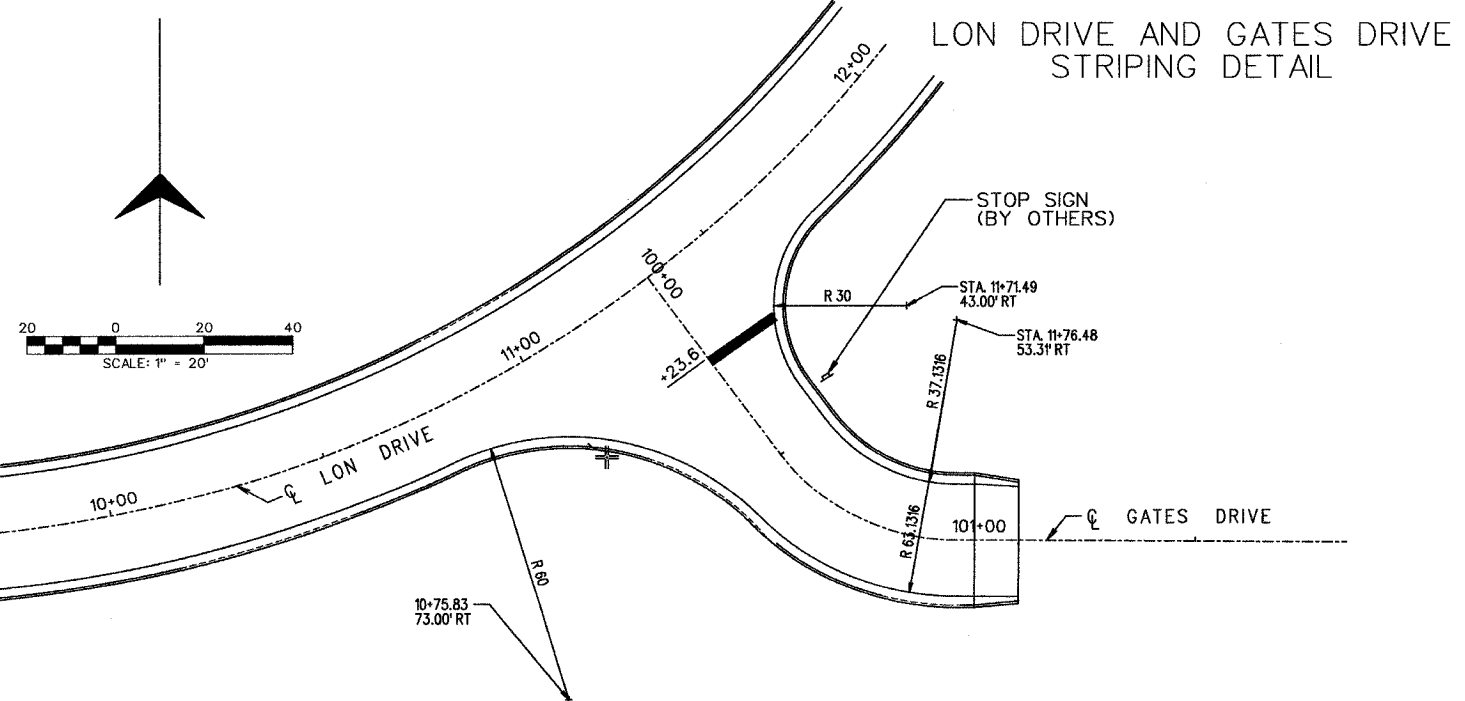
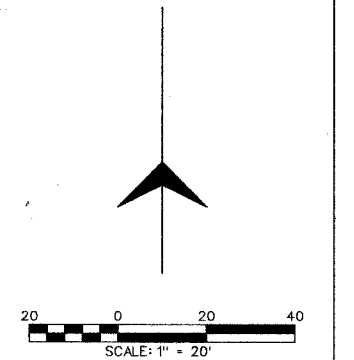
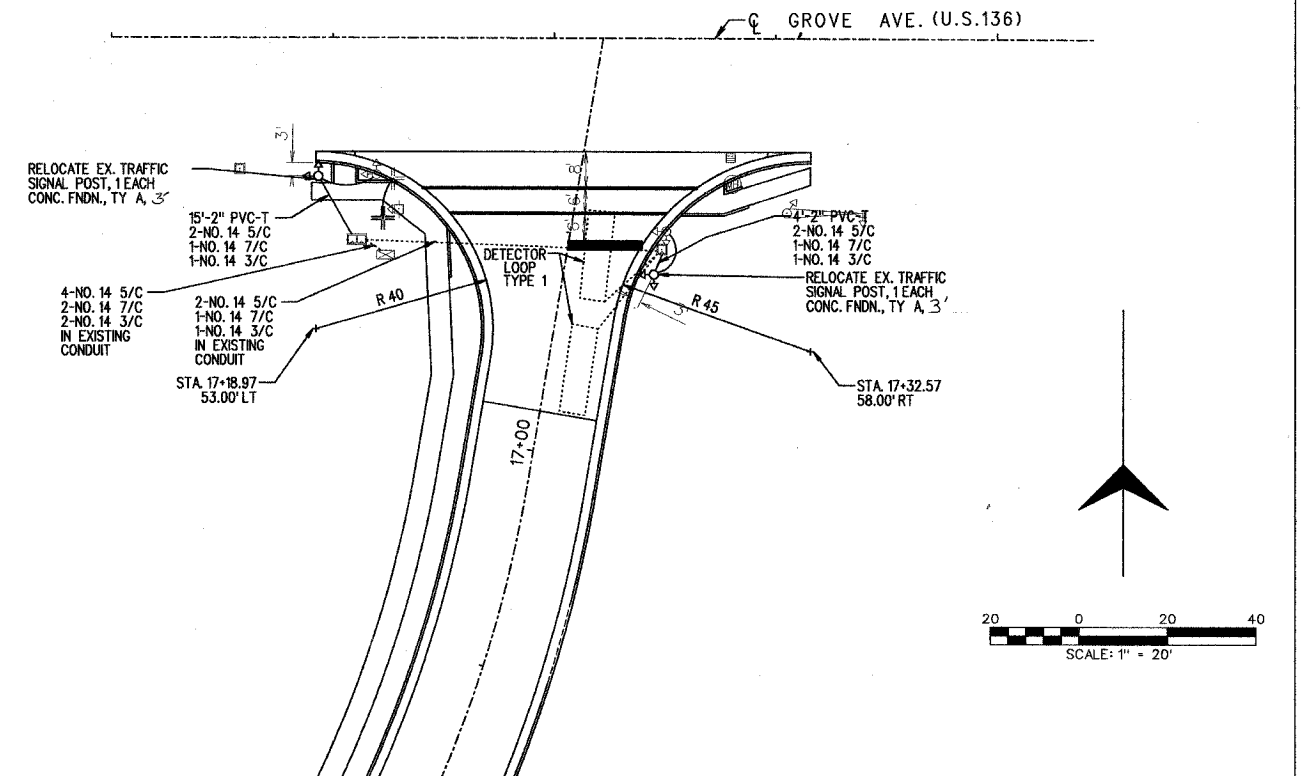

LON DRIVE AND GATES DRIVE STRIPING DETAIL

| BILL OF MATERIALS | | |
|---|------|----------|
| ITEM | UNIT | QUANTITY |
| CONDUIT IN TRENCH, 2 " DIA., PVC | FOOT | 19.0 |
| TRENCH AND BACKFILL FOR ELECTRICAL WORK | FOOT | 19.0 |
| ELECTRIC CABLE IN CONDUIT, SIGNAL No. 14 3C | FOOT | 170.0 |
| ELECTRIC CABLE IN CONDUIT, SIGNAL No. 14 5C | FOOT | 340.0 |
| ELECTRIC CABLE IN CONDUIT, SIGNAL No. 14 7C | FOOT | 170.0 |
| RELOCATE EXISTING TRAFFIC SIGNAL POST | EACH | 2.0 |
| CONCRETE FOUNDATION, TYPE A | FOOT | 6.0 |
| REMOVE EXISTING CONCRETE FOUNDATION | EACH | 2.0 |
| DETECTOR LOOP, TYPE I | FOOT | 141.0 |
| REMOVE ELECTRIC CABLE FROM CONDUIT | FOOT | 680.0 |

LON DRIVE AND US 136 SIGNAL AND STRIPING DETAIL