

TOTAL SHEETS 62  
SHEET NO. 1



**JULIE, INC.**  
The Illinois  
One-Call System  
1 (800) 892-0123

City of Urbana - Cunningham Township

STATE OF ILLINOIS  
DEPARTMENT OF TRANSPORTATION  
DIVISION OF HIGHWAYS

**PLANS FOR PROPOSED  
FEDERAL AID HIGHWAY**

SCALES

PLAN	1 INCH = 20 FEET
PROFILE HORIZ.	1 INCH = 20 FEET
PROFILE VERT.	1 INCH = 5 FEET
CROSS SECTIONS HORIZ.	1 INCH = 10 FEET
CROSS SECTIONS VERT.	1 INCH = 5 FEET

CITY OF URBANA  
CHAMPAIGN COUNTY, ILLINOIS  
SECTION NO. 95-00305-01-PV  
PROJECT NO. M-5181(39)  
JOB NO. C-95-327-05  
**PHILO ROAD**  
**F.A.U. ROUTE 7185**

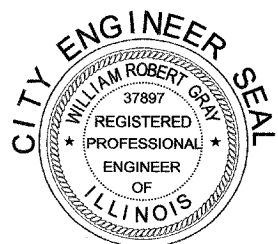

LICENSE EXPIRES  
**11/30/07**

INDEX OF SHEETS

SHEET NO.	DESCRIPTION
1	COVER SHEET
2	GENERAL NOTES
3-4	SUMMARY OF QUANTITIES
5-8	SCHEDULE OF QUANTITIES
9-11	DRAINAGE STRUCTURE SCHEDULES
12	DRAINAGE PIPE SCHEDULES
13	EXISTING TYPICAL SECTIONS
14-15	PROPOSED TYPICAL SECTIONS
16	HORIZONTAL ALIGNMENT LAYOUT
17-18	STORM WATER POLLUTION PREVENTION PLAN
19-20	STAGE CONSTRUCTION AND MAINTENANCE OF TRAFFIC PLAN
21-25	REMOVALS/RELOCATIONS PLAN
26-34	PLAN AND PROFILE - PHILO ROAD
35-39	PAVEMENT MARKING PLAN
40-41	PAVEMENT MARKING DETAILS
42-45	MISCELLANEOUS DETAILS
46-62	CROSS SECTIONS - PHILO ROAD

HIGHWAY STANDARDS

STANDARD NO.	DESCRIPTION
00001-04	STANDARD SYMBOLS, ABBREVIATIONS AND PATTERNS
280001-02	TEMPORARY EROSION CONTROL SYSTEMS
420001-06	PAVEMENT JOINTS
424001-04	CURB RAMPS FOR SIDEWALKS
442201-01	CLASS C AND D PATCHES
602301-01	INLET, TYPE A
602306-01	INLET, TYPE B
602401-01	MANHOLE, TYPE A
602601	PRECAST REINFORCED CONCRETE FLAT TOP SLAB
604001-02	FRAME AND LIDS, TYPE 1
604006-02	FRAME AND LIDS, TYPE 3
604036-01	GRATE, TYPE 8
606001-02	<b>CONCRETE CURB TYPE B AND COMBINATION CURB AND GUTTER</b>
701006-02	OFF-ROAD OPERATIONS, 2L, 2W, 15' TO 24" FROM PAVEMENT EDGE
701311-02	LANE CLOSURE, 2L, 2W, MOVING OPERATIONS-DAY ONLY
701501-03	URBAN LANE CLOSURE, 2L, 2W, UNDIVIDED
701606-04	URBAN LANE CLOSURE, MULTILANE, 2W WITH MOUNTABLE MEDIAN
701701-04	URBAN LANE CLOSURE, MULTILANE INTERSECTION
701801-03	LANE CLOSURE MULTILANE 1W OR 2W
	CROSSWALK OR SIDEWALK CLOSURE
702001-06	TRAFFIC CONTROL DEVICES
BLR 10-5	PCC PAVEMENT SPECIAL

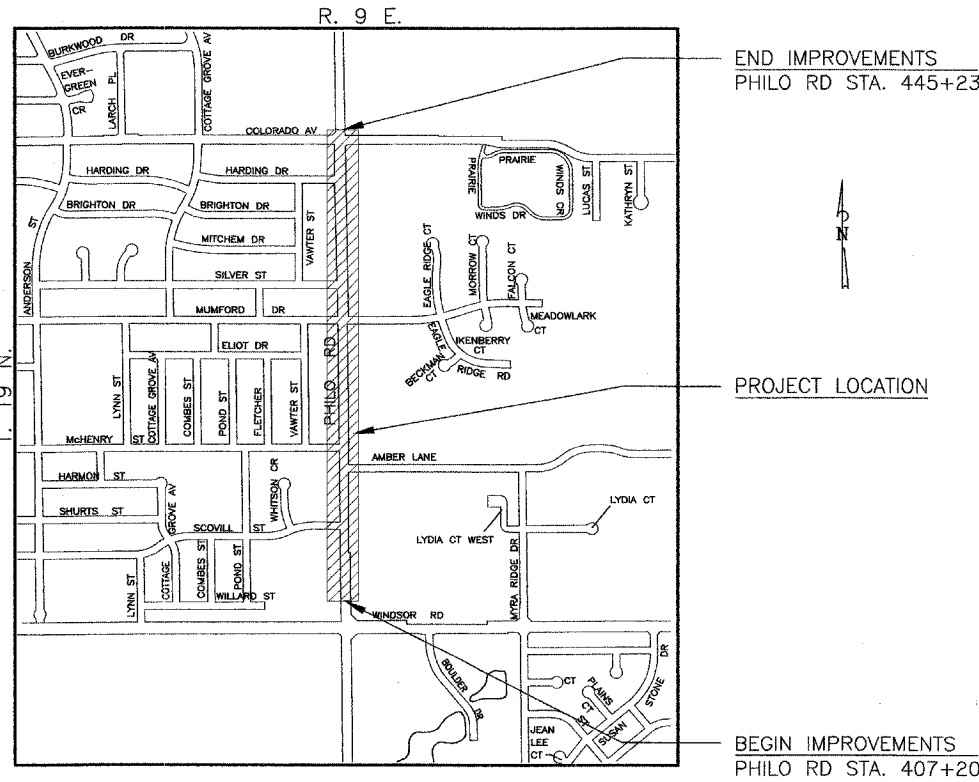

**LOCATION MAP**  
(NOT TO SCALE)

TOTAL LENGTH OF PROJECT = 3,803 FEET = 0.72 MILES  
TOTAL LENGTH OF IMPROVEMENT = 3,803 FEET = 0.72 MILES

Prepared by  
**CITY OF URBANA**  
PUBLIC WORKS DEPARTMENT  
ENGINEERING DIVISION

REVIEWED:

<i>Wickie R. May</i> Public Works Director/City Engineer	2/16/06 Date
<i>Paul D. Johnson</i> Assistant City Engineer	2/16/06 Date
<i>Craig Shanker</i> Civil Engineer	2-16-06 Date

**Illinois Department of Transportation**

PASSED 2/27 20 06

*Daniel H. Seal*  
DISTRICT FIVE ENGINEER OF  
LOCAL ROADS & STREETS

Releasing For Bid Based on Limited Review  
FEB 28 20 06

*Julie*  
DEPUTY DIRECTOR OF HIGHWAYS,  
REGION THREE ENGINEER

STATE OF ILLINOIS  
DEPARTMENT OF TRANSPORTATION