

ROUTE NO.	SECTION	LOBBY	TOTAL SHEETS	SHEET NO.
TR 261	*	Vermillion	10	4

\*94-14129-00-BR

BENCHMARKS

- BM #1 - CHISELED SQUARE IN TOP OF NE WINGWALL OF EXISTING BRIDGE, ELEV. 99.11
- BM #2 - R.R. SPIKE IN POWER POLE, STA. 108+24, 19' RT. ELEV. 99.52
- BM #3 - R.R. SPIKE IN POWER POLE, STA. 111+31, 36' RT. ELEV. 98.52

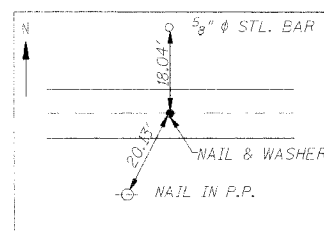
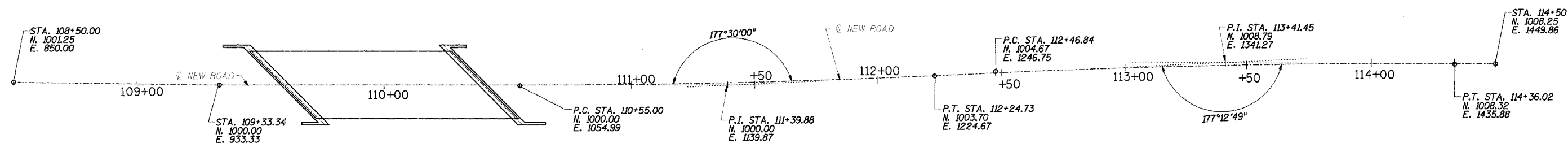
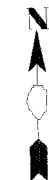

© STA. 106+00.00, 0.00' RT.  
N. 1000.00  
E. 600.00

TIE POINT #1

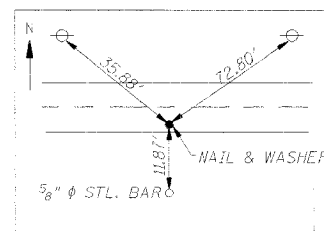

© STA. 114+00.12, 8.35' RT.  
N. 1000.00  
E. 1400.00

TIE POINT #2