

F.A.S. RTE.	SECTION	COUNTY	TOTAL SHEETS	SHEET NO.
567	04-00027-01-PV	MASON	79	26
STA.		TO STA.		
FED. ROAD DIST. NO.		ILLINOIS FED. AID PROJECT		

- NOTES:**
1. ALL PAVEMENT WIDTH DIMENSIONS ARE CALLED OUT FROM CENTERLINE TO EDGE OF PAVEMENT
 2. FROM STATION 47+40.00 SB LANE AND 47+60.00 NB LANE TO STATION 49+70.00 - SEE MISCELLANEOUS OVERLAY DETAIL NORTHBOUND LANE AND SOUTHBOUND LANE FOR MORE INFORMATION.
 3. SEE PROPOSED DRIVEWAY PAVEMENT SCHEDULE FOR PROPOSED DRIVEWAY SURFACES
 4. SEE MISCELLANEOUS DETAIL - SIDE ROADS, ENTRANCES, AND MAILBOX TURNOUTS FOR SIDE ROAD, MAILBOX, AND ENTRANCE CONSTRUCTION

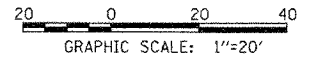
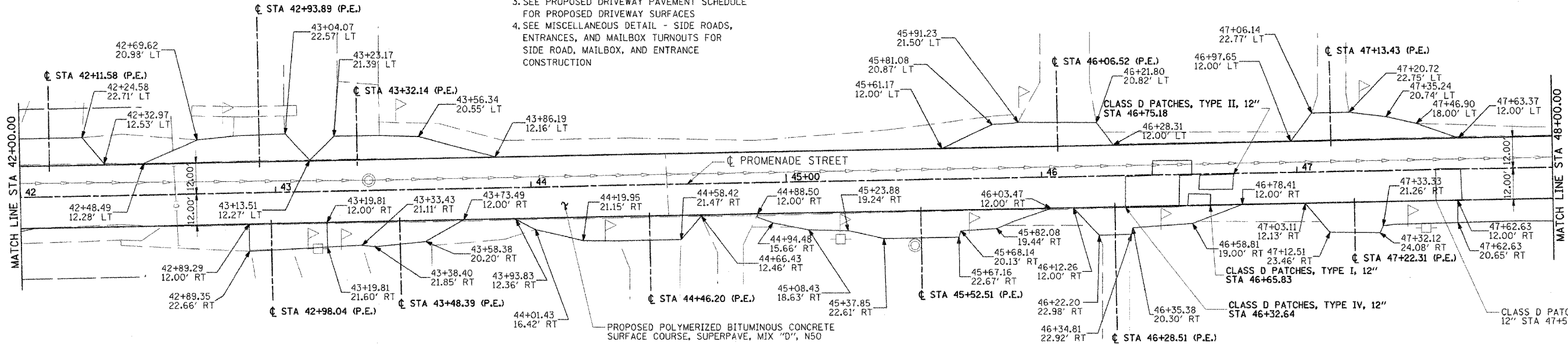
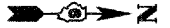

PLAN	DATE
BY	
REVIEWED	
DATE	

PROFILE	DATE
BY	
REVIEWED	
DATE	

LAYOUT	DATE
BY	
REVIEWED	
DATE	

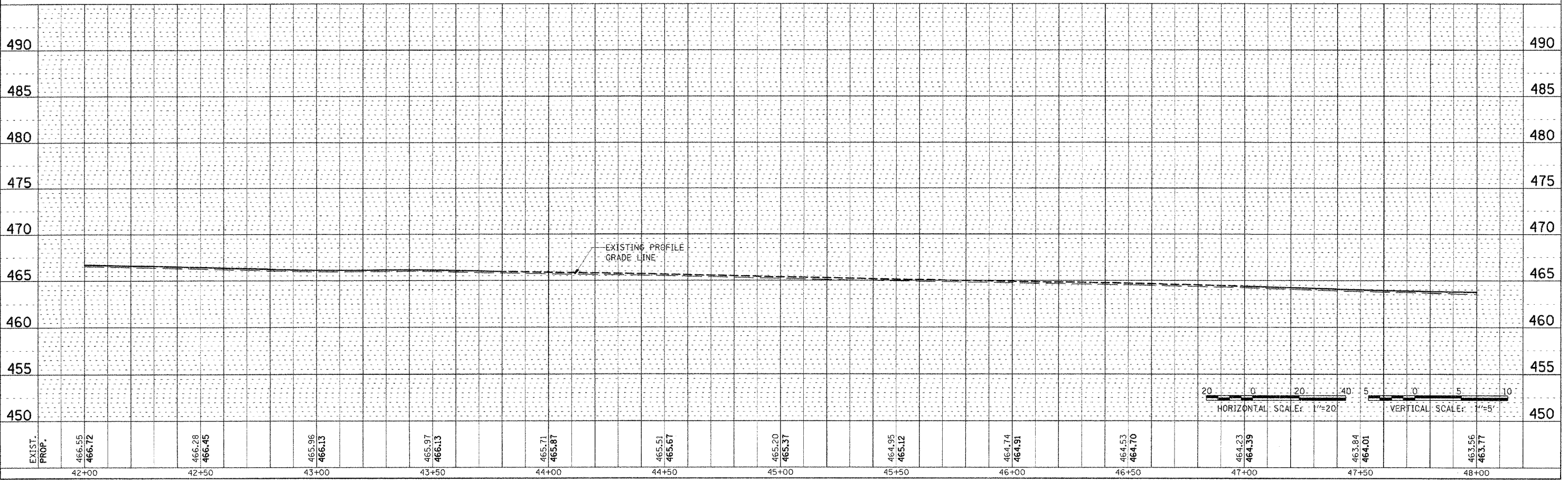

10:05:48 AM
 02/02/2006 12:05 AM
 FILE