

FINAL	DATE
DESIGNED	BY
SURVEY	PLOTTED
NOTE BOOK	TEMPLATE
NO.	AREAS CHECKED

ORIGINAL	DATE
SURVEY	BY
NOTE BOOK	PLOTTED
NO.	TEMPLATE
	AREAS CHECKED

F.A.P. RTE.	SECTION	COUNTY	TOTAL SHEETS	SHEET NO.
327	182 & 18V, RS 282	MARION	222	162
STA.	TO STA.			
FED. ROAD DIST. NO.	ILLINOIS	FED. AID PROJECT		

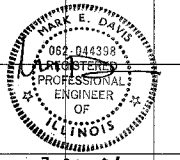
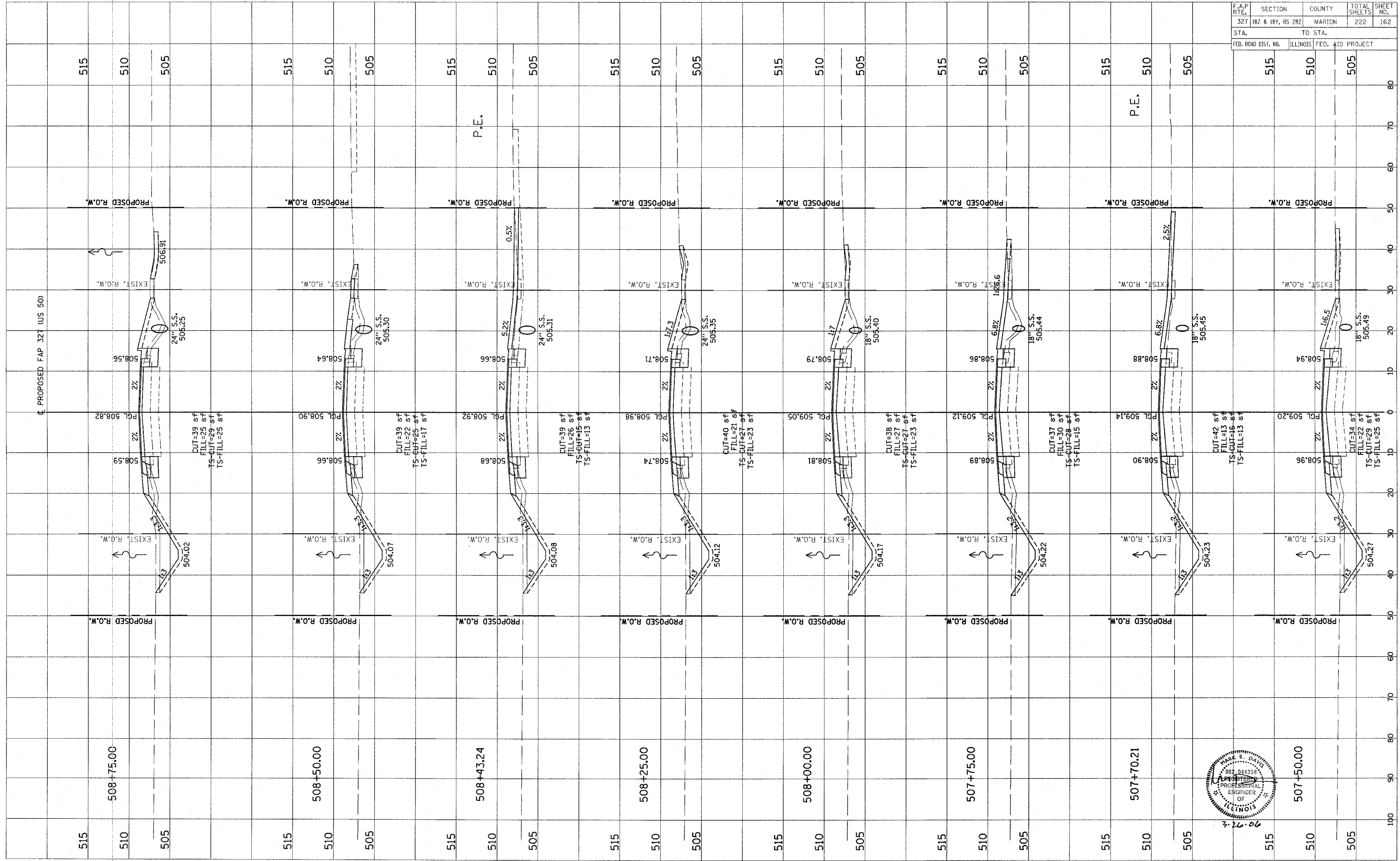

Revised 3/28/06

CONTRACT NO. 94700