

N.E. QUADRANT			
STATIONING ALONG U.S. RTE. 51	OFFSET TO EOP FEET	EOP ELEV FEET	DISTANCE ALONG RAD. FEET
LT. 2305+29.95	22.00	513.69	
LT. 2305+53.07	20.83	513.66	23.00
LT. 2305+71.96	22.07	513.47	18.80
LT. 2305+91.67	25.40	513.27	20.00
LT. 2306+11.13	30.02	513.08	20.00
LT. 2306+30.24	35.91	512.89	20.00
LT. 2306+48.28	44.40	512.69	20.00
LT. 2306+63.63	57.14	512.50	20.00
LT. 2306+75.30	73.32	512.83	20.00
LT. 2306+82.56	91.90	513.15	20.00
LT. 2306+84.65	106.39	513.39	14.68

S.E. QUADRANT			
STATIONING ALONG U.S. RTE. 51	OFFSET TO EOP FEET	EOP ELEV FEET	DISTANCE ALONG RAD. FEET
LT. 2307+20.39	171.46	513.36	
LT. 2307+21.24	161.76	513.32	9.74
LT. 2307+23.89	141.94	513.25	20.00
LT. 2307+27.76	122.32	513.18	20.00
LT. 2307+32.83	102.97	513.11	20.00
LT. 2307+39.09	83.98	513.04	20.00
LT. 2307+46.31	69.16	512.98	16.52
LT. 2307+58.93	53.71	512.91	20.00
LT. 2307+75.01	41.91	512.84	20.00
LT. 2307+95.53	34.52	512.77	20.00
LT. 2308+13.32	32.00	512.70	20.00

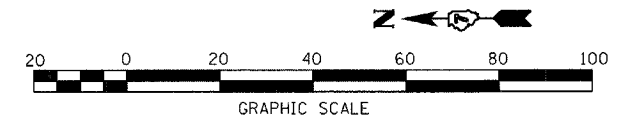
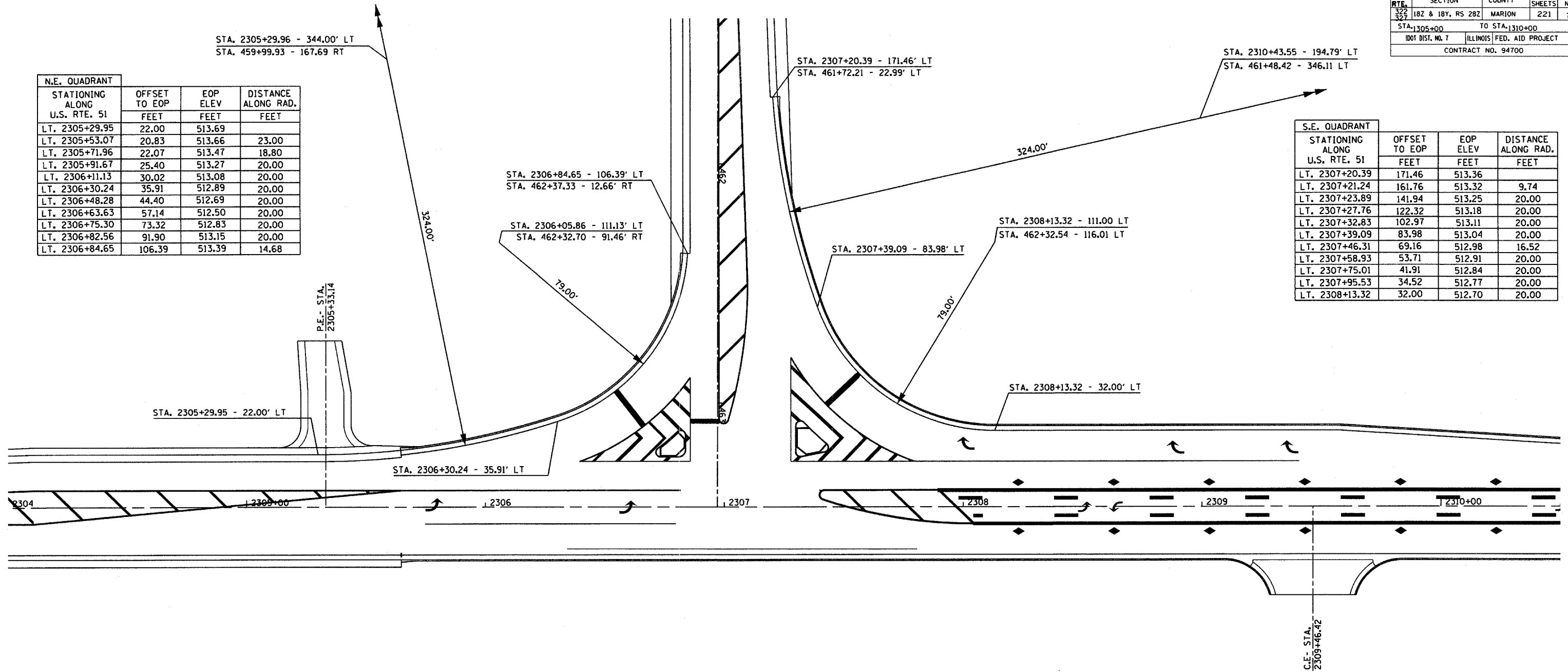

REVISIONS	
NAME	DATE

ILLINOIS DEPARTMENT OF TRANSPORTATION

**INTERSECTION WARPING / GEOMETRIC LAYOUT**

**U.S. ROUTE 51**

SCALE: VERT. N/A  
 HORIZ. 1" = 20'  
 DATE 6-27-03

DRAWN BY MMH  
 CHECKED BY AEF