

F.A.P. RTE.	SECTION	COUNTY	TOTAL SHEETS	SHEET NO.
327	1B2 & 1B4, RS 282	MARION	221	99
STA. 487+00.00		TO STA. 499+00.00		
IDOT DIST. NO. 7		ILLINOIS FED. AID PROJECT		
CONTRACT NO. 94700				

MATCHLINE STA. 490+00.00
SEE SHEET 98

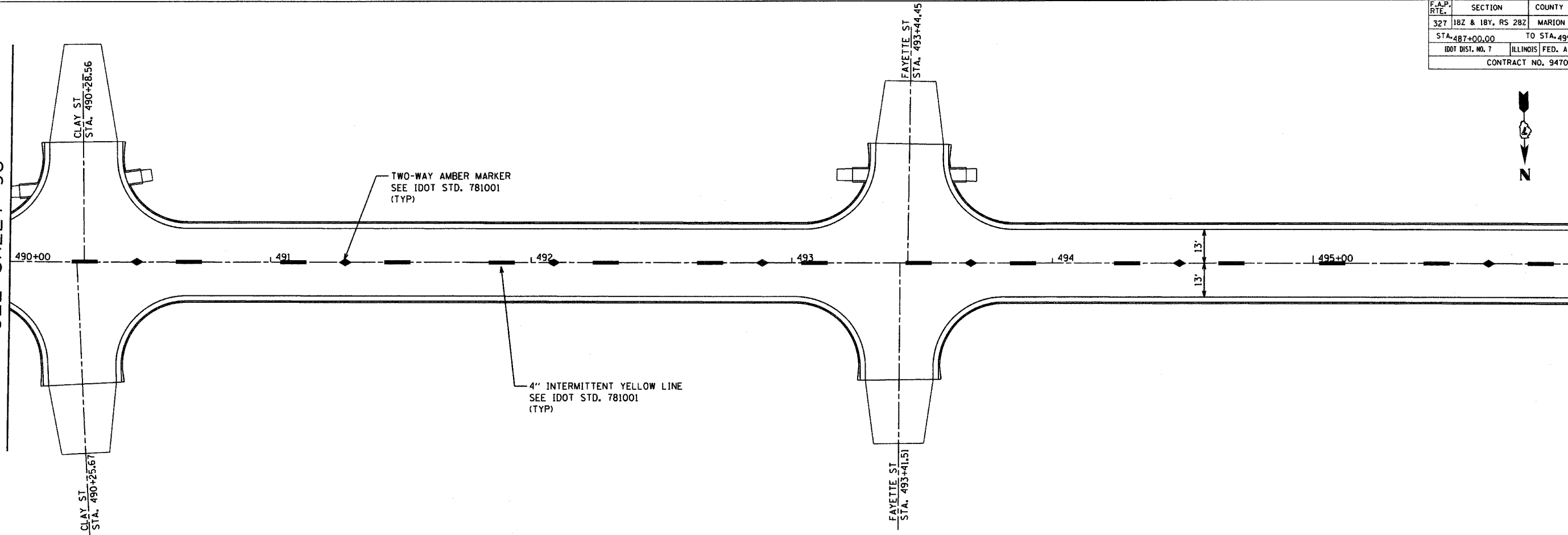

MATCHLINE STA. 496+00.00

MATCHLINE STA. 496+00.00

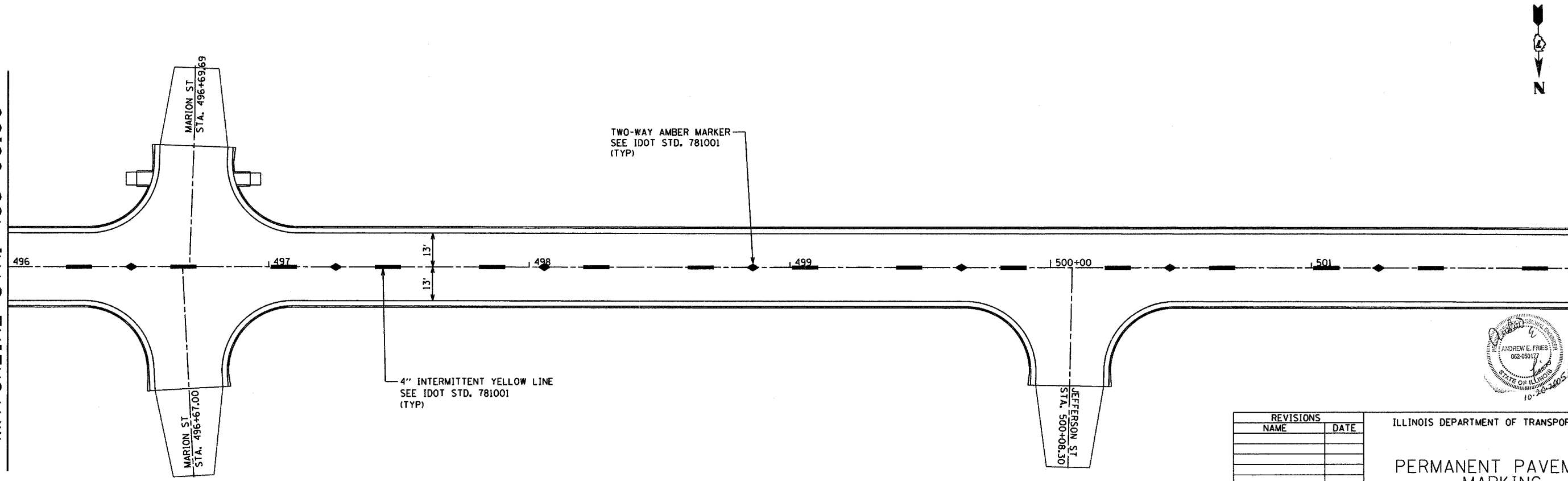

MATCHLINE STA. 502+00.00
SEE SHEET 100

SEE STD. 780001 FOR ADDITIONAL INFORMATION

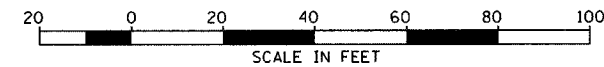

REVISIONS	
NAME	DATE

ILLINOIS DEPARTMENT OF TRANSPORTATION
PERMANENT PAVEMENT MARKING
SCALE: AS NOTED
DATE 10/20/2005
DRAWN BY ELA
CHECKED BY AEF

