

F.A.E. RTE.	SECTION	COUNTY	TOTAL SHEETS	SHEET NO.
182 & 18Y, RS 282	MARION		222	104
STA.	TO STA.			
1801 DIST. NO. 1	ILLINOIS FED. AID PROJECT			
CONTRACT NO. 94700				

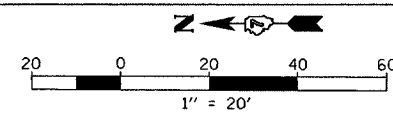

* SEAL BOTH ENDS OF CASING WATER TIGHT. CASING PIPE TO HAVE MINIMUM YIELD STRENGTH OF 35,000 PSI. WALL THICKNESS TO BE A MINIMUM OF 0.875" FOR COATED PIPE AND 0.938" FOR UNPROTECTED PIPE.

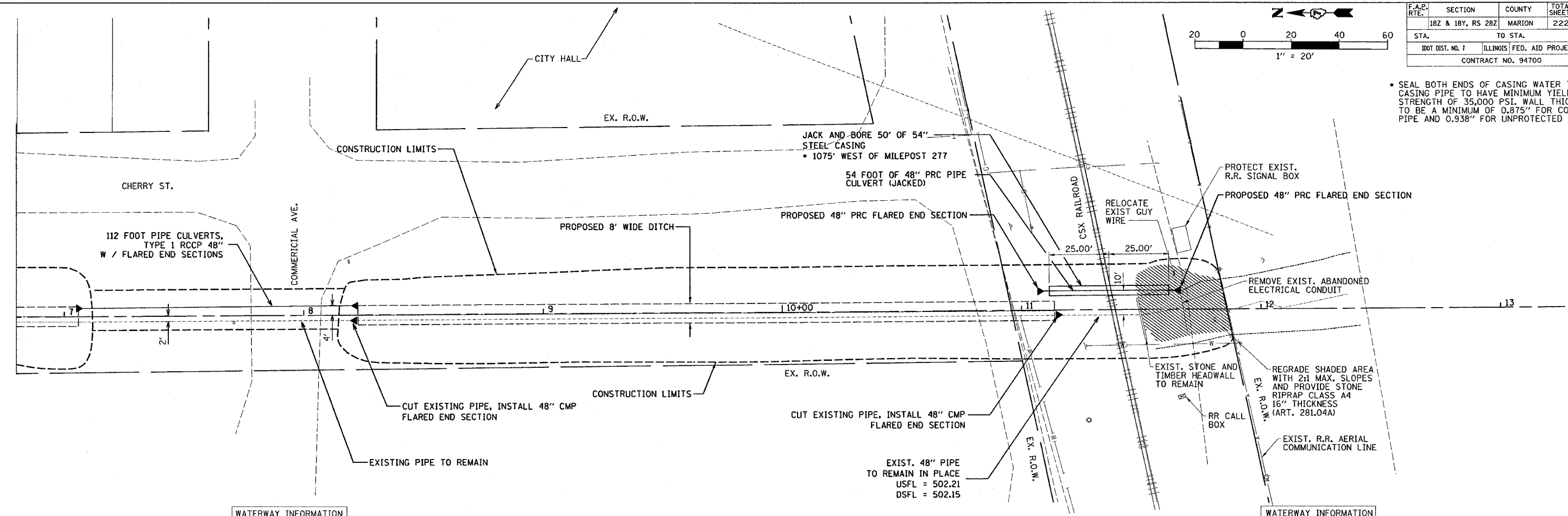

WATERWAY INFORMATION

2 48" CULVERTS UNDER COMMERCIAL AVE. STA. 478+04 OFF. 561' LT								
FLOOD YRS.	FREQ. C.F.S.	OPENING SQ. FT. EXIST.	PROP.	NAT. H.W.E.	HEAD - FT. EXIST.	PROP.	HEADWATER EL. EXIST.	PROP.
DESIGN	50	12.57	25.14					
BASE	100	12.57	25.14					
OVERTOPPING								
MAX. CALC.	500	12.57	25.14					

WATERWAY INFORMATION

2 48" CULVERTS UNDER CSX RAILROAD STA. 477+72 OFF. 904' LT								
FLOOD YRS.	FREQ. C.F.S.	OPENING SQ. FT. EXIST.	PROP.	NAT. H.W.E.	HEAD - FT. EXIST.	PROP.	HEADWATER EL. EXIST.	PROP.
DESIGN	50	54	12.57	25.14	504.39	3.50	1.08	507.89
BASE	100	60	12.57	25.14	504.40	4.27	1.29	508.67
OVERTOPPING								
MAX. CALC.	500	74	12.57	25.14	504.72	5.74	1.43	510.46

PLAN
SURVEYED BY
NOTE BOOK NO.
DATE

PROFILE
SURVEYED BY
NOTE BOOK NO.
DATE

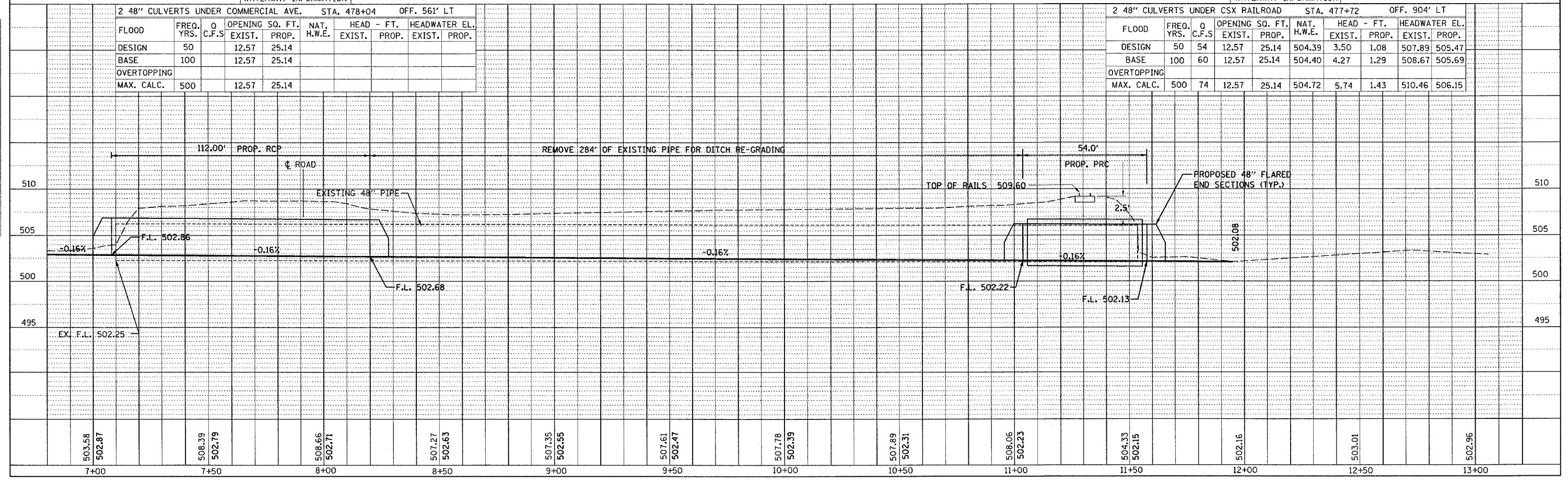

REVISION DATED 1/10/06