

F.A.P. SHEET NO.	SECTION	COUNTY	TOTAL SHEETS	SHEET NO.
327	18Z & 18Y, RS 28Z	MARION	222	106
STA.		TO STA.		
IDOT DIST. NO. 7		ILLINOIS FED. AID PROJECT		
CONTRACT NO. 94700				

WATERWAY INFORMATION									
3 24" CULVERT UNDER CSX RAILROAD				STA. 503+17		OFF. 1254' LT			
FLOOD	FREQ. YRS.	Q C.F.S.	OPENING SO. FT.	NAT. H.W.E.	HEAD - FT. EXIST.	HEAD - FT. PROP.	HEADWATER EL. EXIST.	HEADWATER EL. PROP.	
DESIGN	50	37	3.14	12.57	504.42	3.51	0.70	507.93	505.12
BASE	100	41	3.14	12.57	504.49	0.88	N/A	505.37	
OVERTOPPING									
MAX. CALC.	500	49	3.14	12.57	505.61	0.93	N/A	505.54	

* SEAL BOTH ENDS OF CASINGS WATER TIGHT. CASING PIPE TO HAVE MINIMUM YIELD STRENGTH OF 35,000 PSI. WALL THICKNESS TO BE A MINIMUM OF .375" FOR COATED PIPE AND .438" FOR UNPROTECTED PIPE.

PLAN SURVEYED BY DATE
 PLOTTED/RENDERED BY DATE
 CHECKED BY DATE
 NOTE BOOK NO. _____
 STRUCTURE METADATA CIPID

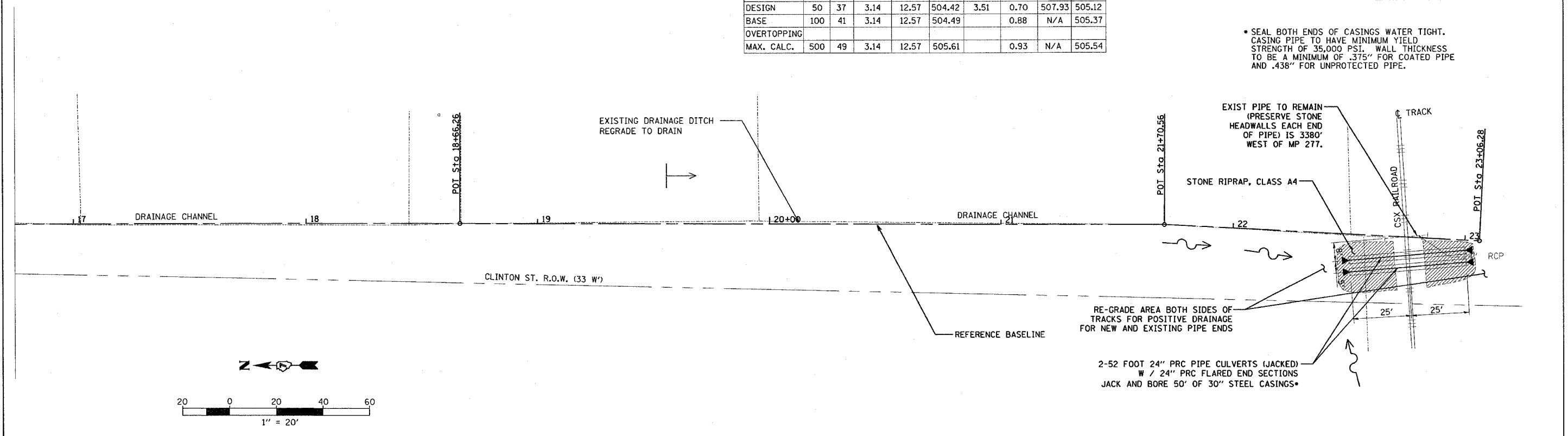

PROFILE SURVEYED BY DATE
 PLOTTED/RENDERED BY DATE
 CHECKED BY DATE
 NOTE BOOK NO. _____
 STRUCTURE METADATA CIPID

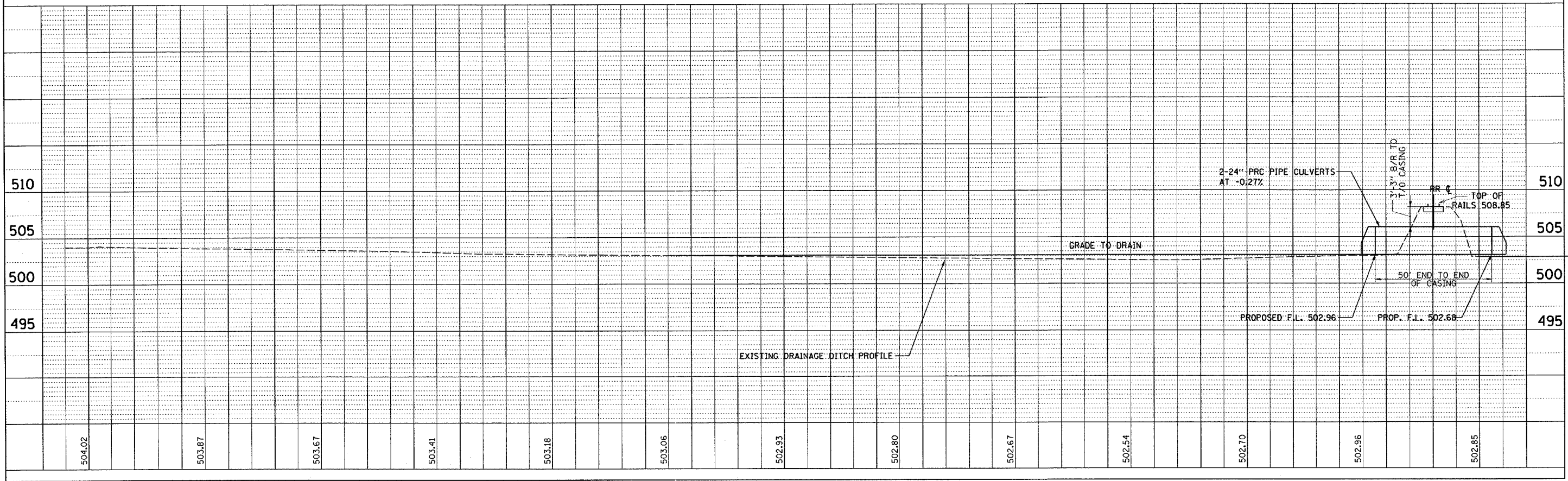

Revised 1/18/06