

# STATE OF ILLINOIS DEPARTMENT OF TRANSPORTATION DIVISION OF HIGHWAYS PLANS FOR PROPOSED FEDERAL AID HIGHWAY

ROUTE NO.	SECTION	COUNTY	TOTAL SHEETS	SHEET NO.
FAS 719	03-00108-00-RS	FAYETTE	49	1
FED. ROAD DIST. NO.	ILLINOIS	PROJECT		

CONTRACT NO. 95460



LOCATION OF PROJECT INDICATED THUS - - -

**INDEX OF SHEETS**

1	COVER SHEET
2	TYPICAL SECTIONS AND GENERAL NOTES
3	SUMMARY OF QUANTITIES AND MISCELLANEOUS DETAILS
4	MISCELLANEOUS DETAILS
5	BOX CULVERT DETAILS
6-20	PLAN AND PROFILE SHEETS
21-49	CROSS SECTION SHEETS

SCALES: PLAN & PROFILE HORIZ. CROSS SECTIONS HORIZ.   
 PLAN & PROFILE VERT. CROSS SECTIONS VERT.

## SECTION 03-00108-00-RS F.A.S. ROUTE 719 PROJECT NO. RS-719(109) FAYETTE COUNTY JOB NO. C-97-051-06

**STANDARDS**

STANDARD 000001-04	STANDARD SYMBOLS, ABBREVIATIONS AND PATTERNS
STANDARD 280001-02	TEMPORARY EROSION CONTROL SYSTEMS
STANDARD 420001-06	PAVEMENT JOINTS
STANDARD 420701-01	PAVEMENT FABRIC
STANDARD 424001-04	CURB RAMPS FOR SIDEWALKS
STANDARD 602301-01	INLET, TYPE A
STANDARD 602401-01	MANHOLE, TYPE A
STANDARD 604001-02	FRAME AND LIDS TYPE 1
STANDARD 604036-01	GRATE, TYPE 8
STANDARD 606001-02	CONCRETE CURB TYPE B AND COMBINATION CONCRETE CURB AND GUTTER
STANDARD 630001-06	STEEL PLATE BEAM GUARDRAIL
STANDARD 630301-03	SHOULDER WIDENING FOR TYPE 1 (SPECIAL) GUARDRAIL TERMINALS
STANDARD 631026-02	TRAFFIC BARRIER TERMINAL TYPE 5 & 5A
STANDARD 635006-02	REFLECTOR AND TERMINAL MARKER PLACEMENT
STANDARD 666001	RIGHT-OF-WAY MARKERS
STANDARD 701006-02	TRAFFIC CONTROL DEVICES
STANDARD 701201-02	TRAFFIC CONTROL DEVICES
STANDARD 701306-01	TRAFFIC CONTROL DEVICES
STANDARD 701501-03	TRAFFIC CONTROL DEVICES
STANDARD 702001-06	TRAFFIC CONTROL DEVICES
STANDARD 780001-01	TYPICAL PAVEMENT MARKINGS
STANDARD B.L.R. 10-5	PCC PAVEMENT SPECIAL DETAILS
STANDARD B.L.R. 14-9	PORTLAND CEMENT CONCRETE PAVEMENT
STANDARD B.L.R. 21-6	TYPICAL APPLICATION OF TRAFFIC CONTROL DEVICES FOR CONSTRUCTION ON RURAL LOCAL HIGHWAYS
STANDARD B.L.R. 24-1	MAILBOX TURNOUT FOR LOCAL ROADS

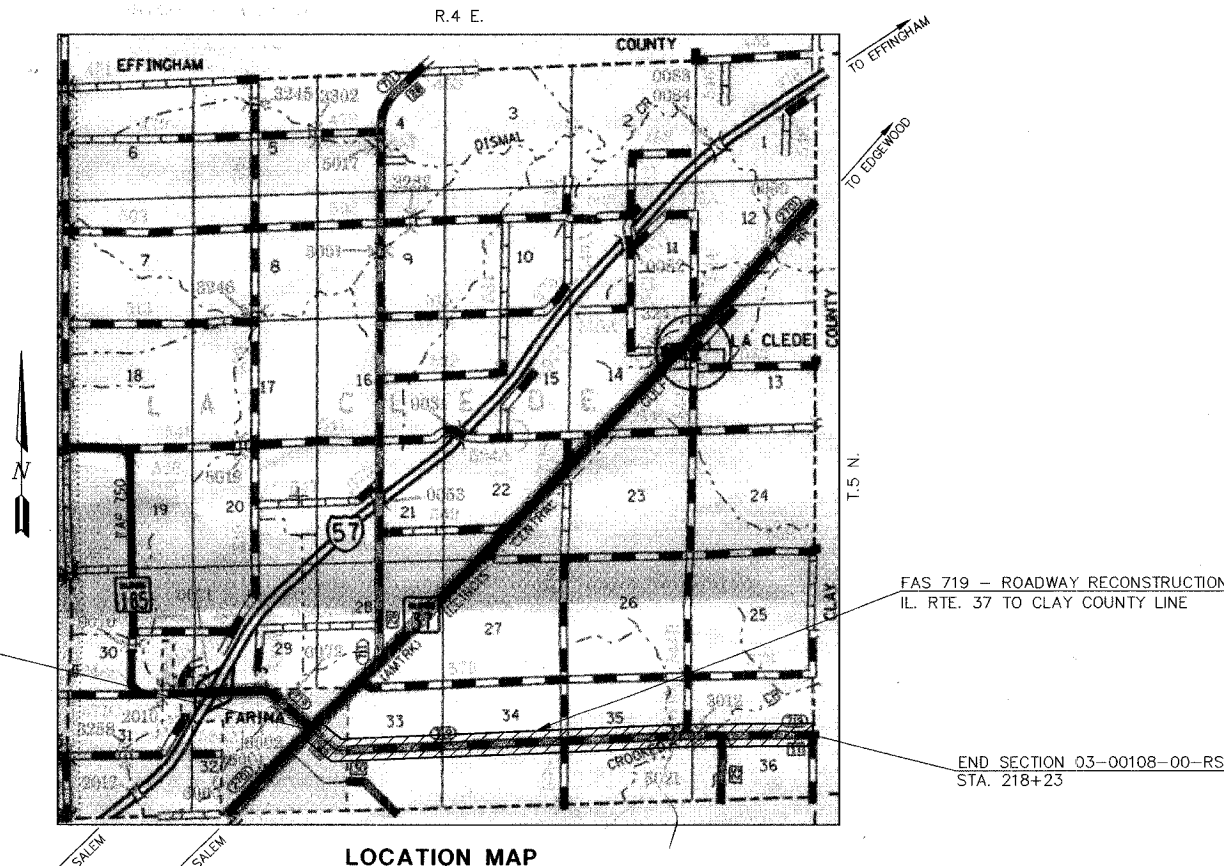

BEGIN SECTION 03-00108-00-RS  
STA. 0+12.61

FAS 719 - ROADWAY RECONSTRUCTION  
IL. RTE. 37 TO CLAY COUNTY LINE

END SECTION 03-00108-00-RS  
STA. 218+23

**LOCATION MAP**

APPROXIMATE SCALE - 1" = 0.69 MILES  
NET LENGTH OF IMPROVEMENTS = 21,810.39 FOOT = 4.131 MILES

APPROVED 1-23, 2006.  
*William A. Mah*  
COUNTY ENGINEER

PASSED 3-8, 2006.  
*Maurice J. Kaul*  
DISTRICT SEVEN ENGINEER OF  
LOCAL ROADS & STREETS

Releasing For  
Bid Based on  
Limited Review 3-8, 2006.  
*Christina M. Reed*  
DEPUTY DIRECTOR OF HIGHWAYS,  
REGION FOUR ENGINEER

STATE OF ILLINOIS  
DEPARTMENT OF TRANSPORTATION

1/17/06  
LIC EXP 11/30/07

48 HOURS PRIOR TO EXCAVATION CALL J.U.L.I.E.: 1-800-892-0123

CLASS ROAD: MAJOR COLLECTOR  
A.D.T. = 900  
50 M.P.H.

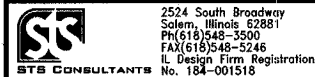

STS JOB NO. 30084

JANUARY 9, 2006

L:\FAH\00331.dwg, CCV-30084.dwg, 1/17/2006 10:56:21 AM