

ROUTE NO.	SECTION	COUNTY	TOTAL SHEETS	SHEET NO.
FAS 788 (C.H. 24/ C.H. 16)	03-00075- 00-BR WASH. 03-00082- 00-BR CLIN.	WASHINGTON CLINTON	22	9

FINAL SURVEY
 DATE: 2/17/13
 DRAWN BY: [REDACTED]
 CHECKED BY: [REDACTED]
 DATE: [REDACTED]
 ORIGINAL SURVEY DATE: [REDACTED]
 DATE: [REDACTED]

ORIGINAL SURVEY
 DATE: 2/17/13
 DRAWN BY: [REDACTED]
 CHECKED BY: [REDACTED]
 DATE: [REDACTED]
 ORIGINAL SURVEY DATE: [REDACTED]
 DATE: [REDACTED]

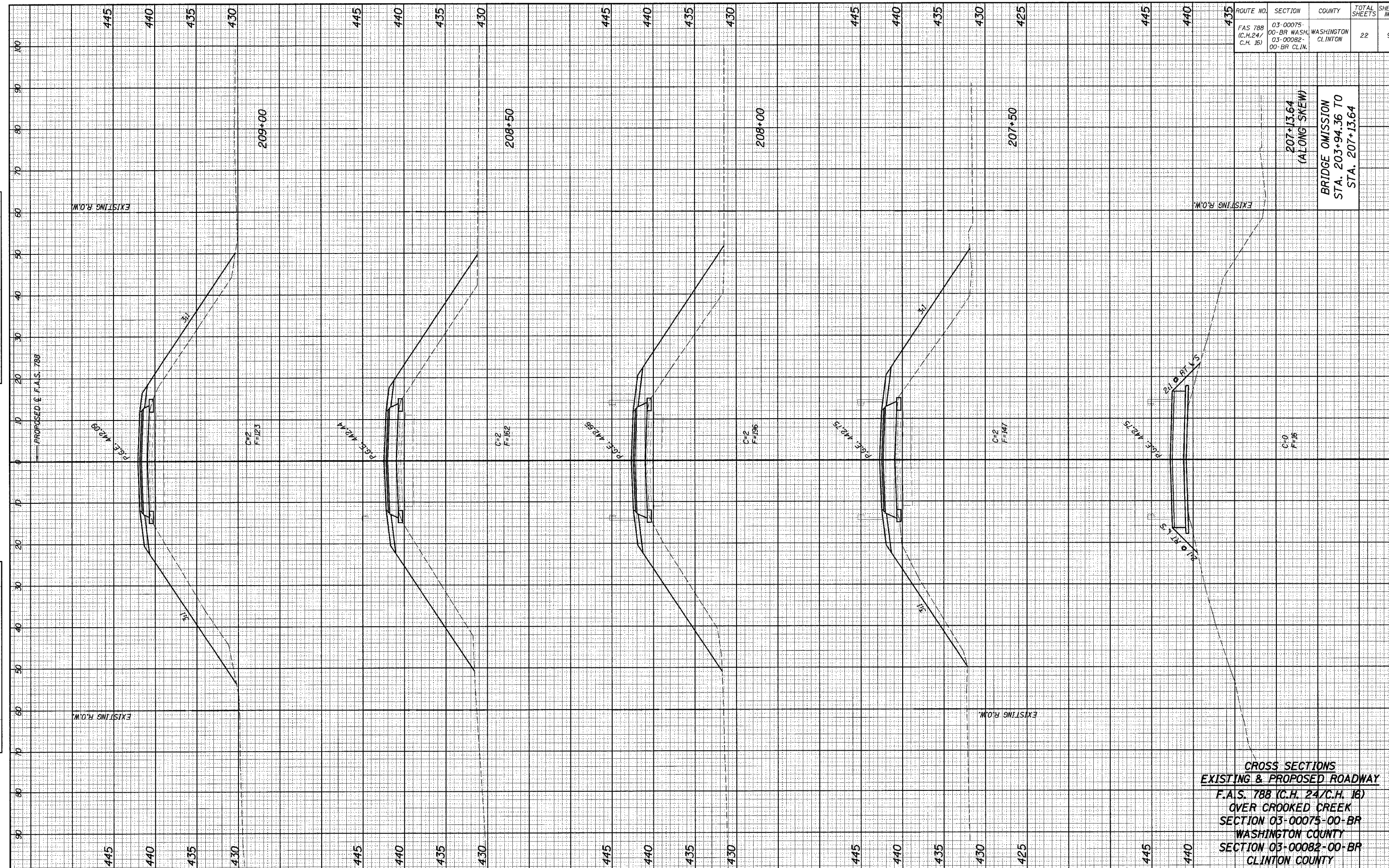

**CROSS SECTIONS
 EXISTING & PROPOSED ROADWAY**
 F.A.S. 788 (C.H. 24/C.H. 16)
 OVER CROOKED CREEK
 SECTION 03-00075-00-BR
 WASHINGTON COUNTY
 SECTION 03-00082-00-BR
 CLINTON COUNTY

BRIDGE OMISSION
 STA. 203+94.36 TO
 STA. 207+13.64
 (ALONG SKEW)