

F.A.P. RTE	SECTION	COUNTY	TOTAL SHEETS	SHEET NO.
331	*	JACKSON	258	40
STA.	TO STA.		ILLINOIS FED. AID PROJECT	
* (12-1)2N,1-5,TS-3,B-1				

INLET SPECIAL, TY 3, 6', 1 EACH
 STA. 34+66.40, 39.75' LT
 INV. ELEV. = 401.60
 LID ELEV FRONT = 407.62
 LID ELEV BACK = 409.16
 SS REM 27", 6 LIN FT

EXIST STORM SEWER 27"
 TO REMAIN

INLET MODIFICATION, 1 EACH
 STA 36+15.37 LT
 LID ELEV FRONT = 406.66
 LID ELEV BACK = 407.31
 SEE DETAIL SHEET 88

TIE CURB AND GUTTER
 TO EXISTING INLET

EXIST STORM SEWER 27"
 TO REMAIN

EXIST 48" RCCP
 TO REMAIN

EXIST 15" RCCP
 TO REMAIN

PROPOSED CAST IN PLACE
 BOX CULVERT EXTENSION
 STA 40+14.54 LT
 INVERT = 396.84

EXIST 18" RCCP
 TO REMAIN

PROPOSED CONCRETE
 CURB CUT
 STA 39+42.50 LT
 SEE DETAIL SHEET 77

STORM SEWER REMOVAL 12"
 15 LIN FT

STORM SEWER REMOVAL 12"
 15 LIN FT

35+00

40+

10+00

NOTE:
 A QUANTITY FOR REMOVING THE ABANDONED STORM SEWER LOCATED UNDER THE PROPOSED PCC BASE COURSE HAS BEEN INCLUDED IN THE STORM SEWER REMOVAL SCHEDULE. THIS QUANTITY DOES NOT REFLECT SMALL SECTIONS REMOVED AND PLUGGED DURING PREVIOUS IMPROVEMENTS. THE ACTUAL REMOVAL QUANTITY REQUIRED SHALL BE DETERMINED BY THE RESIDENT IN THE FIELD.

REMOVING INLET, 1 EACH
 STA 34+66 LT

EXIST ABANDONED STORM SEWER
 TO BE REMOVED
 SEE NOTE ON THIS SHEET

REMOVING INLET, 1 EACH
 STA 36+15 LT

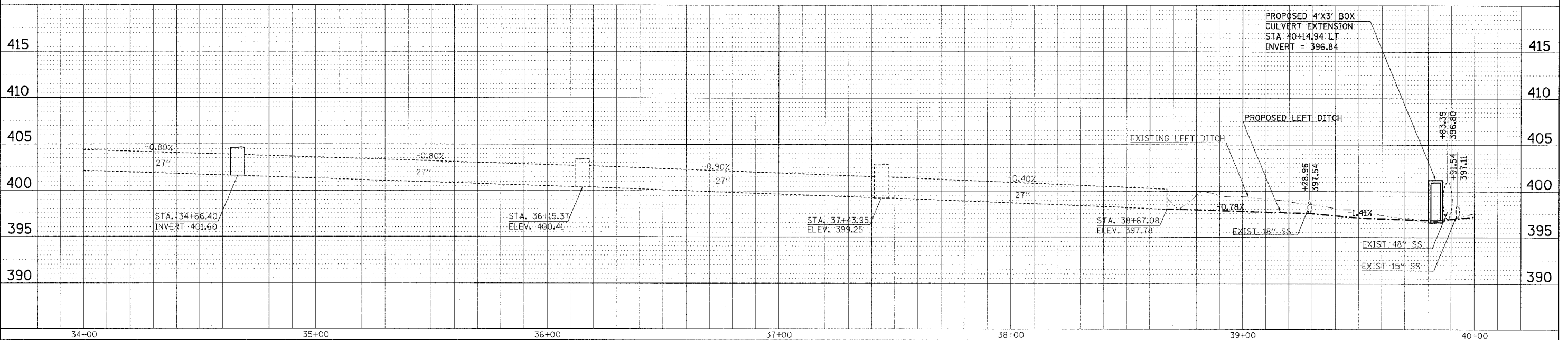
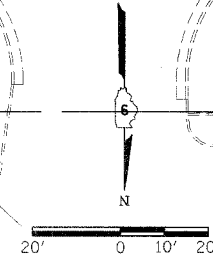

PLAN PROFILE - DRAINAGE (ILLINOIS 13)

DATE	BY	DESCRIPTION

DATE	BY	DESCRIPTION

2/15/2006
 c:\p\projects\1041827\1041827.dwg
 20.0000 / 11.0000