

F.A.P. RTE.	SECTION	COUNTY	TOTAL SHEETS	SHEET NO.
331	*	JACKSON	258	87
STA.		TO STA.		
FED. ROAD DIST. NO. -		ILLINOIS	FED. AID PROJECT	
*(12-1)2N, I-5, TS-3, B-1				

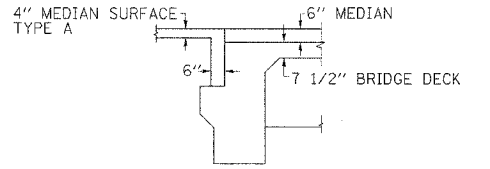
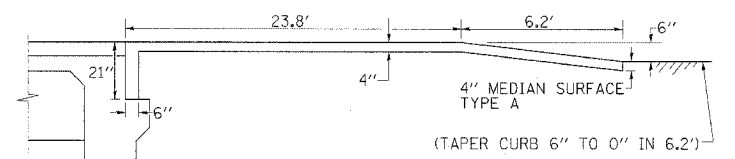
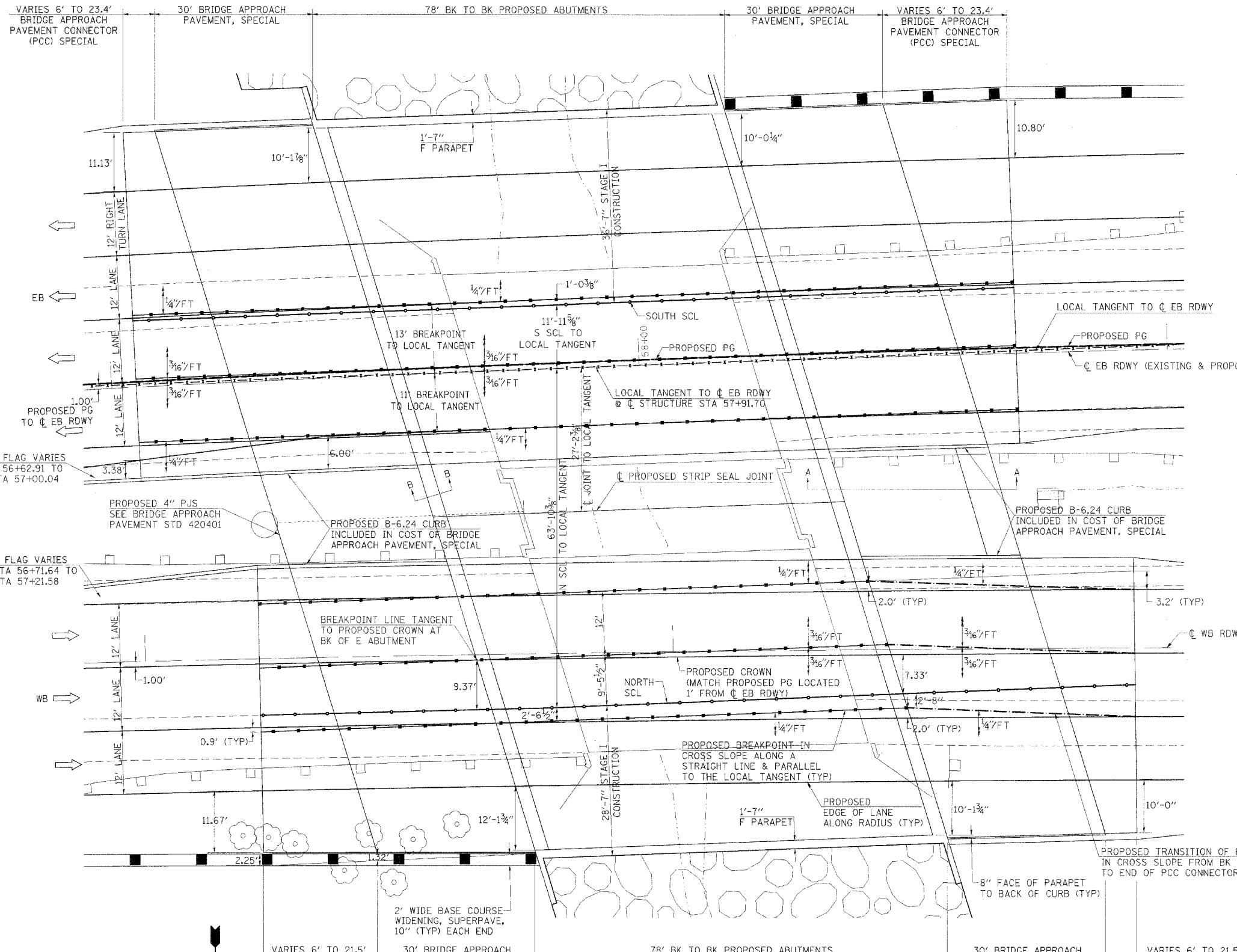

SECTION B-B

LEGEND

- - - - LOCAL TANGENT TO EB ROADWAY @ STRUCTURE STA 57+91.70
- - - - PROPOSED PG 1' FROM EB ROADWAY (EXISTING & PROPOSED)
- - - - PROPOSED BREAKPOINT IN CROSS SLOPE ALONG A STRAIGHT LINE & PARALLEL TO THE LOCAL TANGENT
- - - - STAGE CONSTRUCTION JOINT ALONG A STRAIGHT LINE & PARALLEL TO THE LOCAL TANGENT
- - - - PROPOSED TRANSITION OF BREAKPOINT IN CROSS SLOPE OVER THE BRIDGE APPROACH PAVEMENT & PCC CONNECTOR PAVEMENT WEST OF THE WESTBOUND WEST ABUTMENT

PLAN

(ALL CROSS SLOPES ARE PERPENDICULAR TO THE LOCAL TANGENT TO EB RDWY)

PROPOSED CROSS SLOPES
FAP 331 - SEC (12-1)B-1
JACKSON COUNTY
STA 57+91.70
STRUCTURE NO 039-0071

2/16/2006
c:\projects\984403\d904403pl.dgn
10:00:00 / IN.
willabr

