

F.A.P. RTE.	SECTION	COUNTY	TOTAL SHEETS	SHEET NO.
331	*	JACKSON	258	96
STA. 27+75.00		TO STA. 28+11.70		
FED. ROAD DIST. NO. 7 ILLINOIS FED. AID PROJECT				
* (12-112N, 1-5, TS-3, B-1)				

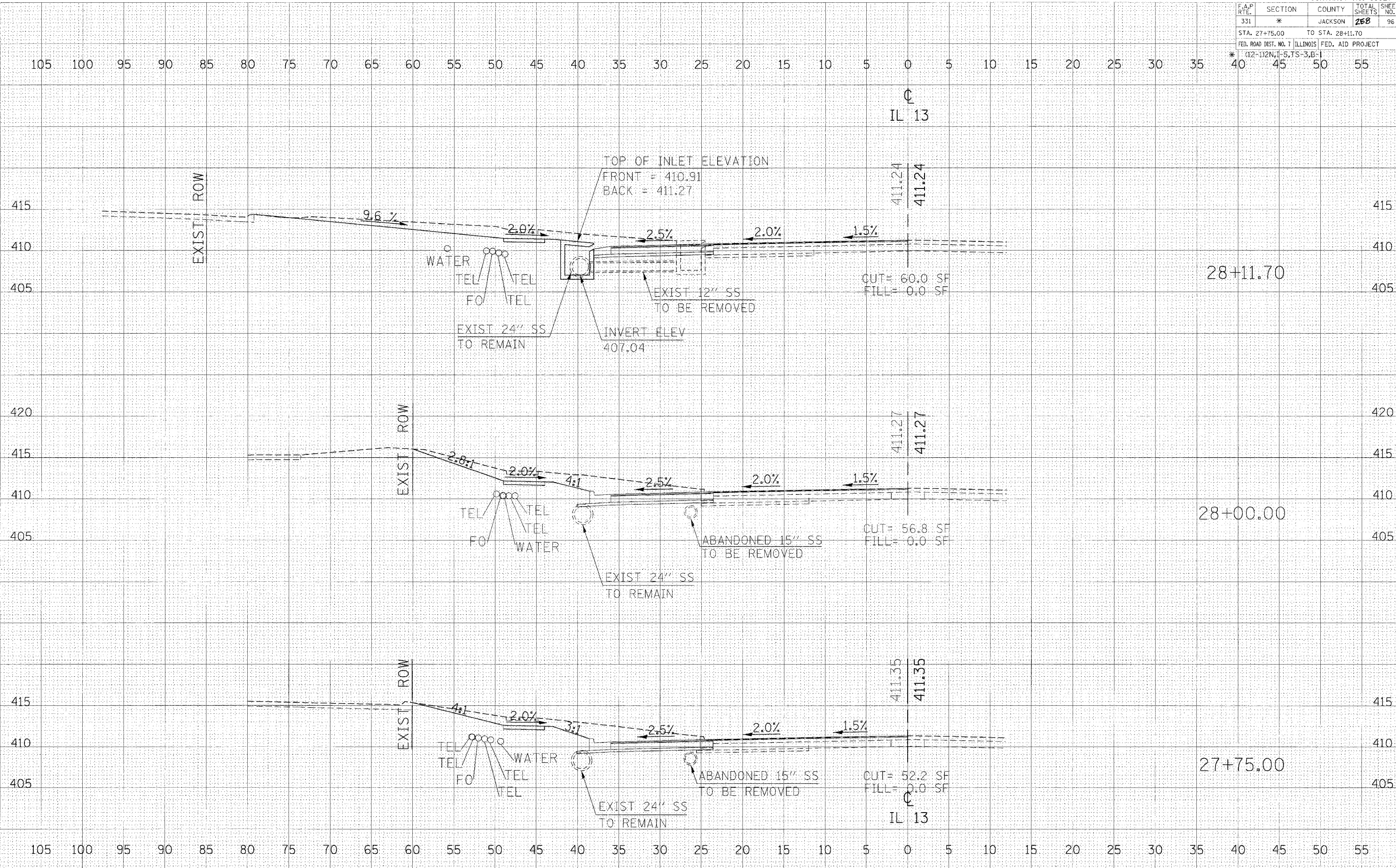

DATE: \_\_\_\_\_ BY: \_\_\_\_\_  
 SURVEYED: \_\_\_\_\_  
 ORIGINAL SURVEY: \_\_\_\_\_  
 NOTE BOOK: \_\_\_\_\_  
 NO. \_\_\_\_\_

DATE: \_\_\_\_\_ BY: \_\_\_\_\_  
 SURVEYED: \_\_\_\_\_  
 ORIGINAL SURVEY: \_\_\_\_\_  
 NOTE BOOK: \_\_\_\_\_  
 NO. \_\_\_\_\_

2/15/2006  
 c:\p\jaco\p\984483\sh13.dgn  
 5:00:00 / 1h