

CONTRACT NO. 98827				
F.A.P. RTE.	SECTION	COUNTY	TOTAL SHEETS	SHEET NO.
331	*	JACKSON	258	101
STA. 30+85.49		TO STA. 31+47.95		
FED. ROAD DIST. NO. 7 ILLINOIS FED. AID PROJECT				
* (12-1)2N, 1-5, TS-3, B-1				

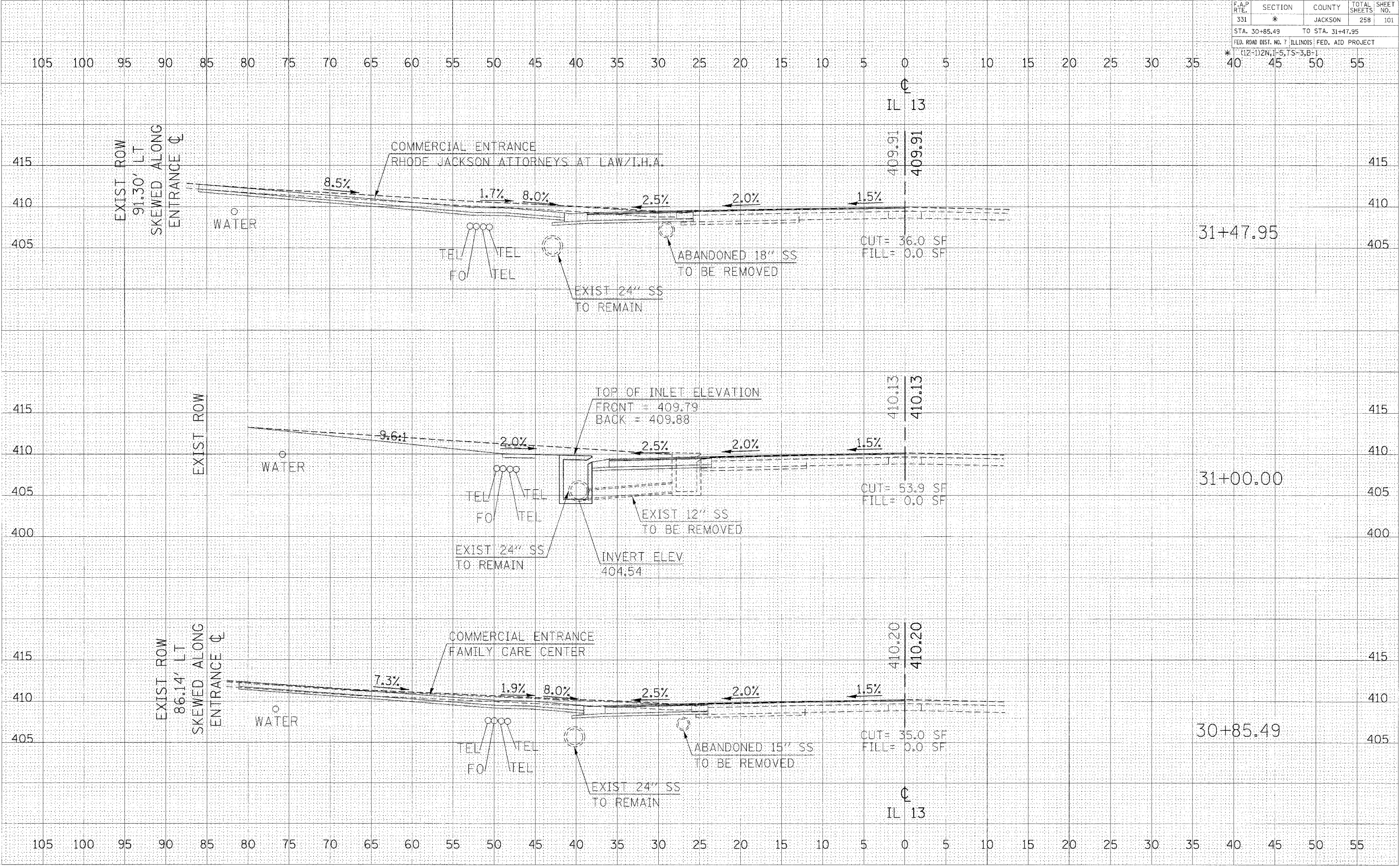

DATE	BY
FINAL SURVEY	PLOTTED
NOTE BOOK	AREAS CHECKED

DATE	BY
ORIGINAL SURVEY	PLOTTED
NOTE BOOK	AREAS CHECKED

2/15/2006
 c:\pws\pcr\p\p04\c3\veh113.dgn
 5.68288 / IN

CROSS SECTIONS - IL 13