

F.A.P. RTE.	SECTION	COUNTY	TOTAL SHEETS	SHEET NO.
331	*	JACKSON	258	106
STA. 34+50.00			TO STA. 34+66.40	
FED. ROAD DIST. NO. 7 ILLINOIS FED. AID PROJECT				
* (12-1)2N,T-5,TS-3,B-1				

DATE _____ BY _____

FINAL SURVEY
 SURVEYED
 TEMPLATE
 NOTE BOOK
 AREAS
 AREAS CHECKED
 NO. _____

DATE _____ BY _____

ORIGINAL SURVEY
 SURVEYED
 TEMPLATE
 NOTE BOOK
 AREAS
 AREAS CHECKED
 NO. _____

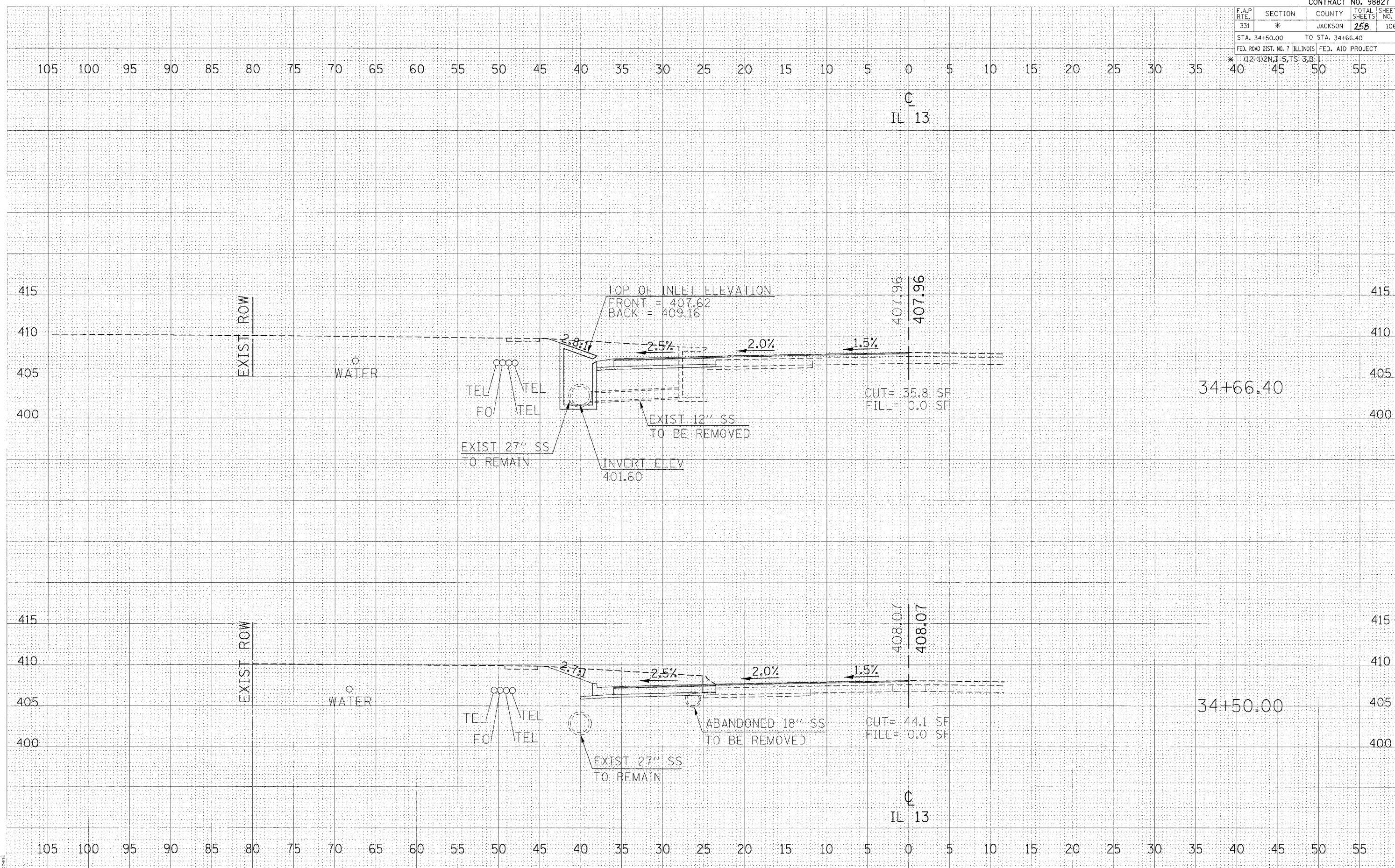

2/15/2008
 ct:\proj\p08\344483\sheet3.dgn
 3:26:02 / IN

CROSS SECTIONS - IL 13