

F.A.P. RTE.	SECTION	COUNTY	TOTAL SHEETS	SHEET NO.
331	*	JACKSON	258	111
STA. 37+00.00		TO STA. 37+50.00		
FED. ROAD DIST. NO. 7 ILLINOIS FED. AID PROJECT				
* (12-1)2N, 1-5, TS-3, B-1				

DATE	BY

FINAL SURVEY	DATE

DATE	BY

ORIGINAL SURVEY	DATE

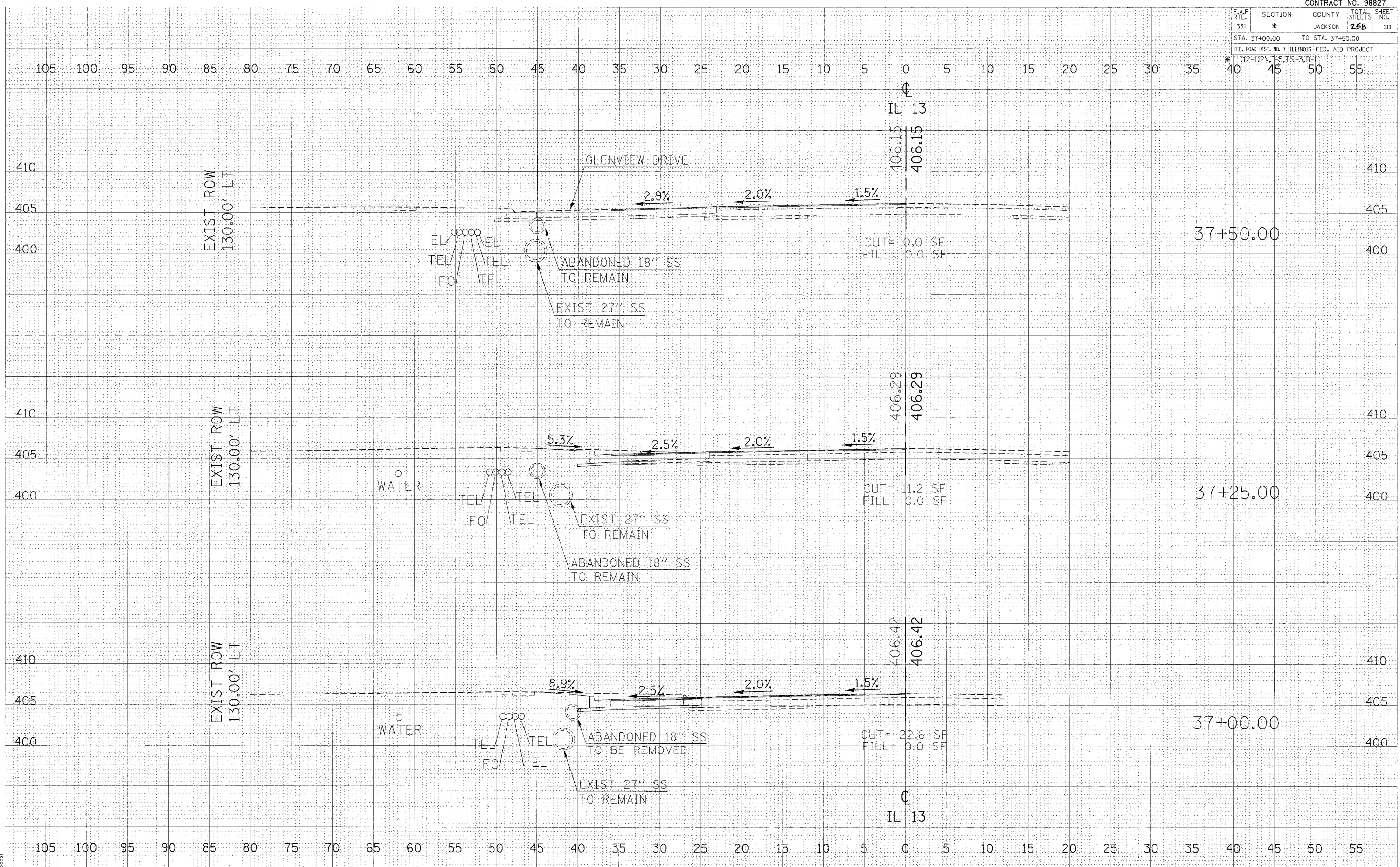

2/15/2006
 c:\p\j\p\va\98827\403\ss\st1.dgn
 gms