

F.A.P. RTE.	SECTION	COUNTY	TOTAL SHEETS	SHEET NO.
331	*	JACKSON	258	137
STA. 55+53.09 TO STA. 55+78.19				
FED. ROAD DIST. NO. 7 ILLINOIS FED. AID PROJECT				
* (12-1)2N, 1-5, TS-3, B-1				

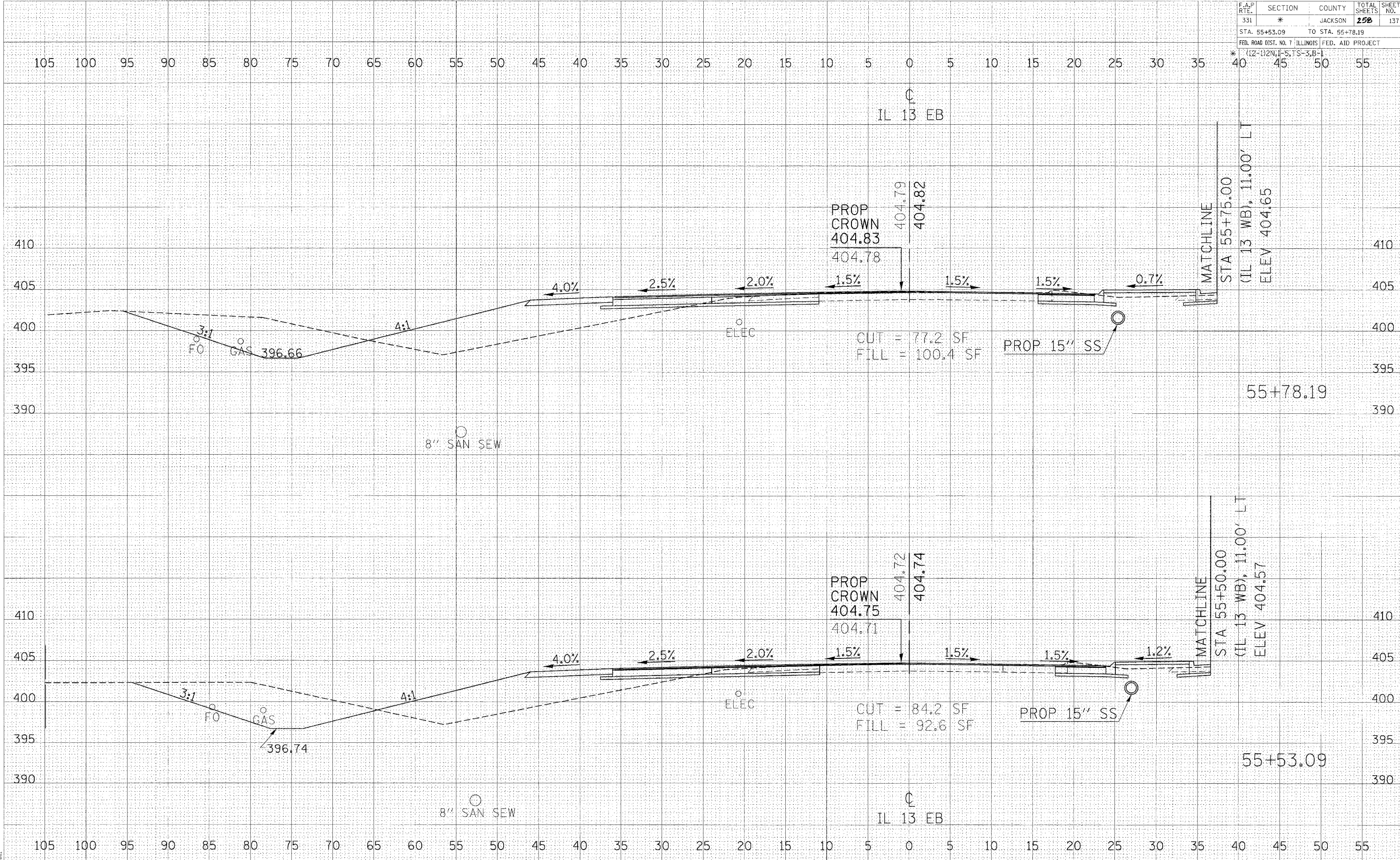

CROSS SECTIONS - IL 13 EB

DATE: _____

FINAL SURVEY	SURVEYED
NOTE BOOK NO.	PLOTTED
AREAS CHECKED	TEMPLATE

DATE: _____

ORIGINAL SURVEY	SURVEYED
NOTE BOOK NO.	PLOTTED
AREAS CHECKED	TEMPLATE

2/15/2006 10:00 AM V:\9884\27\user\pedu\jpn