

CONTRACT NO. 98827				
F.A.P. RTE.	SECTION	COUNTY	TOTAL SHEETS	SHEET NO.
331	*	JACKSON	258	143
STA. 58+36.58 TO STA. 58+46.05				
FED. ROAD DIST. NO. 7 ILLINOIS FED. AID PROJECT				
* (12-1)2N, 1-5, TS-3, B-1				

DATE	BT
FINAL SURVEY	
NOTE BOOK	
NO.	

DATE	BT
ORIGINAL SURVEY	
NOTE BOOK	
NO.	

2/15/2006  
 at:\pno\_jps\sta58\114483\work\paper\sub.dgn  
 5,000/80 / IN.  
 p:\pno\_jps\sta58\114483\work\paper\sub.dgn

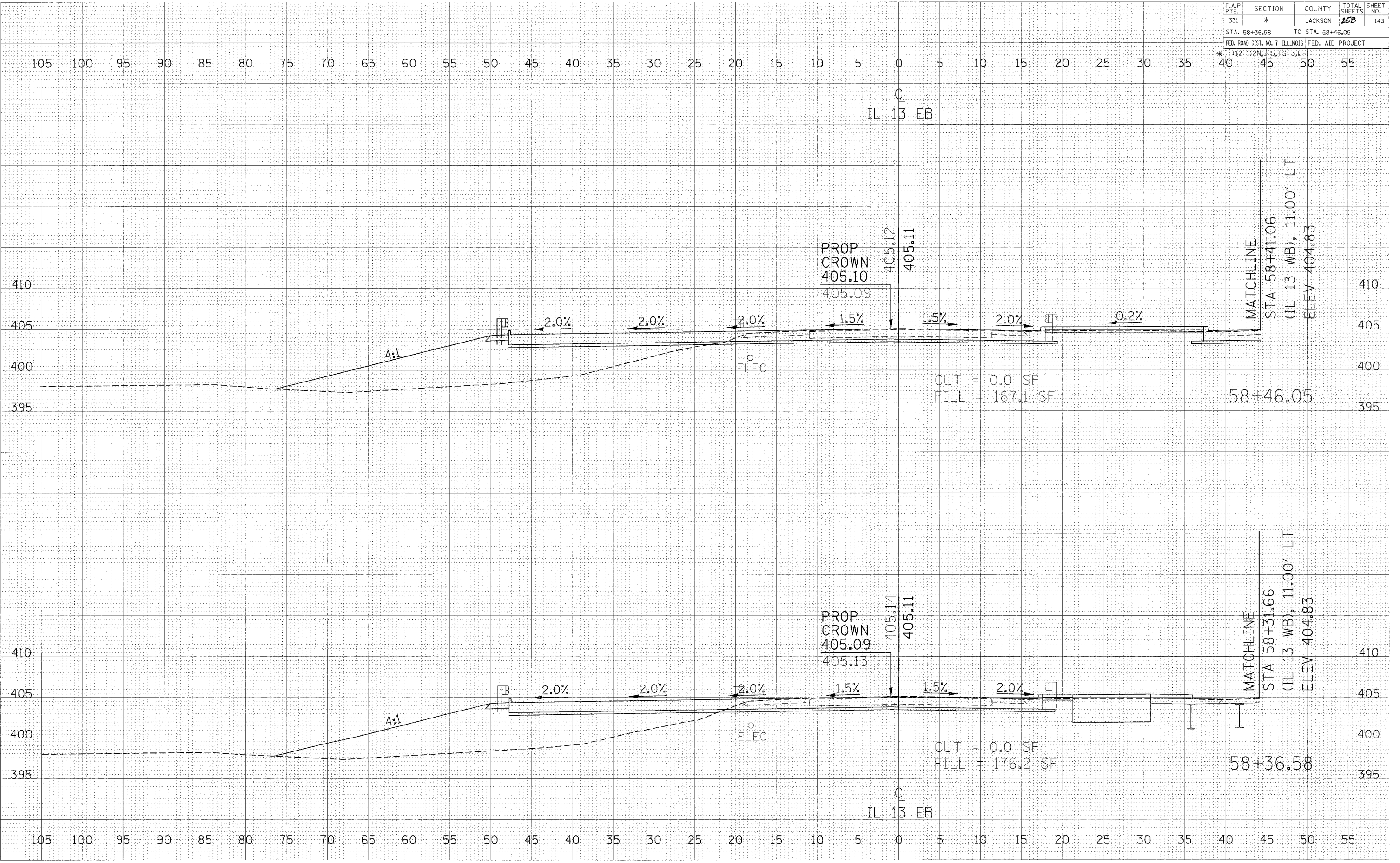

**CROSS SECTIONS - IL 13 EB**