

F.A.P. RTE.	SECTION	COUNTY	TOTAL SHEETS	SHEET NO.
331	*	JACKSON	158	146
STA. 60+56.62		TO STA. 61+07.03		
FED. ROAD DIST. NO. 7 ILLINOIS FED. AID PROJECT				
* (12-1)2N, 1-5, TS-3, B-1				

DATE	BY	REVISION

DATE	BY	REVISION

2/15/2002
 c:\pwworkspace\98827\1\10101.dgn
 5:00PM / IN

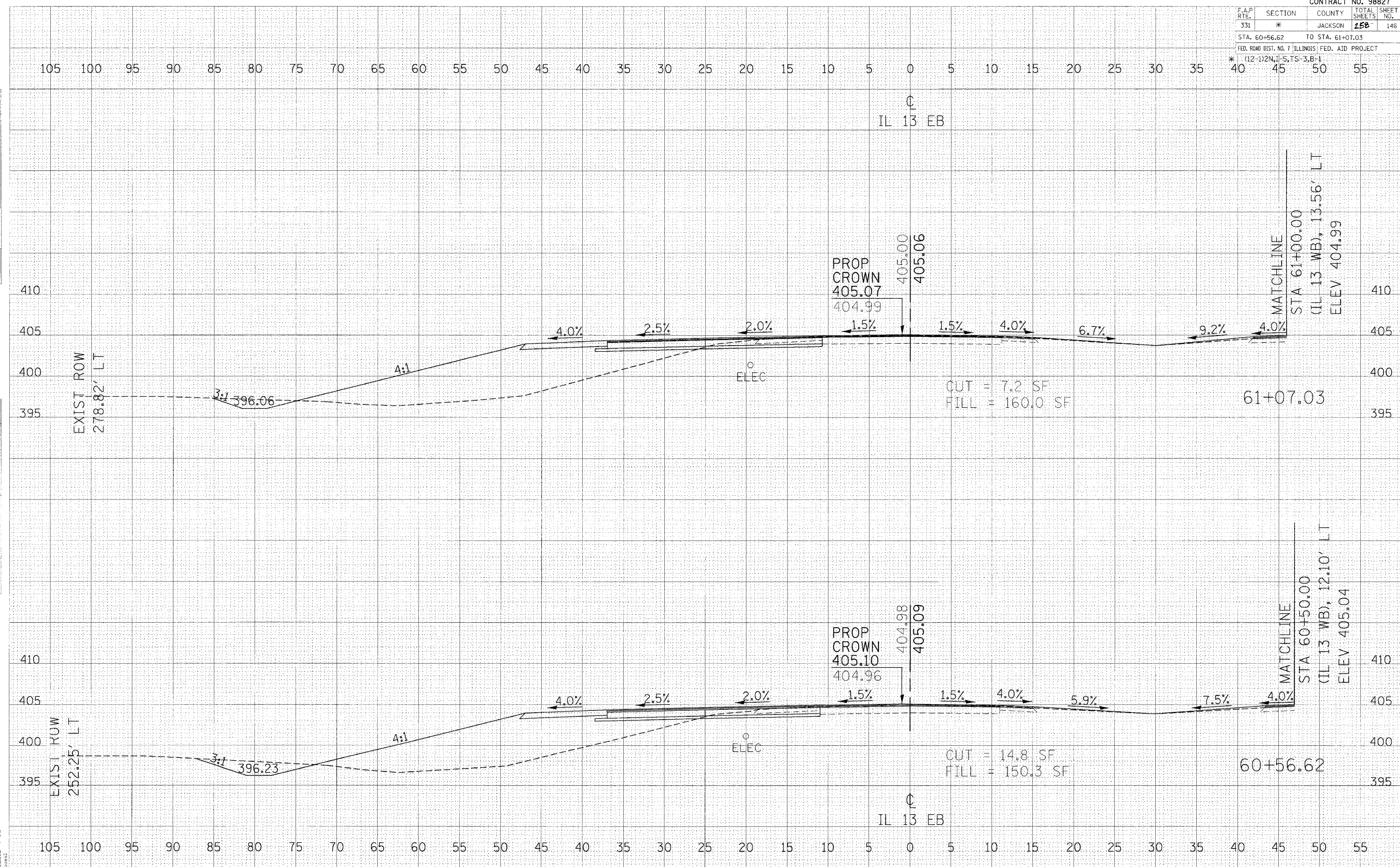

CROSS SECTIONS - IL 13 EB