

F.A.P. RTE.	SECTION	COUNTY	TOTAL SHEETS	SHEET NO.
331	*	JACKSON	258	151

STA. 65+51.95 TO STA. 66+02.40
 FED. ROAD DIST. NO. 7 ILLINOIS FED. AID PROJECT
 * (12-1)2N, 1-5, TS-3, B-1

DATE	BY
DATE	BY
DATE	BY

DATE	BY
DATE	BY
DATE	BY

2/15/2006
 c:\projects\98827\sheet\papeb.dgn
 papeb / jn

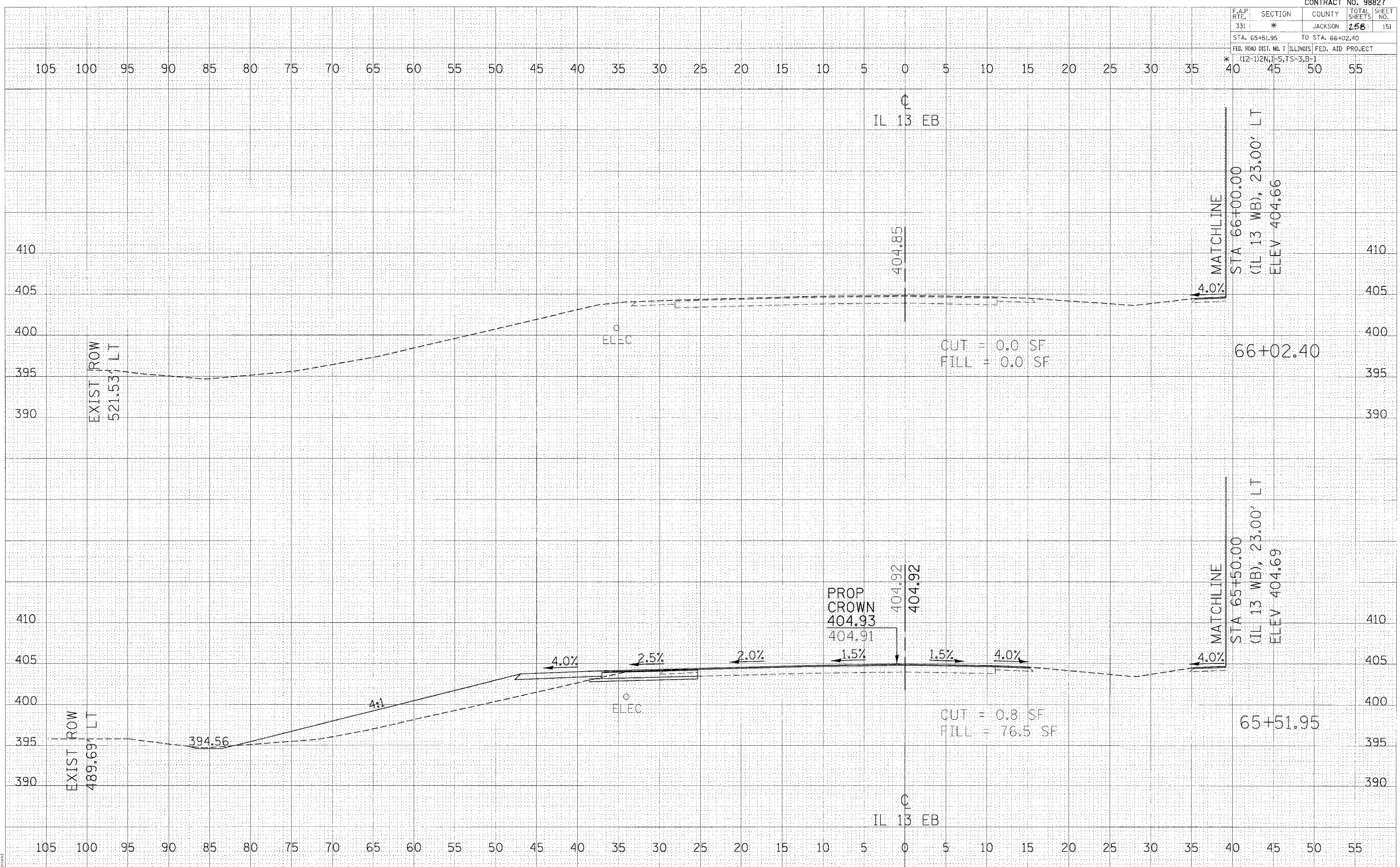

CROSS SECTIONS - IL 13 EB