

| F.A.P. RTE. | SECTION | COUNTY | TOTAL SHEETS | SHEET NO. |
|-------------|---------|---------|--------------|-----------|
| 331 | * | JACKSON | 258 | 156 |

STA. +50.00 TO STA. +75.00
 FED. ROAD DIST. NO. 7 ILLINOIS FED. AID PROJECT
 *12-112N, I-5, TS-3, B-1, B-1A

| | | |
|---------------|---------------|------|
| FINAL SURVEY | SURVEY | DATE |
| NOTE BOOK | PLOTTED | BY |
| AREAS CHECKED | TEMPLATE | |
| | AREAS CHECKED | |

| | | |
|-----------------|---------------|------|
| ORIGINAL SURVEY | SURVEY | DATE |
| NOTE BOOK | PLOTTED | BY |
| AREAS CHECKED | TEMPLATE | |
| | AREAS CHECKED | |

2/15/2006
 c:\prowork\984403\wb\propsect.dwg
 p:\prowork\984403\wb\propsect.dwg

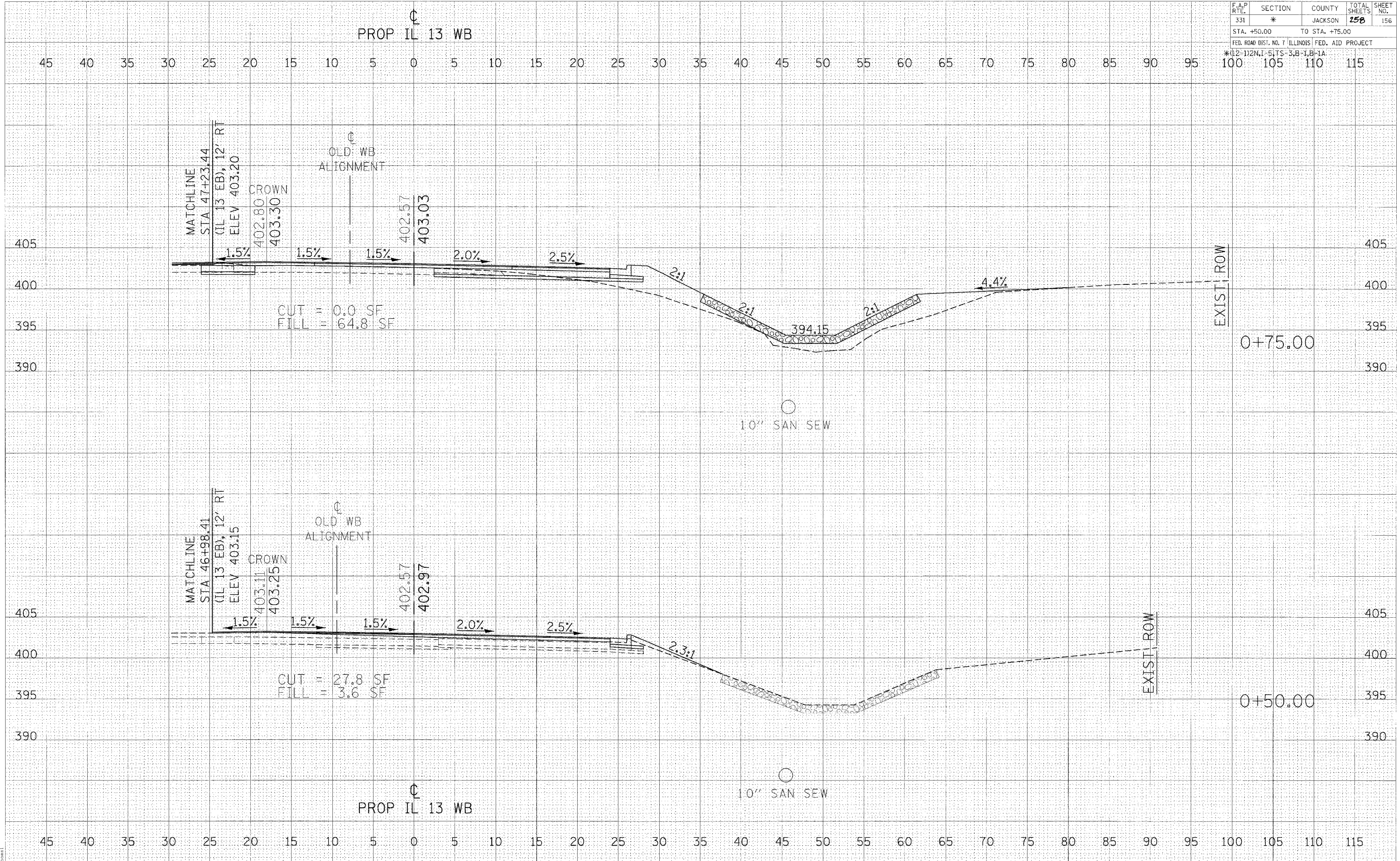

CROSS SECTIONS - PROPOSED IL 13 WB LANE