

F.A.P. RTE.	SECTION	COUNTY	TOTAL SHEETS	SHEET NO.
331	*	JACKSON	258	160

STA. 2+50.00 TO STA. 2+75.00
 FED. ROAD DIST. NO. 7 ILLINOIS FED. AID PROJECT
 *12-112N, I-5, TS-3, B-1, B-1A

DATE: _____ BY: _____

FINAL SURVEY: _____
 SURVEYED: _____
 CHECKED: _____
 NOTE BOOK NO.: _____
 AREAS CHECKED: _____

DATE: _____ BY: _____

ORIGINAL SURVEY: _____
 SURVEYED: _____
 CHECKED: _____
 NOTE BOOK NO.: _____
 AREAS CHECKED: _____

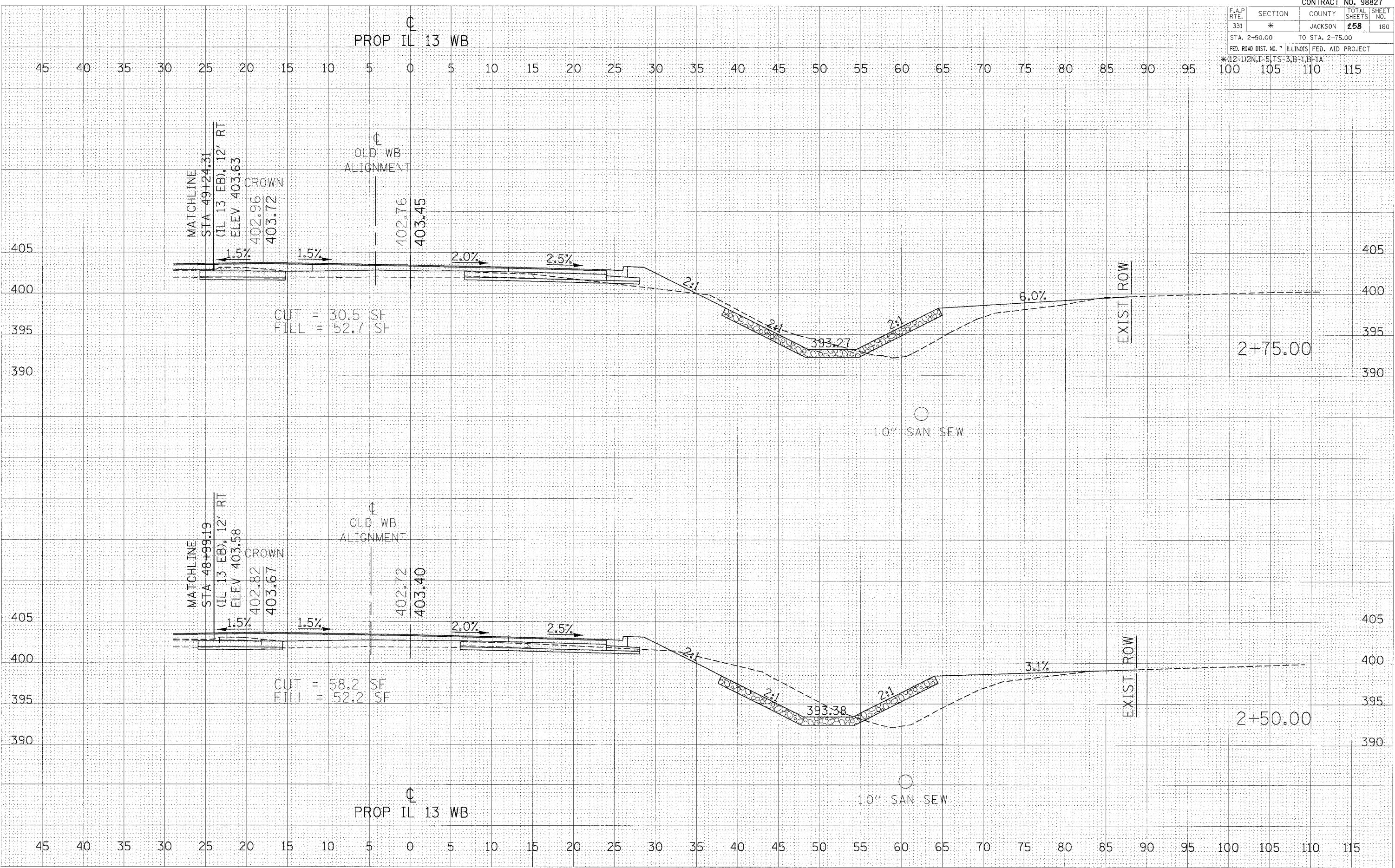

2/15/2006
 c:\p\projects\9824\93\sheet\propel.dgn
 5:00PM / IL

CROSS SECTIONS - PROPOSED IL 13 WB LANE