

F.A.P. RTE.	SECTION	COUNTY	TOTAL SHEETS NO.
331	*	JACKSON	158 165
STA. 5+00.00		TO STA. 5+25.00	
FED. ROAD DIST. NO. 7 ILLINOIS FED. AID PROJECT			
*(12-1)2N,1-5,TS-3,B-1,B-1A			

DATE	
BY	
DATE	
BY	
DATE	
BY	

DATE	
BY	
DATE	
BY	
DATE	
BY	

2/12/2008
 s:\proj\98827\98827\98827.dgn
 98827.dwg / 115

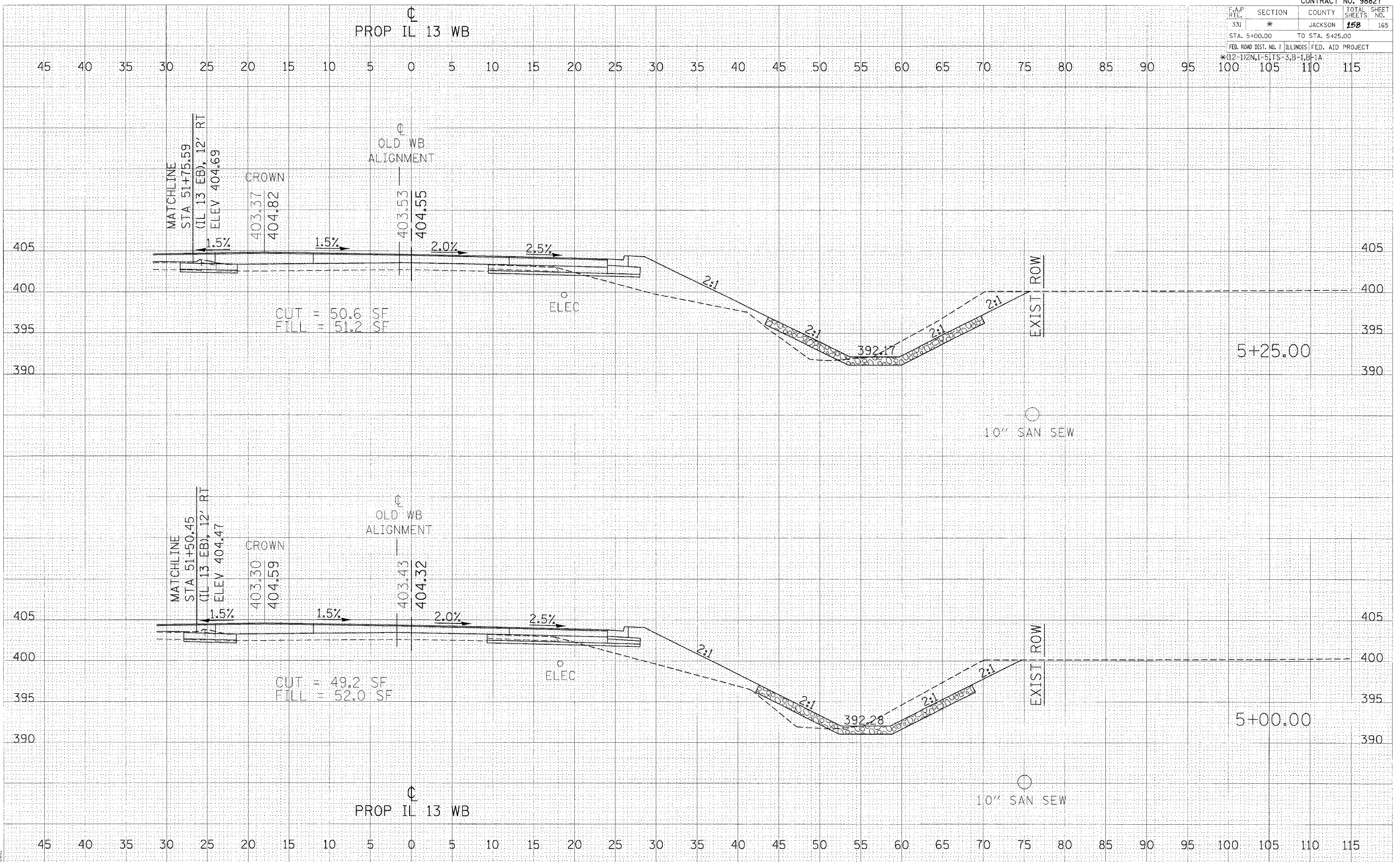

CROSS SECTIONS - PROPOSED IL 13 WB LANE