

F.A.P. RTE.	SECTION	COUNTY	TOTAL SHEETS	SHEET NO.
331	*	JACKSON	258	174

STA. 55+50.00 TO STA. 55+75.00

FED. ROAD DIST. NO. 7 ILLINOIS FED. AID PROJECT

\*(12-1)2N,1-5,TS-3,B-1

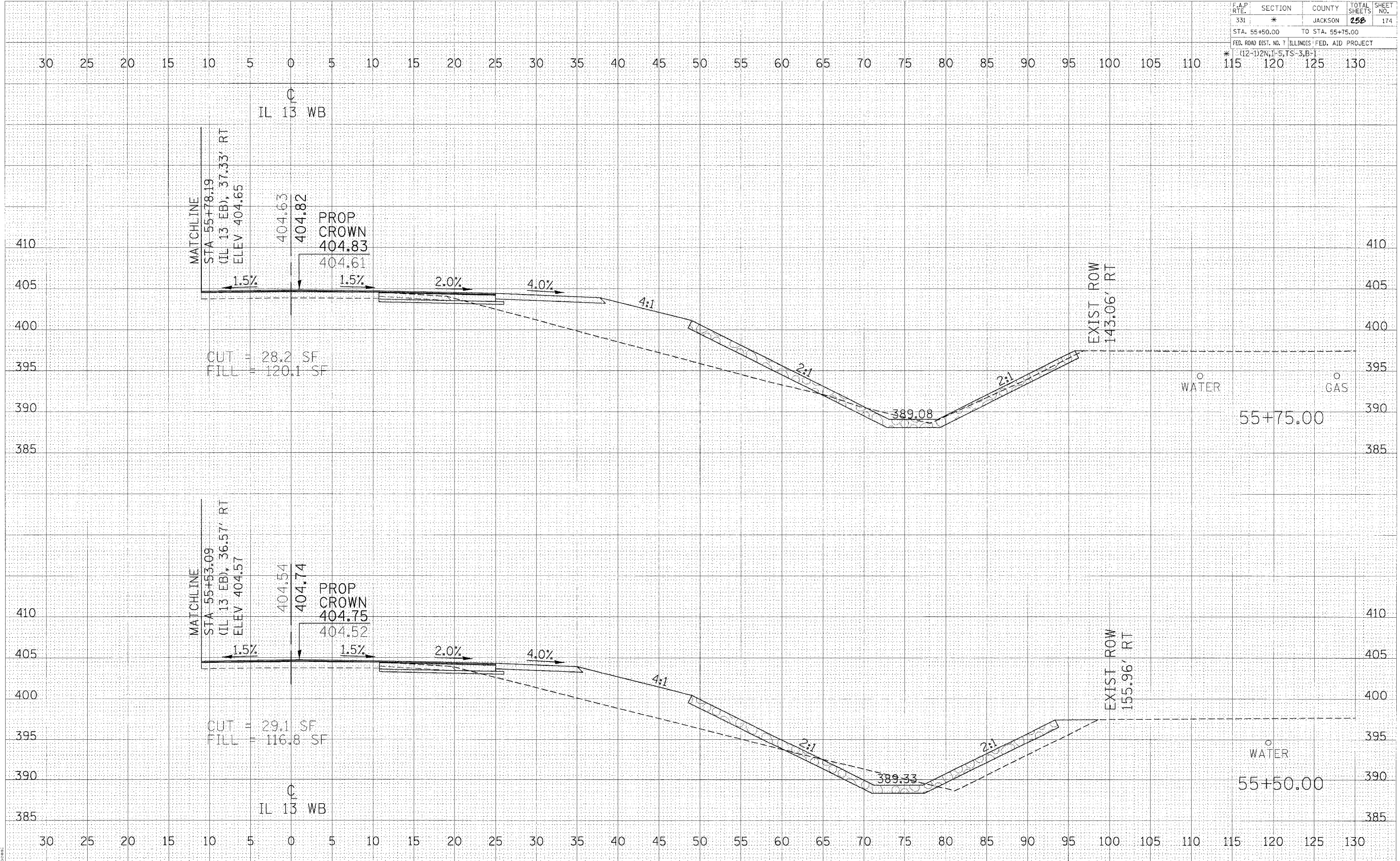

DATE	BY
DATE	BY
DATE	BY
DATE	BY
DATE	BY

DATE	BY
DATE	BY
DATE	BY
DATE	BY
DATE	BY

2/15/2006  
 c:\prow\proj\98827\114483\ashtp\pbe0dgn  
 10/11/06 7:10

**CROSS SECTIONS - IL 13 WB**