

F.A.P. RTE.	SECTION	COUNTY	TOTAL SHEETS	SHEET NO.
331	*	JACKSON	258	178

STA. 57+50.00 TO STA. 57+62.51
 FED. ROAD DIST. NO. 7 ILLINOIS FED. AID PROJECT

* (12-1)2N, 1-5, TS-3, B-1

DATE	BY
DATE	BY
DATE	BY
DATE	BY

DATE	BY
DATE	BY
DATE	BY
DATE	BY

2/15/2006
 C:\pwworkspace\98827\103\sheet\p98827.dgn
 7 / 11

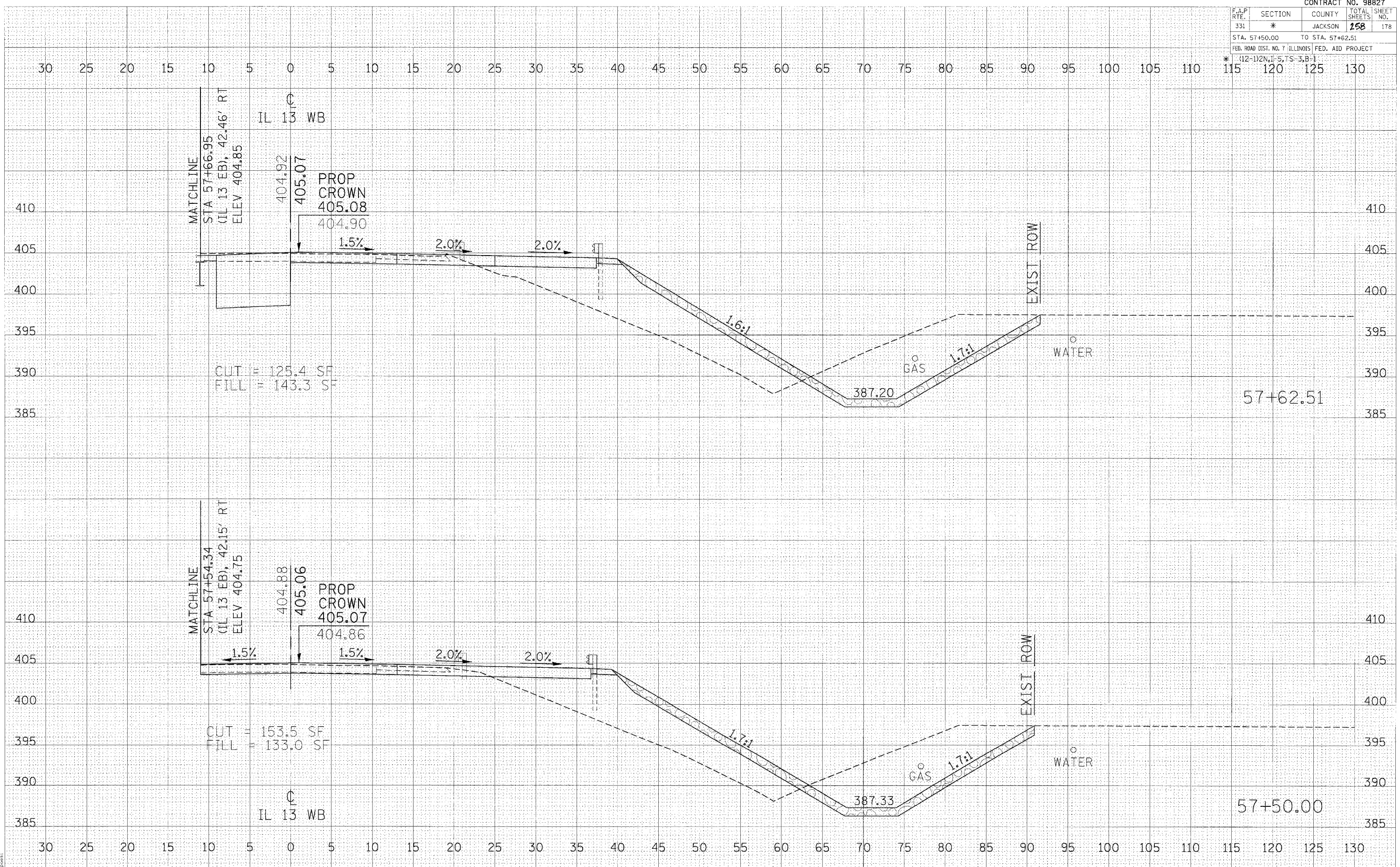

CROSS SECTIONS - IL 13 WB