

F.A.P. RTE.	SECTION	COUNTY	TOTAL SHEETS	SHEET NO.
331	*	JACKSON	258	184
STA. 61+00.00		TO STA. 61+50.00		
FED. ROAD DIST. NO. 7 ILLINOIS FED. AID PROJECT				

\* (12-1)2N,1-5,TS-3,B-1

DATE	BY
DATE	BY
DATE	BY
DATE	BY

DATE	BY
DATE	BY
DATE	BY
DATE	BY

2/15/2005  
 c:\projects\98827\12-1\1-5\ts-3\paweb.dgn  
 page 1

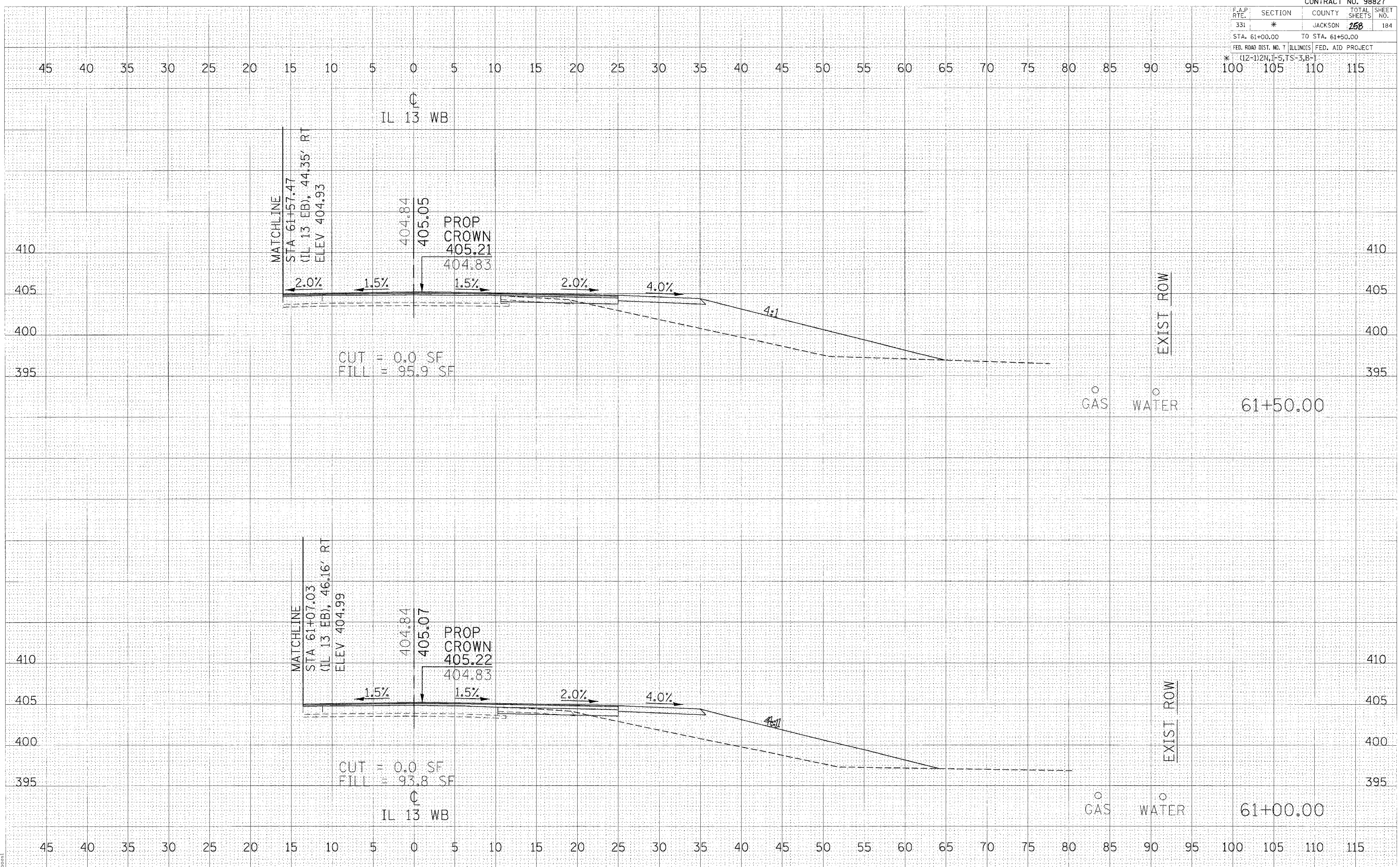

CROSS SECTIONS - IL 13 WB