

F.A.P. RTE.	SECTION	COUNTY	TOTAL SHEETS	SHEET NO.
331	*	JACKSON	158	190
STA. 67+00.00		TO STA. 67+25.00		
FED. ROAD DIST. NO. 7 ILLINOIS FED. AID PROJECT				

\* (12-1)2N, I-5, TS-3, B-1

DATE	BY
DATE	BY
DATE	BY
DATE	BY

DATE	BY
DATE	BY
DATE	BY
DATE	BY

2/15/2005  
 C:\1\2005\1004403\1004403.dwg  
 5:40:08 / In.  
 p001

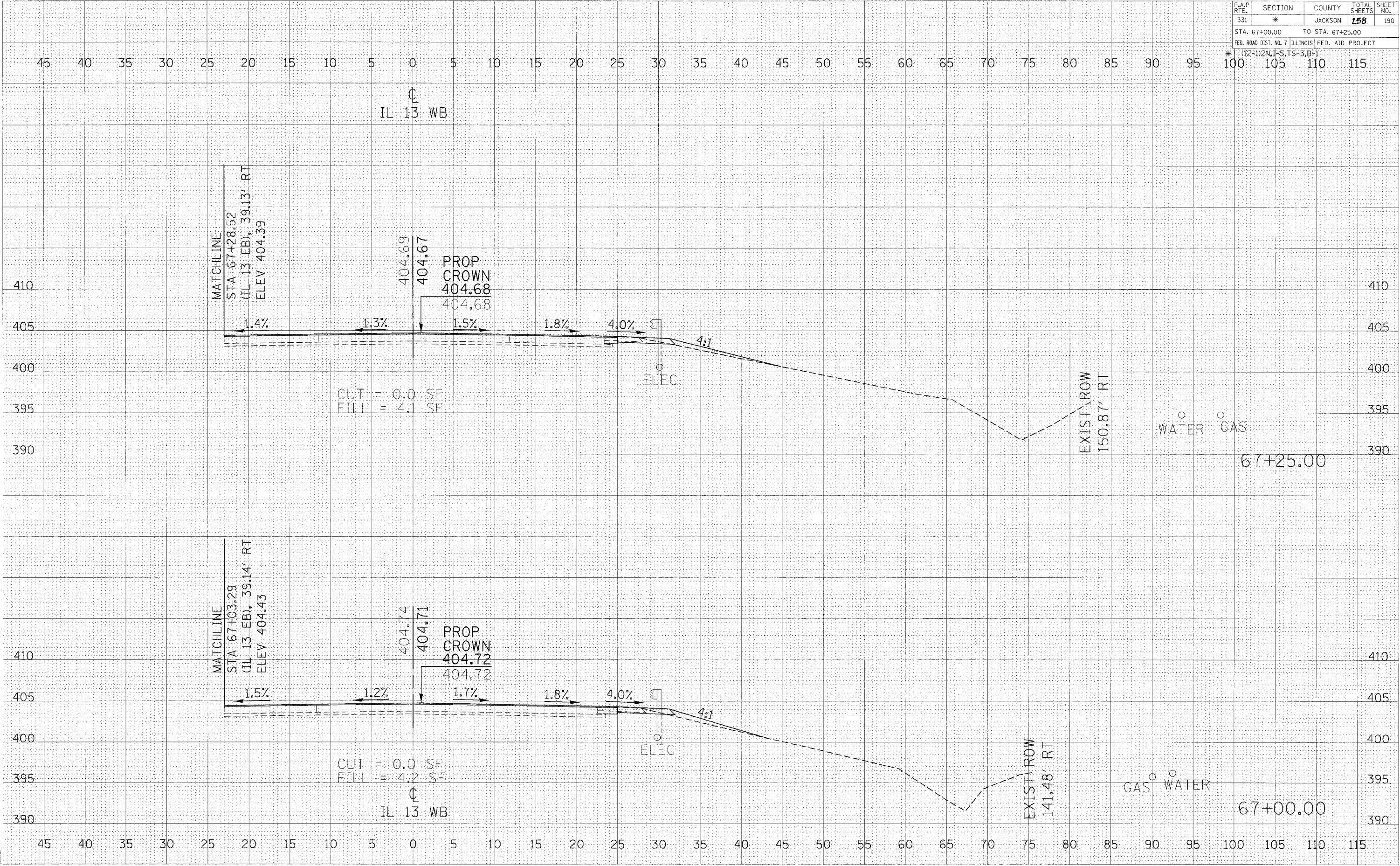

CROSS SECTIONS - IL 13 WB