

F.A.P. RTE.	SECTION	COUNTY	TOTAL SHEETS	SHEET NO.
331	*	JACKSON	258	198
STA. 10+75.00		STA. 11+03.02		
FED. ROAD DIST. NO. 7 ILLINOIS FED. AID PROJECT				

\* (12-1)2N, 1-5, TS-3, B-1

FINN	DATE
BY	
NO.	

ORIGINAL	DATE
BY	
NO.	

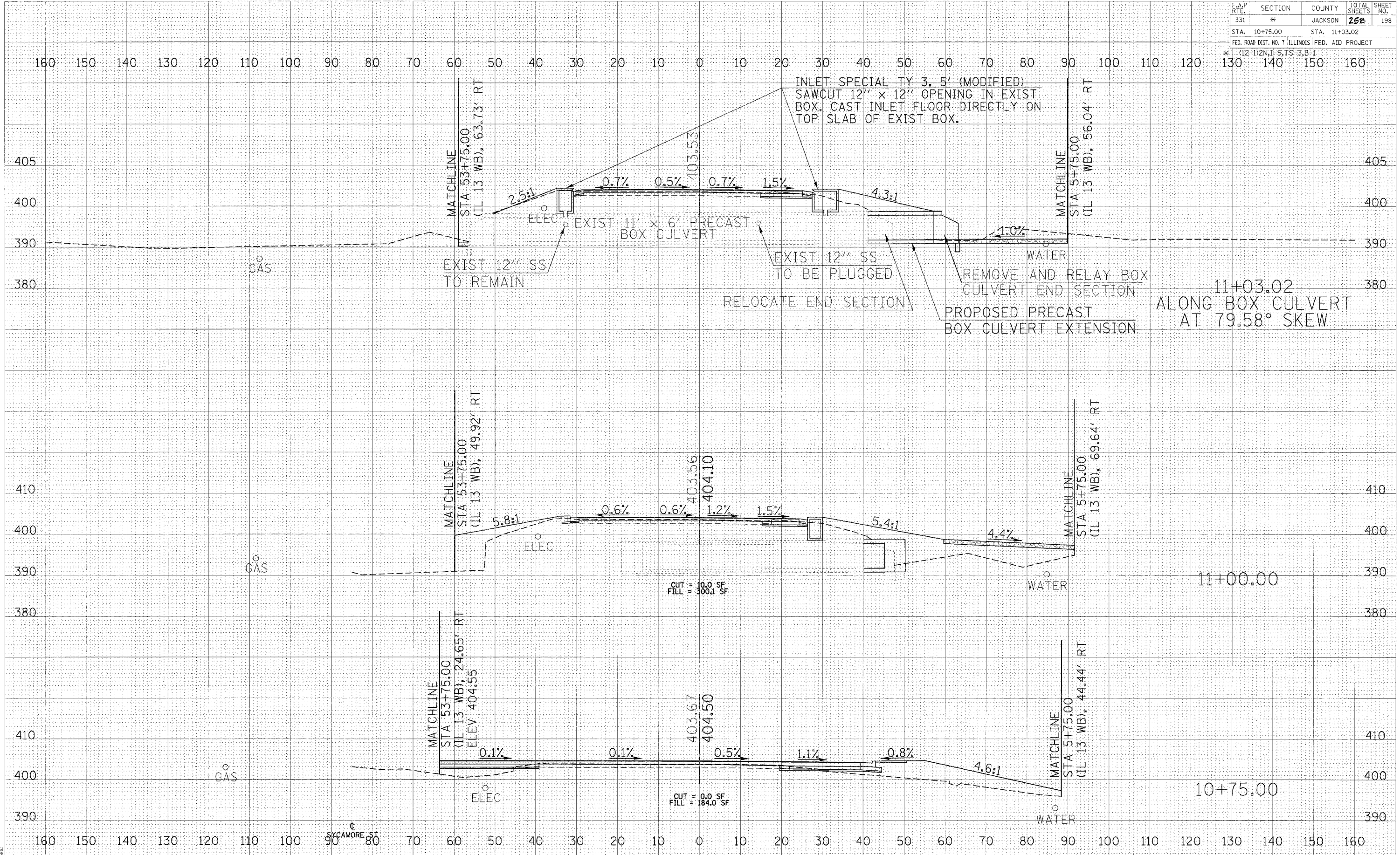

CROSS SECTIONS - SYCAMORE ST

2/15/2008  
 9:00am  
 10:00am  
 11:00am  
 12:00pm  
 1:00pm  
 2:00pm  
 3:00pm  
 4:00pm  
 5:00pm  
 6:00pm  
 7:00pm  
 8:00pm  
 9:00pm  
 10:00pm  
 11:00pm  
 12:00am