

F.A.P. RTE.	SECTION	COUNTY	TOTAL SHEETS	SHEET NO.
331	*	JACKSON	158	200
STA. 1+00.00		TO STA. 1+10.00		
FED. ROAD DIST. NO. 7 ILLINOIS FED. AID PROJECT				

\* (12-1)2N, 1-5, TS-3, B-1

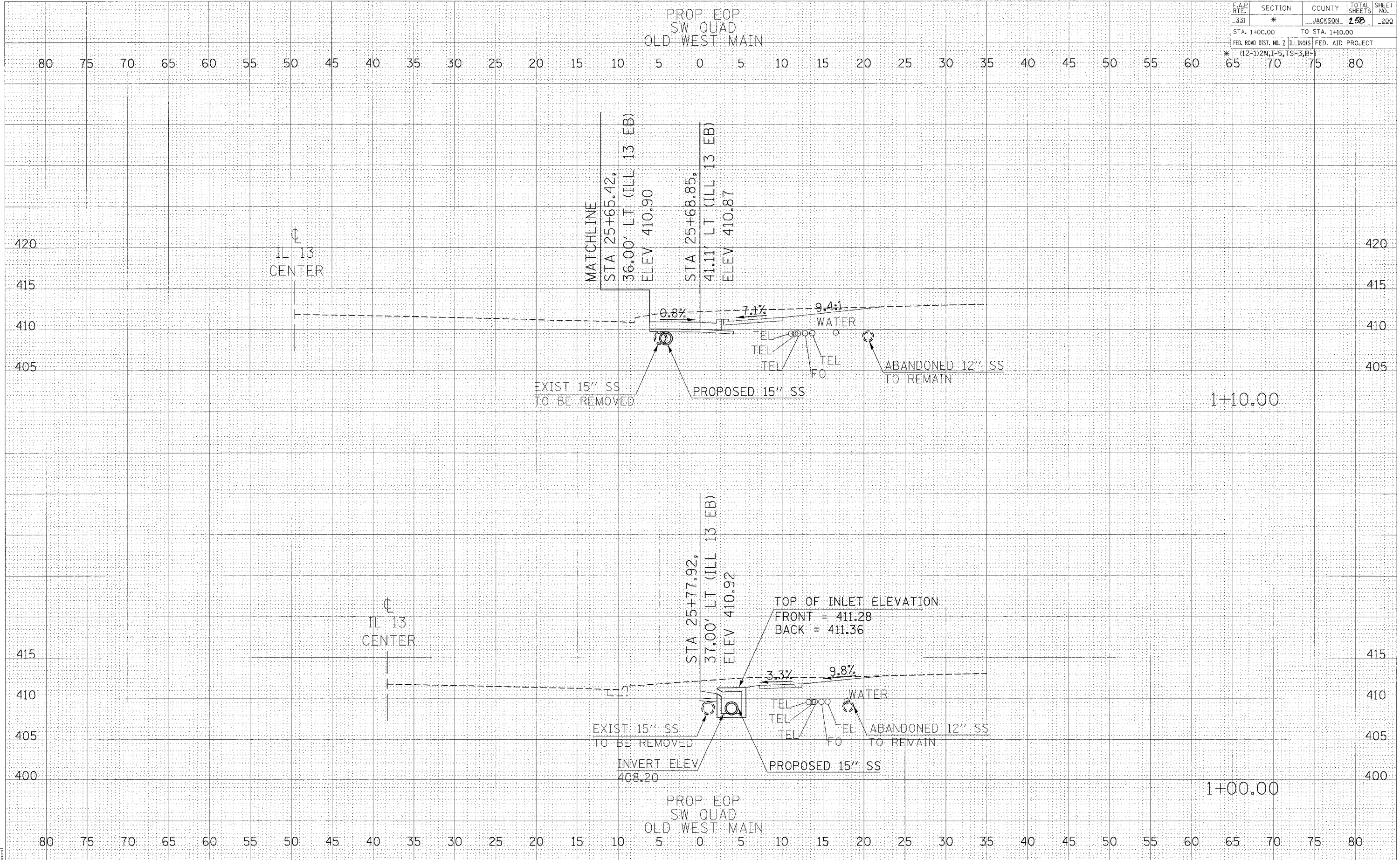

CROSS SECTIONS - OLD MAIN ST SW QUADRANT

FINAL SURVEY	SURVEYED	BY	DATE
NOTE BOOK NO.	PLOTTED		
	TEMPLATE		
	AREAS CHECKED		

ORIGINAL SURVEY	SURVEYED	BY	DATE
NOTE BOOK NO.	PLOTTED		
	TEMPLATE		
	AREAS CHECKED		