

F.A.P. RTE.	SECTION	COUNTY	TOTAL SHEETS	SHEET NO.
331	*	JACKSON	256	201
STA. 1+20.00		TO STA. 1+30.00		
FED. ROAD DIST. NO. 7 ILLINOIS FED. AID PROJECT				
* (12-1)2N, II-5, TS-3, B-1				

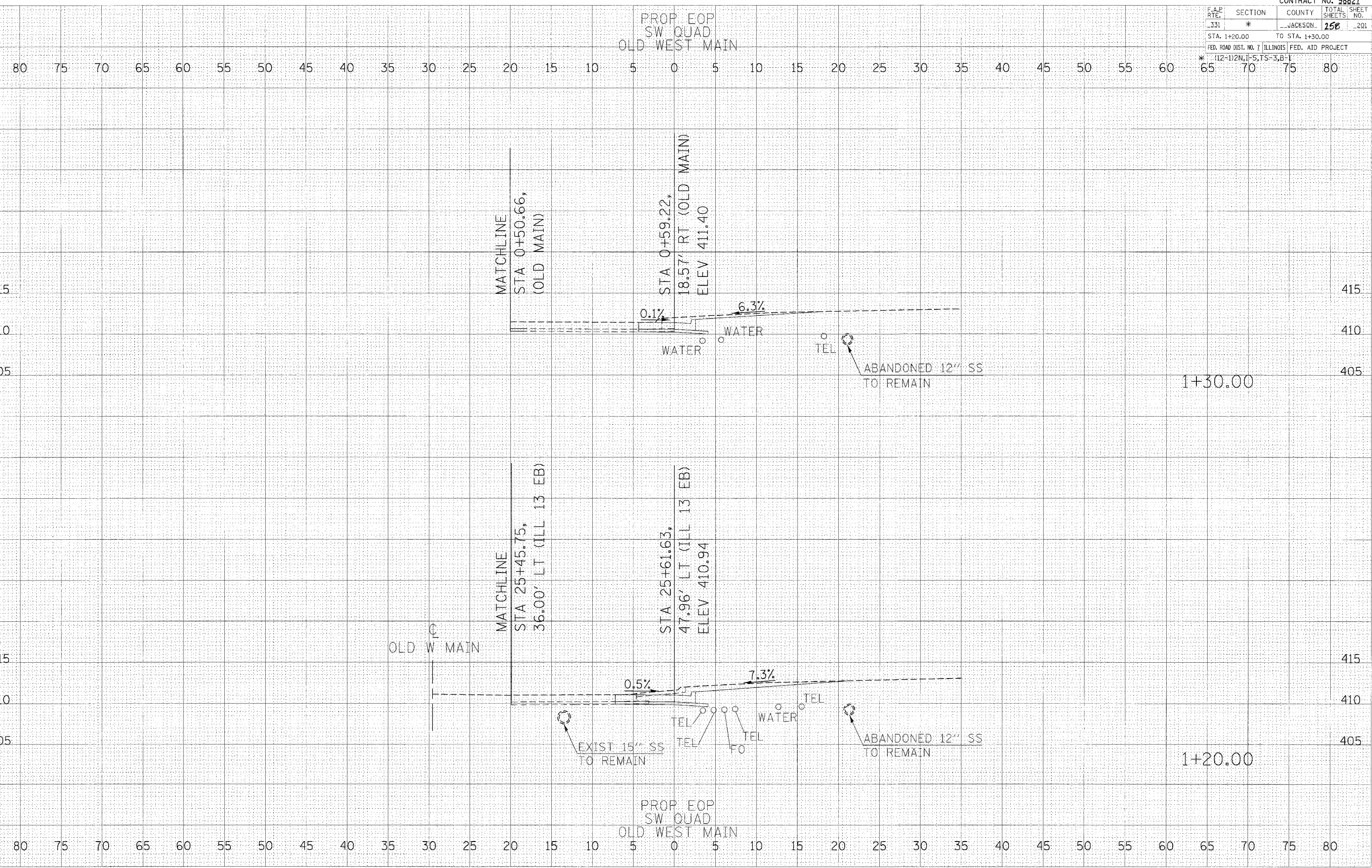

BT

DATE
BY
SURVEYED
PLOTTED
NOTE BOOK
AREAS CHECKED
NO.

BT

DATE
BY
SURVEYED
PLOTTED
NOTE BOOK
AREAS CHECKED
NO.

2/15/2005
 C:\Users\marta_0904403\work\comquad.dgn
 5.8827 / Pl
 pms1

CROSS SECTIONS - OLD MAIN ST SW QUADRANT