

F.A.P. RTE.	SECTION	COUNTY	TOTAL SHEET NO.
331	*	JACKSON	268 / 218
STA. +40.00		TO STA. +50.00	
FED. ROAD DIST. NO. I ILLINOIS FED. AID PROJECT			

* (12-1)2N, I-5, TS-3, B-1

DATE	BY
DATE	BY
DATE	BY

DATE	BY
DATE	BY
DATE	BY

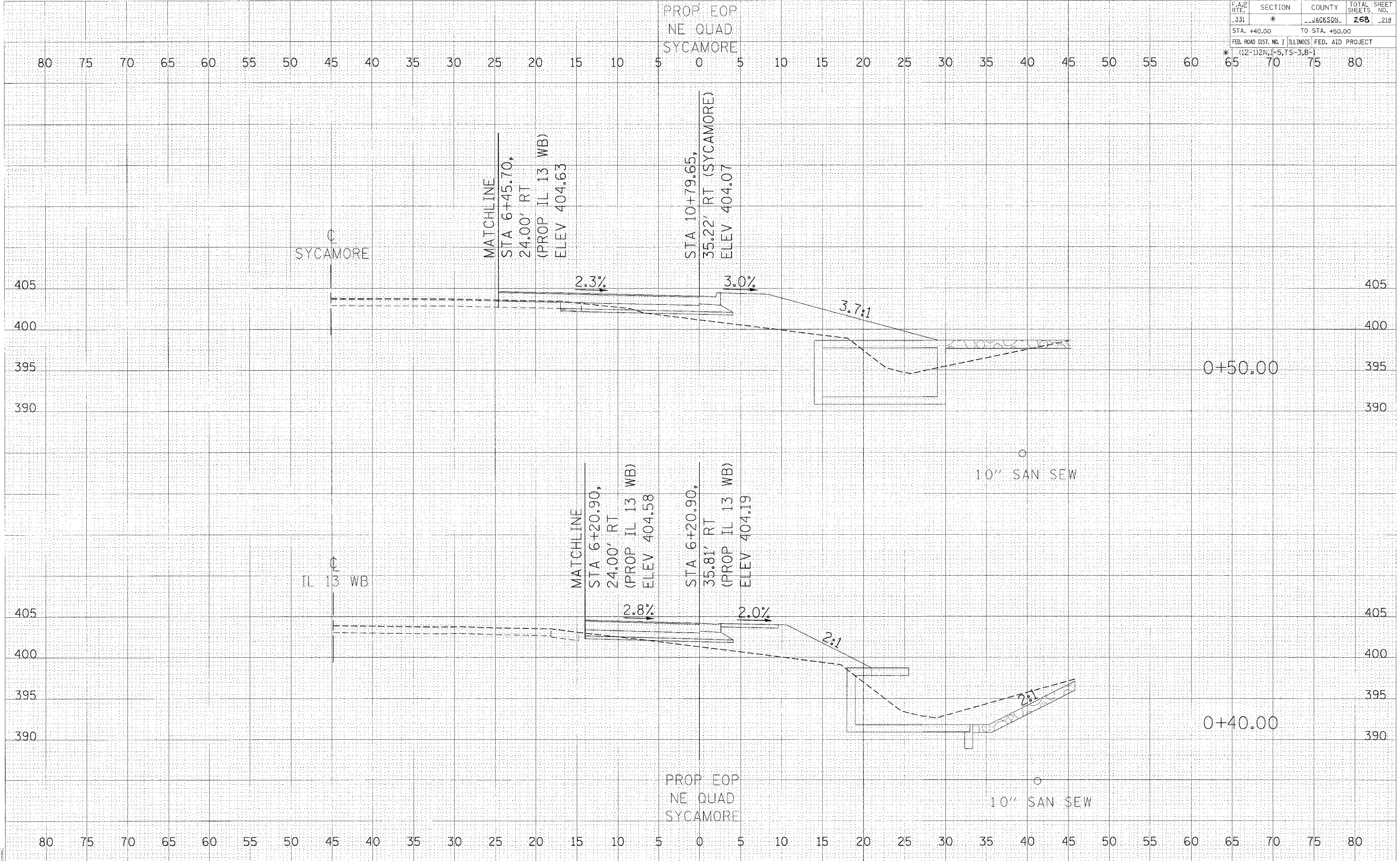

2/15/2006
c:\pco\jct\981103\shch\981103.dwg
08 / 36

CROSS SECTIONS - EMERALD/SYCAMORE NE QUADRANT