

F.A.P. RTE.	SECTION	COUNTY	TOTAL SHEETS	SHEET NO.
845	**	FRANKLIN	7	1

** SLOPE STABILIZATION FY06

D-99-023-06

STATE OF ILLINOIS
DEPARTMENT OF TRANSPORTATION
DIVISION OF HIGHWAYS

**PROPOSED
HIGHWAY PLANS**

F.A.P. ROUTE 845 (ILL. RTE. 154)
SECTION: SLOPE STABILIZATION FY06
PROJECT: *MA-0845(008)*
FRANKLIN COUNTY
C-99-030-06

**RIPRAP PLACEMENT AND SCOUR REPAIR
ALONG THE ILL. RTE 154 CAUSEWAY**

FOR INDEX OF SHEETS, SEE SHEET NO. 2

ADT (2003) = 4450

PROPOSED IMPROVEMENT BEGINS
STA. 198+30

PROPOSED IMPROVEMENT ENDS
STA. 369+50

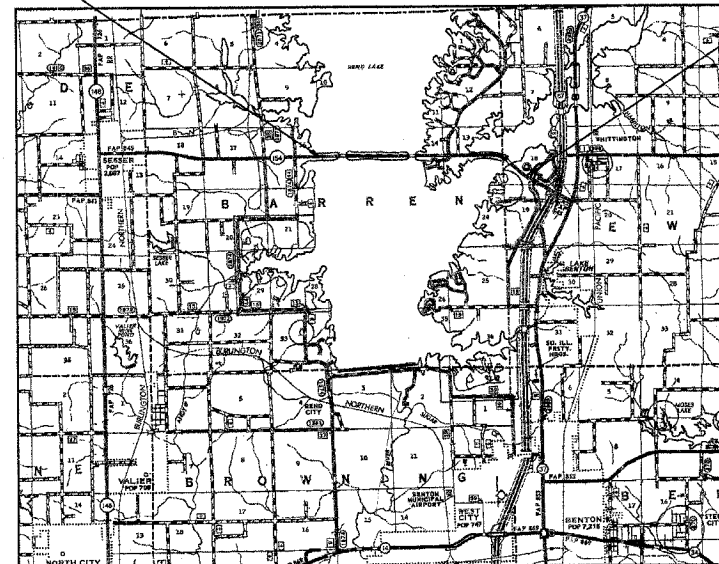

GROSS LENGTH OF PROJECT = 17,120'



STATE OF ILLINOIS
DEPARTMENT OF TRANSPORTATION
DIVISION OF HIGHWAYS

SUBMITTED Feb 9 20 06
May C. Lami
DEPUTY DIRECTOR OF HIGHWAYS, REGION ENGINEER

March 24 20 06
Mike New
ENGINEER OF DESIGN AND ENVIRONMENT

March 24 20 06
Milton R. Seas P.E.
DIRECTOR OF HIGHWAYS, CHIEF ENGINEER

**PRINTED BY THE AUTHORITY
OF THE STATE OF ILLINOIS**

FULL SIZE PLANS HAVE BEEN PREPARED USING STANDARD
ENGINEERING SCALES. REDUCED SIZED PLANS WILL NOT
CONFORM TO STANDARD SCALES. IN MAKING MEASUREMENTS
ON REDUCED PLANS, THE ABOVE SCALES MAY BE USED.

J.U.L.I.E.
JOINT UTILITY LOCATION INFORMATION FOR EXCAVATION
1-800-892-0123

CONTRACT NO. 98966

F.A.P. RTE.	SECTION	COUNTY	TOTAL SHEETS	SHEET NO.
845	**	FRANKLIN	7	3
STA. 198+30		TO STA. 369+50		
FED. ROAD DIST. NO. 7	ILLINOIS	FED. AID PROJECT		

** SLOPE STABILIZATION FY06

SCHEDULE

LOCATION STATION TO STATION	STONE DUMPED RIPRAP CLASS A5
	TONS
SOUTH FACE OF CAUSEWAY	
RT. STA. 198+30 TO 198+90	75
RT. STA. 200+50 TO 201+30	100
RT. STA. 203+00 TO 204+00	125
RT. STA. 204+50 TO 204+80	38
RT. STA. 206+60 TO 208+35	292
RT. STA. 209+50 TO 211+50	250
RT. STA. 213+00 TO 214+00	125
RT. STA. 216+50 TO 220+50	500
RT. STA. 223+80 TO 228+00	525
RT. STA. 230+10 TO 232+25	269
RT. STA. 233+50 TO 234+50	125
RT. STA. 235+50 TO 236+50	125
RT. STA. 237+00 TO 237+50	63
RT. STA. 240+00 TO 241+00	125
RT. STA. 242+00 TO 242+50	63
RT. STA. 246+00 TO 247+50	188
RT. STA. 251+00 TO 251+50	84
RT. STA. 254+00 TO 256+50	313
RT. STA. 257+20 TO 258+20	125
RT. STA. 258+75 TO 260+15	389
RT. STA. 260+15 TO 261+00	189
RT. STA. 261+75 TO 262+50	94
RT. STA. 263+00 TO 263+50	63
RT. STA. 264+20 TO 264+75	153
RT. STA. 265+00 TO 267+50	313

SCHEDULE

LOCATION STATION TO STATION	STONE DUMPED RIPRAP CLASS A5
	TONS
SOUTH FACE OF CAUSEWAY	
S. W. CONE OF SN 028-0051	167
RT. STA. 280+00 TO 282+00	417
RT. STA. 282+00 TO 284+50	556
RT. STA. 285+00 TO 286+00	250
RT. STA. 331+70 TO 334+20	347
RT. STA. 335+00 TO 337+50	139
RT. STA. 344+50 TO 345+00	63
RT. STA. 346+50 TO 347+75	208
RT. STA. 350+00 TO 350+50	63
RT. STA. 354+50 TO 355+50	125
S. W. CONE OF SN 028-0052	125
S. E. CONE OF SN 028-0052	63
RT. STA. 363+50 TO 365+00	188
RT. STA. 367+75 TO 369+50	389
NORTH FACE OF CAUSEWAY	
N. W. CONE OF SN 028-0050	139
N. E. CONE OF SN 028-0050	139
LT. STA. 251+20 TO 266+00	3084
LT. STA. 266+85 TO 267+35	167
LT. STA. 267+65 TO 268+15	167
LT. STA. 268+75 TO 275+00	2084
LT. STA. 279+50 TO 287+22	2574
TOTAL	16165

PLOT DATE = 12/21/2005
 FILE NAME = I:\982305\enddata.e32
 PLOT SCALE = 50.0000 / IN.
 USER NAME = halswood

ROUTE NO.	SEC.	COUNTY	TOTAL SHEETS	SHEET NO.
RD. 845	**	FRANKLIN	7	4
FED. ROAD DIST. NO. 7	ILLINOIS	PROJECT		

TYPICAL SECTION

** SLOPE STABILIZATION FY06

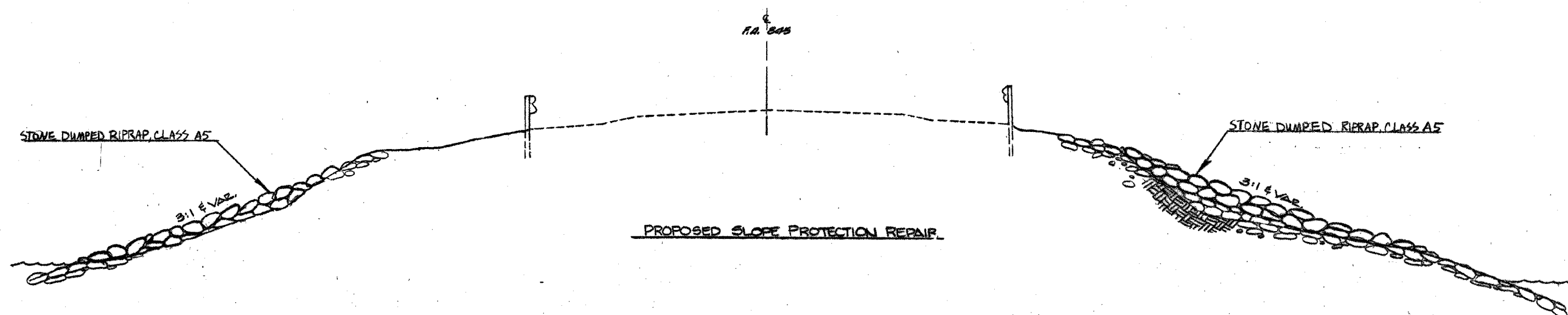
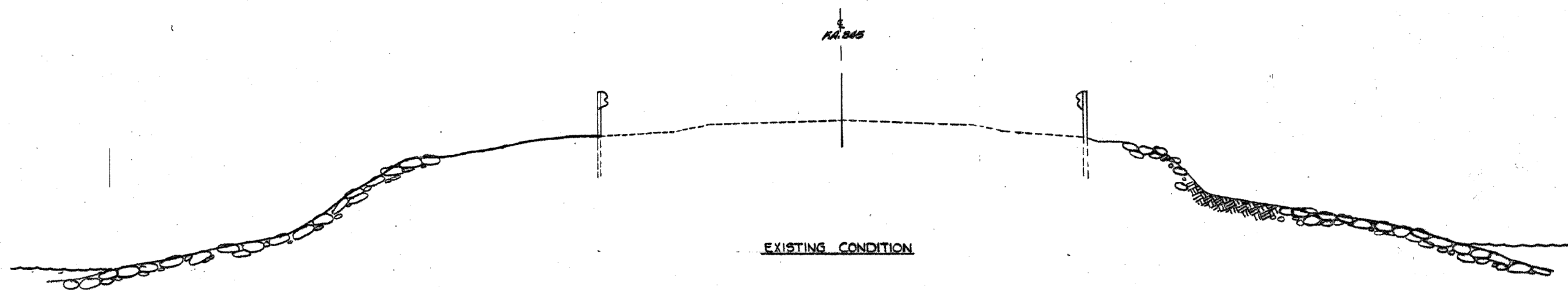

ROUTE NO.	SEC.	COUNTY	TOTAL SHEETS	SHEET NO.
FA 845	**	FRANKLIN	7	5
FED. ROAD DIST. NO. 7	ILLINOIS	PROJECT		

** SLOPE STABILIZATION FY06

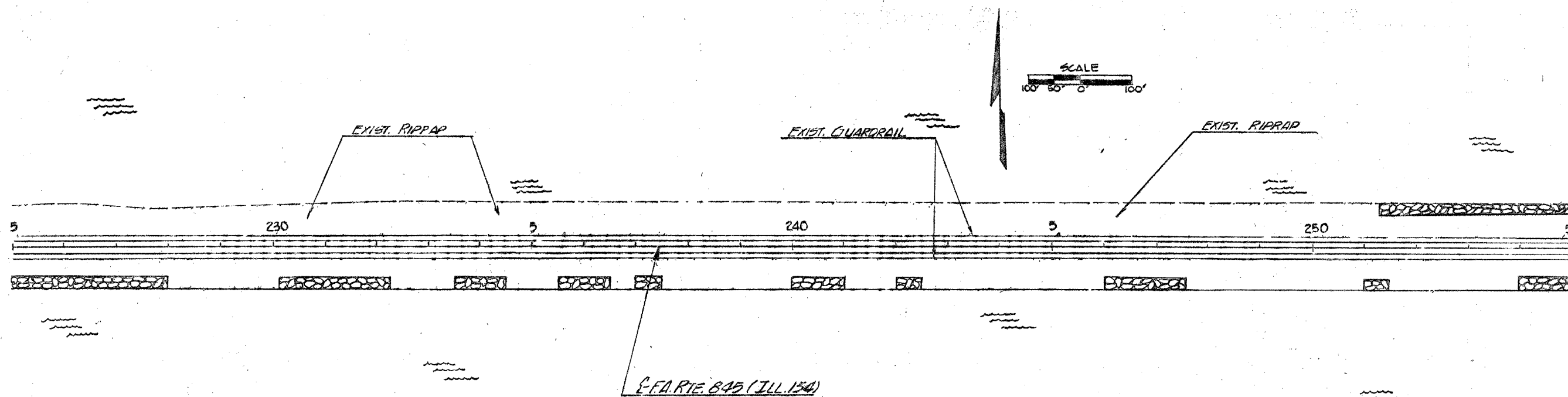
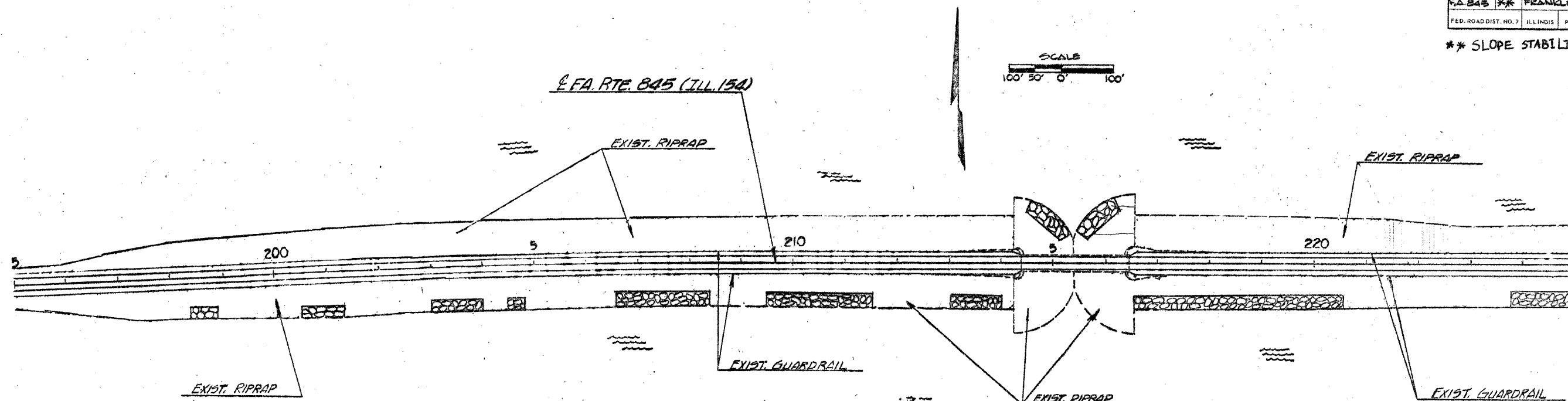

ROUTE NO.	SEC.	COUNTY	TOTAL SHEETS	SHEET NO.
FA. 845	**	FRANKLIN	7	6
FED. ROAD DIST. NO. 7	ILLINOIS	PROJECT		



** SLOPE STABILIZATION FY06

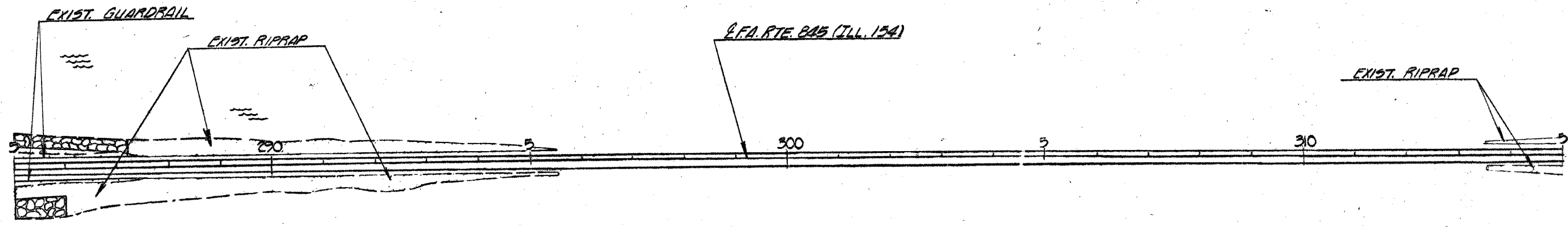
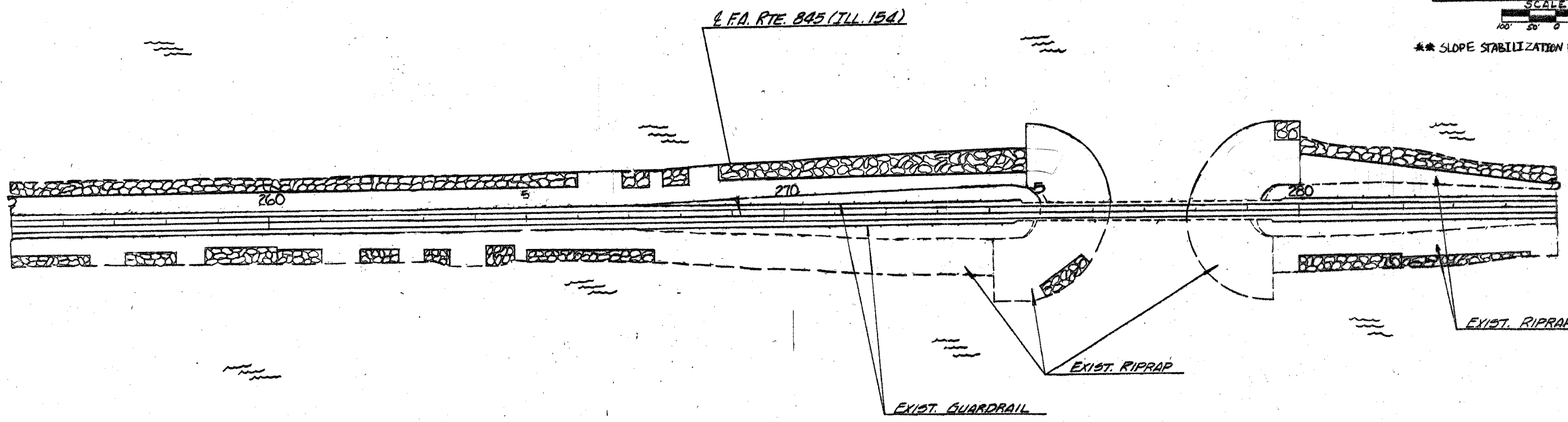

ROUTE NO.	SEC.	COUNTY	TOTAL SHEETS	SHEET NO.
FA. 845**		FRANKLIN	7	7
FED. ROAD DIST. NO. 7	ILLINOIS	PROJECT		

** SLOPE STABILIZATION FY06

