

Order v(E) bars full length. Cut as shown and use remainder in opposite face.

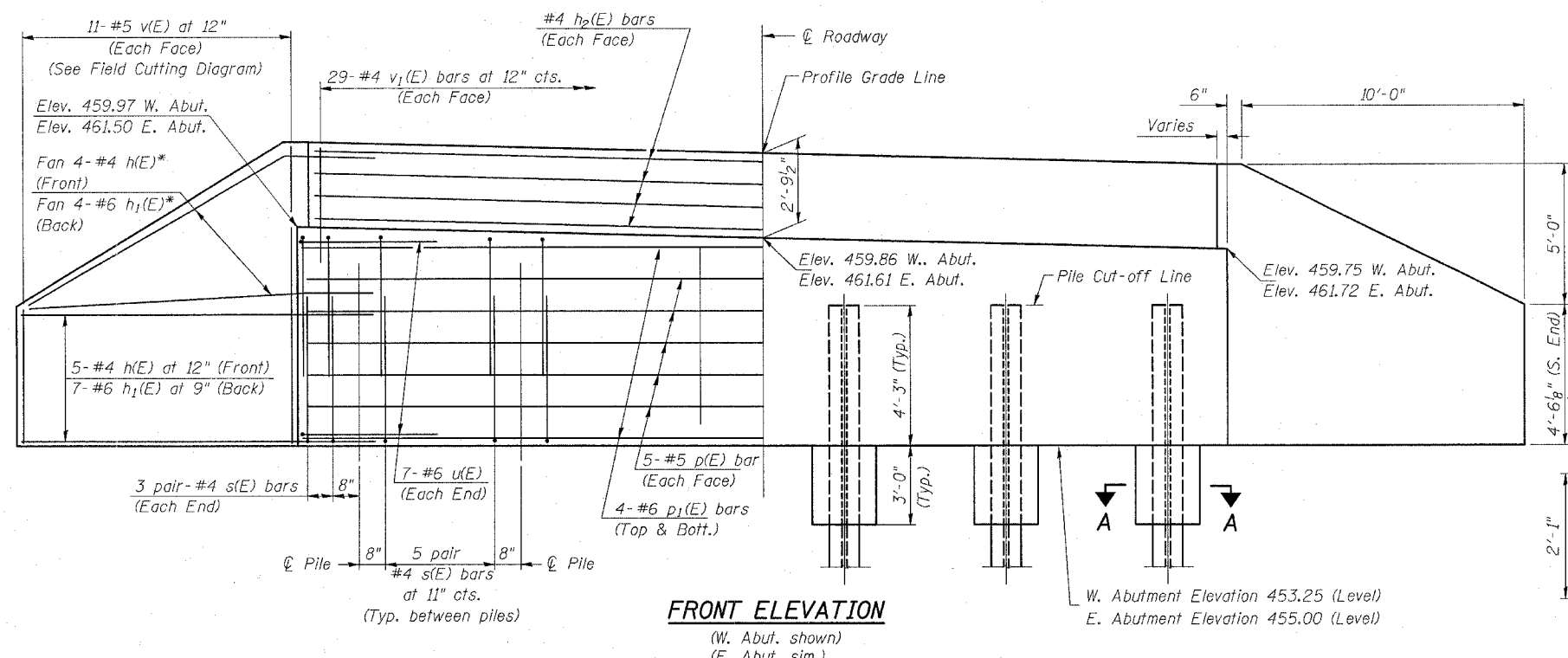

BILL OF MATERIAL FOR TWO ABUTMENTS

Bar	No.	Size	Length	Shape
h(E)	36	#4	12'-4"	—
h ₁ (E)	44	#6	13'-4"	—
h ₂ (E)	16	#4	28'-8"	—
p(E)	20	#5	28'-8"	—
p ₁ (E)	16	#6	28'-8"	—
s(E)	124	#4	10'-4"	□
u(E)	28	#6	11'-1"	□
v(E)	44	#5	13'-2"	—
v ₁ (E)	116	#4	4'-2"	—
Concrete Structures	Cu. Yd.		51.2	
Reinforcement Bars, Epoxy Coated	Pound		5020	
Furnishing Steel Piles, HP 12x53	Foot		160	
Driving Steel Piles	Foot		160	
Test Piles Steel, HP 12x53	Each		2	
Metal Shoes	Each		10	
Set Piles in Rock	Each		5	

Bars denoted (E) shall be epoxy coated.

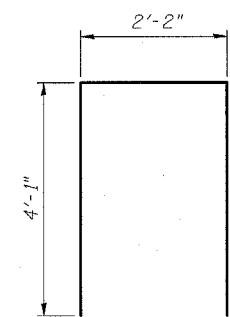
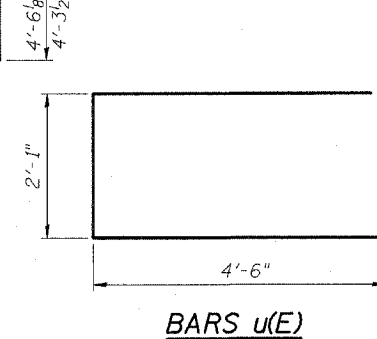

* Field bend h(E) and h₁(E) bars as required to maintain 1/2" cl. within backwall

NOTES

- The Backwall and the portion of the wingwalls above the bonded construction joint shall be cast against the in-place beam.
- Reinforcement bars shall conform to A.A.S.H.T.O. M-31, M-42 or M-53, Grade 60.
- A benchmark shall be installed in the flat portion of one of the wingwalls. A benchmark disk shall be furnished to the Contractor by the Engineer and installed as directed by the Engineer. Cost included with Concrete Structures.

PILE DATA

Type: Steel H12X53
Capacity: Drive to Refusal
Estimated Length: 15 Feet (W. Abutment)
17 Feet (E. Abutment)
No. Required: 6 per Abutment (Including one test pile per abutment)

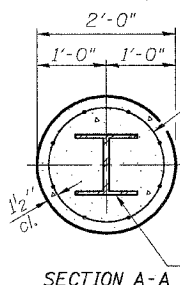

Welded wire fabric 6 x 6-W4.0 x W4.0 weighing 58#/100 sq. ft. The cost of Excavation, Class SI Concrete Encasement and Reinforcement is included with Furnishing Piles. Forms for Encasement may be omitted when soil conditions permit.

PILE ENCASUREMENT DETAIL

REVISIONS	
NAME	DATE

ILLINOIS DEPARTMENT OF TRANSPORTATION
F.A.S. 1926
SECTION 04-00093-00-BR
UNION COUNTY
COUNTY HIGHWAY 8 OVER BRADSHAW CREEK

PILE BENT ABUTMENTS

SCALE: VERT. DRAWN BY MGM
HORIZ. CHECKED BY SMK
DATE 02/03/06