

# PLANS FOR PROPOSED HIGHWAY SAFETY IMPROVEMENT PROJECT

COUNTY WIDE GUARDRAIL END TERMINAL UPGRADE

SECTION 15-00175-00-SP

HSIP-0167(084)

SANGAMON COUNTY

C-96-224-16

SEE SHEET 2 FOR INDEX OF SHEETS AND  
LIST OF ILLINOIS DOT HIGHWAY STANDARDS

F.A.S. RTE.	SECTION	COUNTY	TOTAL SHEETS	SHEET NO.
VARIOUS	15-00175-00-SP	SANGAMON	15	1
FEDERAL AID PROJECT		ILLINOIS	CONTRACT NO. 93696	

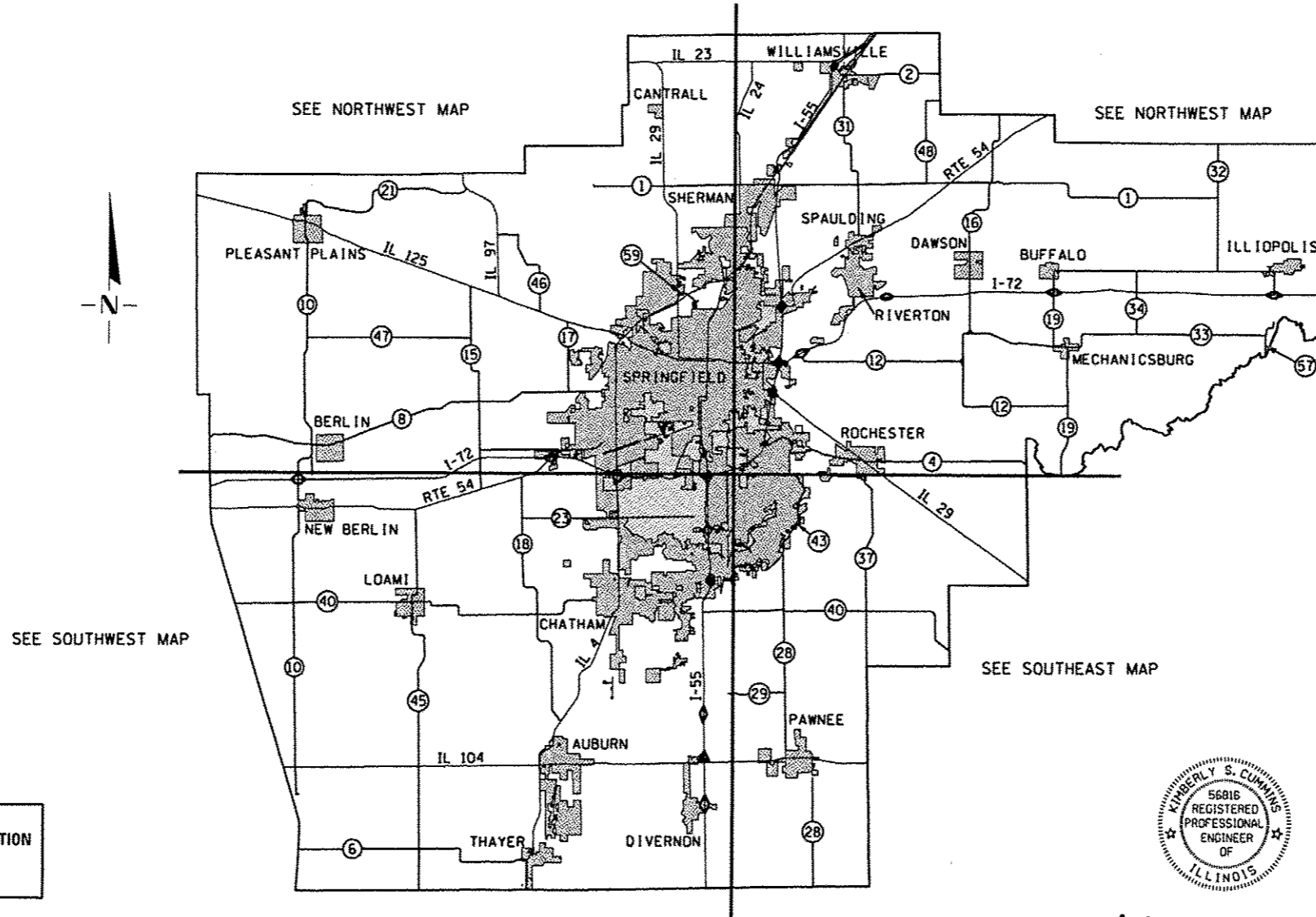
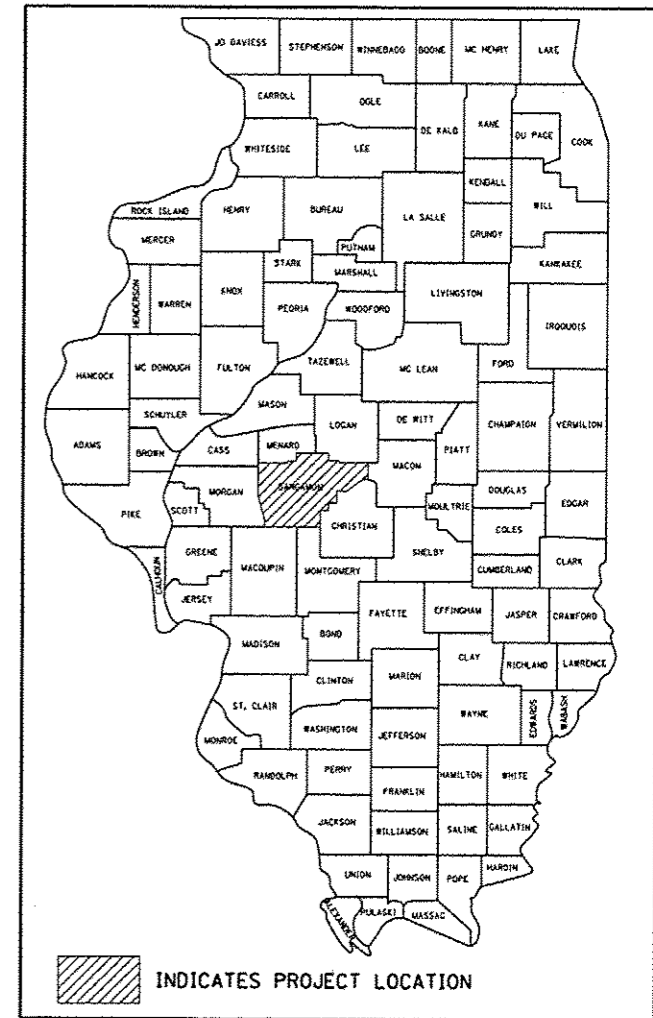

SEE SOUTHWEST MAP

SEE SOUTHEAST MAP

J.U.L.I.E.  
JOINT UTILITY LOCATION INFORMATION FOR EXCAVATION  
1-800-892-0123  
OR 811



SANGAMON COUNTY  
LOCATION MAP  
COUNTY WIDE  
(NO SCALE)



*Kimberly S. Cummins* 1/12/17  
ILLINOIS PROFESSIONAL NO. 56816  
(Expires 11/30/17)

STATE OF ILLINOIS  
DEPARTMENT OF TRANSPORTATION

APPROVED *Jan 12, '17* . 20 17  
*B. Davis, Acting*  
SANGAMON COUNTY ENGINEER

PASSED FEB 10 . 20 17  
*[Signature]*  
DISTRICT SIX ENGINEER OF  
LOCAL ROADS AND STREETS

RELEASED FOR  
BID BASED ON  
LIMITED REVIEW FEB 10 . 20 17  
*Jeffrey M. South*  
REGION ENGINEER

**INDEX OF SHEETS**

SHEET NO.	TITLE
1	COVER SHEET
2	INDEX OF SHEETS, HIGHWAY STANDARDS AND SUMMARY OF QUANTITIES
3	TYPICAL PLAN, SECTIONS AND GENERAL NOTES
4	TYPICAL TERMINAL REPLACEMENT
5	LOCATION MAP - NORTHEAST SANGAMON COUNTY
6-7	SCHEDULE OF QUANTITIES - NORTHEAST SANGAMON COUNTY
8	LOCATION MAP - NORTHWEST SANGAMON COUNTY
9	SCHEDULE OF QUANTITIES - NORTHWEST SANGAMON COUNTY
10	LOCATION MAP - SOUTHWEST SANGAMON COUNTY
11-12	SCHEDULE OF QUANTITIES - SOUTHWEST SANGAMON COUNTY
13	LOCATION MAP - SOUTHEAST SANGAMON COUNTY
14	SCHEDULE OF QUANTITIES - SOUTHEAST SANGAMON COUNTY
15	CONCRETE COLLAR

SUMMARY OF QUANTITIES			
CODE	ITEM	UNIT	TOTAL QUANTITY
Δ 20200100	EARTH EXCAVATION	CU YD	116
Δ 20400800	FURNISHED EXCAVATION	CU YD	3,625
Δ 28000250	TEMPORARY EROSION CONTROL SEEDING	POUND	325
Δ 28000305	TEMPORARY DITCH CHECKS	FOOT	216
Δ 28000400	PERIMETER EROSION BARRIER	FOOT	16,093
Δ 28000500	INLET AND PIPE PROTECTION	EACH	8
Δ 48102100	AGGREGATE WEDGE SHOULDER, TYPE B	TON	53
Δ 54248510	CONCRETE COLLAR	CU YD	0.8
63000001	STEEL PLATE BEAM GUARDRAIL, TYPE A, 6 FOOT POSTS	FOOT	137.5
63100045	TRAFFIC BARRIER TERMINAL, TYPE 2	EACH	2
63100167	TRAFFIC BARRIER TERMINAL, TYPE 1 (SPECIAL) TANGENT	EACH	207
63100169	TRAFFIC BARRIER TERMINAL, TYPE 1 (SPECIAL) FLARED	EACH	5
63200310	GUARDRAIL REMOVAL	FOOT	9,387
67100100	MOBILIZATION	LSUM	1
72501000	TERMINAL MARKER - DIRECT APPLIED	EACH	212
Δ 542D0220	PIPE CULVERTS, CLASS D, TYPE 1 15"	FOOT	38
Δ 542D0223	PIPE CULVERTS, CLASS D, TYPE 1 18"	FOOT	436
* X2501000	SEEDING, CLASS 2 (SPECIAL)	ACRE	3.25
* X6330900	VERTICAL ADJUSTMENT OF GUARDRAIL	FOOT	2,637.5
* X7010216	TRAFFIC CONTROL AND PROTECTION, (SPECIAL)	LSUM	1

# \* 20076600 Trainees Hour 1,000  
 # \* 20076604 Trainees Training Program Graduate Hour 1,000

\* SEE SPECIAL PROVISIONS

Δ SPECIALTY ITEMS

# 0042

**LIST OF ILLINOIS DOT HIGHWAY STANDARDS**

280001-07	TEMPORARY EROSION CONTROL SYSTEMS
630001-11	STEEL PLATE BEAM GUARDRAIL
630301-07	SHOULDER WIDENING FOR TYPE 1 (SPECIAL) GUARDRAIL TERMINALS
631011-10	TRAFFIC BARRIER TERMINAL, TYPE 2
701006-05	OFF-ROAD OPERATIONS, 2L, 2W, 15' (4.5 M) TO 24' (600 MM) FROM PAVEMENT EDGE
701201-04	LANE CLOSURE, 2L, 2W, DAY ONLY, FOR SPEEDS > 45 MPH
701301-04	LANE CLOSURE, 2L, 2W, SHORT TIME OPERATIONS
701501-06	URBAN LANE CLOSURE 2L, 2W, UNDIVIDED
701901-06	TRAFFIC CONTROL DEVICES
725001-01	OBJECT AND TERMINAL MARKERS
782006	GUARDRAIL AND BARRIER WALL REFLECTOR MOUNTING DETAILS



JOB # 2435	DESIGNED - NAK	REVISED -
FILE NAME # 2435-shr-ovr.dgn	DRAWN - SJS	REVISED -
PLOT SCALE = 1/8" = 1' in.	CHECKED - NAK	REVISED -
PLDT DATE = 1/9/2017	DATE - 3/18/2016	REVISED -

**SANGAMON COUNTY  
 GUARDRAIL TERMINAL IMPROVEMENTS**

**INDEX OF SHEETS, HIGHWAY STANDARDS  
 AND SUMMARY OF QUANTITIES**

SCALE: SHEET NO. OF SHEETS STA. TO STA.

F.A.S. RTE.	SECTION	COUNTY	TOTAL SHEETS	SHEET NO.
VAR.	15-00175-00-SP	SANGAMON	15	2
CONTRACT NO. 93696			ILLINOIS FED. AID PROJECT	

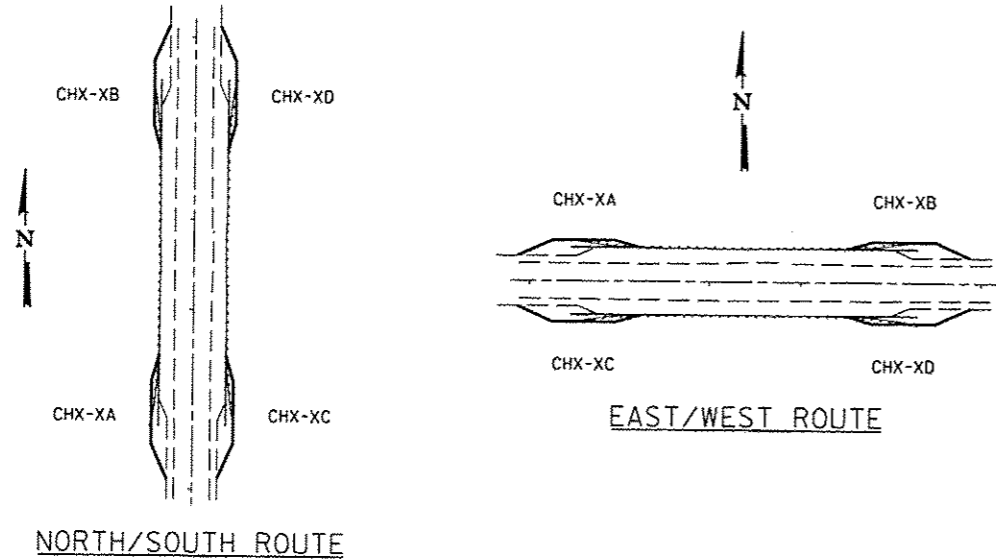

**LOCATION IDENTIFICATION**

**GENERAL NOTES**

- EXISTING TYPE 5A TERMINALS, TYPE 6 TERMINALS, AND GUARDRAIL ATTACHED TO STRUCTURES SHALL REMAIN IN PLACE.
- SEE STANDARD 630301 FOR DETAILS OF SHOULDER WIDENING FOR TYPE 1 (SPECIAL) TERMINALS.
- ALL DISTURBED AREA SHALL BE SEEDED WITH SEEDING, CLASS 2 (SPECIAL).
- EROSION CONTROL ITEMS SHALL BE INSTALLED AS DIRECTED BY THE ENGINEER.
- THE CONTRACTOR SHALL BE RESPONSIBLE FOR PROTECTING UTILITY PROPERTY DURING CONSTRUCTION OPERATIONS AS SPECIFIED IN ARTICLE 107.31 OF THE STANDARD SPECIFICATIONS. A MINIMUM OF 48 HOURS ADVANCE NOTICE IS REQUIRED FOR NON-EMERGENCY WORK. THE JULIE NUMBER IS (800) 892-0123.
- NO MATERIAL SHALL BE LEFT ON OR NEAR THE ROADWAY DURING NON-WORKING HOURS.
- REMOVED TERMINALS THAT ARE NOT REPLACED ON THE SAME DAY SHALL BE PROTECTED WITH LIGHTED BARRICADES. NO LOCATION WILL BE LEFT WITHOUT EITHER LIGHTED BARRICADES OR COMPLETED TERMINALS AT ANY TIME.
- WHEN POSTS ARE REQUIRED TO BE INSTALL THROUGH PAVED SHOULDER, ALL COST TO DO SO SHALL BE INCLUDED IN THE CONTRACT UNIT PRICE FOR THE WORK BEING DONE. THE TOP 3 INCHES OF THE AREA AROUND THE POST SHALL BE FILLED WITH BITUMINOUS MATERIAL OR GROUT.
- WHEN SPECIFIED, PROPOSED PIPE CULVERTS SHALL BE CONNECTED TO EXISTING PIPES WITH CONCRETE COLLARS.
- THE CONTRACTOR IS ADVISED THAT THE GUARDRAIL PAY ITEMS INCLUDED IN THE PLANS MAY BE USED TO REPLACE STEEL PLATE BEAM GUARD RAIL AND TRAFFIC BARRIER TERMINALS FOR THE NEW MIDWEST STANDARD AS SHOWN IN THE HIGHWAY STANDARDS AS WELL AS STEEL PLATE BEAM GUARDRAIL AND TRAFFIC BARRIER TERMINALS INSTALLED PRIOR TO JANUARY 1, 2007, NO ADDITIONAL COMPENSATION WILL BE ALLOWED FOR UTILIZING THE CURRENT MIDWEST STANDARDS.

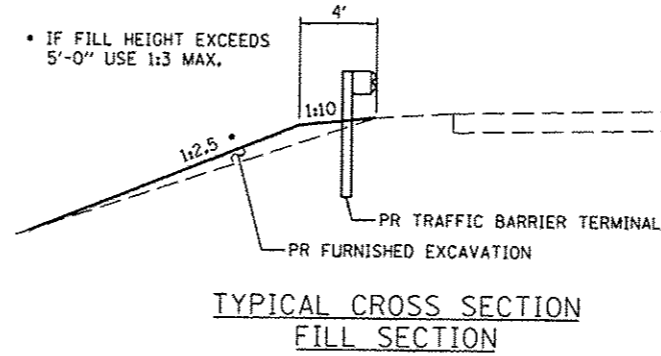

**TYPICAL CROSS SECTION  
FILL SECTION**

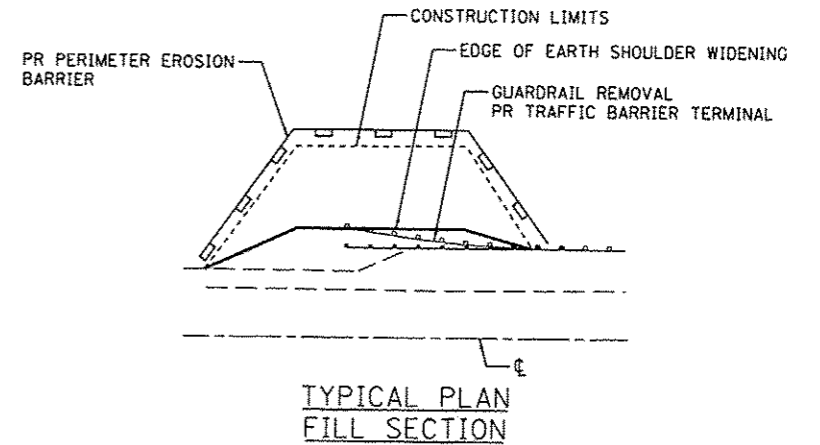

**TYPICAL PLAN  
FILL SECTION**

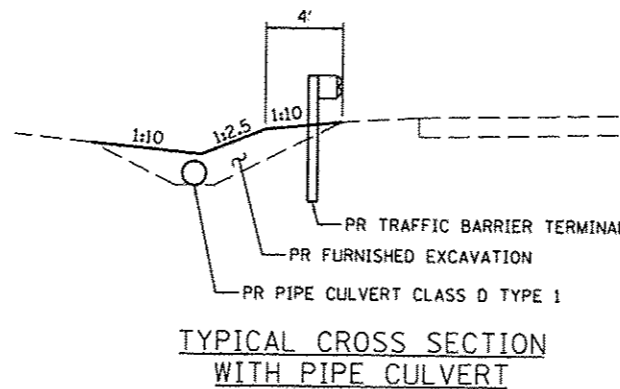

**TYPICAL CROSS SECTION  
WITH PIPE CULVERT**

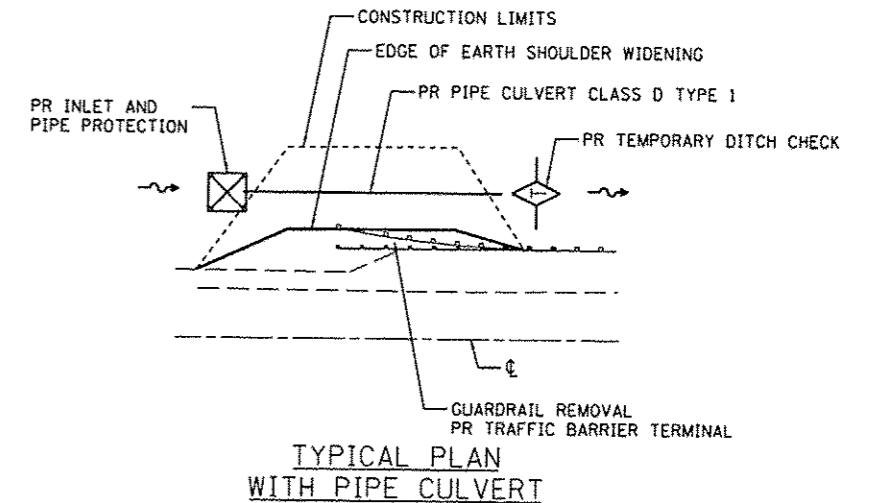

**TYPICAL PLAN  
WITH PIPE CULVERT**

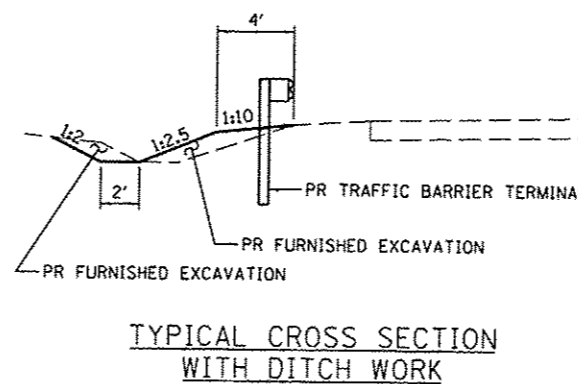

**TYPICAL CROSS SECTION  
WITH DITCH WORK**

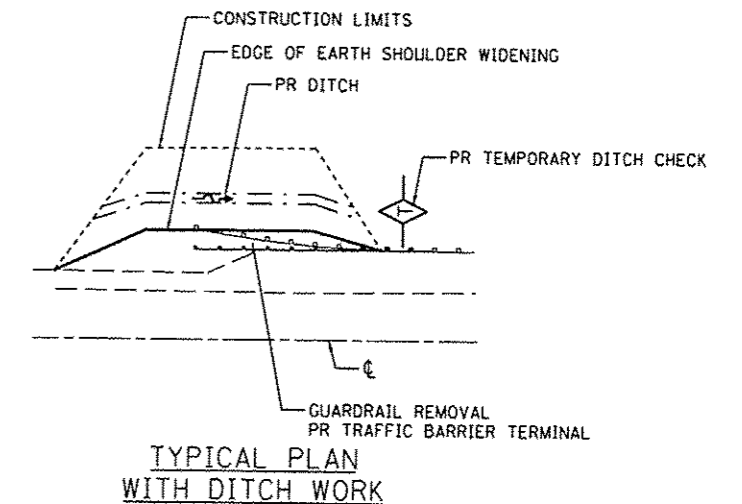

**TYPICAL PLAN  
WITH DITCH WORK**

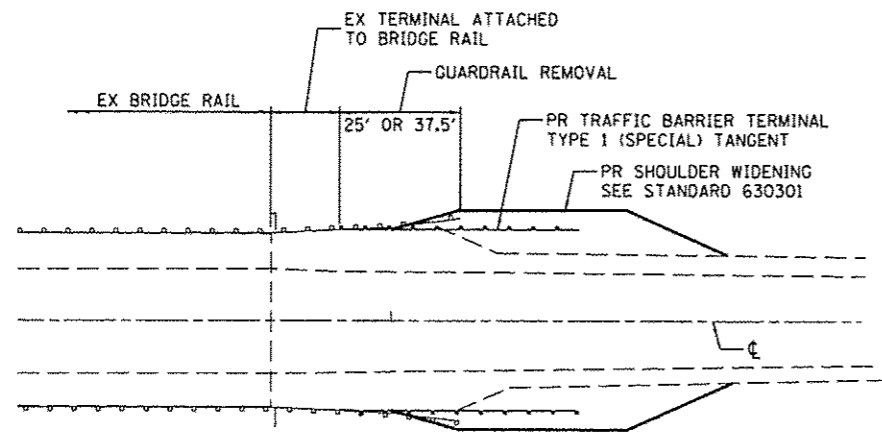

**TYPICAL TERMINAL REPLACEMENT  
LESS THEN 50' OF GUARDRAIL REMOVAL**

APPLIES WHERE EXISTING GUARDRAIL AND TERMINAL EXCLUDING TERMINALS ATTACHED TO BRIDGE RAIL AND GUARDRAIL ATTACHED TO STRUCTURES IS LESS THAN 50 FEET.

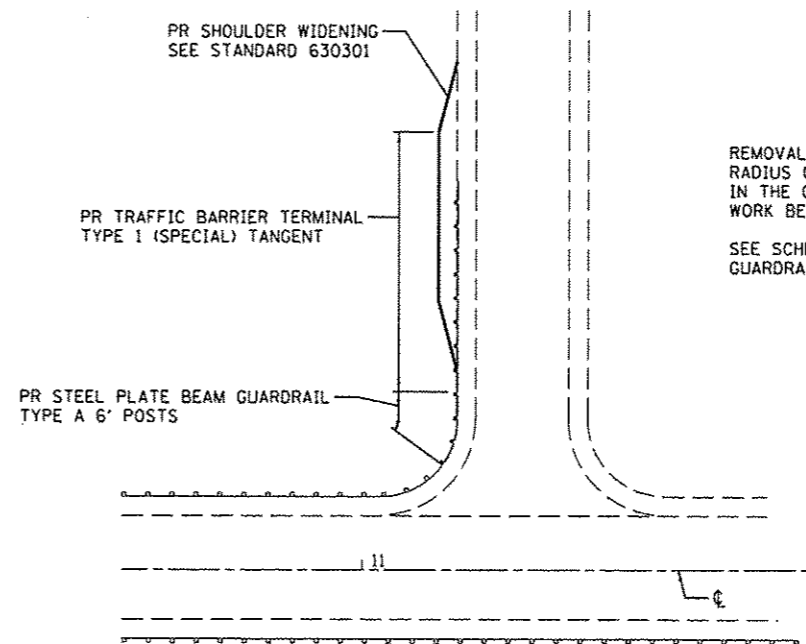

**TYPICAL TERMINAL REPLACEMENT  
EXISTING RADIUS GUARDRAIL AT SIDE ROADS**

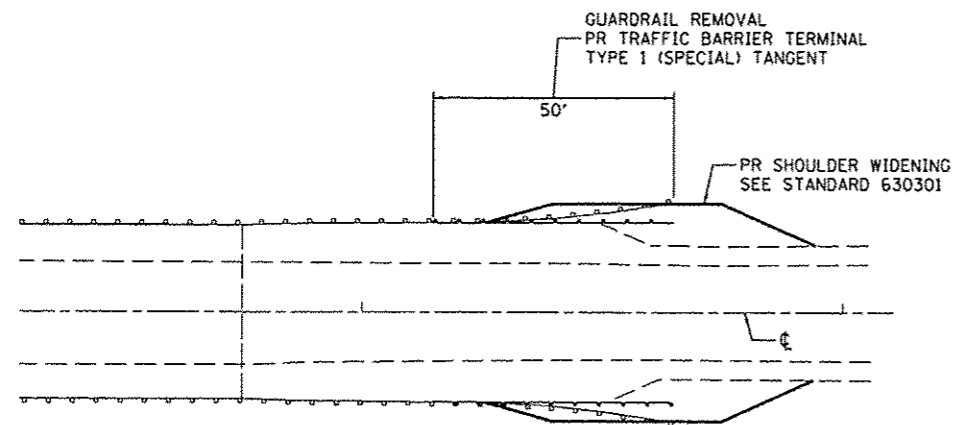

**TYPICAL TERMINAL REPLACEMENT  
50 FOOT OF GUARDRAIL REMOVAL**

APPLIES WHERE EXISTING GUARDRAIL AND TERMINAL EXCLUDING TERMINALS ATTACHED TO BRIDGE RAIL AND GUARDRAIL ATTACHED TO STRUCTURES IS 50 FEET OR MORE.

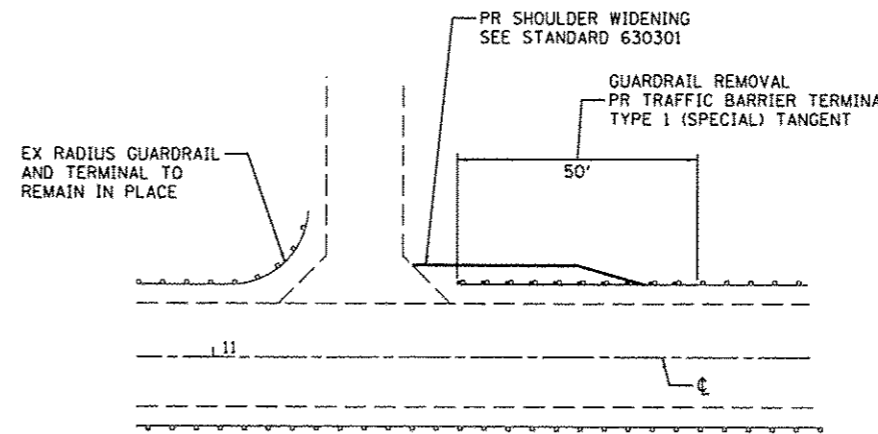

**TYPICAL TERMINAL REPLACEMENT  
EXISTING GUARDRAIL AT ENTRANCE**

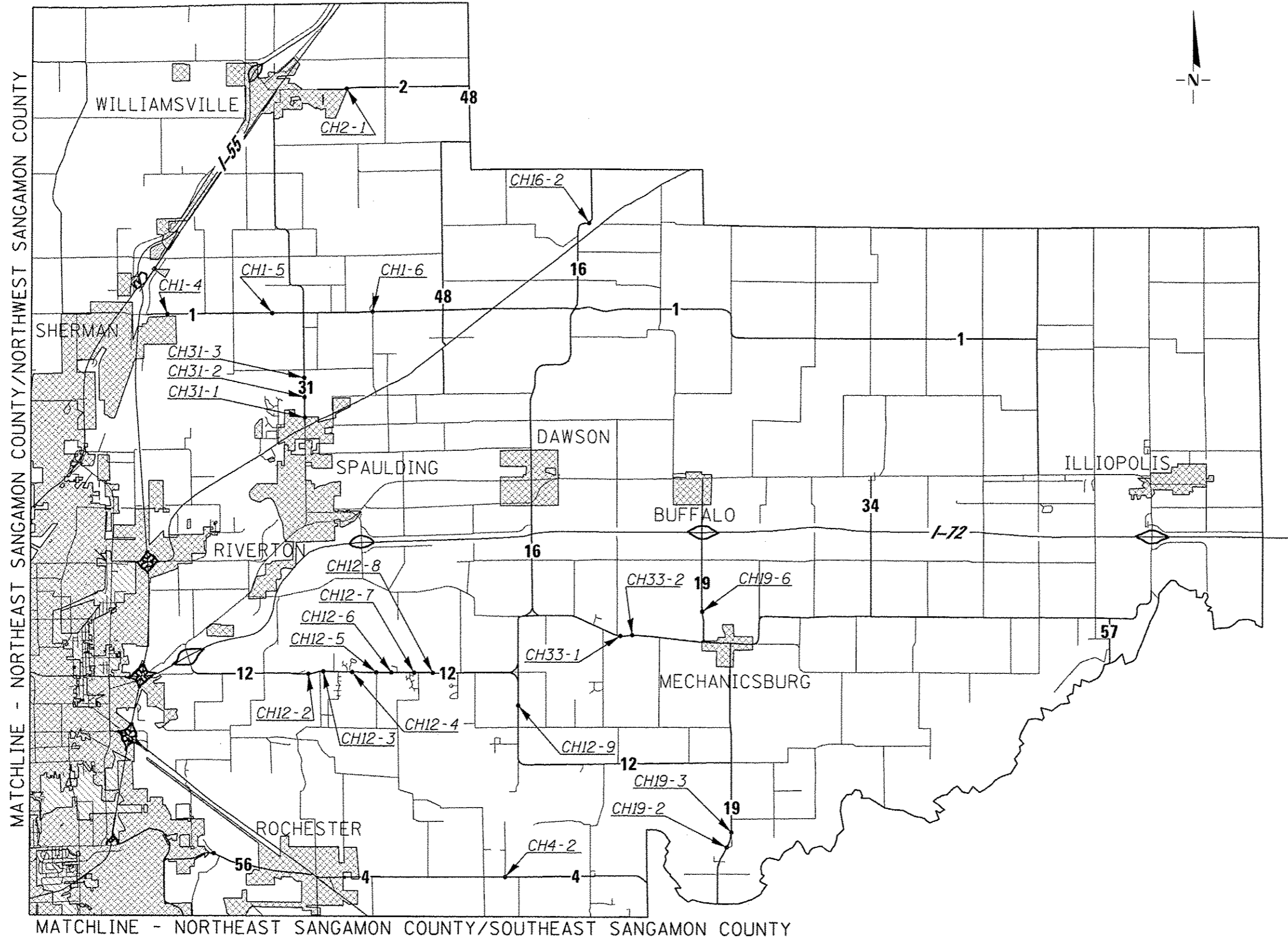

MATCHLINE - NORTHEAST SANGAMON COUNTY/NORTHWEST SANGAMON COUNTY

MATCHLINE - NORTHEAST SANGAMON COUNTY/SOUTHEAST SANGAMON COUNTY



JOB # 2435	DESIGNED -	REVISED -
FILE NAME = 2435 location map.dgn	DRAWN -	REVISED -
PLOT SCALE = 10000.0000' / in.	CHECKED -	REVISED -
PLOT DATE = 1/9/2017	DATE -	REVISED -

**SANGAMON COUNTY  
GUARDRAIL TERMINAL IMPROVEMENTS**

<b>LOCATION MAP NORTHEAST SANGAMON COUNTY</b>			
SCALE:	SHEET NO.	OF SHEETS	STA. TO STA.

F.A.S. RTE.	SECTION	COUNTY	TOTAL SHEETS	SHEET NO.
VARY	15-00175-00-SP	SANGAMON	15	5
FED. ROAD DIST. NO.			ILLINOIS FED. AID PROJECT	
			CONTRACT NO. 93696	

LOCATION			GUARDRAIL REMOVAL	TRAFFIC BARRIER TERMINAL TYPE 1 (SPECIAL) TANGENT	TRAFFIC BARRIER TERMINAL TYPE 1 (SPECIAL) FLARED	TRAFFIC BARRIER TERMINAL, TYPE 2	TERMINAL MARKER - DIRECT APPLIED	STEEL PLATE BEAM GUARDRAIL TYPE A 6' POSTS	VERTICAL ADJUSTMENT OF GUARDRAIL	EARTH EXCAVATION	FURNISHED EXCAVATION	SEEDING, CLASS 2 (SPECIAL)	PIPE CULVERTS, CLASS D, TYPE 1		PERIMETER EROSION BARRIER	TEMPROARY DITCH CHECK	INLET AND PIPE PROTECTION	AGGREGATE WEDGE SHOULDER, TYPE B	
ROUTE	NAME	QUADRANT	FOOT	EACH	EACH	EACH	EACH	FOOT	FOOT	CU YD	CU YD	ACRE	15"	18"	FOOT	FOOT	EACH	TON	
NORTHEAST SANGAMON COUNTY																			
CH1-4A	E Andrew Rd	NW	25	1			1	12.5			28	0.02			83				
CH1-4B	E Andrew Rd	NE	25	1			1	12.5			26	0.02			83				
CH1-4C	E Andrew Rd	SW	25	1			1	12.5			3	0.01			83				
CH1-4D	E Andrew Rd	SE	37.5		1 <sup>7</sup>		1	12.5			3	0.01			83				
CH1-5A	Sherman Rd	NW	37.5	1			1	12.5			33	0.02			83				
CH1-5B	Sherman Rd	NE	37.5	1			1	12.5			7	0.02			83				
CH1-5C	Sherman Rd	SW	37.5	1			1	12.5			22	0.02			83				
CH1-5D	Sherman Rd	SE	37.5	1			1	12.5			19	0.02			83				
CH1-6A	Sherman Rd	NW	37.5	1			1	12.5		4 <sup>4</sup>	21	0.02							
CH1-6B	Sherman Rd	NE	37.5	1			1	12.5			56	0.02	42			8		1	
CH1-6C	Sherman Rd	SW	37.5	1			1	12.5			47	0.02	44			8		1	
CH1-6D	Sherman Rd	SE	3 <sup>3</sup>	1			1	12.5			22	0.01			83				
CH 2-1A	E Main St	NW	50	1			1	12.5			15	0.02			75				
CH 2-1B	E Main St	NE	50	1			1	12.5			10	0.02			80				
CH 2-1C	E Main St	SW	50	1			1	12.5			11	0.02			81				
CH 2-1D	E Main St	SE	50	1			1	12.5			28	0.03			79				
CH4-2C	Buckhart Rd	SW	50	1			1	12.5		3 <sup>4</sup>	19	0.02				8			
CH4-2D	Buckhart Rd	SE	50	1			1	12.5			23	0.01	40 <sup>2</sup>			8			
CH12-2A	Mechanicsburg Rd	NW	50	1			1	12.5			2	0.01			83				
CH12-2B	Mechanicsburg Rd	NE	50	1			1	12.5			1								
CH12-2C	Mechanicsburg Rd	SW	50	1			1	12.5			1								
CH12-2D	Mechanicsburg Rd	SE	50	1			1	12.5			1								
CH12-3A	Mechanicsburg Rd	NW	50	1			1	12.5			16	0.04			83				
CH12-3B	Mechanicsburg Rd	NE	50	1			1	12.5		7 <sup>4</sup>	2	0.02				8			
CH12-4A	Mechanicsburg Rd	NW	50	1			1	12.5		20 <sup>4</sup>	13	0.02				8			
CH12-4B	Mechanicsburg Rd	NE	50	1			1	12.5		10 <sup>4</sup>	14	0.02				8			
CH12-5A	Mechanicsburg Rd	NW	50	1			1	12.5			1								
CH12-5A2	Mechanicsburg Rd	NE (ENTRANCE)	50	1			1	12.5			1								
CH12-5A3	Mechanicsburg Rd	NW (ENTRANCE)	50	1			1	12.5			1								
CH12-5B	Mechanicsburg Rd	NE	50	1			1	12.5			1								
CH12-5C	Mechanicsburg Rd	SW	50	1			1	12.5			8	0.01			59				
CH12-5D	Mechanicsburg Rd	SE	50		1		1	12.5			74	0.03	30					1	
CH12-6A	Mechanicsburg Rd	NW	50	1			1	12.5			1								
CH12-6B	Mechanicsburg Rd	NE	50	1			1	12.5			1								
CH12-6D	Mechanicsburg Rd	SE	50	1			1	12.5			1								
CH12-7A	Mechanicsburg Rd	NW	50	1			1	12.5			3	0.01			59				
CH12-7B	Mechanicsburg Rd	NE	50	1			1	12.5			33 <sup>8</sup>	0.02			83				
CH12-7C	Mechanicsburg Rd	SW	50	1			1	12.5			2	0.01			83				
CH12-7D	Mechanicsburg Rd	SE	50	1			1	12.5			3	0.01			59				
CH12-8A	Mechanicsburg Rd	NW	50	1			1	12.5			1								
CH12-8B	Mechanicsburg Rd	NE	37.5		1 <sup>7</sup>		1	12.5			2	0.01			59				
CH12-8C	Mechanicsburg Rd	SW	37.5	1			1	12.5			10 <sup>8</sup>	0.02			83				
CH12-8D	Mechanicsburg Rd	SE	37.5	1			1	12.5			2	0.01			83				
CH 56-1A	Rochester Rd	SW	50	1 <sup>7</sup>			1	12.5			1								
CH 56-1B	Rochester Rd	NW	25	1 <sup>7</sup>			1	12.5		2	40	0.02				8			
CH 56-1C	Rochester Rd	SE	50	1 <sup>7</sup>			1	12.5			1								
CH 56-1D	Rochester Rd	NE	25	1 <sup>7</sup>			1	12.5			1								
TOTAL THIS SHEET			2,037.5	44	3	0	47	0.0	587.5	46	617	0.59	0	116	1796	72	3	0	

CONTINUED ON NEXT SHEET

- NOTES
- |   |  |
|---|--|
| 1 NO SHOULDER WIDENING REQUIRED                                       | 7 REQUIRES 37'-6" TERMINAL   |
| 2 CONNECT TO EXISTING PIPE  | 8 CONSTRUCT 1:3 FRONT SLOPES   |
| 3 REMOVE END SHOE, INSTALL TYPE 1 TERMINAL ALONG SIDE ROAD            | 9 REMOVE END SHOE  |
| 4 REGRADE DITCH   | 10 REMOVE END SHOE, INSTALL 25' RADIUS GUARDRAIL AND TYPE 2 TERMINAL |
| 5 NO IMPROVEMENT. EXISTING TERMINAL TO REMAIN IN PLACE.               | 11 INSTALL STANDARD END SHOE - BACK SIDE OF RAIL                     |
| 6 REMOVE END SHOE, INSTALL 12.5' RADIUS GUARDRAIL AND TYPE 1 TERMINAL | 12 INSTALL GUARDRAIL AND TERMINAL 15' FROM CENTERLINE                |
|   | 13 12.5' RADIUS GUARDRAIL (15' R)                                    |



JOB # 2435	DESIGNED - NAK	REVISED -
FILE NAME = 2435-SHT-SCHEDULE.dgn	DRAWN - SJS	REVISED -
PLOT SCALE = 25.0000' / 1" =	CHECKED - NAK	REVISED -
PLOT DATE = 1/9/2017	DATE - 3/18/2016	REVISED -

**SANGAMON COUNTY  
GUARDRAIL TERMINAL IMPROVEMENTS**

SCHEDULE OF QUANTITIES			
NORTHEAST SANGAMON COUNTY			
SCALE:	SHEET NO.	OF SHEETS	STA. TO STA.

F.A.S. RTE.	SECTION	COUNTY	TOTAL SHEETS	SHEET NO.
VAR.	15-00175-00-SP	SANGAMON	15	6
CONTRACT NO. 93696				
FED. ROAD DIST. NO. ILLINOIS FED. AID PROJECT				

LOCATION			GUARDRAIL REMOVAL	TRAFFIC BARRIER TERMINAL TYPE 1 (SPECIAL) TANGENT	TRAFFIC BARRIER TERMINAL TYPE 1 (SPECIAL) FLARED	TRAFFIC BARRIER TERMINAL, TYPE 2	TERMINAL MARKER - DIRECT APPLIED	STEEL PLATE BEAM GUARDRAIL TYPE A 6' POSTS	VERTICAL ADJUSTMENT OF GUARDRAIL	EARTH EXCAVATION	FURNISHED EXCAVATION	SEEDING, CLASS 2 (SPECIAL)	PIPE CULVERTS, CLASS D, TYPE 1		PERIMETER EROSION BARRIER	TEMPROARY DITCH CHECK	INLET AND PIPE PROTECTION	AGGREGATE WEDGE SHOULDER, TYPE B
ROUTE	NAME	QUADRANT	FOOT	EACH	EACH	EACH	EACH	FOOT	FOOT	CU YD	CU YD	ACRE	15"	18"	FOOT	FOOT	EACH	TON
NORTHEAST SANGAMON COUNTY																		
CH12-9A	S Tower Rd	SW	25	1			1		12.5		44 <sup>8</sup>	0.02			83			
CH12-9B	S Tower Rd	NW	25	1			1		12.5		76 <sup>8</sup>	0.03			83			
CH12-9C	S Tower Rd	SE	25 <sup>10</sup>			1		37.5 <sup>13</sup>										
CH12-9D	S Tower Rd	NE	25	1			1		12.5		79	0.03			83			
CH16-2C	Buffalo Hart Rd	SE	50	1			1		12.5		1	0.01			59			
CH16-2D	Buffalo Hart Rd	NE	50	1			1		12.5		1	0.01			59			
CH19-2A	Roby Rd	SW	50	1			1		12.5		2	0.01			59			
CH19-2A2	Roby Rd	SW (ENTRANCE)	50	1			1		12.5		3	0.01			59			
CH19-2A3	Roby Rd	SW (ENTRANCE)	50	1			1		12.5		1	0.01			59			
CH19-2B	Roby Rd	NW	50	1			1		12.5		2	0.01			83			
CH19-2C	Roby Rd	SE	50	1			1		12.5		1							
CH19-2D	Roby Rd	NE	50	1			1		12.5		2	0.01			83			
CH19-3C	Roby Rd	SE	50	1			1		12.5		24	0.02			83			
CH19-3D	Roby Rd	NE	50	1			1		12.5		4	0.01			83			
CH19-6A	Buffalo Mechanicsburg Rd	SW	50	1			1		12.5		2	0.01			83			
CH19-6B	Buffalo Mechanicsburg Rd	NW	50	1			1		12.5		4	0.01			83			
CH19-6C	Buffalo Mechanicsburg Rd	SE	50	1			1		12.5		9	0.01			59			
CH19-6D	Buffalo Mechanicsburg Rd	NE	50	1			1		12.5		4	0.01			83			
CH31-1B	S Williamsville Rd	NW	50	1			1		12.5		1	0.01			83			
CH31-1B1	S Williamsville Rd	SW (ENTRANCE)	50	1			1		12.5		2	0.03			83			
CH31-1C	S Williamsville Rd	SE	50	1			1		12.5		1							
CH31-1C1	S Williamsville Rd	SE (ENTRANCE)	50	1			1		12.5		2	0.02			59			
CH31-1C2	S Williamsville Rd	NE (ENTRANCE)	50	1			1		12.5		1							
CH31-1D	S Williamsville Rd	NE	50	1			1		12.5		16	0.03			89			
CH31-2A	S Williamsville Rd	SW	50	1			1		12.5		46	0.04			83			
CH31-2B	S Williamsville Rd	NW	50	1			1		12.5		40	0.05			83			
CH31-2C	S Williamsville Rd	SE	50	1			1		12.5		59	0.06			83			
CH31-2D	S Williamsville Rd	NE	50	1			1		12.5	11 <sup>4</sup>	137	0.07				8		
CH31-3A	S Williamsville Rd	SW	50	1			1		12.5		1							
CH31-3B	S Williamsville Rd	NW	50	1			1		12.5		11	0.02			83			
CH31-3C	S Williamsville Rd	SE	50	1			1		12.5		3	0.02			83			
CH31-3D	S Williamsville Rd	NE	50	1			1		12.5		162	0.06		54		8	1	
CH33-1A	Mechanicsburg Blacktop	NW	50	1			1		12.5		79 <sup>8</sup>	0.02			83			
CH33-1B	Mechanicsburg Blacktop	NE	50	1			1		12.5		33	0.02			83			
CH33-1C	Mechanicsburg Blacktop	SW	50	1			1		12.5		59	0.02			83			
CH33-1D	Mechanicsburg Blacktop	SE	50	1			1		12.5		42	0.02			83			
CH33-2A	Mechanicsburg Blacktop	NW	50	1			1		12.5		3	0.01			83			
CH33-2B	Mechanicsburg Blacktop	NE	50	1			1		12.5		3	0.01			83			
CH33-2B2	Mechanicsburg Blacktop	NW (ENTRANCE)	50	1			1		12.5		2	0.01			83			
CH33-2B3	Mechanicsburg Blacktop	NE (ENTRANCE)	50	1			1		12.5		2	0.01			83			
CH33-2C	Mechanicsburg Blacktop	SW	50	1			1		12.5		4	0.02			83			
CH33-2D	Mechanicsburg Blacktop	SE	50	1			1		12.5		4	0.01			83			
TOTAL THIS SHEET			2000.0	41	0	1	41	37.5	512.5	11	968	0.78	0	54	2,743	16	1	0
NORTHEAST SANGAMON COUNTY TOTAL			4037.5	85	3	1	88	37.5	1100.0	57	1,585	1.37	0	170	9,078	88	4	0

NOTES

- |   |  |
|---|--|
| 1 NO SHOULDER WIDENING REQUIRED                                       | 7 REQUIRES 37'-6" TERMINAL   |
| 2 CONNECT TO EXISTING PIPE  | 8 CONSTRUCT 1:3 FRONT SLOPES   |
| 3 REMOVE END SHOE, INSTALL TYPE 1 TERMINAL ALONG SIDE ROAD            | 9 REMOVE END SHOE  |
| 4 REGRADE DITCH   | 10 REMOVE END SHOE, INSTALL 25' RADIUS GUARDRAIL AND TYPE 2 TERMINAL |
| 5 NO IMPROVEMENT. EXISTING TERMINAL TO REMAIN IN PLACE.               | 11 INSTALL STANDARD END SHOE - BACK SIDE OF RAIL                     |
| 6 REMOVE END SHOE, INSTALL 12.5' RADIUS GUARDRAIL AND TYPE 1 TERMINAL | 12 INSTALL GUARDRAIL AND TERMINAL 15' FROM CENTERLINE                |
|   | 13 12.5' RADIUS GUARDRAIL (15' R)                                    |



JOB # 2435  
 FILE NAME = 2435-SHT-SCHEDULE.dgn  
 PLOT SCALE = 25.0000 1/1 in.  
 PLOT DATE = 1/9/2017

DESIGNED - NAK  
 DRAWN - SJS  
 CHECKED - NAK  
 DATE - 3/18/2016

REVISED -  
 REVISED -  
 REVISED -  
 REVISED -

SANGAMON COUNTY  
 GUARDRAIL TERMINAL IMPROVEMENTS

SCHEDULE OF QUANTITIES NORTHEAST SANGAMON COUNTY			
SCALE:	SHEET NO.	OF SHEETS	STA. TO STA.

F.A.S. RTE.	SECTION	COUNTY	TOTAL SHEETS	SHEET NO.
VAR.	15-00175-00-SP	SANGAMON	15	7
CONTRACT NO. 93696				

FED. ROAD DIST. NO. ILLINOIS FED. AID PROJECT

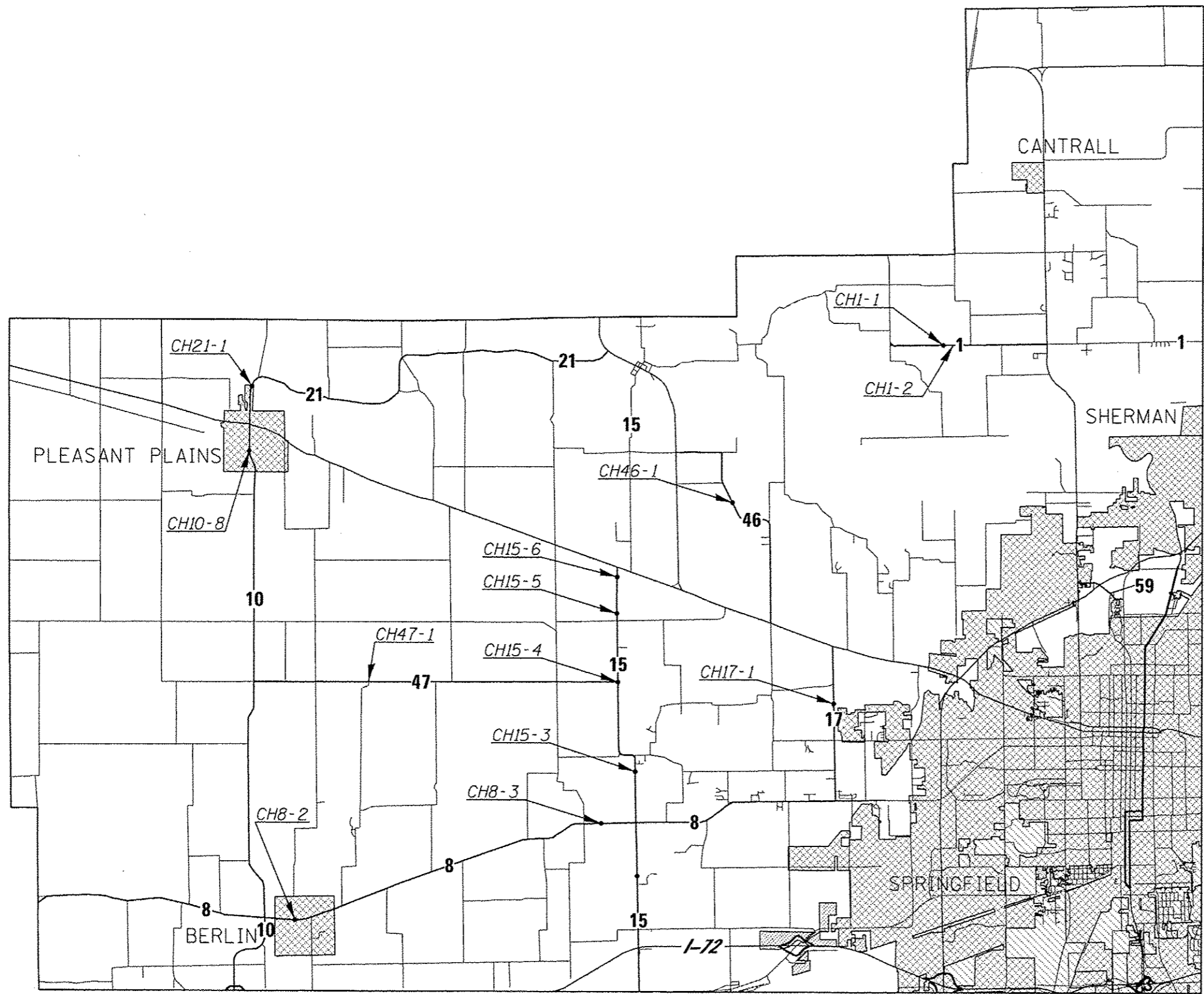

MATCHLINE - NORTHWEST SANGAMON COUNTY/SOUTHWEST SANGAMON COUNTY

MATCHLINE NORTHWEST SANGAMON COUNTY/NORTHEAST SANGAMON COUNTY

**CEC** Cummins  
Engineering  
Corporation  
Civil and Structural Engineering

JOB # 2435  
FILE NAME = 2435 location map.dgn  
PLOT SCALE = 10000.0000' / 1" =  
PLOT DATE = 1/9/2017

DESIGNED -  
DRAWN -  
CHECKED -  
DATE -

REVISED -  
REVISED -  
REVISED -  
REVISED -

**SANGAMON COUNTY  
GUARDRAIL TERMINAL IMPROVEMENTS**

**LOCATION MAP  
NORTHWEST SANGAMON COUNTY**

SCALE: SHEET NO. OF SHEETS STA. TO STA.

F.A.S. RTE.	SECTION	COUNTY	TOTAL SHEETS	SHEET NO.
VARY	15-00175-00-SP	SANGAMON	15	B
FED. ROAD DIST. NO.		ILLINOIS FED. AID PROJECT		
		CONTRACT NO. 93696		



LOCATION			GUARDRAIL REMOVAL	TRAFFIC BARRIER TERMINAL TYPE 1 (SPECIAL) TANGENT	TRAFFIC BARRIER TERMINAL TYPE 1 (SPECIAL) FLARED	TRAFFIC BARRIER TERMINAL, TYPE 2	TERMINAL MARKER - DIRECT APPLIED	STEEL PLATE BEAM GUARDRAIL TYPE A 6' POSTS	VERTICAL ADJUSTMENT OF GUARDRAIL	EARTH EXCAVATION	FURNISHED EXCAVATION	SEEDING, CLASS 2 (SPECIAL)	PIPE CULVERTS, CLASS D, TYPE 1		PERIMETER EROSION BARRIER	TEMPROARY DITCH CHECK	INLET AND PIPE PROTECTION	AGGREGATE WEDGE SHOULDER, TYPE B	
ROUTE	NAME	QUADRANT	FOOT	EACH	EACH	EACH	EACH	FOOT	FOOT	CU YD	CU YD	ACRE	15"	18"	FOOT	FOOT	EACH	TON	
NORTHWEST SANGAMON COUNTY																			
CH1-1A	Cantrall Creek Rd	NW	50	1			1		12.5		1	0.01			83				
CH1-1B	Cantrall Creek Rd	NE	50	1			1		12.5		53	0.04			83				
CH1-1C	Cantrall Creek Rd	SW	50	1			1		12.5		2	0.01			83				
CH1-1D	Cantrall Creek Rd	SE	50	1			1		12.5		55	0.03			83				
CH1-2A	Cantrall Creek Rd	NW	50	1			1		12.5		3	0.01			59				
CH1-2B	Cantrall Creek Rd	NE	50	1			1		12.5		1	0.01			58				
CH1-2C	Cantrall Creek Rd	SW	50	1			1		12.5		2	0.01			83				
CH1-2D	Cantrall Creek Rd	SE	50	1			1		12.5		1								
CH8-2C	Old Jacksonville Rd	SW	50	1			1		12.5		1								
CH8-2D	Old Jacksonville Rd	SE	50	1			1		12.5		1								
CH8-3A	Old Jacksonville Rd	NW	50	1			1		12.5		45	0.03			83				
CH8-3B	Old Jacksonville Rd	NE	25	1			1		12.5		25	0.03			83				
CH8-3C	Old Jacksonville Rd	SW	50	1			1		12.5		28	0.03			83				
CH8-3D	Old Jacksonville Rd	SE	25	1			1		12.5		46	0.03			83				
CH10-8C	Pleasant Plains Rd	SW	25	1			1		12.5		2	0.01			83				
CH15-3A	S Farmingdale Rd	SW	50	1			1		12.5		1								
CH15-3B	S Farmingdale Rd	NW	50	1			1		12.5		1								
CH15-3C	S Farmingdale Rd	SE	50	1			1		12.5		1								
CH15-3D	S Farmingdale Rd	NE	50	1			1		12.5		1								
CH15-4A	N Farmingdale Rd	SW	50	1			1		12.5		1								
CH15-5A	N Farmingdale Rd	SW	50	1			1		12.5		3	0.01			83				
CH15-5B	N Farmingdale Rd	NW	50	1			1		12.5		1								
CH15-5C	N Farmingdale Rd	SE	50	1			1		12.5		3	0.01			59				
CH15-5D	N Farmingdale Rd	NE	50	1			1		12.5		24	0.02			83				
CH15-6C	N Farmingdale Rd	SE	50	1			1		12.5		2	0.01			59				
CH15-6D	N Farmingdale Rd	NE	50	1			1		12.5		8	0.01			59				
CH17-1A	Bradfordton Rd	SW	50	1			1		12.5		1	0.01			83				
CH17-1B	Bradfordton Rd	NW	50	1			1		12.5										
CH17-1C	Bradfordton Rd	SE	50	1			1		12.5		7	0.01			83				
CH17-1D	Bradfordton Rd	NE	50	1			1		12.5		11	0.02			83				
CH21-1A	Salisbury Rd	SW	37.5	1			1		12.5		1								
CH21-1B	Salisbury Rd	NW	50	1			1		12.5		1								
CH21-1C	Salisbury Rd	SE	50	1			1		12.5		6	0.02			83				
CH21-1D	Salisbury Rd	NE	37.5	1			1		12.5		14	0.02			83				
CH46-1A	N Lincoln Trail	SW	5																
CH46-1B	N Lincoln Trail	NW	50	1			1		12.5		15	0.01			83				
CH46-1C	N Lincoln Trail	SE	5																
CH46-1C <sub>1</sub>	N Lincoln Trail	NE (ENTRANCE)	50	1			1		12.5		16	0.01			83				
CH46-1C <sub>2</sub>	N Lincoln Trail	SE (ENTRANCE)	50	1			1		12.5		27	0.01			83				
CH46-1D	N Lincoln Trail	NE	50	1			1		12.5		24	0.01			83				
CH47-1B	Prairie Creek Rd	NW	50	1			1		12.5		10	0.01			83				
CH47-1C	Prairie Creek Rd	SE	50	1			1		12.5		2	0.01			83				
NORTHWEST SANGAMON COUNTY TOTAL			1,850.0	40	0	0	40	0.0	500.0	0	436	0.45	0	0	2,203	0	0	0	

NOTES

- |   |  |
|---|--|
| 1 NO SHOULDER WIDENING REQUIRED                                       | 7 REQUIRES 37'-6" TERMINAL   |
| 2 CONNECT TO EXISTING PIPE  | 8 CONSTRUCT 1:3 FRONT SLOPES   |
| 3 REMOVE END SHOE, INSTALL TYPE 1 TERMINAL ALONG SIDE ROAD            | 9 REMOVE END SHOE  |
| 4 REGRADE DITCH   | 10 REMOVE END SHOE, INSTALL 25' RADIUS GUARDRAIL AND TYPE 2 TERMINAL |
| 5 NO IMPROVEMENT. EXISTING TERMINAL TO REMAIN IN PLACE.               | 11 INSTALL STANDARD END SHOE - BACK SIDE OF RAIL                     |
| 6 REMOVE END SHOE, INSTALL 12.5' RADIUS GUARDRAIL AND TYPE 1 TERMINAL | 12 INSTALL GUARDRAIL AND TERMINAL 15' FROM CENTERLINE                |
|   | 13 12.5' RADIUS GUARDRAIL (15' R)                                    |



JOB # 2435  
 FILE NAME = 2435-SHT-SCHEDULE.dgn  
 PLOT SCALE = 25.0000' / 1" =  
 PLOT DATE = 1/9/2017

DESIGNED - NAK  
 DRAWN - SJS  
 CHECKED - NAK  
 DATE - 3/18/2016

REVISED -  
 REVISED -  
 REVISED -  
 REVISED -

SANGAMON COUNTY  
 GUARDRAIL TERMINAL IMPROVEMENTS

SCHEDULE OF QUANTITIES  
 NORTHWEST SANGAMON COUNTY

SCALE: SHEET NO. OF SHEETS STA. TO STA.

F.A.S. RTE.	SECTION	COUNTY	TOTAL SHEETS	SHEET NO.
VAR.	15-00175-00-SP	SANGAMON	15	9
CONTRACT NO. 93696				
FED. ROAD DIST. NO. ILLINOIS FED. AID PROJECT				

MATCHLINE - SOUTHWEST SANGAMON COUNTY/NORTHWEST SANGAMON COUNTY

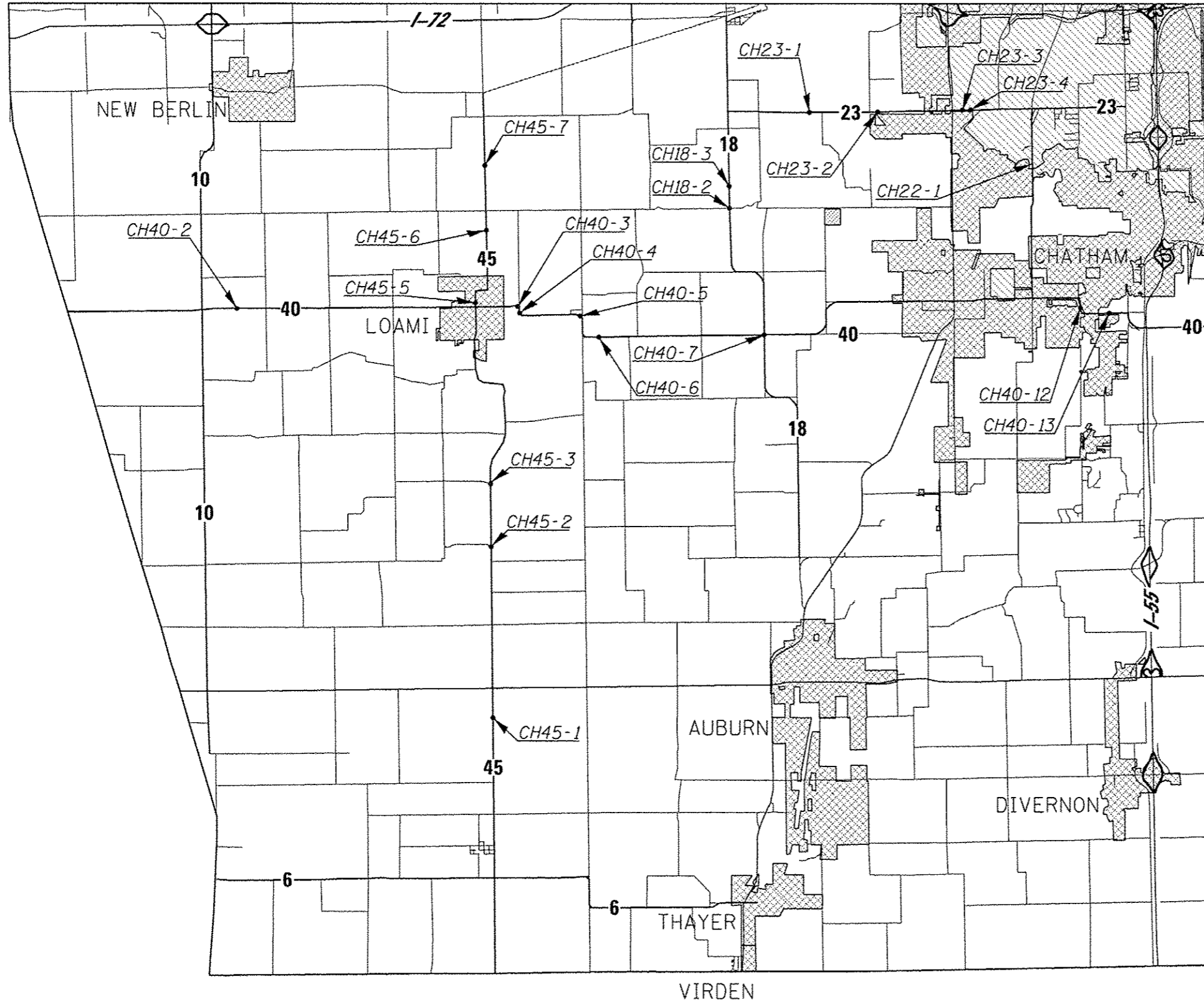

MATCHLINE - SOUTHWEST SANGAMON COUNTY/SOUTHEAST SANGAMON COUNTY

**CEC** Cummins  
Engineering  
Corporation  
Civil and Structural Engineering

JOB # 2435  
FILE NAME = 2435 location map.dgn  
PLOT SCALE = 1/8000.0000" / 1" =  
PLOT DATE = 1/9/2017

DESIGNED -  
DRAWN -  
CHECKED -  
DATE -

REVISED -  
REVISED -  
REVISED -  
REVISED -

**SANGAMON COUNTY  
GUARDRAIL TERMINAL IMPROVEMENTS**

**LOCATION MAP  
SOUTHWEST SANGAMON COUNTY**  
SCALE: SHEET NO. OF SHEETS STA. TO STA.

F.A.S. RTE.	SECTION	COUNTY	TOTAL SHEETS	SHEET NO.
VARY	15-00175-00-SP	SANGAMON	15	10
FED. ROAD DIST. NO. ILLINOIS FED. AID PROJECT			CONTRACT NO. 93696	

LOCATION			GUARDRAIL REMOVAL	TRAFFIC BARRIER TERMINAL TYPE 1 (SPECIAL) TANGENT	TRAFFIC BARRIER TERMINAL TYPE 1 (SPECIAL) FLARED	TRAFFIC BARRIER TERMINAL, TYPE 2	TERMINAL MARKER - DIRECT APPLIED	STEEL PLATE BEAM GUARDRAIL TYPE A 6' POSTS	VERTICAL ADJUSTMENT OF GUARDRAIL	EARTH EXCAVATION	FURNISHED EXCAVATION	SEEDING, CLASS 2 (SPECIAL)	PIPE CULVERTS, CLASS D, TYPE 1		PERIMETER EROSION BARRIER	TEMPORARY DITCH CHECK	INLET AND PIPE PROTECTION	AGGREGATE WEDGE SHOULDER, TYPE B	
ROUTE	NAME	QUADRANT	FOOT	EACH	EACH	EACH	EACH	FOOT	FOOT	CU YD	CU YD	ACRE	15'	18'	FOOT	FOOT	EACH	TON	
SOUTHWEST SANGAMON COUNTY																			
CH18-2A	Curran Rd	SW	50	1			1		12.5		57	0.03			83				
CH18-2A1	Curran Rd	SW (ENTRANCE)	50	1			1		12.5		4	0.01			59				
CH18-2B	Curran Rd	NW	50	1			1		12.5		7	0.01			59				
CH18-2B1	Curran Rd	NW (ENTRANCE)	50	1			1		12.5		11	0.02			59				
CH18-2C	Curran Rd	SE	50	1			1		12.5		10	0.02			83				
CH18-2C1	Curran Rd	SE (ENTRANCE)	50	1			1		12.5		1	0.01			59				
CH18-2D	Curran Rd	NE	50	1			1		12.5		20	0.02			83				
CH18-2D1	Curran Rd	NE (ENTRANCE)	50	1			1		12.5		7	0.01			59				
CH18-3B	Curran Rd	NW	25	1			1		12.5		79 <sup>b</sup>	0.03	46			8		1	
CH18-3C	Curran Rd	SE	25	1			1		12.5		56 <sup>b</sup>	0.03			83				
CH22-1A	Iron Bridge Rd	SW	50	1			1		12.5		1								
CH22-1B	Iron Bridge Rd	NW	50	1			1		12.5		4	0.01			83				
CH22-1C	Iron Bridge Rd	SE	5 <sup>s</sup>																
CH22-1D	Iron Bridge Rd	NE	50	1			1		12.5		3	0.01			83				
CH23-1A	Spaulding Orchard Rd	NW	50	1			1		12.5		79 <sup>b</sup>	0.02			83				
CH23-1B	Spaulding Orchard Rd	NE	50	1			1		12.5		5	0.02			83				
CH23-1C	Spaulding Orchard Rd	SW	50	1			1		12.5		26	0.02			83				
CH23-1D	Spaulding Orchard Rd	SE	50	1			1		12.5		38	0.02			83				
CH23-2A	Spaulding Orchard Rd	NW	50	1			1		12.5		8	0.02			83				
CH23-2B	Spaulding Orchard Rd	NE	50	1			1		12.5		4	0.01			83				
CH23-2C	Spaulding Orchard Rd	SW	50	1			1		12.5		4	0.01			83				
CH23-2D	Spaulding Orchard Rd	SE	50	1			1		12.5		9	0.01			59				
CH23-3A	Spaulding Orchard Rd	NW	50	1			1		12.5		19 <sup>b</sup>	0.02			83				
CH23-3B	Spaulding Orchard Rd	NE	50	1			1		12.5		26 <sup>b</sup>	0.02			83				
CH23-3C	Spaulding Orchard Rd	SW	50	1			1		12.5		19 <sup>b</sup>	0.02			83				
CH23-3D	Spaulding Orchard Rd	SE	50	1			1		12.5		48 <sup>b</sup>	0.03			83				
CH23-4A	Spaulding Orchard Rd	NW	50	1			1		12.5		11	0.02			83				
CH23-4B	Spaulding Orchard Rd	NE	50	1			1		12.5		56 <sup>b</sup>	0.04			83				
CH23-4C	Spaulding Orchard Rd	SW	50	1			1		12.5		4	0.01			83				
CH23-4D	Spaulding Orchard Rd	SE	50	1			1		12.5		26 <sup>b</sup>	0.03			83				
CH40-2A	W Loami Rd	NW		1 <sup>a</sup>			1		12.5	1 <sup>d</sup>	26	0.02			83	8			
CH40-2B	W Loami Rd	NE	25	1			1		12.5		12	0.02			83				
CH40-2C	W Loami Rd	SW	25	1			1		12.5		7	0.02			83				
CH40-2D	W Loami Rd	SE		1 <sup>a</sup>			1		12.5	2 <sup>d</sup>	26	0.02			83	8			
CH40-3A	E Loami Rd	NW	50	1			1		12.5		33	0.01	60			8		1	
CH40-3B	E Loami Rd	NE	62.5	1			1		12.5		2	0.01			83				
CH40-3C	E Loami Rd	SW	50	1			1		12.5		19	0.01	60			8		1	
CH40-3D	E Loami Rd	SE	50	1			1		12.5		13	0.01				8			
CH40-4C	E Loami Rd	SW	50	1			1		12.5	3 <sup>d</sup>	12	0.03			83				
CH40-4D	E Loami Rd	SE	50	1			1		12.5		10	0.02			83				
CH40-5A	E Loami Rd	NW	50	1			1		12.5		2	0.01			83				
TOTAL THIS SHEET			1,812.5	40	0	0	40	0.0	500.0	6	803	0.71	0	166	2,761	48	3	0	

CONTINUED ON NEXT SHEET

NOTES

- 1 NO SHOULDER WIDENING REQUIRED
- 2 CONNECT TO EXISTING PIPE
- 3 REMOVE END SHOE, INSTALL TYPE 1 TERMINAL ALONG SIDE ROAD
- 4 REGRADE DITCH
- 5 NO IMPROVEMENT. EXISTING TERMINAL TO REMAIN IN PLACE.
- 6 REMOVE END SHOE, INSTALL 12.5' RADIUS GUARDRAIL AND TYPE 1 TERMINAL
- 7 REQUIRES 37'-6" TERMINAL
- 8 CONSTRUCT 1:3 FRONT SLOPES
- 9 REMOVE END SHOE
- 10 REMOVE END SHOE, INSTALL 25' RADIUS GUARDRAIL AND TYPE 2 TERMINAL
- 11 INSTALL STANDARD END SHOE - BACK SIDE OF RAIL
- 12 INSTALL GUARDRAIL AND TERMINAL 15' FROM CENTERLINE
- 13 12.5' RADIUS GUARDRAIL (15' R)



JOB # 2435  
 FILE NAME = 2435-SHT-SCHEDULE.dgn  
 PLOT SCALE = 25.0000' = 1" = 10'  
 PLOT DATE = 1/9/2017

DESIGNED - NAK  
 DRAWN - SJS  
 CHECKED - NAK  
 DATE - 3/18/2016

REVISED -  
 REVISED -  
 REVISED -  
 REVISED -

SANGAMON COUNTY  
 GUARDRAIL TERMINAL IMPROVEMENTS

SCHEDULE OF QUANTITIES  
 SOUTHWEST SANGAMON COUNTY

SCALE: SHEET NO. OF SHEETS STA. TO STA.

F.A.S. RTE.	SECTION	COUNTY	TOTAL SHEETS	SHEET NO.
VAR.	15-00175-00-SP	SANGAMON	15	11
FED. ROAD DIST. NO.		ILLINOIS FED. AID PROJECT		
		CONTRACT NO. 93696		

LOCATION	GUARDRAIL REMOVAL	TRAFFIC BARRIER TERMINAL TYPE 1 (SPECIAL) TANGENT	TRAFFIC BARRIER TERMINAL TYPE 1 (SPECIAL) FLARED	TRAFFIC BARRIER TERMINAL, TYPE 2	TERMINAL MARKER - DIRECT APPLIED	STEEL PLATE BEAM GUARDRAIL TYPE A 6' POSTS	VERTICAL ADJUSTMENT OF GUARDRAIL	EARTH EXCAVATION	FURNISHED EXCAVATION	SEEDING, CLASS 2 (SPECIAL)	PIPE CULVERTS, CLASS D, TYPE 1		PERIMETER EROSION BARRIER	TEMPROARY DITCH CHECK	INLET AND PIPE PROTECTION	AGGREGATE WEDGE SHOULDER, TYPE B		
											15"	18"						
ROUTE	NAME	QUADRANT	FOOT	EACH	EACH	EACH	FOOT	FOOT	CU YD	CU YD	ACRE	FOOT	FOOT	EACH	TON			
SOUTHWEST SANGAMON COUNTY																		
CH40-5B	E Loami Rd	NE	50	1			12.5		18	0.01			83					
CH40-5C	E Loami Rd	SW	50	1			12.5		32	0.01			83					
CH40-5D	E Loami Rd	SE	50	1			12.5		23	0.01			83					
CH40-6B	E Loami Rd	NE	5															
CH40-6C	E Loami Rd	SW	25	1			12.5	10 <sup>4</sup>	12	0.03			8					
CH40-6D	E Loami Rd	SE	5															
CH40-7A	W Walnut St	NW	62.5	1			12.5		3	0.01			83					
CH40-12D	Chatham Rd	SE	50 <sup>11</sup>	1			12.5		1									
CH40-13A	Chatham Rd	NW	50	1			12.5		2	0.01			83					
CH40-13B	Chatham Rd	NE	50	1			12.5		1									
SOUTHWEST SANGAMON COUNTY TOTAL																		
CH45-1A	Lowder Rd	SW	25	1			12.5		7	0.02			83					
CH45-1B	Lowder Rd	NW	5															
CH45-1C	Lowder Rd	SE	25	1			12.5		22	0.02		52	83					
CH45-1D	Lowder Rd	NE	25	1			12.5		3	0.02			83					
CH45-2A	Johns Creek Rd	SW	5	1			12.5 (23' R)											
CH45-2B	Johns Creek Rd	NW	25	1			12.5		12	0.02			83					
CH45-2C	Johns Creek Rd	SE	25	1			12.5		37	0.03			83					
CH45-2D	Johns Creek Rd	NE	25	1			12.5		11	0.03			83					
CH45-3A	Johns Creek Rd	SW	25	1			12.5		54	0.03			83					
CH45-3B	Johns Creek Rd	NW	25 <sup>10</sup>			1	25 <sup>13</sup>											
CH45-3C	Johns Creek Rd	SE	25	1			12.5		18	0.03			83					
CH45-3D	Johns Creek Rd	NE	25	1			12.5		4	0.01			83					
CH45-5C	N Main St	SE		1 <sup>7</sup>			12.5											
CH45-5D	N Main St	NE	50	1 <sup>7</sup>			12.5											
CH45-6A	Loami Bates Rd	SW	25	1			12.5	2 <sup>4</sup>	2	0.01			8					
CH45-6B	Loami Bates Rd	NW	25	1 <sup>7</sup>			12.5		9	0.01	38		8					
CH45-6C	Loami Bates Rd	SE	25	1			12.5	15 <sup>4</sup>	10	0.02			8					
CH45-6D	Loami Bates Rd	NE	25	1			12.5	3 <sup>4</sup>	10	0.02			8					
CH45-7A	Loami Bates Rd	SW	50	1			12.5	2 <sup>4</sup>	15	0.02			8					
CH45-7A1	Loami Bates Rd	SW (ENTRANCE)	5															
CH45-7B	Loami Bates Rd	NW	50	1			12.5		22	0.01		48	8	1				
CH45-7B1	Loami Bates Rd	NW (ENTRANCE)	5															
CH45-7C	Loami Bates Rd	SE	50	1			12.5	2 <sup>4</sup>	9	0.02			8					
CH45-7C1	Loami Bates Rd	SE (ENTRANCE)	5															
CH45-7D	Loami Bates Rd	NE	50	1			12.5	14 <sup>4</sup>	14	0.02			8					
CH45-7D1	Loami Bates Rd	NE (ENTRANCE)	5															
TOTAL THIS SHEET			987.5	28	0	1	28	37.5	350.0	48	349	0.42	38	100	1,162	72	1	0
SOUTHWEST SANGAMON COUNTY TOTAL			2,800.0	68	0	1	68	37.5	850.0	54	1,152	1.13	38	266	3,923	120	4	0

NOTES

- 1 NO SHOULDER WIDENING REQUIRED
- 2 CONNECT TO EXISTING PIPE
- 3 REMOVE END SHOE, INSTALL TYPE 1 TERMINAL ALONG SIDE ROAD
- 4 REGRADE DITCH
- 5 NO IMPROVEMENT. EXISTING TERMINAL TO REMAIN IN PLACE.
- 6 REMOVE END SHOE, INSTALL 12.5' RADIUS GUARDRAIL AND TYPE 1 TERMINAL
- 7 REQUIRES 37-6" TERMINAL
- 8 CONSTRUCT 1:3 FRONT SLOPES
- 9 REMOVE END SHOE
- 10 REMOVE END SHOE, INSTALL 25' RADIUS GUARDRAIL AND TYPE 2 TERMINAL
- 11 INSTALL STANDARD END SHOE - BACK SIDE OF RAIL
- 12 INSTALL GUARDRAIL AND TERMINAL 15' FROM CENTERLINE
- 13 12.5' RADIUS GUARDRAIL (15' R)



JOB # 2435  
 FILE NAME = 2435-SHT-SCHEDULE.dgn  
 PLOT SCALE = 25,000 / 1" = 1/4"  
 PLOT DATE = 1/9/2017

DESIGNED - NAK  
 DRAWN - SJS  
 CHECKED - NAK  
 DATE - 3/18/2016

REVISED -  
 REVISED -  
 REVISED -

SANGAMON COUNTY  
 GUARDRAIL TERMINAL IMPROVEMENTS

SCHEDULE OF QUANTITIES  
 SOUTHWEST SANGAMON COUNTY

SCALE: SHEET NO. OF SHEETS STA. TO STA.

F.A.S. RTE.	SECTION	COUNTY	TOTAL SHEETS	SHEET NO.
VAR.	15-00175-00-SP	SANGAMON	15	12
CONTRACT NO. 93696				
FED. ROAD DIST. NO. ILLINOIS FED. AID PROJECT				

MATCHLINE - SOUTHEAST SANGAMON COUNTY/NORTHEAST SANGAMON COUNTY

MATCHLINE - SOUTHWEST SANGAMON COUNTY/SOUTHWEST SANGAMON COUNTY

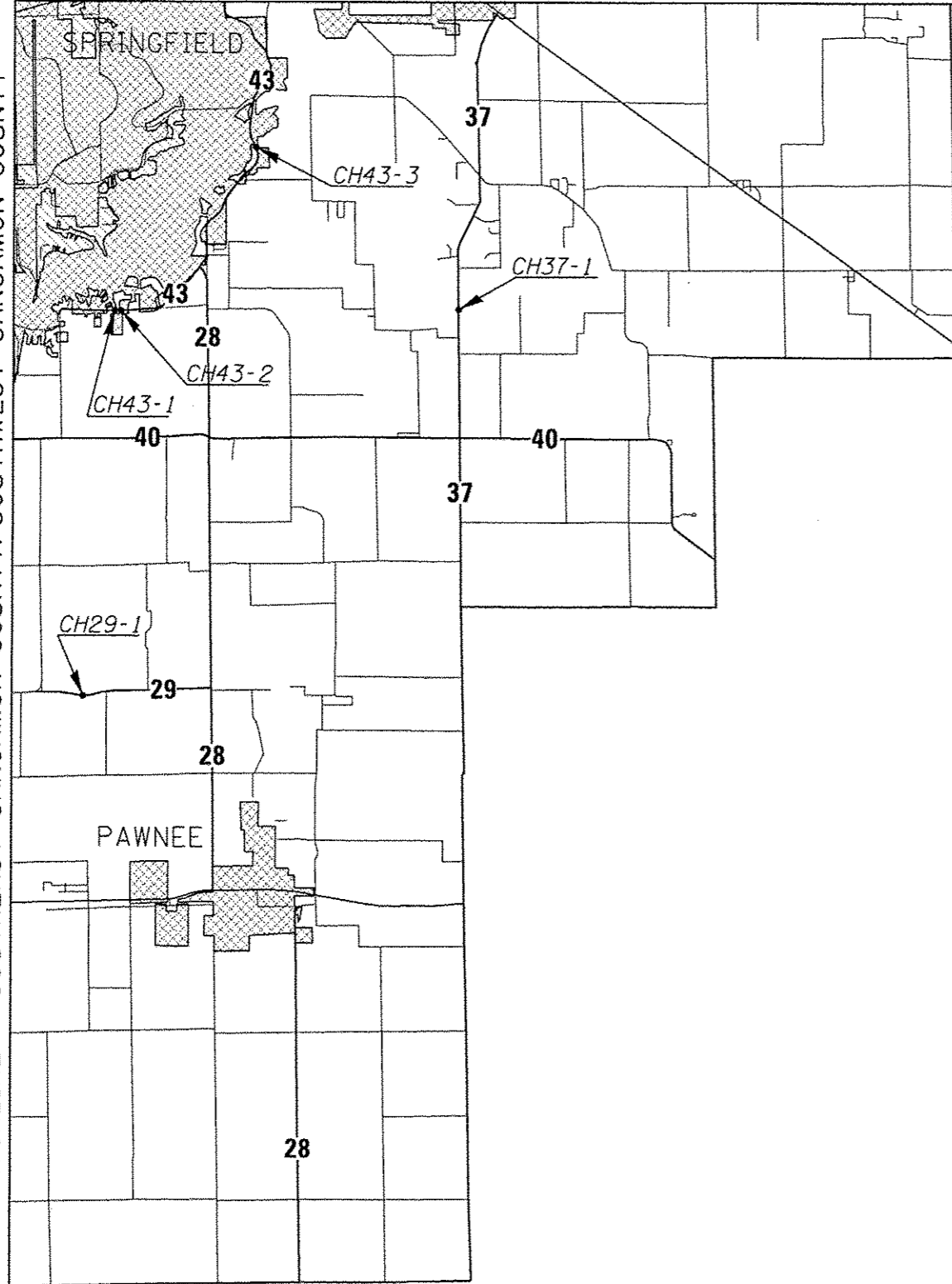

**CEC** Cummins  
Engineering  
Corporation  
Civil and Structural Engineering

JOB # 2435  
FILE NAME # 2435 location map.dgn  
PLOT SCALE # 10000.0000 ' / in.  
PLOT DATE # 1/9/2017

DESIGNED -  
DRAWN -  
CHECKED -  
DATE -

REVISED -  
REVISED -  
REVISED -  
REVISED -

**SANGAMON COUNTY  
GUARDRAIL TERMINAL IMPROVEMENTS**

**LOCATION MAP  
SOUTHEAST SANGAMON COUNTY**

SCALE: SHEET NO. OF SHEETS STA. TO STA.

F.A.S. RTE.	SECTION	COUNTY	TOTAL SHEETS	SHEET NO.
VARY	15-00175-00-SP	SANGAMON	15	13
FED. ROAD DIST. NO.		ILLINOIS FED. AID PROJECT		
		CONTRACT NO. 93696		

LOCATION			GUARDRAIL REMOVAL	TRAFFIC BARRIER TERMINAL TYPE 1 (SPECIAL) TANGENT	TRAFFIC BARRIER TERMINAL TYPE 1 (SPECIAL) FLARED	TRAFFIC BARRIER TERMINAL, TYPE 2	TERMINAL MARKER - DIRECT APPLIED	STEEL PLATE BEAM GUARDRAIL TYPE A 6' POSTS	VERTICAL ADJUSTMENT OF GUARDRAIL	EARTH EXCAVATION	FURNISHED EXCAVATION	SEEDING, CLASS 2 (SPECIAL)	PIPE CULVERTS, CLASS D, TYPE 1		PERIMETER EROSION BARRIER	TEMPROARY DITCH CHECK	INLET AND PIPE PROTECTION	AGGREGATE WEDGE SHOULDER, TYPE B
ROUTE	NAME	QUADRANT	FOOT	EACH	EACH	EACH	EACH	FOOT	FOOT	CU YD	CU YD	ACRE	15"	18"	FOOT	FOOT	EACH	TON
SOUTHEAST SANGAMON COUNTY																		
CH29-1C	E Glenarm Rd	SW	81	1 <sup>12</sup>			1	62.5		5 <sup>4</sup>	18	0.03				8		28
CH29-1D	E Glenarm Rd	SE	81	1 <sup>12</sup>			1		12.5		71	0.04			83			25
CH37-1A	Rochester New City Rd	SW	25		1 <sup>7</sup>		1		12.5		1							
CH37-1B	Rochester New City Rd	NW	25		1 <sup>7</sup>		1		12.5		1							
CH37-1C	Rochester New City Rd	SE	25	1			1		12.5		4	0.01			83			
CH37-1D	Rochester New City Rd	NE	25	1			1		12.5		2	0.01			83			
CH43-1A	East Lake Shore Dr	NW	50	1			1		12.5		14	0.02			83			
CH43-1B	East Lake Shore Dr	NE	50	1			1		12.5		9	0.02			83			
CH43-1C	East Lake Shore Dr	SW	50	1			1		12.5		1	0.01			59			
CH43-1D	East Lake Shore Dr	SE	50	1			1		12.5		47 <sup>8</sup>	0.03			83			
CH43-2C	East Lake Shore Dr	SW		1 <sup>12</sup>			1		12.5		1							
CH43-2D	East Lake Shore Dr	SE	37.5	1 <sup>12</sup>			1		12.5		1							
CH43-3A	East Lake Shore Dr	SW	50	1			1		12.5		79 <sup>11</sup>	0.03			83			
CH43-3B	East Lake Shore Dr	NW	50	1			1		12.5		74 <sup>11</sup>	0.04			83			
CH43-3C	East Lake Shore Dr	SE	50	1			1		12.5		24 <sup>11</sup>	0.02			83			
CH43-3D	East Lake Shore Dr	NE	50	1			1		12.5		109 <sup>11</sup>	0.04			83			
SOUTHEAST SANGAMON COUNTY TOTAL			699.5	14	2	0	16	62.5	187.5	5	452	0.30	0	0	889	8	0	53

NOTES

- 1 NO SHOULDER WIDENING REQUIRED
- 2 CONNECT TO EXSTING PIPE
- 3 REMOVE END SHOE, INSTALL TYPE 1 TERMINAL ALONG SIDE ROAD
- 4 REGRADE DITCH
- 5 NO IMPROVEMENT, EXISTING TERMINAL TO REMAIN IN PLACE.
- 6 REMOVE END SHOE, INSTALL 12.5' RADIUS GUARDRAIL AND TYPE 1 TERMINAL
- 7 REQUIRES 37'-6" TERMINAL
- 8 CONSTRUCT 1:3 FRONT SLOPES
- 9 REMOVE END SHOE
- 10 REMOVE END SHOE, INSTALL 25' RADIUS GUARDRAIL AND TYPE 2 TERMINAL
- 11 INSTALL STANDARD END SHOE - BACK SIDE OF RAIL
- 12 INSTALL GUARDRAIL AND TERMINAL 15' FROM CENTERLINE
- 13 12.5' RADIUS GUARDRAIL (15' R)

SUMMARY OF GUARDRAIL IMPROVEMENTS

LOCATION	GUARDRAIL REMOVAL	TRAFFIC BARRIER TERMINAL TYPE 1 (SPECIAL) TANGENT	TRAFFIC BARRIER TERMINAL TYPE 1 (SPECIAL) FLARED	TRAFFIC BARRIER TERMINAL, TYPE 2	TERMINAL MARKER - DIRECT APPLIED	STEEL PLATE BEAM GUARDRAIL TYPE A 6' POSTS	VERTICAL ADJUSTMENT OF GUARDRAIL	EARTH EXCAVATION	FURNISHED EXCAVATION	SEEDING, CLASS 2 (SPECIAL)	PIPE CULVERTS, CLASS D, TYPE 1		PERIMETER EROSION BARRIER	TEMPROARY DITCH CHECKS	INLET AND PIPE PROTECTION	AGGREGATE WEDGE SHOULDER, TYPE B
	FOOT	EACH	EACH	EACH	EACH	FOOT	FOOT	CU YD	CU YD	ACRE	15"	18"	FOOT	FOOT	EACH	TON
NORTHEAST SANGAMON COUNTY TOTAL	4,037.5	85	3	1	88	37.5	1,100.0	57	1,585	1.37	0	170	9,078	88	4	0
NORTHWEST SANGAMON COUNTY TOTAL	1,850.0	40	0	0	40	0	500.0	0	436	0.45	0	0	2203	0	0	0
SOUTHWEST SANGAMON COUNTY TOTAL	2,800.0	68	0	1	68	37.5	850.0	54	1,152	1.13	38	266	3,923	120	4	0
SOUTHEAST SANGAMON COUNTY TOTAL	699.5	14	2	0	16	62.5	187.5	5	452	0.30	0	0	889	8	0	53
TOTAL	9,387.0	207	5	2	212	137.5	2,637.5	116	3,625	3.25	38	436	16,093	216	8	53

	JOB = 2435	DESIGNED - NAK	REVISED -	<b>SANGAMON COUNTY</b> <b>GUARDRAIL TERMINAL IMPROVEMENTS</b>	<b>SCHEDULE OF QUANTITIES</b> <b>SOUTHEAST SANGAMON COUNTY</b>				F.A.S. RTE. VAR.	SECTION 15-00175-00-SP	COUNTY SANGAMON	TOTAL SHEETS 15	SHEET NO. 14
	FILE NAME = 2435-SHT-SCHEDULE.dgn	DRAWN - SJS	REVISED -		SCALE:	SHEET NO. OF SHEETS STA. TO STA.	FED. ROAD DIST. NO. [ILLINOIS] FED. AID PROJECT	CONTRACT NO. 93696					
	PLOT SCALE = 25.0000' / 1"	CHECKED - NAK	REVISED -										
	PLOT DATE = 1/9/2017	DATE - 3/18/2016	REVISED -										

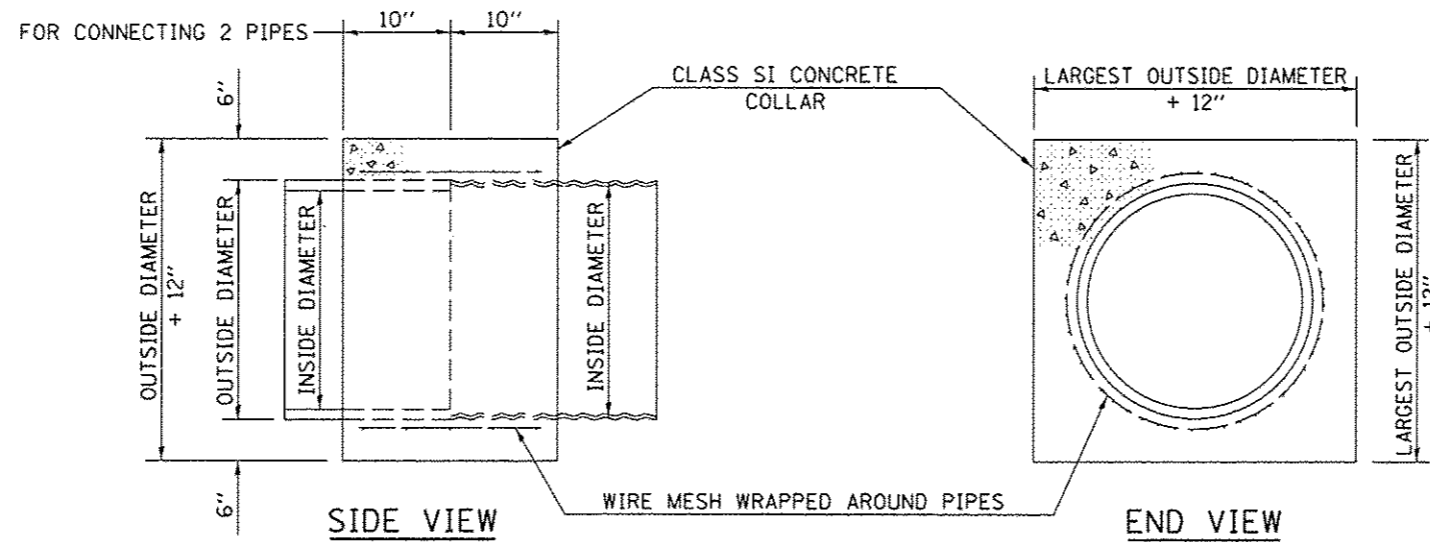

**GENERAL NOTES**

1. CLASS SI CONCRETE SHALL BE USED THROUGHOUT.
2. WHEN CONCRETE COLLARS ARE USED TO CONNECT PIPES OF DIFFERENT OUTSIDE DIAMETERS, THE CONCRETE COLLAR SHALL BE FORMED USING THE LARGEST OUTSIDE DIAMETER (SEE END VIEW).
3. THE WIRE MESH SHALL WEIGH NOT LESS THAN 54#/100 SQ. FT.
4. CONCRETE COLLARS WILL BE PAID FOR AT THE CONTRACT UNIT PRICE, PER CUBIC YARD, FOR CONCRETE COLLARS INCLUDING ALL MATERIAL AND LABOR SPECIFIED TO COMPLETE THE WORK IN PLACE.

QUANTITIES FOR METAL PIPES	
INSIDE DIAMETER OF PIPE	ESTIMATED CLASS SI CONCRETE REQUIRED 20" WIDTH
INCH	CU. YD.
4"	0.12
6"	0.14
8"	0.16
10"	0.19
12"	0.21
15"	0.25
18"	0.29
24"	0.38
30"	0.47
36"	0.59
42"	0.69
48"	0.81
54"	0.93
60"	1.05

Note: All dimensions are in INCHES unless otherwise shown.