

# SUMMARY OF QUANTITIES

LOCATION OF WORK:

FAP 800

FAP 800

URBAN

RURAL

FOUR LANE DIVIDED

FOUR LANE DIVIDED

STA. 49+00 TO STA. 163+45

STA. 163+45 TO STA. 329+00

CHAMPAIGN COUNTY

CHAMPAIGN COUNTY

FUNDING BREAKOUT:

80% FEDERAL, 20% STATE

80% FEDERAL, 20% STATE

CONSTRUCTION TYPE CODE:

0005

0005

CODE NO.	ITEM	UNIT	TOTAL QUANTITY		
<del>20200400</del>	<del>EARTH EXCAVATION</del>	<del>CU YD</del>	<del>4,537.00</del>	<del>2,772.0</del>	<del>1,765.0</del>
20201200	REMOVAL AND DISPOSAL OF UNSUITABLE MATERIAL	CU YD	4,537.00	2,772.0	1,765.0
20400800	FURNISHED EXCAVATION	CU YD	3,474.00	1,043.0	2,431.0
21400100	GRADING AND SHAPING DITCHES	FOOT	1,131.00	843.0	288.0
25000210	SEEDING, CLASS 2A	ACRE	17.0	5.5	11.5
25000350	SEEDING, CLASS 7	ACRE	17.0	5.5	11.5
25000400	NITROGEN FERTILIZER NUTRIENT	POUND	1544.0	505.0	1039.0
25000500	PHOSPHORUS FERTILIZER NUTRIENT	POUND	1544.0	505.0	1039.0
25000600	POTASSIUM FERTILIZER NUTRIENT	POUND	1544.0	505.0	1039.0
25100115	MULCH, METHOD 2	ACRE	34.0	14.0	23.0
28000250	TEMPORARY EROSION CONTROL SEEDING	POUND	1715.0	561.0	1154.0
28000305	TEMPORARY DITCH CHECKS	FOOT	2,748.00	900.0	1,848.0
28000400	PERIMETER EROSION BARRIER	FOOT	3,375.00	1,750.0	1,625.0
28000500	INLET AND PIPE PROTECTION	EACH	32.00	10.0	22.0
31100100	SUBBASE GRANULAR MATERIAL, TYPE A	TON	2,120.00	2,120.0	0.0

\* DENOTES SPECIALTY ITEM

FILE NAME =	USER NAME = ceer-lock_jd	DESIGNED - RTB	REVISED -
o:\11\04E8\INTEG\illinois.gov\PW\DOT\Documents\DOT Offices\District 5\Projects\0577\DRAWN\Date\Design\RTB\07779-sht-schedule.dwg		CHECKED -	REVISED -
		DATE - 11/16/16	REVISED -

STATE OF ILLINOIS  
DEPARTMENT OF TRANSPORTATION

SUMMARY OF QUANTITIES

SCALE: SHEET 1 OF 7 SHEETS STA. TO STA.

F.A.P. RTE.	SECTION	COUNTY	TOTAL SHEETS	SHEET NO.
800	(28X-1,29X-1)RS-4	CHAMPAIGN	192	6
ILLINOIS FED. AID PROJECT			CONTRACT NO. 70779	

REV 4-12-17 REV

# SUMMARY OF QUANTITIES

LOCATION OF WORK:

FAP 800

FAP 800

URBAN

RURAL

FOUR LANE DIVIDED

FOUR LANE DIVIDED

STA. 49+00 TO STA. 163+45

STA. 163+45 TO STA. 329+00

CHAMPAIGN COUNTY

CHAMPAIGN COUNTY

FUNDING BREAKOUT:

80% FEDERAL, 20% STATE

80% FEDERAL, 20% STATE

CONSTRUCTION TYPE CODE:

0005

0005

CODE NO.	ITEM	UNIT	TOTAL QUANTITY		
* 78200005	GUARDRAIL REFLECTORS, TYPE A	EACH	20.00	0.0	20.0
* 78300200	RAISED REFLECTIVE PAVEMENT MARKER REMOVAL	EACH	840.00	379.0	461.0
* 88600100	DETECTOR LOOP, TYPE I	FOOT	579.00	579.0	0.0
X4400196	HOT-MIX ASPHALT SURFACE REMOVAL, SPECIAL	SQ YD	6,917.00	4,339.0	2,578.0
X4402020	CONCRETE MEDIAN SURFACE REMOVAL	SQ FT	2,463.00	2,463.0	0.0
X4406310	PARTIAL DEPTH REMOVAL, TYPE II, 11"	SQ YD	1,867.0	339.0	1,528.0
<del>X4406110</del>	<del>PARTIAL DEPTH REMOVAL, TYPE I, 11"</del>	<del>SQ YD</del>	<del>1,973.0</del>	<del>339.0</del>	<del>1,634.0</del>
X4406710	PARTIAL DEPTH REMOVAL, TYPE III, 11"	SQ YD	106.00		106.0
X4421000	PARTIAL DEPTH PATCHING	TON	1216.0	209.0	1007.0
X6061005	CONCRETE CURB, TYPE B (SPECIAL)	FOOT	625.00	625.0	0.0
* X6310176	TRAFFIC BARRIER TERMINAL, TYPE 2 (SPECIAL)	EACH	3.00	0.0	3.0
* X6330725	STEEL PLATE BEAM GUARDRAIL (SHORT RADIUS)	FOOT	100.00	0.0	100.0
X7015005	CHANGEABLE MESSAGE SIGN	CAL DA	14.00	7.0	7.0
* X7830068	GROOVING FOR RECESSED PAVEMENT MARKING, LETTERS, NUMBERS AND SYMBOLS	SQ FT	1,529.00	1,092.0	437.0
* X7830070	GROOVING FOR RECESSED PAVEMENT MARKING 5"	FOOT	113,290.00	45,845.0	67,445.0
* X7830074	GROOVING FOR RECESSED PAVEMENT MARKING 7"	FOOT	604.00	604.0	0.0

\* DENOTES SPECIALTY ITEM

REV 4-12-17 REV



## ② EXISTING TYPICAL CROSS SECTION

NOTE: STRIP REFLECTIVE CRACK PREVENT PLACED ALONG LONGITUDINAL JOINTS

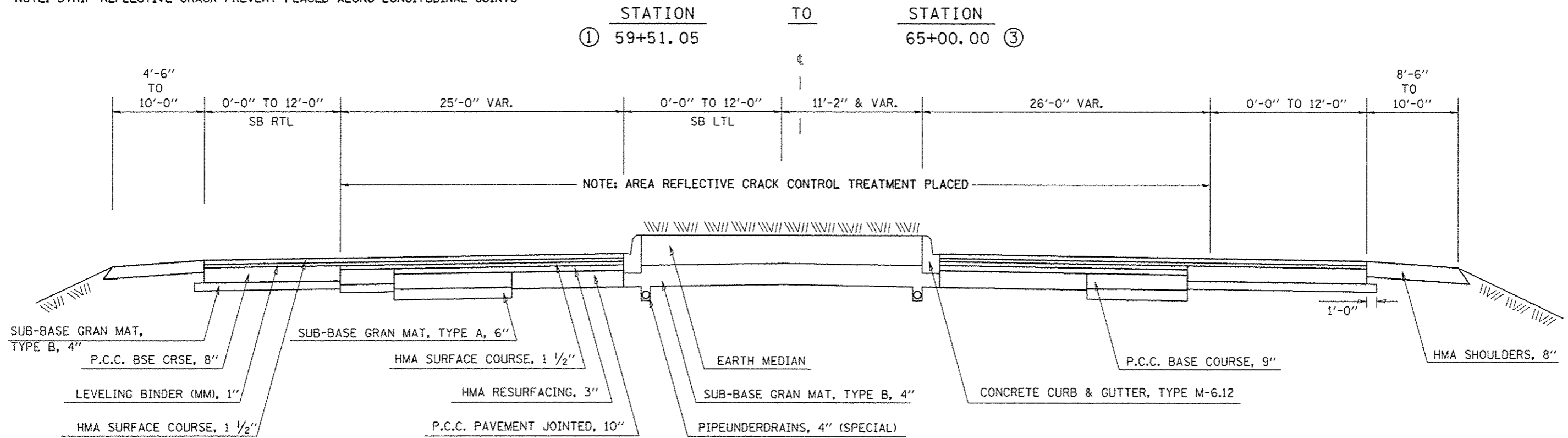

## ② PROPOSED TYPICAL CROSS SECTION

STATION ① 59+51.05 TO STATION ③ 65+00.00

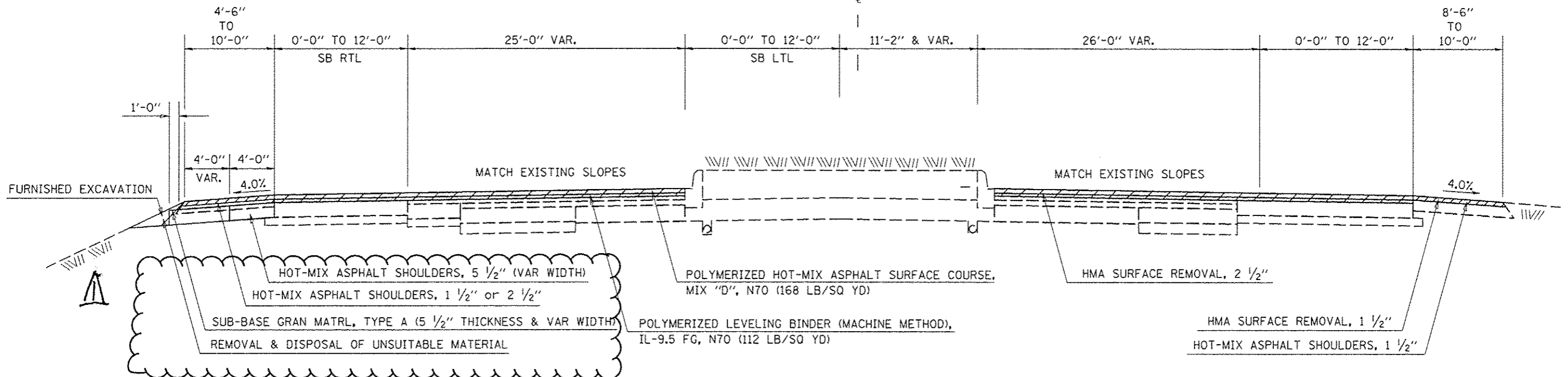

FILE NAME :	USER NAME : black-t	DESIGNED -	REVISED -	<b>STATE OF ILLINOIS DEPARTMENT OF TRANSPORTATION</b>	<b>TYPICAL CROSS SECTIONS</b>	F.A.P. RTE. 800	SECTION (28X-1, 29X-1) RS-4	COUNTY CHAMPAIGN	TOTAL SHEETS 192	SHEET NO. 14
MODEL NAME :	PLT SCALE = 48,0000' / 1" =	CHECKED -	REVISED -	SCALE:	SHEET 2 OF 9 SHEETS	STA. TO STA.		CONTRACT NO. 70779		
	PLT DATE = 4/6/2017	DATE -	REVISED -	ILLINOIS FED. AID PROJECT						

REV 4-2-17

NOTE: STRIP REFLECTIVE CRACK PREVENT PLACED ALONG LONGITUDINAL JOINTS

### ③ EXISTING TYPICAL CROSS SECTION

NB LTL FROM STA. 65+27.64 TO STA. 70+32.89

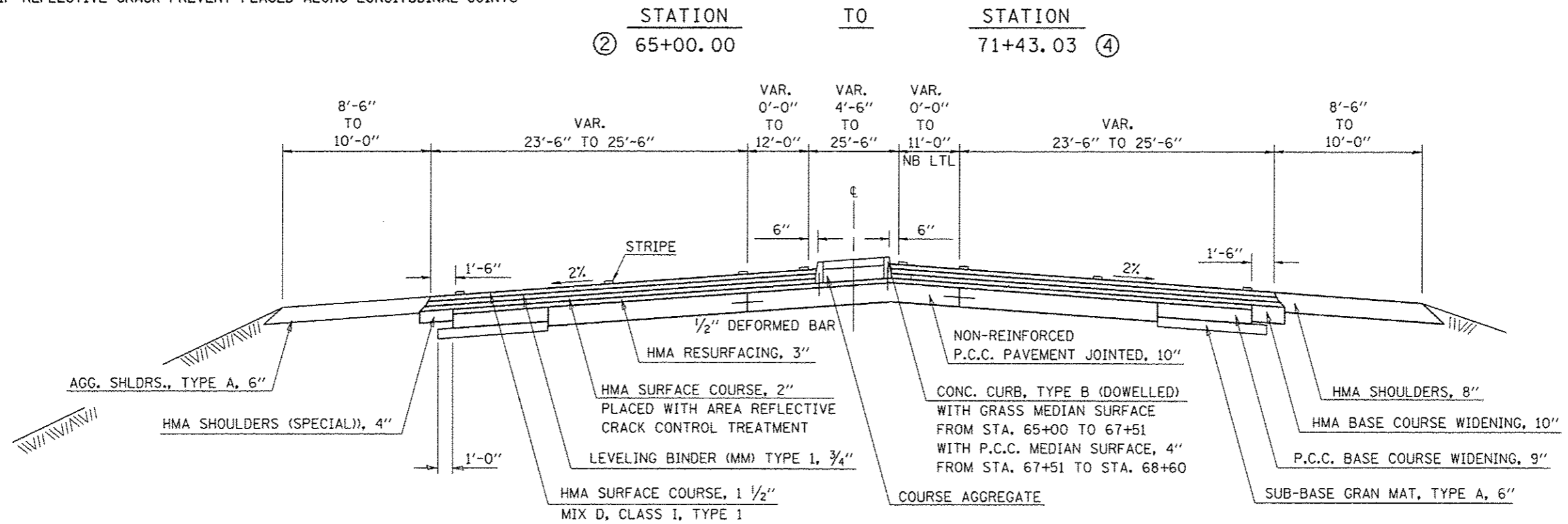

### ③ PROPOSED TYPICAL CROSS SECTION

NB LTL FROM STA. 65+27.64 TO STA. 70+32.89

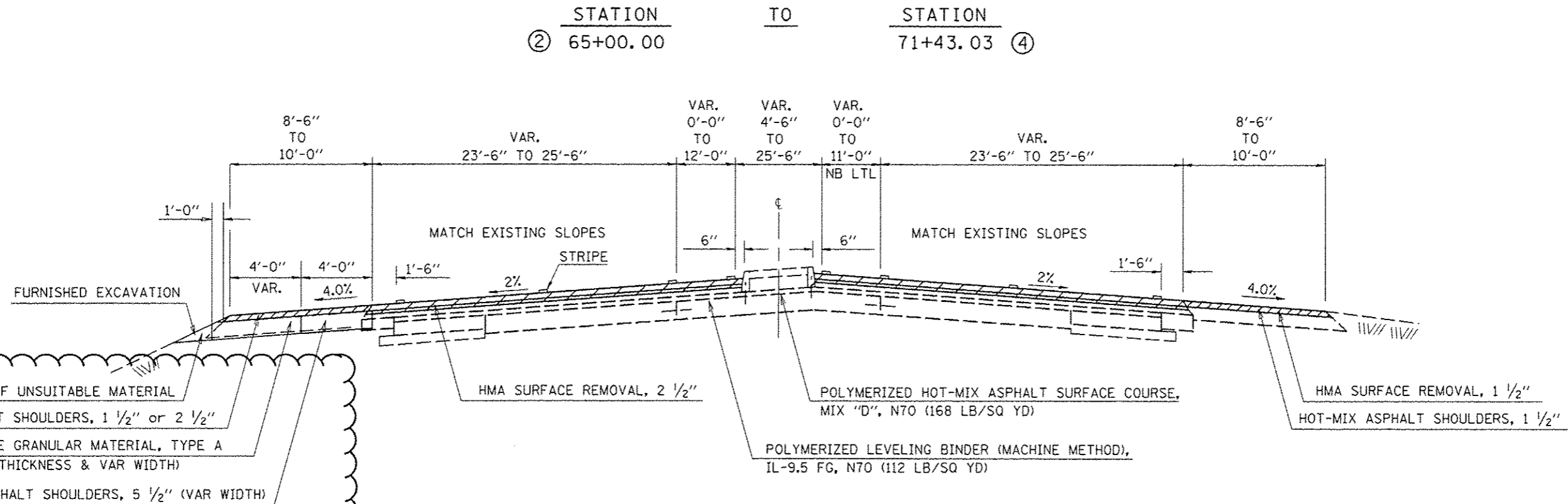

STATE OF ILLINOIS  
DEPARTMENT OF TRANSPORTATION

TYPICAL CROSS SECTIONS

FILE NAME	USER NAME	DESIGNED	REVISED	STATE OF ILLINOIS DEPARTMENT OF TRANSPORTATION		TYPICAL CROSS SECTIONS		F.A.P. RTE.	SECTION	COUNTY	TOTAL SHEETS	SHEET NO.
p:\11084EBID\INTEG\Illinois.gov\PW1001\Documents\1001 Offices\District 9\Projects\0579\DrawnData\Design\0579779-ehs-typical.dwg	blackst	05/11/2017	05/11/2017					800	(28X-1, 29X-1) RS-4	CHAMPAIGN	192	15
MODEL NAME	PLOT SCALE	CHECKED	REVISED	SCALE:		SHEET 3 OF 9 SHEETS		STA.		TO STA.		ILLINOIS FED. AID PROJECT
	48,0000 1" = 100'	05/11/2017	05/11/2017									CONTRACT NO. 70779

REV 4-12-17

SB LTL FROM STA. 71+43.03 TO STA. 74+70.37

### ④ EXISTING TYPICAL CROSS SECTION

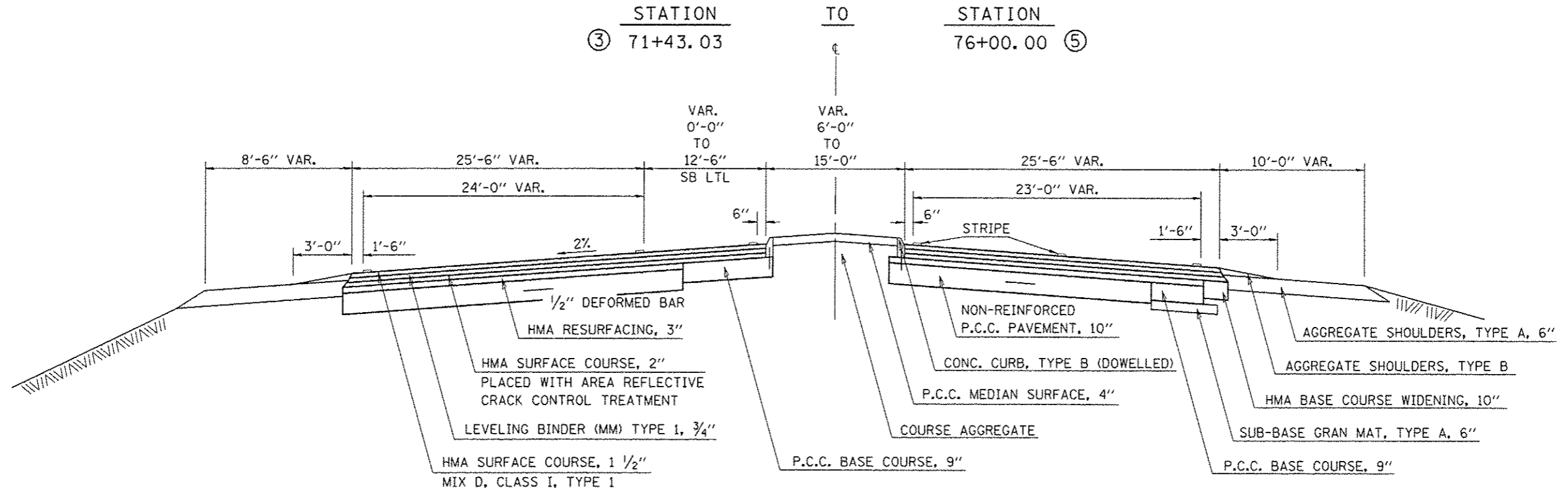

SB LTL FROM STA. 71+43.03 TO STA. 74+70.37

### ④ PROPOSED TYPICAL CROSS SECTION

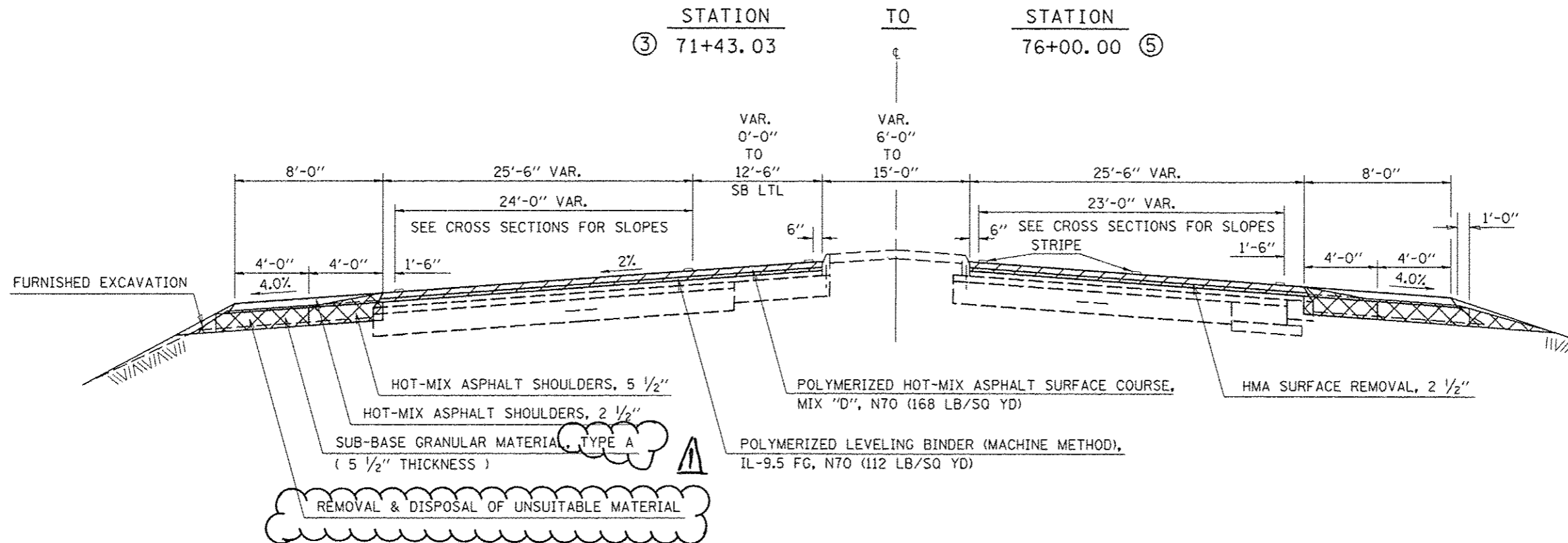

FILE NAME: p:\il\084EBIDINTEG\illinois.gov\p\1007\Documents\1007 Offices\District 5\Projects\0579\Drawings\Design\0579779-shr-typical.dwg	USER NAME: blackrt	DESIGNED: [ ]	REVISED: [ ]	<b>STATE OF ILLINOIS DEPARTMENT OF TRANSPORTATION</b>	<b>TYPICAL CROSS SECTIONS</b>		F.A.P. RTE. 800	SECTION (28X-1, 29X-1) RS-4	COUNTY CHAMPAIGN	TOTAL SHEETS 192	SHEET NO. 16	
PLDT SCALE: 1/8" = 1'-0"	CHECKED: [ ]	REVISOR: [ ]	DATE: [ ]		SCALE: [ ]	SHEET 4 OF 9 SHEETS	STA. [ ] TO STA. [ ]	CONTRACT NO. 70779				
PLDT DATE: 4/4/2017	DATE: [ ]	REVISOR: [ ]	DATE: [ ]		[ILLINOIS] FED. AID PROJECT							
REV 4-12-17												



SB LTL FROM STA. 100+71.27 TO STA. 103+66.34  
 SB LTL FROM STA. 182+57.76 TO STA. 185+53.39  
 SB LTL FROM STA. 288+86.43 TO STA. 292+53.52

### ⑥ EXISTING TYPICAL CROSS SECTION

STATION	TO	STATION
⑤ 92+00.00		105+00.00 ⑤
⑤ 177+72.05		186+19.76 ⑤
⑤ 283+78.61		293+35.55 ⑤

NB LTL FROM STA. 92+61.12 TO STA. 95+89.38  
 NB LTL FROM STA. 97+14.17 TO STA. 99+27.85  
 NB LTL FROM STA. 178+21.98 TO STA. 181+27.15  
 NB LTL FROM STA. 284+08.23 TO STA. 287+63.10

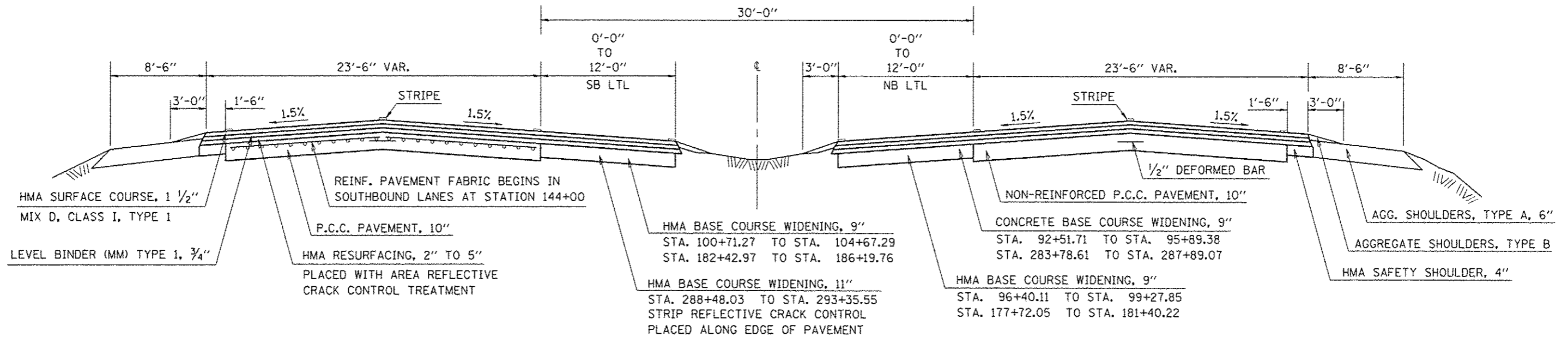

SB LTL FROM STA. 100+71.27 TO STA. 103+66.34  
 SB LTL FROM STA. 182+57.76 TO STA. 185+53.39  
 SB LTL FROM STA. 288+86.43 TO STA. 292+53.52

### ⑥ PROPOSED TYPICAL CROSS SECTION

STATION	TO	STATION
⑤ 177+72.05		186+19.76 ⑤
⑤ 283+78.61		293+35.55 ⑤

NB LTL FROM STA. 92+61.12 TO STA. 95+89.38  
 NB LTL FROM STA. 97+14.17 TO STA. 99+27.85  
 NB LTL FROM STA. 178+21.98 TO STA. 181+27.15  
 NB LTL FROM STA. 284+08.23 TO STA. 287+63.10

NOTE: BIKE PATH ENDS AT STATION 144+00  
 SEE SOUTHBOUND BIKE PATH DETAIL

NOTE: BIKE PATH ENDS AT STATION 144+00  
 SEE NORTHBOUND BIKE PATH DETAIL

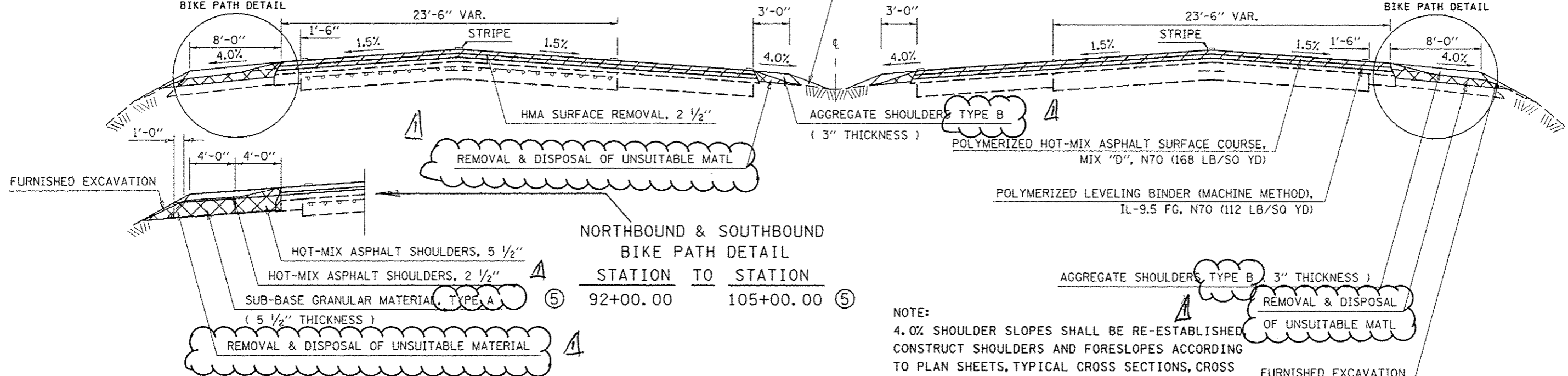

NOTE:  
 4.0% SHOULDER SLOPES SHALL BE RE-ESTABLISHED.  
 CONSTRUCT SHOULDERS AND FORESLOPES ACCORDING  
 TO PLAN SHEETS, TYPICAL CROSS SECTIONS, CROSS  
 SECTIONS AND SPECIAL PROVISIONS.

FILE NAME :	USER NAME :	DESIGNED :	REVISED :	STATE OF ILLINOIS DEPARTMENT OF TRANSPORTATION	TYPICAL CROSS SECTIONS	F.A.P. RTE.	SECTION	COUNTY	TOTAL SHEETS	SHEET NO.	
p:\11\004\EBID\INTEG\Illinois.gov\PI007\Documents\1007 Offices\District 5\Projects\0572\Drawings\Design\0570779-shr-typical.d		DRAWN :	REVISED :			800	(28X-1, 29X-1) R5-4	CHAMPAIGN	192	18	
PLOT SCALE : 48.0000' / 1" =		CHECKED :	REVISED :			CONTRACT NO. 70779					
PLOT DATE : 4/4/2017		DATE :	REVISED :			ILLINOIS FED. AID PROJECT					

REV 4-12-17



### ⑦ EXISTING TYPICAL CROSS SECTION

STATION	TO	STATION
⑤ 120+87.20		124+62.84 ⑧
⑧ 132+81.38		141+83.61 ⑤

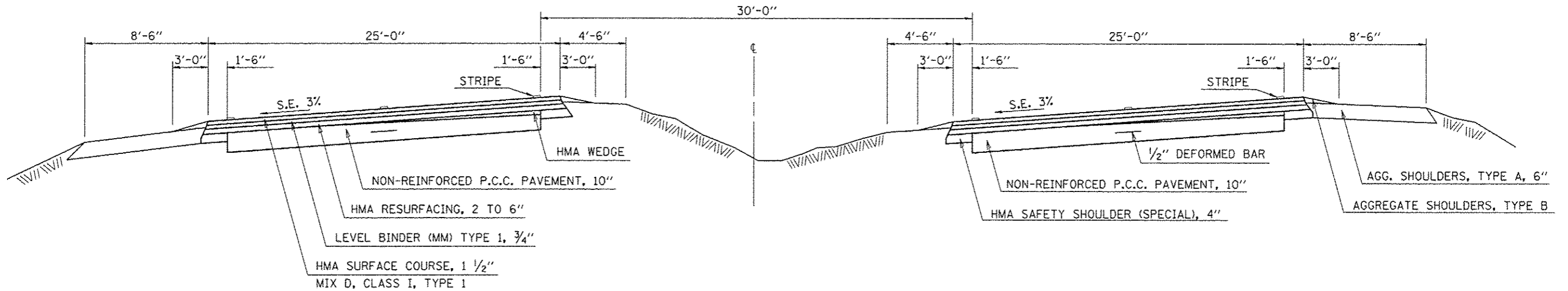

### ⑦ PROPOSED TYPICAL CROSS SECTION

STATION	TO	STATION
⑤ 120+87.20		124+62.84 ⑧
⑧ 132+81.38		141+83.61 ⑤

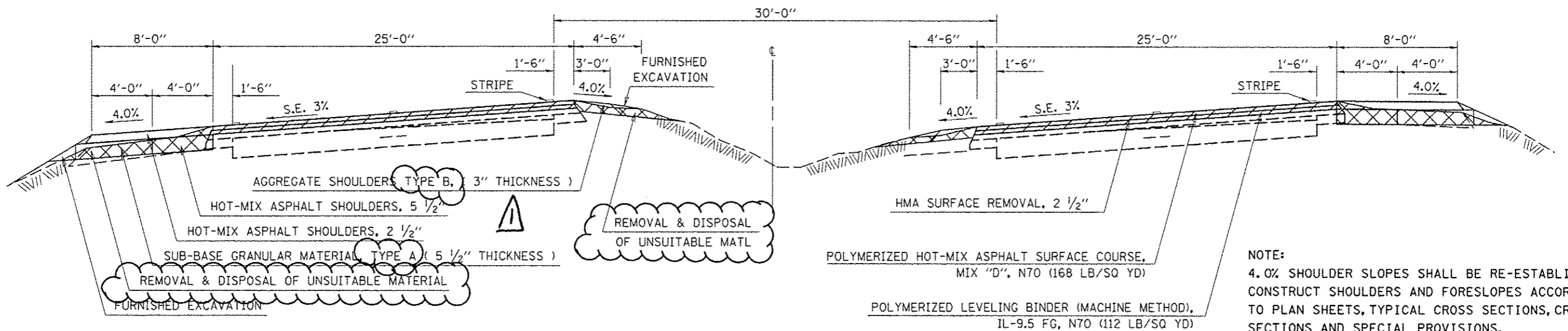

NOTE:  
4.0% SHOULDER SLOPES SHALL BE RE-ESTABLISHED. CONSTRUCT SHOULDERS AND FORESLOPES ACCORDING TO PLAN SHEETS, TYPICAL CROSS SECTIONS, CROSS SECTIONS AND SPECIAL PROVISIONS.

FILE NAME :	USER NAME :	DESIGNED :	REVISED :	<b>STATE OF ILLINOIS DEPARTMENT OF TRANSPORTATION</b>	<b>TYPICAL CROSS SECTIONS</b>	F.A.P. RTE.	SECTION	COUNTY	TOTAL SHEETS	SHEET NO.		
800	(28X-1, 29X-1) RS-4	CHAMPAIGN	192			19						
						SCALE:	SHEET 7 OF 9 SHEETS	STA.	TO STA.	ILLINOIS FED. AID PROJECT		
						CONTRACT NO. 70779						

REV 4-12-17

SB LTL FROM STA. 129+58.47 TO STA. 132+57.00

### 8 EXISTING TYPICAL CROSS SECTION

NB LTL FROM STA. 125+17.07 TO STA. 128+37.82

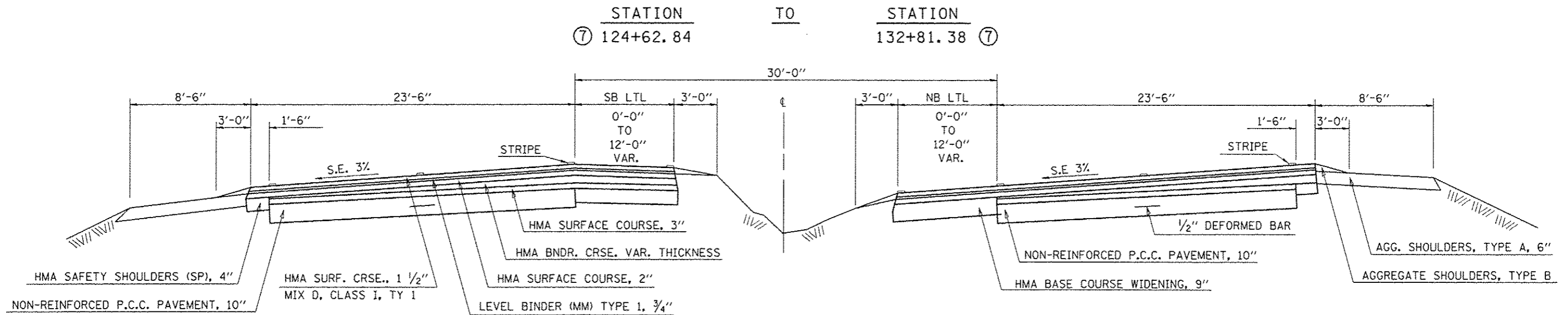

SB LTL FROM STA. 129+58.47 TO STA. 132+57.00

### 8 PROPOSED TYPICAL CROSS SECTION

NB LTL FROM STA. 125+17.07 TO STA. 128+37.82

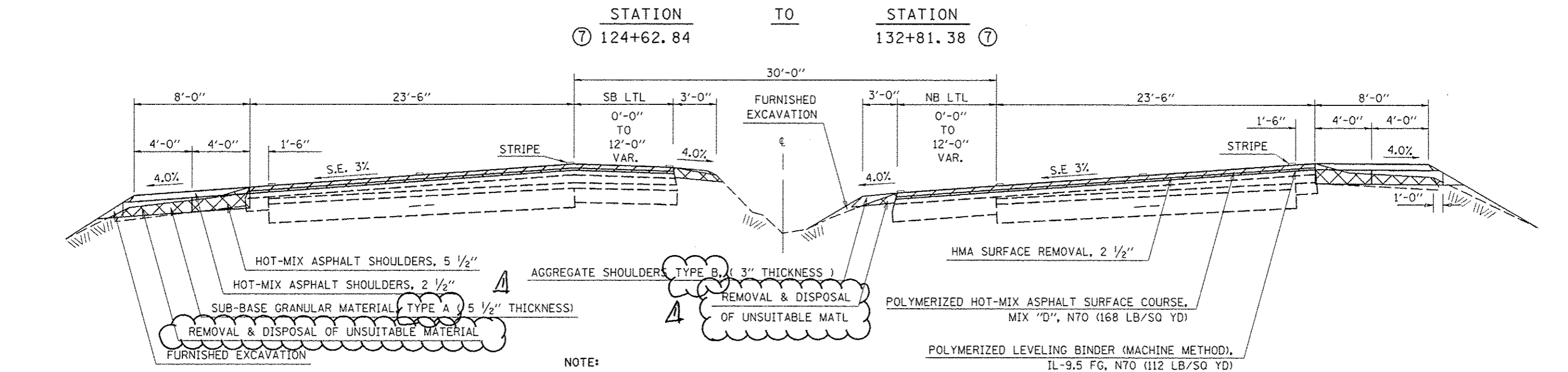

NOTE:  
 4.0% SHOULDER SLOPES SHALL BE RE-ESTABLISHED.  
 CONSTRUCT SHOULDERS AND FORESLOPES ACCORDING  
 TO PLAN SHEETS, TYPICAL CROSS SECTIONS, CROSS  
 SECTIONS AND SPECIAL PROVISIONS.

FILE NAME :	USER NAME : bhekr	DESIGNED -	REVISED -	<b>STATE OF ILLINOIS DEPARTMENT OF TRANSPORTATION</b>	<b>TYPICAL CROSS SECTIONS</b>	F.A.P. RTE.	SECTION	COUNTY	TOTAL SHEETS	SHEET NO.
pw\11L884EIDINTEG.illinois.gov\1001\Documents\1001_01\Office\District 5\Projects\0577\DRAWN\Info\Design\057779-shr-typical.dwg	DRAWN	REVISED	800			(28X-1, 29X-1) RS-4	CHAMPAIGN	192	20	
PLDT SCALE : 40.0000' / in.	CHECKED -	REVISED -	CONTRACT NO. 70779							
PLDT DATE : 4/4/2017	DATE -	REVISED -	ILLINOIS FED. AID PROJECT							

REV 4-12-17

SB LTL FROM STA. 248+77.69 TO STA. 251+84.22  
 SB RTL FROM STA. 249+07.91 TO STA. 251+50.11

⑨ EXISTING TYPICAL CROSS SECTION

NB LTL FROM STA. 244+49.14 TO STA. 247+70.45

LEVERETT ROAD INTERSECTION

STATION TO STATION  
 ⑤ 243+56.76 252+47.90 ⑤

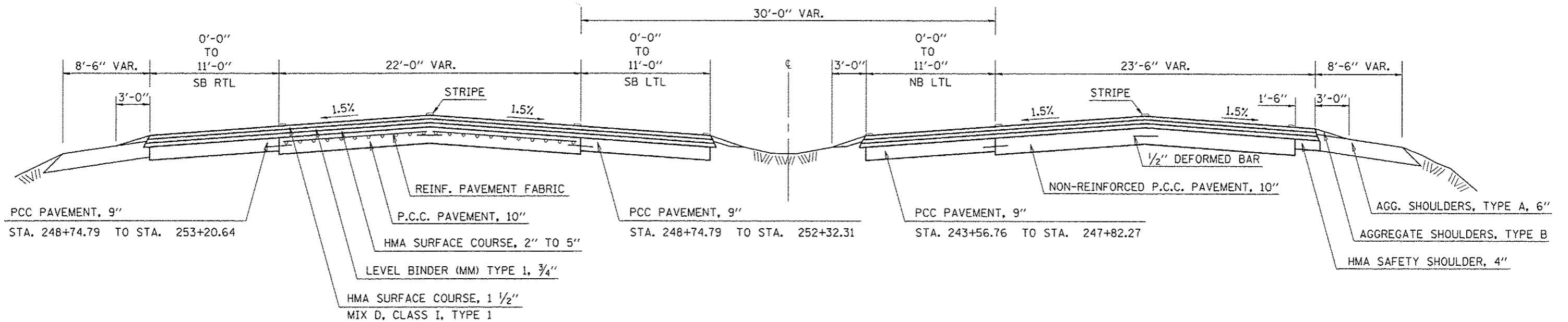

SB LTL FROM STA. 248+77.69 TO STA. 251+84.22  
 SB RTL FROM STA. 249+07.91 TO STA. 251+50.11

⑨ PROPOSED TYPICAL CROSS SECTION

NB LTL FROM STA. 244+49.14 TO STA. 247+70.45

LEVERETT ROAD INTERSECTION

STATION TO STATION  
 ⑤ 243+56.76 252+47.90 ⑤

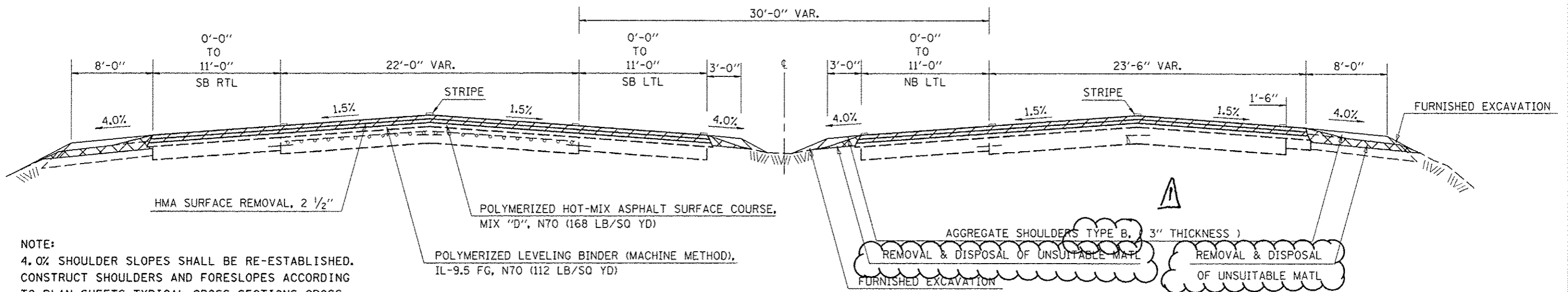

NOTE:  
 4.0% SHOULDER SLOPES SHALL BE RE-ESTABLISHED.  
 CONSTRUCT SHOULDERS AND FORESLOPES ACCORDING  
 TO PLAN SHEETS, TYPICAL CROSS SECTIONS, CROSS  
 SECTIONS AND SPECIAL PROVISIONS.

FILE NAME :	USER NAME :	DESIGNED :	REVISED :	STATE OF ILLINOIS DEPARTMENT OF TRANSPORTATION	TYPICAL CROSS SECTIONS	F.A.P. RTE.	SECTION	COUNTY	TOTAL SHEETS	SHEET NO.
pw:\jlb94EBID\INTEG\illinois.gov\PIWIDOT\Documents\1007 Offices\District 5N\Projects\0579\DRAWN\Date\Design\0579779-sht-typical.d	blackrt	ORAN	REVIS			800	(28X-1, 29X-1) RS-4	CHAMPAIGN	192	21
PLLOT SCALE :	CHECKED :	REVIS	REVIS			SCALE:		SHEET 9 OF 9 SHEETS		STA. TO STA.
PLLOT DATE :	DATE :	REVIS	REVIS			ILLINOIS FED. AID PROJECT				

REV 4-12-17

# SCHEDULE OF QUANTITIES

## EARTHWORK



20201200 REMOVAL & DISPOSAL OF UNSUITABLE MATERIAL SBPL OUTSIDE SHOULDER	20201200 REMOVAL & DISPOSAL OF UNSUITABLE MATERIAL SBPL MEDIAN SHOULDER	20201200 REMOVAL & DISPOSAL OF UNSUITABLE MATERIAL NBPL MEDIAN SHOULDER	20201200 REMOVAL & DISPOSAL OF UNSUITABLE MATERIAL NBPL OUTSIDE SHOULDER
---	--	--	---

LOCATION	BEGIN STATION	END STATION	(CU YD)	(CU YD)	(CU YD)	(CU YD)	(CU YD)	(CU YD)	(CU YD)	(CU YD)
AIRPORT RD	59+00.00	70+70.00	65.01	0.00	0.00	46.55	0.00	0.00	0.00	0.00
OLYMPIAN RD	70+70.00	129+00.00	939.80	124.10	94.95	795.77	146.37	96.86	125.55	205.02
	129+00.00	163+45.00	256.49	56.63	41.31	351.27	172.70	84.50	145.75	66.82
URBAN LIMIT										
RURAL LIMIT										
FORD HARRIS	163+45.00	182+00.00	74.15	43.42	20.63	75.00	39.64	17.89	107.50	50.87
LEVERETT RD	182+00.00	248+00.00	219.96	131.78	66.20	223.71	214.86	168.68	372.08	370.40
2200N	248+00.00	288+00.00	167.26	80.79	52.69	163.58	114.78	67.74	170.67	70.74
	288+00.00	329+00.00	143.04	83.47	52.23	167.67	275.69	115.76	200.72	72.54

URBAN SUBTOTAL =	1261.30	180.73	136.26	1193.59	319.07	181.36	271.30	271.84
USE =	1261.00	181.00	136.00	1194.00	319.00	181.00	271.00	272.00
RURAL SUBTOTAL =	604.41	339.46	191.75	629.96	644.97	370.07	850.97	564.55
USE =	604.00	339.00	192.00	630.00	645.00	370.00	851.00	565.00

URBAN REMVL & DISPOSAL UNSUITABL MATL =	2772.00
RURAL REMVL & DISPOSAL UNSUITABL MATL =	1765.00
<b>REMVL &amp; DISPOSAL UNSUITABL MATL TOTAL =</b>	<b>4537.00</b>

URBAN FURNISH EX TOTAL =	1043.00
RURAL FURNISH EX TOTAL =	2431.00
<b>FURNISH EX TOTAL =</b>	<b>3474.00</b>

REV 4-2-17

# SCHEDULE OF QUANTITIES

## PARTIAL DEPTH PATCHES

PARTIAL DEPTH PATCHES, 11 INCH

STATION	DIRECTION	LANE	LENGTH FOOT	WIDTH FOOT	AREA SQ YD	EXISTING OVERLAY THICKNESS (INCH)	PATCH DEPTH (INCH)	X4406310 PARTIAL DEPTH REMOVAL TYPE II, 11" (SQ YD)	X4421000 PARTIAL DEPTH PATCHING (TON)
63+74.00	NB	DL	6.00	12.00	8.00	8.0	11.0	8.00	4.93
76+16.00	NB	DL	6.00	12.00	8.00	8.0	11.0	8.00	4.93
76+16.00	NB	PL	6.00	12.00	8.00	8.0	11.0	8.00	4.93
78+96.00	NB	DL	6.00	12.00	8.00	8.0	11.0	8.00	4.93
78+96.00	NB	PL	6.00	12.00	8.00	8.0	11.0	8.00	4.93
88+43.00	NB	DL	6.00	12.00	8.00	8.0	11.0	8.00	4.93
88+43.00	NB	PL	6.00	12.00	8.00	8.0	11.0	8.00	4.93
99+08.00	NB	DL	8.00	12.00	10.67	8.0	11.0	10.67	6.57
99+08.00	NB	PL	8.00	12.00	10.67	8.0	11.0	10.67	6.57
104+29.00	NB	DL	6.00	12.00	8.00	8.0	11.0	8.00	4.93
104+29.00	NB	PL	6.00	12.00	8.00	8.0	11.0	8.00	4.93
112+33.00	NB	DL	6.00	12.00	8.00	8.0	11.0	8.00	4.93
112+33.00	NB	PL	6.00	12.00	8.00	8.0	11.0	8.00	4.93
117+33.00	NB	DL	8.00	12.00	10.67	8.0	11.0	10.67	6.57
117+33.00	NB	PL	8.00	12.00	10.67	8.0	11.0	10.67	6.57
123+95.00	NB	DL	8.00	12.00	10.67	8.0	11.0	10.67	6.57
123+95.00	NB	PL	8.00	12.00	10.67	8.0	11.0	10.67	6.57
133+65.00	NB	DL	8.00	12.00	10.67	8.0	11.0	10.67	6.57
133+65.00	NB	PL	8.00	12.00	10.67	8.0	11.0	10.67	6.57
141+56.00	NB	PL	10.00	12.00	13.33	8.0	11.0	13.33	8.21
150+13.00	NB	PL	10.00	12.00	13.33	8.0	11.0	13.33	8.21
154+59.00	NB	DL	6.00	12.00	8.00	8.0	11.0	8.00	4.93
154+59.00	NB	PL	6.00	12.00	8.00	8.0	11.0	8.00	4.93
161+89.00	NB	DL	10.00	12.00	13.33	8.0	11.0	13.33	8.21
161+89.00	NB	PL	10.00	12.00	13.33	8.0	11.0	13.33	8.21

TYPE II, 11" NORTHBOUND URBAN SUBTOTALS = 242.67 149.48

PARTIAL DEPTH PATCHES, 11 INCH

STATION	DIRECTION	LANE	LENGTH FOOT	WIDTH FOOT	AREA SQ YD	EXISTING OVERLAY THICKNESS (INCH)	PATCH DEPTH (INCH)	X4406310 PARTIAL DEPTH REMOVAL TYPE II, 11" (SQ YD)	X4421000 PARTIAL DEPTH PATCHING (TON)
166+08.00	NB	DL	6.00	12.00	8.00	8.0	11.0	8.00	4.93
166+08.00	NB	PL	6.00	12.00	8.00	8.0	11.0	8.00	4.93
172+44.00	NB	DL	8.00	12.00	10.67	8.0	11.0	10.67	6.57
172+44.00	NB	PL	8.00	12.00	10.67	8.0	11.0	10.67	6.57
177+84.00	NB	DL	6.00	12.00	8.00	8.0	11.0	8.00	4.93
178+41.00	NB	PL	6.00	12.00	8.00	8.0	11.0	8.00	4.93
187+98.00	NB	DL	6.00	12.00	8.00	8.0	11.0	8.00	4.93
187+98.00	NB	PL	6.00	12.00	8.00	8.0	11.0	8.00	4.93
203+86.00	NB	DL	6.00	12.00	8.00	8.0	11.0	8.00	4.93
203+86.00	NB	PL	6.00	12.00	8.00	8.0	11.0	8.00	4.93
204+26.00	NB	DL	6.00	12.00	8.00	8.0	11.0	8.00	4.93
204+26.00	NB	PL	6.00	12.00	8.00	8.0	11.0	8.00	4.93
210+68.00	NB	DL	6.00	12.00	8.00	8.0	11.0	8.00	4.93
210+68.00	NB	PL	6.00	12.00	8.00	8.0	11.0	8.00	4.93
215+23.00	NB	DL	8.00	12.00	10.67	8.0	11.0	10.67	6.57
215+23.00	NB	PL	8.00	12.00	10.67	8.0	11.0	10.67	6.57
223+76.00	NB	DL	8.00	12.00	10.67	8.0	11.0	10.67	6.57
223+76.00	NB	PL	8.00	12.00	10.67	8.0	11.0	10.67	6.57
232+82.00	NB	DL	8.00	12.00	10.67	8.0	11.0	10.67	6.57
232+82.00	NB	PL	8.00	12.00	10.67	8.0	11.0	10.67	6.57
239+44.00	NB	DL	6.00	12.00	8.00	8.0	11.0	8.00	4.93
239+44.00	NB	PL	6.00	12.00	8.00	8.0	11.0	8.00	4.93
245+24.00	NB	DL	6.00	12.00	8.00	8.0	11.0	8.00	4.93
245+24.00	NB	PL	6.00	12.00	8.00	8.0	11.0	8.00	4.93
249+19.00	NB	DL	6.00	12.00	8.00	8.0	11.0	8.00	4.93
249+19.00	NB	PL	6.00	12.00	8.00	8.0	11.0	8.00	4.93
250+12.00	NB	DL	30.00	12.00	40.00	8.0	11.0		
255+63.00	NB	DL	6.00	12.00	8.00	8.0	11.0	8.00	4.93
255+63.00	NB	PL	6.00	12.00	8.00	8.0	11.0	8.00	4.93

TYPE II, 11" NORTHBOUND RURAL SUBTOTALS = 245.33 151.13

X4406710  
PARTIAL  
DEPTH  
REMOVAL  
TYPE IV, 11"  
(SQ YD)

X4421000  
PARTIAL  
DEPTH  
PATCHING  
(TON)

250+12.00	NB	DL	30.00	12.00	40.00	8.0	11.0	40.00	24.64
-----------	----	----	-------	-------	-------	-----	------	-------	-------

TYPE IV, 11" NORTHBOUND RURAL SUBTOTALS = 40.00 24.64

PROJECT TOTALS ON SHEET 38

REV 4-12-17

# SCHEDULE OF QUANTITIES

## PARTIAL DEPTH PATCHES (CONTINUED)

PARTIAL DEPTH PATCHES, 11 INCH

STATION	DIRECTION	LANE	LENGTH FOOT	WIDTH FOOT	AREA SQ YD	EXISTING OVERLAY THICKNESS (INCH)	PATCH DEPTH (INCH)	X4406310 PARTIAL DEPTH REMOVAL TYPE II, 11" (SQ YD)	X4421000 PARTIAL DEPTH PATCHING (TON)
255+98.00	NB	DL	6.00	12.00	8.00	8.0	11.0	8.00	4.93
257+97.00	NB	DL	8.00	12.00	10.67	8.0	11.0	10.67	6.57
257+97.00	NB	PL	8.00	12.00	10.67	8.0	11.0	10.67	6.57
269+14.00	NB	DL	25.00	12.00	33.33	8.0	11.0		
269+14.00	NB	PL	25.00	12.00	33.33	8.0	11.0		
276+01.00	NB	DL	8.00	12.00	10.67	8.0	11.0	10.67	6.57
276+01.00	NB	PL	8.00	12.00	10.67	8.0	11.0	10.67	6.57
291+13.00	NB	DL	8.00	12.00	10.67	8.0	11.0	10.67	6.57
291+13.00	NB	PL	8.00	12.00	10.67	8.0	11.0	10.67	6.57
302+36.00	NB	DL	10.00	12.00	13.33	8.0	11.0	13.33	8.21
302+36.00	NB	PL	8.00	12.00	10.67	8.0	11.0	10.67	6.57
315+06.00	NB	DL	6.00	12.00	8.00	8.0	11.0	8.00	4.93
315+06.00	NB	PL	6.00	12.00	8.00	8.0	11.0	8.00	4.93
324+90.00	NB	DL	6.00	12.00	8.00	8.0	11.0	8.00	4.93
324+90.00	NB	PL	6.00	12.00	8.00	8.0	11.0	8.00	4.93
326+01.00	NB	DL	6.00	12.00	8.00	8.0	11.0	8.00	4.93
326+01.00	NB	PL	6.00	12.00	8.00	8.0	11.0	8.00	4.93

TYPE II, 11" NORTHBOUND RURAL SUBTOTALS = 144.00 88.70

PARTIAL DEPTH PATCHES, 11 INCH

STATION	DIRECTION	LANE	LENGTH FOOT	WIDTH FOOT	AREA SQ YD	EXISTING OVERLAY THICKNESS (INCH)	PATCH DEPTH (INCH)	X4406310 PARTIAL DEPTH REMOVAL TYPE II, 11" (SQ YD)	X4421000 PARTIAL DEPTH PATCHING (TON)
76+20.00	SB	DL	6.00	12.00	8.00	8.0	11.0	8.00	4.93
76+20.00	SB	PL	6.00	12.00	8.00	8.0	11.0	8.00	4.93
99+78.00	SB	DL	6.00	12.00	8.00	8.0	11.0	8.00	4.93
99+78.00	SB	PL	6.00	12.00	8.00	8.0	11.0	8.00	4.93
138+89.00	SB	DL	6.00	12.00	8.00	8.0	11.0	8.00	4.93
138+89.00	SB	PL	6.00	12.00	8.00	8.0	11.0	8.00	4.93
144+65.00	SB	DL	6.00	12.00	8.00	8.0	11.0	8.00	4.93
144+65.00	SB	PL	6.00	12.00	8.00	8.0	11.0	8.00	4.93
154+69.00	SB	DL	6.00	12.00	8.00	8.0	11.0	8.00	4.93
154+69.00	SB	PL	6.00	12.00	8.00	8.0	11.0	8.00	4.93
159+72.00	SB	DL	6.00	12.00	8.00	8.0	11.0	8.00	4.93
159+72.00	SB	PL	6.00	12.00	8.00	8.0	11.0	8.00	4.93

TYPE II, 11" SOUTHBOUND URBAN SUBTOTALS = 96.00 59.14

X4406710 X4421000  
PARTIAL DEPTH REMOVAL TYPE IV, 11" (SQ YD) PARTIAL DEPTH PATCHING (TON)

269+14.00	NB	DL	25.00	12.00	33.33	8.0	11.0	33.33	20.53
269+14.00	NB	PL	25.00	12.00	33.33	8.0	11.0	33.33	20.53

TYPE IV, 11" NORTHBOUND RURAL SUBTOTALS = 66.67 41.07

PROJECT TOTALS ON SHEET 36

# SCHEDULE OF QUANTITIES

## PARTIAL DEPTH PATCHES (CONTINUED)

### PARTIAL DEPTH PATCHES, 11 INCH

STATION	DIRECTION	LANE	LENGTH FOOT	WIDTH FOOT	AREA SQ YD	EXISTING OVERLAY THICKNESS (INCH)	PATCH DEPTH (INCH)	X4406310 PARTIAL DEPTH REMOVAL TYPE II, 11" (SQ YD)	X4421000 PARTIAL DEPTH PATCHING (TON)
163+73.00	SB	DL	6.00	12.00	8.00	8.0	11.0	8.00	4.93
163+73.00	SB	PL	6.00	12.00	8.00	8.0	11.0	8.00	4.93
165+73.00	SB	DL	6.00	12.00	8.00	8.0	11.0	8.00	4.93
165+73.00	SB	PL	6.00	12.00	8.00	8.0	11.0	8.00	4.93
170+75.00	SB	DL	6.00	12.00	8.00	8.0	11.0	8.00	4.93
170+75.00	SB	PL	6.00	12.00	8.00	8.0	11.0	8.00	4.93
183+88.00	SB	DL	6.00	12.00	8.00	8.0	11.0	8.00	4.93
183+88.00	SB	PL	6.00	12.00	8.00	8.0	11.0	8.00	4.93
185+88.00	SB	DL	6.00	12.00	8.00	8.0	11.0	8.00	4.93
185+88.00	SB	PL	6.00	12.00	8.00	8.0	11.0	8.00	4.93
186+87.00	SB	DL	6.00	12.00	8.00	8.0	11.0	8.00	4.93
186+87.00	SB	PL	6.00	12.00	8.00	8.0	11.0	8.00	4.93
195+90.00	SB	DL	6.00	12.00	8.00	8.0	11.0	8.00	4.93
195+90.00	SB	PL	6.00	12.00	8.00	8.0	11.0	8.00	4.93
200+90.00	SB	DL	6.00	12.00	8.00	8.0	11.0	8.00	4.93
200+90.00	SB	PL	6.00	12.00	8.00	8.0	11.0	8.00	4.93
201+90.00	SB	DL	6.00	12.00	8.00	8.0	11.0	8.00	4.93
201+90.00	SB	PL	6.00	12.00	8.00	8.0	11.0	8.00	4.93
203+90.00	SB	DL	6.00	12.00	8.00	8.0	11.0	8.00	4.93
203+90.00	SB	PL	6.00	12.00	8.00	8.0	11.0	8.00	4.93
204+91.00	SB	DL	6.00	12.00	8.00	8.0	11.0	8.00	4.93
204+91.00	SB	PL	6.00	12.00	8.00	8.0	11.0	8.00	4.93
205+91.00	SB	DL	6.00	12.00	8.00	8.0	11.0	8.00	4.93
205+91.00	SB	PL	6.00	12.00	8.00	8.0	11.0	8.00	4.93
206+90.00	SB	DL	6.00	12.00	8.00	8.0	11.0	8.00	4.93
206+90.00	SB	PL	6.00	12.00	8.00	8.0	11.0	8.00	4.93
208+90.00	SB	DL	6.00	12.00	8.00	8.0	11.0	8.00	4.93
208+90.00	SB	PL	6.00	12.00	8.00	8.0	11.0	8.00	4.93

TYPE II, 11" SOUTHBOUND RURAL SUBTOTALS = 224.00 137.98

### PARTIAL DEPTH PATCHES, 11 INCH

STATION	DIRECTION	LANE	LENGTH FOOT	WIDTH FOOT	AREA SQ YD	EXISTING OVERLAY THICKNESS (INCH)	PATCH DEPTH (INCH)	X4406310 PARTIAL DEPTH REMOVAL TYPE II, 11" (SQ YD)	X4421000 PARTIAL DEPTH PATCHING (TON)
209+90.00	SB	DL	6.00	12.00	8.00	8.0	11.0	8.00	4.93
209+90.00	SB	PL	6.00	12.00	8.00	8.0	11.0	8.00	4.93
210+89.00	SB	DL	6.00	12.00	8.00	8.0	11.0	8.00	4.93
210+89.00	SB	PL	6.00	12.00	8.00	8.0	11.0	8.00	4.93
212+90.00	SB	DL	6.00	12.00	8.00	8.0	11.0	8.00	4.93
212+90.00	SB	PL	6.00	12.00	8.00	8.0	11.0	8.00	4.93
214+89.00	SB	DL	6.00	12.00	8.00	8.0	11.0	8.00	4.93
214+89.00	SB	PL	6.00	12.00	8.00	8.0	11.0	8.00	4.93
229+94.00	SB	DL	6.00	12.00	8.00	8.0	11.0	8.00	4.93
229+94.00	SB	PL	6.00	12.00	8.00	8.0	11.0	8.00	4.93
230+93.00	SB	DL	6.00	12.00	8.00	8.0	11.0	8.00	4.93
230+93.00	SB	PL	6.00	12.00	8.00	8.0	11.0	8.00	4.93
231+95.00	SB	DL	6.00	12.00	8.00	8.0	11.0	8.00	4.93
231+95.00	SB	PL	6.00	12.00	8.00	8.0	11.0	8.00	4.93
232+96.00	SB	DL	6.00	12.00	8.00	8.0	11.0	8.00	4.93
232+96.00	SB	PL	6.00	12.00	8.00	8.0	11.0	8.00	4.93
235+00.00	SB	DL	6.00	12.00	8.00	8.0	11.0	8.00	4.93
235+00.00	SB	PL	6.00	12.00	8.00	8.0	11.0	8.00	4.93
235+99.00	SB	DL	6.00	12.00	8.00	8.0	11.0	8.00	4.93
235+99.00	SB	PL	6.00	12.00	8.00	8.0	11.0	8.00	4.93
242+01.00	SB	DL	6.00	12.00	8.00	8.0	11.0	8.00	4.93
242+01.00	SB	PL	6.00	12.00	8.00	8.0	11.0	8.00	4.93
243+02.00	SB	DL	6.00	12.00	8.00	8.0	11.0	8.00	4.93
243+02.00	SB	PL	6.00	12.00	8.00	8.0	11.0	8.00	4.93
246+03.00	SB	DL	6.00	12.00	8.00	8.0	11.0	8.00	4.93
246+03.00	SB	PL	6.00	12.00	8.00	8.0	11.0	8.00	4.93

TYPE II, 11" SOUTHBOUND RURAL SUBTOTALS = 208.00 128.13

PROJECT TOTALS ON SHEET 38

# SCHEDULE OF QUANTITIES

## PARTIAL DEPTH PATCHES (CONTINUED)



PARTIAL DEPTH PATCHES, 11 INCH

STATION	DIRECTION	LANE	LENGTH FOOT	WIDTH FOOT	AREA SQ YD	EXISTING OVERLAY THICKNESS (INCH)	PATCH DEPTH (INCH)	X4406310 PARTIAL DEPTH REMOVAL TYPE II, 11" (SQ YD)	X4421000 PARTIAL DEPTH PATCHING (TON)
249+65.00	SB	RTL	6.00	12.00	8.00	8.0	11.0	8.00	4.93
249+65.00	SB	DL	6.00	12.00	8.00	8.0	11.0	8.00	4.93
249+65.00	SB	PL	6.00	12.00	8.00	8.0	11.0	8.00	4.93
249+65.00	SB	LTL	6.00	12.00	8.00	8.0	11.0	8.00	4.93
250+64.00	SB	DL	6.00	12.00	8.00	8.0	11.0	8.00	4.93
251+66.00	SB	DL	6.00	12.00	8.00	8.0	11.0	8.00	4.93
251+66.00	SB	PL	6.00	12.00	8.00	8.0	11.0	8.00	4.93
252+65.00	SB	DL	6.00	12.00	8.00	8.0	11.0	8.00	4.93
252+65.00	SB	PL	6.00	12.00	8.00	8.0	11.0	8.00	4.93
253+65.00	SB	DL	6.00	12.00	8.00	8.0	11.0	8.00	4.93
253+65.00	SB	PL	6.00	12.00	8.00	8.0	11.0	8.00	4.93
259+69.00	SB	DL	6.00	12.00	8.00	8.0	11.0	8.00	4.93
259+69.00	SB	PL	6.00	12.00	8.00	8.0	11.0	8.00	4.93
260+68.00	SB	DL	6.00	12.00	8.00	8.0	11.0	8.00	4.93
260+68.00	SB	PL	6.00	12.00	8.00	8.0	11.0	8.00	4.93
261+69.00	SB	DL	6.00	12.00	8.00	8.0	11.0	8.00	4.93
261+69.00	SB	PL	6.00	12.00	8.00	8.0	11.0	8.00	4.93
264+69.00	SB	DL	6.00	12.00	8.00	8.0	11.0	8.00	4.93
264+69.00	SB	PL	6.00	12.00	8.00	8.0	11.0	8.00	4.93
266+69.00	SB	DL	6.00	12.00	8.00	8.0	11.0	8.00	4.93
266+69.00	SB	PL	6.00	12.00	8.00	8.0	11.0	8.00	4.93
267+69.00	SB	DL	6.00	12.00	8.00	8.0	11.0	8.00	4.93
267+69.00	SB	PL	6.00	12.00	8.00	8.0	11.0	8.00	4.93
268+70.00	SB	DL	6.00	12.00	8.00	8.0	11.0	8.00	4.93
268+70.00	SB	PL	6.00	12.00	8.00	8.0	11.0	8.00	4.93
271+71.00	SB	DL	6.00	12.00	8.00	8.0	11.0	8.00	4.93
271+71.00	SB	PL	6.00	12.00	8.00	8.0	11.0	8.00	4.93
272+69.00	SB	DL	6.00	12.00	8.00	8.0	11.0	8.00	4.93
272+69.00	SB	PL	6.00	12.00	8.00	8.0	11.0	8.00	4.93

TYPE II, 11" SOUTHBOUND RURAL SUBTOTALS = 232.00 142.91

PARTIAL DEPTH PATCHES, 11 INCH

STATION	DIRECTION	LANE	LENGTH FOOT	WIDTH FOOT	AREA SQ YD	EXISTING OVERLAY THICKNESS (INCH)	PATCH DEPTH (INCH)	X4406310 PARTIAL DEPTH REMOVAL TYPE II, 11" (SQ YD)	X4421000 PARTIAL DEPTH PATCHING (TON)
275+92.00	SB	DL	6.00	12.00	8.00	8.0	11.0	8.00	4.93
275+92.00	SB	PL	6.00	12.00	8.00	8.0	11.0	8.00	4.93
276+72.00	SB	DL	6.00	12.00	8.00	8.0	11.0	8.00	4.93
276+72.00	SB	PL	6.00	12.00	8.00	8.0	11.0	8.00	4.93
277+71.00	SB	DL	6.00	12.00	8.00	8.0	11.0	8.00	4.93
277+71.00	SB	PL	6.00	12.00	8.00	8.0	11.0	8.00	4.93
278+71.00	SB	DL	6.00	12.00	8.00	8.0	11.0	8.00	4.93
278+71.00	SB	PL	6.00	12.00	8.00	8.0	11.0	8.00	4.93
282+75.00	SB	DL	6.00	12.00	8.00	8.0	11.0	8.00	4.93
282+75.00	SB	PL	6.00	12.00	8.00	8.0	11.0	8.00	4.93
283+75.00	SB	DL	6.00	12.00	8.00	8.0	11.0	8.00	4.93
283+75.00	SB	PL	6.00	12.00	8.00	8.0	11.0	8.00	4.93
286+73.00	SB	DL	6.00	12.00	8.00	8.0	11.0	8.00	4.93
286+73.00	SB	PL	6.00	12.00	8.00	8.0	11.0	8.00	4.93
287+86.00	SB	DL	6.00	12.00	8.00	8.0	11.0	8.00	4.93
287+86.00	SB	PL	6.00	12.00	8.00	8.0	11.0	8.00	4.93
303+77.00	SB	DL	6.00	12.00	8.00	8.0	11.0	8.00	4.93
303+77.00	SB	PL	6.00	12.00	8.00	8.0	11.0	8.00	4.93
304+76.00	SB	DL	6.00	12.00	8.00	8.0	11.0	8.00	4.93
304+76.00	SB	PL	6.00	12.00	8.00	8.0	11.0	8.00	4.93
309+80.00	SB	DL	6.00	12.00	8.00	8.0	11.0	8.00	4.93
309+80.00	SB	PL	6.00	12.00	8.00	8.0	11.0	8.00	4.93
310+80.00	SB	DL	6.00	12.00	8.00	8.0	11.0	8.00	4.93
310+80.00	SB	PL	6.00	12.00	8.00	8.0	11.0	8.00	4.93
311+81.00	SB	DL	6.00	12.00	8.00	8.0	11.0	8.00	4.93
311+81.00	SB	PL	6.00	12.00	8.00	8.0	11.0	8.00	4.93
312+81.00	SB	DL	6.00	12.00	8.00	8.0	11.0	8.00	4.93
312+81.00	SB	PL	6.00	12.00	8.00	8.0	11.0	8.00	4.93

TYPE II, 11" SOUTHBOUND RURAL SUBTOTALS = 224.00 137.98

PROJECT TOTALS ON SHEET 38



# SCHEDULE OF QUANTITIES

## PARTIAL DEPTH PATCHES (CONTINUED)

PARTIAL DEPTH PATCHES, 11 INCH

STATION	DIRECTION	LANE	LENGTH FOOT	WIDTH FOOT	AREA SQ YD	EXISTING OVERLAY THICKNESS (INCH)	PATCH DEPTH (INCH)	X4406310 PARTIAL DEPTH REMOVAL TYPE II, 11" (SQ YD)	X4421000 PARTIAL DEPTH PATCHING (TON)
314+81.00	SB	DL	8.00	12.00	10.67	8.0	11.0	10.67	6.57
314+81.00	SB	PL	8.00	12.00	10.67	8.0	11.0	10.67	6.57
315+82.00	SB	DL	6.00	12.00	8.00	8.0	11.0	8.00	4.93
315+82.00	SB	PL	6.00	12.00	8.00	8.0	11.0	8.00	4.93
316+82.00	SB	DL	8.00	12.00	10.67	8.0	11.0	10.67	6.57
316+82.00	SB	PL	8.00	12.00	10.67	8.0	11.0	10.67	6.57
317+83.00	SB	DL	8.00	12.00	10.67	8.0	11.0	10.67	6.57
317+83.00	SB	PL	8.00	12.00	10.67	8.0	11.0	10.67	6.57
318+82.00	SB	DL	6.00	12.00	8.00	8.0	11.0	8.00	4.93
318+82.00	SB	PL	6.00	12.00	8.00	8.0	11.0	8.00	4.93
319+83.00	SB	DL	10.00	12.00	13.33	8.0	11.0	13.33	8.21
319+83.00	SB	PL	10.00	12.00	13.33	8.0	11.0	13.33	8.21
320+82.00	SB	DL	8.00	12.00	10.67	8.0	11.0	10.67	6.57
320+82.00	SB	PL	8.00	12.00	10.67	8.0	11.0	10.67	6.57
322+05.00	SB	DL	8.00	12.00	10.67	8.0	11.0	10.67	6.57
322+05.00	SB	PL	8.00	12.00	10.67	8.0	11.0	10.67	6.57
322+83.00	SB	PL	6.00	12.00	8.00	8.0	11.0	8.00	4.93
323+83.00	SB	DL	8.00	12.00	10.67	8.0	11.0	10.67	6.57
323+83.00	SB	PL	8.00	12.00	10.67	8.0	11.0	10.67	6.57
324+25.00	SB	DL	6.00	12.00	8.00	8.0	11.0	8.00	4.93
324+25.00	SB	PL	6.00	12.00	8.00	8.0	11.0	8.00	4.93
324+83.00	SB	DL	6.00	12.00	8.00	8.0	11.0	8.00	4.93
324+83.00	SB	PL	6.00	12.00	8.00	8.0	11.0	8.00	4.93
325+14.00	SB	DL	6.00	12.00	8.00	8.0	11.0	8.00	4.93
325+14.00	SB	PL	6.00	12.00	8.00	8.0	11.0	8.00	4.93
325+44.00	SB	DL	6.00	12.00	8.00	8.0	11.0	8.00	4.93

X4406310  
PARTIAL  
DEPTH  
REMOVAL  
TYPE II, 11"  
(SQ YD)

TYPE II, 11" SOUTHBOUND RURAL SUBTOTALS = 250.67 154.41

			PARTIAL DEPTH REMOVAL (SQ YD)	PARTIAL DEPTH PATCHING (TON)
SHEET 34	X4406110	TYPE II, 11"	242.67	149.48
SHEET 35	X4406110	TYPE II, 11"	96.00	59.14
NORTHBOUND URBAN SUBTOTALS =			242.67	149.48
SOUTHBOUND URBAN SUBTOTALS =			96.00	59.14
SHEET 34	X4406110	TYPE II, 11"	245.33	151.13
SHEET 35	X4406110	TYPE II, 11"	144.00	88.70
NORTHBOUND RURAL SUBTOTALS =			245.33	151.13
SOUTHBOUND RURAL SUBTOTALS =			144.00	88.70
SHEET 36	X4406110	TYPE II, 11"	224.00	137.98
SHEET 36	X4406110	TYPE II, 11"	208.00	128.13
SHEET 37	X4406110	TYPE II, 11"	232.00	142.91
SHEET 37	X4406110	TYPE II, 11"	224.00	137.98
SHEET 38	X4406110	TYPE II, 11"	250.67	154.41
SOUTHBOUND RURAL SUBTOTALS =			250.67	154.41
TYPE II, 11" URBAN SUBTOTALS =			338.67	208.62
TYPE II, 11" RURAL SUBTOTALS =			1528.00	941.24
TYPE II, 11" TOTAL =			1866.67	1149.86
USE =			1,867.00	1150.00
SHEET 34	X4406710	TYPE IV, 11"	40.00	24.64
SHEET 35	X4406710	TYPE IV, 11"	33.33	20.53
SHEET 35	X4406710	TYPE IV, 11"	33.33	20.53
NORTHBOUND RURAL SUBTOTALS =			40.00	24.64
NORTHBOUND RURAL SUBTOTALS =			33.33	20.53
NORTHBOUND RURAL SUBTOTALS =			33.33	20.53
TYPE IV, 11" RURAL SUBTOTALS =			106.66	65.70
TYPE IV, 11" TOTAL =			106.66	65.70
USE =			106.00	66.00
PROJECT TOTALS =			1,973.00	1,216.00

4-12-17

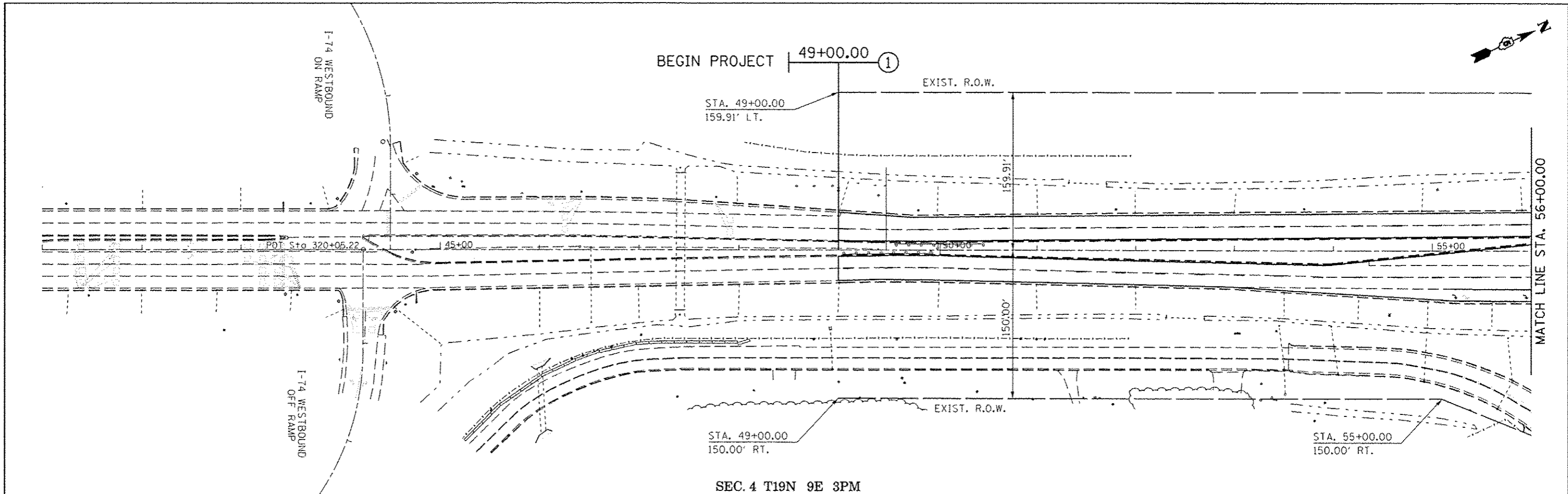

SEC. 4 T19N 9E 3PM

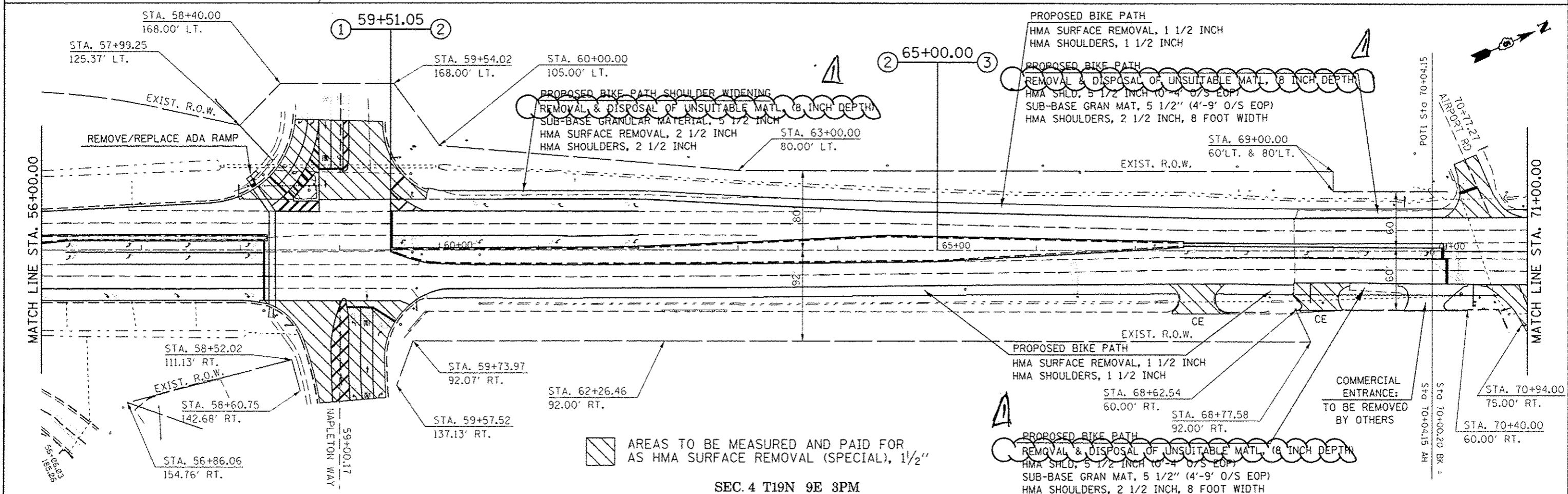

SEC. 4 T19N 9E 3PM

FILE NAME :	USER NAME :	DESIGNED :	REVISED :	<b>STATE OF ILLINOIS DEPARTMENT OF TRANSPORTATION</b>	<b>PLAN SHEET</b>	F.A.P. RTE.	SECTION	COUNTY	TOTAL SHEETS	SHEET NO.	
pw\jll84EBIDINTEG\Illinois.gov\PKIDOT\Documents\1001\Offices\District 5\Projects\0577\Drawn\0577\05779-ehs-061\11.56	blackrt	DRAWN	REVISED			800	(28X-1, 29X-1RS-4	CHAMPAIGN	192	61	
PLOT SCALE = 1/8" = 1'-0"		CHECKED	REVISED			SCALE: 1" = 50'		SHEET 1 OF 10 SHEETS		STA. 45+00.00 TO STA. 71+00.00	
PLOT DATE = 4/3/2017		DATE	REVISED			[ILLINOIS] FED. AID PROJECT					

REV 4-12-17

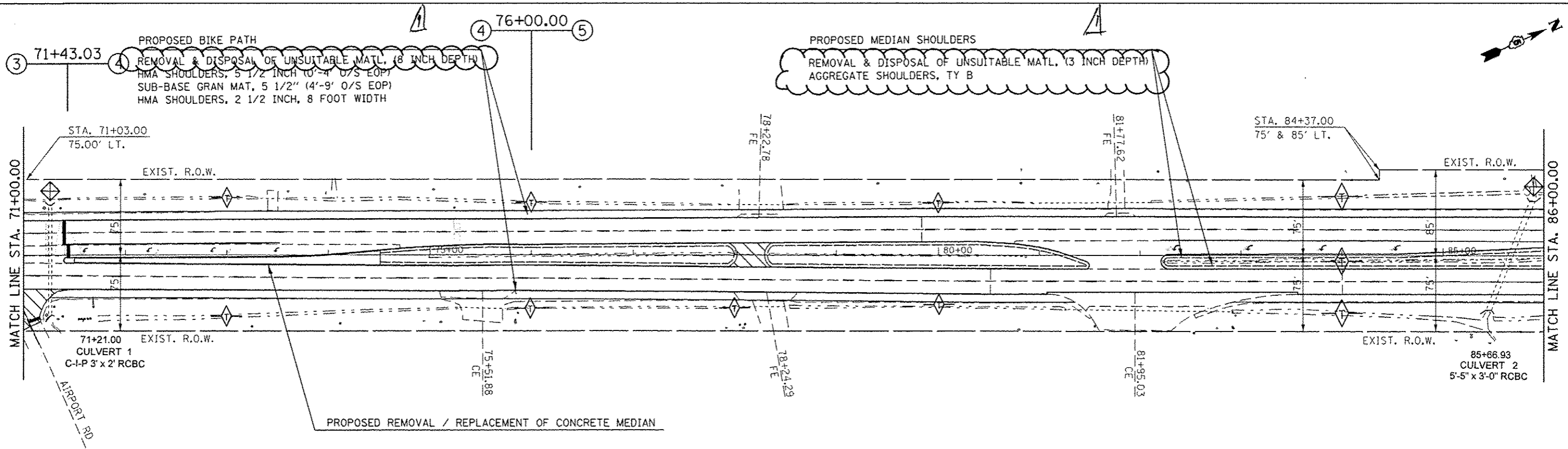

SEC. 33 T20N 9E 3PM

AREAS TO BE MEASURED AND PAID FOR AS HMA SURFACE REMOVAL (SPECIAL), 1 1/2"

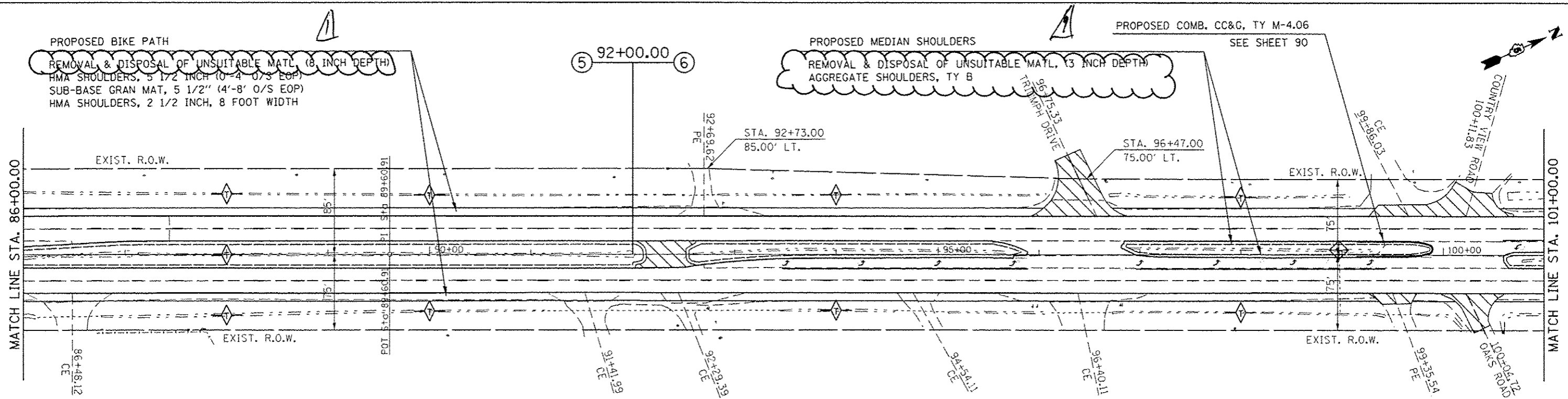

SEC. 33 T20N 9E 3PM

- INLET AND PIPE PROTECTION
- TEMPORARY DITCH CHECK, 12' (UNLESS OTHERWISE SPECIFIED)

STATE OF ILLINOIS  
DEPARTMENT OF TRANSPORTATION

PLAN SHEET

FILE NAME :	USER NAME :	DESIGNED :	REVISED :	SCALE: 1" = 50'	SHEET 2 OF 10 SHEETS	STA. 71+00.00 TO STA. 101+00.00	F.A.P. RTE.	SECTION	COUNTY	TOTAL SHEETS	SHEET NO.
							800	(28X-1, 29X-1RS-4	CHAMPAIGN	192	62
							CONTRACT NO. 70779				
							ILLINOIS FED. AID PROJECT				

REV 4-12-17



SEC. 28 T20N 9E 3PM

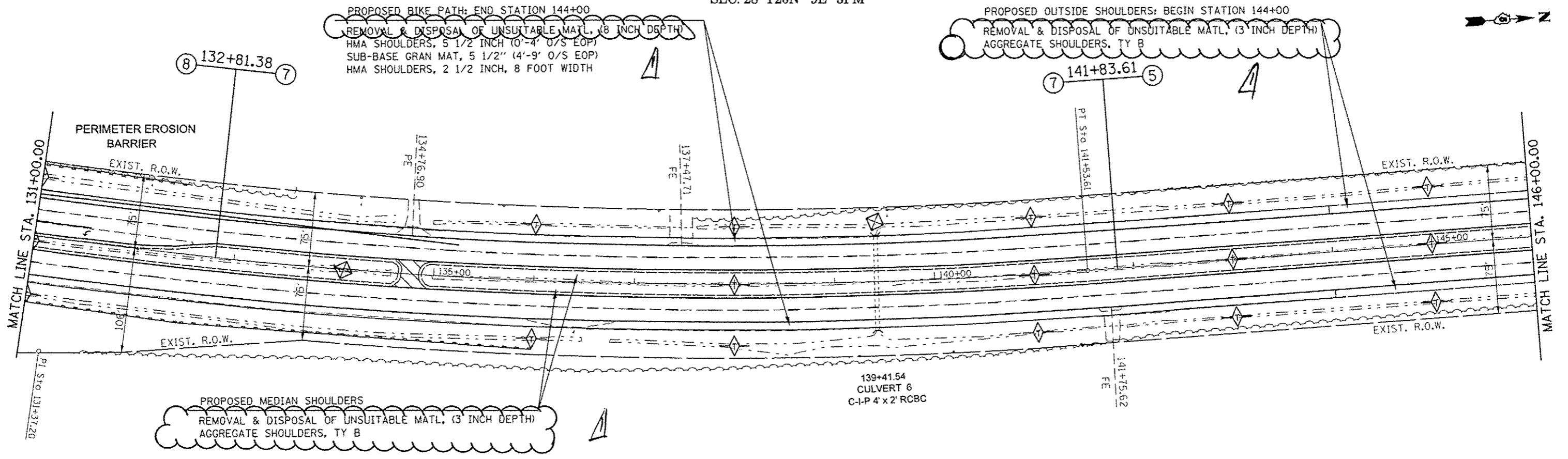

SEC. 27 T20N 9E 3PM

SEC. 28 T20N 9E 3PM

AREAS TO BE MEASURED AND PAID FOR AS HMA SURFACE REMOVAL (SPECIAL), 1/2"

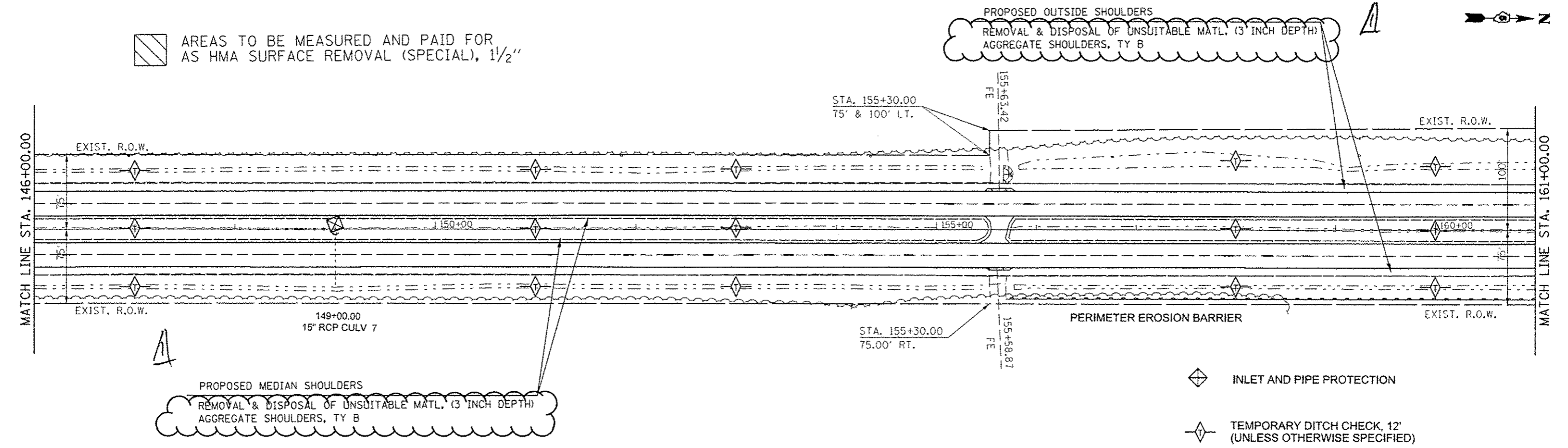

SEC. 27 T20N 9E 3PM

FILE NAME :	USER NAME : blackrt	DESIGNED -	REVISED -	<b>STATE OF ILLINOIS DEPARTMENT OF TRANSPORTATION</b>	<b>PLAN SHEET</b>	F.A.P. RTE.:	SECTION	COUNTY	TOTAL SHEETS	SHEET NO.
PROJECT :	PROJECT :	CHECKED -	REVISED -			800	(28X-1, 29X-1)RS-4	CHAMPAIGN	192	64
PLOT SCALE :	PLOT DATE :	DATE -	REVISED -			SCALE: 1" = 50'		SHEET 4 OF 10 SHEETS		STA. 131+00.00 TO STA. 161+00.00

REV 4-12-17

SEC. 28 T20N 9E 3PM

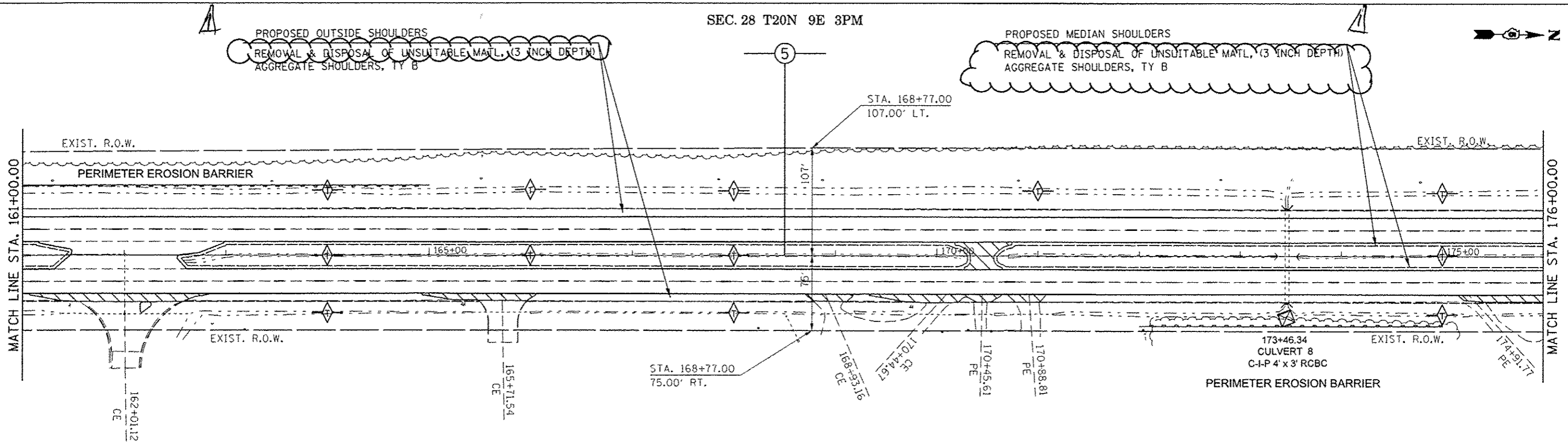

AREAS TO BE MEASURED AND PAID FOR AS HMA SURFACE REMOVAL (SPECIAL), 1/2"

SEC. 27 T20N 9E 3PM

SEC. 28 T20N 9E 3PM

SEC. 21 T20N 9E 3PM

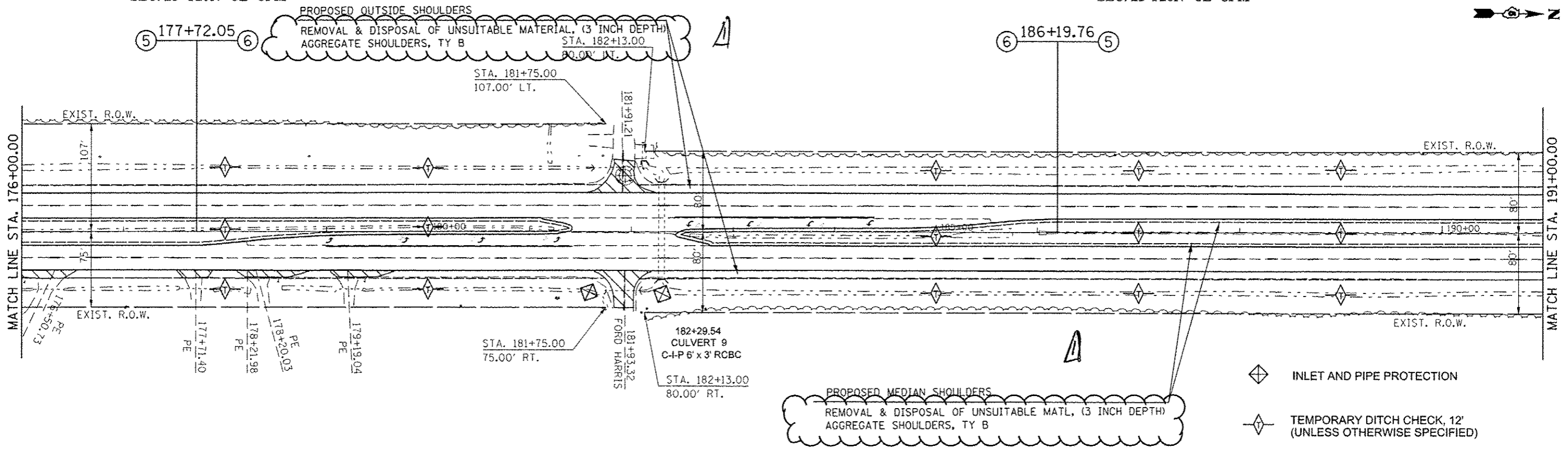

- ◆ INLET AND PIPE PROTECTION
- ◆ TEMPORARY DITCH CHECK, 12' (UNLESS OTHERWISE SPECIFIED)

SEC. 27 T20N 9E 3PM

SEC. 22 T20N 9E 3PM

FILE NAME :	USER NAME : blackrt	DESIGNED -	REVISED -	<b>STATE OF ILLINOIS DEPARTMENT OF TRANSPORTATION</b>	<b>PLAN SHEET</b>	F.A.P. RTE.	SECTION	COUNTY	TOTAL SHEETS	SHEET NO.
PROJECT :	PROJECT :	DRAWN :	REVISED :			800	(28X-1, 29X-URS-4)	CHAMPAIGN	192	65
PLOT SCALE : 1/8" = 1' / in.	CHECKED -	REVISED -	REVISED -			CONTRACT NO. 70779				
PLOT DATE : 4/23/2017	DATE -	REVISED -	REVISED -			ILLINOIS FED. AID PROJECT				

REV 4-12-17

SEC. 21 T20N 9E 3PM

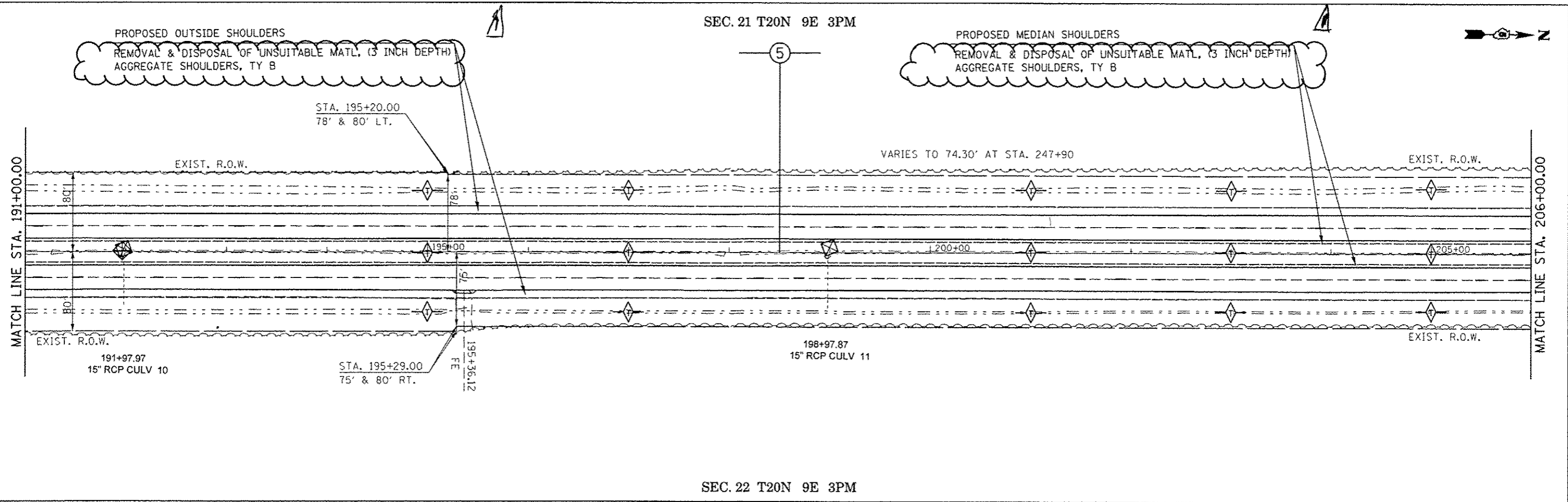

SEC. 22 T20N 9E 3PM

SEC. 21 T20N 9E 3PM

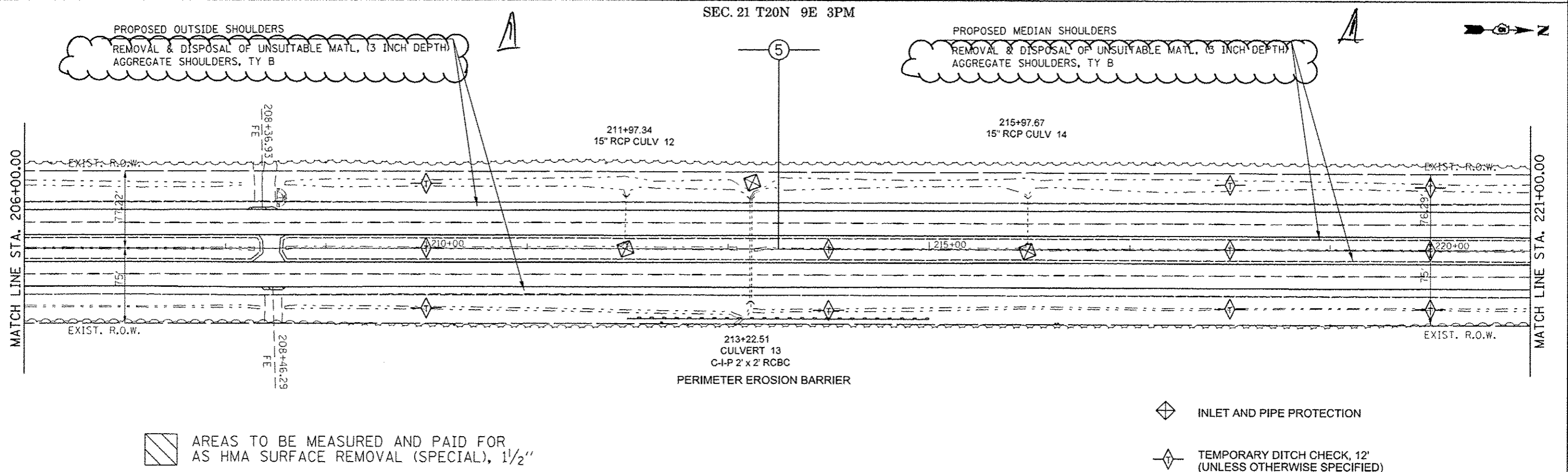

 AREAS TO BE MEASURED AND PAID FOR AS HMA SURFACE REMOVAL (SPECIAL), 1 1/2"

 INLET AND PIPE PROTECTION

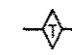

 TEMPORARY DITCH CHECK, 12' (UNLESS OTHERWISE SPECIFIED)

SEC. 22 T20N 9E 3PM

FILE NAME :	USER NAME : black-t	DESIGNED -	REVISED -	<b>STATE OF ILLINOIS DEPARTMENT OF TRANSPORTATION</b>	<b>PLAN SHEET</b>		F.A.P. RTE.	SECTION	COUNTY	TOTAL SHEETS	SHEET NO.		
path: \\L804EB\ID\INTEG\Illinois.gov\PWIDOT\Documents\DOT Offices\District 5\Projects\057\DRAWN\Design\0570779-sh1-06\PI\58	PLT SCALE : 1/8"=1'-0"	CHECKED -	REVISED -				800	(28X-1, 29X-URS-4	CHAMPAIGN	192	66		
#MODELNAME#	PLT DATE : 4/3/2017	DATE -	REVISED -				SCALE: 1" = 50'		SHEET 6 OF 10 SHEETS		STA. 191+00.00 TO STA. 221+00.00		CONTRACT NO. 70779
							ILLINOIS FED. AID PROJECT						

REV 4-12-17

SEC. 21 T20N 9E 3PM

-  INLET AND PIPE PROTECTION
-  TEMPORARY DITCH CHECK, 12' (UNLESS OTHERWISE SPECIFIED)

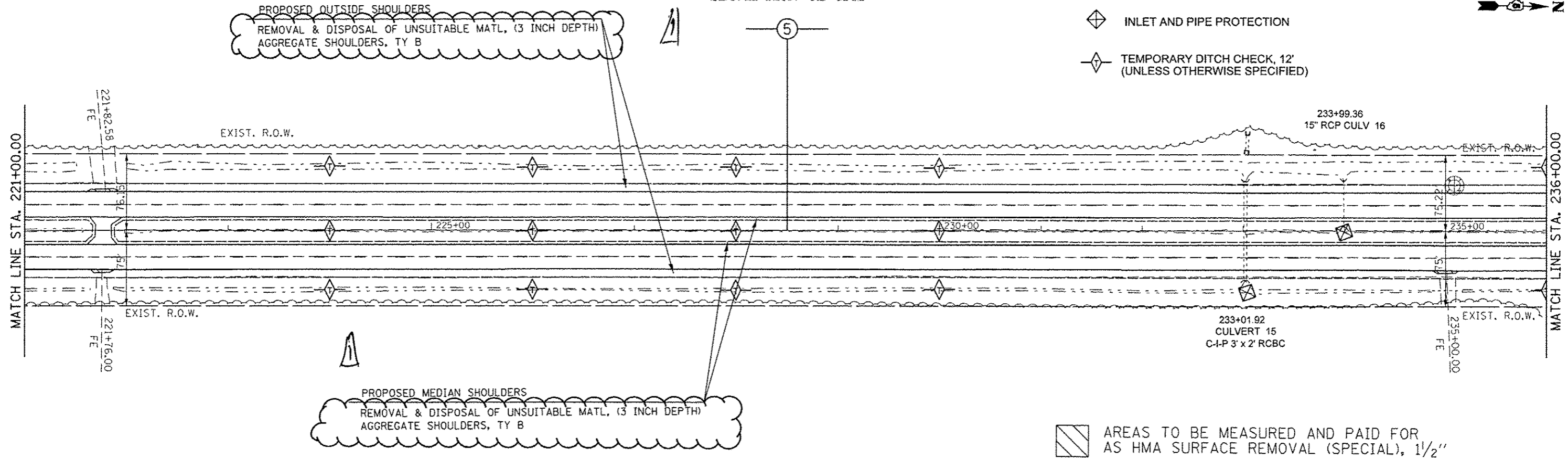

 AREAS TO BE MEASURED AND PAID FOR AS HMA SURFACE REMOVAL (SPECIAL), 1 1/2"

SEC. 22 T20N 9E 3PM

SEC. 21 T20N 9E 3PM

SEC. 16 T20N 9E 3PM

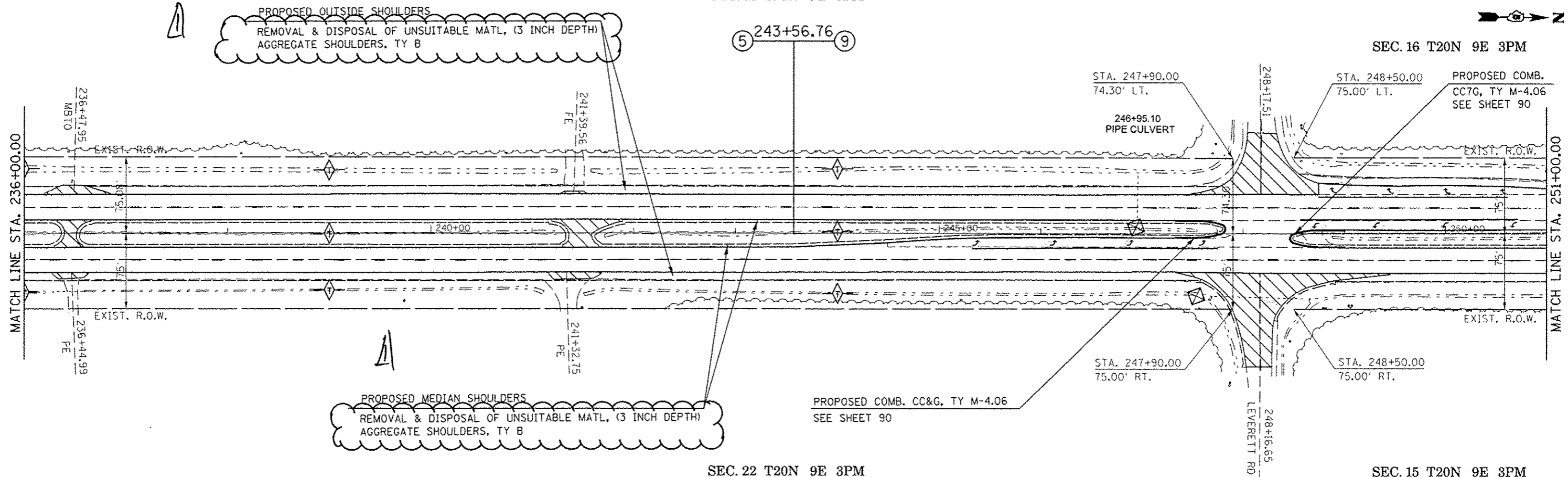

SEC. 22 T20N 9E 3PM

SEC. 15 T20N 9E 3PM

FILE NAME :	USER NAME : blackrt	DESIGNED -	REVISED -	<b>STATE OF ILLINOIS DEPARTMENT OF TRANSPORTATION</b>	<b>PLAN SHEET</b>	F.A.P. RTE.:	SECTION	COUNTY	TOTAL SHEETS	SHEET NO.
pw:\IL084E010\INTEG.illinois.gov\FWIDOT\Documents\DOT Offices\District 9\Projects\0579\DRAWN\Design\0579779-shr-06\Pln_58	DRAWN	REVISED	800			(28X-1, 29X-1)RS-4	CHAMPAIGN	192	67	
PLOT SCALE = 100.0000' / in.	CHECKED -	REVISED -	CONTRACT NO. 70779							
PLOT DATE = 4/3/2017	DATE -	REVISED -	ILLINOIS FED. AID PROJECT							
#MODELNAME#				SCALE: 1" = 50'		SHEET 7 OF 10 SHEETS		STA. 221+00.00 TO STA. 251+00.00		REV 4-12-17



SEC. 16 T20N 9E 3PM

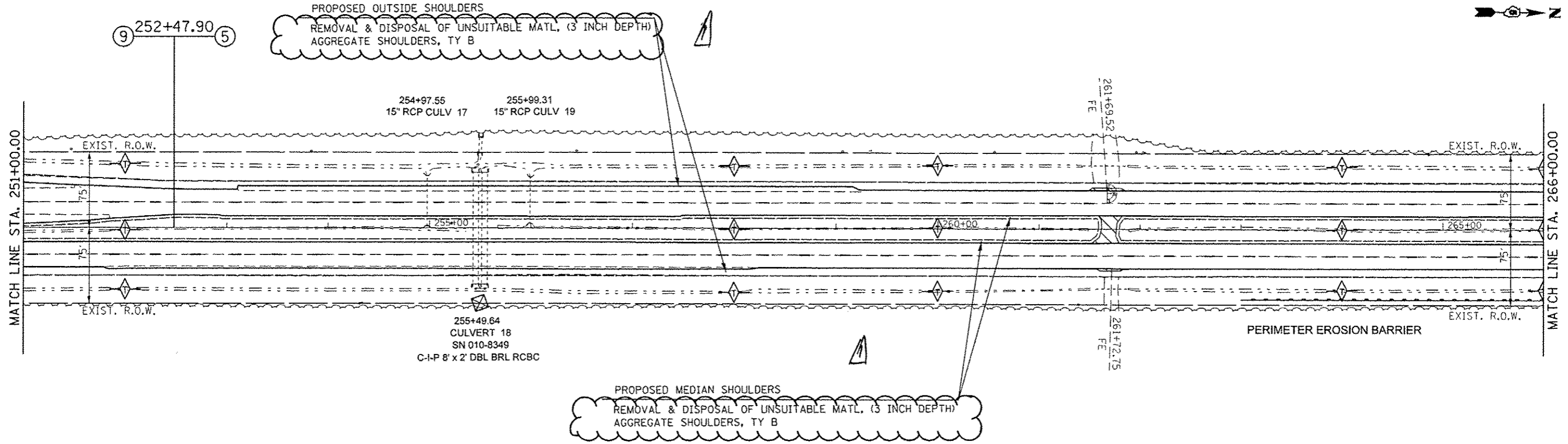

SEC. 15 T20N 9E 3PM

SEC. 16 T20N 9E 3PM

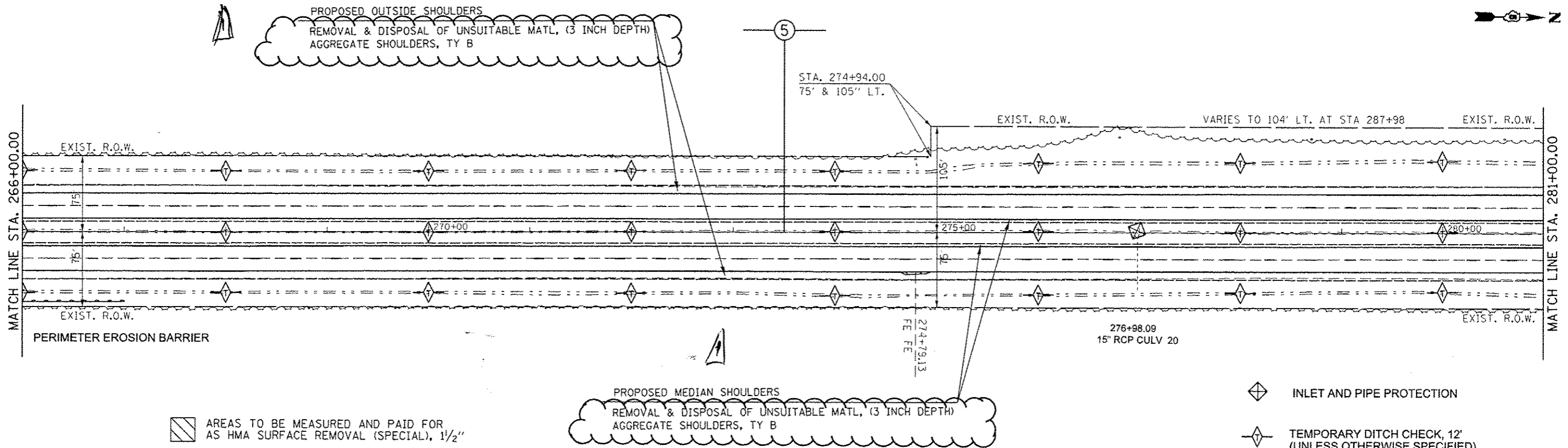

AS HMA SURFACE REMOVAL (SPECIAL), 1 1/2"

- INLET AND PIPE PROTECTION
- TEMPORARY DITCH CHECK, 12' (UNLESS OTHERWISE SPECIFIED)

SEC. 15 T20N 9E 3PM

FILE NAME :	USER NAME :	DESIGNED :	REVISED :	<b>STATE OF ILLINOIS DEPARTMENT OF TRANSPORTATION</b>	<b>PLAN SHEET</b>	F.A.P. RTE. :	SECTION :	COUNTY :	TOTAL SHEETS :	SHEET NO. :	
PROJECT :	DATE :	CHECKED :	REVISED :			800	(28X-1, 29X-URS-4)	CHAMPAIGN	192	68	
SCALE :	DATE :	DATE :	DATE :			CONTRACT NO. 70779					
SCALE: 1" = 50'						SHEET 8 OF 10 SHEETS		STA. 251+00.00 TO STA. 281+00.00			

REV 4-2-17

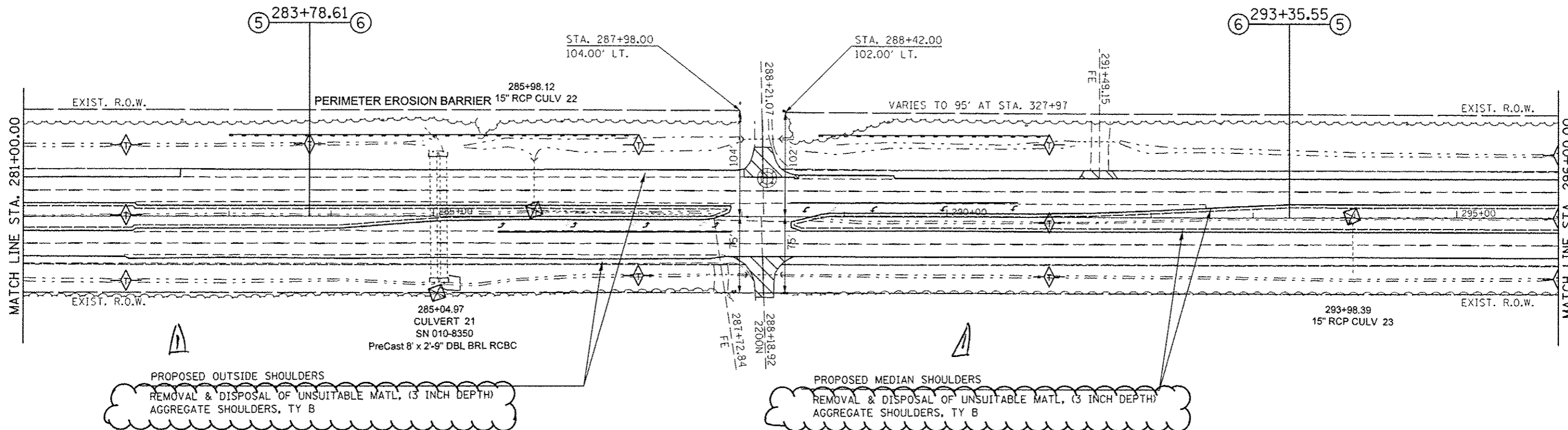

PROPOSED OUTSIDE SHOULDERS  
 REMOVAL & DISPOSAL OF UNSUITABLE MATL, (3 INCH DEPTH)  
 AGGREGATE SHOULDERS, TY B

PROPOSED MEDIAN SHOULDERS  
 REMOVAL & DISPOSAL OF UNSUITABLE MATL, (3 INCH DEPTH)  
 AGGREGATE SHOULDERS, TY B

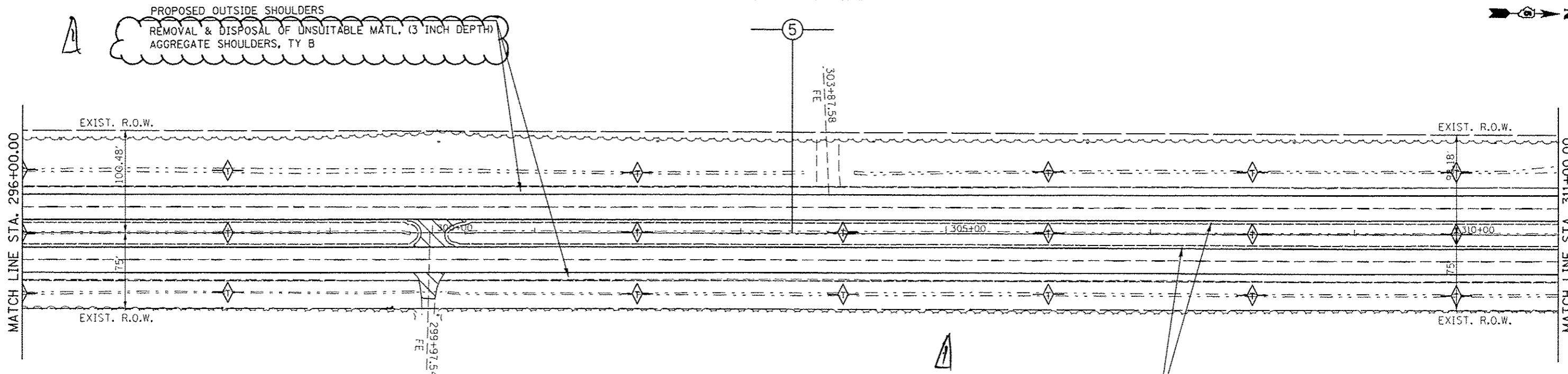

PROPOSED OUTSIDE SHOULDERS  
 REMOVAL & DISPOSAL OF UNSUITABLE MATL, (3 INCH DEPTH)  
 AGGREGATE SHOULDERS, TY B

PROPOSED MEDIAN SHOULDERS  
 REMOVAL & DISPOSAL OF UNSUITABLE MATL, (3 INCH DEPTH)  
 AGGREGATE SHOULDERS, TY B

▨ AREAS TO BE MEASURED AND PAID FOR AS HMA SURFACE REMOVAL (SPECIAL), 1 1/2"

- ◆ INLET AND PIPE PROTECTION
- ◇ TEMPORARY DITCH CHECK, 12' (UNLESS OTHERWISE SPECIFIED)

FILE NAME :	USER NAME :	DESIGNED :	REVISED :	<b>STATE OF ILLINOIS DEPARTMENT OF TRANSPORTATION</b>	<b>PLAN SHEET</b>	F.A.P. RTE.:	SECTION:	COUNTY:	TOTAL SHEETS:	SHEET NO.:	
pw:\IL094ERIDINTEG\Illinois.gov\PIDOT\Documents\DOT Offices\District 5\Projects\0577\DrawnData\Design\057779-shs-0b\Pln.54	blackrt					800	(28X-1, 29X-1RS-4)	CHAMPAIGN	192	69	
PLT SCALE = 1/80.0000' / in.		CHECKED :	REVISED :			SCALE: 1" = 50'		SHEET 9 OF 10 SHEETS		STA. 281+00.00 TO STA. 311+00.00	
PLT DATE = 4/3/2017		DATE :	REVISED :			ILLINOIS FED. AID PROJECT					

REV 4-12-17

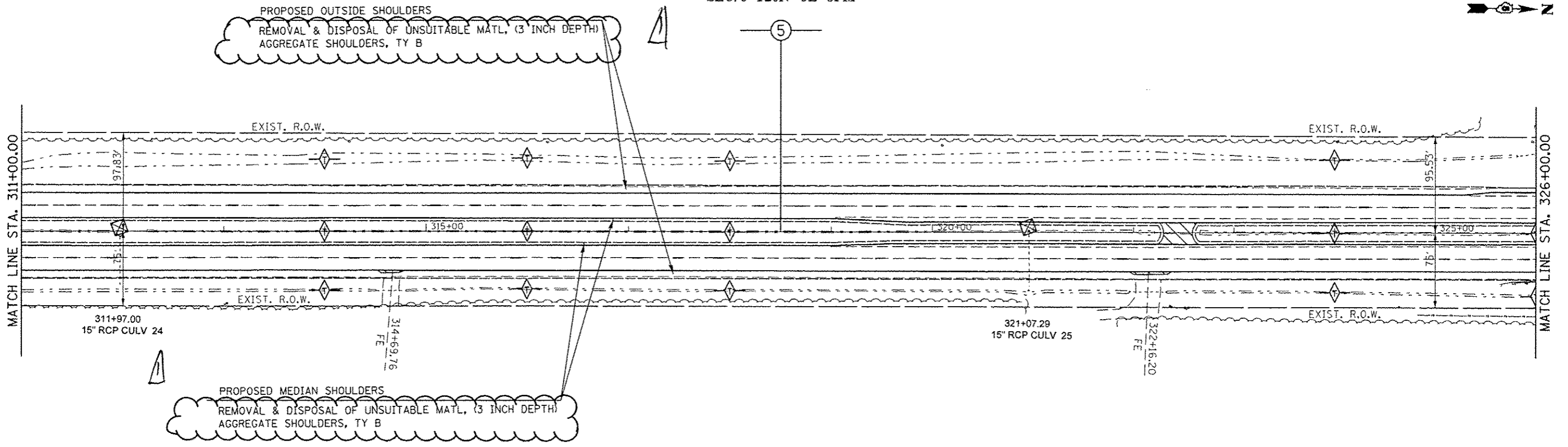

SEC. 9 T20N 9E 3PM

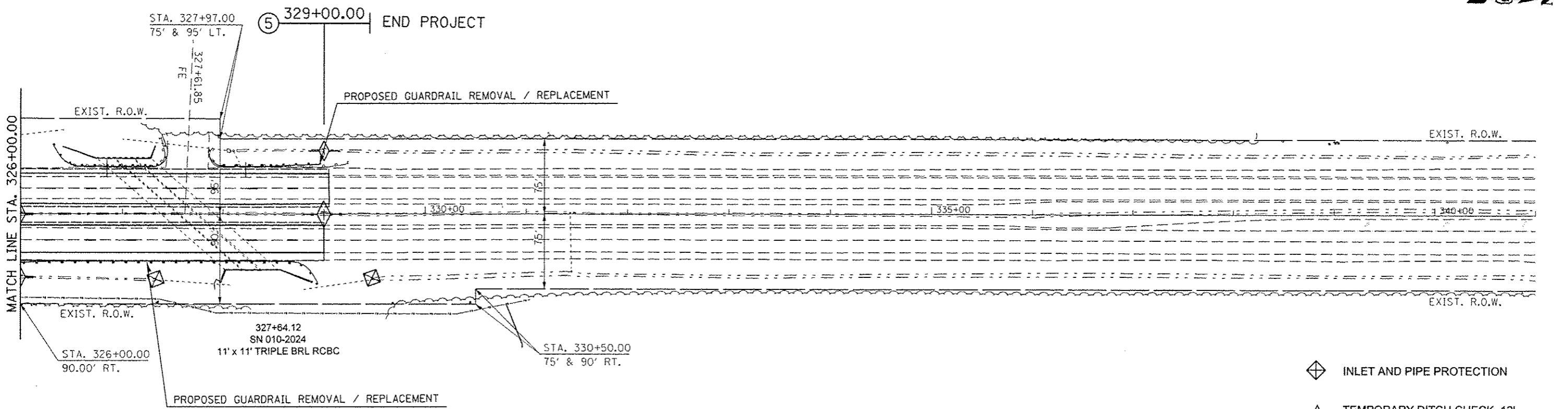
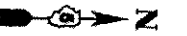

SEC. 10 T20N 9E 3PM

SEC. 9 T20N 9E 3PM



-  INLET AND PIPE PROTECTION
-  TEMPORARY DITCH CHECK, 12' (UNLESS OTHERWISE SPECIFIED)

SEC. 10 T20N 9E 3PM

FILE NAME :	USER NAME : blechrt	DESIGNED -	REVISED -	<b>STATE OF ILLINOIS DEPARTMENT OF TRANSPORTATION</b>	<b>PLAN SHEET</b>	F.A.P. RTE.	SECTION	COUNTY	TOTAL SHEETS	SHEET NO.
g:\1\1884EBIDINTEG\Illinois.gov\PI\DOT\Documents\DOT Offices\District 5\Projects\DS70\DRAWING\Design\DS70779-ehv-DblP1n.5	DRAWN -	REVISED -	800			(28X-1, 29X-1)RS-4	CHAMPAIGN	192	70	
PLOT SCALE : 1/8" = 1' / in.	CHECKED -	REVISED -	CONTRACT NO. 70779							
PLOT DATE : 4/2/2017	DATE -	REVISED -	[ILLINOIS] FED. AID PROJECT							
				SCALE: 1" = 50'		SHEET 10 OF 10 SHEETS		STA. 311+00.00 TO STA. 330+00.00		

A REV 4-12-17