

04-28-2017 LETTING ITEM 107

STATE OF ILLINOIS
DEPARTMENT OF TRANSPORTATION
DIVISION OF HIGHWAYS

**PROPOSED
HIGHWAY PLANS**

FAS ROUTE 522 & FAS ROUTE 525
SECTION (41,48-15,81-15,118)Q-2
PROJECT
BIT SURFACE TREATMENT-A1
CHAMPAIGN COUNTY

C-95-004-17
(2100 E)
SIDNEY/LONGVIEW RD FROM 600N TO BROADLANDS RD &
BROADLANDS RD FROM SIDNEY-LONGVIEW RD TO IL 49

F.A.S. RTE.	SECTION	COUNTY	TOTAL SHEETS	SHEET NO.
*	141,48-15,81-15,118Q-2	CHAMPAIGN	11	1
	ILLINOIS	CONTRACT NO. 70C51		

*F.A.S. ROUTE 522 & F.A.S. ROUTE 525

D-95-004-17

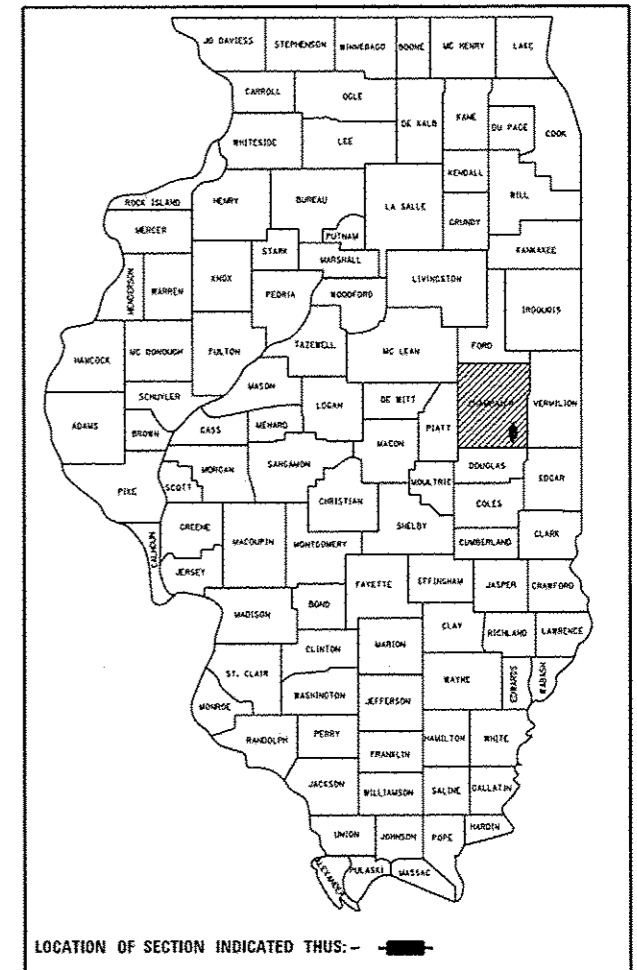

FOR INDEX OF SHEETS, SEE SHEET NO. 2
FOR SUMMARY OF QUANTITIES, SEE SHEET NO. 4

TRAFFIC DATA - SEE LOCATION MAPS

DESIGN DESIGNATION
N/A

FOR LOCATION MAPS, SEE SHEET NO. 3

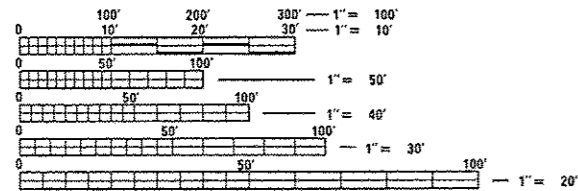

FULL SIZE PLANS HAVE BEEN PREPARED USING STANDARD ENGINEERING SCALES. REDUCED SIZED PLANS WILL NOT CONFORM TO STANDARD SCALES. IN MAKING MEASUREMENTS ON REDUCED PLANS, THE ABOVE SCALES MAY BE USED.

J.U.L.I.E.
JOINT UTILITY LOCATION INFORMATION FOR EXCAVATION
1-800-892-0123 (RAYMOND & AYERS TOWNSHIPS)
OR 811

PROJECT ENGINEER: NANCY FASIG
SQUAD LEADER: STEVE COOMBES
DESIGNER: CHRISTINA GOSNELL
(217) 465-4181
CONTRACT NO. 70C51

STATE OF ILLINOIS
DEPARTMENT OF TRANSPORTATION
DIVISION OF HIGHWAYS

SUBMITTED January 31 20 17
James C. James
REGIONAL ENGINEER

Mar 24 20 17
Margaret M. Addis
ENGINEER OF DESIGN AND ENVIRONMENT

Mar 24 20 17
Amel Al-Obeidi
DIRECTOR OF PROGRAM DEVELOPMENT

PRINTED BY THE AUTHORITY
OF THE STATE OF ILLINOIS

INDEX OF SHEETS

SHEET NO.	DESCRIPTION
1	COVER SHEET
2	INDEX OF SHEETS
2	HIGHWAY STANDARDS
2	GENERAL NOTES
3	LOCATION MAPS
4	SUMMARY OF QUANTITIES
5-9	TYPICAL SECTIONS
10-11	SCHEDULE OF QUANTITIES

GENERAL NOTES

G.N.-100
ENGLISH UNITS OF MEASUREMENT SHALL GOVERN OVER AND SUPERSEDE ANY METRIC UNITS SHOWN IN THIS CONTRACT. WHERE INCLUDED, METRIC UNITS ARE FOR INFORMATION ONLY.

G.N.-100A
ELECTRONIC FILES AND/OR ELECTRONIC SURVEY INFORMATION INCLUDING CADD FILES WILL NOT BE AVAILABLE TO THE CONTRACTOR.

G.N.-403 SPL
BITUMINOUS SURFACE TREATMENTS: GRADATION CA-16 (MID SPEC.) IS ASSUMED FOR SEAL COATS. THE AGGREGATE SHALL BE EITHER CRUSHED GRAVEL OR CARBONATE CRUSHED STONE AND SHALL BE CLASS C QUALITY OR BETTER. THE RESULTING TARGET APPLICATION RATES ARE AS FOLLOWS:

TYPE OF CONSTRUCTION	BITUMINOUS MATERIAL	TARGET RATE	AGGREGATE	APPLICATION RATE
TACK COAT (HARD SURFACE)	Art. 406.02	0.05 LB/SQ FT	FA-1 or FA-2	3 LB/SQ YD
A-1	HFP or CRSP	0.35 GAL/SQ YD	CA-16	19 LB/SQ YD

NOTE: THE ENGINEER RESERVES THE RIGHT TO ADJUST THE TARGET APPLICATION RATES AND THE QUANTITIES.

NO COMMITMENTS

HIGHWAY STANDARDS

STANDARD NO.	DESCRIPTION
000001 - 06	STANDARD SYMBOLS, ABBREVIATIONS, AND PATTERNS
001006	DECIMAL OF AN INCH AND OF A FOOT
701301 - 04	LANE CLOSURE, 2L, 2W, SHORT TIME OPERATIONS
701306 - 03	LANE CLOSURE, 2L, 2W, SLOW MOVING OPERATIONS DAY ONLY, FOR SPEEDS >= 45 MPH
701311 - 03	LANE CLOSURE, 2L, 2W, MOVING OPERATIONS - DAY ONLY
701901 - 06	TRAFFIC CONTROL DEVICES
780001 - 05	TYPICAL PAVEMENT MARKINGS

* F.A.S. ROUTE 522 & F.A.S. ROUTE 525

FILE NAME =	USER NAME = goaneljol	DESIGNED -	REVISED -	STATE OF ILLINOIS DEPARTMENT OF TRANSPORTATION	INDEX OF SHEETS, GENERAL NOTES & HIGHWAY STANDARDS	F.A.S. RTE.	SECTION	COUNTY	TOTAL SHEETS	SHEET NO.	
p:\1\12084EB\IDINTEG.illinois.gov\PI\DOT\Documents\1007 Offices\District 5\Projects\0572\DRAWING\Design\0572051-ah-tr-gennotes.d	DRAWN	CHECKED -	REVISED -			*	(41,48-15,61-15,118)Q-2	CHAMPAIGN	11	2	
PLOT SCALE = 48.0000' / in.	DATE -	REVISIONS	SCALE:			SHEET 1 OF 1 SHEETS STA. TO STA.		CONTRACT NO. 70C51			
PLOT DATE = 1/31/2017	DATE -	REVISIONS	[ILLINOIS] FED. AID PROJECT								

LOCATION MAP FOR LOCATION #1

F.A.S. 522 (SIDNEY-LONGVIEW RD) FROM TR 600N TO BROADLANDS RD CHAMPAIGN COUNTY

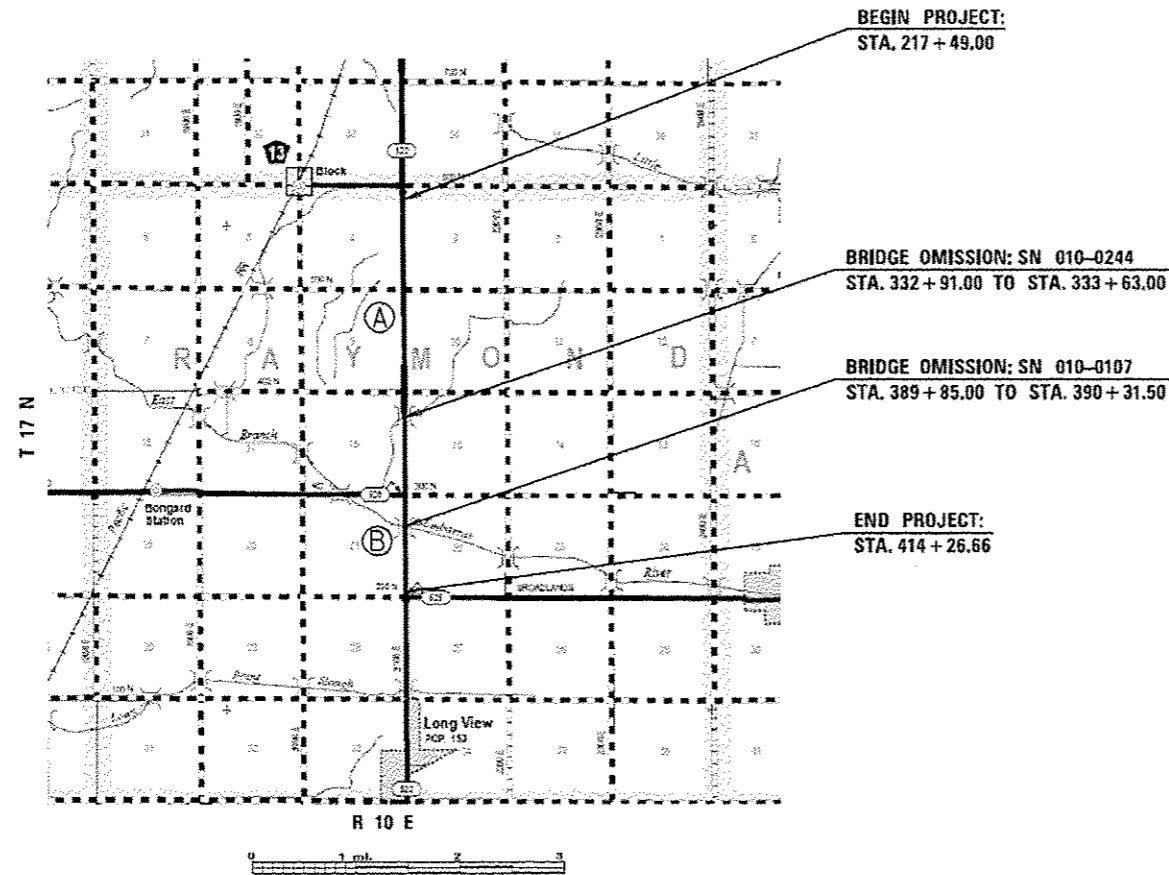

GROSS LENGTH = 19,677.66 FT. = 3.727 MILE
NET LENGTH = 19,559.16 FT. = 3.704 MILE

CURRENT TRAFFIC DATA

F.A.S. ROUTE 522

	LEG "A"	LEG "B"
2016 ADT =	550	750
PV % =	83.7	89.3
SU % =	12.7	6.7
MU% =	3.6	4.0

TRAFFIC DATA LOCATIONS

LEG "A" = 600 N TO F.A.S. 526
LEG "B" = F.A.S. 526 TO F.A.S. 525

LOCATION MAP FOR LOCATION #2

F.A.S. 525 (BROADLANDS RD) FROM SIDNEY-LONGVIEW RD TO IL 49 CHAMPAIGN COUNTY

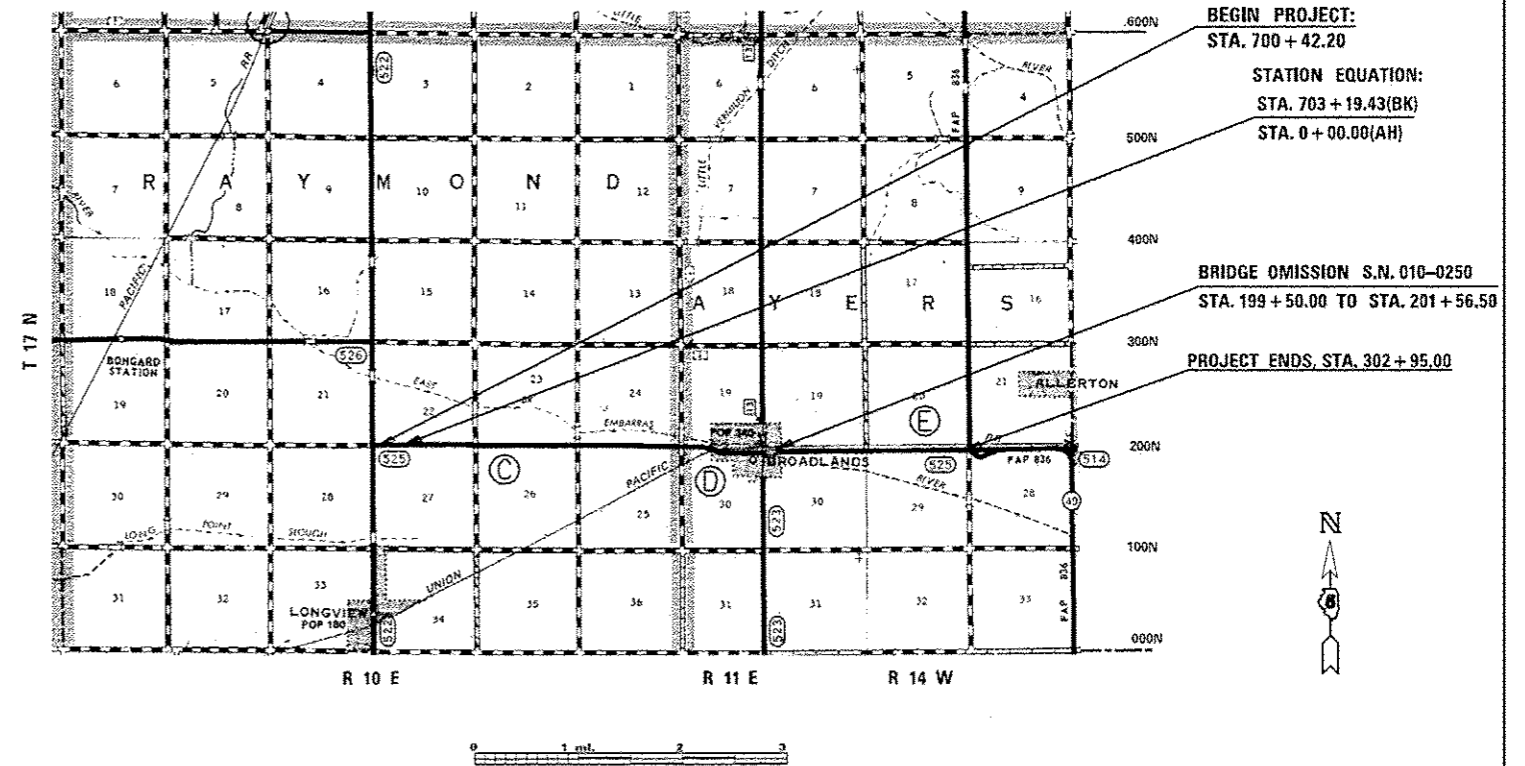

GROSS LENGTH = 30,572.23 FT. = 5.790 MILE
NET LENGTH = 30,365.73 FT. = 5.751 MILE

CURRENT TRAFFIC DATA

F.A.S. ROUTE 525

	LEG "C"	LEG "D"	LEG "E"
2016 ADT =	750	950	700
PV % =	93.3	90.5	88.6
SU % =	4.0	5.3	7.1
MU% =	2.7	4.2	4.3

TRAFFIC DATA LOCATIONS

LEG "C" = 600N TO TR 304 (2400E)
LEG "D" = TR 304 (2400E) TO F.A.S. 523 (MAIN ST)
LEG "E" = F.A.S. 523 (MAIN ST) TO IL 49

100 01 11

LOCATION OF WORK: FAS 522 FAS 525
 RURAL TWO-LANE RURAL TWO-LANE ✓
 MAJOR COLLECTOR MAJOR COLLECTOR
 COUNTY: CHAMPAIGN COUNTY CHAMPAIGN COUNTY
 FUNDING BREAKOUT: 100% STATE 100% STATE ✓
 CONSTRUCTION TYPE CODE: 0005 0005 ✓

CODE NO.	ITEM DESCRIPTION	UNIT	TOTAL QUANTITY	QUANTITY	QUANTITY
40300405	POLYMERIZED BITUMINOUS MATERIALS (COVER AND SEAL COAT)	TON	166.0	65.0	101.0
40300600	SEAL COAT AGGREGATE	TON	1,055.0	414.0	641.0
40600290	BITUMINOUS MATERIALS (TACK COAT)	POUND	54,979.0	21,576.0	33,403.0
67100100	MOBILIZATION	L SUM	1.0	0.5	0.5
* 78001110	PAINT PAVEMENT MARKING - LINE 4"	FOOT	120,630.0	50,460.0	70,170.0
X7010216	TRAFFIC CONTROL AND PROTECTION, (SPECIAL)	L SUM	1.0	0.5	0.5
* DENOTES SPECIALTY ITEM					

6

* F.A.S. ROUTE 522 & F.A.S. ROUTE 525

LOCATION #1 (FAS 522)

EXISTING TYPICAL CROSS SECTION ①

STATION	TO	STATION
② 217+49.00		225+49.00 ②
② 230+49.00		236+99.00 ②
② 240+49.00		244+49.00 ②
② 265+49.00		322+99.00 ②

GUTTER LOCATIONS

DETAIL "A"

LT. STA.	269+04	TO	STA.	272+42
LT. STA.	278+85	TO	STA.	284+93
LT. STA.	298+10	TO	STA.	301+92
RT. STA.	278+87	TO	STA.	284.92
RT. STA.	298+10	TO	STA.	302.30
RT. STA.	311+07	TO	STA.	317+94

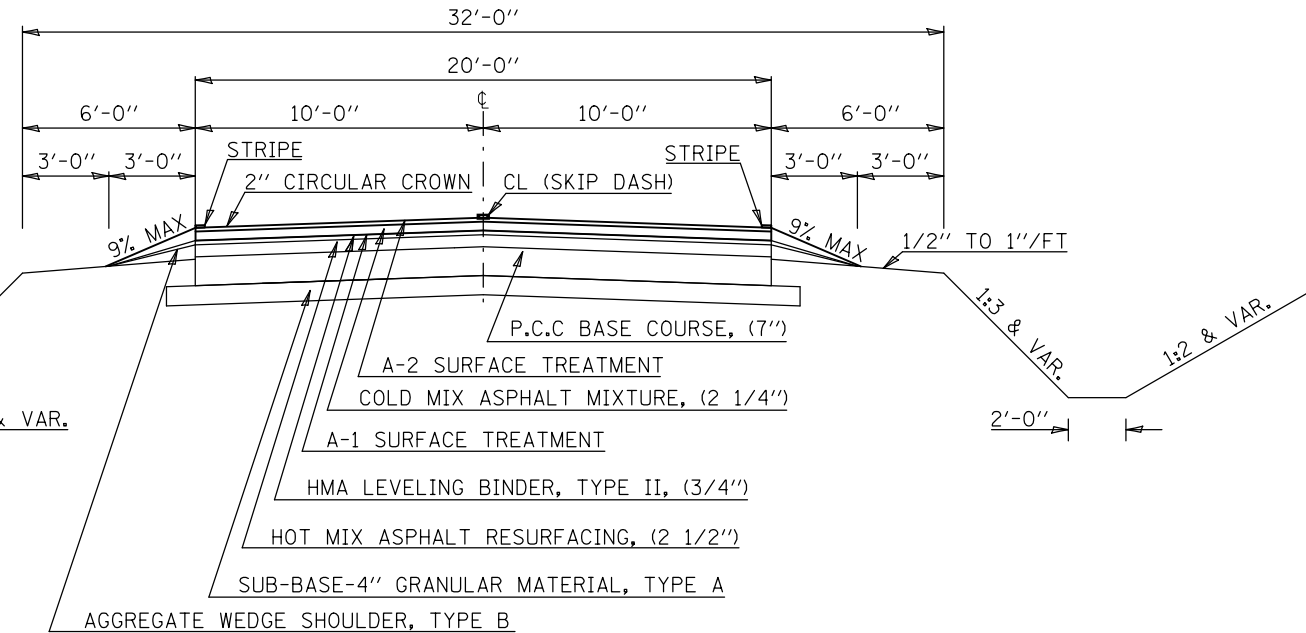
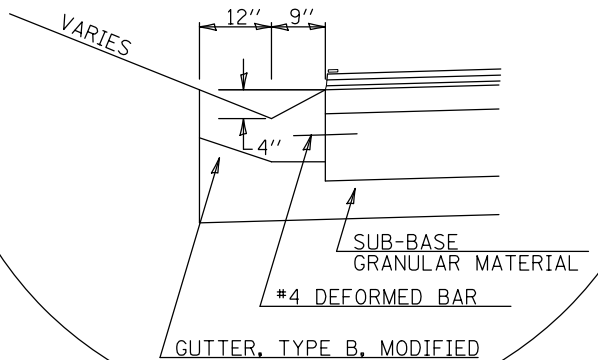

LOCATION #1 (FAS 522)

PROPOSED TYPICAL CROSS SECTION ①

STATION	TO	STATION
② 217+49.00		225+49.00 ②
② 230+49.00		236+99.00 ②
② 240+49.00		244+49.00 ②
② 265+49.00		322+99.00 ②

GUTTER LOCATIONS

DETAIL "A"

LT. STA.	269+04	TO	STA.	272+42
LT. STA.	278+85	TO	STA.	284+93
LT. STA.	298+10	TO	STA.	301+92
RT. STA.	278+87	TO	STA.	284.92
RT. STA.	298+10	TO	STA.	302.30
RT. STA.	311+07	TO	STA.	317+94

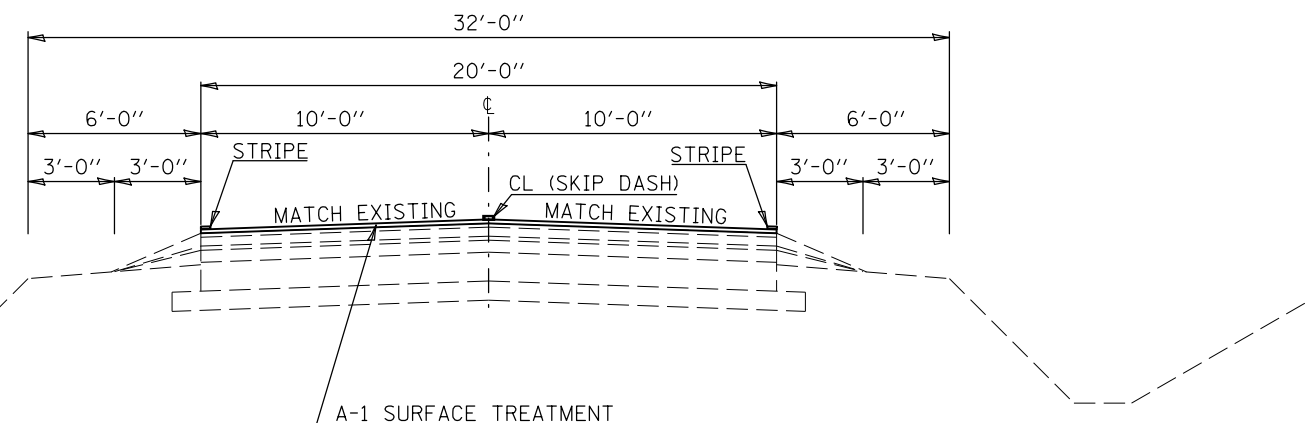
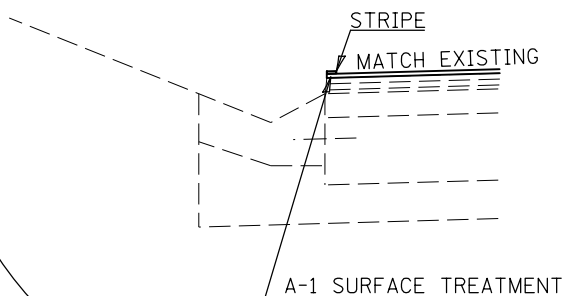

• F.A.S. ROUTE 522 & F.A.S. ROUTE 525

FILE NAME =	USER NAME = coombessf	DESIGNED -	REVISED -	STATE OF ILLINOIS DEPARTMENT OF TRANSPORTATION	LOCATION #1 EXISTING & PROPOSED TYPICAL SECTION	F.A.S. RTE.	SECTION	COUNTY	TOTAL SHEETS	SHEET NO.	
p:\11\084EBIDINTEG.illinois.gov\PIDOT\Documents\DOT Offices\District 5\Projects\057\DRAWING\Design\057051-shr-typical.dgn						(41,48-15,81-15,118)0-2	CHAMPAIGN	11	5		
PLOT SCALE = 40.0000' / in.						CONTRACT NO. 70C51					
PLOT DATE = 1/23/2017						SCALE: _____ SHEET 1 OF 5 SHEETS STA. _____ TO STA. _____		ILLINOIS FED. AID PROJECT			

LOCATION #1 (FAS 522)

EXISTING TYPICAL CROSS SECTION ②

STATION	TO	STATION
① 225+49.00		230+49.00 ①
① 236+99.00		240+49.00 ①
① 244+49.00		265+49.00 ①
① 322+99.00		331+41.00 ③
③ 335+13.00		414+26.66

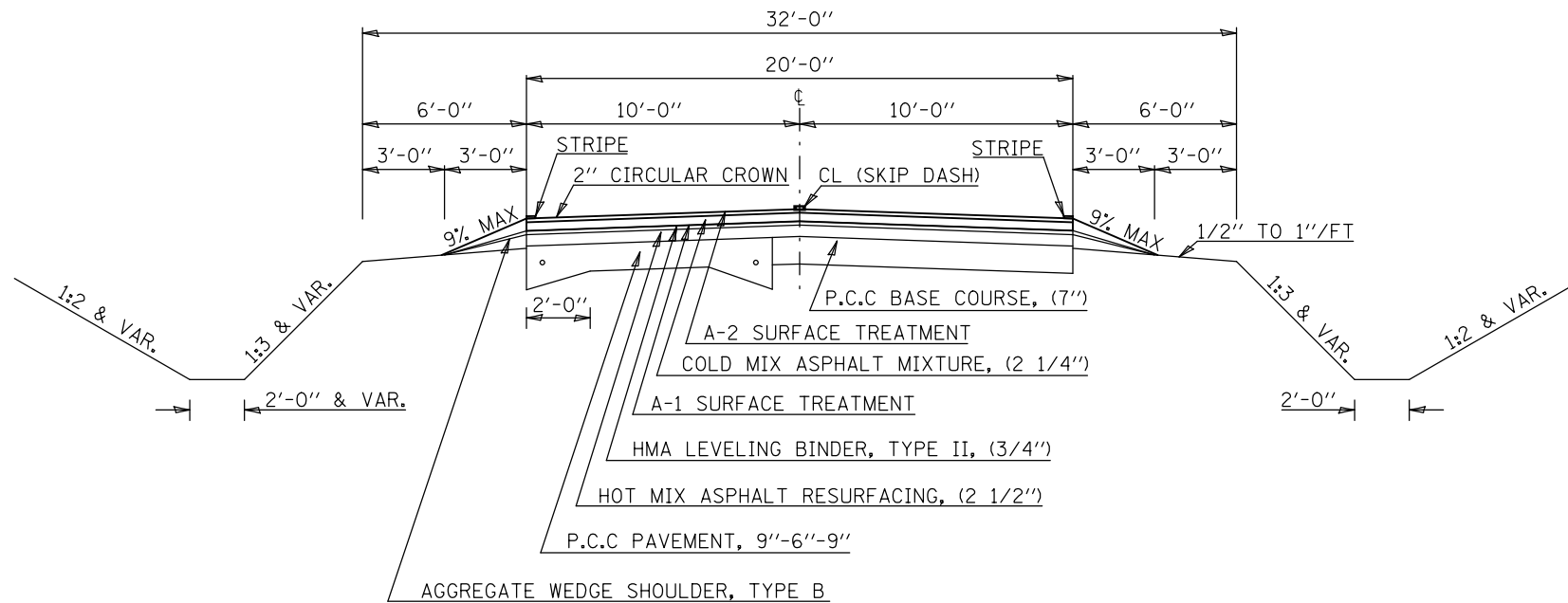

LOCATION #1 (FAS 522)

PROPOSED TYPICAL CROSS SECTION ②

STATION	TO	STATION
① 225+49.00		230+49.00 ①
① 236+99.00		240+49.00 ①
① 244+49.00		265+49.00 ①
① 322+99.00		331+41.00 ③
③ 335+13.00		414+26.66

NOTE: BRIDGE OMMISION (SN 010-0107):
STA. 389+85.00 TO STA. 390+31.50

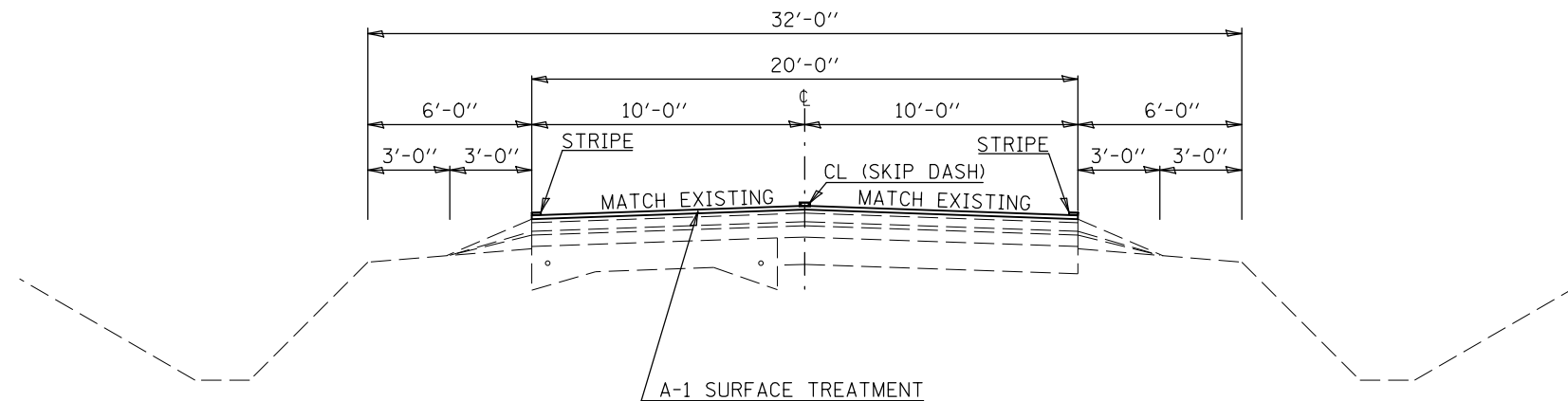

LOCATION #1 (FAS 522)

EXISTING TYPICAL CROSS SECTION ③

STATION TO STATION
 ② 331+41.00 335+13.00 ②

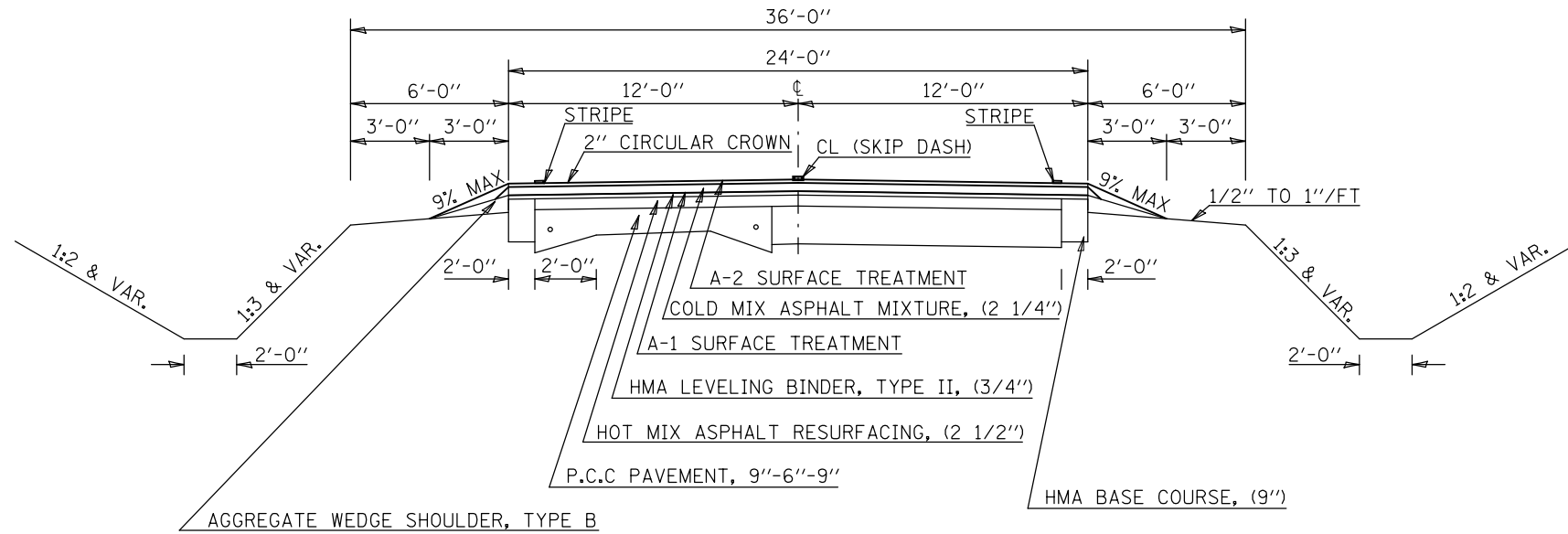

LOCATION #1 (FAS 522)

PROPOSED TYPICAL CROSS SECTION ③

STATION TO STATION
 ② 331+41.00 335+13.00 ②

NOTE: BRIDGE OMMISION (SN 010-0244):
 STA. 332+91.00 TO STA. 333+63.00

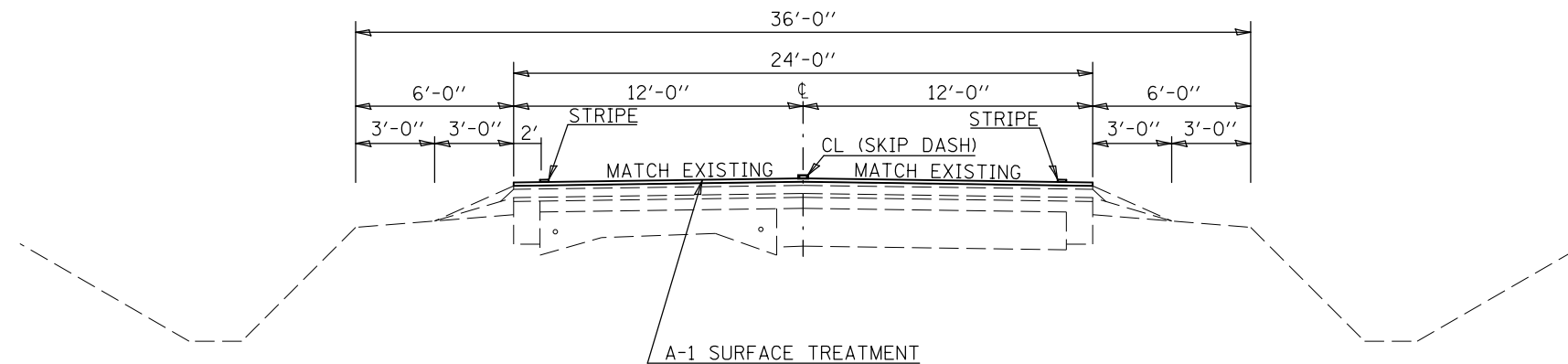

FILE NAME =	USER NAME = coombessf	DESIGNED -	REVISED -
p:\1\084EBIDINTEG.illinois.gov\PIWIDOT\Documents\DOT Offices\District 5\Projects\0570\DRAWING\Design\0570C51-shr-typical.dgn		REVISIONS	
		CHECKED -	REVISED -
		DATE -	REVISED -

STATE OF ILLINOIS
DEPARTMENT OF TRANSPORTATION

LOCATION #1 EXISTING & PROPOSED TYPICAL SECTION

SCALE: _____ SHEET 3 OF 5 SHEETS STA. _____ TO STA. _____

F.A.S. RTE.	SECTION	COUNTY	TOTAL SHEETS	SHEET NO.
•	(41,48-15,81-15,118)0-2	CHAMPAIGN	11	7
CONTRACT NO. 70C51			ILLINOIS FED. AID PROJECT	

LOCATION #2 (FAS 525)

EXISTING TYPICAL CROSS SECTION ①

STATION	TO	STATION
700+42.20		703+19.43 (BK)
0+00.00 (AH)		172+07.00 ②
② 201+03.00		302+95.00

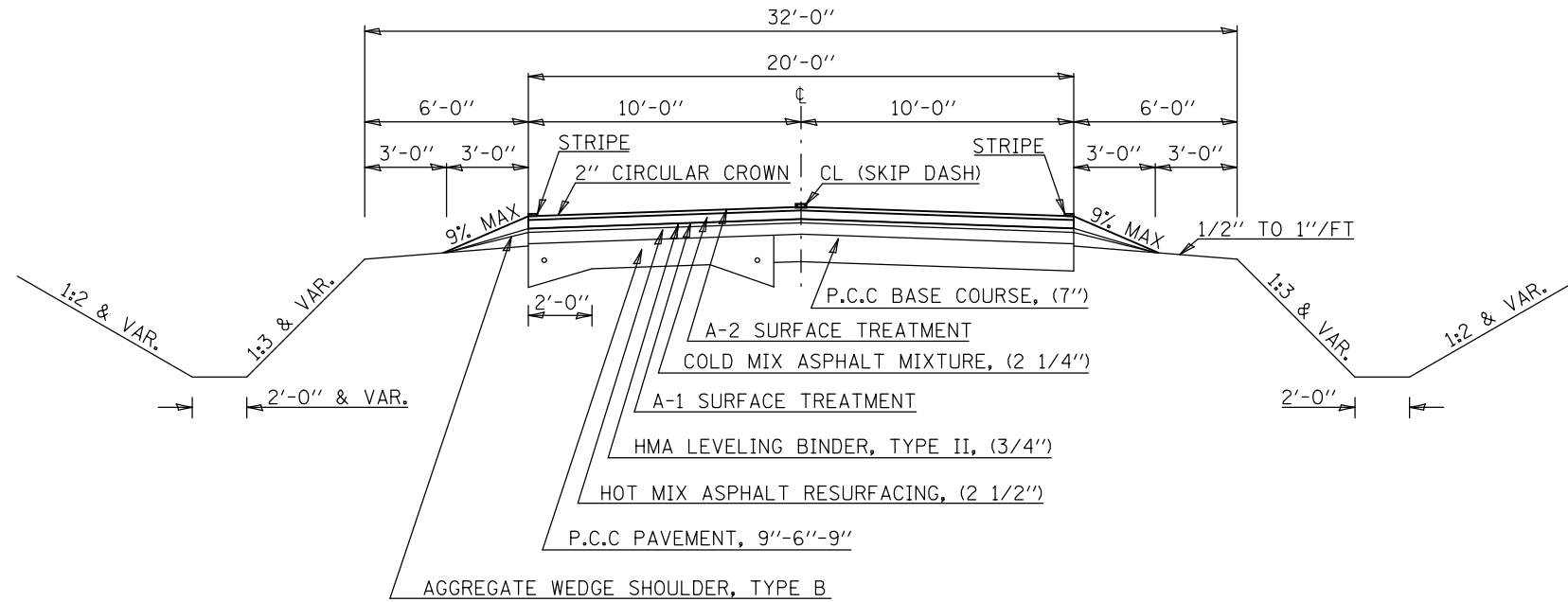

LOCATION #2 (FAS 525)

PROPOSED TYPICAL CROSS SECTION ①

STATION	TO	STATION
700+42.20		703+19.43 (BK)
0+00.00 (AH)		172+07.00 ②
② 201+03.00		302+95.00

NOTE: BRIDGE OMMISION (SN 010-0250):
STA. 199+50.00 TO STA. 201+56.50

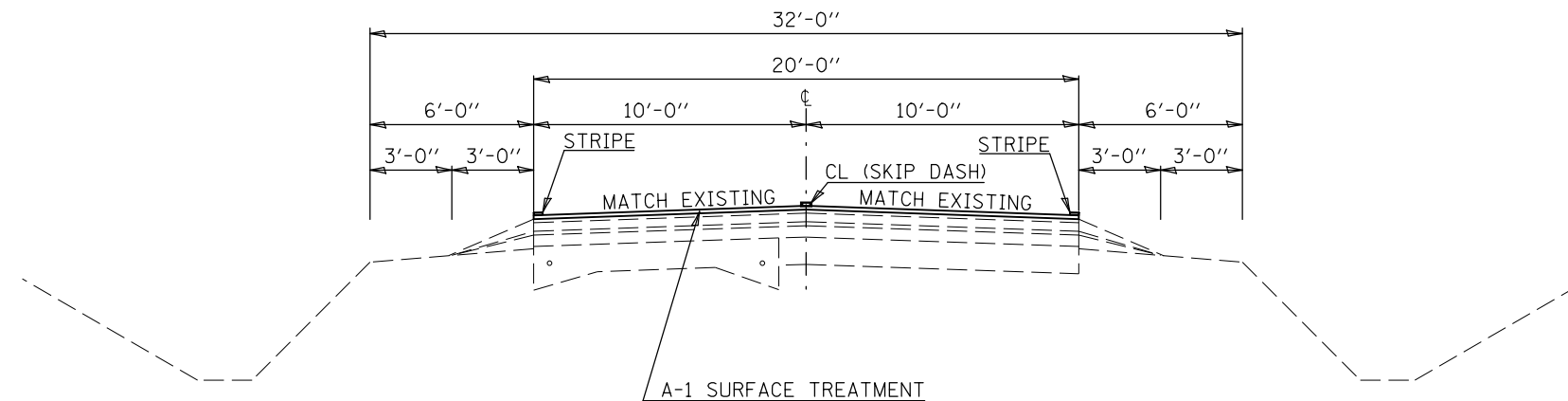

LOCATION #2 (FAS 525)

EXISTING TYPICAL CROSS SECTION ②

STATION TO STATION
 ① 172+07.00 201+03.00 ①

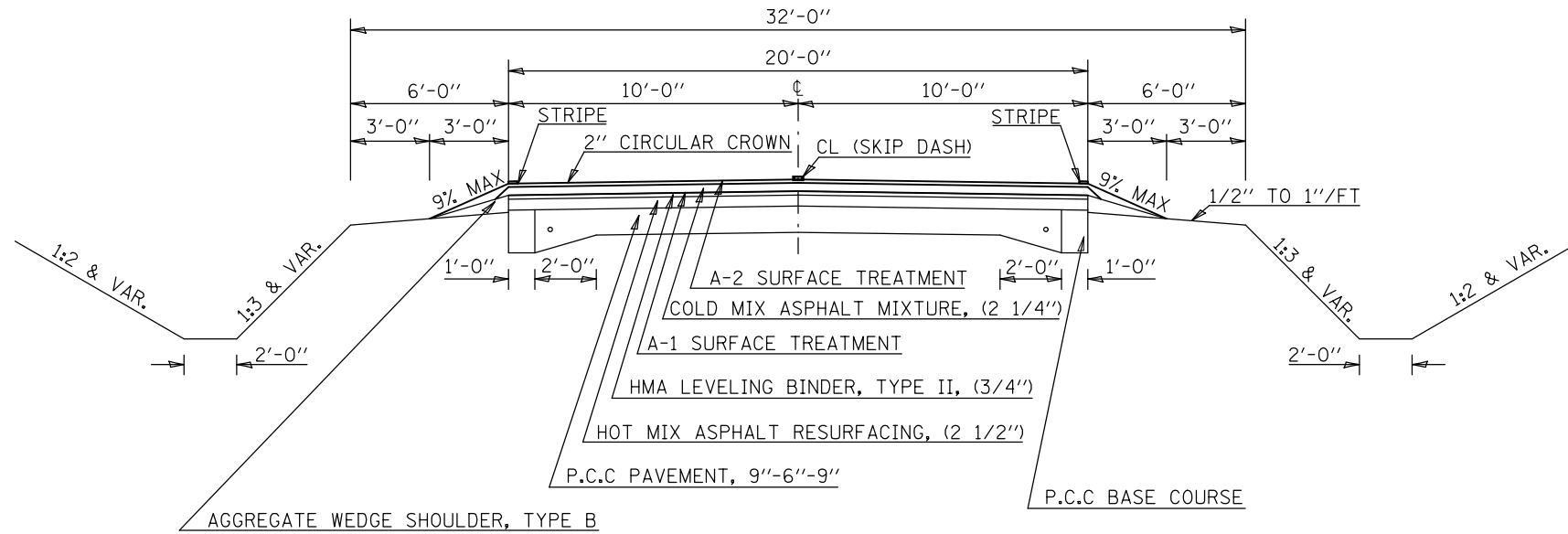

LOCATION #2 (FAS 525)

PROPOSED TYPICAL CROSS SECTION ②

STATION TO STATION
 ① 172+07.00 201+03.00 ①

NOTE: BRIDGE OMMISION (SN 010-0250):
 STA. 199+50.00 TO STA. 201+56.50

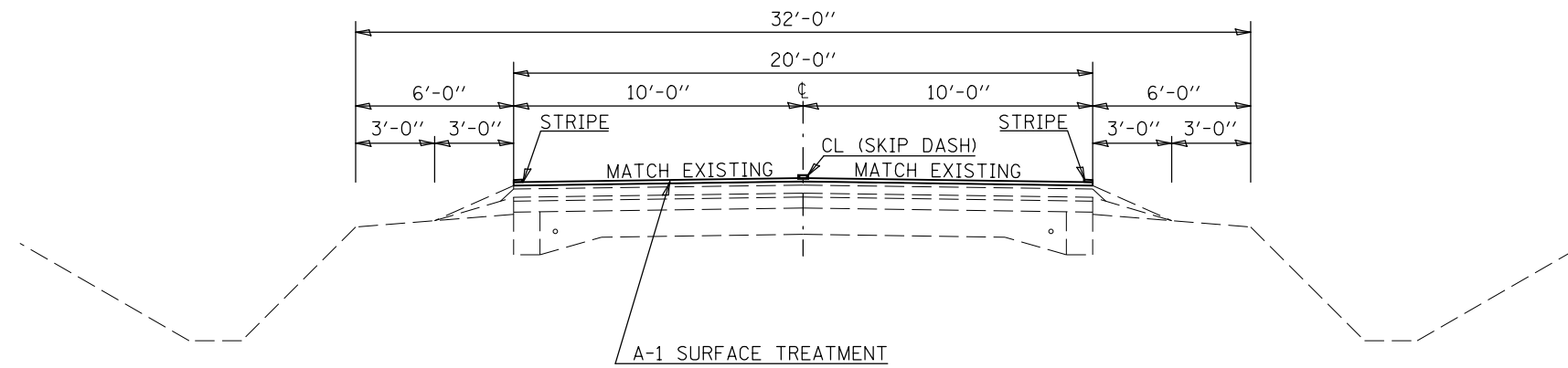

SCHEDULE OF QUANTITIES

BITUMINOUS SURFACE TREATMENT

LOCATION	STATION	TO	STATION	LENGTH (FOOT)	WIDTH (FOOT)	AREA (SQ FT)	AREA (SQ YD)	BITUMINOUS MATERIALS TACK COAT RATE (LBS/SQ FT)	BITUMINOUS MATERIALS (COVER AND SEAL COAT) RATE (GAL/SQ YD)	SEAL COAT AGGREGATE RATE (LBS/SQ YD)	* BITUMINOUS MATERIALS (TACK COAT) 40600290 (POUND)	** POLYMERIZED BITUMINOUS MATERIALS (COVER AND SEAL COAT) 40300405 (TON)	SEAL COAT AGGREGATE 40300600 (TON)
FAS 522 (SIDNEY-LONGVIEW RD)													
FAS 522	217+49.00		331+41.00	11,392.0	20.0	250,624.0	25,315.6	0.05	0.35	19.0	12,531.2	37.7	240.5
FAS 522	331+41.00		332+91.00	150.0	24.0	3,900.0	400.0	0.05	0.35	19.0	195.0	0.6	3.8
OMISSION S.N. 010-0244													
FAS 522	333+63.00		335+13.00	150.0	24.0	3,900.0	400.0	0.05	0.35	19.0	195.0	0.6	3.8
FAS 522	335+13.00		389+85.00	5,472.0	20.0	120,384.0	12,160.0	0.05	0.35	19.0	6,019.2	18.1	115.5
OMISSION S.N. 010-0107													
FAS 522	390+31.50		414+26.66	2,395.2	20.0	52,693.5	5,322.6	0.05	0.35	19.0	2,634.7	7.9	50.6
FAS 525 (BROADLANDS RD)													
FAS 525	700+42.20		703+19.43	277.2	20.0	6,099.1	616.1	0.05	0.35	19.0	305.0	0.9	5.9
STATION EQUATION: STA. 703+19.43 (BK) = STA. 0+00.00 (AH)													
FAS 525	0+00.00		172+07.00	17,207.0	20.0	378,554.0	38,237.8	0.05	0.35	19.0	18,927.7	56.9	363.3
FAS 525	172+07.00		199+50.00	2,743.0	20.0	60,346.0	6,095.6	0.05	0.35	19.0	3,017.3	9.1	57.9
OMISSION S.N. 010-0250													
FAS 525	201+56.50		302+95.00	10,138.5	20.0	223,047.0	22,530.0	0.05	0.35	19.0	11,152.4	33.6	214.0
FAS 522 TOTAL:											21,575.1	64.9	414.2
FAS 522 ROUNDED:											21,576.0	65.0	414.0
FAS 525 TOTAL:											33,402.3	100.5	641.1
FAS 525 ROUNDED:											33,403.0	101.0	641.0
GRAND TOTAL:											54,979.0	166.0	1,055.0

*INCLUDES 1 FT OF OVERSPRAY ON EACH SIDE OF THE ROADWAY
 **WEIGHT CONVERSION: 235 GALLONS/TON

SCHEDULE OF QUANTITIES

PAVEMENT MARKING

LOCATION	STATION	TO	STATION	LENGTH (FOOT)	*** STRIPE LAYOUT	STRIPE WIDTH (INCH)	YELLOW	WHITE
							PAINT PAVEMENT MARKING - LINE, 4" 78001110 (FOOT)	
FAS 522 (SIDNEY-LONGVIEW RD)								
FAS 522	217+49.00		230+16.00	1,267.00	SD	4.0	316.8	2,534.0
FAS 522	230+16.00		238+08.00	792.00	SD & NP	4.0	990.0	1,584.0
FAS 522	238+08.00		243+89.00	581.00	SD	4.0	145.3	1,162.0
FAS 522	243+89.00		250+23.00	634.00	SD & NP	4.0	792.5	1,268.0
FAS 522	250+23.00		264+40.00	1,417.00	SD	4.0	354.3	2,834.0
FAS 522	264+40.00		274+14.00	974.00	SD & NP	4.0	1,217.5	1,948.0
FAS 522	274+14.00		274+67.00	53.00	SD	4.0	13.3	106.0
FAS 522	274+67.00		285+76.00	1,109.00	SD & NP	4.0	1,386.3	2,218.0
FAS 522	285+76.00		292+10.00	634.00	SD	4.0	158.5	1,268.0
FAS 522	292+10.00		297+38.00	528.00	SD & NP	4.0	660.0	1,056.0
FAS 522	297+38.00		302+13.00	475.00	SD	4.0	118.8	950.0
FAS 522	302+13.00		306+88.00	475.00	SD & NP	4.0	593.8	950.0
FAS 522	306+88.00		307+94.00	106.00	NP & NP	4.0	212.0	212.0
FAS 522	307+94.00		314+28.00	634.00	SD & NP	4.0	792.5	1,268.0
FAS 522	314+28.00		317+45.00	317.00	SD	4.0	79.3	634.0
FAS 522	317+45.00		325+90.00	845.00	SD & NP	4.0	1,056.3	1,690.0
FAS 522	325+90.00		414+26.66	8,836.66	SD	4.0	2,209.2	17,673.3
FAS 525 (BROADLANDS RD)								
FAS 525	700+42.20		703+19.43	277.23	SD	4.0	69.3	554.5
STATION EQUATION: STA. 703+19.43 (BK) = STA. 0+00.00 (AH)								
FAS 525	0+00.00		163+37.47	16,337.47	SD	4.0	4,084.4	32,674.9
FAS 525	163+37.47		177+15.00	1,377.53	SD & NP	4.0	1,721.9	2,755.1
FAS 525	177+15.00		302+95.00	12,580.00	SD	4.0	3,145.0	25,160.0
FAS 522 TOTAL:							50,451.7	
FAS 522 ROUNDED:							50,460.0	
FAS 525 TOTAL:							70,165.1	
FAS 525 ROUNDED:							70,170.0	
GRAND TOTAL:							120,630.0	

***SD=SKIP DASH; SD & NP=SKIP DASH WITH NO PASSING ZONE;
AND NP & NP=DOUBLE NO PASSING ZONE.