

STATE OF ILLINOIS  
DEPARTMENT OF TRANSPORTATION

F.A.S. RTE.	SECTION	COUNTY	TOTAL SHEETS	SHEET NO.
2729	D6 W. FRONT RD REPAIR	MONTGOMERY	7	1
		ILLINOIS	CONTRACT NO. 72J34	

FOR INDEX OF SHEETS, SEE SHEET NO. 2

# PROPOSED IMPROVEMENTS

FAS 2729 (I-55 W FR RD)  
D6 W. FRONTAGE RD REPAIR  
BITUMIONOUS SURFACE TREATMENT

MONTGOMERY CO

C-96-072-16

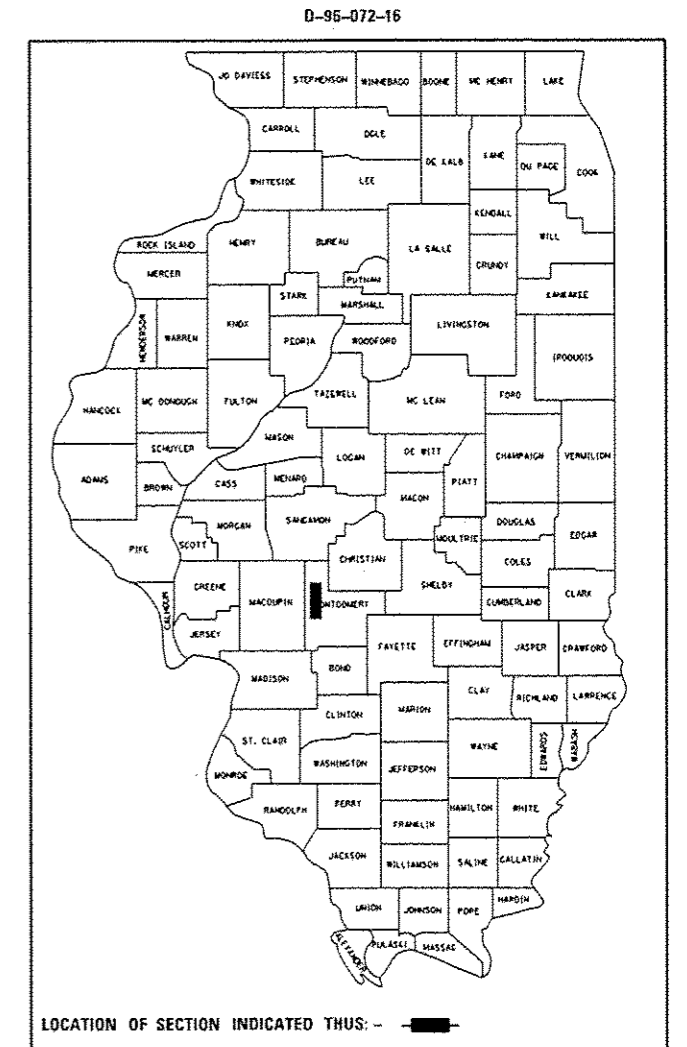

ADT = 600  
SU = 18  
MU = 19

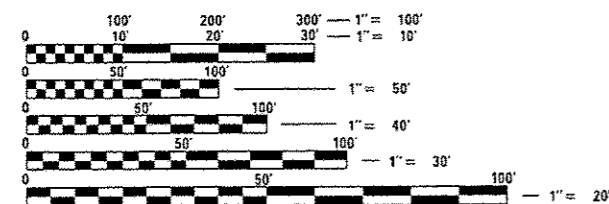

FULL SIZE PLANS HAVE BEEN PREPARED USING STANDARD ENGINEERING SCALES. REDUCED SIZED PLANS WILL NOT CONFORM TO STANDARD SCALES. IN MAKING MEASUREMENTS ON REDUCED PLANS, THE ABOVE SCALES MAY BE USED.

J.U.L.I.E.  
JOINT UTILITY LOCATION INFORMATION FOR EXCAVATION  
1-800-892-0123  
OR 811

BEGIN PROJECT  
LOC. #1 STA.  
282+92.06

STA. EQ 310+33.00 bk  
= 1510+33.00 ah  
STA. EQ. 1629+99.96 bk  
= 329+99.96 ah

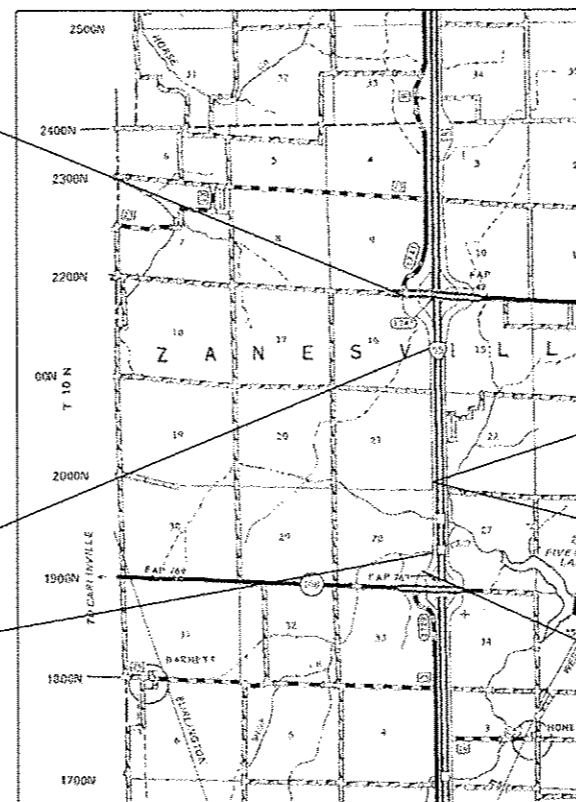

END PROJECT LOC. #1  
STA. 1582+57.00

BEGIN PROJECT LOC. #2  
STA. 1582+57.00

END PROJECT LOC. #2  
STA. 350+00.00

PROJECT ENGINEER : MIKE IRWIN - (217)524-7765  
PROJECT MANAGER : TIM SHARP - (217)524-9160

CONTRACT NO. 72J34

STATE OF ILLINOIS  
DEPARTMENT OF TRANSPORTATION

SUBMITTED 17 February 2017

*[Signature]*  
REGION FOUR ENGINEER

Mar 24 2017  
Maurice M. Adonis P.E.  
ENGINEER OF DESIGN AND ENVIRONMENT

Mar 24 2017  
*[Signature]*  
DIRECTOR OF HIGHWAYS, CHIEF ENGINEER

PRINTED BY THE AUTHORITY  
OF THE STATE OF ILLINOIS

INDEX OF SHEETS

SHEET NO.	DESCRIPTION
1.	COVER SHEET
2.	INDEX OF SHEETS, STANDARDS, GENERAL NOTES & SIGNATURE
3.	SUMMARY OF QUANTITIES
4.	PROJECT LOCATION MAP
5-6.	PROJECT TYPICAL SECTIONS
7.	BUTT JOINT DETAILS

STANDARDS

STANDARD NO.	DESCRIPTION
442201-03	CLASS C and D PATCHES
701201-04	LANE CLOSURE, 2L, 2W, DAY ONLY, FOR SPEEDS $\geq$ 45 MPH
701301-04	LANE CLOSURE, 2L, 2W, SHORT TERM OPERATIONS
701306-03	LANE CLOSURE, 2L, 2W, SLOW MOVING OPERATIONS DAY ONLY, FOR SPEEDS $\geq$ 45 MPH
701311-03	LANE CLOSURE, 2L, 2W, MOVING OPERATIONS, DAY ONLY
701901-06	TRAFFIC CONTROL DEVICES
780001-05	TYPICAL PAVEMENT MARKINGS

NOTES:

SEAL COAT AGGREGATE SHALL BE CRUSHED LIMESTONE AND USED FOR BOTH APPLICATIONS OF THE BITUMINOUS SURFACE TREATMENTS (NO COVER COAT AGGREGATE, USE SMALLER AGGREGATE FOR BOTH APPLICATIONS).

D-6 OPERATIONS WILL PLACE PERMANENT PAVEMENT MARKINGS

**STATE OF ILLINOIS  
DEPARTMENT OF TRANSPORTATION  
DIVISION OF HIGHWAYS  
DISTRICT 6**

---

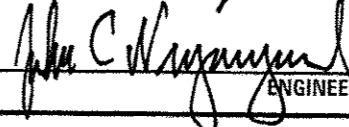
EXAMINED February 2, 20 17  
  
 ENGINEER OF OPERATIONS

---

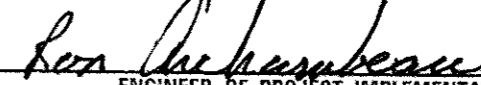
EXAMINED January 19 20 17  
  
 ENGINEER OF PROJECT IMPLEMENTATION

---

EXAMINED February 16 20 17  
  
 ENGINEER OF PROGRAM DEVELOPMENT

CODE NO.	ITEM	UNIT	TOTAL QUANTITY	0-01623-6013	0-01623-2014
				100% STATE ✓	100% STATE ✓
				MONTGOMERY	MONTGOMERY
				ROADWAY	ROADWAY
✓0005	✓0005				
				✓RURAL	✓RURAL
40600290	BITUMINOUS MATERIALS (TACK COAT)	POUND	8,092	0	8,092
40600990	TEMPORARY RAMP	SQ YD	36	0	36
40600982	HOT-MIX ASPHALT SURFACE REMOVAL - BUTT JOINT	SQ YD	107	0	107
40602978	HOT-MIX ASPHALT BINDER COURSE, IL-9.5, N50	TON	1,007	0	1,007
40600985	PORTLAND CEMENT CONCRETE SURFACE REMOVAL - BUTT JOINT	SQ YD	107	0	107
44201694	CLASS D PATCHES, TYPE III, 4 INCH	SQ YD	43	20	23
44201696	CLASS D PATCHES, TYPE IV, 4 INCH	SQ YD	855	659	196
44201761	CLASS D PATCHES, TYPE I, 10 INCH	SQ YD	24	0	24
44201765	CLASS D PATCHES, TYPE II, 10 INCH	SQ YD	1,456	925	531
44201769	CLASS D PATCHES, TYPE III, 10 INCH	SQ YD	96	64	32
44201771	CLASS D PATCHES, TYPE IV, 10 INCH	SQ YD	45	0	45
48101200	AGGREGATE SHOULDERS, TYPE B	TON	513	0	513
67100100	MOBILIZATION	L.SUM	1	0.5	0.5
70100450	TRAFFIC CONTROL AND PROTECTION, STANDARD 701201	L.SUM	1	0.5	0.5
70100460	TRAFFIC CONTROL AND PROTECTION, STANDARD 701306	L.SUM	1	0.5	0.5
X1500001	BITUMINOUS SURFACE TREATMENT (PREVENTIVE MAINTENANCE)	SQ YD	94,100	53,211	40,889

STATE OF ILLINOIS  
DEPARTMENT OF TRANSPORTATION

SUMMARY OF QUANTITIES

FILE NAME *	USER NAME *	DESIGNED -	REVISED -	SCALE: _____ SHEET _____ OF _____ SHEETS STA. _____ TO STA. _____		F.A.S. RTE.	SECTION	COUNTY	TOTAL SHEETS	SHEET NO.
S:\CONTRMAINT\CAD\72J34 - Bituminous Sur	sharptd	Treatment - FAS 2729 - W.F.R. - Mont PLANS	DRW - 3-500.dwg			2989	06 W. FRONT RD REPAIR	MONTGOMERY	7	3
Default		PLOT SCALE = 40,0000' / 1"	CHECKED -	REVISED -			ILLINOIS FED. AID PROJECT		CONTRACT NO. 72J34	
		PLOT DATE = 2/19/2017	DATE -	REVISED -						



END PROJECT  
LOCATION #1  
STA. 1582+57.00

BEGIN PROJECT  
LOCATION #2  
STA. 1582+57.00



STA EQ. 34+47.08  
IL 127 = 282+80.06  
WFR

BEGIN PROJECT  
LOCATION #1  
STA. 282+92.06

END PROJECT  
LOCATION #2  
STA. 350+00.00

STA. EQ. 35+09.62  
IL 108 = 357+23.64  
WFR

STA. EQ. - 310+33.00 bk  
= 1510+33.00 ah

STA. EQ. - 1629+99.96 bk  
= 329+99.96 ah

FILE NAME : S:\CONTRMAINT_CAD\72J34 - Bituminous Surf	USER NAME : sharptd	DESIGNED - _____	REVISED - _____	STATE OF ILLINOIS DEPARTMENT OF TRANSPORTATION	LOCATION MAP		F.A.S. RTE. 2729	SECTION D6 W. FRONT RD REPAI	COUNTY MONTGOMERY	TOTAL SHEETS 7	SHEET NO. 4	
Default	Plot Treatment - FAS 2729 - W.F.R. - Mont	CHECKED - _____	REVISED - _____		SCALE: _____	SHEET _____	OF _____	SHEETS	STA. _____	TO STA. _____	CONTRACT NO. 72J34	
	PLOT SCALE = 48,0000' / in.	DATE - _____	REVISED - _____		ILLINOIS FED. AID PROJECT							
	PLOT DATE = 2/22/2017											

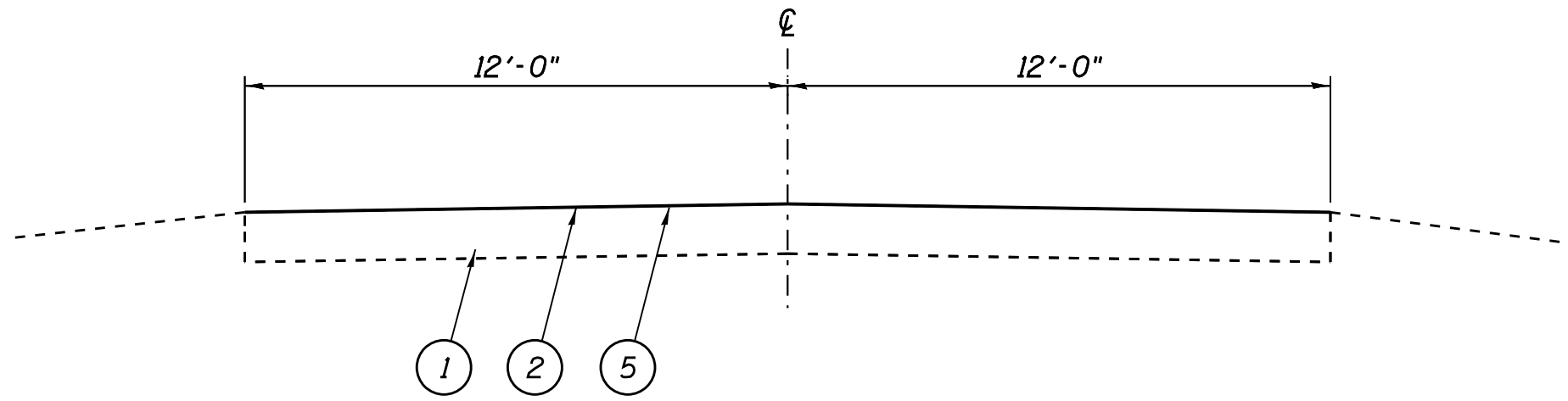

LOCATION #1 STA. 1510+33.00(AH) TO 1582+57.00

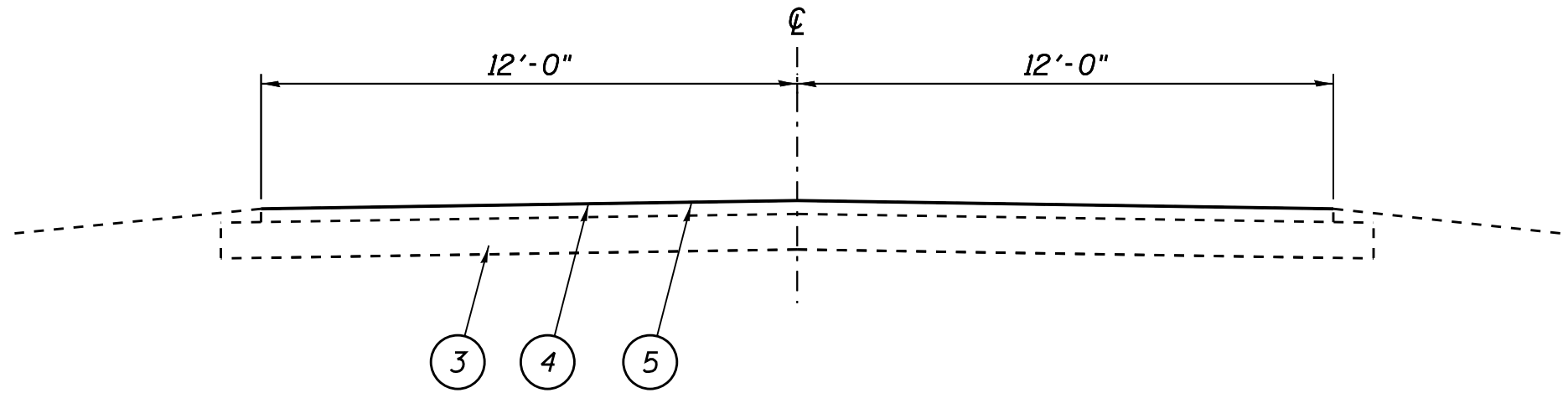

LOCATION #1 STA. 282+92.06 TO 310+33.00

**LEGEND**

- 1- EXIST. P.C.C. PAVEMENT 10"
- 2- EXIST BITUMINOUS SURFACE COURSE (PREVENTIVE MAINTENANCE)
- 3- EXIST. 8" AGGREGATE BASE COURSE, TYPE "A"
- 4- EXIST. 2" H.M.A. MIXTURE COMPLETE
- 5- PROP. BITUMINOUS SURFACE TREATMENT (PREVENTIVE MAINTENANCE) A-2 WITH TWO SEAL TREATMENTS, NO COVER COAT AGGREGATE)
- 6- PROP. H.M.A. BINDER COURSE, IL-9.5, N50 2"
- 7- PROP. AGGREGATE SHOULDER, TYPE B

**MIXTURE REQUIREMENTS**

THE FOLLOWING MIXTURE REQUIREMENTS ARE APPLICABLE FOR THIS PROJECT

MIXTURE USE(S):	PAVEMENT PATCHING	H.M.A BINDER COURSE
AC/PG	PG 64-22	PG 64-22
DESIGN AIR VOIDS:	4.0% @ N DESIGN = 50	4.0% @ N DESIGN = 50
MIXTURE COMP:	IL 19.0	IL 9.5
FRICITION AGG:	N/A	N/A

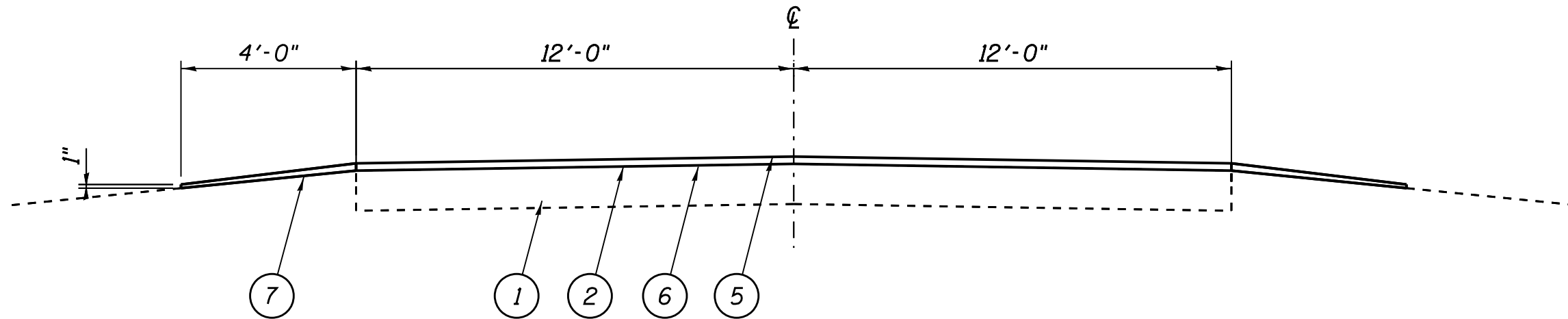

LOCATION #2 STA. 1582+57.00 TO 1629+99.96(BK)

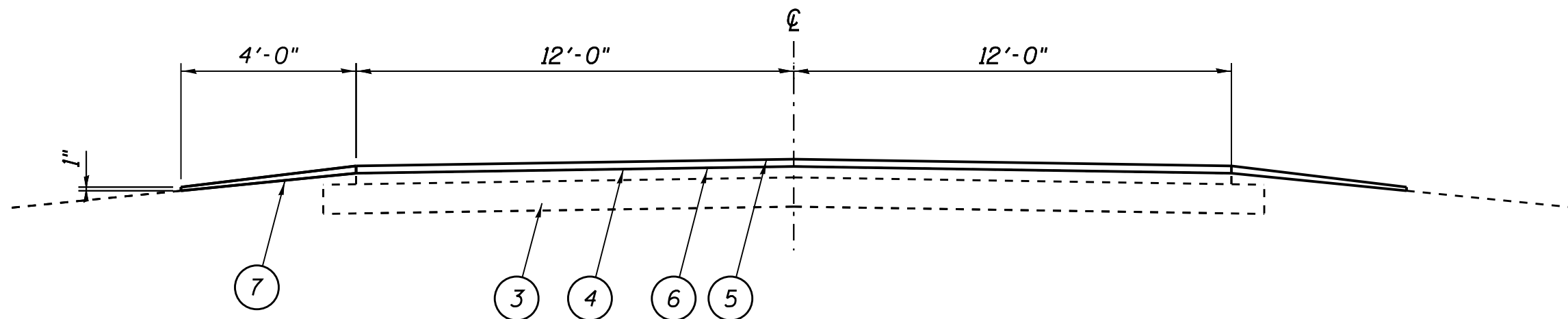

LOCATION #2 STA. 329+99.96(AH) TO 350+00.00

**LEGEND**

- 1- EXIST. P.C.C. PAVEMENT 10"
- 2- EXIST BITUMINOUS SURFACE COURSE (PREVENTIVE MAINTENANCE)
- 3- EXIST. 8" AGGREGATE BASE COURSE, TYPE "A"
- 4- EXIST. 2" H.M.A. MIXTURE COMPLETE
- 5- PROP. BITUMINOUS SURFACE TREATMENT (PREVENTIVE MAINTENANCE) A-2 WITH TWO SEAL TREATMENTS, NO COVER COAT AGGREGATE)
- 6- PROP. H.M.A. BINDER COURSE, IL-9.5, N50 2"
- 7- PROP. AGGREGATE SHOULDER, TYPE B

FILE NAME : S:\CONTRMAINT_CAD\72J34 - Bituminous Surf	USER NAME : sharptd	DESIGNED - DP	REVISED -	STATE OF ILLINOIS DEPARTMENT OF TRANSPORTATION	TYPICALS		F.A.S. RTE.	SECTION	COUNTY	TOTAL SHEETS	SHEET NO.				
Default	Treatment -FAS 2729 - W.F.R. - Mont\PLANS	D6	REVISED -		SCALE: _____	SHEET _____	OF _____	SHEETS	STA. _____	TO STA. _____	2729	D6 W. FRONT RD REPAIR	MONTGOMERY	7	6
	PLOT SCALE = 3.0000' / in.	CHECKED -	REVISED -								CONTRACT NO. 72J34				
	PLOT DATE = 2/22/2017	DATE -	REVISED -								ILLINOIS FED. AID PROJECT				

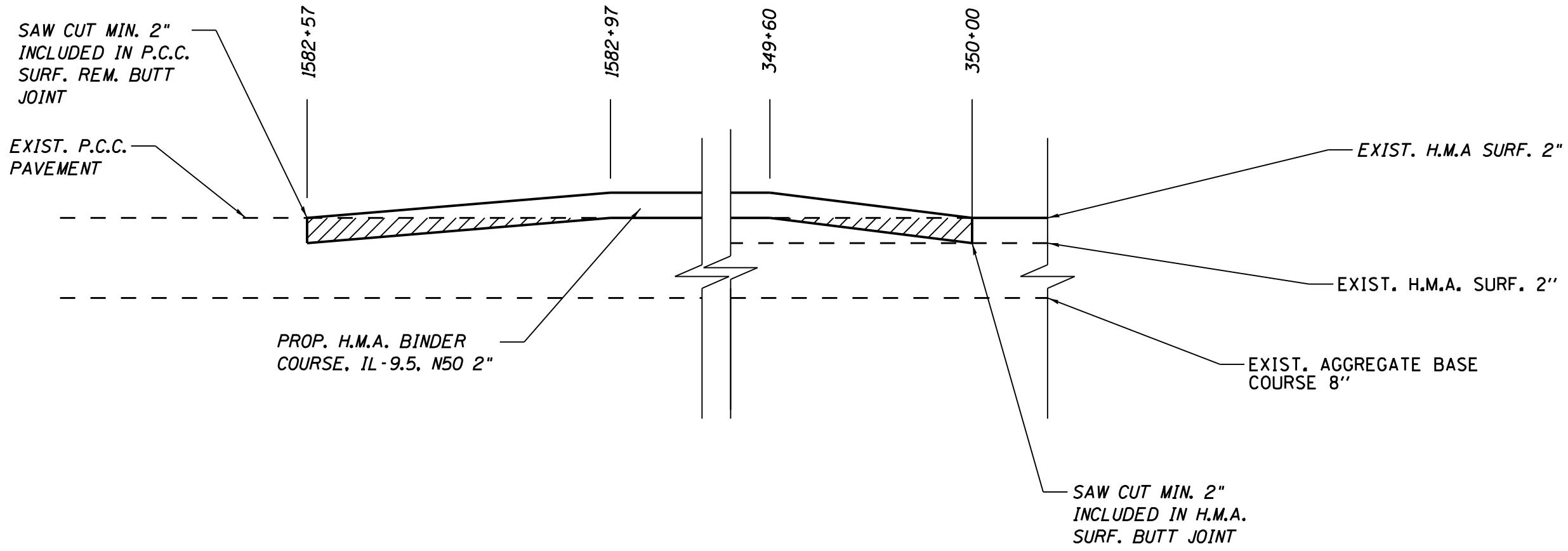

FILE NAME :	USER NAME :	DESIGNED -	REVISED -
S:\CONTRMAINT_CAD\72J34 - Bituminous Surf Treatment - FAS 2729 - W.F.R. - Mont\PLANS\DRWING\sh7-butt-joint.dgn	sharptd	_____	_____
Default	PLOT SCALE = 1:2047' / in.	CHECKED -	REVISED -
	PLOT DATE = 2/22/2017	DATE -	REVISED -

**STATE OF ILLINOIS  
DEPARTMENT OF TRANSPORTATION**

<b>BUTT JOINT DETAILS</b>			
SCALE:	SHEET	OF	SHEETS
	STA.	TO STA.	

F.A.S. RTE.	SECTION	COUNTY	TOTAL SHEETS	SHEET NO.
2729	D6 W. FRONT RD REPAIR	MONTGOMERY	7	7
CONTRACT NO. 72J34			ILLINOIS FED. AID PROJECT	