

INDEX OF SHEETS

STANDARDS CONT'D.

SHT NO	DESCRIPTION
1	COVER SHEET
2	SIGNATURE SHEET
3	INDEX OF SHEETS & STANDARDS
4	GENERAL NOTES
5	MIXTURES REQUIREMENTS
6 - 15	SUMMARY OF QUANTITIES
16 - 19	TYPICAL SECTIONS
20 - 28	SCHEDULES OF QUANTITIES
29	TIE POINTS
30	GEOPAK ELEMENTS IDENTIFICATION
31 - 33	PLAN PROFILE - ROADWAY
34 - 36	PLAN PROFILE - STORM SEWER
37 - 38	PROPOSED REMOVAL AND CONSTRUCTION
39	STAGING SHEETS
40 - 41	DETOUR SHEETS
42 - 43	GEOMETRICS
44	PAVEMENT MARKINGS
45	EROSION CONTROL
46	RIGHT OF WAY
47	EXISTING TRAFFIC SIGNALS
48	PROPOSED TRAFFIC SIGNALS
49	PROPOSED WIRING DIAGRAM
50	PROPOSED PHASE DESIGNATION AND LIGHTING DIAGRAM
51	PROPOSED DETECTOR LOOP LAYOUT
52 - 57	DETAILS: DRAINAGE STRUCTURES
58	DETAILS: ENTRANCE
59 - 65	DETAILS: SIDEWALK AND CURB RAMPS
66 - 67	DETAILS: RETAINING WALLS
68	DETAILS: CONCRETE GUTTER (SPECIAL)
69	DETAILS: INLET SPECIAL; CONCRETE COLLAR; SERVICE INSTALLATION
70	DETAILS: UNEVEN LANES; ROUGH GROOVED SURFACE; SEEDING AND MULCHING
71	DETAILS: DETECTABLE WARNING; LUMINAIRE PERFORMANCE TABLE
72 - 77	CROSS-SECTIONS IL 14
78 - 89	CROSS-SECTIONS IL 37
90 - 95	CROSS-SECTIONS NE QUAD.
96 - 101	CROSS-SECTIONS SE QUAD.
102	CROSS-SECTIONS MARK FRANKLIN DR.
103 - 104	CROSS-SECTIONS MF RADIUS

000001-06	STANDARD SYMBOLS, ABBREVIATIONS, AND PATTERNS
001001-02	AREAS OF REINFORCEMENT BARS
001006	DECIMAL OF AN INCH AND OF A FOOT
280001-07	TEMPORARY EROSION CONTROL SYSTEMS
353001-04	PCC BASE COURSE WITH HMA BINDER AND SURFACE COURSES
420001-08	PAVEMENT JOINTS
424001-09	PERPENDICULAR CURB RAMPS FOR SIDEWALKS
424006-02	DIAGONAL CURB RAMPS FOR SIDEWALKS
424011-03	CORNER PARALLEL CURB RAMPS FOR SIDEWALKS
424016-03	MID-BLOCK CURB RAMPS FOR SIDEWALKS
424026-01	ENTRANCE - ALLEY PEDESTRIAN CROSSINGS
442201-03	CLASS C AND D PATCHES
542306-03	PRECAST REINFORCED CONCRETE ELLIPTICAL FLARED END SECTION
602301-04	INLET - TYPE A
602401-03	MANHOLE TYPE A
602416-05	MANHOLE TYPE A 8' DIAMETER
602421-05	MANHOLE TYPE A 9' DIAMETER
602601-04	PRECAST REINFORCED CONCRETE FLAT SLAB TOP
602701-02	MANHOLE STEPS
604001-04	FRAME AND LIDS TYPE 1
604006-05	FRAME AND GRATE TYPE 3
604036-03	GRATE TYPE 8
606001-06	CONCRETE CURB TYPE B AND COMBINATION CONCRETE CURB AND GUTTER
667101-02	PERMANENT SURVEY MARKERS
701001-02	OFF-RD OPERATIONS, 2L, 2W, MORE THAN 15' AWAY FROM EOP
701006-05	OFF-RD OPERATIONS, 2L, 2W, 15' TO 24 INCHES FROM EOP
701501-06	URBAN LANE CLOSURE, 2L, 2W, UNDIVIDED
701502-07	URBAN LANE CLOSURE 2L2W WITH BIDIRECTIONAL LEFT TURN LANE
701801-06	SIDEWALK, CORNER OR CROSSWALK CLOSURE
701901-06	TRAFFIC CONTROL DEVICES
720016-03	MAST ARM MOUNTED STREET NAME SIGNS
780001-05	TYPICAL PAVEMENT MARKINGS
781001-04	TYPICAL APPLICATIONS RAISED REFLECTIVE PAVEMENT MARKERS
805001-01	ELECTRICAL SERVICE INSTALLATION DETAILS
821101-02	LUMINAIRE WIRING IN POLE
825011-03	LIGHTING CONTROLLER PEDESTAL MOUNTED, 240V
836001-02	LIGHT POLE FOUNDATION
857001-01	STANDARD PHASE DESIGNATION DIAGRAMS AND PHASE SEQUENCES
862001-01	UNINTERRUPTABLE POWER SUPPLY (UPS)
873001-02	TRAFFIC SIGNAL GROUNDING AND BONDING
877001-06	STEEL MAST ARM ASSEMBLY AND POLE 16' THROUGH 55'
877011-08	STEEL COMB. MAST ARM ASSEMBLY AND POLE 16' THROUGH 55'
878001-10	CONCRETE FOUNDATION DETAILS
880006-01	TRAFFIC SIGNAL MOUNTING DETAILS
886001-01	DETECTOR LOOP INSTALLATIONS
886006-01	TYPICAL LAYOUTS FOR DETECTION LOOPS
BLR 21-9	TYPICAL APPLICATION OF TRAFFIC CONTROL DEVICES FOR CONSTRUCTION ON RURAL LOCAL HIGHWAYS
830001-03	LIGHT POLE ALUMINUM MAST ARM

△ REVISED SHEET 4-12-17

SUMMARY OF QUANTITIES - CONT

COUNTY:	FRANKLIN
ROUTE:	FAP 726, IL 37
FUNDING:	80% FED 20% STATE
LOCATION:	URBAN
TOTAL QUANTITY	ROADWAY 0021

CODE NUMBER	ITEM DESCRIPTION	UNIT	TOTAL QUANTITY	ROADWAY QUANTITY
* 82102250	LUMINAIRE, SODIUM VAPOR, HORIZONTAL MOUNT, 250 WATT	EACH	2	2
* 82500330	LIGHTING CONTROLLER, PEDESTAL MOUNTED, 240VOLT, 60AMP	EACH	1	1
* 83009600	LIGHT POLE, ALUMINUM, 45 FT. M.H., 15 FT. MAST ARM	EACH	1	1
* 83600300	LIGHT POLE FOUNDATION, 30" DIAMETER	FOOT	6.5	6.5
* 85700200	FULL-ACTUATED CONTROLLER AND TYPE IV CABINET	EACH	1	1
* 86200300	UNINTERRUPTABLE POWER SUPPLY, EXTENDED	EACH	1	1
* 87301225	ELECTRIC CABLE IN CONDUIT, SIGNAL NO. 14 3C	FOOT	661	661
* 87301245	ELECTRIC CABLE IN CONDUIT, SIGNAL NO. 14 5C	FOOT	538	538
* 87301255	ELECTRIC CABLE IN CONDUIT, SIGNAL NO. 14 7C	FOOT	420	420
* 87301305	ELECTRIC CABLE IN CONDUIT, LEAD-IN, NO. 14 1 PAIR	FOOT	1,084	1,084
* 87301815	ELECTRIC CABLE IN CONDUIT, SERVICE, NO. 6 3 C	FOOT	128	128
* 87301900	ELECTRIC CABLE IN CONDUIT, EQUIPMENT GROUNDING CONDUCTOR, NO. 6 1C	FOOT	1,222	1,222
* 87500400	TRAFFIC SIGNAL POST, 8 FT.	EACH	1	1
* 87501200	TRAFFIC SIGNAL POST, 16 FT.	EACH	2	2
* SPECIALTY ITEM				



14*

REV. 4-12-17

SUMMARY OF QUANTITIES - CONT

COUNTY:	FRANKLIN
ROUTE:	FAP 726, IL 37
FUNDING:	80% FED 20% STATE
LOCATION:	URBAN
TOTAL QUANTITY	ROADWAY 0021.













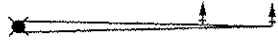

W/S 8 4 14L

CODE NUMBER	ITEM DESCRIPTION	UNIT	TOTAL QUANTITY	ROADWAY
* 88800100	PEDESTRIAN PUSH-BUTTON	EACH	6	6
* 89502375	REMOVE EXISTING TRAFFIC SIGNAL EQUIPMENT	EACH	1	1
X0321501	WEED BARRIER FABRIC	SO YD	402	402
X0323117	LANDSCAPING GRAVEL	SO YD	402	402
X0325405	FILL EXISTING STORM SEWERS	CU YD	42	42
* X0325476	RADAR VEHICLE DETECTION SYSTEM	EACH	1	1
X0327980	PAVEMENT MARKING REMOVAL - WATER BLASTING	SO FT	1,628	1,628
X6024240	INLETS, SPECIAL	EACH	5	5
X6062400	CONCRETE GUTTER (SPECIAL)	FOOT	11	11
X7010216	TRAFFIC CONTROL AND PROTECTION, (SPECIAL)	LSUM	1	1
* X8050115	SERVICE INSTALLATION, TYPE A (MODIFIED)	EACH	1	1
* X8850106	INDUCTIVE LOOP DETECTOR, RACK MOUNTED	EACH	3	3
Z000400Z	BOLLARDS	EACH	5	5
* Z0033062	RADIO TRANSCEIVER	EACH	1	1
149 * Z0054517	ROCK FILL - FOUNDATION	TON	24	24

* SPECIALTY ITEM

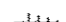
△ REV. 4-12-17

LEGEND

-  - FULL-ACTUATED CONTROLLER AND TYPE IV CABINET
-  - LIGHTING CONTROLLER, PEDESTAL MOUNTED, 240VOLT, 60AMP
-  - PROPOSED UNDERGROUND CONDUIT, PVC
-  - PROPOSED HANDHOLE
-  - PROPOSED PEDESTRIAN PUSH BUTTON
-  - PROPOSED PEDESTRIAN SIGNAL HEAD, LED, 1-FACE, BRACKET MOUNTED
-  - STEEL COMBINATION MAST ARM ASSEMBLY AND POLE WITH 45' FIXTURE MOUNTING HEIGHT WITH 15' MAST ARM
-  - LIGHT POLE, ALUMINUM, 45 FT. M.H. WITH 15' MAST ARM
-  - TRAFFIC SIGNAL POLE
-  - PEDESTRIAN PUSH BUTTON POLE
-  - RADIO TRANSCIVER
-  - TRAFFIC SIGNAL WITH BACKPLATE
-  - LUMINAIRE, SODIUM VAPOR, HORIZONTAL MOUNT, 250 WATT
-  - MOTION AND DETECTION SENSOR TO BE PAID FOR AS RADAR VEHICLE DETECTION SYSTEM

NOTE: NEW SERVICE LINE

CONTRACTOR TO INSTALL CONDUIT UP TO 8" FROM BASE OF POLE AND PROVIDE (1) 10' PIECE OF SCHEDULE 80 AND (2) 10' PIECES OF SCHEDULE 40 CONDUIT WITH WEATHER HEAD FOR SERVICE RISER AND PROVIDE SUFFICIENT LENGTH OF WIRE TO REACH AMEREN SECONDARY CONDUCTORS ON POLE. AMEREN WILL MAKE ELECTRICAL CONNECTIONS AND ATTACH SERVICE RISER AT POLE.

A QUANTITY OF "UNDERGROUND CONDUIT, PVC, 2" DIA." AND "ELECTRICAL CABLE IN CONDUIT, SERVICE, NO. 6 3C" HAS BEEN ADDED TO THE PLANS FOR THIS WORK. ALL OTHER ITEMS SHALL BE INCIDENTAL TO SERVICE INSTALLATION, TYPE A (MODIFIED).

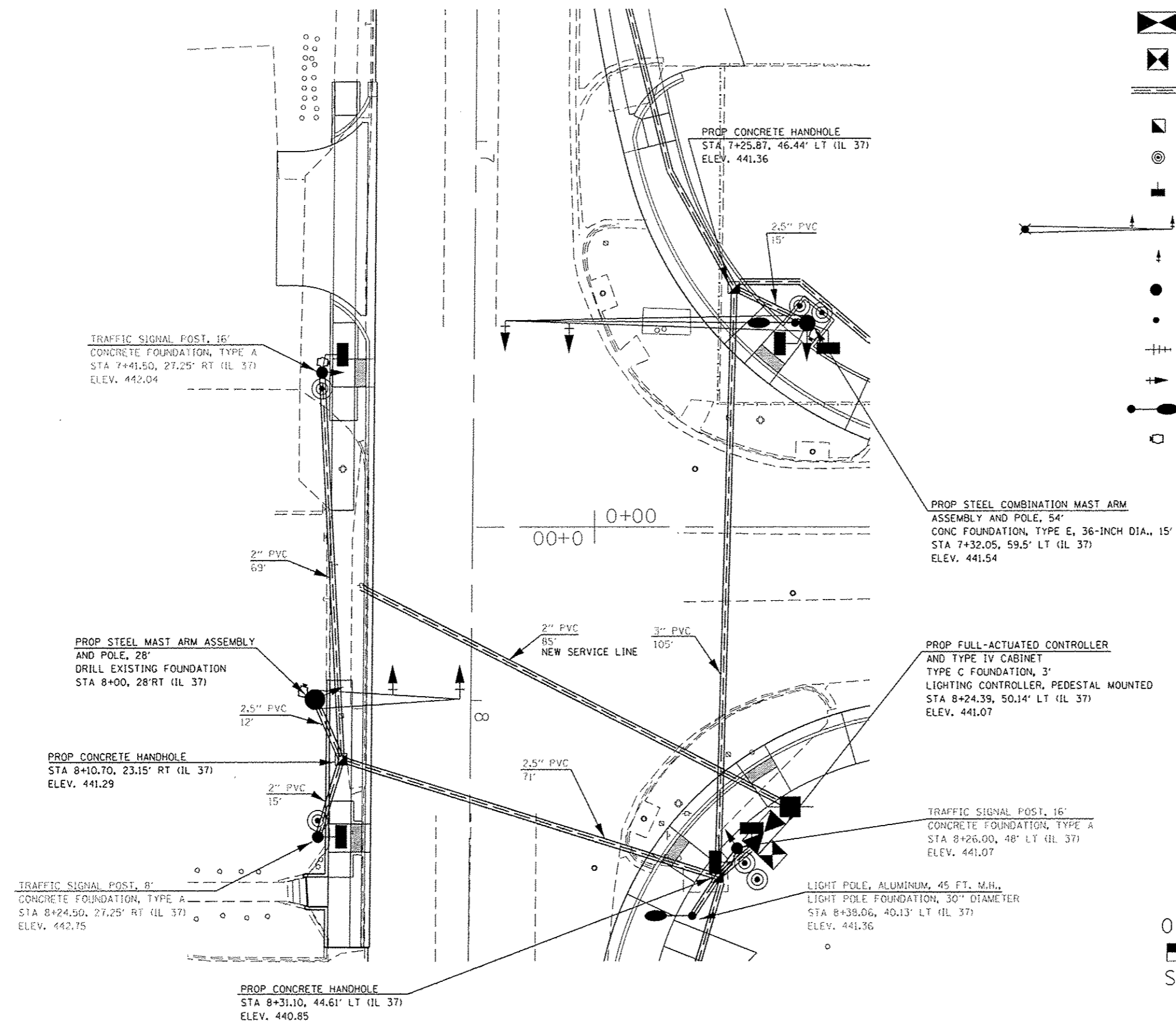
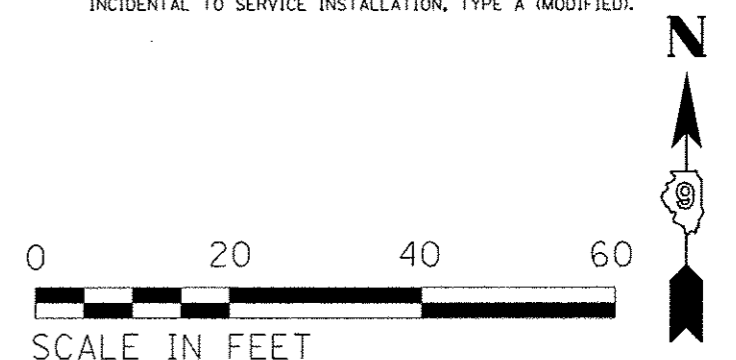

FOR CLARITY - 2" PVC CONDUIT TO THE LIGHT POLE (9) AND THE TRAFFIC SIGNAL POST (5) IN THE SE QUAD, 4" PVC CONDUIT (8) FROM THE CONTROLLER TO THE HANDHOLE

REVISIONS

NO.	DATE	DESCRIPTION
1	4/7/2017	ISSUED FOR BIDDING
2	4/12/2017	REVISED SHEET 4-12-17

STATE OF ILLINOIS DEPARTMENT OF TRANSPORTATION

PROPOSED TRAFFIC SIGNALS

FILE NAME : p:\11\08\EB\INTEG.ILLINOIS.GOV\PWID01\00	USER NAME : greenloam	DESIGNED : -	REVISED : -	SCALE: SHEET OF SHEETS STA. TO STA.	F.A.P. RTE. 853 09 TRAFFIC SIGNAL 2014-1	COUNTY FRANKLIN	TOTAL SHEETS 104	SHEET NO. 48
PROJECT : 09 TRAFFIC SIGNAL 2014-1	DESIGNED BY : -	CHECKED : -	REVISED : -					
PLOT SCALE : 20.0000 "/>								
PLOT DATE : 4/7/2017	DATE : -	REVISED : -	REVISED : -					

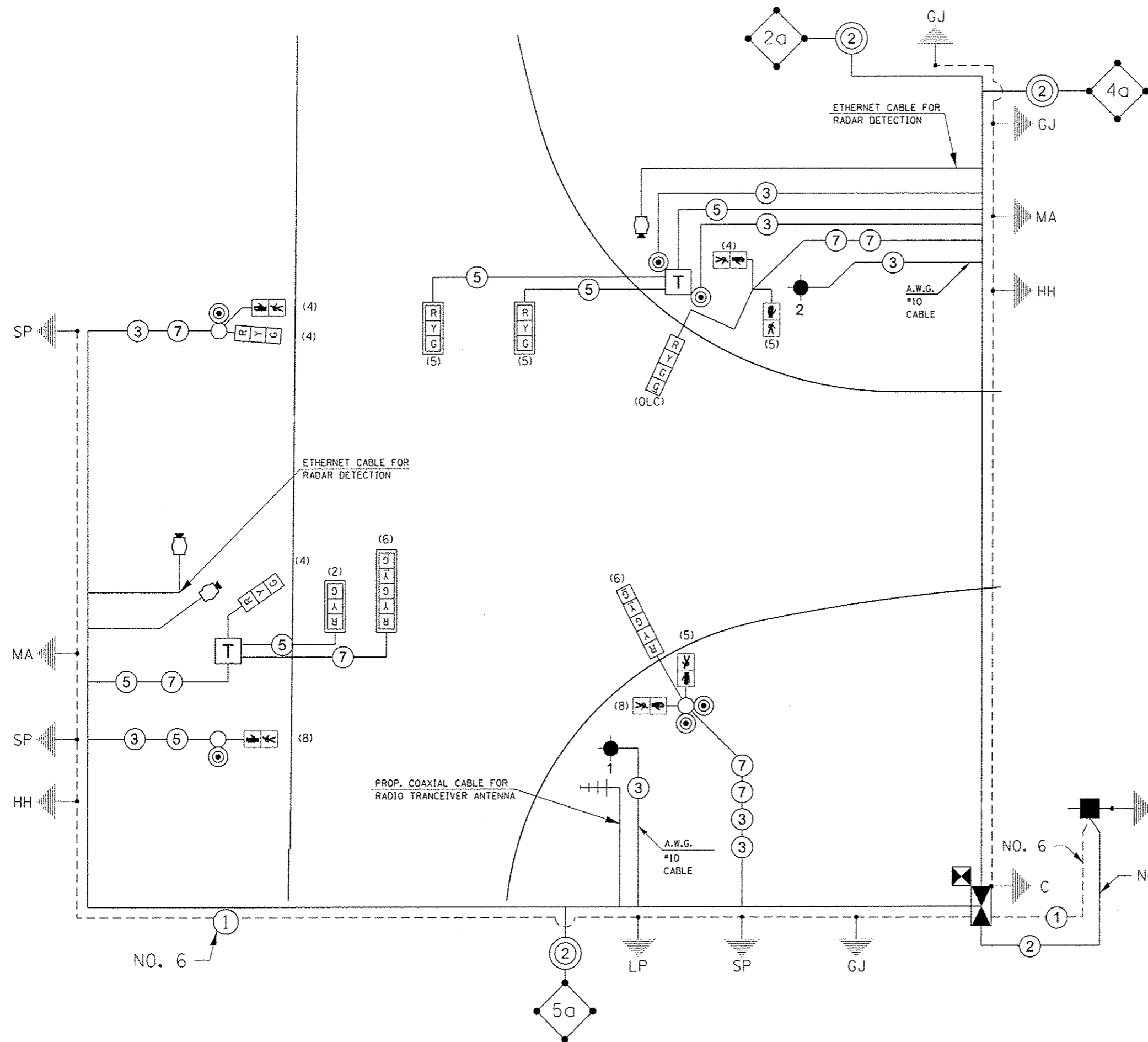

NOTES

- ALL CABLES SHALL BE A.W.G. #14 UNLESS OTHERWISE NOTED.
- ELECTRIC SERVICE IS SUPPLIED BY AMEREN CIPS.
- ELECTRIC CABLE DENOTED AS #10, 3/C BEING INSTALLED TO THE COMBINATION MAST ARM POLES SHALL NOT GO THROUGH THE TERMINAL BLOCK BUT SHOULD BE SPLICED IN POLE. SEE STEEL COMB. MAST ARM ASSEMBLY AND POLE DETAIL.
- PROPOSED COAXIAL CABLE AND ANTENNA INCLUDED IN THE COST OF RADIO TRANSCIEVER.
- ALL SIGNAL LENSES SHALL BE 12 INCHES.
- SEE SHEET #71 FOR THE ILLINOIS DEPARTMENT OF TRANSPORTATION LUMINAIRE PERFORMANCE TABLE

LEGEND

- PEDESTRIAN PUSH BUTTON
- PEDESTRIAN SIGNAL HEAD
- MOTION AND DETECTION SENSOR TO BE PAID FOR AS RADAR VEHICLE DETECTION SYSTEM
- TERMINAL BLOCK (SEE SPECIAL PROVISIONS).
- SINGLE LUMINAIRE. NUMBER INDICATED ON DRAWING DENOTES FIXTURE NUMBER
- 12" TRAFFIC SIGNAL SECTION. LETTER INDICATES COLOR.
- TRAFFIC SIGNAL CONTROLLER CABINET
- LIGHTING CONTROLLER, PEDESTAL MOUNTED, 240V, 60A
- NUMBER IN CIRCLE INDICATES NUMBER OF CONDUCTORS IN THAT CABLE
- NUMBER IN PARENTHESIS INDICATES PHASE

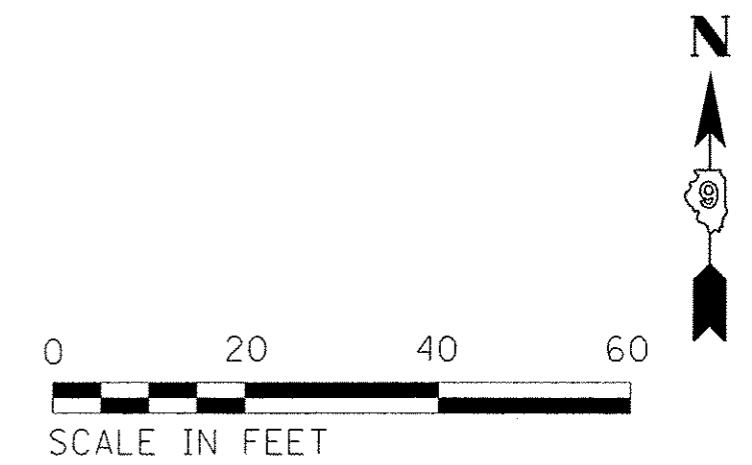

▲ REVISED SHEET 4-12-17

FILE NAME : USER NAME : greenlaasm DESIGNED - CHECKED - DATE - PLOT SCALE : 20,0000' / 1"	USER NAME : greenlaasm DESIGNED - CHECKED - DATE -	DRAWN BY : REVISED -	STATE OF ILLINOIS DEPARTMENT OF TRANSPORTATION	PROPOSED WIRING DIAGRAM		F.A.P. RTE. : 853	SECTION : 09 TRAFFIC SIGNAL 2014-1	COUNTY : FRANKLIN	TOTAL SHEETS : 104	SHEET NO. : 49
		SCALE:	SHEET OF SHEETS:	STA. TO STA.	CONTRACT NO. 78367		ILLINOIS FED. AID PROJECT			

PHASE DESIGNATION DIAGRAM

IL 37 & IL 14



REFERRING TO STANDARD 857001, THE VEHICULAR AND PEDESTRIAN PHASES USED ARE DESIGNATED AS SHOWN.

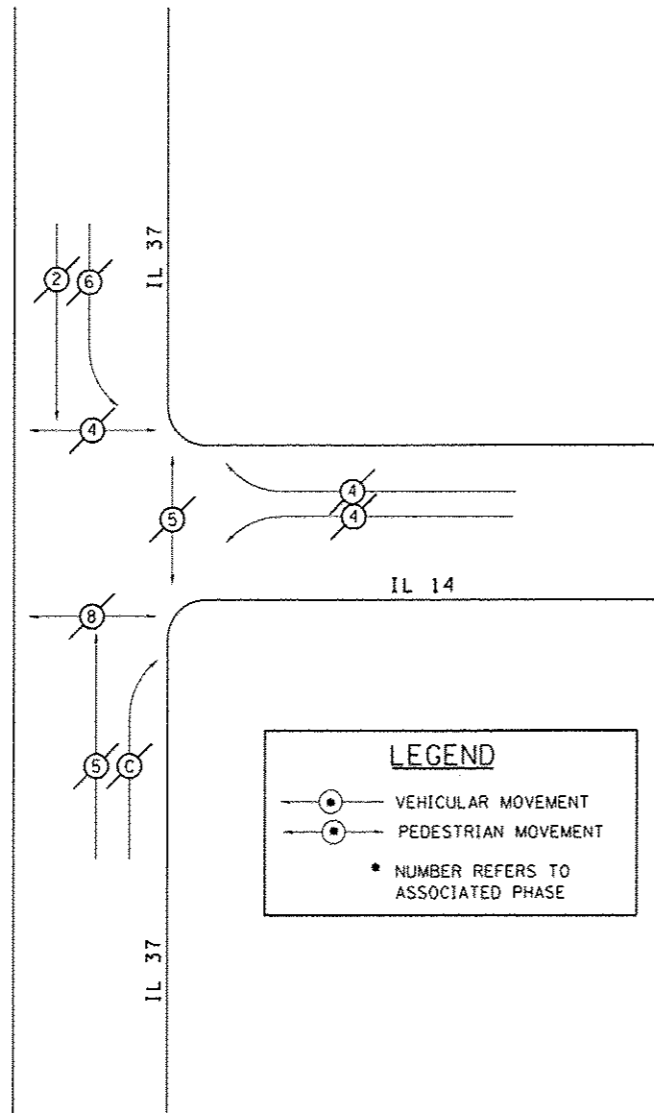

LEGEND

- VEHICULAR MOVEMENT
- PEDESTRIAN MOVEMENT
- NUMBER REFERS TO ASSOCIATED PHASE

WIRING DIAGRAM FOR LIGHTING

NOTES:

- FOR SIZE AND TYPE OF CABLE USED FOR LIGHTING INSTALLATION SEE CABLE DIAGRAM SHEET NO. 49.

LEGEND FOR WIRING DIAGRAM

HH INDICATES PROPOSED TRAFFIC SIGNAL HANDHOLE.

NOTE: THE SIGNAL CONDUIT SYSTEM SHALL BE UTILIZED TO INSTALL WIRING FOR ALL THE PROPOSED LIGHTING SYSTEM. A LIGHTING CONDUIT SHALL BE INSTALLED BETWEEN THE LIGHTING CONTROLLER AND THE TRAFFIC SIGNAL CONTROLLER. THIS SHALL BE COVERED UNDER PAY ITEM "87301815 - ELECTRIC CABLE IN CONDUIT SERVICE NO. 6 3C"

- 1** NUMBER INDICATES POSITION OF POLE IN WIRING DIAGRAM.
- INDICATES PROPOSED GROUND AT LIGHT POLE AND CONTROL INSTALLATION.
- INDICATES CONTINUOUS GROUND FROM CONTROL INSTALLATION.

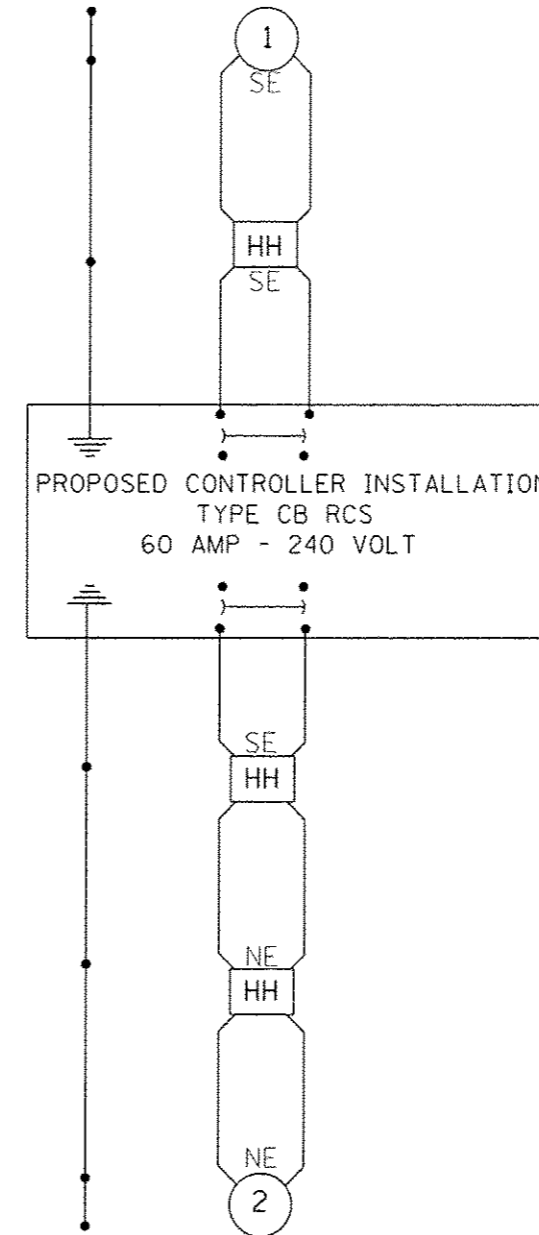

STANDARD 9-66

REVISIONS	
DRAWN	1-31-90
REVISED	5-30-90
REVISED	12-18-01
REVISED	3-27-08

REVISIONS	
DRAWN	7-27-93
REVISED	5-14-02
RESIZED	5-8-08

REVISIED SHEET 4-12-17

**STATE OF ILLINOIS
DEPARTMENT OF TRANSPORTATION**

PROPOSED PHASE DIAGRAM, LIGHTING DIAGRAM

FILE NAME :	USER NAME :	DESIGNED :	REVISED :	STATE OF ILLINOIS DEPARTMENT OF TRANSPORTATION	PROPOSED PHASE DIAGRAM, LIGHTING DIAGRAM	F.A.P. RTE.	SECTION	COUNTY	TOTAL SHEETS	SHEET NO.	
Default	greenloesm	-	-			853	09 TRAFFIC SIGNAL 2014-1	FRANKLIN	104	90	
		CHECKED :	REVISED :			CONTRACT NO. 78367					
		DATE :	REVISED :			ILLINOIS FED. AID PROJECT					

UNEVEN LANES SIGN

W8-11 (48" x 48")

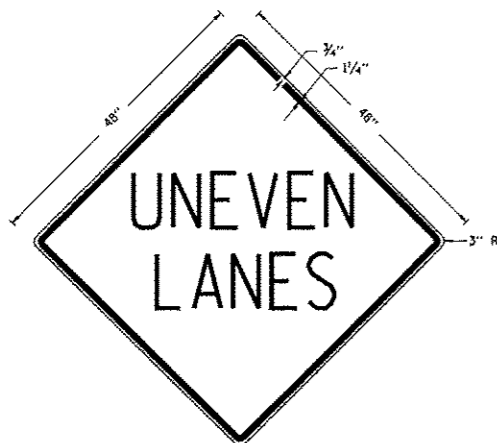

COLORS:
LEGEND AND BORDER - BLACK NON-REFLECTORIZED
BACKGROUND - ORANGE REFLECTORIZED

NOTE: PRIOR TO ALLOWING TRAFFIC ON ANY PORTION OF THE ROADWAY THAT HAS BEEN COLDMILLED OR BEFORE RESURFACING OPERATIONS BEGIN, THE CONTRACTOR SHALL HAVE ERECTED "UNEVEN PAVEMENT" SIGNS THAT CONFORM TO THE ABOVE DETAILS. A MINIMUM OF ONE SIGN AT EACH END OF THE IMPROVEMENT WILL BE REQUIRED. THE CONTRACTOR SHALL MAINTAIN THE "UNEVEN PAVEMENT" SIGNS UNTIL THE RESURFACING OPERATIONS ARE COMPLETED.

IF AT ANY TIME THE SIGNS ARE IN PLACE BUT NOT APPLICABLE, THEY SHALL BE TURNED FROM THE VIEW OF MOTORISTS OR COVERED AS DIRECTED BY THE ENGINEER.

THE COST OF FURNISHING, ERECTING, MAINTAINING, AND REMOVING THE REQUIRED SIGNS SHALL BE INCLUDED IN THE CONTRACT.

REVISIONS	
DRAWN	2-15-89
REVISED	4-06-93
REDESIGNED	7-23-04
RESIZED	5-08-08
REVIEWED	5-17-13

STD. 9-41

ILLINOIS STANDARD

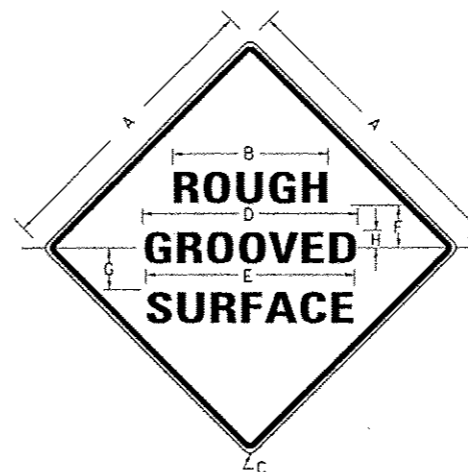

COLORS:

LEGEND AND BORDER- BLACK NON-REFLECTORIZED
BACKGROUND- ORANGE REFLECTORIZED

SIGN SIZE	DIMENSIONS							
	A	B	C	D	E	F	G	H
48X48	48.0	24.1	3.0	34.0	33.0	6.0	13.0	3.5

SIGN SIZE	SERIES LINES			MAR-GIN	BOR-DER	BLANK STD.
	1	2	3			
48X48	7C	7C	7C	0.8	1.2	B4-48D

ALL DIMENSIONS IN INCHES

NOTES:

PRIOR TO ALLOWING TRAFFIC ON ANY PORTION OF THE ROADWAY THAT HAS BEEN COLDMILLED, THE CONTRACTOR SHALL HAVE ERECTED "ROUGH GROOVED SURFACE" SIGNS THAT CONFORM TO THE ABOVE DETAILS. A MINIMUM OF ONE SIGN AT EACH END OF THE IMPROVEMENT WILL BE REQUIRED. THE CONTRACTOR SHALL MAINTAIN THE "ROUGH GROOVED SURFACE" SIGNS UNTIL THE COLDMILLED SURFACE IS COVERED WITH LEVELING BINDER OR SURFACE COURSE.

IF AT ANY TIME THE SIGNS ARE IN PLACE BUT NOT APPLICABLE, THEY SHALL BE TURNED FROM THE VIEW OF MOTORISTS OR COVERED AS DIRECTED BY THE ENGINEER.

THE COST OF FURNISHING, ERECTING, MAINTAINING, AND REMOVING THE REQUIRED SIGNS SHALL BE INCLUDED IN THE CONTRACT.

REVISIONS	
REDRAWN	2-15-89
REVISED	4-6-93
REVISED	3-27-08
REVIEWED	5-17-13

STD. 9-39

SEEDING & MULCHING

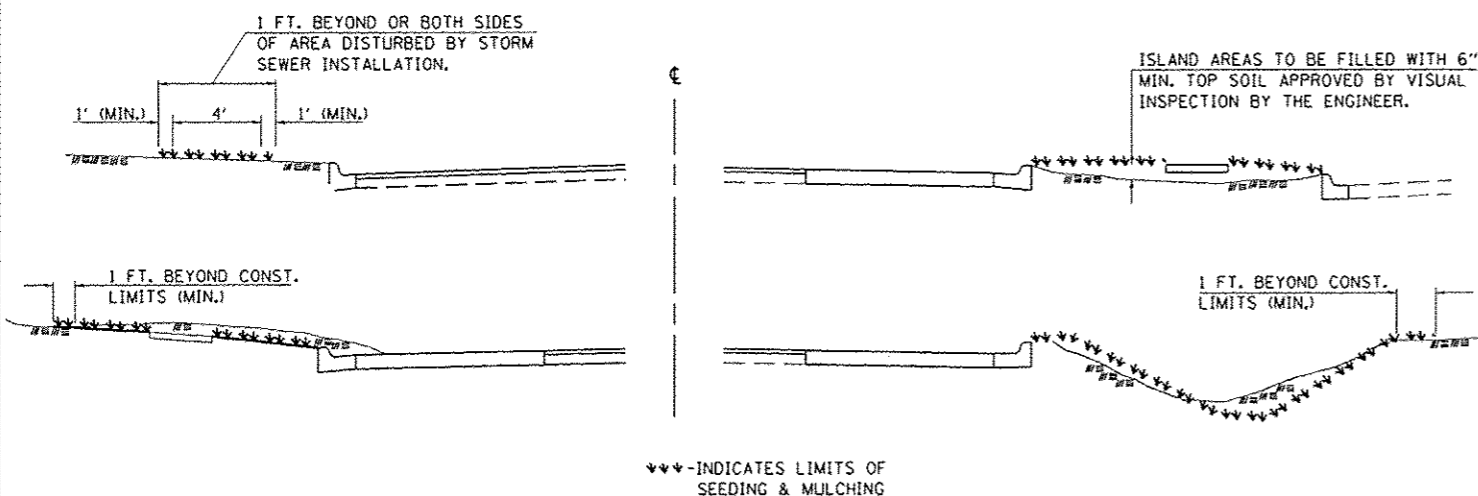

GENERAL NOTES

IN GENERAL, ALL EARTH SURFACES DISTURBED DURING CONSTRUCTION OPERATIONS SHALL BE SEEDED AND MULCHED UPON COMPLETION OF ALL GRADING OPERATIONS.

FERTILIZER NUTRIENTS AND LIMESTONE SHALL BE APPLIED TO ALL SEEDED AREAS.

THE RATES OF APPLICATION OF FERTILIZER, MULCH AND LIMESTONE SHALL BE AS SPECIFIED IN THE SPECIAL PROVISIONS.

SECTIONS 250 AND 251 OF THE STANDARD SPECIFICATIONS SHALL GOVERN THIS WORK EXCEPT AS SPECIFIED HEREIN OR AS NOTED IN THE SPECIAL PROVISIONS.

REVISIONS	
DRAWN	6-15-89
REVISED	8-16-94
REVISED	3-27-08
REVIEWED	-

STD. 9-52

BOLLARD LOCATIONS

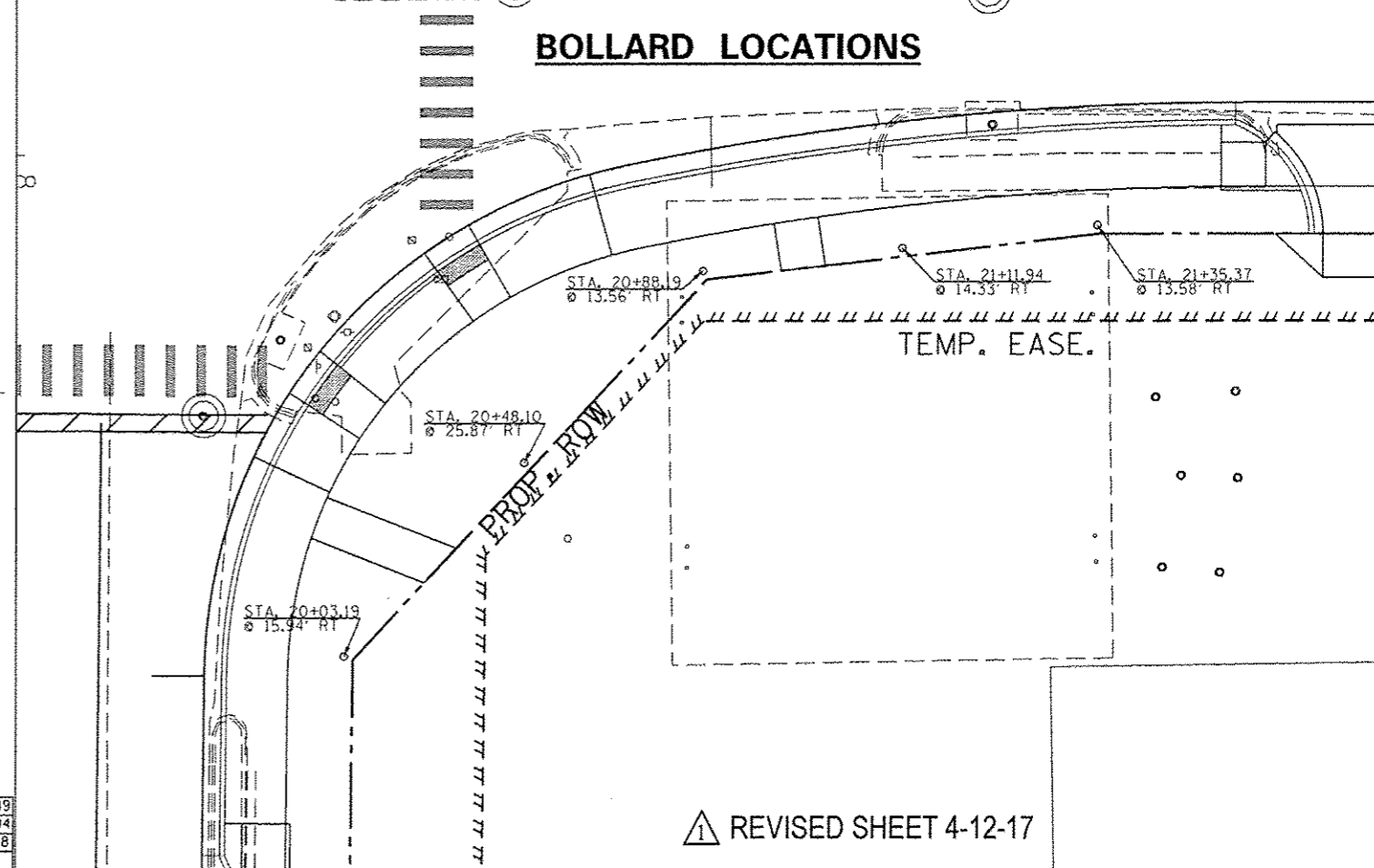

REVISOR'S MARK: **REVISOR'S MARK** (triangle with '1') REVISED SHEET 4-12-17

STATE OF ILLINOIS
DEPARTMENT OF TRANSPORTATION

DETAILS: INLET SPECIAL, CONCRETE COLLAR,
SERVICE INSTALLATION, BOLLARD LOCATIONS

F.A.P. RTE.	SECTION	COUNTY	TOTAL SHEETS	SHEET NO.
853	09 TRAFFIC SIGNAL 2014-1	FRANKLIN	104	70

CONTRACT NO. 78367

FILE NAME	USER NAME	DESIGNED	REVISED
pur\l\084EBID\INTEG.illinois.gov\PHI00T\Documents\DOT Offices\District 9\Projects\78367\Drawings\78367-sh1-details.dwg	greenleaf	-	-
		CHECKED	REVISED
		DATE	REVISED

PLOT SCALE = 20.0000 / 1" = 40.0000'
PLOT DATE = 4/10/2017

SCALE: SHEET OF SHEETS STA. TO STA.

ILLINOIS FED. AID PROJECT

DETECTABLE WARNING DETAIL

FRANKLIN COUNTY
 CONTRACT NO.: 78367
 SECTION:
 DISTRICT: 8

ILLINOIS DEPARTMENT OF TRANSPORTATION LUMINAIRE PERFORMANCE TABLE

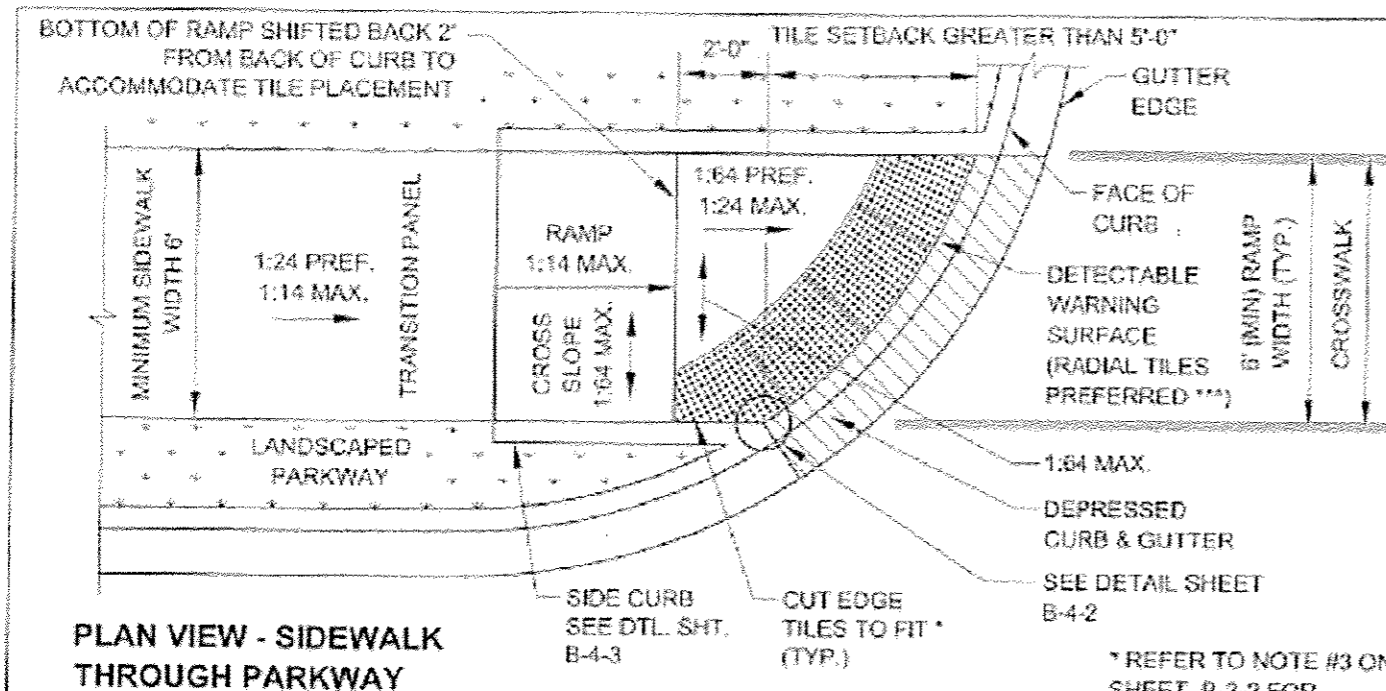

PLAN VIEW - SIDEWALK THROUGH PARKWAY

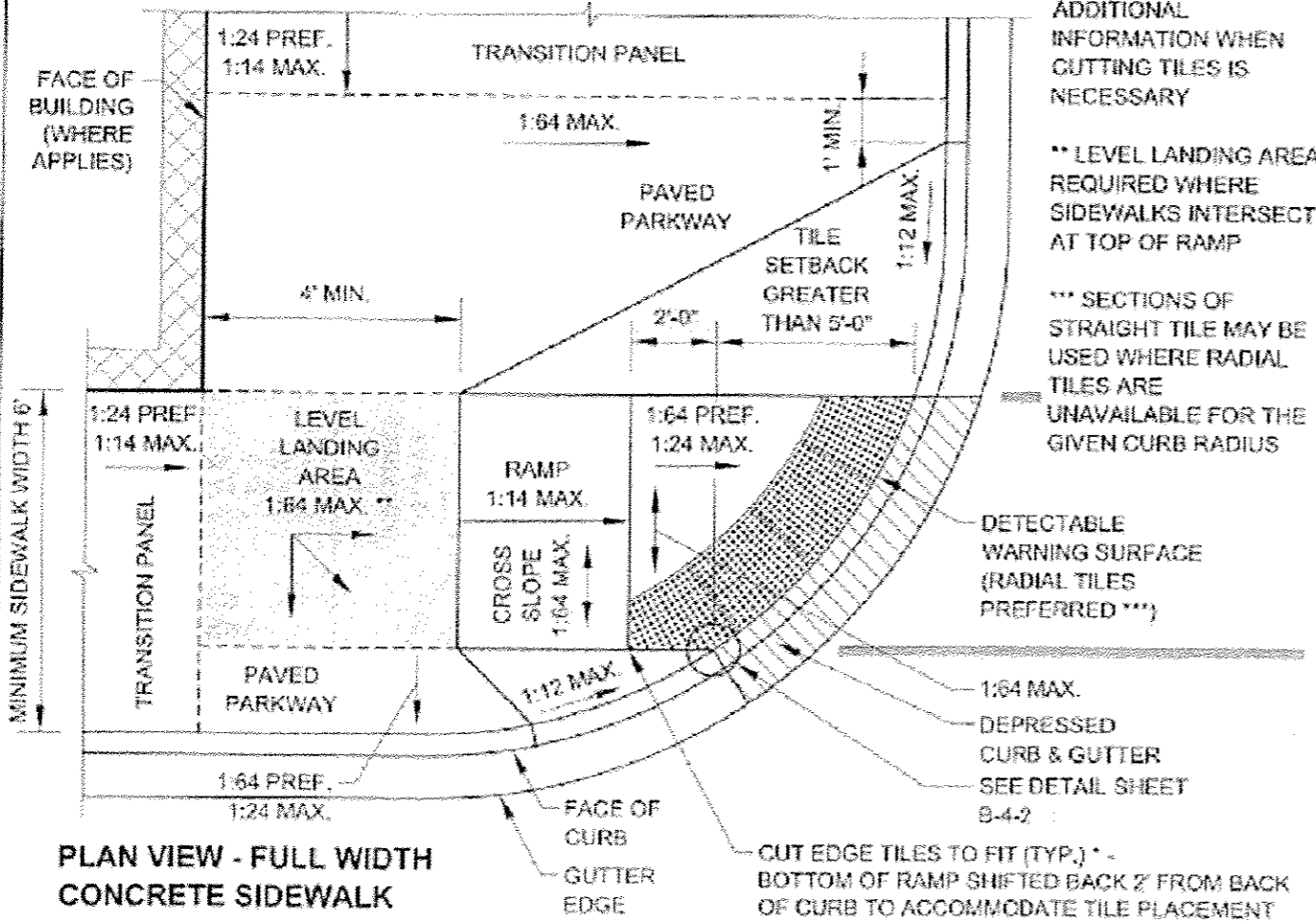

PLAN VIEW - FULL WIDTH CONCRETE SIDEWALK

* REFER TO NOTE #3 ON SHEET B-3-2 FOR ADDITIONAL INFORMATION WHEN CUTTING TILES IS NECESSARY

** LEVEL LANDING AREA REQUIRED WHERE SIDEWALKS INTERSECT AT TOP OF RAMP

*** SECTIONS OF STRAIGHT TILE MAY BE USED WHERE RADIAL TILES ARE UNAVAILABLE FOR THE GIVEN CURB RADIUS

GIVEN CONDITIONS

ROADWAY DATA	I.E.S. Surface Classification = R3, Q-Zero Value = 0.07	
	Lane Width	11 ft
	Number of Lanes (in each direction)	2
LIGHT POLE DATA	Mounting Height	45 ft
	Mast Arm Length	15 ft
	Pole Set-Back From Edge of Pavement	15 ft
LUMINAIRE DATA	Luminaire Type	HPS
	Initial Lumens	17,000 min.
	BUG Rating	U = 0
	I.E.S. Lateral Distribution	Type II
	Total Light Loss Factor	0.684
LAYOUT DATA	Spacing	128 ft
	Configuration	1 row, near side

PERFORMANCE REQUIREMENTS

ILLUMINANCE	Average Illuminance, E_{AVE}	≥ 0.8 fc
	Uniformity Ratio, E_{AVE}/E_{MIN}	$\leq 6.0 : 1$

LIGHT TRESPASS

ROADWAY DATA	Distance to R-O-W (Behind Pole)	6 ft
	Distance to R-O-W (Front of Pole)	88 ft

REVISOR: [Symbol] REVISED SHEET 4-12-17