

1. COVER SHEET
2. GENERAL NOTES
- 3-4. SUMMARY OF QUANTITIES
5. EXISTING TYPICAL SECTIONS
6. PROPOSED TYPICAL SECTIONS
7. PLAN AND PROFILE
8. CROSS SECTIONS

STANDARDS

000001-06	STANDARD SYMBOLS, ABBREVIATIONS AND PATTERNS
001001-02	AREAS OF REINFORCEMENT BARS
001006	DECIMAL OF AN INCH AND OF A FOOT
280001-07	TEMPORARY EROSION CONTROL SYSTEMS
442101-07	CLASS B PATCHES
701001-02	OFF-ROAD OPERATIONS 2L, 2W, MORE THAN 15' (4.5 m) AWAY
701006-05	OFF-ROAD OPERATIONS 2L, 2W, 15' (4.5 m) TO 24" (600 mm) FROM PAVEMENT EDGE
701201-04	LANE CLOSURE, 2L, 2W, DAY ONLY, FOR SPEEDS ≥ 45 MPH
701206-03	LANE CLOSURE, 2L, 2W, NIGHT ONLY, FOR SPEEDS ≥ 45 MPH
701301-04	LANE CLOSURE, 2L, 2W, SHORT TIME OPERATIONS
701901-06	TRAFFIC CONTROL DEVICES

PROJECT LOCATION

**EXISTING STRUCTURE NO. 046-2559
AT STA. 1006+18
OVER A TRIBUTARY OF REDDICK RUN
0.8 MILES NORTH OF THE FORD COUNTY LINE**

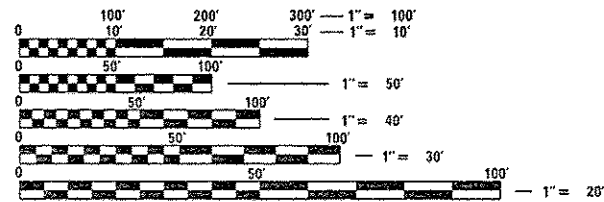

FULL SIZE PLANS HAVE BEEN PREPARED USING STANDARD ENGINEERING SCALES. REDUCED SIZED PLANS WILL NOT CONFORM TO STANDARD SCALES. IN MAKING MEASUREMENTS ON REDUCED PLANS, THE ABOVE SCALES MAY BE USED.

J.U.L.I.E.
JOINT UTILITY LOCATION INFORMATION FOR EXCAVATION
1-800-892-0123
OR 811

DISTRICT 3 PHONE: 815-434-6131
PROJECT ENGINEER: JOE KANNEL P.E.
UNIT CHIEF: RON WOODSHANK

CONTRACT NO. 66F69

STATE OF ILLINOIS
DEPARTMENT OF TRANSPORTATION

**PROPOSED
HIGHWAY PLANS**

F.A.P. ROUTE 796 (IL 115)
SECTION (104B)C
**CULVERT REMOVAL AND REPLACEMENT
KANKAKEE COUNTY**

C-93-108-16

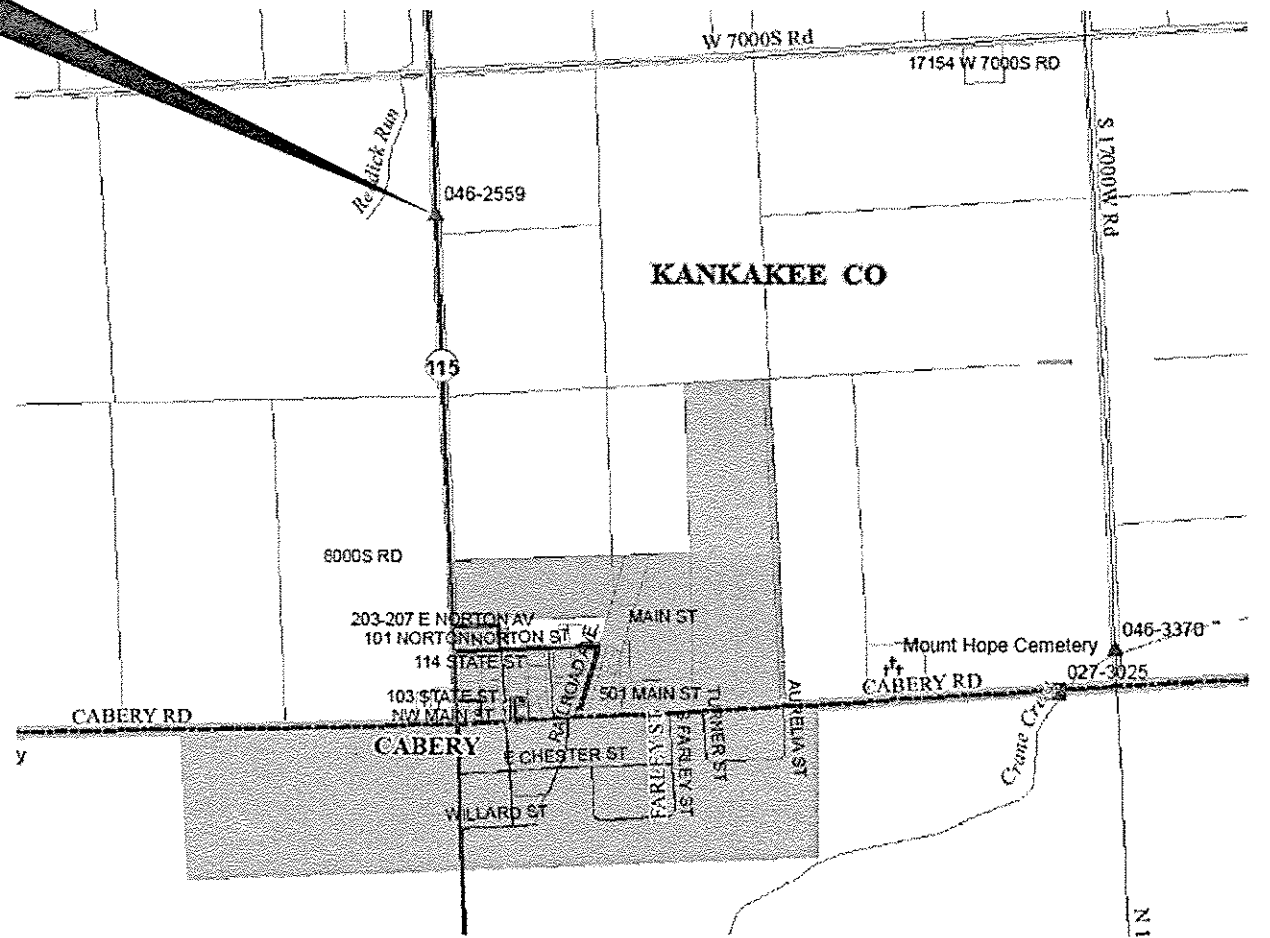

POINT LOCATION

F.A.P. RTE.	SECTION	COUNTY	TOTAL SHEETS	SHEET NO.
796	(104B)C	KANKAKEE	8	1
		ILLINOIS	CONTRACT NO. 66F69	

D-93-002-16

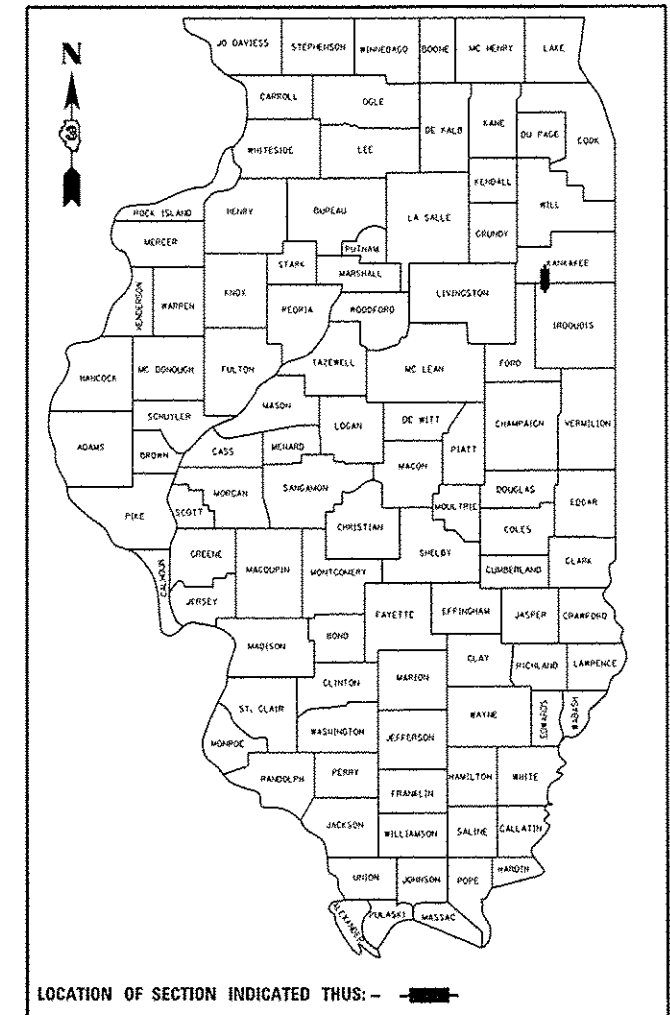

LOCATION OF SECTION INDICATED THUS: - [shaded box] -

FUNCTIONAL CLASSIFICATION

RURAL - MAJOR COLLECTOR
2015 ADT 525
P.V. 43.3%
S.U. 5.71%
M.U. 3.81%

STATE OF ILLINOIS
DEPARTMENT OF TRANSPORTATION

SUBMITTED 2-15 2017
Kevin Marchek P.E.
REGIONAL ENGINEER

Mar 24 2017
Muhammad M. Adis P.E.
ENGINEER OF DESIGN AND ENVIRONMENT

Mar 24 2017
Annele [Signature]
DIRECTOR OF PROGRAM DEVELOPMENT

PRINTED BY THE AUTHORITY
OF THE STATE OF ILLINOIS

GENERAL NOTES

THE THICKNESS OF HMA SHOWN ON THE PLANS IS THE NOMINAL THICKNESS. DEVIATIONS FROM THE NOMINAL THICKNESS WILL BE PERMITTED WHEN SUCH DEVIATIONS OCCUR DUE TO IRREGULARITIES IN THE EXISTING SURFACE OR BASE ON WHICH THE HMA IS PLACED.

BEFORE ORDERING PIPE CULVERTS OR PIPE DRAINS, THE CONTRACTOR SHALL CONSULT THE ENGINEER FOR EXACT LENGTHS.

FOR STABILIZATION, ALL TYPE III BARRICADES WILL REQUIRE A MINIMUM OF FOUR SAND BAGS PER BARRICADE.

SEEDING WILL NOT BE PERMITTED AT ANY TIME WHEN THE GROUND IS FROZEN, WET, OR IN AN UNTILLABLE CONDITION. LOCATIONS TO BE SEEDED WILL BE DETERMINED BY THE ENGINEER.

THE FINISHED EARTHWORK SHALL HAVE A VEGETATION SUSTAINING SOIL COVERING THE TOP FOUR INCHES IN AREAS TO BE SEEDED OR SODDED. THE VEGETATION SUSTAINING SOIL REQUIRED WILL NOT BE PAID FOR SEPARATELY BUT WILL BE INCLUDED IN THE COST OF "FURNISHED EXCAVATION".

ON EXISTING PAVEMENT WHICH MAY BE SUPERELEVATED, THE NEW HMA PAVEMENT SHALL BE BUILT WITH THE SAME SUPERELEVATION UNLESS NEW SUPERELEVATION RATES ARE GIVEN ON THE PLANS.

ABANDONED UNDERGROUND UTILITIES THAT CONFLICT WITH CONSTRUCTION SHALL BE DISPOSED OF OUTSIDE THE LIMITS OF THE RIGHT OF WAY ACCORDING TO ARTICLE 202.03 OF THE STANDARD SPECIFICATIONS AND AS DIRECTED BY THE ENGINEER. THIS WORK WILL NOT BE PAID FOR SEPARATELY, BUT WILL BE INCLUDED IN THE COST OF EARTH EXCAVATION.

ANY REFERENCE TO A STANDARD IN THESE PLANS SHALL BE INTERPRETED TO MEAN THE EDITION AS INDICATED BY THE SUBNUMBER SHOWN IN THE LIST OF STANDARDS OR THE COPY INCLUDED IN THESE PLANS.

THE FOLLOWING RATES OF APPLICATION HAVE BEEN USED IN CALCULATING PLAN QUANTITIES:

GRANULAR MATERIALS	2.05	TONS / CU YD
--------------------	------	--------------

THE CONTRACTOR SHALL CONTACT JULIE AT LEAST 48 HOURS PRIOR TO EXCAVATION TO DETERMINE WHICH UTILITIES ARE IN THE AREA.

COMMITMENTS

STATE OF ILLINOIS
DEPARTMENT OF TRANSPORTATION
DISTRICT THREE
AS BUILT INFORMATION

SUPERVISING CONSTRUCTION FIELD ENGINEER

RESIDENT ENGINEER / TECHNICIAN

START & END DATES
OF CONSTRUCTION:

INSPECTORS:

DATE:

2-15-17

PREPARED BY:

[Signature]

DISTRICT STUDIES & PLANS ENGINEER

EXAMINED BY:

[Signature]

DISTRICT CONSTRUCTION ENGINEER

[Signature]

DISTRICT MATERIALS ENGINEER

[Signature]

DISTRICT OPERATIONS ENGINEER

STATE OF ILLINOIS
DEPARTMENT OF TRANSPORTATION

GENERAL NOTES

FILE NAME :	USER NAME :	DESIGNED -	REVISED -	STATE OF ILLINOIS DEPARTMENT OF TRANSPORTATION	GENERAL NOTES	F.A.P. RTE.	SECTION	COUNTY	TOTAL SHEETS	SHEET NO.	
p:\110946BID\INTEC\Illinois.gov\PW1001\Documents\1001\Offices\District 3\Projects\036	woodshankr1	DRAWN	REVISED			796	1104BC	KANKAKEE	8	2	
		CHECKED -	REVISED -			CONTRACT NO. 66F69					
Default		DATE -	REVISED -			SCALE:	SHEET 1	OF 1	SHEETS	STA.	TO STA.
		PLOT SCALE = 100,0000 / in.									
		PLOT DATE = 2/10/2017									

CODE NO.	ITEM	UNIT	TOTAL QUANTITY	CONSTR. CODE
				CONT. MAINT. 100% STATE PIPE CULVERT <i>0004</i> RURAL
20200100	EARTH EXCAVATION	CU YD	20	20
25000210	SEEDING, CLASS 2A	ACRE	0.1	0.1
25000400	NITROGEN FERTILIZER NUTRIENT	POUND	9	9
25000500	PHOSPHORUS FERTILIZER NUTRIENT	POUND	9	9
25000600	POTASSIUM FERTILIZER NUTRIENT	POUND	9	9
25100635	HEAVY DUTY EROSION CONTROL BLANKET	SQ YD	400	400
44201035	CLASS B PATCHES, TYPE III, 15 INCH	SQ YD	44	44
48101200	AGGREGATE SHOULDERS, TYPE B	TON	2	2
50100100	REMOVAL OF EXISTING STRUCTURES	EACH	1	1
50800205	REINFORCEMENT BARS, EPOXY COATED	POUND	654	654
52100510	ANCHOR BOLTS, 3/4"	EACH	16	16
542A5485	PIPE CULVERTS, CLASS A, TYPE 1 EQUIVALENT ROUND-SIZE 30"	FOOT	48	48
59300100	CONTROLLED LOW-STRENGTH MATERIAL	CU YD	15	15
67100100	MOBILIZATION	LSUM	1	1

FILE NAME :	USER NAME :	DESIGNED :	REVISED :
p:\1\084E810INTEG\illinois.gov\PK1001\Documents\1001 Offices\District 3\Projects\036	woodshankr1	RW	-
		DRAWN :	REVISED :
		0368F	-
		CHECKED :	REVISED :
		EP	-
		DATE :	REVISED :
		1/6/2017	-

**STATE OF ILLINOIS
DEPARTMENT OF TRANSPORTATION**

SUMMARY OF QUANTITIES

SCALE: SHEET 1 OF 1 SHEETS STA. TO STA.

F.A.P. RTE.	SECTION	COUNTY	TOTAL SHEETS	SHEET NO.
796	(104)C	KANKAKEE	8	3
CONTRACT NO. 66F69			ILLINOIS FED. AID PROJECT	

REV

CODE NO.	ITEM	UNIT	TOTAL QUANTITY	CONSTR. CODE
				CONT. MAINT. 100% STATE PIPE CULVERT 0004 RURAL
70100450	TRAFFIC CONTROL AND PROTECTION, STANDARD 701201	LSUM	1	1
70100455	TRAFFIC CONTROL AND PROTECTION, STANDARD 701206	LSUM	1	1
70200100	NIGHTTIME WORK ZONE LIGHTING	LSUM	1	1
Z0030850	TEMPORARY INFORMATION SIGNING	SO FT	42	42
X6060100	CLASS SI CONCRETE FOR END SECTION	CU YD	4	4

5

FILE NAME :	USER NAME = woodshankr1	DESIGNED - RW	REVISED -	STATE OF ILLINOIS DEPARTMENT OF TRANSPORTATION	GENERAL NOTES	F.A.P. RTE.	SECTION	COUNTY	TOTAL SHEETS	SHEET NO.	
pw\11094EBID\INTEG\illinois.gov\PWID01\0	Documents\DDT Offices\District 3\Projects\0366	DRAWN Data\0366\RWdetails.dgn	REVISED -			796	(104)C	KANKAKEE	8	4	
Default	PLOT SCALE = 100.0000 1/ in.	CHECKED - EP	REVISED -			SCALE:		SHEET 1 OF 1 SHEETS		STA. TO STA.	ILLINOIS FED. AID PROJECT
	PLOT DATE = 2/19/2017	DATE - 1/6/2017	REVISED -								

REV

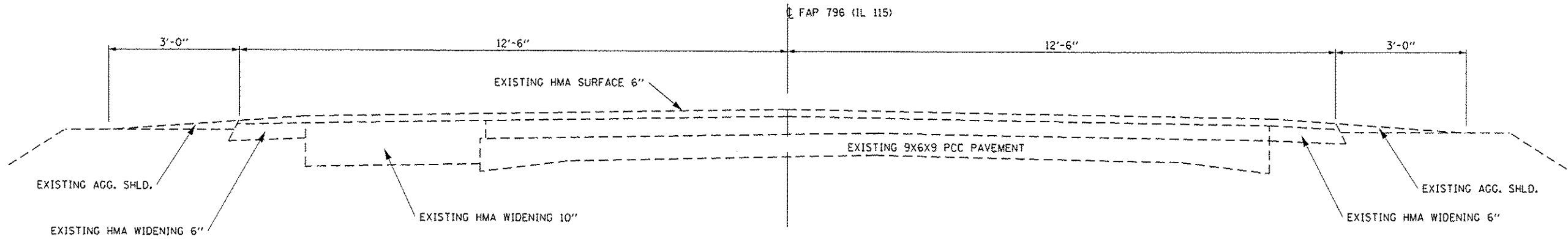

EXISTING TYPICAL SECTION
NORTH AND SOUTH OF CULVERT
 LOOKING SOUTH

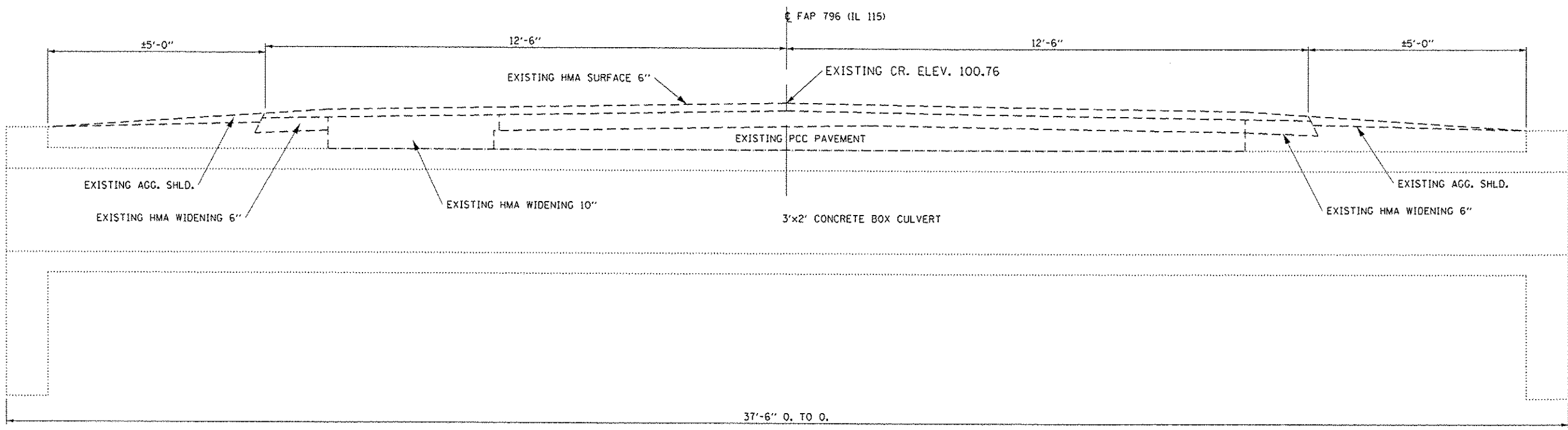

EXISTING TYPICAL SECTION
STA. 1006 + 18
 LOOKING SOUTH

FILE NAME : p:\11\084610\FEG\Illinois.gov\PIW1001\Documents\1001\District 3\Projects\026\DRAWNData\666F\RWdetails.dgn Default	USER NAME : woodshank1	DESIGNED - RW	REVISED -	STATE OF ILLINOIS DEPARTMENT OF TRANSPORTATION	GENERAL NOTES	F.A.P. RTE. 796	SECTION (104)C	COUNTY KANKAKEE	TOTAL SHEETS 8	SHEET NO. 5
	PLOT SCALE : 100.0000 ' / in.	CHECKED - EP	REVISED -			STA. TO STA.	CONTRACT NO. 66F69			
	PLOT DATE : 2/18/2017	DATE - 1/6/2017	REVISED -			ILLINOIS FED. AID PROJECT				
						SCALE: SHEET 1 OF 1 SHEETS				

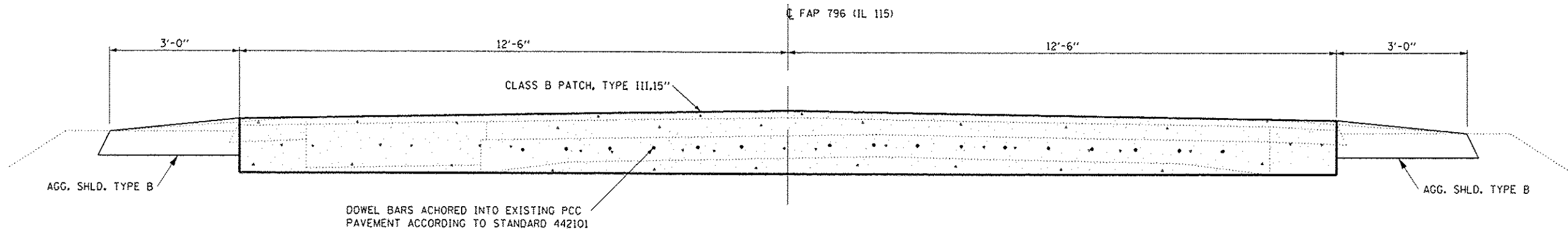

PROPOSED TYPICAL SECTION
NORTH AND SOUTH OF CULVERT
 LOOKING SOUTH

NOTE:
 IF THE ENGINEER DETERMINES THAT THE EXISTING SUB-BASE IS UNSUITABLE FOR RECONSTRUCTION, THE SUB-BASE SHALL BE EXCAVATED TO A DEPTH DETERMINED BY THE ENGINEER AND THE MATERIAL REPLACED WITH AGGREGATE ACCORDING TO SECTION 358 OF THE STANDARD SPECIFICATIONS. COST OF THE EXCAVATION, DISPOSAL OF EXCAVATED MATERIALS, FURNISHING, PLACING AND COMPACTION EFFORTS OF NEW AGGREGATE SHALL BE PAID FOR ACCORDING TO ARTICLE 109.04 OF THE STANDARD SPECIFICATIONS.

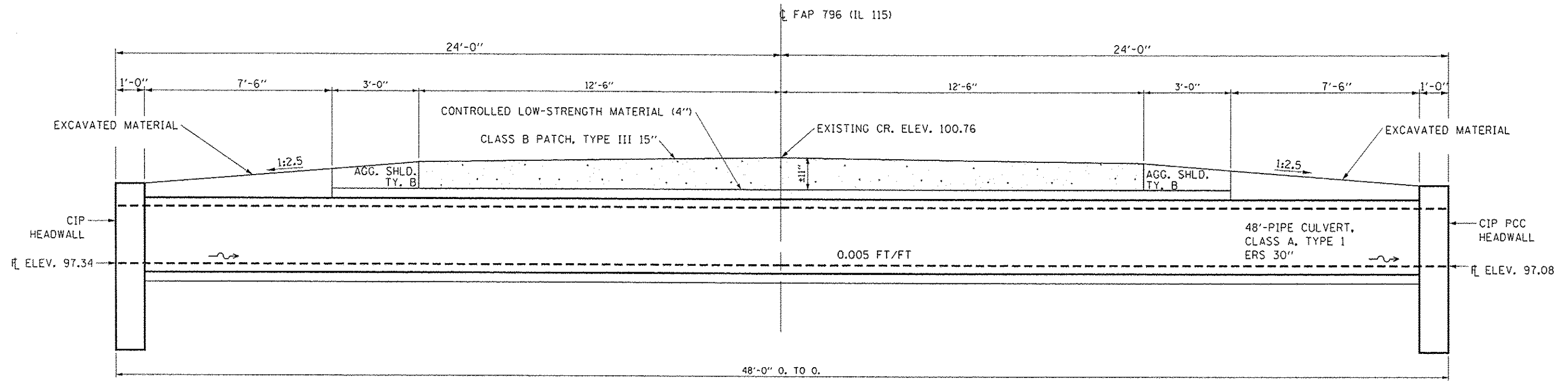

PROPOSED TYPICAL SECTION
STA. 1006 + 18
 LOOKING SOUTH

FILE NAME :	USER NAME :	DESIGNED -	REVISED -	STATE OF ILLINOIS DEPARTMENT OF TRANSPORTATION	GENERAL NOTES	F.A.P. RTE.	SECTION	COUNTY	TOTAL SHEETS	SHEET NO.	
path\11084EBIDINTEG\illinois.gov\PI\DOT\Documents\1007 Offices\District 3\Projects\0364	woodshank-1	RW	-			796	(104)C	KANKAKEE	8	6	
Default		DRAWN	-			SCALE:	SHEET 1	OF 1	SHEETS	STA.	TO STA.
		CHECKED	-								
		DATE	-								
			-								

DATE	
BY	
FINISHED	
REVISIONS	
NO. 1	
NO. 2	
NO. 3	
NO. 4	
NO. 5	
NO. 6	
NO. 7	
NO. 8	
NO. 9	
NO. 10	
NO. 11	
NO. 12	
NO. 13	
NO. 14	
NO. 15	
NO. 16	
NO. 17	
NO. 18	
NO. 19	
NO. 20	
NO. 21	
NO. 22	
NO. 23	
NO. 24	
NO. 25	
NO. 26	
NO. 27	
NO. 28	
NO. 29	
NO. 30	
NO. 31	
NO. 32	
NO. 33	
NO. 34	
NO. 35	
NO. 36	
NO. 37	
NO. 38	
NO. 39	
NO. 40	
NO. 41	
NO. 42	
NO. 43	
NO. 44	
NO. 45	
NO. 46	
NO. 47	
NO. 48	
NO. 49	
NO. 50	

DATE	
BY	
FINISHED	
REVISIONS	
NO. 1	
NO. 2	
NO. 3	
NO. 4	
NO. 5	
NO. 6	
NO. 7	
NO. 8	
NO. 9	
NO. 10	
NO. 11	
NO. 12	
NO. 13	
NO. 14	
NO. 15	
NO. 16	
NO. 17	
NO. 18	
NO. 19	
NO. 20	
NO. 21	
NO. 22	
NO. 23	
NO. 24	
NO. 25	
NO. 26	
NO. 27	
NO. 28	
NO. 29	
NO. 30	
NO. 31	
NO. 32	
NO. 33	
NO. 34	
NO. 35	
NO. 36	
NO. 37	
NO. 38	
NO. 39	
NO. 40	
NO. 41	
NO. 42	
NO. 43	
NO. 44	
NO. 45	
NO. 46	
NO. 47	
NO. 48	
NO. 49	
NO. 50	

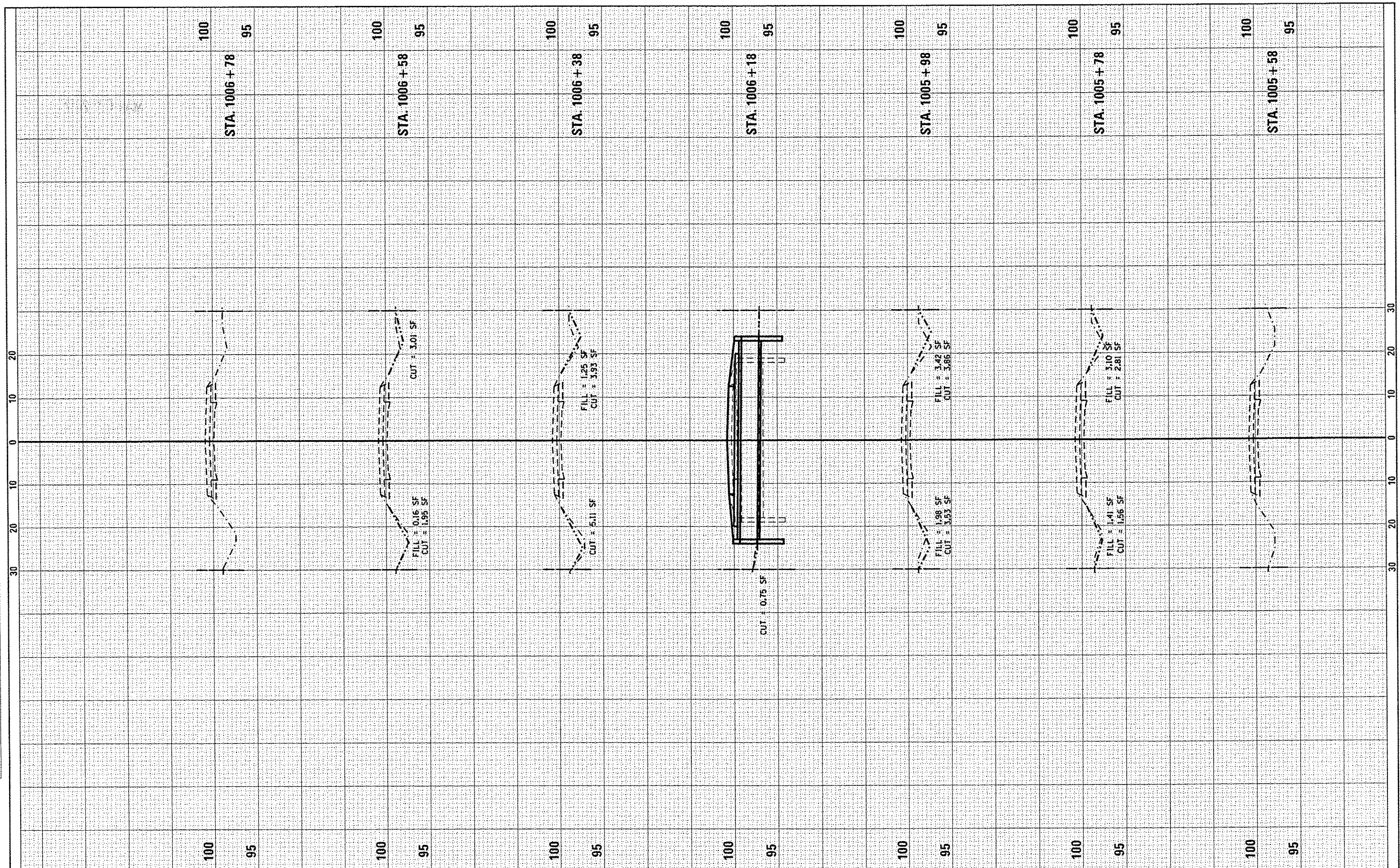

FILE NAME =	USER NAME = woadshank	DESIGNED - RW	REVISED -	STATE OF ILLINOIS DEPARTMENT OF TRANSPORTATION	CROSS SECTIONS	F.A.P. RTE. 796	SECTION 1104BIC	COUNTY KANKAKEE	TOTAL SHEETS 8	SHEET NO. 8		
CONTRACT NO. 66F69	PLLOT SCALE = 100.0000 / in.	CHECKED - EP	REVISED -			SCALE:	SHEET 1 OF 1 SHEETS	STA. TO STA.	ILLINOIS FED. AID PROJECT			
PLLOT DATE = 2/10/2017	DATE - 1/18/17	REVISED -	REVISED -									