



Existing Structure: S.N. 098-0034 was originally constructed in 1940 carrying one lane of eastbound and one lane of westbound US Route 30 over Rock River (F.A. Route 141/Section 110-BFP) and is 31'-7" wide 1078'-3" long. The structure consists of two 4-span continuous units symmetrical about the center pier (Pier 4) and supported by reinforced stub abutments on steel piles and wall piers on timber or steel piles. In 1989, the bridge length was increased from 1078'-3" to 1097'-7" (back-to-back-abutments), and the width was increased from 31'-7" to 43'-2". The existing 8-span steel superstructure and abutments were removed. The existing piers remained and had their pier caps extended. A new steel plate girder superstructure and new pile bent abutments were built.

The structure will be closed to vehicular traffic during construction.

No Salvage.

LEGEND

-  Concrete Removal
-  Traffic Direction

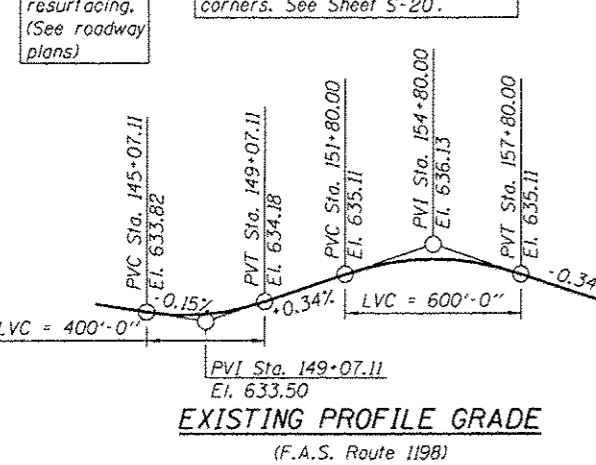
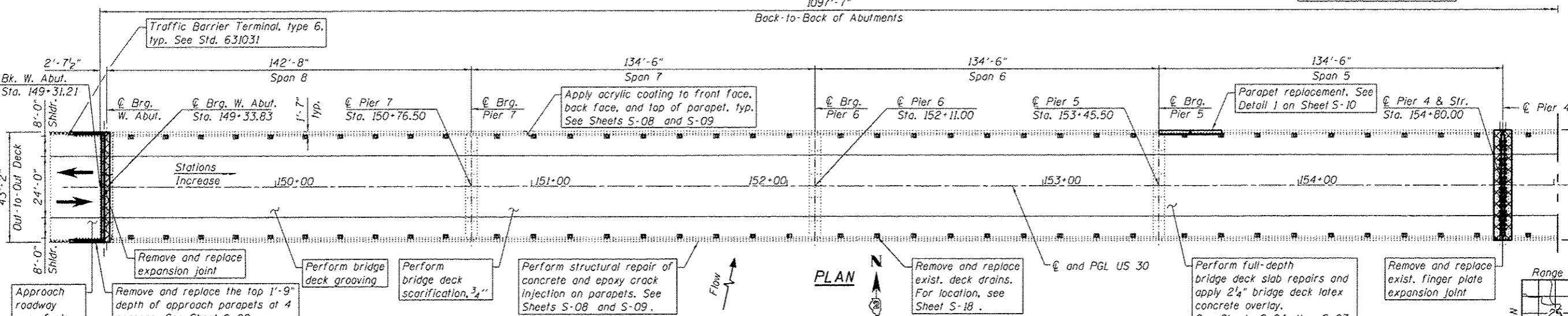
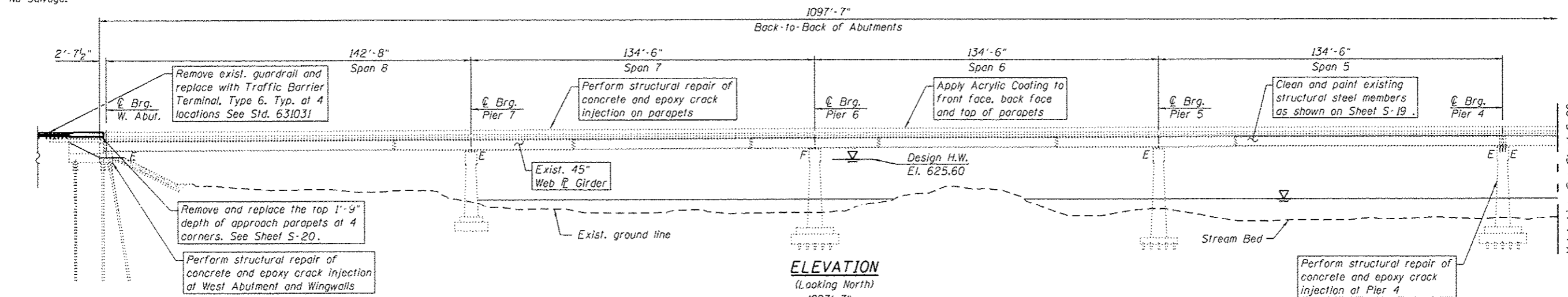

LOADING
HS20-44

REHABILITATION (1989)
Allow 25 #/sq. ft. for future wearing surface

DESIGN SPECIFICATIONS
2002 AASHTO Standard Specifications for Highway Bridges

REHABILITATION (1989)
1983 AASHTO, 1984 thru 1988 Interim Specifications

DESIGN STRESSES

FIELD UNITS
 $f'_c = 4,000$ psi (Concrete)
 $f_y = 60,000$ psi (Reinforcement)
 $f_y = 50,000$ psi (M270 Grade 50)

REHABILITATION (1989)
 $f'_c = 3,500$ psi (Concrete)
 $f_y = 60,000$ psi (Reinforcement)
 $f_y = 50,000$ psi (M270 Grade 50)
 $f_y = 36,000$ psi (M270 Grade 36)

NOTES:

1. For bridge approach pavement resurfacing and bridge approach shoulder pavement replacement and resurfacing, see Roadway Plans.
2. For guardrail removal and replacement, see Roadway Plans.

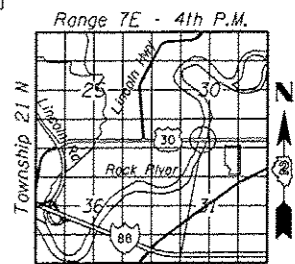

LOCATION SKETCH

GENERAL PLAN AND ELEVATION
SPANS 5 THRU 8
US ROUTE 30 (F.A.S. ROUTE 1198)
OVER ROCK RIVER
WHITESIDE COUNTY
STATION 154+80
STRUCTURE NO. 098-0034



Signed Moussa A. Issa
Moussa A. Issa, HBM II. Lic. No. 081-005738
Expires 11-30-2016

Date 01/22/2016 For Sheets S-01 Thru S-23
(Total of S-23 Sheets)



USER NAME *	DESIGNED - MI, FA	REVISED
PLOT SCALE *	CHECKED - MAI, MI	REVISED
PLOT DATE *	DRAWN - FA	REVISED
	DATE - 1/22/2016	REVISED

STATE OF ILLINOIS
DEPARTMENT OF TRANSPORTATION

GENERAL PLAN AND ELEVATION (SPANS 5 THRU 8)
US ROUTE 30 OVER THE ROCK RIVER STRUCTURE NO. 098-0034

SHEET S-01 OF S-23 SHEETS

F.A.S. RTE.	SECTION	COUNTY	TOTAL SHEETS	SHEET NO.
1198	110 BRM	WHITESIDE	34	01
			CONTRACT NO. 64L09	
[ILLINOIS] FED. AID PROJECT				

1/22/2016 10:35:30 AM P:\1208-552\DOT\Various\Various (Office) 21\Work\Draws\7\Sheets\Structural\SD1-CPE (Sheet 1 of 2).dgn

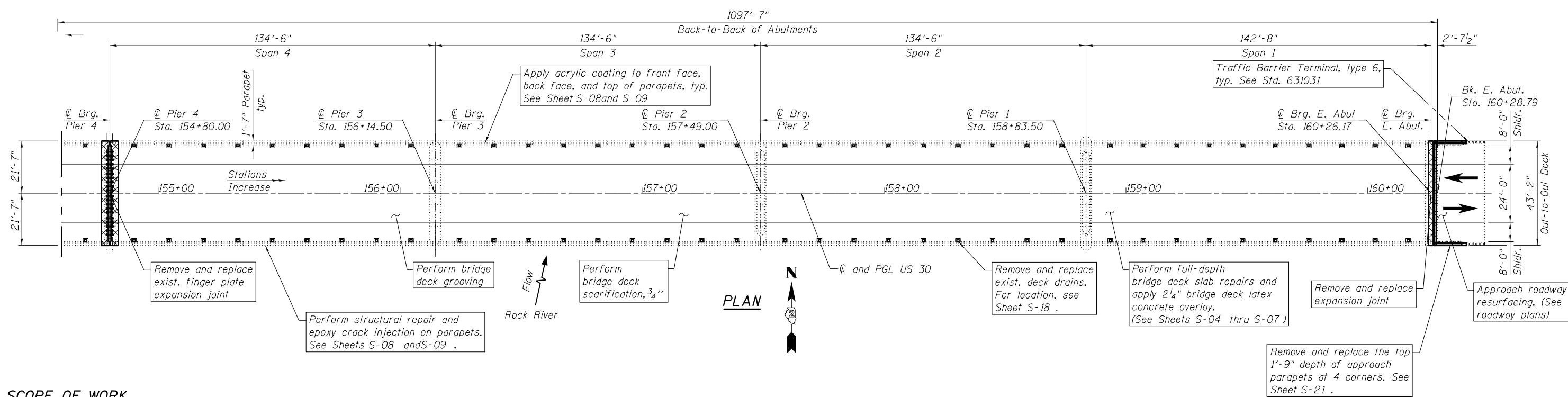
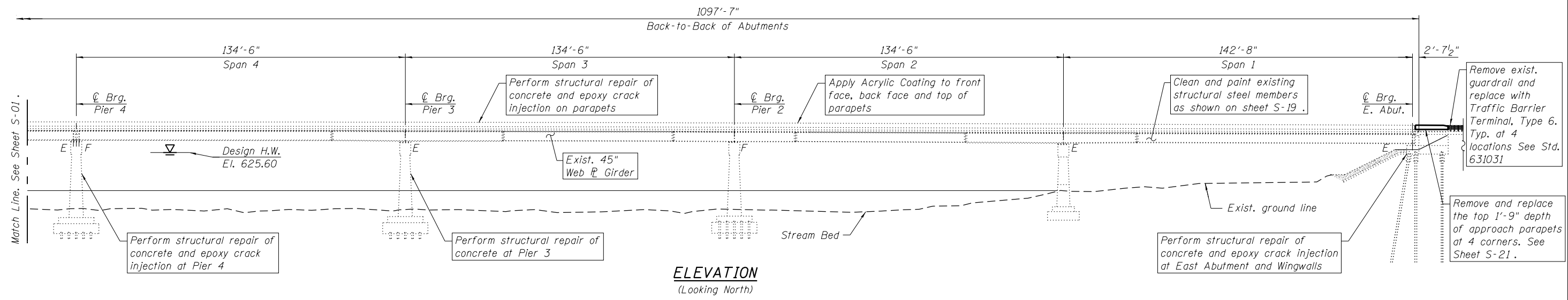

SCOPE OF WORK

- Scarify 3/4" from the bridge deck slab.
- Perform full depth deck slab repairs.
- Remove and replace existing deck drains.
- Remove and replace the neoprene expansion joints at the East and West Abutments with strip seal joints. Remove and replace the finger plate expansion joint at Pier 4 in kind.
- Perform structural repair of concrete, epoxy crack injection and/or partial replacement of the parapets as required.
- Apply a 2 1/4" bridge deck latex concrete overlay to the bridge deck slab.
- Perform bridge deck grooving for the 2 1/4" bridge deck latex concrete overlay and reconstructed transverse expansion joints.
- Apply protective coat for the reconstructed parapets and reconstructed expansion joint areas.
- Apply acrylic paint for the inside face, back face and top of existing and reconstructed parapets.
- Clean and repaint existing outside face of fascia girders and bottom face of their bottom flanges on both sides of the bridge as required. Clean and repaint all steel elements located under the expansion joints at East and West Abutments and Pier 4.
- Repair, clean and paint the existing bearings located under the expansion joints at the East and West Abutments and Pier 4.
- Perform structural concrete repairs and crack sealing repairs for the abutments, wingwalls, and Piers 3 and 4.
- Clean bridge seats and apply concrete sealant at the East and West Abutments and Pier 4.
- Repaint pavement markings on the top of deck.

NOTES:

- For bridge approach pavement resurfacing and bridge approach shoulder pavement replacement and resurfacing, see Roadway Plans.
- For guardrail removal and replacement, see Roadway Plans.

LEGEND

- Concrete Removal
- Traffic Direction

**GENERAL PLAN AND ELEVATION
SPANS 1 THRU 4
US ROUTE 30 (F.A.S. ROUTE 1198)
OVER ROCK RIVER
WHITESIDE COUNTY
STATION 154+80
STRUCTURE NO. 098-0034**

1/22/2016 2:43:51 PM P:\1208-562 IDOT Various\Various (District 2)\Work Order 7\Sheets\Structural\SO2-GPE(Sheet 2 of 2).dgn



USER NAME =	DESIGNED - MI, FA	REVISION
	CHECKED - MAI, MI	REVISION
PLOT SCALE =	DRAWN - FA	REVISION
PLOT DATE	DATE - 1/22/2016	REVISION

**STATE OF ILLINOIS
DEPARTMENT OF TRANSPORTATION**

**GENERAL PLAN AND ELEVATION (SPANS 1 THRU 4)
US ROUTE 30 OVER THE ROCK RIVER STRUCTURE NO. 098-0034**

F.A.S. RTE.	SECTION	COUNTY	TOTAL SHEETS	SHEET NO.
1198	(110 BRM)	WHITESIDE	34	08
			CONTRACT NO. 64L09	
ILLINOIS FED. AID PROJECT				

SHEET S-02 OF S-23 SHEETS