

STATE OF ILLINOIS
DEPARTMENT OF TRANSPORTATION

SECTION	COUNTY	TOTAL SHEETS	SHEET NO.
CHAMPAIGN IMP 2023-1	CHAMPAIGN	15	1
ILLINOIS		CONTRACT NO. 70F46	

INDEX OF SHEETS

- 1 COVER
- 2 GENERAL NOTES AND COMMITMENTS
- 3-5 SUMMARY OF QUANTITIES
- 6-8 TYPICAL SECTIONS AND MISCELLANEOUS DETAILS
- 9-10 SCHEDULE OF QUANTITIES
- 11 CONTROL POINTS AND BENCHMARKS
- 12 REMOVAL PLAN
- 13 SITE PLAN
- 14 GRADING PLAN
- 15 DISTRICT 5 DETAIL - DISABLED PARKING

HIGHWAY STANDARDS

- 000001-08 STANDARD SYMBOLS, ABBREVIATIONS AND PATTERNS
- 001006 DECIMAL OF AN INCH AND OF A FOOT
- 280001-07 TEMPORARY EROSION CONTROL SYSTEMS
- 806161-05 TYPE A GUTTER (INLET, OUTLET, & ENTRANCE)
- 606401-02 PAVED DITCH
- 701501-06 URBAN LANE CLOSURE 2L, 2W, UNDIVIDED
- 701801-08 TRAFFIC CONTROL DEVICES
- 720001-01 DISABLED PARKING
- 760001-05 TYPICAL PAVEMENT MARKINGS

**PROPOSED
HIGHWAY PLANS**

SECTION CHAMPAIGN IMP 2023-1
PATCHING PARKING IMPROVEMENT DRAINAGE
DIST 5 STORAGE FACILITY
CHAMPAIGN COUNTY
C-95-056-21
CHAMPAIGN COMPLEX

D-95-043-21

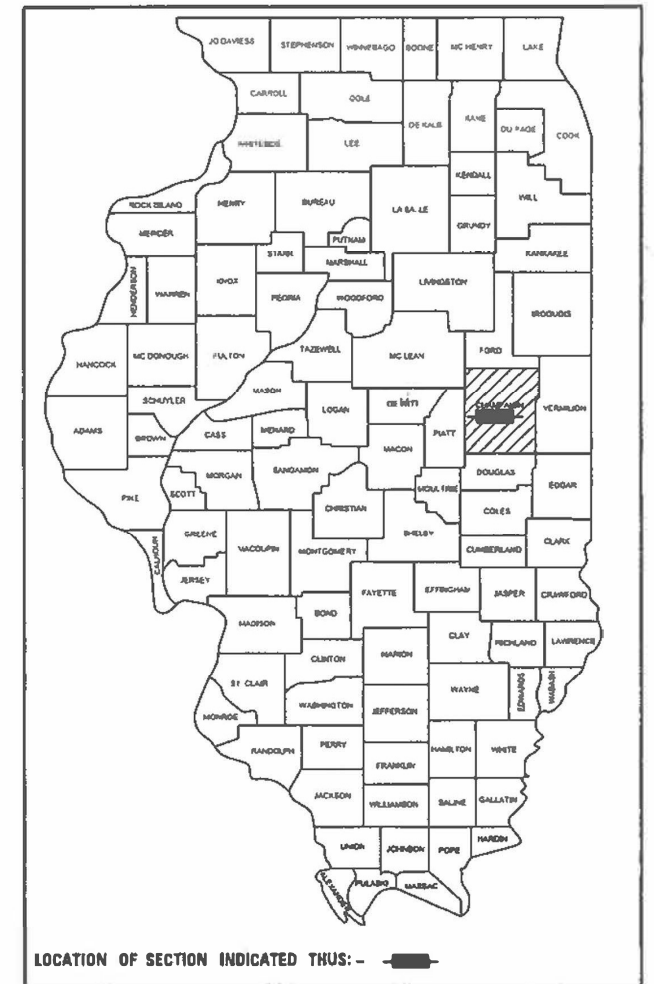

LOCATION OF SECTION INDICATED THUS: - [shaded box] -

PROJECT LOCATION
DISTRICT 5 CHAMPAIGN
STORAGE FACILITY
201 EISNER DRIVE
CHAMPAIGN, IL 61822

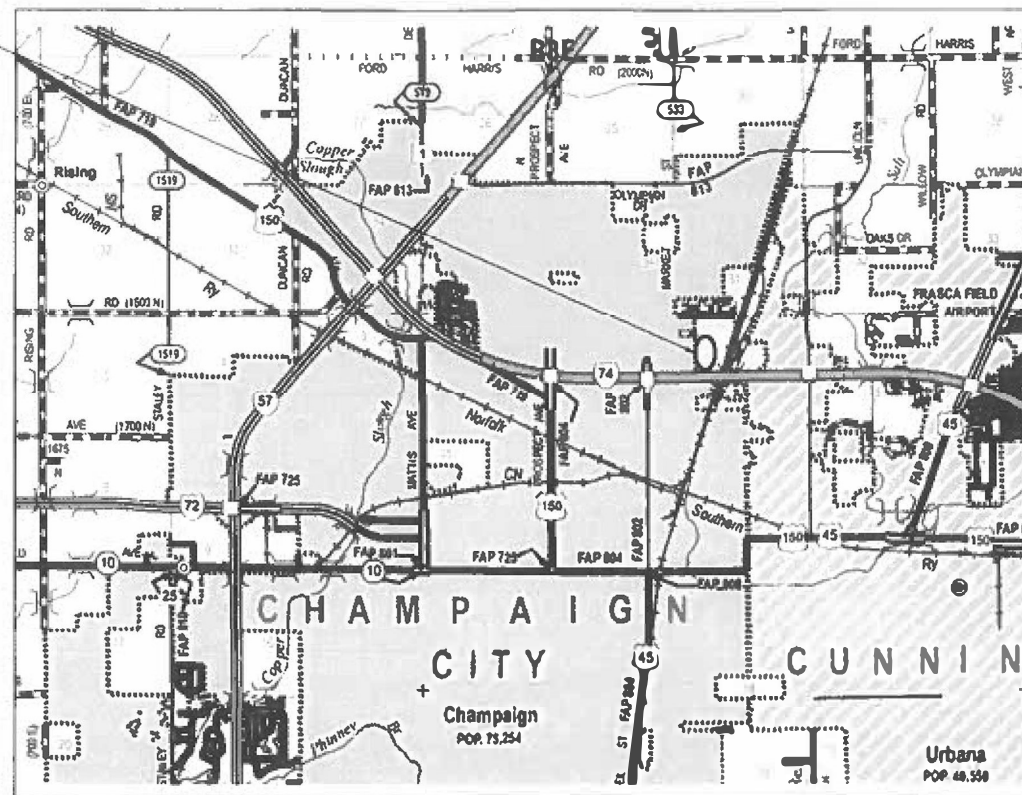

LOCATION MAP



FULL SIZE PLANS HAVE BEEN PREPARED USING STANDARD ENGINEERING SCALES. REDUCED SIZED PLANS WILL NOT CONFORM TO STANDARD SCALES. IN MAKING MEASUREMENTS ON REDUCED PLANS, THE ABOVE SCALES MAY BE USED.

J.U.L.I.E.
JOINT UTILITY LOCATION INFORMATION FOR EXCAVATION
1-800-892-0123
OR 811
CHAMPAIGN CITY TOWNSHIP

PROJECT ENGINEER: RYAN T. CARROLL, P.E.
SQUAD LEADER: CLARE B. DIETZ, P.E.
PHONE NUMBER: (217) 465-4181
CONTRACT NO. 70F46

MAURER-STUTZ
ENGINEERS SURVEYORS
3116 DRIES LN STE 100
PEORIA, ILLINOIS 61604
PH. (309) 693-7615
FAX (309) 693-7616
PROFESSIONAL DESIGN FIRM #184-005754

STATE OF ILLINOIS
DEPARTMENT OF TRANSPORTATION
SUBMITTED 1/31 20 23
Kensil A. Barnett REGIONAL ENGINEER
March 24, 2023
Steph M. Davis ENGINEER OF DESIGN AND ENVIRONMENT
March 24, 2023
DIRECTOR OF HIGHWAYS PROJECT IMPLEMENTATION



Baylor Wagnoff
BAYLOR M. WAGNOFF, P.E.
P.E. No. 062-073331
Exp. Date: 11/30/2023
01/27/2023

PRINTED BY THE AUTHORITY
OF THE STATE OF ILLINOIS

COUNTY:	CHAMPAIGN
FUNDING:	100% STATE
CONSTRUCTION CODE:	0005
	URBAN

CODE NO.	ITEM	UNIT	TOTAL QUANTITY	QUANTITY
20200100	EARTH EXCAVATION	CU YD	340	340
20800150	TRENCH BACKFILL	CU YD	10	10
28000510	INLET FILTERS	EACH	2	2
28100105	STONE RIPRAP, CLASS A3	SQ YD	123	123
28200200	FILTER FABRIC	SQ YD	123	123
31101200	SUBBASE GRANULAR MATERIAL, TYPE B 4"	SQ YD	519	519
35800100	PREPARATION OF BASE	SQ YD	3,235	3,235
40200800	AGGREGATE SURFACE COURSE, TYPE B	TON	191	191
40600275	BITUMINOUS MATERIALS (PRIME COAT)	POUND	7,277	7,277
40600290	BITUMINOUS MATERIALS (TACK COAT)	POUND	2,872	2,872
40600982	HOT-MIX ASPHALT SURFACE REMOVAL - BUTT JOINT	SQ YD	987	987
40603215	POLYMERIZED HOT-MIX ASPHALT BINDER COURSE, IL-9.5FG, N50	TON	363	363
40604150	POLYMERIZED HOT-MIX ASPHALT SURFACE COURSE, IL-9.5, MIX "C", N50	TON	896	896
42400300	PORTLAND CEMENT CONCRETE SIDEWALK 6 INCH	SQ FT	543	543

* SPECIALTY ITEMS

MODEL: D:\d\h\l
 FILE NAME: S:\37\2020\23720012.03 (193-025) NO. 7 Champaign Storage Facility\CADD\CADD_Sheets\0570F46-46-46-46-Summary.dgn



USER NAME = bmrwagehoft	DESIGNED -	REVISED -
PLOT SCALE = 0.167 "/>		

STATE OF ILLINOIS
DEPARTMENT OF TRANSPORTATION

DISTRICT 5 CHAMPAIGN STORAGE FACILITY IMPROVEMENTS
SUMMARY OF QUANTITIES

SCALE: N.T.S. SHEET 1 OF 3 SHEETS STA. TO STA.

SECTION	COUNTY	TOTAL SHEETS	SHEET NO.
CHAMPAIGN IMP 2023-1	CHAMPAIGN	15	3
		CONTRACT NO. 70F46	
		ILLINOIS FED. AID PROJECT	

COUNTY:	CHAMPAIGN
FUNDING:	100% STATE
CONSTRUCTION CODE:	0005
	URBAN

CODE NO.	ITEM	UNIT	TOTAL QUANTITY	QUANTITY
44000100	PAVEMENT REMOVAL	SQ YD	265	265
44004000	PAVED DITCH REMOVAL	FOOT	96	96
48102100	AGGREGATE WEDGE SHOULDER, TYPE B	TON	9	9
50105220	PIPE CULVERT REMOVAL	FOOT	127	127
56109210	WATER VALVES TO BE ADJUSTED	EACH	3	3
56400300	FIRE HYDRANTS TO BE ADJUSTED	EACH	1	1
60300305	FRAMES AND LIDS TO BE ADJUSTED	EACH	6	6
60500060	REMOVING INLETS	EACH	1	1
60602500	CONCRETE GUTTER, TYPE A	FOOT	51	51
* 66900200	NON-SPECIAL WASTE DISPOSAL	CU YD	122	122
* 66900530	SOIL DISPOSAL ANALYSIS	EACH	1	1
* 66901001	REGULATED SUBSTANCES PRE-CONSTRUCTION PLAN	L SUM	1	1
* 66901003	REGULATED SUBSTANCES FINAL CONSTRUCTION REPORT	L SUM	1	1
* 66901006	REGULATED SUBSTANCES MONITORING	CAL DA	2	2

* SPECIALTY ITEMS

MODEL: D:\d\h\l...
 FILE NAME: S:\37\2020\23720012.03 (193-025) NO. 7 Champaign Storage Facility\CADD\CADD_Sheets\0570F46-4hc-Summary.dgn



USER NAME = bmrwagehoft	DESIGNED -	REVISED -
PLOT SCALE = 0.167 "/>		

**STATE OF ILLINOIS
DEPARTMENT OF TRANSPORTATION**

**DISTRICT 5 CHAMPAIGN STORAGE FACILITY IMPROVEMENTS
SUMMARY OF QUANTITIES**

SCALE: N.T.S. SHEET 2 OF 3 SHEETS STA. TO STA.

SECTION	COUNTY	TOTAL SHEETS	SHEET NO.
CHAMPAIGN IMP 2023-1	CHAMPAIGN	15	4
CONTRACT NO. 70F46			
ILLINOIS FED. AID PROJECT			

COUNTY:	CHAMPAIGN
FUNDING:	100% STATE
CONSTRUCTION CODE:	0005
	URBAN

CODE NO.	ITEM	UNIT	TOTAL QUANTITY	QUANTITY
67100100	MOBILIZATION	L SUM	1	1
* 78001100	PAINT PAVEMENT MARKING - LETTERS AND SYMBOLS	SQ FT	7	7
* 78001110	PAINT PAVEMENT MARKING - LINE 4"	FOOT	712	712
X0350810	BOLLARD REMOVAL	EACH	5	5
X1200235	REMOVE EXISTING RIPRAP	CU YD	34	34
X6061460	PAVED DITCH (SPECIAL)	FOOT	514	514
X7010216	TRAFFIC CONTROL AND PROTECTION, (SPECIAL)	L SUM	1	1
X8140115	HANDHOLE TO BE ADJUSTED	EACH	1	1
XZ177600	REMOVE EXISTING BUMPER BLOCKS	EACH	22	22
Z0004002	BOLLARDS	EACH	4	4
Z0007800	BUMPER BLOCKS	EACH	23	23
Z0013798	CONSTRUCTION LAYOUT	L SUM	1	1

* SPECIALTY ITEMS

MODEL: D:\p\h\c\3\27\2020\2720012.03 (183-025 WO 7 Champaign Storage Facility)\CADD\CADD Sheets\0570646-sh-5summary.dgn
 FILE NAME: 3\27\2020\2720012.03 (183-025 WO 7 Champaign Storage Facility)\CADD\CADD Sheets\0570646-sh-5summary.dgn

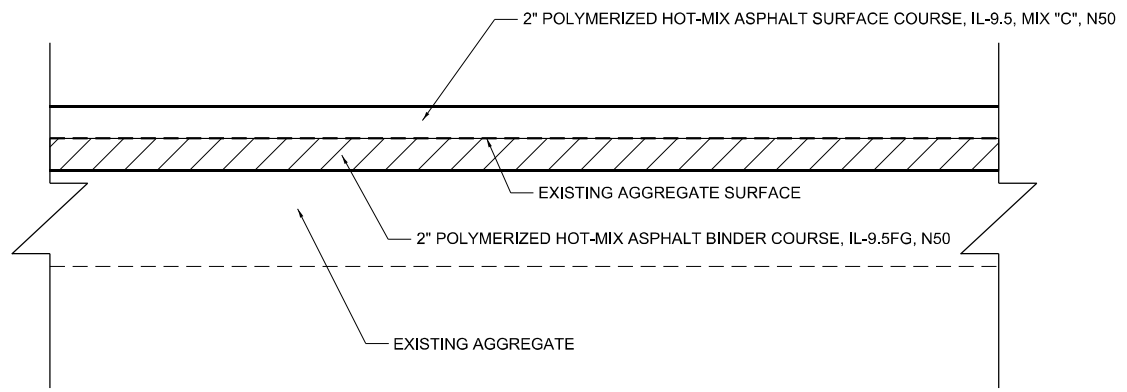

2" EARTH EXCAVATION (NOMINAL - GRADE FOR POSITIVE DRAINAGE)

PROPOSED TYPICAL SECTION
HOT-MIX ASPHALT OVER EXISTING AGGREGATE
NOT TO SCALE

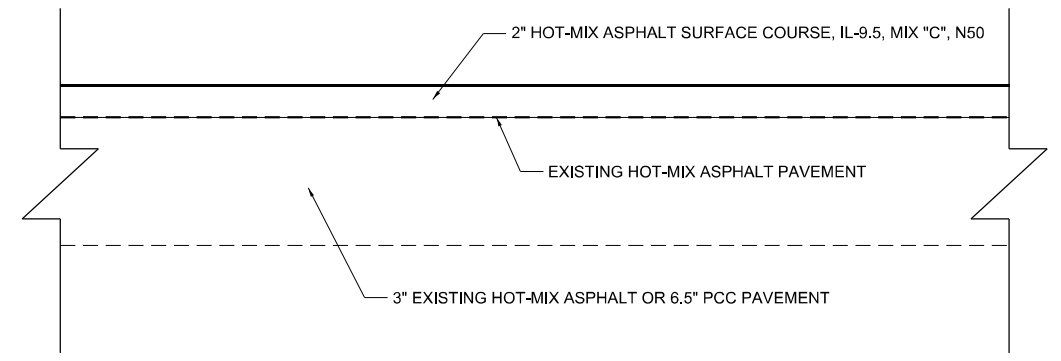

PROPOSED TYPICAL SECTION
HOT-MIX ASPHALT OVER EXISTING HOT-MIX ASPHALT OR PCC PAVEMENT
NOT TO SCALE

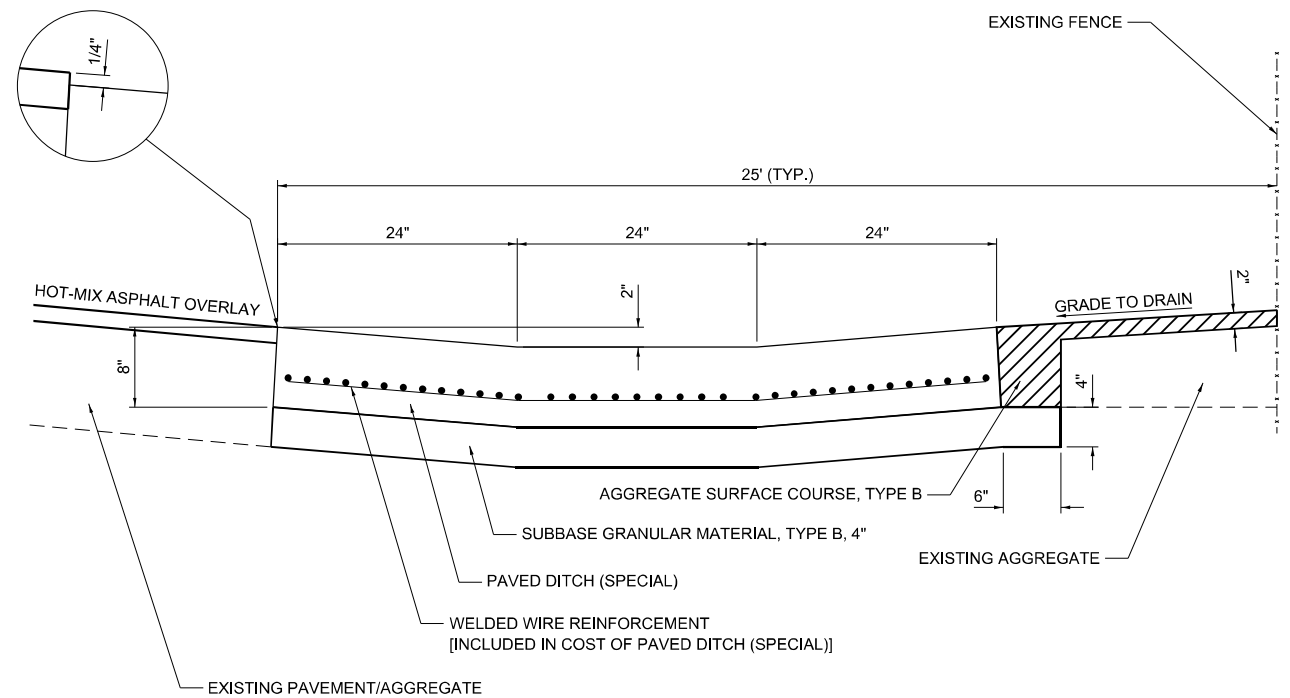

NORTH-SOUTH PAVED DITCH (SPECIAL) DETAIL
NOT TO SCALE

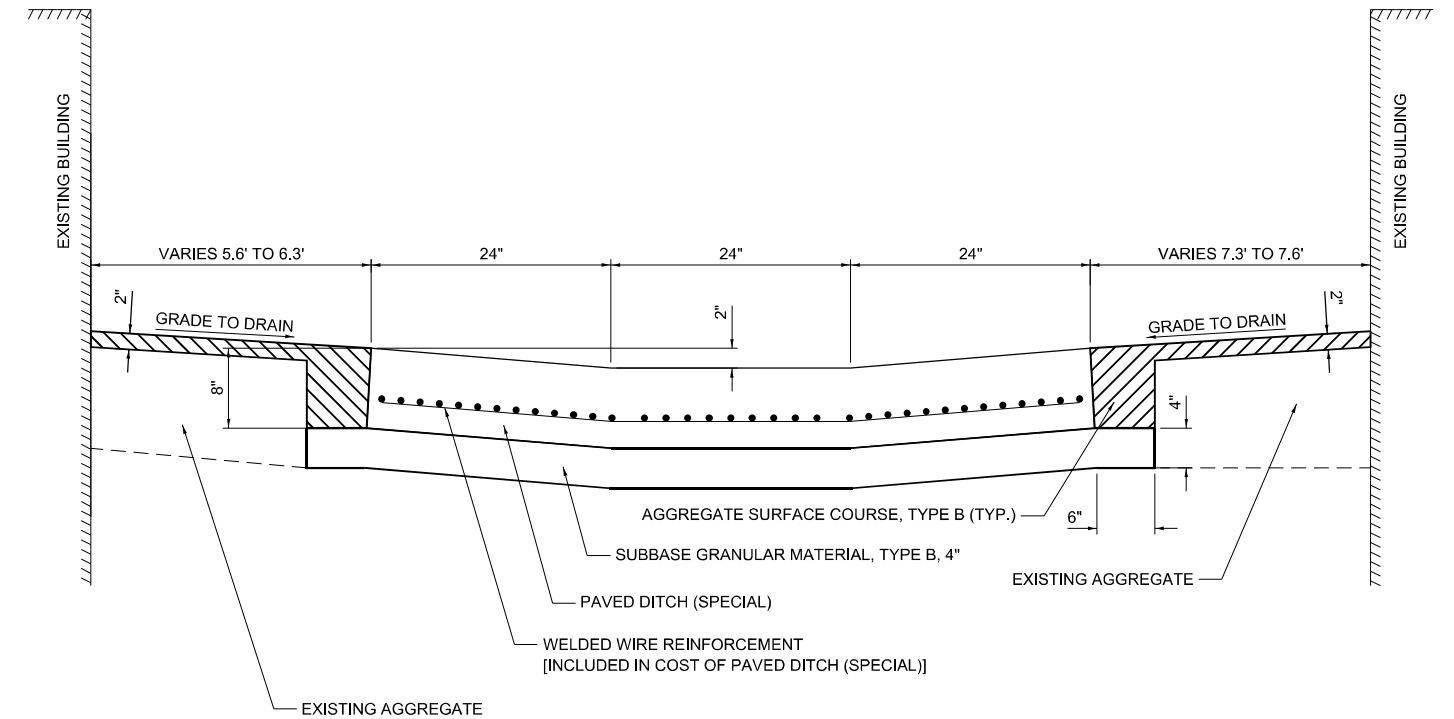

EAST-WEST PAVED DITCH (SPECIAL) DETAIL
NOT TO SCALE

MODEL: D:\default\... MAURER-STUTZ ENGINEERS SURVEYORS

MAURER-STUTZ ENGINEERS SURVEYORS	USER NAME = bmrwagehoft	DESIGNED -	REVISED -
	PLOT SCALE = 2,000' / in.	DRAWN -	REVISED -
	PLOT DATE = 1/27/2023	CHECKED -	REVISED -
		DATE -	REVISED -

STATE OF ILLINOIS
DEPARTMENT OF TRANSPORTATION

DISTRICT 5 CHAMPAIGN STORAGE FACILITY IMPROVEMENTS			
TYPICAL SECTIONS AND MISCELLANEOUS DETAILS			
SCALE:	SHEET 1	OF 3 SHEETS	STA. TO STA.

SECTION	COUNTY	TOTAL SHEETS	SHEET NO.
CHAMPAIGN IMP 2023-1	CHAMPAIGN	15	6
CONTRACT NO. 70F46			
ILLINOIS FED. AID PROJECT			

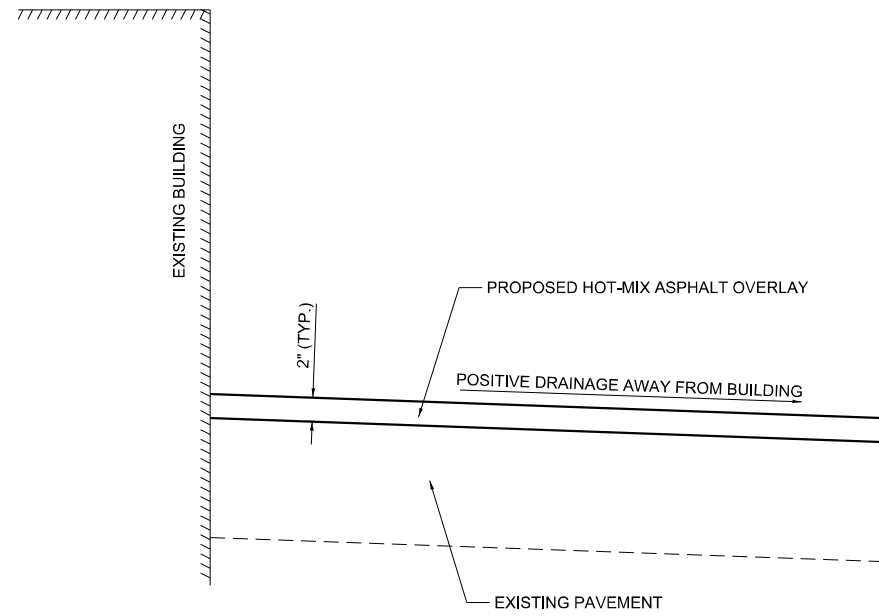

SECTION A-A

HOT-MIX ASPHALT OVERLAY ADJACENT TO EXISTING BUILDING
NOT TO SCALE

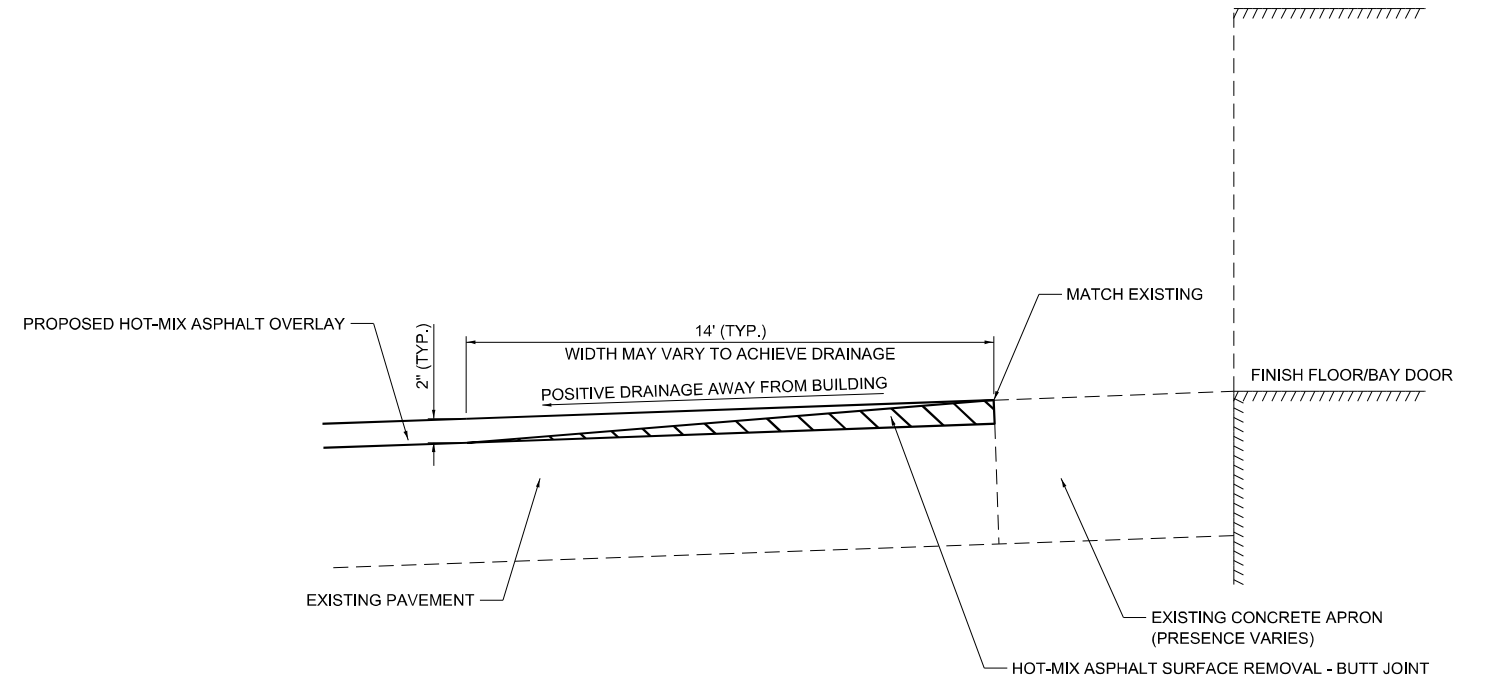

SECTION B-B

HOT-MIX ASPHALT OVERLAY WITH BUTT JOINT
AGAINST EXISTING FINISH FLOOR/BAY DOOR
NOT TO SCALE

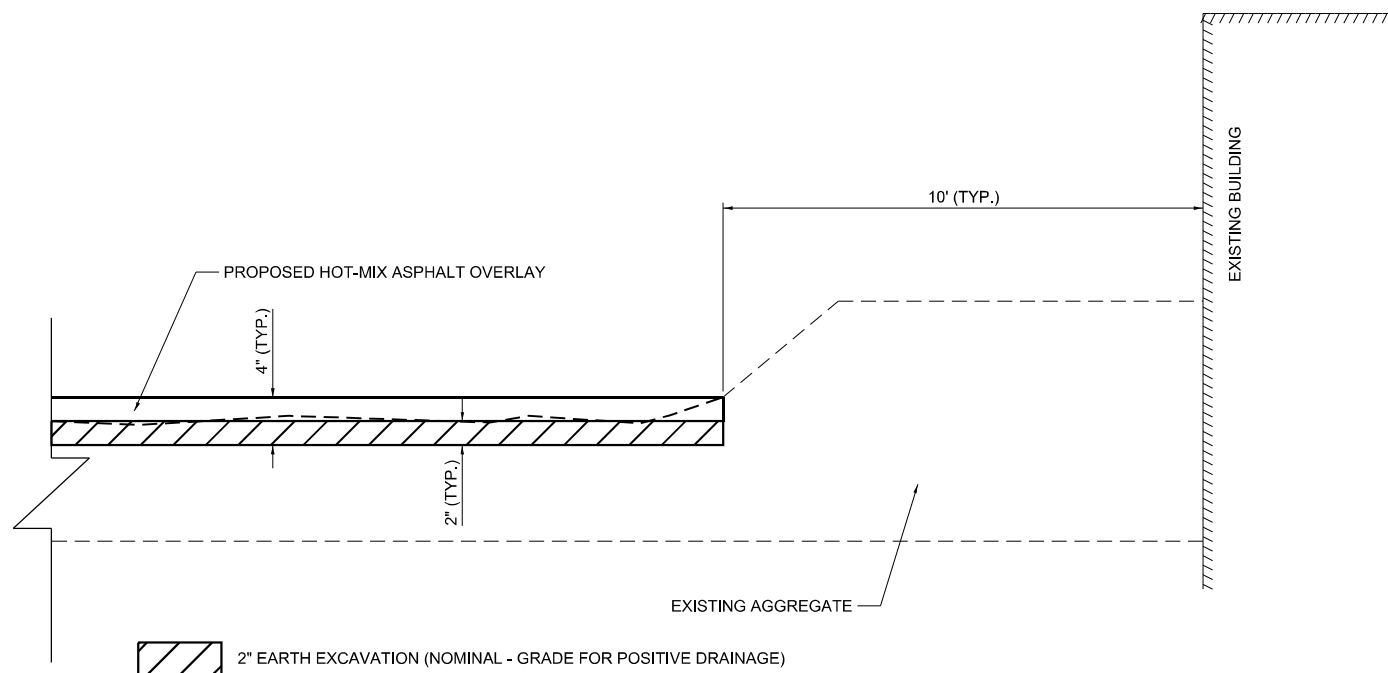

SECTION C-C

HOT-MIX ASPHALT OVER EXISTING AGGREGATE
NEAR EXISTING BUILDINGS
NOT TO SCALE

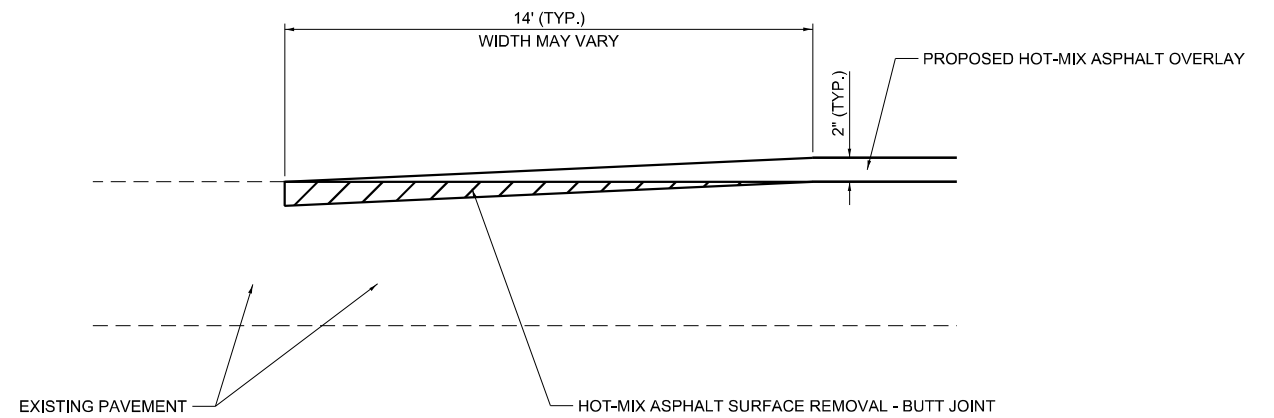

SECTION D-D

HOT-MIX ASPHALT OVERLAY ADJACENT TO EXISTING PAVEMENT
NOT TO SCALE

MODEL: D:\default
 FILE NAME: S:\37120202023720012.03 (193-025 WO 7 Champaign Storage Facility)\CADD\CADD_Sheets\0370F46-ht-Details-Misc.dgn



USER NAME = bmrwagehoft	DESIGNED -	REVISED -
	DRAWN -	REVISED -
PLOT SCALE = 2,000' = 1 in.	CHECKED -	REVISED -
PLOT DATE = 1/27/2023	DATE -	REVISED -

**STATE OF ILLINOIS
DEPARTMENT OF TRANSPORTATION**

**DISTRICT 5 CHAMPAIGN STORAGE FACILITY IMPROVEMENTS
TYPICAL SECTIONS AND MISCELLANEOUS DETAILS**

SCALE: SHEET 2 OF 3 SHEETS STA. TO STA.

SECTION	COUNTY	TOTAL SHEETS	SHEET NO.
CHAMPAIGN IMP 2023-1	CHAMPAIGN	15	7
		CONTRACT NO. 70F46	
ILLINOIS FED. AID PROJECT			

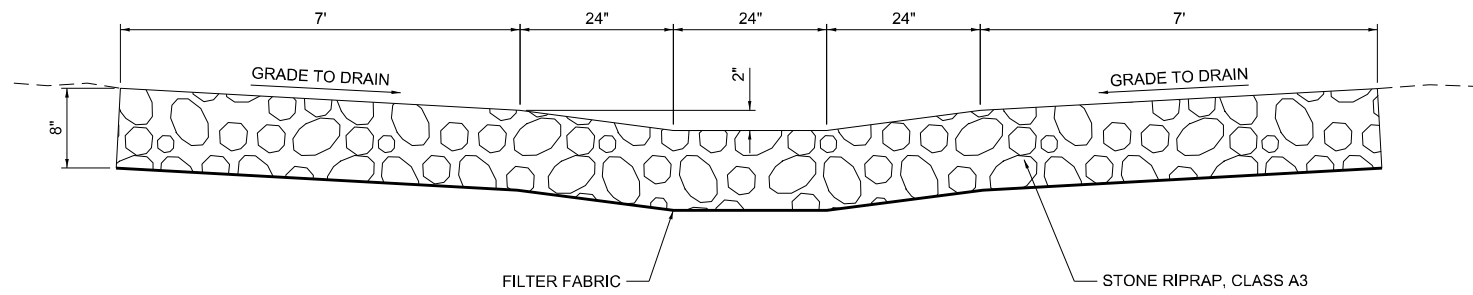

SECTION E-E
STONE RIPRAP, CLASS A3 AT SE CORNER OF YARD
NOT TO SCALE

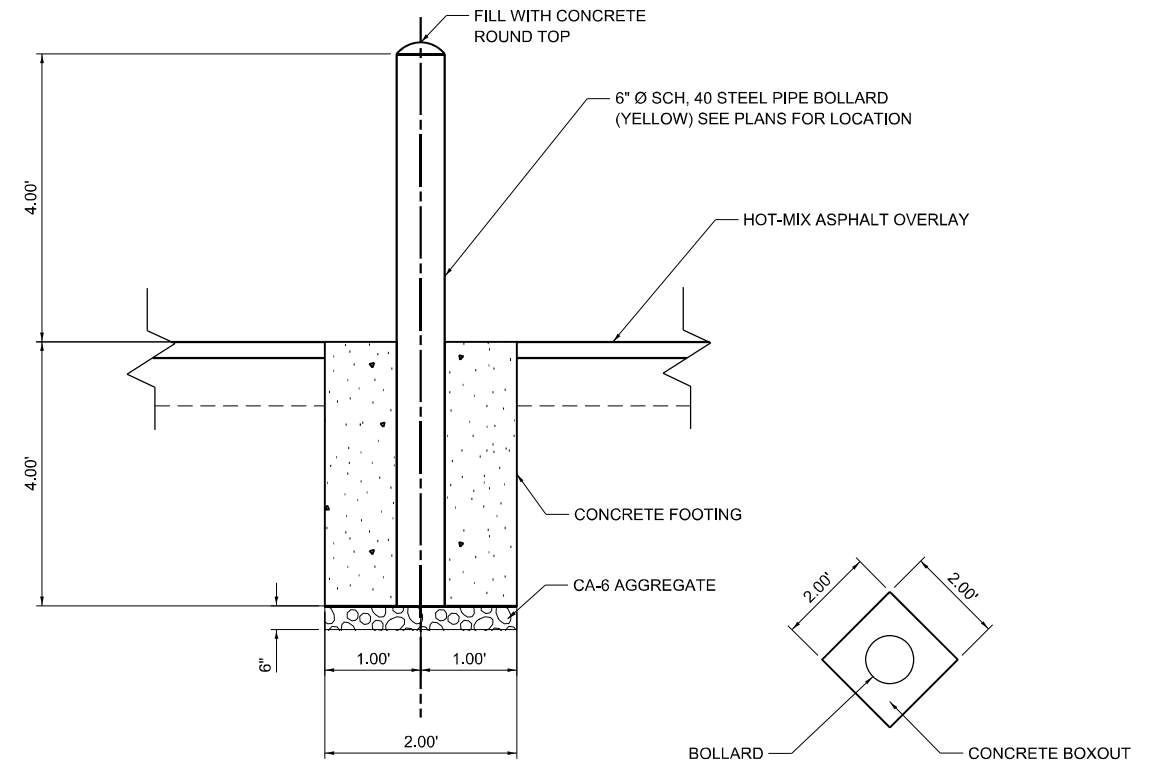

BOLLARD DETAIL
NOT TO SCALE

MODEL: D:\default
 FILE NAME: S:\3732020\23720012.03 (193-025 WO 7 Champaign Storage Facility)\CADD\CADD_Sheets\0570646-shc-Details-Misc.dgn



USER NAME = bmrwagehoft	DESIGNED -	REVISED -
	DRAWN -	REVISED -
PLOT SCALE = 2,000 * / in.	CHECKED -	REVISED -
PLOT DATE = 1/27/2023	DATE -	REVISED -

STATE OF ILLINOIS
DEPARTMENT OF TRANSPORTATION

DISTRICT 5 CHAMPAIGN STORAGE FACILITY IMPROVEMENTS
TYPICAL SECTIONS AND MISCELLANEOUS DETAILS

SCALE: SHEET 3 OF 3 SHEETS STA. TO STA.

SECTION	COUNTY	TOTAL SHEETS	SHEET NO.
CHAMPAIGN IMP 2023-1	CHAMPAIGN	15	8
CONTRACT NO. 70F46			
ILLINOIS FED. AID PROJECT			

20800150 TRENCH BACKFILL		
LOCATION	CU YD	REMARKS
WEST SIDE OF BLDG D0557	9.3	
SUBTOTAL		9.3
ROUNDED TOTAL		10.0

28000510 INLET FILTERS		
LOCATION	EACH	REMARKS
EX INLETS WEST OF TRUCK WASH	2.0	
SUBTOTAL		2.0
ROUNDED TOTAL		2.0

28100105 STONE RIPRAP, CLASS A3		
LOCATION	SQ YD	REMARKS
SOUTHEAST CORNER OF YARD	122.2	8 INCH THICK
SUBTOTAL		122.2
ROUNDED TOTAL		123.0

28200200 FILTER FABRIC		
LOCATION	SQ YD	REMARKS
SOUTHEAST CORNER OF YARD	122.2	
SUBTOTAL		122.2
ROUNDED TOTAL		123.0

31101200 SUBBASE GRANULAR MATERIAL, TYPE B 4"		
LOCATION	SQ YD	REMARKS
AT EAST PR PAVED DITCH (SPL)	333.7	
PAVED DITCH (SPL) SOUTH OF BLDG D0557	40.4	
NORTHEAST OF BLDG D0557	6.8	EX PAVED DITCH REMOVAL
BETWEEN TRUCK WASH AND BLDG 0557	138.1	EX PCC PAVT & DITCH REMOVAL
SUBTOTAL		519.0
ROUNDED TOTAL		519.0

35800100 PREPARATION OF BASE		
LOCATION	SQ YD	REMARKS
EX AGG SURFACE AREA	3234.1	
SUBTOTAL		3234.1
ROUNDED TOTAL		3235.0

40200800 AGGREGATE SURFACE COURSE, TYPE B		
LOCATION	TON	REMARKS
AT EAST PR PAVED DITCH (SPL)	11.7	8 INCH THICK
EAST OF PR PAVED DITCH (SPL) UP TO FENCE	159.5	2 INCH THICK
AT PAVED DITCH (SPL) SOUTH OF BLDG D0557	2.6	8 INCH THICK
AREA SOUTH OF BLDG D0557	6.9	2 INCH THICK
AREA NORTH OF BLDG D0557	6.6	2 INCH THICK
AT TRUCK WASH TRANSFORMER PAD	3.3	2 INCH THICK
SUBTOTAL		190.7
ROUNDED TOTAL		191.0

40600275 BITUMINOUS MATERIALS (PRIME COAT)		
LOCATION	POUND	REMARKS
EX AGGREGATE SURFACE AREA	7276.8	
SUBTOTAL		7276.8
ROUNDED TOTAL		7277.0

40600290 BITUMINOUS MATERIALS (TACK COAT)		
LOCATION	POUND	REMARKS
EX AGG SURFACE AREA	727.7	OVER BINDER CSE
EX HMA SURFACE AREA	2143.6	
SUBTOTAL		2871.3
ROUNDED TOTAL		2872.0

40600982 HOT-MIX ASPHALT SURFACE REMOVAL - BUTT JOINT		
LOCATION	SQ YD	REMARKS
NORTHWEST OF TRUCK WASH	216.7	
WEST OF BUILDING D0506	210.1	
SOUTH OF BUILDING D0505	469.6	
YARD ENTRANCE	90.7	
SUBTOTAL		987.0
ROUNDED TOTAL		987.0

40603215 POLYMERIZED HOT-MIX ASPHALT BINDER COURSE, IL-9.5FG, N50		
LOCATION	TON	REMARKS
EX AGG SURFACE AREA	362.2	
SUBTOTAL		362.2
ROUNDED TOTAL		363.0

40604150 POLYMERIZED HOT-MIX ASPHALT SURFACE COURSE, IL-9.5, MIX "C", N50		
LOCATION	TON	REMARKS
ENTIRE PROJECT	895.8	
SUBTOTAL		895.8
ROUNDED TOTAL		896.0

42400300 PORTLAND CEMENT CONCRETE SIDEWALK 6 INCH		
LOCATION	SQ FT	REMARKS
WEST ENTRANCE OF D0505	97.5	
EAST ENTRANCE OF D0505	51.3	
WEST OF BUILDING D0557	393.7	
SUBTOTAL		542.5
ROUNDED TOTAL		543.0

44000100 PAVEMENT REMOVAL		
LOCATION	SQ YD	REMARKS
EAST OF BLDG D0506 / SOUTH OF BRINE STORAGE	101.0	EX 3 INCH HMA
WEST OF BLDG D0557	147.4	EX 6.25 INCH PCC
WEST ENTRANCE OF BLDG D0505	15.7	EX 6 INCH PCC
SUBTOTAL		264.1
ROUNDED TOTAL		265.0

44004000 PAVED DITCH REMOVAL		
LOCATION	FOOT	REMARKS
NORTH OF BLDG D0557	95.3	
SUBTOTAL		95.3
ROUNDED TOTAL		96.0

48102100 AGGREGATE WEDGE SHOULDER, TYPE B		
LOCATION	TON	REMARKS
EX AGG SURFACE AREA	8.4	OUTSIDE EDGE OF PR HMA
SUBTOTAL		8.4
ROUNDED TOTAL		9.0

50105220 PIPE CULVERT REMOVAL		
LOCATION	FOOT	REMARKS
WEST OF BLDG D0557	127.0	
SUBTOTAL		127.0
ROUNDED TOTAL		127.0

56109210 WATER VALVES TO BE ADJUSTED		
LOCATION	EACH	REMARKS
NEXT TO FIRE HYDRANT	1.0	
NEAR WEST ENTRANCE TO BLDG D0505	1.0	
SOUTH OF EAST ENTRANCE TO BLDG D0505	1.0	
SUBTOTAL		3.0
ROUNDED TOTAL		3.0

56400300 FIRE HYDRANTS TO BE ADJUSTED		
LOCATION	EACH	REMARKS
EX HYDRANT NORTH OF HANDICAP PARKING	1.0	
SUBTOTAL		1.0
ROUNDED TOTAL		1.0

60300305 FRAMES AND LIDS TO BE ADJUSTED		
LOCATION	EACH	REMARKS
EX MANHOLES IN STRIPED PARKING AREA	2.0	STORM
NORTH OF TRUCK WASH BLDG	1.0	SANITARY
SOUTHWEST OF BLDG D0506	1.0	STORM
SOUTHEAST OF BLDG D0506	1.0	SANITARY
NORTHWEST OF BLDG D0506	1.0	STORM
SUBTOTAL		6.0
ROUNDED TOTAL		6.0

60500060 REMOVING INLETS		
LOCATION	EACH	REMARKS
SOUTHWEST OF BUILDING D0557	1.0	BURIED
SUBTOTAL		1.0
ROUNDED TOTAL		1.0

60602500 CONCRETE GUTTER, TYPE A		
LOCATION	FOOT	REMARKS
NORTH OF BLDG D0557	50.4	
SUBTOTAL		50.4
ROUNDED TOTAL		51.0

78001100 PAINT PAVEMENT MARKING - LETTERS AND SYMBOLS		
LOCATION	SQ FT	REMARKS
ACCESSIBLE PARKING STALLS	6.2	WHITE
SUBTOTAL		6.2
ROUNDED TOTAL		7.0

78001110 PAINT PAVEMENT MARKING - LINE 4"		
LOCATION	FOOT	REMARKS
EMPLOYEE PARKING STALLS	440.0	WHITE
ACCESSIBLE AISLES	272.0	WHITE
SUBTOTAL		712.0
ROUNDED TOTAL		712.0

X0350810 BOLLARD REMOVAL		
LOCATION	EACH	REMARKS
NORTH OF BUILDING D0506	4.0	
SOUTH OF BUILDING D0557	1.0	
SUBTOTAL		5.0
ROUNDED TOTAL		5.0

X1200235 REMOVE EXISTING RIPRAP		
LOCATION	CU YD	REMARKS
SOUTHEAST CORNER OF YARD	33.3	3 FEET THICK
SUBTOTAL		33.3
ROUNDED TOTAL		34.0

X6061460 PAVED DITCH (SPECIAL)		
LOCATION	FOOT	REMARKS
EAST SIDE OF PROJECT	462.1	
SOUTH OF BLDG D0557	52.0	
SUBTOTAL		514.0
ROUNDED TOTAL		514.0

MODEL: D:\default...
 FILE NAME: S:\317\2020\23170012.03 (18)3-025.W07-Champaign Storage Facility\ICADD\CADD_Sheets\0570646-ht-Sched.qdw



USER NAME = bmrwagehoft	DESIGNED -	REVISED -
PLOT SCALE = 0.167" / 1.	DRAWN -	REVISED -
PLOT DATE = 1/27/2023	CHECKED -	REVISED -
	DATE -	REVISED -

**STATE OF ILLINOIS
DEPARTMENT OF TRANSPORTATION**

**DISTRICT 5 CHAMPAIGN STORAGE FACILITY IMPROVEMENTS
SCHEDULE OF QUANTITIES**

SCALE: SHEET 1 OF 2 SHEETS STA. TO STA.

SECTION	COUNTY	TOTAL SHEETS	SHEET NO.
CHAMPAIGN IMP 2023-1	CHAMPAIGN	15	9
		CONTRACT NO. 70F46	
ILLINOIS	FED. AID PROJECT		

X8140115 HANDHOLE TO BE ADJUSTED		
LOCATION	EACH	REMARKS
WEST OF BLDG D0505 & ENTRANCE TO YARD	1.0	
SUBTOTAL		1.0
ROUNDED TOTAL		1.0

XZ177600 REMOVE EXISTING BUMPER BLOCKS		
LOCATION	EACH	REMARKS
EX EMPLOYEE PARKING	22.0	
SUBTOTAL		22.0
ROUNDED TOTAL		22.0

Z0004002 BOLLARDS		
LOCATION	EACH	REMARKS
NORTH OF BLDG D0506	4.0	
SUBTOTAL		4.0
ROUNDED TOTAL		4.0

Z0007800 BUMPER BLOCKS		
LOCATION	EACH	REMARKS
EMPLOYEE PARKING	23.0	
SUBTOTAL		23.0
ROUNDED TOTAL		23.0

LOCATION	EARTH EXCAVATION CU YD	EXCAVATION ADJUSTED FOR SHRINKAGE (25%) CU YD	EMBANKMENT (FILL) CU YD	EARTHWORK BALANCE WASTE (+) OR SHORTAGE (-) CU YD
PAVED DITCH (SPECIAL) AT EAST SIDE	121.12	90.84	0.00	90.84
PAVED DITCH (SPECIAL) SOUTH OF BLDG D0557	14.79	11.09	0.00	11.09
2 INCH EARTH EX FOR HMA	183.27	137.45	0.00	137.45
EX RIPRAP REMOVAL AREA	0.00	0.00	25.89	-25.89
PR RIPRAP AREA	19.85	14.89	0.00	14.89
TOTAL	339.03	254.28	25.89	228.39

EARTHWORK SUMMARY			
20200100	EARTH EXCAVATION	340	CU YD

MODEL: D:\p\h\...
 FILE NAME: S:\37\2020\23720012.03 (193-025 WO 7 Champaign Storage Facility)\CADD\Sheet\0570F46-1h-Schedule.dgn



USER NAME = bmrwagehoft	DESIGNED -	REVISED -
PLOT SCALE = 0.167' / in.	DRAWN -	REVISED -
PLOT DATE = 1/27/2023	CHECKED -	REVISED -
	DATE -	REVISED -

**STATE OF ILLINOIS
DEPARTMENT OF TRANSPORTATION**

**DISTRICT 5 CHAMPAIGN STORAGE FACILITY IMPROVEMENTS
SCHEDULE OF QUANTITIES**

SCALE: SHEET 2 OF 2 SHEETS STA. TO STA.

SECTION	COUNTY	TOTAL SHEETS	SHEET NO.
CHAMPAIGN IMP 2023-1	CHAMPAIGN	15	10
CONTRACT NO. 70F46			
ILLINOIS FED. AID PROJECT			

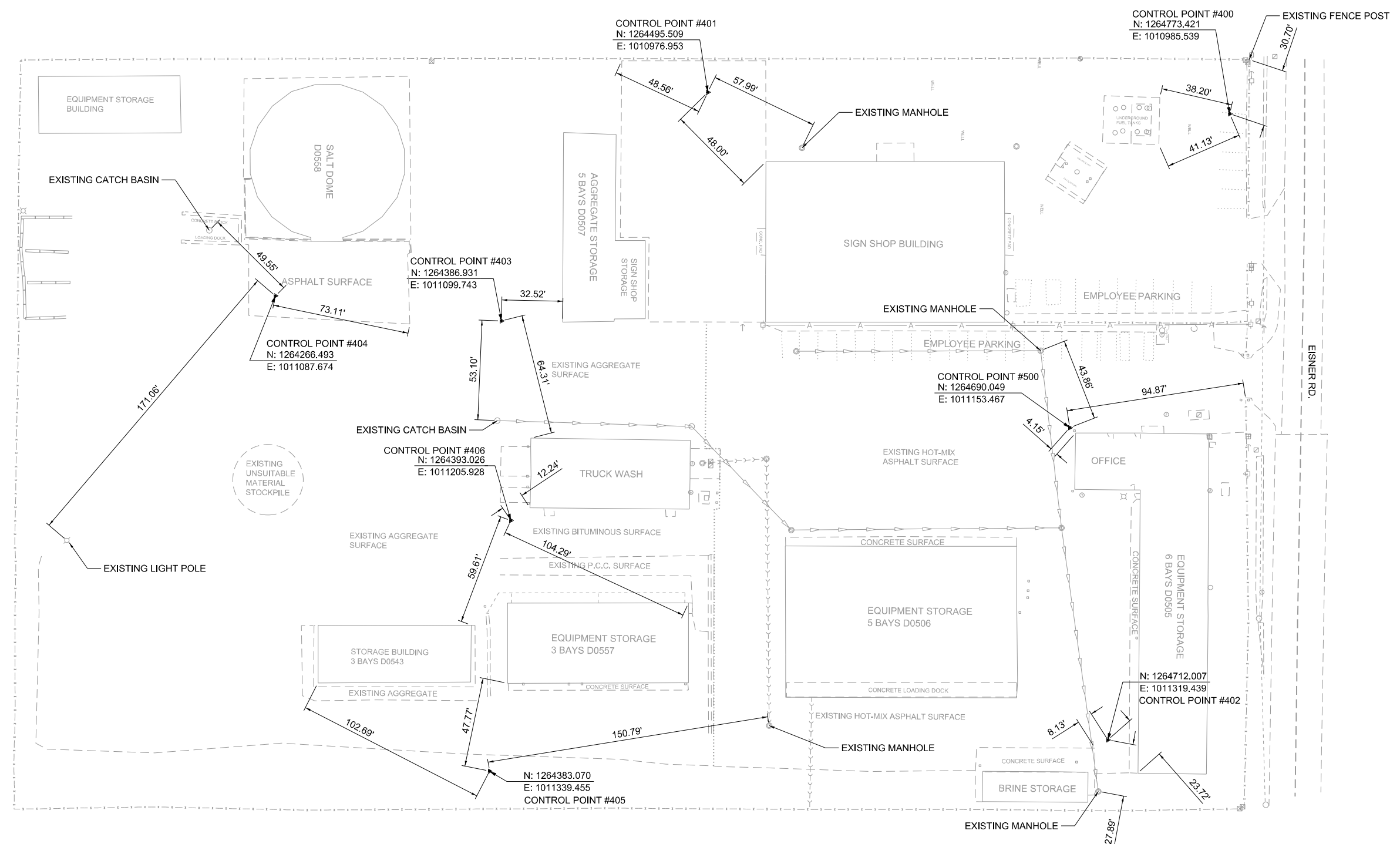
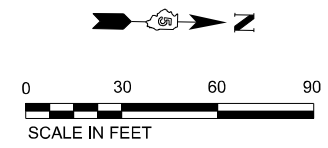

MODEL: D:\default\...
 FILE NAME: S:\371202023720012.03 (193-025) NO 7 Champaign Storage Facility\CADD\CADD_Sheets\0570F46-sh-ATE.dgn





USER NAME = cadiaz	DESIGNED -	REVISED -
PLOT SCALE = 60,000' / in.	DRAWN -	REVISED -
PLOT DATE = 1/30/2023	CHECKED -	REVISED -
	DATE -	REVISED -

STATE OF ILLINOIS
DEPARTMENT OF TRANSPORTATION

DISTRICT 5 CHAMPAIGN STORAGE FACILITY IMPROVEMENTS
CONTROL POINTS AND BENCHMARKS
 SCALE: 1" = 30' SHEET OF SHEETS STA. TO STA.

SECTION	COUNTY	TOTAL SHEETS	SHEET NO.
CHAMPAIGN IMP 2023-1	CHAMPAIGN	15	11
CONTRACT NO. 70F46			
ILLINOIS FED. AID PROJECT			

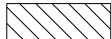
LEGEND

-  VARIABLE DEPTH EARTH EXCAVATION
-  HOT-MIX ASPHALT SURFACE REMOVAL - BUTT JOINT
-  PAVEMENT REMOVAL

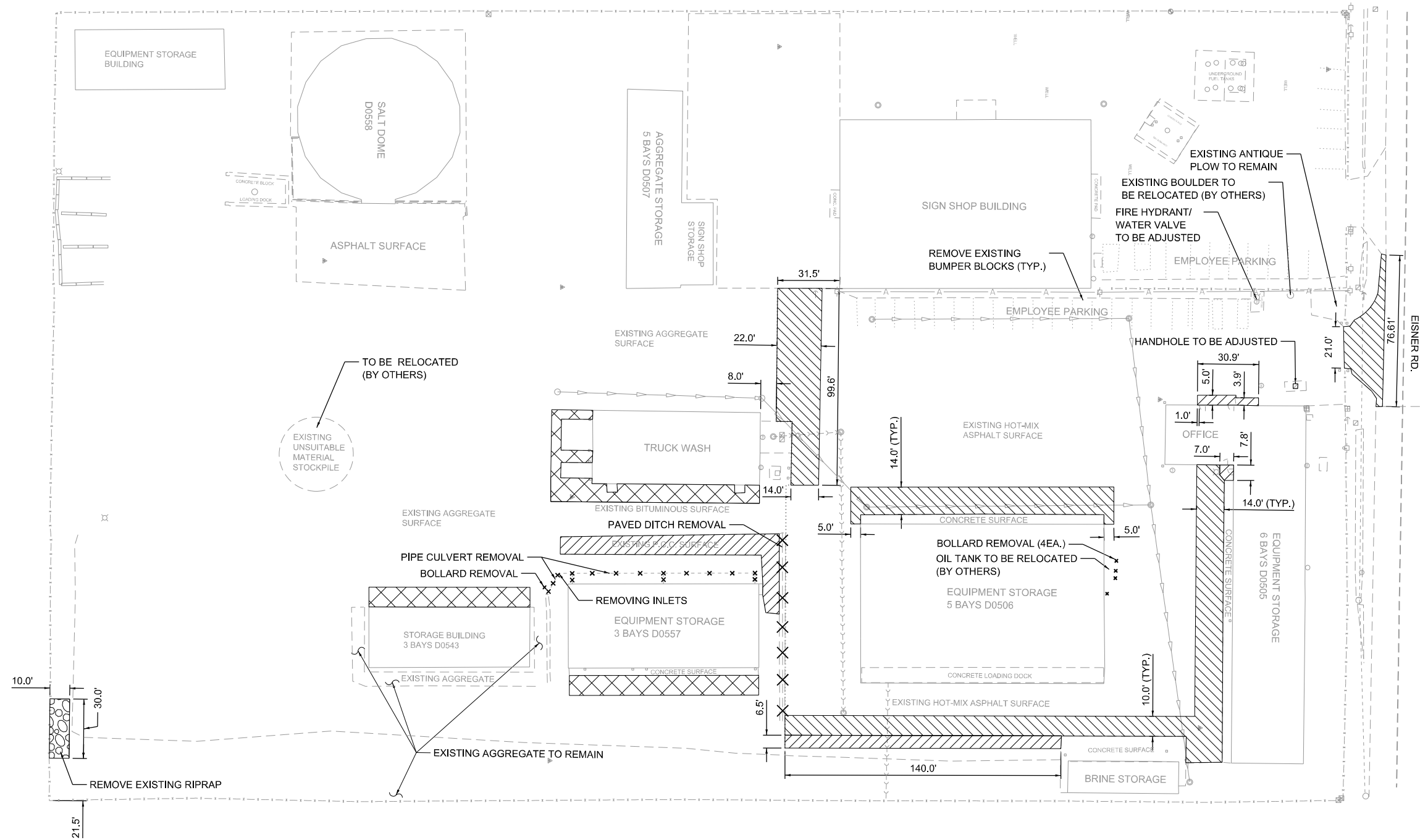
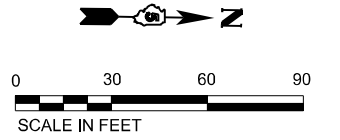

MODEL: D:\default\...
 FILE NAME: S:\371202023720012.03 (193-025 WO 7 Champaign Storage Facility)\CADD\CADD_Sheets\0570F46-ht-Removal.dgn



USER NAME = cadiaz	DESIGNED -	REVISED -
PLOT SCALE = 60,000' / in.	DRAWN -	REVISED -
PLOT DATE = 1/30/2023	CHECKED -	REVISED -
	DATE -	REVISED -

**STATE OF ILLINOIS
DEPARTMENT OF TRANSPORTATION**

**DISTRICT 5 CHAMPAIGN STORAGE FACILITY IMPROVEMENTS
REMOVAL PLAN**

SCALE: 1" = 30' SHEET OF SHEETS STA. TO STA.

SECTION	COUNTY	TOTAL SHEETS	SHEET NO.
CHAMPAIGN IMP 2023-1	CHAMPAIGN	15	12
CONTRACT NO. 70F46			
ILLINOIS FED. AID PROJECT			

LEGEND

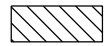

EXISTING AGGREGATE SURFACE TO BE PAVED
2" POLYMERIZED HOT-MIX ASPHALT SURFACE COURSE, IL-9.5, MIX "C", N50 &
2" POLYMERIZED HOT-MIX ASPHALT BINDER COURSE, IL-9.5FG, N50

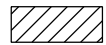

EXISTING HOT-MIX ASPHALT SURFACE TO BE OVERLAYED
2" POLYMERIZED HOT-MIX ASPHALT SURFACE COURSE, IL-9.5, MIX "C", N50

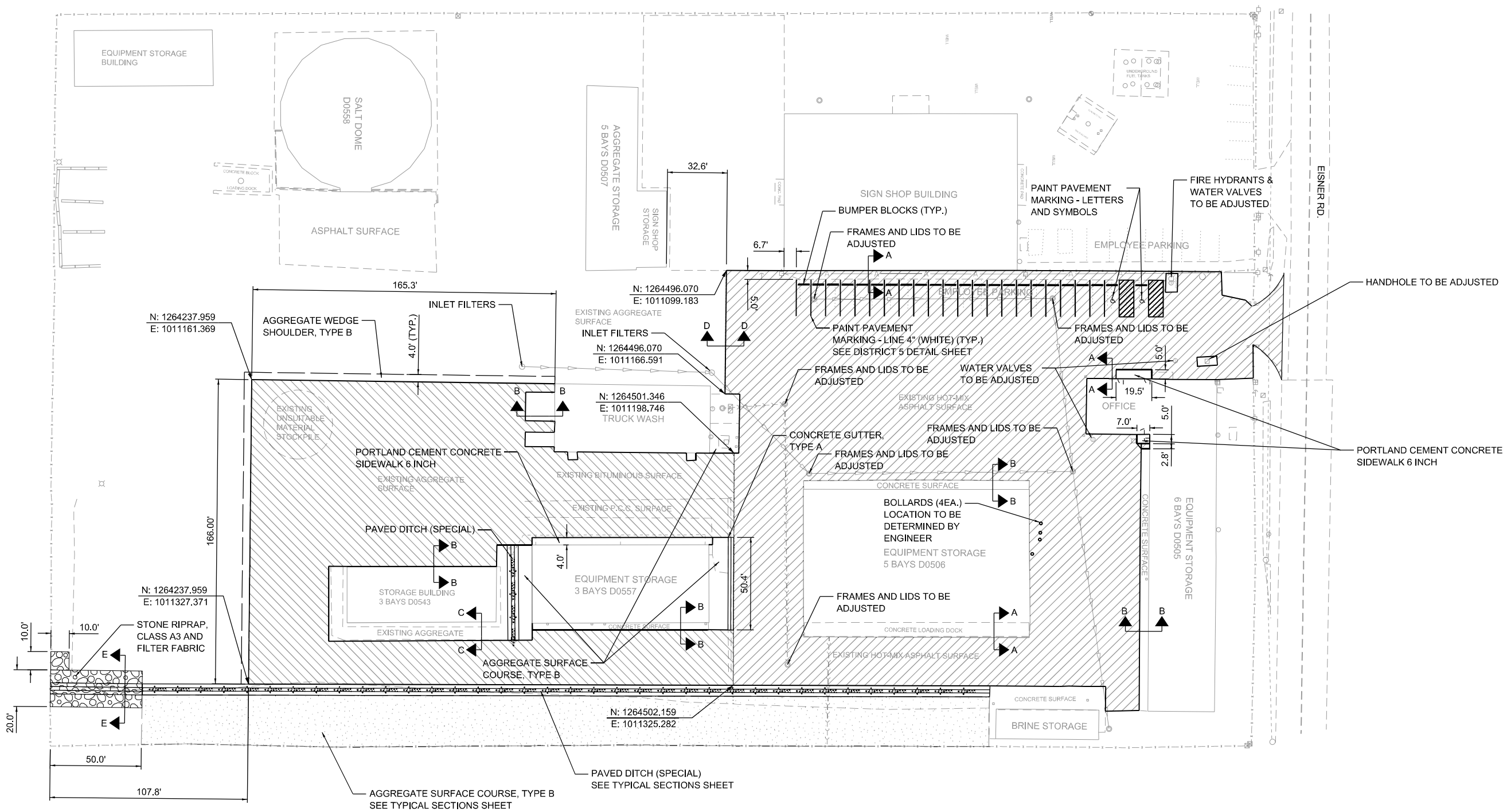

MODEL: D:\default...
 FILE NAME: S:\337\2020\23720012.03 (193-025) NO 7 Champaign Storage Facility\ICADD\ICADD_Sheets\0570F46-4h-5h-5h-Plan.dgn
 MAURER-STUTZ ENGINEERS SURVEYORS

USER NAME = cadiaz	DESIGNED -	REVISED -
PLOT SCALE = 60,000' / in.	DRAWN -	REVISED -
PLOT DATE = 1/30/2023	CHECKED -	REVISED -
	DATE -	REVISED -

STATE OF ILLINOIS
DEPARTMENT OF TRANSPORTATION

DISTRICT 5 CHAMPAIGN STORAGE FACILITY IMPROVEMENTS
SITE PLAN

SECTION	COUNTY	TOTAL SHEETS	SHEET NO.
CHAMPAIGN IMP 2023-1	CHAMPAIGN	15	13
		CONTRACT NO. 70F46	
ILLINOIS		FED. AID PROJECT	

SCALE: 1" = 30' SHEET OF SHEETS STA. TO STA.

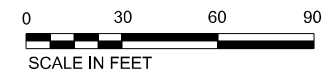

NOTE: ALL CONTOURS SHOWN ON THIS SHEET ARE EXISTING.

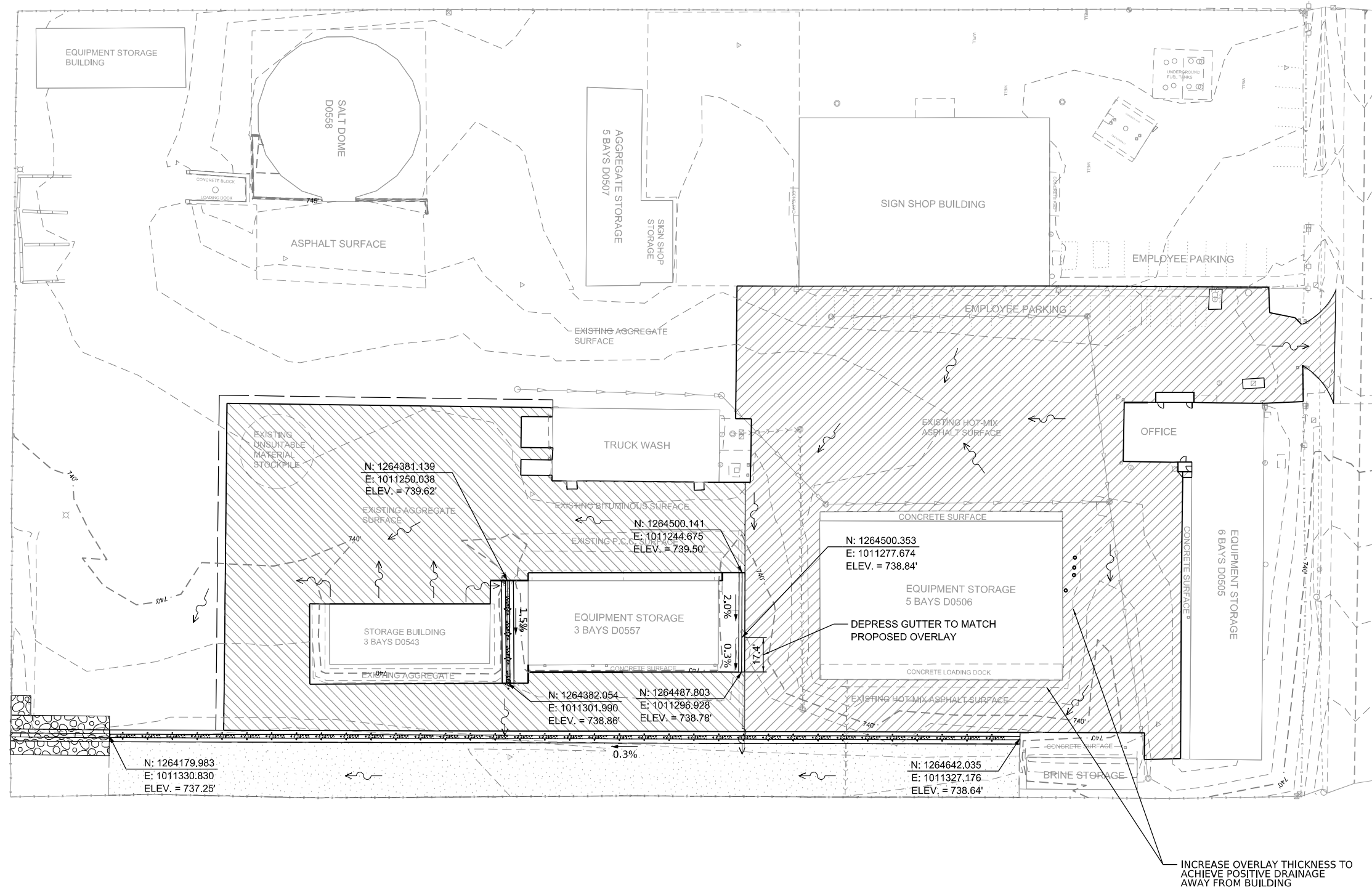

MODEL: D:\default... MAURER-STUTZ ENGINEERS SURVEYORS



USER NAME = cadiaz	DESIGNED -	REVISED -
PLOT SCALE = 60,000' / in.	DRAWN -	REVISED -
PLOT DATE = 1/30/2023	CHECKED -	REVISED -
	DATE -	REVISED -

**STATE OF ILLINOIS
DEPARTMENT OF TRANSPORTATION**

**DISTRICT 5 CHAMPAIGN STORAGE FACILITY IMPROVEMENTS
GRADING PLAN**

SECTION	COUNTY	TOTAL SHEETS	SHEET NO.
CHAMPAIGN IMP 2023-1	CHAMPAIGN	15	14
CONTRACT NO. 70F46			
ILLINOIS FED. AID PROJECT			

SCALE: 1" = 30' SHEET OF SHEETS STA. TO STA.

SIGN R7-I 101

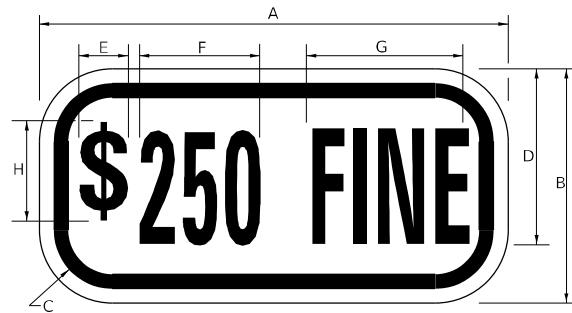

COLOR: LEGEND AND BORDER GREEN NON-REFLECTORIZED BACKGROUND WHITE REFLECTORIZED

SIGN SIZE	DIMENSIONS							
	A	B	C	D	E	F	G	H
6 x 12 (152.4 x 304.8)	12 (304.8)	6 (152.4)	1.5 (38.1)	4.5 (114.3)	1.15 (29.2)	3.4 (86.4)	4.6 (116.8)	4.0 (101.6)

SIGN SIZE	SERIES Lines	Margin	Border	BLK Std
6 x 12 (152.4 x 304.8)	1/3A	0.37 (9.5)	0.37 (9.5)	B5-126

To be used with R7-8
* \$ = SERIES 3A "S"

SIGN R7-8

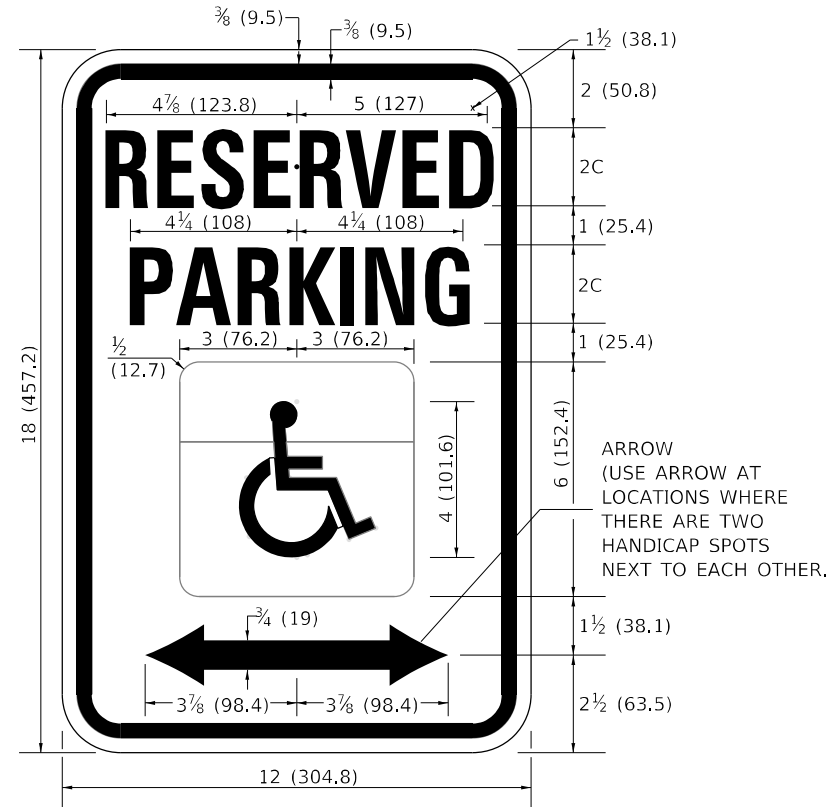

COLORS
LEGEND AND BORDER - GREEN
WHITE SYMBOL ON BLUE BACKGROUND
BACKGROUND - WHITE

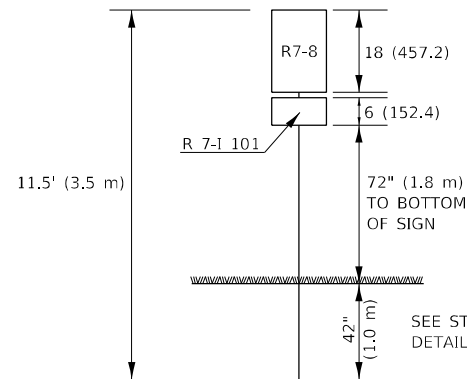

ESTIMATED QUANTITY

72900110 METAL POST - TYPE A = 11.5' (3.5 m)	
72000100 SIGN PANEL R 7-I 101	0.5 SQ.FT. (.046 m ²)
72000100 SIGN PANEL R 7-8	1.5 SQ.FT. (.139 m ²)
TOTAL =	2.0 SQ.FT. (.185 m²)

SEE STD. 720011 & 729001 FOR DETAILS OF METAL POST, TYPE A

SIGN POST DETAILS

DESIGNER NOTE: SEE BDE 58-1.04(A)

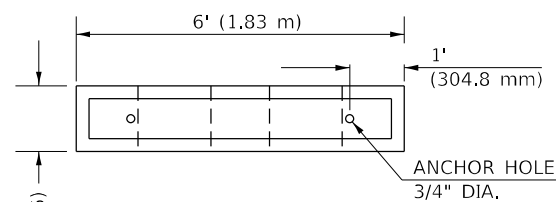

PLAN VIEW

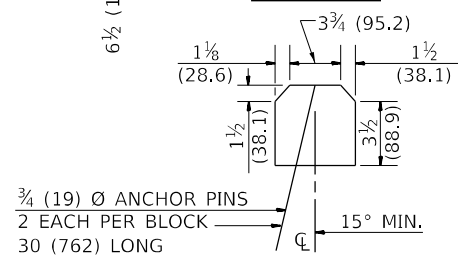

END VIEW

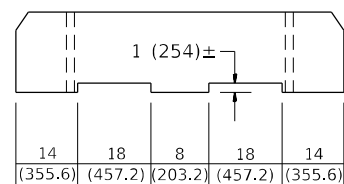

ELEVATION VIEW

NOTE: NOMINAL DIMENSIONS OF BLOCKS MAY VARY
CLASS P.C. CONCRETE SHALL BE USED THROUGHOUT.

BUMPER BLOCK DETAIL

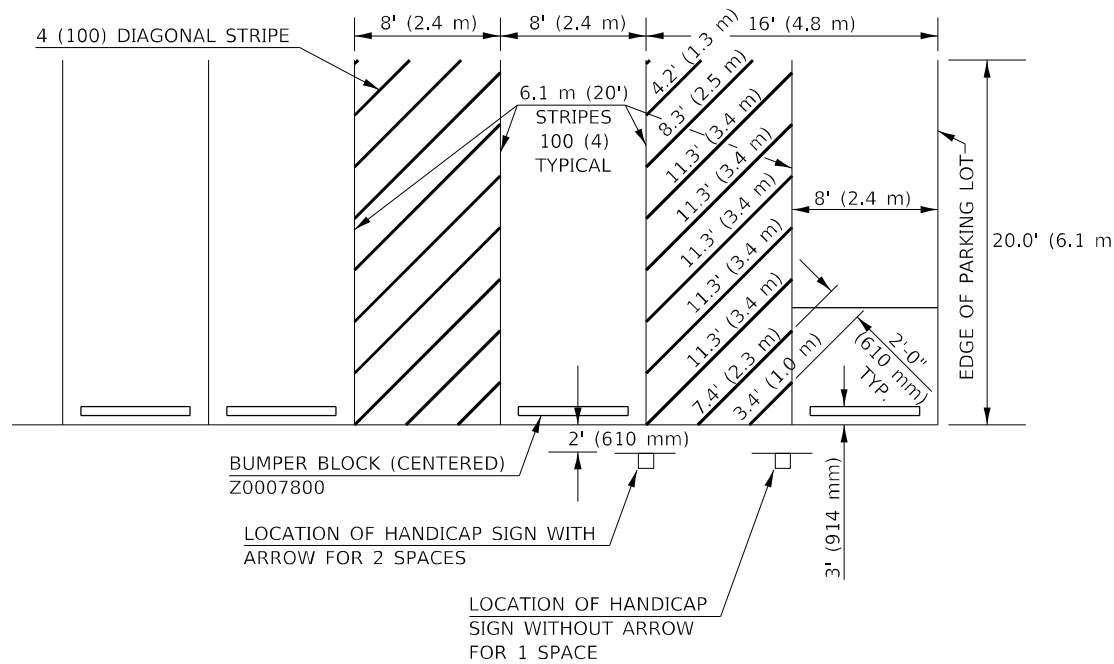

THIS DRAWING HAS NO SCALE.

ESTIMATED QUANTITY OF PAVEMENT MARKING-LINE 4" (100 mm) (FOR 1 SPACE)
TOTAL DIAGONALS = 80' (24.4 m)

SEE DETAIL FOR HANDICAP SIGN.

DETAIL OF PARKING SPACES

Note: All dimensions are in INCHES (millimeters) unless otherwise shown.

DISTRICT 5 DETAIL NO. 72000100

USER NAME = brwagehoff	DESIGNED -	REVISED - 11/06
	DRAWN -	REVISED - 12/27/17 JWS
PLOT SCALE = 40,000' / in.	CHECKED -	REVISED -
PLOT DATE = 1/27/2023	DATE -	REVISED -

STATE OF ILLINOIS
DEPARTMENT OF TRANSPORTATION

DISABLED PARKING

SCALE: SHEET 1 OF 1 SHEETS STA. TO STA.

SECTION	COUNTY	TOTAL SHEETS	SHEET NO.
CHAMPAIGN IMP 2023-1	CHAMPAIGN	15	15
CONTRACT NO.			
ILLINOIS FED. AID PROJECT			