

STATE OF ILLINOIS
DEPARTMENT OF TRANSPORTATION

F.A.P. ATE	SECTION	COUNTY	TOTAL SHEETS	SHEET NO.
799	1-BR, BDS-3	ST. CLAIR	16	1
		ILLINOIS	CONTRACT NO. 76K86	

FOR INDEX OF SHEETS, SEE SHEET NO. 2

PROPOSED
HIGHWAY PLANS

FAP ROUTE 799 (ILLINOIS AVE)
SECTION 1-BR, BDS-3
PROJECT NHPP-P8TY(397)
BRIDGE DECK SEALING
ST. CLAIR COUNTY

D-98-049-21



FUNCTIONAL CLASSIFICATION
OTHER PRINCIPAL ARTERIAL
2017 ADT = 9650 (ACTUAL)
2023 ADT = 9900 (ESTIMATED)
2043 ADT = 10900 (ESTIMATED)
S.U.=1.2% M.U.=1.1%

STATE OF ILLINOIS
DEPARTMENT OF TRANSPORTATION

SUBMITTED Feb 3 2023
[Signature] REGIONAL ENGINEER
March 24, 2023
[Signature] ENGINEER OF DESIGN AND ENVIRONMENT
March 24, 2023
[Signature] DIRECTOR OF HIGHWAYS PROJECT IMPLEMENTATION

PRINTED BY THE AUTHORITY
OF THE STATE OF ILLINOIS

R 10 W C-98-080-21

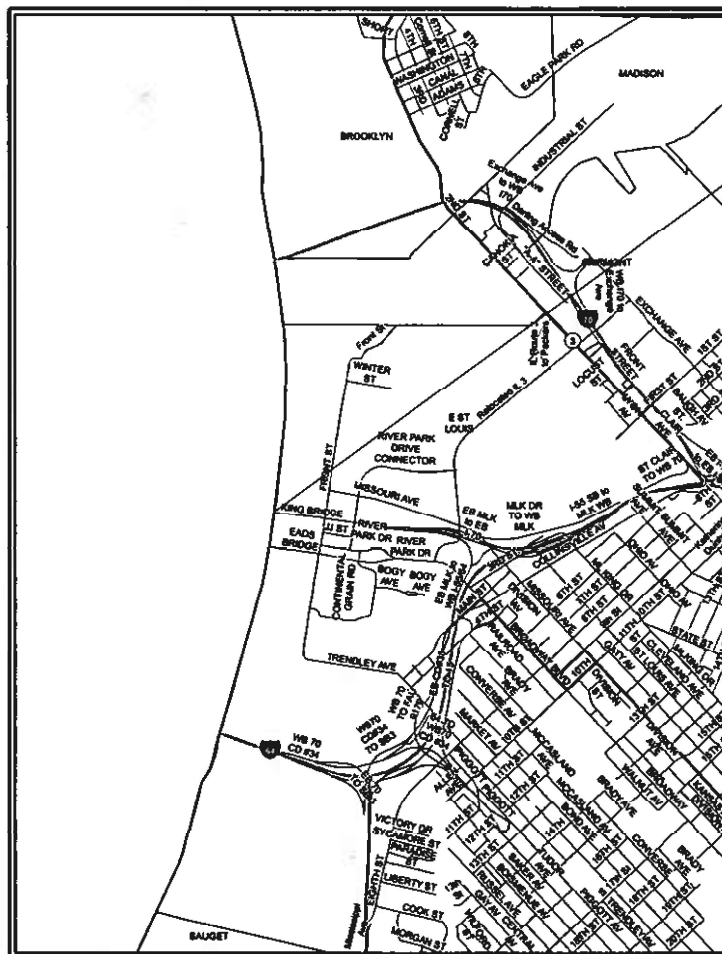

PROJECT LOCATION
MARTIN LUTHER KING BRIDGE
SN 082-6001
LATITUDE: 38.63093
LONGITUDE: -90.17830

T 2 N

NOT TO SCALE

GROSS LENGTH = 4,012.8 FT. = 0.76 MILE
NET LENGTH = 4,012.8 FT. = 0.76 MILE

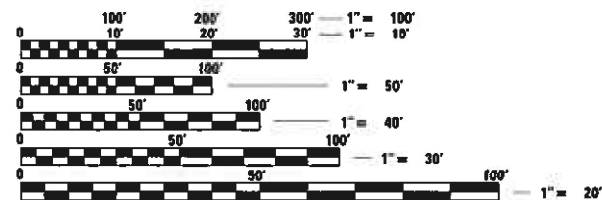

FULL SIZE PLANS HAVE BEEN PREPARED USING STANDARD ENGINEERING SCALES. REDUCED SIZED PLANS WILL NOT CONFORM TO STANDARD SCALES. IN MAKING MEASUREMENTS ON REDUCED PLANS, THE ABOVE SCALES MAY BE USED.

J.U.L.I.E.
JOINT UTILITY LOCATION INFORMATION FOR EXCAVATORS
1-800-892-0123
OR 811

PROJECT ENGINEER CHERYL KEPLAR
PROJECT MANAGER KAREN CHALLANDES

CONTRACT NO. 76K86

INDEX OF SHEETS

- 1. COVER SHEET
- 2. INDEX OF SHEETS, HIGHWAY STANDARDS, GENERAL NOTES, AND COMMITMENTS
- 3. SUMMARY OF QUANTITIES
- 4-12 TYPICAL SECTIONS AND PLAN VIEWS
- 13-16 ELEVATIONS

HIGHWAY STANDARDS

- 000001-08 STANDARD SYMBOLS, ABBREVIATIONS AND PATTERNS
- 001006 DECIMALS OF AN INCH AND OF A FOOT
- 701400-11 APPROACH TO LANE CLOSURE, FREEWAY/EXPRESSWAY
- 701401-13 LANE CLOSURE, FREEWAY/EXPRESSWAY
- 701411-09 LANE CLOSURE, MULTILANE, AT ENTRANCE OR EXIT RAMP, FOR SPEEDS ≥ 45 MPH
- 701422-10 LANE CLOSURE, MULTILANE, FOR SPEEDS ≥ MPH TO 55 MPH
- 701451-05 RAMP CLOSURE FREEWAY/EXPRESSWAY
- 701901-08 TRAFFIC CONTROL DEVICES

GENERAL NOTES

- 1. UTILITIES KNOWN TO HAVE FACILITIES WITHIN THE PROJECT AREA:
 AMEREN ILLINOIS
 AT&T ILLINOIS
 CHARTER COMMUNICATION, INC
 CITY OF EAST ST. LOUIS
 EXPLORER PIPELINE COMPANY
 ILLINOIS AMERICAN WATER COMPANY
 LEVEL 3 COMMUNICATIONS, LLC
 VERIZON BUSINESS
 METRO EAST SANITARY DISTRICT
 SPIRE NGL
 SPRINT
 WINDSTREAM KDL, INC.
- 2. NO SURVEY WAS PERFORMED FOR THIS PROJECT AND THE PLANS WERE CREATED USING MICROFILM AND FIELD MEASUREMENTS.
- 3. THE DEPARTMENT STRONGLY ENCOURAGES THE PRIME CONTRACTOR AND THEIR APPROVED SUB-CONTRACTORS TO HIRE MINORITY, WOMEN, AND DISADVANTAGED INDIVIDUALS FROM ITS FEDERALLY FUNDED HIGHWAY CONSTRUCTION CAREERS TRAINING PROGRAM (HCCTP) TO HELP MEET WORKFORCE AND TRAINEE GOALS. THIS PROGRAM IS TRAINING MINORITIES, WOMEN, AND DISADVANTAGED INDIVIDUALS IN HIGHWAY CONSTRUCTIONS-RELATED SKILLS, E.G., MATH FOR THE TRADES, JOB READINESS, TECHNICAL SKILLS COURSEWORK (CARPENTRY, CONCRETE FLATWORK, BLUEPRINT READING, SITE PLANS, SITE WORK, TOOLS USE, ETC.), AND OSHA 10 HOUR CERTIFICATION, TO PREPARE THEM FOR A CAREER IN THE HIGHWAY CONSTRUCTION TRADES. GRADUATES ARE WELL-TRAINED AND READY TO BECOME PRODUCTIVE ENTRY-LEVEL CONSTRUCTION WORKERS. CONTACT THE DISTRICT 8 EEO OFFICE AT 618-346-3360 AND/OR THE HCCTP COORDINATOR AT 618-874-6528 TO LEARN MORE ABOUT THE PROGRAM AND FOR ASSISTANCE IN MEETING WORKFORCE AND TRAINEE GOALS.
- 4. NO CONCRETE SEALER WILL BE APPLIED TO THE PARAPETS ON SPANS 8, 9, AND 10. BARRIER BETWEEN EAST AND WEST BOUND TRAFFIC WILL REQUIRE SEALER

COMMITMENTS

NONE

MODEL: Default
 FILE: M:\MS-PLAN\110101\Documents\DOT Offices\District 8\Project\876868\CADD\data\CADD\sheet\876868-shr-gmnote.dgn

USER NAME = Karen.Challandes	DESIGNED -	REVISED -	STATE OF ILLINOIS DEPARTMENT OF TRANSPORTATION	INDEX OF SHEETS, HIGHWAY STANDARDS GENERAL NOTES AND COMMITMENTS	F.A.P. RTE.	SECTION	COUNTY	TOTAL SHEETS	SHEET NO.
DRAWN -	REVISED -	799			1-BR, BDS-3	ST. CLAIR	16	2	
PLOT SCALE = 100.0000' / in.	CHECKED -	REVISED -			CONTRACT NO. 76K86				
PLOT DATE = 2/2/2023	DATE -	REVISED -			ILLINOIS FED. AID PROJECT				
			SCALE:	SHEET OF SHEETS	STA.	TO STA.			

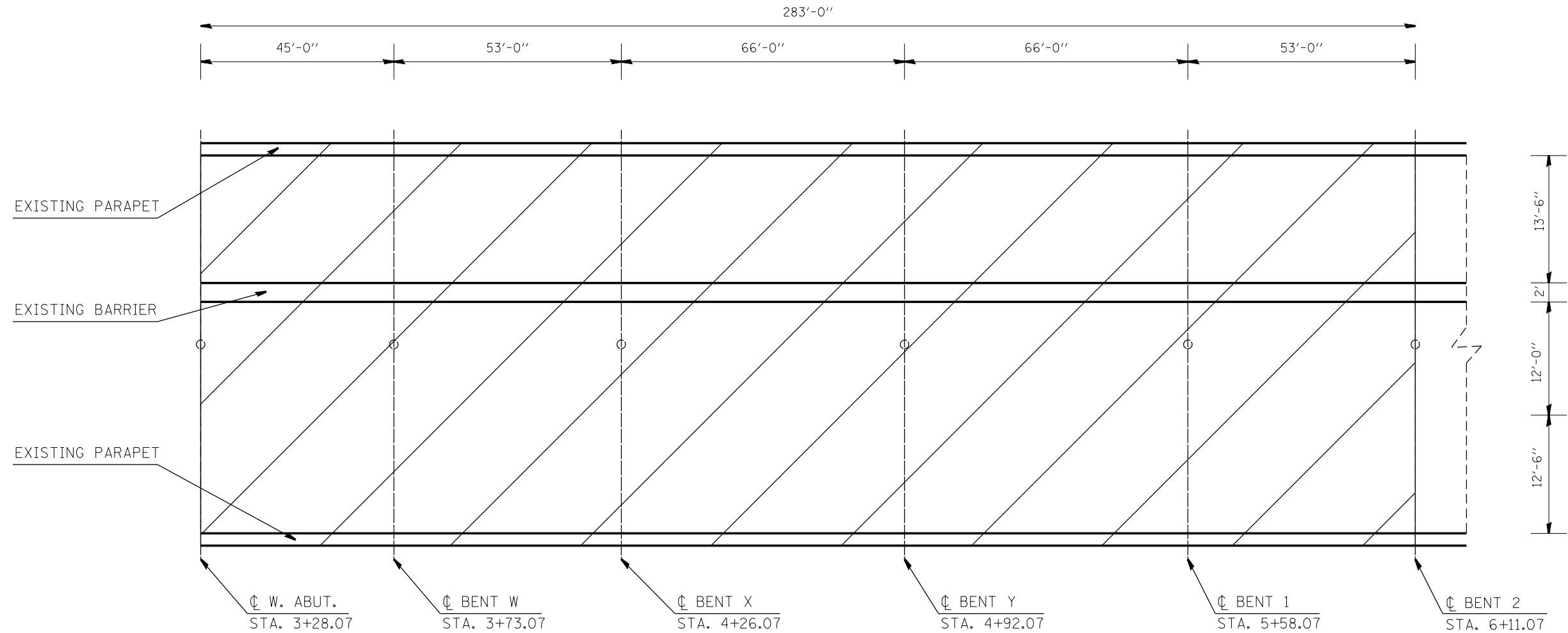

PLAN
SPANS W THROUGH 2

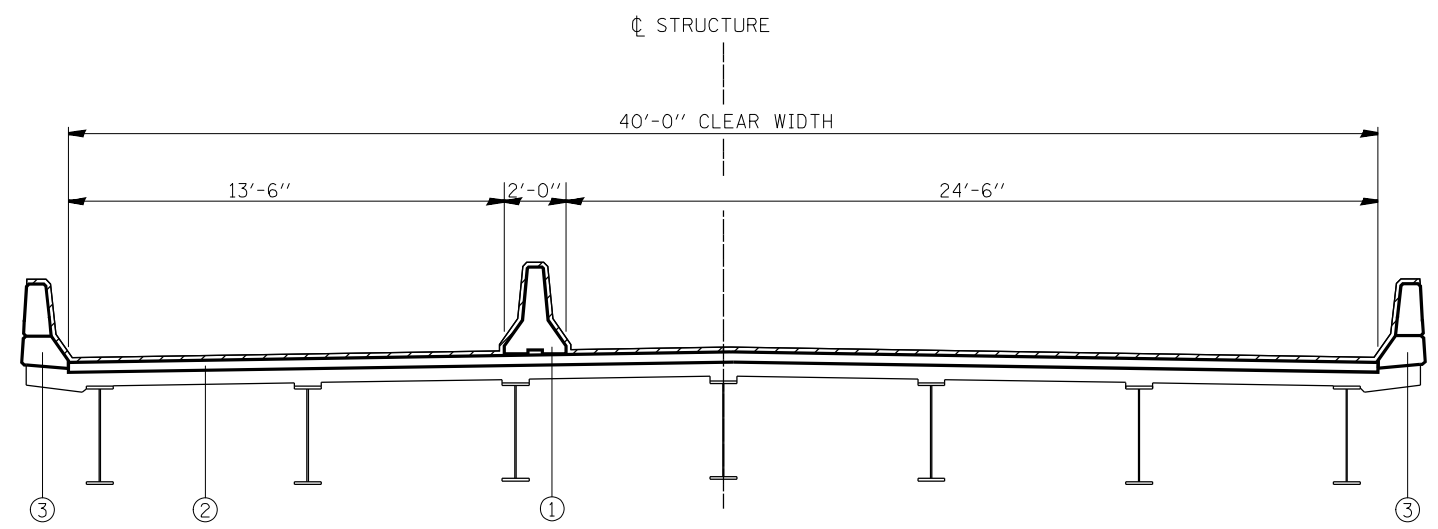

TYPICAL SECTION
(LOOKING EAST)

BILL OF MATERIALS

ITEM	UNIT	TOTAL
BRIDGE DECK CONCRETE SEALER	SQ FT.	14,641

LEGEND

- ① EXISTING CONCRETE SAFETY BARRIER, SPECIAL
- ② EXISTING PCC BRIDGE DECK
- ③ EXISTING CONCRETE PARAPET
- * EXISTING ALUMINUM PARAPET SPAN 8-10

- AREA TO BE SEALED

MODEL: Default
 FILE: \\mifs-pw-beadley.com\P\W\DOT\Documents\DOT_Offices\Dir\dr. B\Project\0876466\CADD\data\CADD\sheet\0876466-sh1-typical.dgn

USER NAME = Karen.Challandes	DESIGNED -	REVISED -
PLOT SCALE = 100,0317' / in.	DRAWN -	REVISED -
PLOT DATE = 2/2/2023	CHECKED -	REVISED -
	DATE -	REVISED -

STATE OF ILLINOIS
DEPARTMENT OF TRANSPORTATION

TYPICAL SECTION AND PLAN VIEW

SCALE: SHEET 1 OF 9 SHEETS STA. TO STA.

F.A.P. RTE.	SECTION	COUNTY	TOTAL SHEETS	SHEET NO.
799	1-BR, BDS-3	ST. CLAIR	16	4
CONTRACT NO. 76K86			ILLINOIS FED. AID PROJECT	

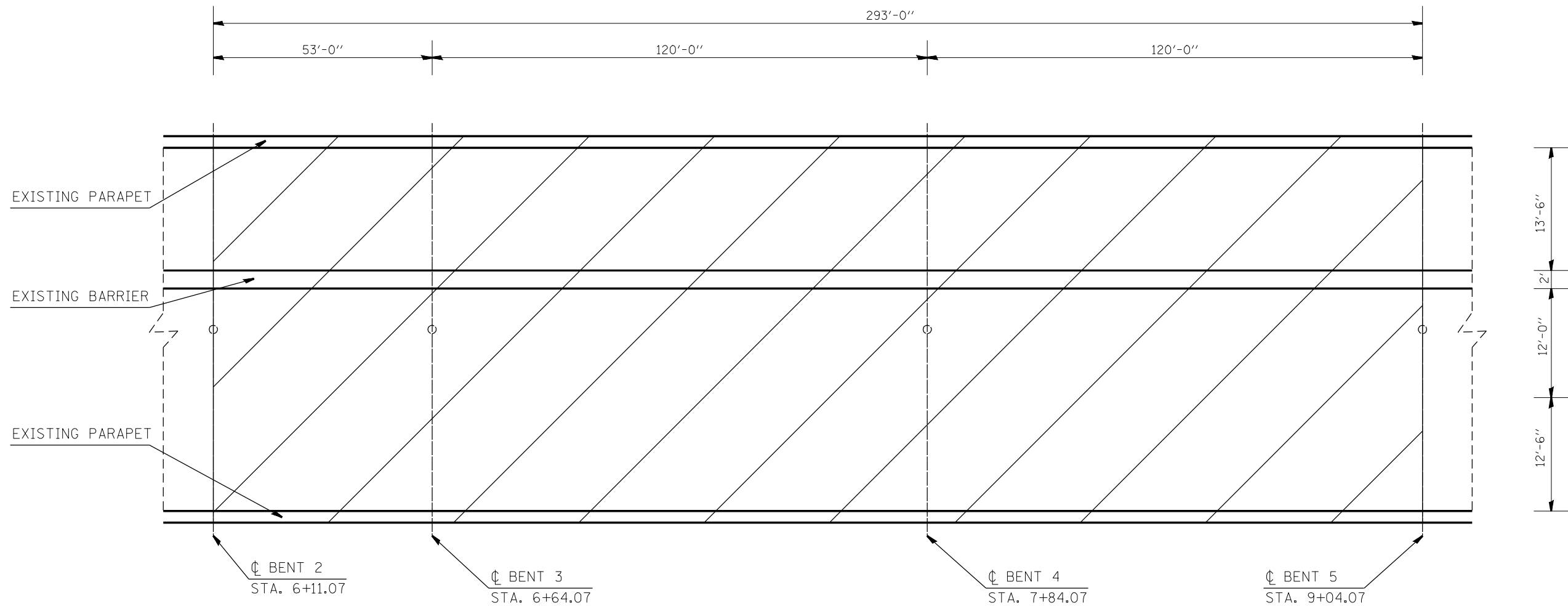

PLAN
SPANS 3 THROUGH 5

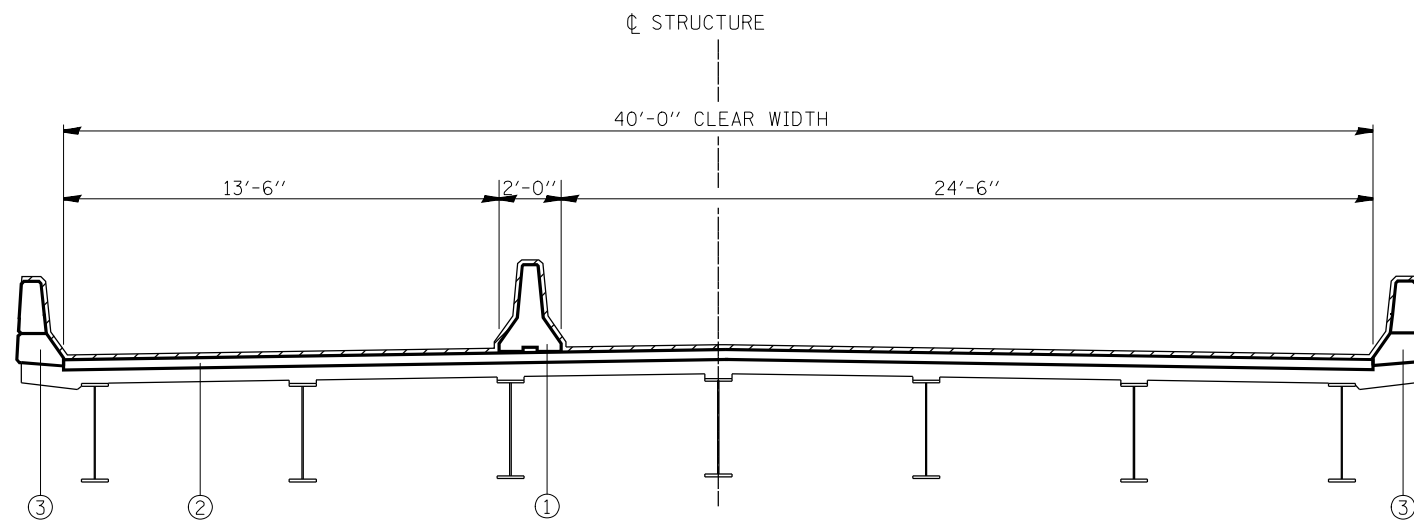

TYPICAL SECTION
(LOOKING EAST)

BILL OF MATERIALS

ITEM	UNIT	TOTAL
BRIDGE DECK CONCRETE SEALER	SQ FT.	15,159

LEGEND

- ① EXISTING CONCRETE SAFETY BARRIER, SPECIAL
- ② EXISTING PCC BRIDGE DECK
- ③ EXISTING CONCRETE PARAPET
- * EXISTING ALUMINUM PARAPET SPAN 8-10

- AREA TO BE SEALED

MODEL: Default
 FILE: \\mfs-pw-bentley.com\PW\DOT\Documents\DOT_Offices\Dir\dr. B\Project\0876666\CADD\data\CAD\sheet\0876666-sh1-typical.dgn

USER NAME = Karen.Challandes	DESIGNED -	REVISED -
PLOT SCALE = 100,0317' / in.	DRAWN -	REVISED -
PLOT DATE = 2/2/2023	CHECKED -	REVISED -
	DATE -	REVISED -

STATE OF ILLINOIS
DEPARTMENT OF TRANSPORTATION

TYPICAL SECTION AND PLAN VIEW

SCALE: SHEET 2 OF 9 SHEETS STA. TO STA.

F.A.P. RTE.	SECTION	COUNTY	TOTAL SHEETS	SHEET NO.
799	1-BR, BDS-3	ST. CLAIR	16	5
CONTRACT NO. 76K86			ILLINOIS FED. AID PROJECT	

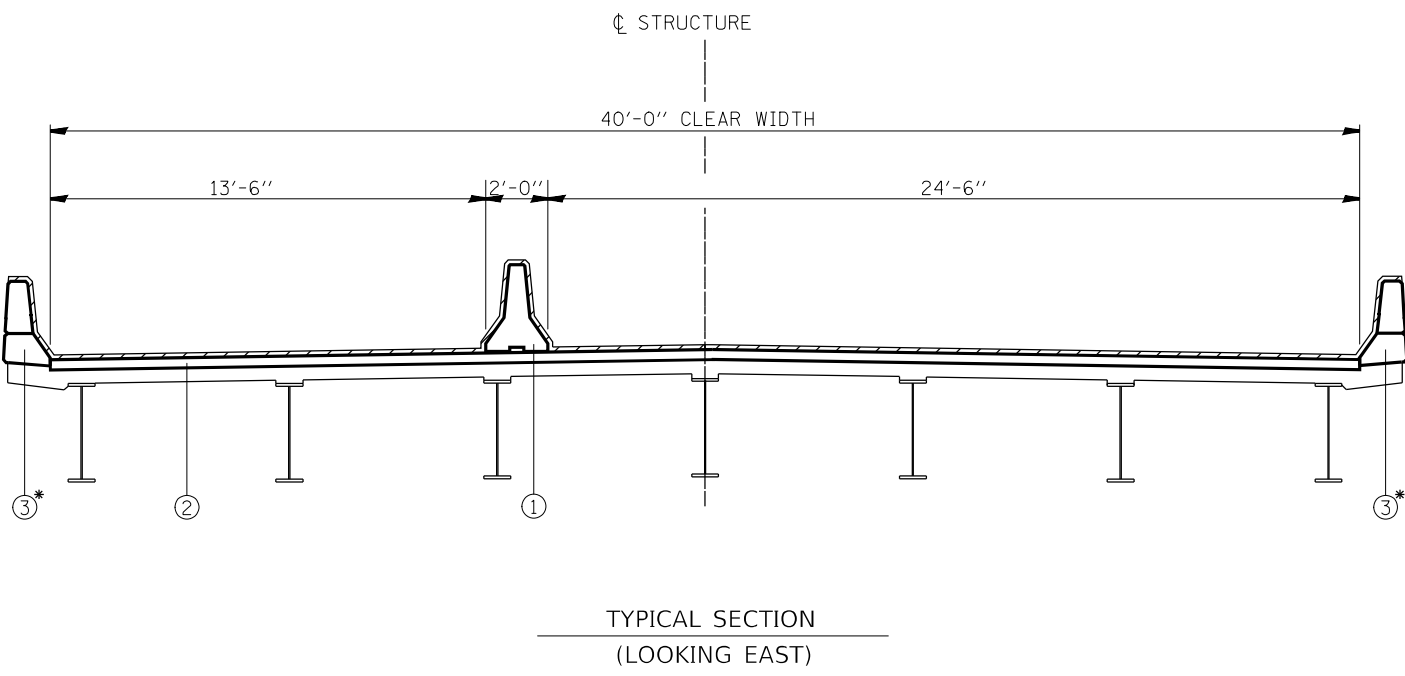
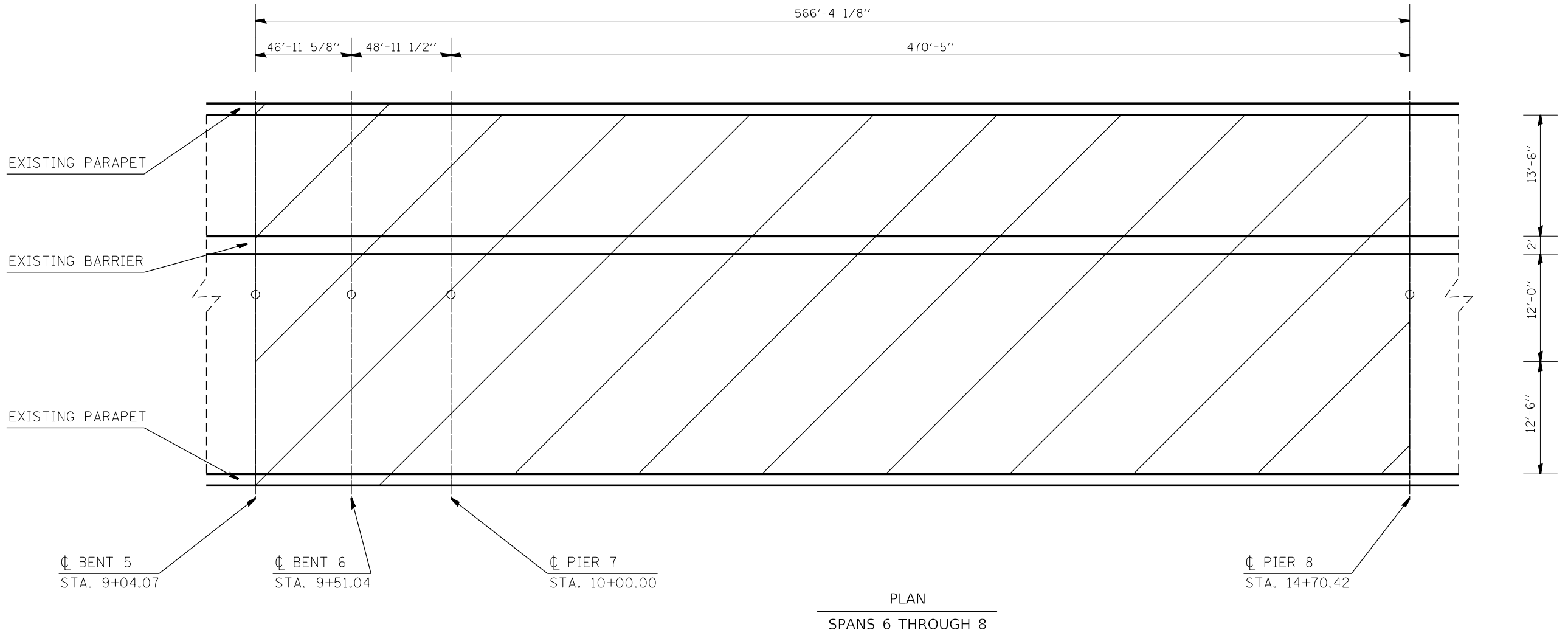

BILL OF MATERIALS

ITEM	UNIT	TOTAL
BRIDGE DECK CONCRETE SEALER	SQ. FT.	25,846

LEGEND

- ① EXISTING CONCRETE SAFETY BARRIER, SPECIAL
- ② EXISTING PCC BRIDGE DECK
- ③ EXISTING CONCRETE PARAPET
- * EXISTING ALUMINUM PARAPET SPAN 8-10

- AREA TO BE SEALED

MODEL: Default
 FILE: M:\MS_Plan\Subcontract\aw_beaufay.com\PIV\DOT\Documents\DOT_Offices\Dir\drt_8\Project\0876868\CADD\data\CADD\beest0876868-ht-typical.dgn
 2/2/2023 10:15:11 AM

USER NAME = Karen.Challandes	DESIGNED -	REVISED -	
PLOT SCALE = 100,0317' / in.	DRAWN -	REVISED -	
PLOT DATE = 2/2/2023	CHECKED -	REVISED -	
	DATE -	REVISED -	

STATE OF ILLINOIS
DEPARTMENT OF TRANSPORTATION

TYPICAL SECTION AND PLAN VIEW

SCALE: SHEET 3 OF 9 SHEETS STA. TO STA.

F.A.P. RTE.	SECTION	COUNTY	TOTAL SHEETS	SHEET NO.
799	1-BR, BDS-3	ST. CLAIR	16	6
CONTRACT NO. 76K86				
ILLINOIS FED. AID PROJECT				

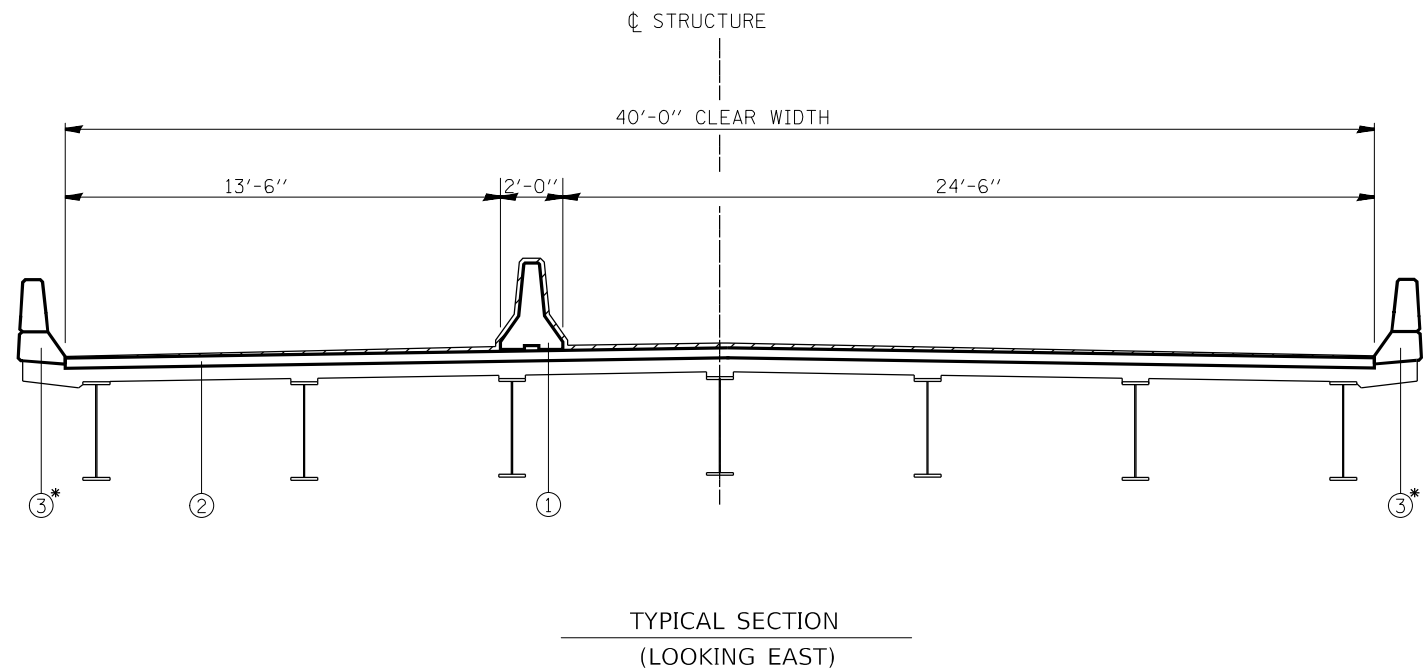
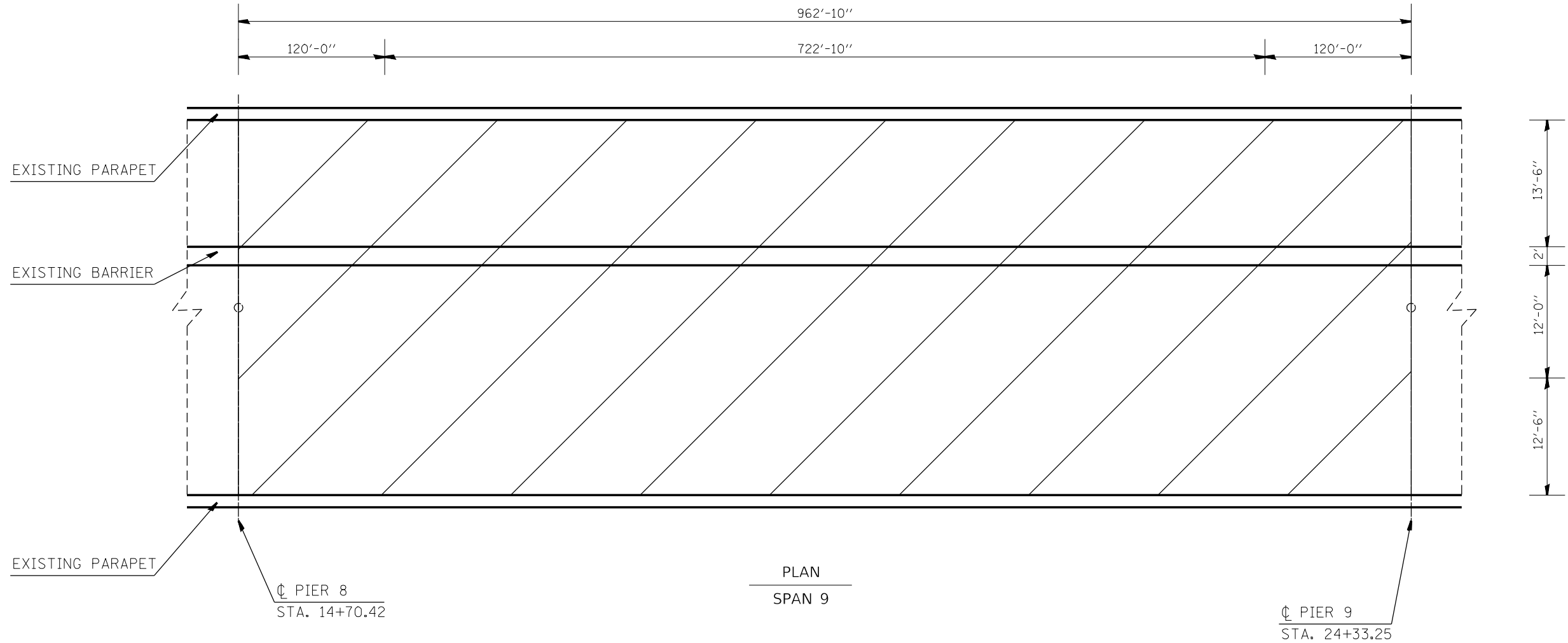

BILL OF MATERIALS

ITEM	UNIT	TOTAL
BRIDGE DECK CONCRETE SEALER	SQ. FT.	42,742

LEGEND

- ① EXISTING CONCRETE SAFETY BARRIER, SPECIAL
- ② EXISTING PCC BRIDGE DECK
- ③ EXISTING CONCRETE PARAPET
- * EXISTING ALUMINUM PARAPET SPAN 8-10

- AREA TO BE SEALED

MODEL: Default
 FILE: \\mfs1-pw-beadley.com\P\DOT\Documents\DOT_Offices\Dir\dr. E\Project\08764666\CADD\data\CAD\sheet\08764666-sh1-typical.dgn

USER NAME = Karen.Challandes	DESIGNED -	REVISED -
	DRAWN -	REVISED -
PLOT SCALE = 100.0317' / in.	CHECKED -	REVISED -
PLOT DATE = 2/2/2023	DATE -	REVISED -

**STATE OF ILLINOIS
DEPARTMENT OF TRANSPORTATION**

TYPICAL SECTION AND PLAN VIEW

SCALE: SHEET 4 OF 9 SHEETS STA. TO STA.

F.A.P. RTE.	SECTION	COUNTY	TOTAL SHEETS	SHEET NO.
799	1-BR, BDS-3	ST. CLAIR	16	7
CONTRACT NO. 76K86			ILLINOIS FED. AID PROJECT	

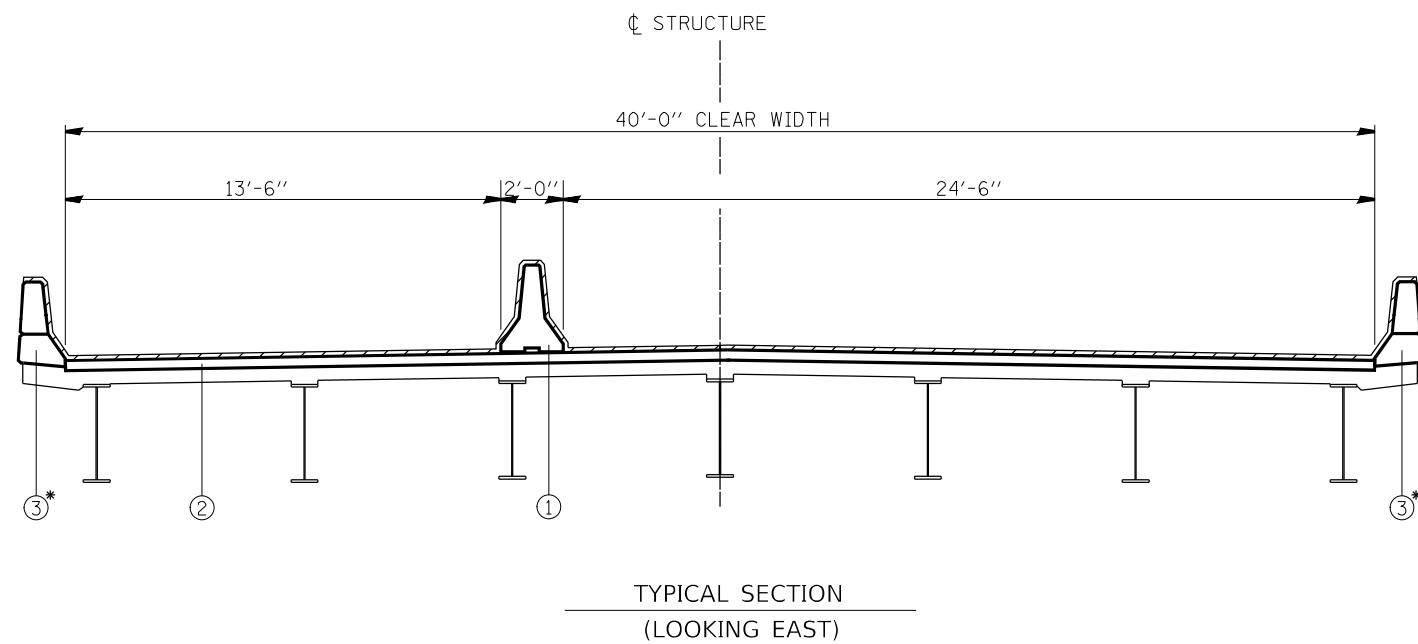
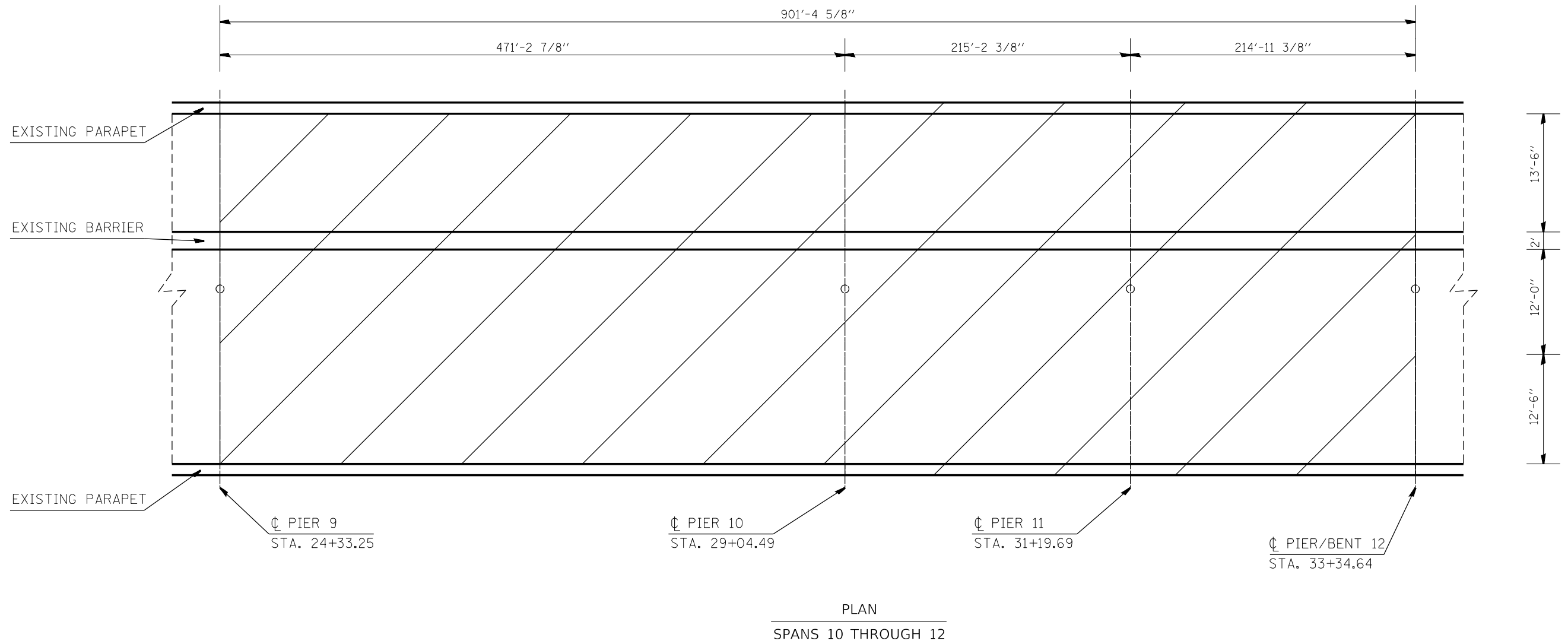

BILL OF MATERIALS

ITEM	UNIT	TOTAL
BRIDGE DECK CONCRETE SEALER	SQ FT.	43,174

LEGEND

- ① EXISTING CONCRETE SAFETY BARRIER, SPECIAL
- ② EXISTING PCC BRIDGE DECK
- ③ EXISTING CONCRETE PARAPET
- * EXISTING ALUMINUM PARAPET SPAN 8-10

- AREA TO BE SEALED

MODEL: Default
FILE: M:\MSD\p1\subct-cw-bead-ey.com\PIV\DOT\Documents\DOT_Offices\Dir\dr. B\Project\0876466\CADD\data\CAD\sheet\0876466-sh1-tyical.dgn

USER NAME = Karen.Challandes	DESIGNED -	REVISED -
PLOT SCALE = 100.0317' / in.	DRAWN -	REVISED -
PLOT DATE = 2/2/2023	CHECKED -	REVISED -
	DATE -	REVISED -

**STATE OF ILLINOIS
DEPARTMENT OF TRANSPORTATION**

TYPICAL SECTION AND PLAN VIEW

SCALE: SHEET 5 OF 9 SHEETS STA. TO STA.

F.A.P. RTE. 799	SECTION 1-BR, BDS-3	COUNTY ST. CLAIR	TOTAL SHEETS 16	SHEET NO. 8
			CONTRACT NO. 76K86	
ILLINOIS FED. AID PROJECT				

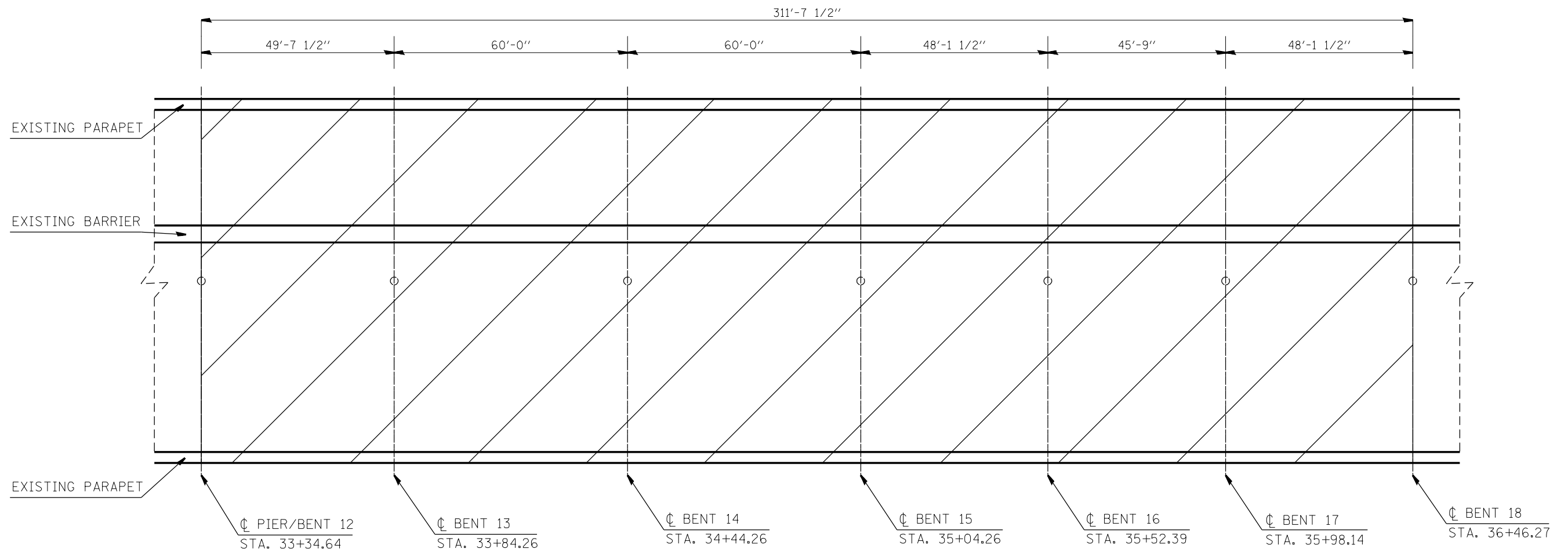

PLAN
SPANS 13 THROUGH 18

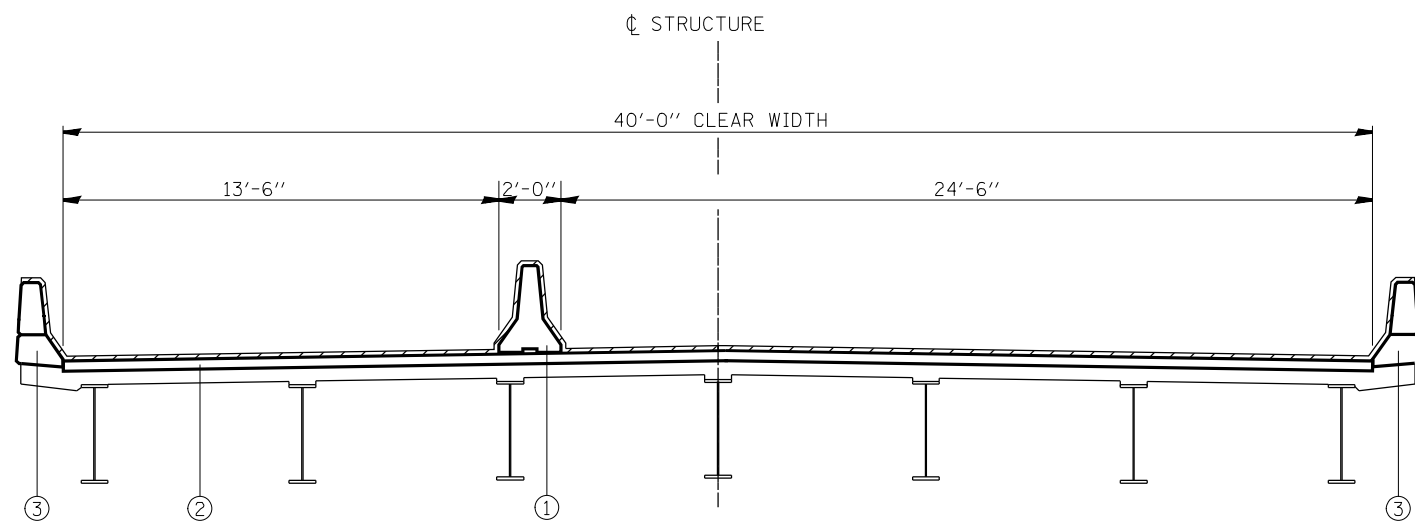

TYPICAL SECTION
(LOOKING EAST)

▨ - AREA TO BE SEALED

BILL OF MATERIALS

ITEM	UNIT	TOTAL
BRIDGE DECK CONCRETE SEALER	SQ FT.	16,123

LEGEND

- ① EXISTING CONCRETE SAFETY BARRIER, SPECIAL
- ② EXISTING PCC BRIDGE DECK
- ③ EXISTING CONCRETE PARAPET
- * EXISTING ALUMINUM PARAPET SPAN 8-10

MODEL: Default
 FILE: \\mifs-prod\share\work\proj\11001\Documents\11001_Offices\Dir\rdt - B\Project\08764666\CADD\data\CADD\sheet\08764666-sh1-typical.dgn

USER NAME = Karen.Challandes	DESIGNED -	REVISED -
PLOT SCALE = 100.0317' / in.	DRAWN -	REVISED -
PLOT DATE = 2/2/2023	CHECKED -	REVISED -
	DATE -	REVISED -

STATE OF ILLINOIS
DEPARTMENT OF TRANSPORTATION

TYPICAL SECTION AND PLAN VIEW

SCALE: SHEET 6 OF 9 SHEETS STA. TO STA.

F.A.P. RTE.	SECTION	COUNTY	TOTAL SHEETS	SHEET NO.
799	1-BR, BDS-3	ST. CLAIR	16	9
CONTRACT NO. 76K86			ILLINOIS FED. AID PROJECT	

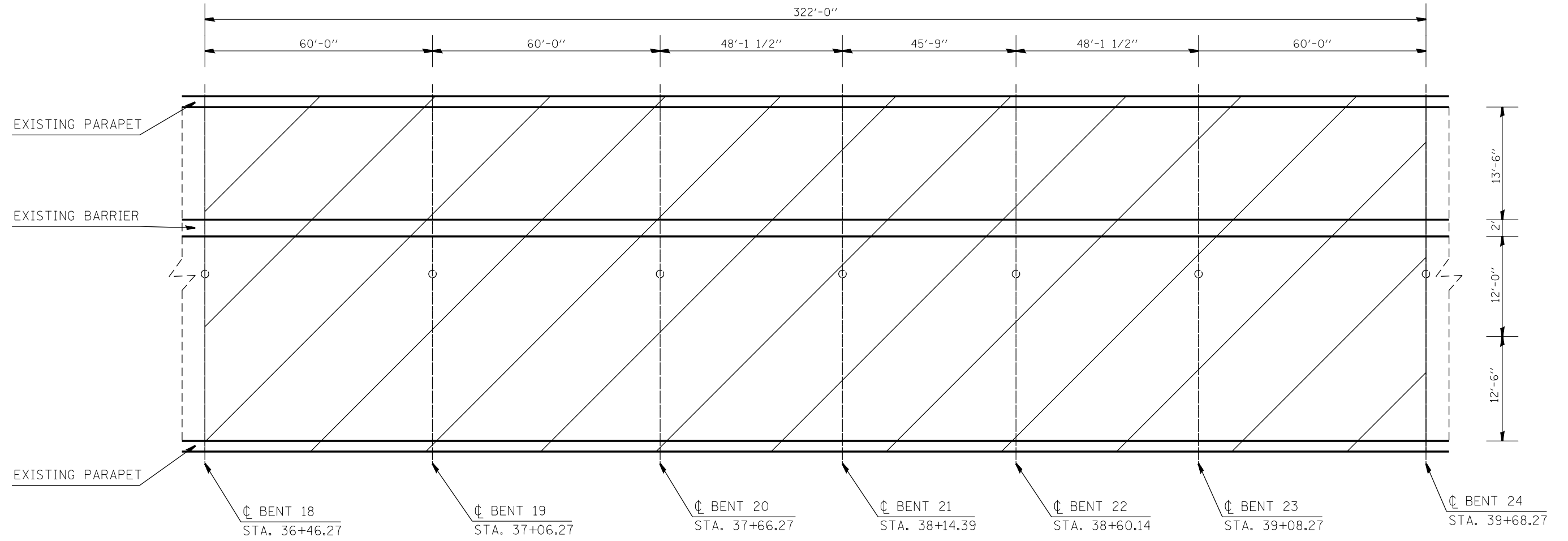

PLAN
SPANS 19 THROUGH 24

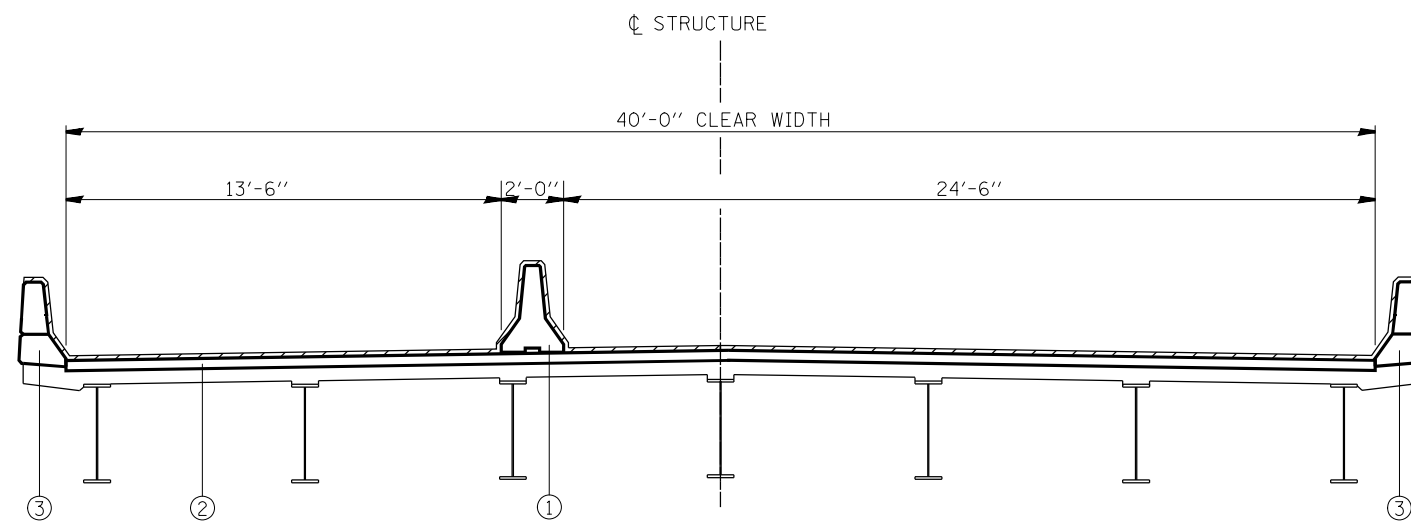

TYPICAL SECTION
(LOOKING EAST)

- AREA TO BE SEALED

BILL OF MATERIALS

ITEM	UNIT	TOTAL
BRIDGE DECK CONCRETE SEALER	SQ. FT.	16,659

LEGEND

- ① EXISTING CONCRETE SAFETY BARRIER, SPECIAL
- ② EXISTING PCC BRIDGE DECK
- ③ EXISTING CONCRETE PARAPET
- * EXISTING ALUMINUM PARAPET SPAN 8-10

MODEL: Default
 FILE: 1441616 - 11/11/2021 10:00:00 AM
 PROJECT: 108764666 - 11/11/2021 10:00:00 AM
 PROJECT: 108764666 - 11/11/2021 10:00:00 AM
 PROJECT: 108764666 - 11/11/2021 10:00:00 AM

USER NAME = Karen.Challandes	DESIGNED -	REVISED -
	DRAWN -	REVISED -
PLOT SCALE = 100.0317' / in.	CHECKED -	REVISED -
PLOT DATE = 2/2/2023	DATE -	REVISED -

STATE OF ILLINOIS
DEPARTMENT OF TRANSPORTATION

TYPICAL SECTION AND PLAN VIEW

SCALE: SHEET 7 OF 9 SHEETS STA. TO STA.

F.A.P. RTE.	SECTION	COUNTY	TOTAL SHEETS	SHEET NO.
799	1-BR, BDS-3	ST. CLAIR	16	10
CONTRACT NO. 76K86			ILLINOIS FED. AID PROJECT	

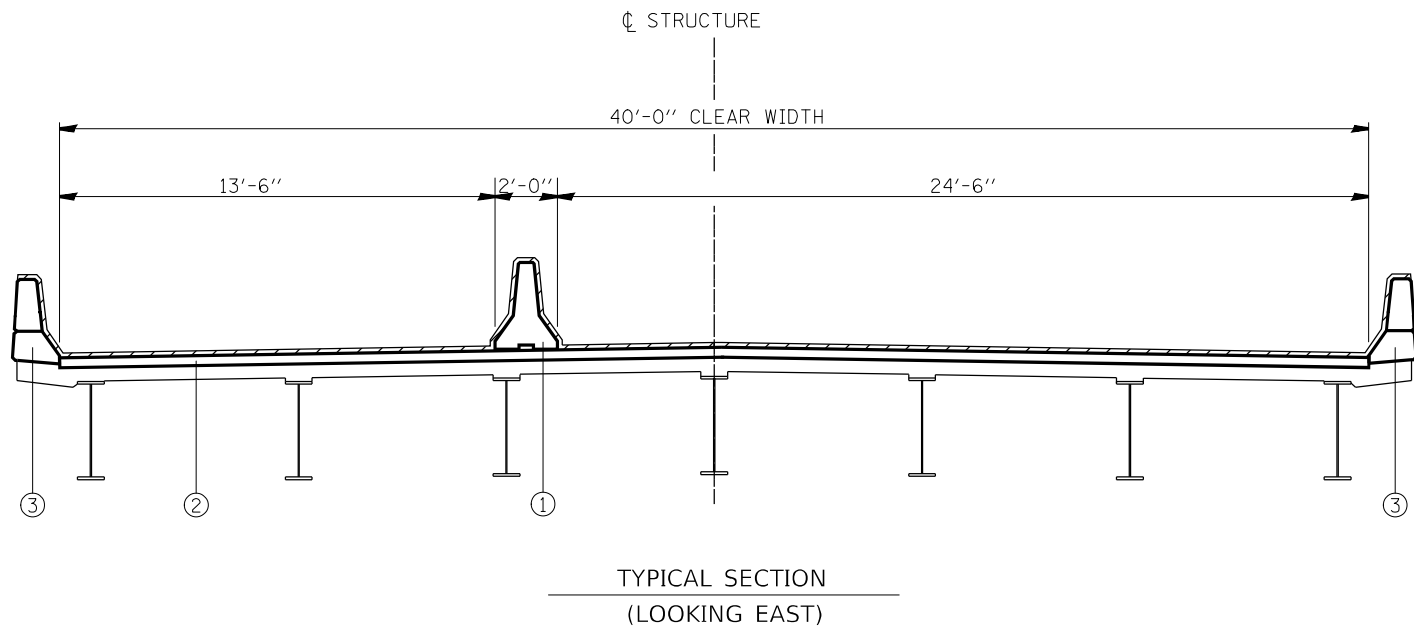
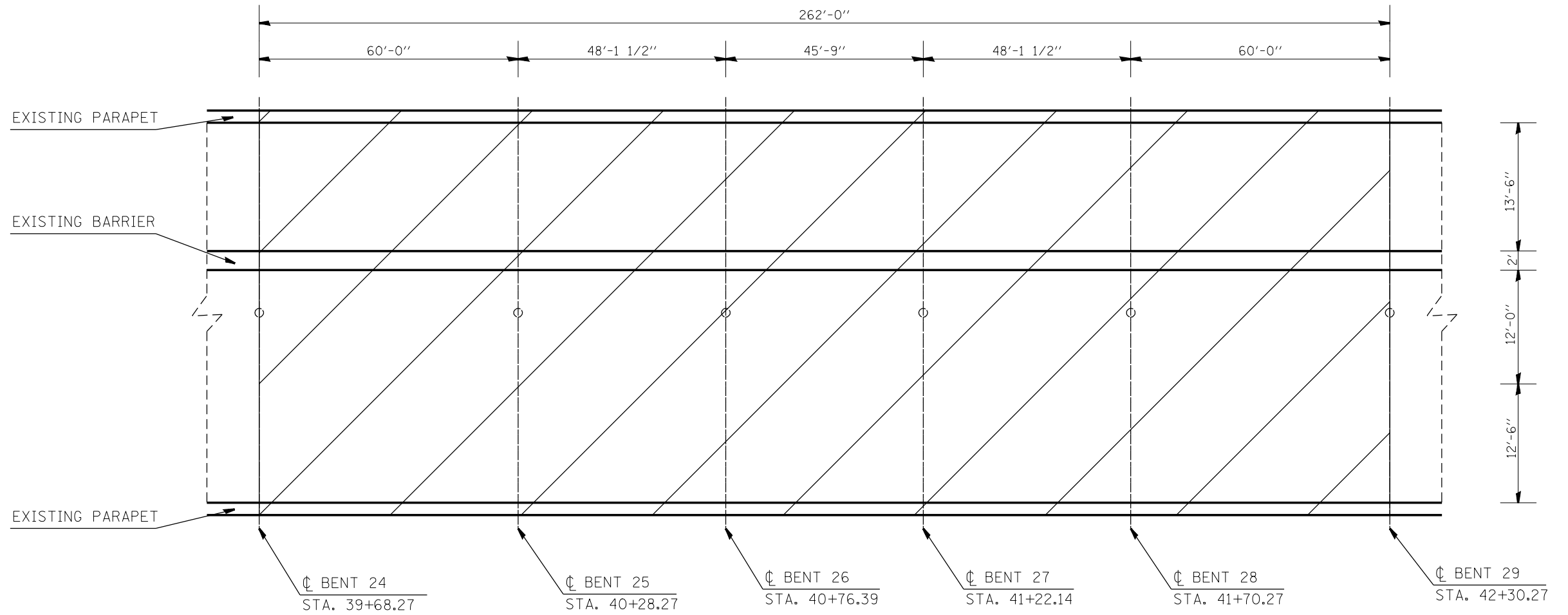

- AREA TO BE SEALED

BILL OF MATERIALS

ITEM	UNIT	TOTAL
BRIDGE DECK CONCRETE SEALER	SQ. FT.	13,555

LEGEND

- ① EXISTING CONCRETE SAFETY BARRIER, SPECIAL
- ② EXISTING PCC BRIDGE DECK
- ③ EXISTING CONCRETE PARAPET
- * EXISTING ALUMINUM PARAPET SPAN 8-10

USER NAME = Karen.Challandes	DESIGNED -	REVISD -
PLOT SCALE = 100,0317' / in.	DRAWN -	REVISD -
PLOT DATE = 2/2/2023	CHECKED -	REVISD -
	DATE -	REVISD -

**STATE OF ILLINOIS
DEPARTMENT OF TRANSPORTATION**

TYPICAL SECTION AND PLAN VIEW

SCALE: SHEET 8 OF 9 SHEETS STA. TO STA.

F.A.P. RTE.	SECTION	COUNTY	TOTAL SHEETS	SHEET NO.
799	1-BR, BDS=3	ST. CLAIR	16	11
CONTRACT NO. 76K86				
ILLINOIS FED. AID PROJECT				

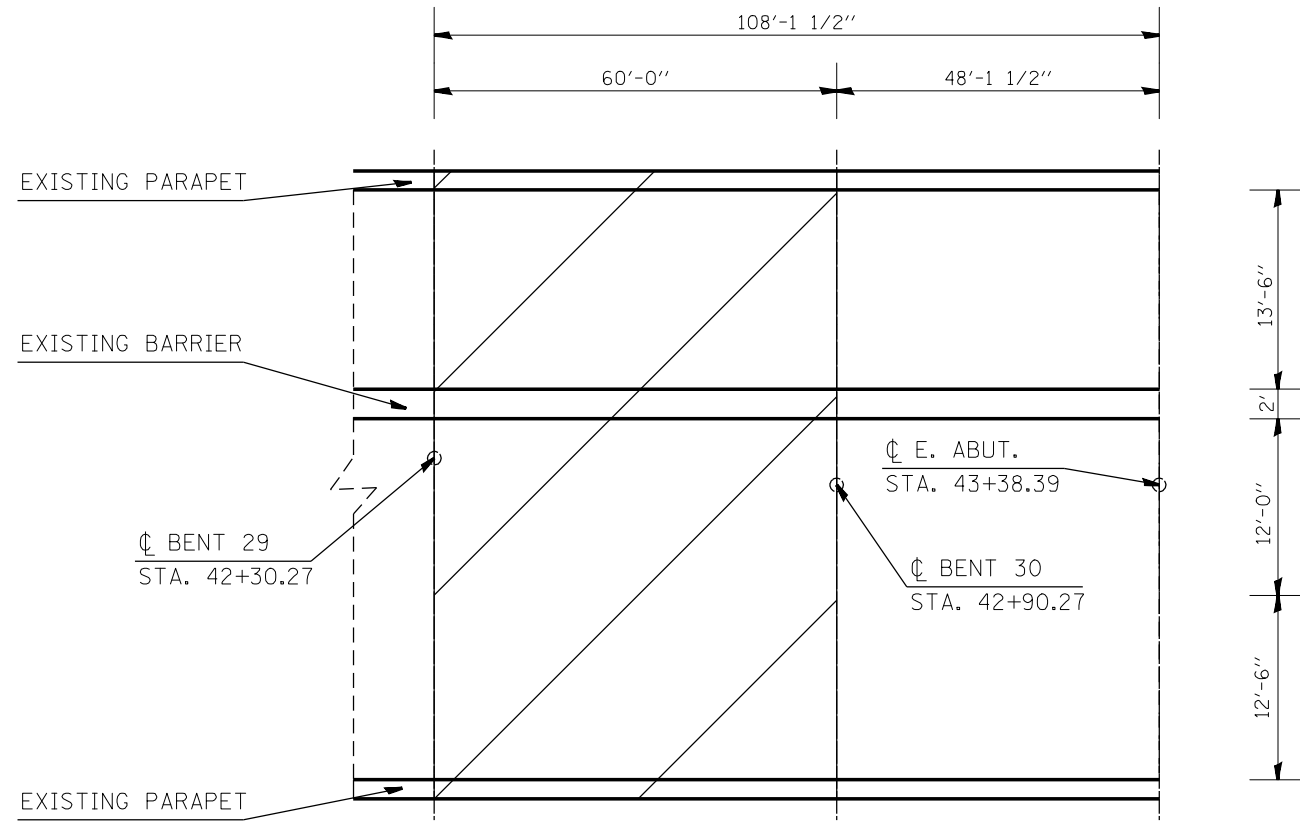

PLAN
SPAN 30 AND EAST ABUTMENT

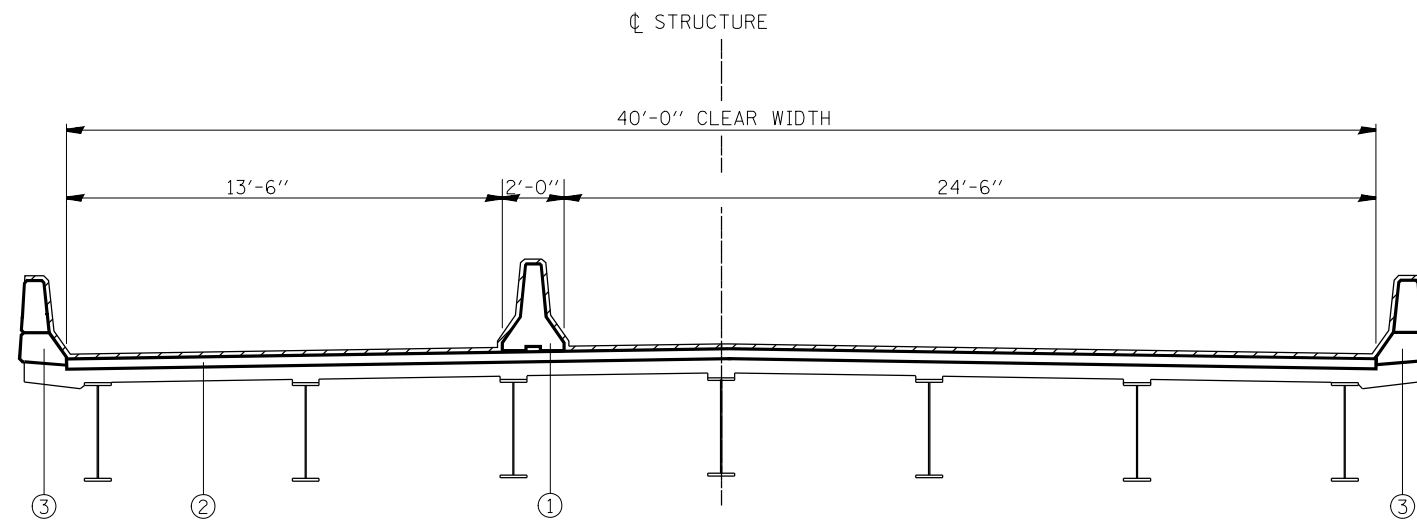

TYPICAL SECTION
(LOOKING EAST)

- AREA TO BE SEALED

BILL OF MATERIALS

ITEM	UNIT	TOTAL
BRIDGE DECK CONCRETE SEALER	SQ FT.	5,594

LEGEND

- ① EXISTING CONCRETE SAFETY BARRIER, SPECIAL
- ② EXISTING PCC BRIDGE DECK
- ③ EXISTING CONCRETE PARAPET
- * EXISTING ALUMINUM PARAPET SPAN 8-10

MODEL: Default
 FILE: 1441612.dwg
 PLOT DATE: 2/2/2023
 PLOT SCALE: 100.0317' / in.
 USER: Karen.Challandes
 PROJECT: 108764666.CADDATA\CADD\108764666.dwg

USER NAME = Karen.Challandes	DESIGNED -	REVISED -
	DRAWN -	REVISED -
PLOT SCALE = 100.0317' / in.	CHECKED -	REVISED -
PLOT DATE = 2/2/2023	DATE -	REVISED -

**STATE OF ILLINOIS
DEPARTMENT OF TRANSPORTATION**

TYPICAL SECTION AND PLAN VIEW

SCALE: SHEET 9 OF 9 SHEETS STA. TO STA.

F.A.P. RTE.	SECTION	COUNTY	TOTAL SHEETS	SHEET NO.
799	1-BR, BDS-3	ST. CLAIR	16	12
CONTRACT NO. 76K86			ILLINOIS FED. AID PROJECT	

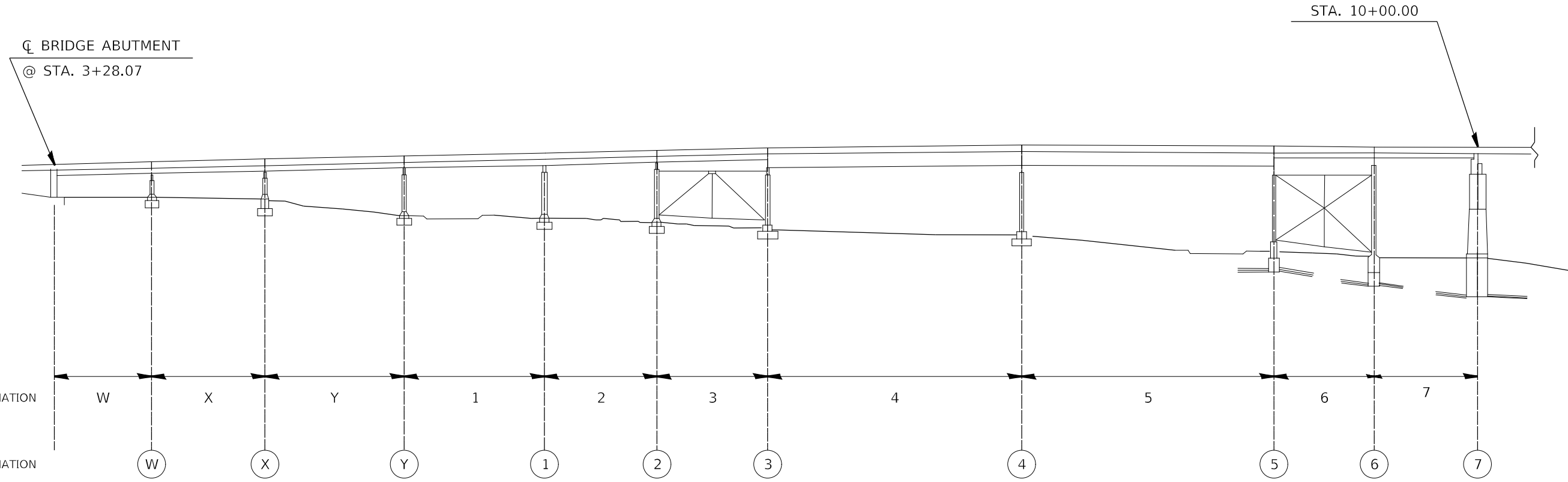

ELEVATION
SPANS W TO 7

MODEL: Default
 FILE NAME: p:\project-aw-beadley.com\p\DOT\Documents\DOT_Offices\Dir\dir_8\Project\0876466\CAD\data\CAD\sheet\0876466-sh13.dwg

USER NAME = Karen.Challandes	DESIGNED -	REVISED -
	DRAWN -	REVISED -
PLOT SCALE = 100.0317' / in.	CHECKED -	REVISED -
PLOT DATE = 2/2/2023	DATE -	REVISED -

**STATE OF ILLINOIS
DEPARTMENT OF TRANSPORTATION**

ELEVATION			
SCALE:	SHEET 1	OF 4 SHEETS	STA. TO STA.

F.A.P. RTE. 799	SECTION 1-BR, BDS-3	COUNTY ST CLAIR	TOTAL SHEETS 16	SHEET NO. 13
CONTRACT NO. 76K86			ILLINOIS FED. AID PROJECT	

MODEL: Default
 FILE NAME: p:\w\dot\aw\bead\p\p\w\dot\Documents\DOT Office\Dir\dir_8\Project\0876466\CADD\data\CADD\sheet\0876466-sh1-1.pcd.dgn

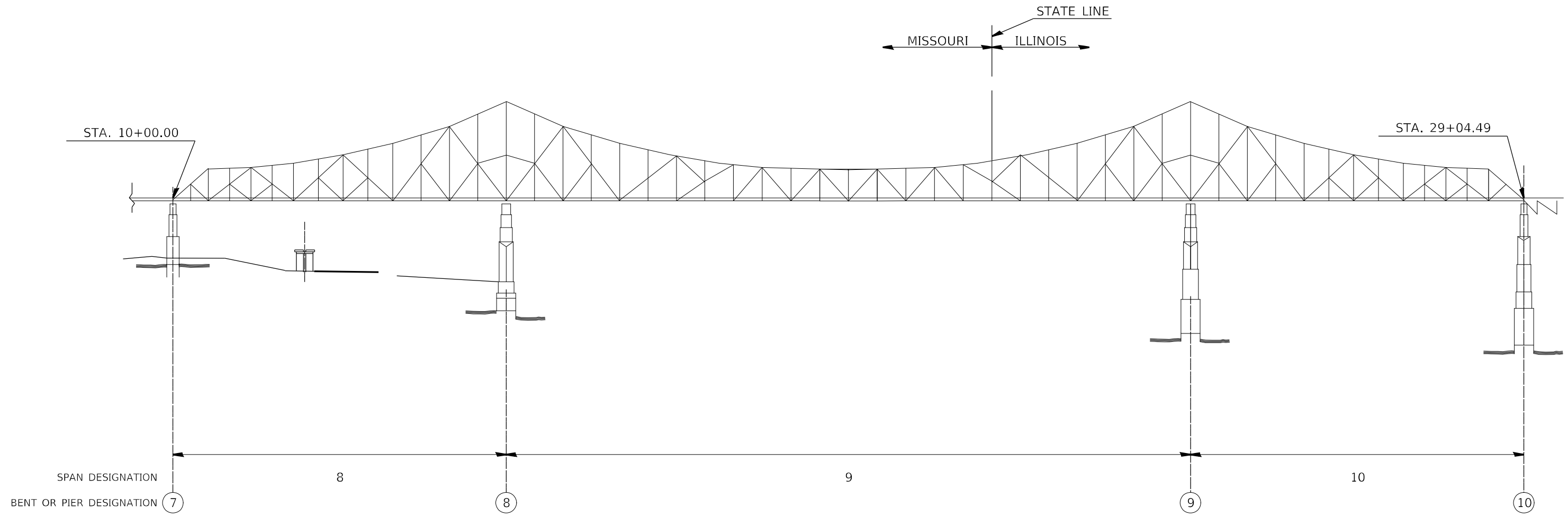

ELEVATION
 SPANS 8 TO 10

	USER NAME = Karen.Challandes PLOT SCALE = 100,0317' / in. PLOT DATE = 2/2/2023	DESIGNED - DRAWN - CHECKED - DATE -	REVISED - REVISED - REVISED - REVISED -	STATE OF ILLINOIS DEPARTMENT OF TRANSPORTATION	ELEVATION	SCALE: SHEET 2 OF 4 SHEETS STA. TO STA.	<table border="1" style="width: 100%; border-collapse: collapse;"> <tr> <th>F.A.P. RTE.</th> <th>SECTION</th> <th>COUNTY</th> <th>TOTAL SHEETS</th> <th>SHEET NO.</th> </tr> <tr> <td>799</td> <td>1-BR, BDS-3</td> <td>ST. CLAIR</td> <td>16</td> <td>14</td> </tr> <tr> <td colspan="5" style="text-align: center;">CONTRACT NO. 76K86</td> </tr> <tr> <td colspan="5" style="text-align: center;">ILLINOIS FED. AID PROJECT</td> </tr> </table>	F.A.P. RTE.	SECTION	COUNTY	TOTAL SHEETS	SHEET NO.	799	1-BR, BDS-3	ST. CLAIR	16	14	CONTRACT NO. 76K86					ILLINOIS FED. AID PROJECT				
F.A.P. RTE.	SECTION	COUNTY	TOTAL SHEETS	SHEET NO.																							
799	1-BR, BDS-3	ST. CLAIR	16	14																							
CONTRACT NO. 76K86																											
ILLINOIS FED. AID PROJECT																											

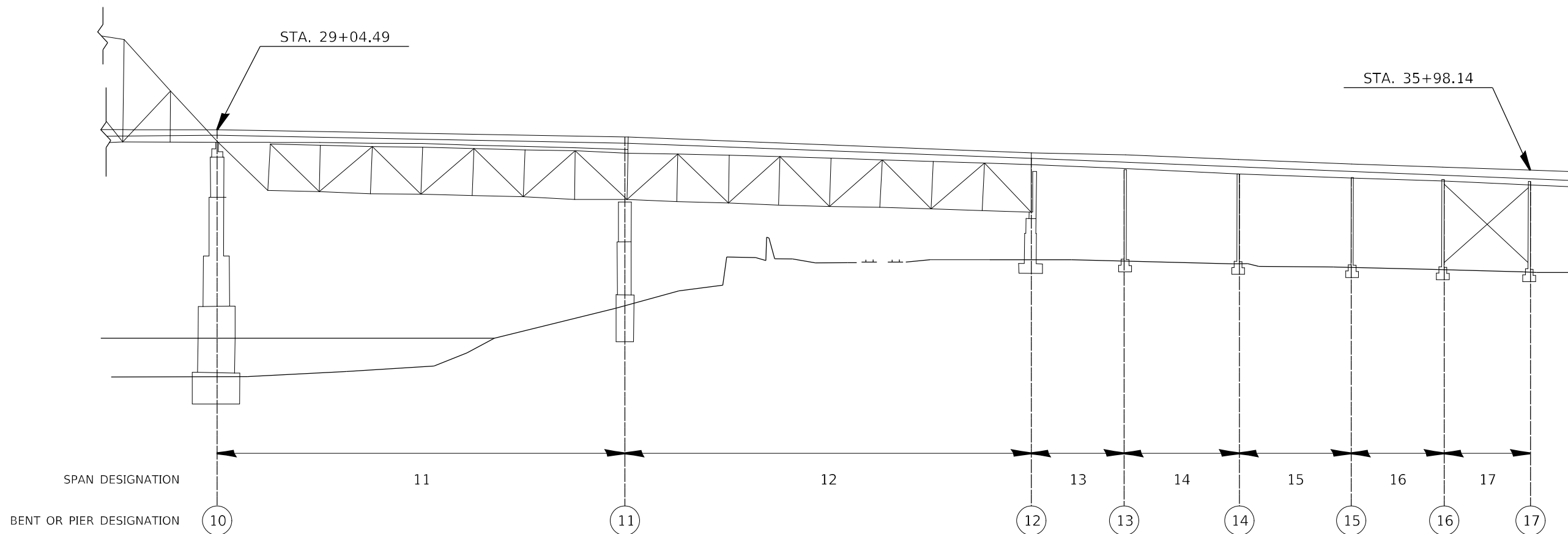

ELEVATION
SPANS 11 TO 17

MODEL: Default
 FILE: 76K86-1-11-17.dwg
 PLOT DATE: 2/2/2023
 PLOT SCALE: 100.0317' / in.
 USER: Karen.Challandes
 PROJECT: I1076666-11-17-17.dwg

USER NAME = Karen.Challandes	DESIGNED -	REVISED -
	DRAWN -	REVISED -
PLOT SCALE = 100.0317' / in.	CHECKED -	REVISED -
PLOT DATE = 2/2/2023	DATE -	REVISED -

**STATE OF ILLINOIS
DEPARTMENT OF TRANSPORTATION**

ELEVATION			
SCALE:	SHEET 3	OF 4 SHEETS	STA. TO STA.

F.A.P. RTE. 799	SECTION 1-BR, BDS-3	COUNTY ST. CLAIR	TOTAL SHEETS 16	SHEET NO. 15
CONTRACT NO. 76K86			ILLINOIS FED. AID PROJECT	

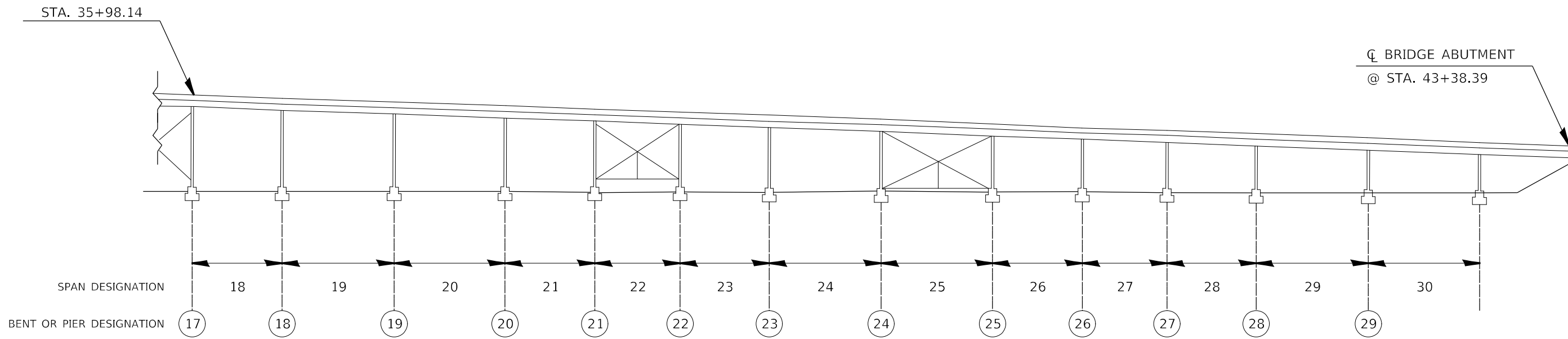

ELEVATION
SPANS 18 TO 30

MODEL: Default
 FILE: \\na11e01.pw.usdnet-cw.bea.fwy.com\FW\DOT\Documents\DOT_Offices\Dir\dr. B\Project\0876466\CAD\data\CAD\sheet\0876466-sh1-jplcal.dgn

USER NAME = Karen.Challandes PLOT SCALE = 100.0317' / in. PLOT DATE = 2/2/2023	DESIGNED -	REVISED -	STATE OF ILLINOIS DEPARTMENT OF TRANSPORTATION	ELEVATION		F.A.P. RTE.	SECTION	COUNTY	TOTAL SHEETS	SHEET NO.
	DRAWN -	REVISED -		799	1-BR, BDS-3	ST. CLAIR	16	16		
	CHECKED -	REVISED -		SCALE: SHEET 4 OF 4 SHEETS STA. TO STA.		CONTRACT NO. 76K86				
DATE -	REVISED -			ILLINOIS FED. AID PROJECT						