

STATE OF ILLINOIS  
DEPARTMENT OF TRANSPORTATION

F.A.I. RTE.	SECTION	COUNTY	TOTAL SHEETS	SHEET NO.
66	60 (1,2,3)PP	MADISON	10	1
		ILLINOIS	CONTRACT NO.	76R90

FOR INDEX OF SHEETS, SEE SHEET NO. 2

**TRAFFIC DATA**

I-270 TO IL 143

2021 ADT = 35400 (ACTUAL)  
2022 ADT = 35800 (ESTIMATED)  
2042 ADT = 43600 (ESTIMATED)  
SU = 2.6% MU = 20.9%

IL 143 TO IL 140

2021 ADT = 38600 (ACTUAL)  
2022 ADT = 38900 (ESTIMATED)  
2042 ADT = 47600 (ESTIMATED)  
SU = 3.6% MU = 16.5%

IL 140 TO IL 4

2021 ADT = 33500 (ACTUAL)  
2022 ADT = 33800 (ESTIMATED)  
2042 ADT = 41300 (ESTIMATED)  
SU = 2.7% MU = 22.7%

IL 4 TO NEW DOUGLAS RD

2021 ADT = 31900 (ACTUAL)  
2022 ADT = 32200 (ESTIMATED)  
2042 ADT = 49300 (ESTIMATED)  
SU = 2.8% MU = 23.8%

NEW DOUGLAS RD TO COUNTY LINE

2021 ADT = 30300 (ACTUAL)  
2022 ADT = 30600 (ESTIMATED)  
2042 ADT = 37300 (ESTIMATED)  
SU = 2.8% MU = 20.1%

**PROPOSED  
HIGHWAY PLANS**

FAI ROUTE 55 (I-55)  
SECTION 60-(1,2,3)PP  
PAVEMENT PATCHING - CM  
MADISON COUNTY

C-98-053-23

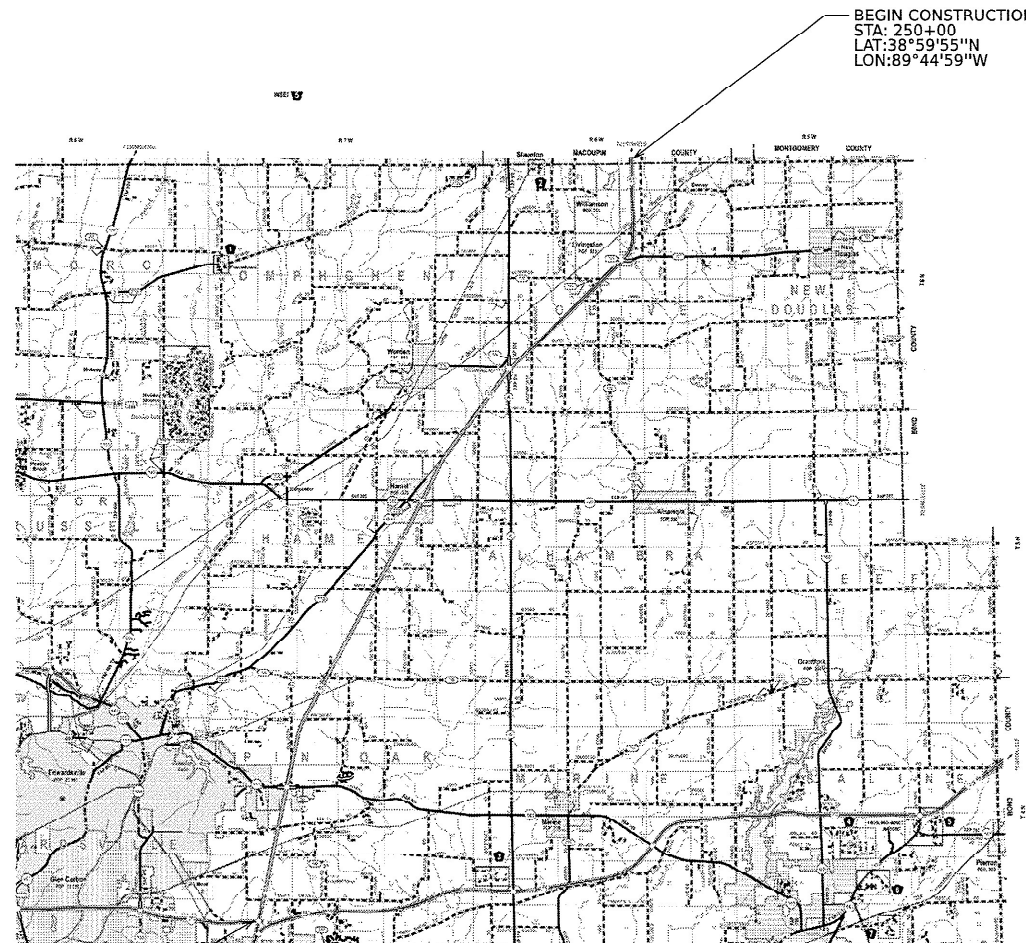
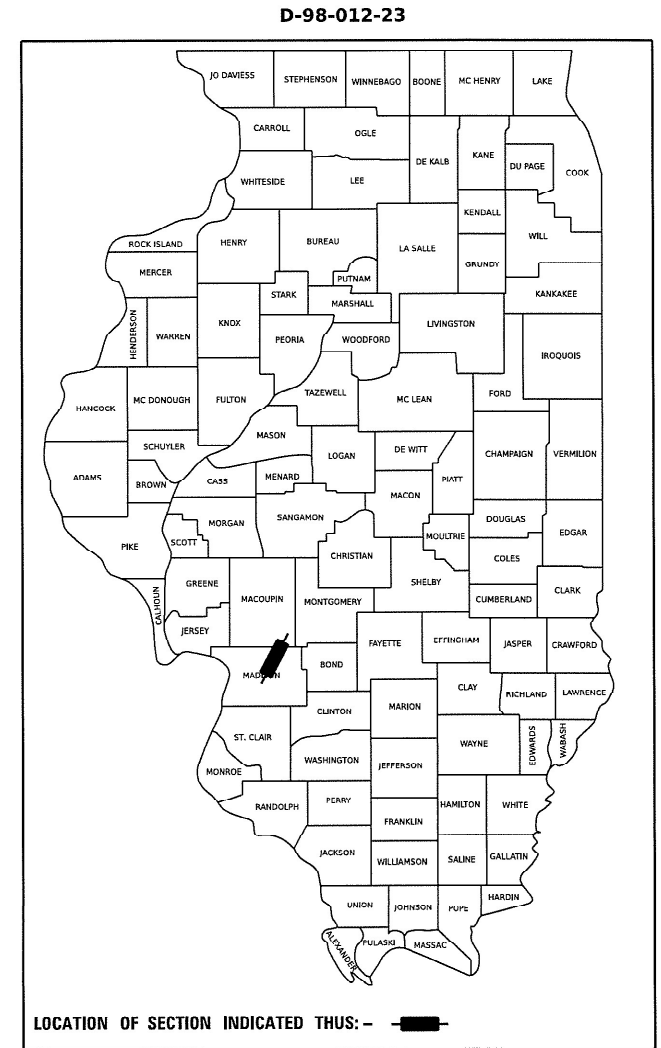

END CONSTRUCTION  
STA: 1382+94  
LAT: 38°45'8.4\"/>

BEGIN CONSTRUCTION  
STA: 250+00  
LAT: 38°59'55\"/>

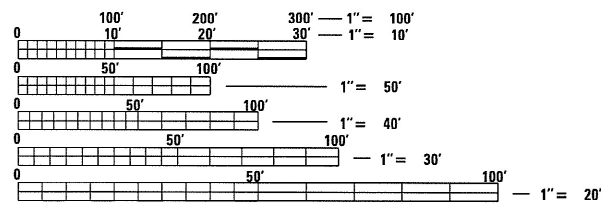

FULL SIZE PLANS HAVE BEEN PREPARED USING STANDARD ENGINEERING SCALES. REDUCED SIZED PLANS WILL NOT CONFORM TO STANDARD SCALES. IN MAKING MEASUREMENTS ON REDUCED PLANS, THE ABOVE SCALES MAY BE USED.

J.U.L.I.E.  
JOINT UTILITY LOCATION INFORMATION FOR EXCAVATION  
1-800-892-0123  
OR 811

PROJECT ENGINEER: BILLIE OWEN  
PROJECT MANAGER: MIKE BERG

CONTRACT NO. 76R90

GROSS/NET LENGTH = 103,435.2 FT. = 19.59 MILE

STATE OF ILLINOIS  
DEPARTMENT OF TRANSPORTATION

SUBMITTED *Jan 27 20 23*  
*Kiz HFB*  
REGIONAL ENGINEER

March 24, 2023  
*S. E. A. etc*  
ENGINEER OF DESIGN AND ENVIRONMENT

March 24, 2023  
*Stephen M. ...*  
DIRECTOR OF HIGHWAYS PROJECT IMPLEMENTATION

PRINTED BY THE AUTHORITY  
OF THE STATE OF ILLINOIS

**INDEX OF SHEETS**

- 1. COVER SHEET
- 2. INDEX OF SHEETS, STANDARDS, GENERAL NOTES, COMMITMENTS
- 3. SUMMARY OF QUANTITIES
- 4-5 TYPICALS
- 6-7 SCHEDULE OF QUANTITIES
- 8 CLASS C PATCH (SPECIAL) DETAIL
- 9-10 CLASS A PATCH (SPECIAL) DETAIL

**STANDARDS**

406101-05	000001-08
442001-04	001001-02
442101-09	001006
442201-03	420001-10
701101-05	780001-05
701106-02	781001-04
701400-11	
701401-13	
701411-09	
701426-09	
701428-01	
701451-05	
701456-05	
701901-08	

**GENERAL NOTES**

- 1. UTILITIES KNOWN TO HAVE FACILITIES WITHIN THE PROJECT AREA ARE AS FOLLOWS:

AMEREN ILLINOIS  
 AT&T ILLINOIS  
 BOND MADISON WATER COMPANY  
 BUCKEYE PARTNERS L.P.-WOOD RIVER PIPELINE  
 CHARTER COMMUNICATIONS, INC.  
 CONSOLIDATED COMMUNICATIONS  
 CITY OF EDWARDSVILLE  
 VILLAGE OF HAMEL  
 ILLINOIS AMERICAN WATER  
 LEVEL 3 COMMUNICATIONS, LLC  
 MADISON TELEPHONE COMPANY  
 MARATHON PIPE LINE LLC  
 VERIZON BUSINESS  
 NORTHEAST CENTRAL COUNTY PUBLIC WATER DISTRICT  
 PLAINES MARKETING, LP  
 SOUTHWESTERN ELECTRIC COOPERATIVE, INC.  
 TC ENERGY  
 WINDSTREAM KDL, INC.

- 2. NO SURVEY WAS PERFORMED FOR THIS PROJECT AND THE PLANS WERE CREATED USING MICROFILM AND FIELD MEASUREMENTS.
- 3. THE RESIDENT ENGINEER SHALL VERIFY THE EXISTENCE OF HIGHWAY LIGHTING AND/OR INTELLIGENT TRANSPORTATION SYSTEMS (I.T.S) UTILITIES WITHIN THE PROJECT LIMITS. IF HIGHWAY LIGHTING AND/OR I.T.S. EXISTS WITHIN THE PROJECT LIMITS, AND IF THESE ITEMS REQUIRE LOCATING, THE CONTRACTOR SHALL BE DIRECTED TO DO SO ACCORDING TO SECTION 803 OF THE STANDARD SPECIFICATIONS. THIS WORK SHALL BE PAID FOR ACCORDING TO ARTICLE 109.04 OF THE STANDARD SPECIFICATIONS.
- 4. FIVE CHANGEABLE MESSAGE SIGNS SHALL BE REQUIRED FOR THIS PROJECT. TWO CHANGEABLE MESSAGE SIGNS SHALL BE PLACED AT THE BEGINNING AND END OF THE PROJECT TWO WEEKS PRIOR TO ANY LANE CLOSURE AND SHALL REMAIN UP FOR THE DURATION OF THE PROJECT. THREE CHANGEABLE MESSAGE SIGNS SHALL BE PLACED AS SPECIFIED IN THE WEEKEND CLOSURES SPECIAL PROVISION.
- 5. THE DEPARTMENT STRONGLY ENCOURAGES THE PRIME CONTRACTOR AND THEIR APPROVED SUB-CONTRACTORS TO HIRE MINORITY, WOMEN, AND DISADVANTAGED INDIVIDUALS FROM ITS FEDERALLY FUNDED HIGHWAY CONSTRUCTION CAREERS TRAINING PROGRAM (HCCTP) TO HELP MEET WORKFORCE AND TRAINEE GOALS. THIS PROGRAM IS TRAINING MINORITIES, WOMEN AND DISADVANTAGED INDIVIDUALS IN HIGHWAY CONSTRUCTION-RELATED SKILLS, E.G., MATH FOR THE TRADES, JOB READINESS, TECHNICAL SKILLS COURSEWORK (CARPENTRY, CONCRETE FLATWORK, BLUEPRINT READING, SITE PLANS, SITE WORK, TOOLS USE, ETC.) AND OSHA 10 HOUR CERTIFICATION, TO PREPARE THEM FOR A CAREER IN THE HIGHWAY CONSTRUCTION TRADES. GRADUATES ARE WELL-TRAINED AND READY TO BECOME PRODUCTIVE ENTRY-LEVEL CONSTRUCTION WORKERS. CONTACT THE DISTRICT 8 EEO OFFICE AT 618-346-3360 AND/OR THE HCCTP COORDINATOR AT 618-874-6528 TO LEARN MORE ABOUT THE PROGRAM AND FOR ASSISTANCE IN MEETING WORKFORCE AND TRAINEE GOALS.

**COMMITMENTS**

NONE

REV. - MS

MODEL: Unintd (Sheet)  
 FILE NAME: P:\idc\pw\benley.com\PWIDOT\Documents\DOT\Office\District 8\CRD Projects\0876690\CAD\Drawn\CADsheets\0876690-8ht-gemnote.dgn

USER NAME = Robert.Hughes	DESIGNED - _____	REVISED - _____
	DRAWN - _____	REVISED - _____
PLOT SCALE = 0.16666633 ' / in.	CHECKED - _____	REVISED - _____
PLOT DATE = 1/27/2023	DATE - _____	REVISED - _____

**STATE OF ILLINOIS  
 DEPARTMENT OF TRANSPORTATION**

**INDEX OF SHEETS, STANDARDS, GENERAL NOTES,  
 AND COMMITMENTS**

SCALE: NTS SHEET 1 OF 1 SHEETS STA. \_\_\_+\_\_\_ TO STA. \_\_\_+\_\_\_

F.A.I. RTE.	SECTION	COUNTY	TOTAL SHEETS	SHEET NO.
55	60-(1,2,3)PP	MADISON	10	2
CONTRACT NO. 76R90				
ILLINOIS FED. AID PROJECT				

100% STATE

CODE NO.	ITEM	UNIT	TOTAL QUANTITY	CONSTRUCTION CODE	
				ROADWAY 0006	ROADWAY 0006
				URBAN	RURAL
4200060	WELDED WIRE REINFORCEMENT	SQ YD	773	302	471
44201023	CLASS B PATCHES, TYPE III, 14 INCH	SQ YD	25		25
44201025	CLASS B PATCHES, TYPE IV, 14 INCH	SQ YD	728	438	290
44201102	CLASS B PATCHES, TYPE II, 20 INCH	SQ YD	8	8	
44201104	CLASS B PATCHES, TYPE III, 20 INCH	SQ YD	20	20	
44201298	DOWEL BARS 1 1/4"	EACH	176	116	60
44201299	DOWEL BARS 1 1/2"	EACH	40	40	
44213000	PATCHING REINFORCEMENT	SQ YD	238		238
44213200	SAW CUTS	FOOT	3442	883	2559
44213204	TIE BARS 3/4"	EACH	270	57	213
67100100	MOBILIZATION	L SUM	1	0.5	0.5
70100420	TRAFFIC CONTROL AND PROTECTION, STANDARD 701411	EACH	1	1	
70100800	TRAFFIC CONTROL AND PROTECTION, STANDARD 701401	L SUM	1	0.5	0.5
70100820	TRAFFIC CONTROL AND PROTECTION, STANDARD 701451	L SUM	1	0.33	0.67
70100825	TRAFFIC CONTROL AND PROTECTION, STANDARD 701456	L SUM	1	0.33	0.67

100% STATE

CODE NO.	ITEM	UNIT	TOTAL QUANTITY	CONSTRUCTION CODE	
				ROADWAY 0006	ROADWAY 0006
				URBAN	RURAL
70107025	CHANGEABLE MESSAGE SIGN	CAL DA	124	56	68
70200100	NIGHTTIME WORK ZONE LIGHTING	L SUM	1	0.5	0.5
70300100	SHORT TERM PAVEMENT MARKING	FOOT	268	148	120
70300150	SHORT TERM PAVEMENT MARKING REMOVAL	SQ FT	89	50	39
* 78001130	PAINT PAVEMENT MARKING - LINE 6"	FOOT	1247	856	391
* 78100100	RAISED REFLECTIVE PAVEMENT MARKER	EACH	9	2	7
78300200	RAISED REFLECTIVE PAVEMENT MARKER REMOVAL	EACH	9	2	7
X4420621	CLASS A PATCHES, TYPE II, 14 INCH (SPEC IAL)	SQ YD	62		62
X4420624	CLASS A PATCHES, TYPE III, 14 INCH (SPEC IAL)	SQ YD	16		16
X4420628	CLASS A PATCHES, TYPE IV, 14 INCH (SPEC IAL)	SQ YD	160		160
X4420743	CLASS C PATCHES, TYPE IV, 16 INCH (SPECIAL)	SQ YD	50		50

\* SPECIALTY ITEM

MODEL: Unintelligible File Name: per:///idb:pw\_bentley.com/PWD/OT/Documental/IDOT/Office/District\_9/CARD/Projects/0876890/CADD/ans/Caddsheet/0876890-sh-500.dgn

REV. - MS

USER NAME = Robert.Hughes	DESIGNED - _____	REVISED - _____
	DRAWN - _____	REVISED - _____
PLOT SCALE = 0.16666633 1/ in.	CHECKED - _____	REVISED - _____
PLOT DATE = 1/27/2023	DATE - _____	REVISED - _____

STATE OF ILLINOIS  
DEPARTMENT OF TRANSPORTATION

SUMMARY OF QUANTITIES

SCALE: NTS SHEET 1 OF 1 SHEETS STA. + TO STA. +

F.A.I. RTE.	SECTION	COUNTY	TOTAL SHEETS	SHEET NO.
55	60-(1,2,3)PP	MADISON	10	3
			CONTRACT NO. 76R90	
ILLINOIS FED. AID PROJECT				

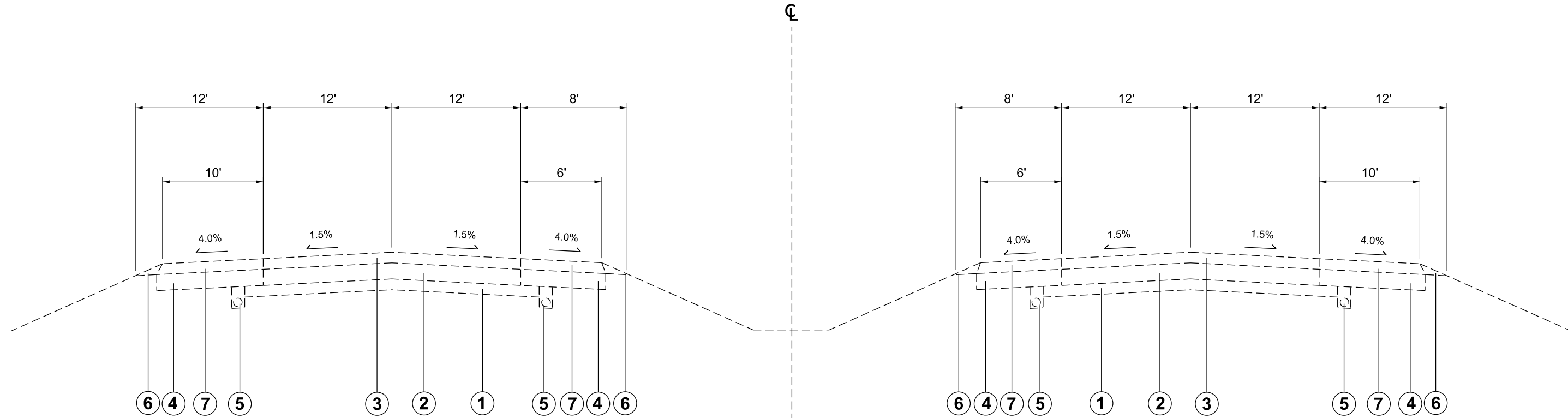

**EXISTING TYPICAL SECTION**  
F.A.I. 55 (SUPERELEVATION VARIES)

**EXISTING LEGEND**

- ① EXISTING STABILIZED SUBBASE (VARIES, SEE TABLE 1)
- ② EXISTING P.C.C. PAVEMENT (VARIES, SEE TABLE 1)
- ③ EXISTING BIT. OVERLAY (VARIES, SEE TABLE 1)
- ④ EXISTING STABILIZED SHOULDERS
- ⑤ EXISTING PIPE UNDERDRAINS
- ⑥ EXISTING AGGREGATE SHOULDERS
- ⑦ EXISTING BITUMINOUS SHOULDERS
- ⑧ EXISTING AGGREGATE BASE COURSE, TYPE A 12"
- ⑨ EXISTING PCC SHOULDERS 12" (SPECIAL)

TABLE 1	APPR. MILE MARKER EQUIVALENCIES	SUBBASE THICKNESS	P.C.C. THICKNESS	CONTINUOUSLY REINFORCED	BIT. OVERLAY THICKNESS
STATION 250+00 TO STATION 520+12.5 N.B. & S.B.	MM 39.3 TO 34.0	4"	9"	YES	4 1/4"
STATION 734+00 TO STATION 1033+86.46 N.B. STATION 734+00 TO STATION 1033+86.46 S.B.	MM 29.8 TO 24.3	7"	10"	NO	11 1/2"
STATION 1271+55 TO STATION 1382+94 S.B.	MM 19.5 TO 17.4	8"	10"	NO	5" to 5 1/2"
RAMP (IL 140)	NA	4"	9"	NO	4 1/4"
RAMP (IL 143)	NA	4"	8"	NO	4 1/4"
RAMP (IL 4)	NA	4"	8"	NO	6 1/2"

MODEL: User\Hed [Sheet]  
 FILE NAME: p:\illinois\dot\documents\dot\office\district 8\8080 Projects\087690\CADD\Drawn\CAD\Drawn\087690\sheet-typical.dgn

USER NAME = Robert.Hughes	DESIGNED - _____	REVISED - _____
	DRAWN - _____	REVISED - _____
PLOT SCALE = 0.16666633 ' / in.	CHECKED - _____	REVISED - _____
PLOT DATE = 1/27/2023	DATE - _____	REVISED - _____

**STATE OF ILLINOIS**  
**DEPARTMENT OF TRANSPORTATION**

**TYPICALS**

SCALE: NTS    SHEET 1 OF 2 SHEETS    STA. \_\_\_\_+\_\_\_\_ TO STA. \_\_\_\_+\_\_\_\_

F.A.I. RTE. 55	SECTION 60-(1,2,3)PP	COUNTY MADISON	TOTAL SHEETS 10	SHEET NO. 4
ILLINOIS FED. AID PROJECT			CONTRACT NO. 76R90	

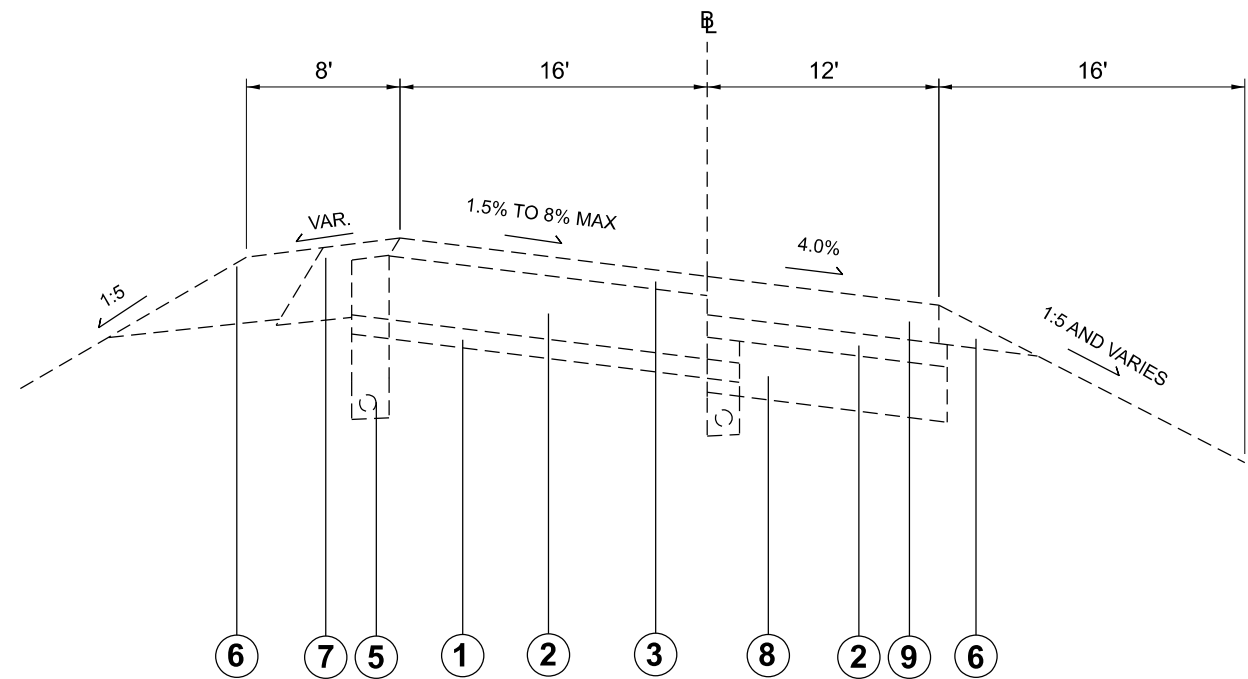

EXISTING TYPICAL SECTION  
(IL 140, IL 143)

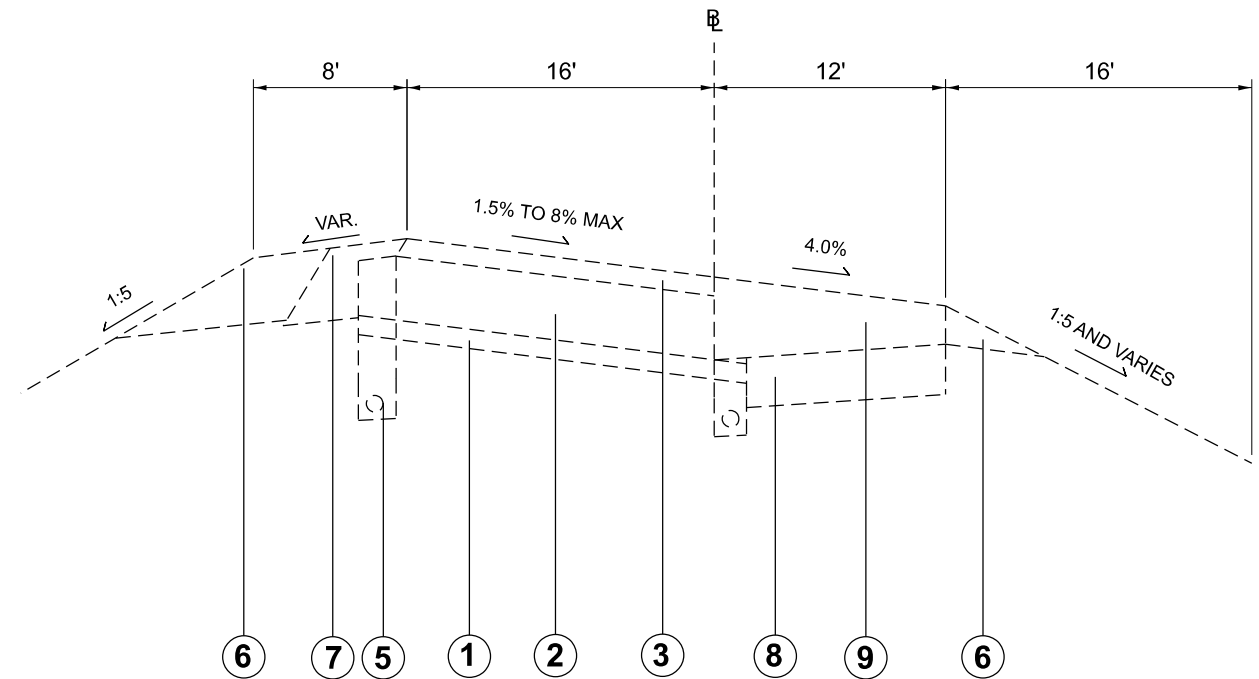

EXISTING TYPICAL SECTION  
(IL 4)

**EXISTING LEGEND**

- ① EXISTING STABILIZED SUBBASE (VARIES, SEE CHART)
- ② EXISTING P.C.C. PAVEMENT (VARIES, SEE CHART)
- ③ EXISTING BIT. OVERLAY (VARIES, SEE CHART)
- ④ EXISTING STABILIZED SHOULDERS
- ⑤ EXISTING PIPE UNDERDRAINS
- ⑥ EXISTING AGGREGATE SHOULDERS
- ⑦ EXISTING BITUMINOUS SHOULDERS
- ⑧ EXISTING AGGREGATE BASE COURSE, TYPE A 12"
- ⑨ EXISTING PCC SHOULDERS 12" (SPECIAL)

TABLE 1	APPR. MILE MARKER EQUIVALENCIES	SUBBASE THICKNESS	P.C.C. THICKNESS	CONTINUOUSLY REINFORCED	BIT. OVERLAY THICKNESS
STATION 250+00 TO STATION 520+12.5 N.B & S.B.	MM 39.3 TO 34.0	4"	9"	YES	4 1/4"
STATION 734+00 TO STATION 1033+86.46 N.B. STATION 734+00 TO STATION 1033+86.46 S.B.	MM 29.8 TO 24.3	7"	10"	NO	11 1/2"
STATION 1271+55 TO STATION 1382+94 S.B.	MM 19.5 TO 17.4	8"	10"	NO	5" to 5 1/2"
RAMP (IL 140)	NA	4"	9"	NO	4 1/4"
RAMP (IL 143)	NA	4"	8"	NO	4 1/4"
RAMP (IL 4)	NA	4"	8"	NO	6 1/2"

MODEL: Sheet 3 (Sheet)  
 FILE NAME: p:\illinois\berkeley.com\PIV\DOT\Documents\DOT Office\District 8\8RD Projects\87690\CAD\Draws\CAD\Draws\87690\87690-shd-typical.dgn

USER NAME = Robert.Hughes	DESIGNED - _____	REVISED - _____
	DRAWN - _____	REVISED - _____
PLOT SCALE = 0.16666633 ' / in.	CHECKED - _____	REVISED - _____
PLOT DATE = 1/27/2023	DATE - _____	REVISED - _____

STATE OF ILLINOIS  
DEPARTMENT OF TRANSPORTATION

TYPICALS

SCALE: NTS SHEET 2 OF 2 SHEETS STA. \_\_\_\_+\_\_\_\_ TO STA. \_\_\_\_+\_\_\_\_

F.A.I. RTE.	SECTION	COUNTY	TOTAL SHEETS	SHEET NO.
55	60-(1,2,3)PP	MADISON	10	5
CONTRACT NO. 76R90				
ILLINOIS FED. AID PROJECT				

PAVEMENT MARKING SCHEDULE						
LOCATION	PAINT PAVEMENT MARKING - LINE 6"		RAISED REFLECTIVE PAVEMENT MARKER (EACH)	RAISED REFLECTIVE PAVEMENT MARKER REMOVAL (EACH)		
	SOLID WHITE	SKIP DASH WHITE				
	(FT)	(FT)				
SB I-55 MM 39.0	50	20	2	2		
SB I-55 MM 38.7	12	10	1	1		
SB I-55 MM 38.5	15	10				
SB I-55 MM 38.4	8	10	1	1		
SB I-55 MM 38.2	10	10				
SB I-55 MM 37.9	8	10	1	1		
SB I-55 MM 37.8	8	10	1	1		
SB I-55 MM 37.6	10	10	1	1		
SB I-55 MM 24.7	15	10	1	1		
SB I-55 MM 19.5	75	20				
NB I-55 MM 39.3	140	40				
NB I-55 MM 24.3	6	10	1	1		
NB I-55 EXIT TO IL 143	14	10				
NB I-55 EXIT TO IL 143	271	70				
NB I-55 EXIT TO IL 143	70	20				
NB I-55 EXIT TO IL 140	34	10				
IL 4 ENTRANCE TO I-55 NB	65	20				
IL 4 ENTRANCE TO I-55 NB	106	30				
<b>TOTAL:</b>	1247		9	9		

SHORT TERM PAVEMENT MARKING SCHEDULE			
LOCATION		SKIP DASH WHITE	REMOVAL
		(FT)	(SQ FT)
SB I-55 MM 39.0		12	4
SB I-55 MM 38.7		8	3
SB I-55 MM 38.5		8	3
SB I-55 MM 38.4		8	3
SB I-55 MM 38.2		8	3
SB I-55 MM 37.9		8	3
SB I-55 MM 37.8		8	3
SB I-55 MM 37.6		8	3
SB I-55 MM 24.7		8	3
SB I-55 MM 19.5		12	4
NB I-55 MM 39.3		20	7
NB I-55 MM 24.3		8	3
NB I-55 EXIT TO IL 143		8	3
NB I-55 EXIT TO IL 143		64	21
NB I-55 EXIT TO IL 143		20	7
NB I-55 EXIT TO IL 140		8	3
IL 4 ENTRANCE TO I-55 NB		20	7
IL 4 ENTRANCE TO I-55 NB		32	11
<b>TOTAL:</b>		268	89

MODEL: Sheet1 (Sheet1)  
 FILE NAME: P:\ilidoc\ch\berkey.com\PMIDOT\Documents\DOT\_Offices\District 8\8RD Projects\876690\CADD\Draw\CAD\Draw\DOT\876690\short-term-schedule.dgn

USER NAME = Robert.Hughes	DESIGNED - _____	REVISED - _____
	DRAWN - _____	REVISED - _____
PLOT SCALE = 0.16666633 1/16 in.	CHECKED - _____	REVISED - _____
PLOT DATE = 1/27/2023	DATE - _____	REVISED - _____

**STATE OF ILLINOIS  
DEPARTMENT OF TRANSPORTATION**

**SCHEDULE OF QUANTITIES**

SCALE: NTS      SHEET 1 OF 2 SHEETS      STA. \_\_\_+\_\_\_ TO STA. \_\_\_+\_\_\_

F.A.I. RTE.	SECTION	COUNTY	TOTAL SHEETS	SHEET NO.
55	60-(1,2,3)PP	MADISON	10	6
CONTRACT NO. 76R90				
ILLINOIS FED. AID PROJECT				

CLASS A PATCHING SCHEDULE									
LOCATION	LENGTH	WIDTH	DEPTH	CLASS A PATCHES, TYPE II, 14 INCH (SPECIAL)	CLASS A PATCHES, TYPE III, 14 INCH (SPECIAL)	CLASS A PATCHES, TYPE IV, 14 INCH (SPECIAL)	PATCHING REINFORCEMENT	TIE BARS 3/4"	SAW CUTS
	(FT)	(FT)	(IN)	(SQ YD)	(SQ YD)	(SQ YD)	(SQ YD)	(EACH)	(FT)
SB I-55 MM 39.0	50	12	13 1/4			66.7	66.7	17	199
SB I-55 MM 38.7	12	12	13 1/4		16.0		16.0		89
SB I-55 MM 38.5	15	6	13 1/4	10.0			10.0		70
SB I-55 MM 38.4	8	12	13 1/4	10.7			10.7		78
SB I-55 MM 38.2	10	6	13 1/4	6.7			6.7		56
SB I-55 MM 37.9	8	12	13 1/4	10.7			10.7		78
SB I-55 MM 37.8	8	12	13 1/4	10.7			10.7		78
SB I-55 MM 37.6	10	12	13 1/4	13.3			13.3		84
NB I-55 MM 39.3	140	6	13 1/4			93.3	93.3	47	444
TOTAL:				62	16	160	238	64	1177

CLASS B PATCHING SCHEDULE												
LOCATION	LENGTH	WIDTH	DEPTH	CLASS B PATCHES, TYPE III, 14 INCH	CLASS B PATCHES, TYPE IV, 14 INCH	CLASS B PATCHES, TYPE II 20 INCH	CLASS B PATCHES, TYPE III, 20 INCH	TIE BARS 3/4"	DOWEL BARS 1 1/4"	DOWEL BARS 1 1/2"	WELDED WIRE REINFORCEMENT	SAW CUTS
	(FT)	(FT)	(IN)	(SQ YD)	(SQ YD)	(SQ YD)	(SQ YD)	(EACH)	(EACH)	(EACH)	(SQ YD)	(FT)
SB I-55 MM 24.7	15	12	21 1/2				20.0			20	20	73
NB I-55 MM 24.3	6	12	21 1/2			8.0				20		49
NB I-55 EXIT TO IL 143	14	16	12 1/4	24.9					28		25	81
NB I-55 EXIT TO IL 143	271	6	12 1/4		180.7			90	8		181	825
NB I-55 EXIT TO IL 143	70	14	12 1/4		108.9			23	24		109	239
NB I-55 EXIT TO IL 140	34	18.5	13 1/4		69.9			11	32		70	144
IL 4 ENTRANCE TO I-55 NB	65	38	14 1/2		274.4			22	72		274	281
IL 4 ENTRANCE TO I-55 NB	106	8	14 1/2		94.2			35	12		94	334
TOTAL:				25	728	8	20	181	176	40	773	2028

CLASS C PATCHING SCHEDULE						
LOCATION	LENGTH	WIDTH	DEPTH	CLASS C PATCHES, TYPE IV, 16 INCH (SPECIAL)	TIE BARS 3/4"	SAW CUTS
	(FT)	(FT)	(IN)	(SQ YD)	(EACH)	(FT)
SB I-55 MM 19.5	75	6	15	50.0	25	237
TOTAL:				50	25	237

MODEL: R:\in\1416\_2-21-2023 (Sheet)  
 FILE NAME: P:\1416\_2-21-2023\1416\_2-21-2023\1416\_2-21-2023\1416\_2-21-2023\1416\_2-21-2023.dwg

USER NAME = RobertHughes	DESIGNED - _____	REVISED - _____
	DRAWN - _____	REVISED - _____
PLOT SCALE = 0.16666633' / in.	CHECKED - _____	REVISED - _____
PLOT DATE = 2/21/2023	DATE - _____	REVISED - _____

**STATE OF ILLINOIS  
DEPARTMENT OF TRANSPORTATION**

**SCHEDULE OF QUANTITIES**

SCALE: NTS      SHEET 1 OF 1 SHEETS      STA. \_\_\_+\_\_\_ TO STA. \_\_\_+\_\_\_

F.A.I. RTE.	SECTION	COUNTY	TOTAL SHEETS	SHEET NO.
55	60-(1,2,3)PP	MADISON	8	7
CONTRACT NO. 76R90				
ILLINOIS FED. AID PROJECT				

EDGE OF LANE



EXISTING PATCH

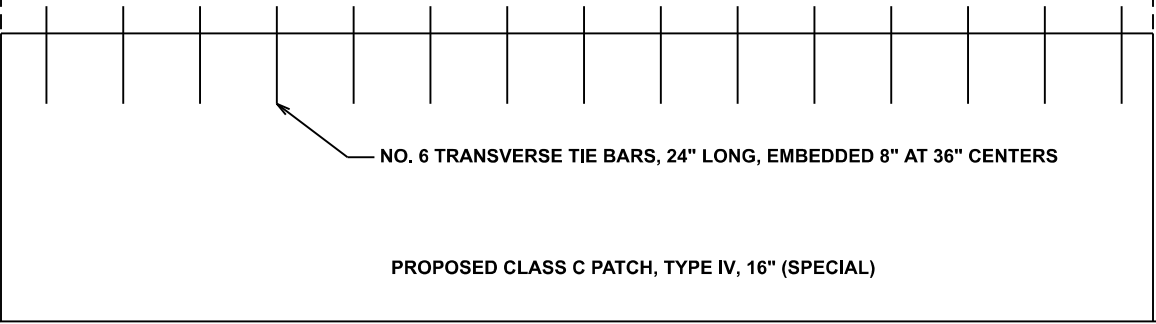

PROPOSED CLASS C PATCH, TYPE IV, 16" (SPECIAL)

EDGE OF PAVEMENT



MODEL: Sheet\_2 (Sheet)  
 FILE NAME: p:\illinois\berkeley.com\PIV\DOT\Documents\DOT Offices\District 8\8RD Projects\876690\CADD\Draw\CAD\Drawings\876690\876690-04-tytical.dgn

USER NAME = Robert.Hughes	DESIGNED - _____	REVISED - _____
	DRAWN - _____	REVISED - _____
PLOT SCALE = 0.16666633 '1/ in.	CHECKED - _____	REVISED - _____
PLOT DATE = 1/27/2023	DATE - _____	REVISED - _____

**STATE OF ILLINOIS  
DEPARTMENT OF TRANSPORTATION**

**CLASS C PATCH (SPECIAL) DETAIL**

SCALE: NTS      SHEET 1 OF 1 SHEETS      STA. \_\_\_+\_\_\_ TO STA. \_\_\_+\_\_\_

F.A.I. RTE.	SECTION	COUNTY	TOTAL SHEETS	SHEET NO.
55	60-(1,2,3)PP	MADISON	10	8
ILLINOIS FED. AID PROJECT			CONTRACT NO. 76R90	





**TRANSVERSE EXPANSION JOINTS**

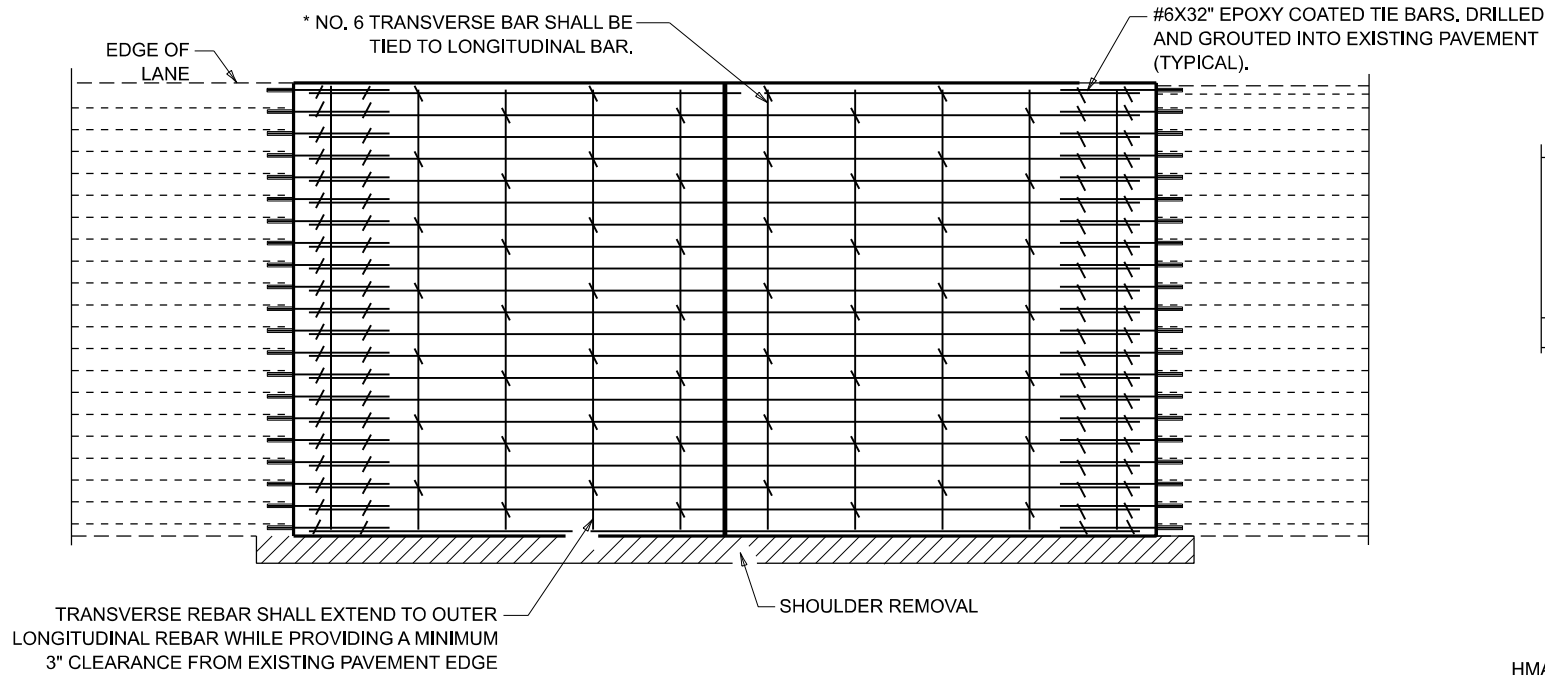

**PAVEMENT REINFORCEMENT DETAIL**

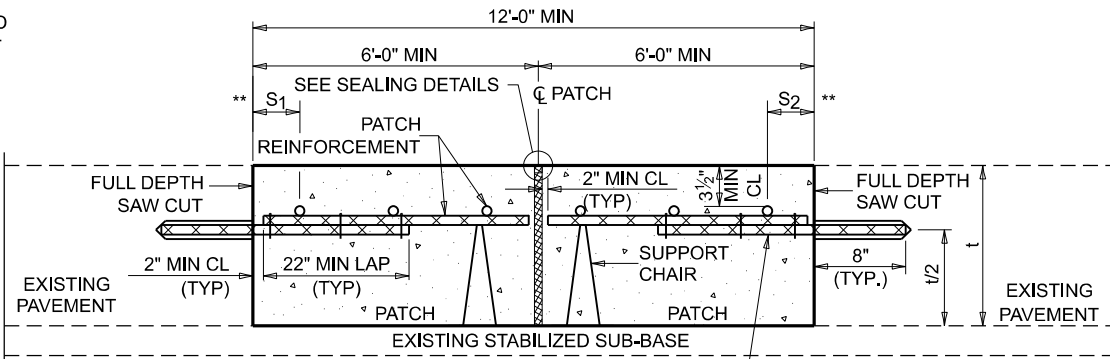

**WITHOUT HMA OVERLAY**

#6X32" EPOXY COATED TIE BARS DRILLED AND GROUDED INTO EXISTING PAVEMENT (TYPICAL)

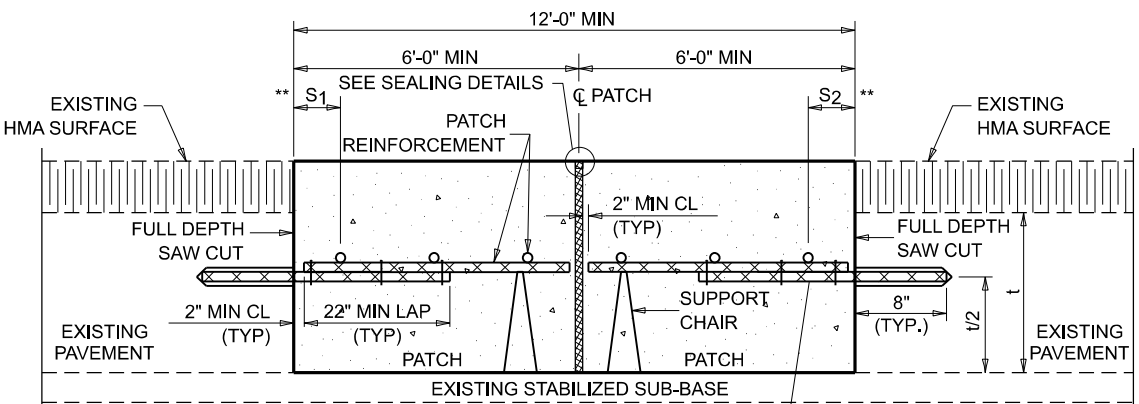

**WITH HMA OVERLAY**

#6X32" EPOXY COATED TIE BARS DRILLED AND GROUDED INTO EXISTING PAVEMENT (TYPICAL)

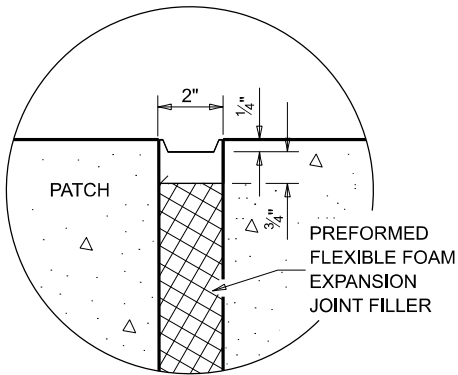

**SEALING DETAIL**

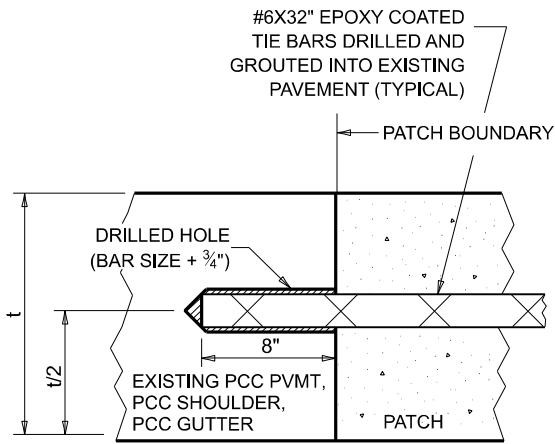

**LONGITUDINAL CONSTRUCTION JOINT**

PATCHES MORE THAN 20' IN LENGTH SHALL BE TIED TO ADJACENT PAVEMENT, PCC SHOULDERS OR PCC CURB AND GUTTER WITH #6x32" EPOXY COATED TIE BARS AT 36" CENTERS.

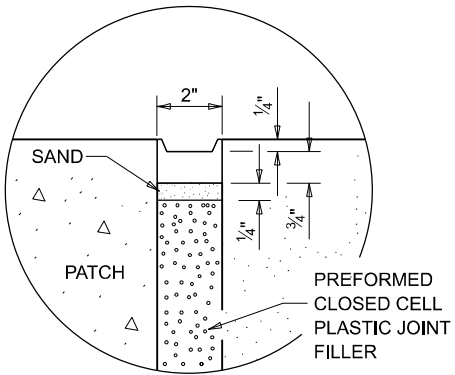

**SEALING DETAIL**

**CLASS A PATCH WITH EXPANSION JOINT**

**NOTES:**

EXISTING LONGITUDINAL REINFORCEMENT SPACING; ±6 1/2".

SPACING OF NEW LONGITUDINAL REINFORCEMENT AND NEW LONGITUDINAL TIE BARS SHALL MATCH SPACING OF EXISTING REINFORCEMENT AND SHALL BE TIED TOGETHER WITH A MINIMUM OF TWO TIES PER BAR.

SUPPORT CHAIRS SHALL BE REQUIRED WHENEVER PATCH LENGTH EXCEEDS 6'-0"

\* EVERY THIRD INTERSECTION MUST BE TIED. WHEN THE MINIMUM CLEARANCE CANNOT BE OBTAINED WITH THE TRANSVERSE REBAR ON TOP, THEN THE TRANSVERSE REBAR SHALL BE TIED TO THE BOTTOM OF THE LONGITUDINAL REBAR.

\*\* VARIABLES WHERE S<sub>1</sub> AND S<sub>2</sub> ARE 2 1/2" MIN. AND 12" MAX.

MODEL: Class A Special 2 (Sheet)  
FILE NAME: I:\projects\pavement\pavement\pavement\DOT Office\Direct\BORD\Projects\B37689\CAD\Drawings\B37689-4-Hypocast.dgn

USER NAME = RobertHughes	DESIGNED - _____	REVISED - _____
PLOT SCALE = 0.16666633' / in.	DRAWN - _____	REVISED - _____
PLOT DATE = 1/27/2023	CHECKED - _____	REVISED - _____
	DATE - _____	REVISED - _____

**STATE OF ILLINOIS  
DEPARTMENT OF TRANSPORTATION**

**CLASS A PATCH (SPECIAL) DETAIL**

SCALE: NTS SHEET 2 OF 2 SHEETS STA. \_\_\_\_+\_\_ TO STA. \_\_\_\_+\_\_

F.A.I. RTE.	SECTION	COUNTY	TOTAL SHEETS	SHEET NO.
55	60-(1,2,3)PP	MADISON	10	10
CONTRACT NO. 76R90				
ILLINOIS FED. AID PROJECT				